

# SKYTТА

## Sliding door system

### Safety

This furniture must be fixed to the ceiling. Different ceiling materials require different types of fixing devices. Use fixing devices suitable for the ceilings in your home, sold separately.

Clean the floor rail and door wheels regularly to make sure the doors run smoothly and the wheels are not damaged.

### Assembly

The total assembly height including the floor and ceiling rails is 80½" for the 77½" door, and 94¾" for the 91" door. They can both be adjusted ¼" up or down.

### Service message

Installing sliding doors can require professional carpentry knowledge.

10

SKYTТА sliding door system has a 10-year limited warranty.



### Sliding doors for any space

Save space, create new space or hide space with SKYTТА sliding doors. The door frames and rails come in three different colors and combines with panels from the PAX range to create a personal solution. Made to run between the ceiling and floor, so no wardrobe frames are needed, and suitable with any of our storage system that fits your space. Or use them as a room divider. Choose a sleek, minimalistic door or an industrial looking glass door to set the style in your room.

A high standard of accuracy has been sought in the preparation of this buying guide. We apologize for, but will not be bound by or responsible for, errors and omissions in this buying guide.

Not all products may be available in all stores. See what is available at your local store by visiting [IKEA-USA.com](https://www.ikea-usa.com). For more detailed product information, see the price tag or visit [IKEA-USA.com](https://www.ikea-usa.com). All products shown require assembly.



# Good to know

Create your own sliding door by choosing between different frames and panels – and combine them as you like.

Our wide range of panels lets you choose between various materials and expressions, such as semi-transparent, glass, high-gloss, wooden foil and mirror.

Integrated handles give the sliding doors a sleek look with clean lines.

If your ceiling is higher than the doors, you can use SKYTТА ceiling height reducer and cover panel to create a fake wall and fill the gap up to 14" above the doors.

If the doors are higher than then your ceiling, it's possible to cut the door at the top, along with the panel. We recommend that you always use our Assembly services for this.

When installing your new storage solution and SKYTТА doors, make sure there are no cables, pipes or heating systems nearby that may prevent the doors from closing completely or which might get damaged during installation



## Plan on paper or use the planner tool

Planning your SKYTТА sliding doors can be a bit tricky, and it's important that all the measurements are correct and aligned. It's perfectly fine to plan on paper if that's what you prefer, but there's also a planner tool available on [IKEA-USA.com/planner](https://www.ikea.com/us/en/planner) to help you out!

# How to measure your space

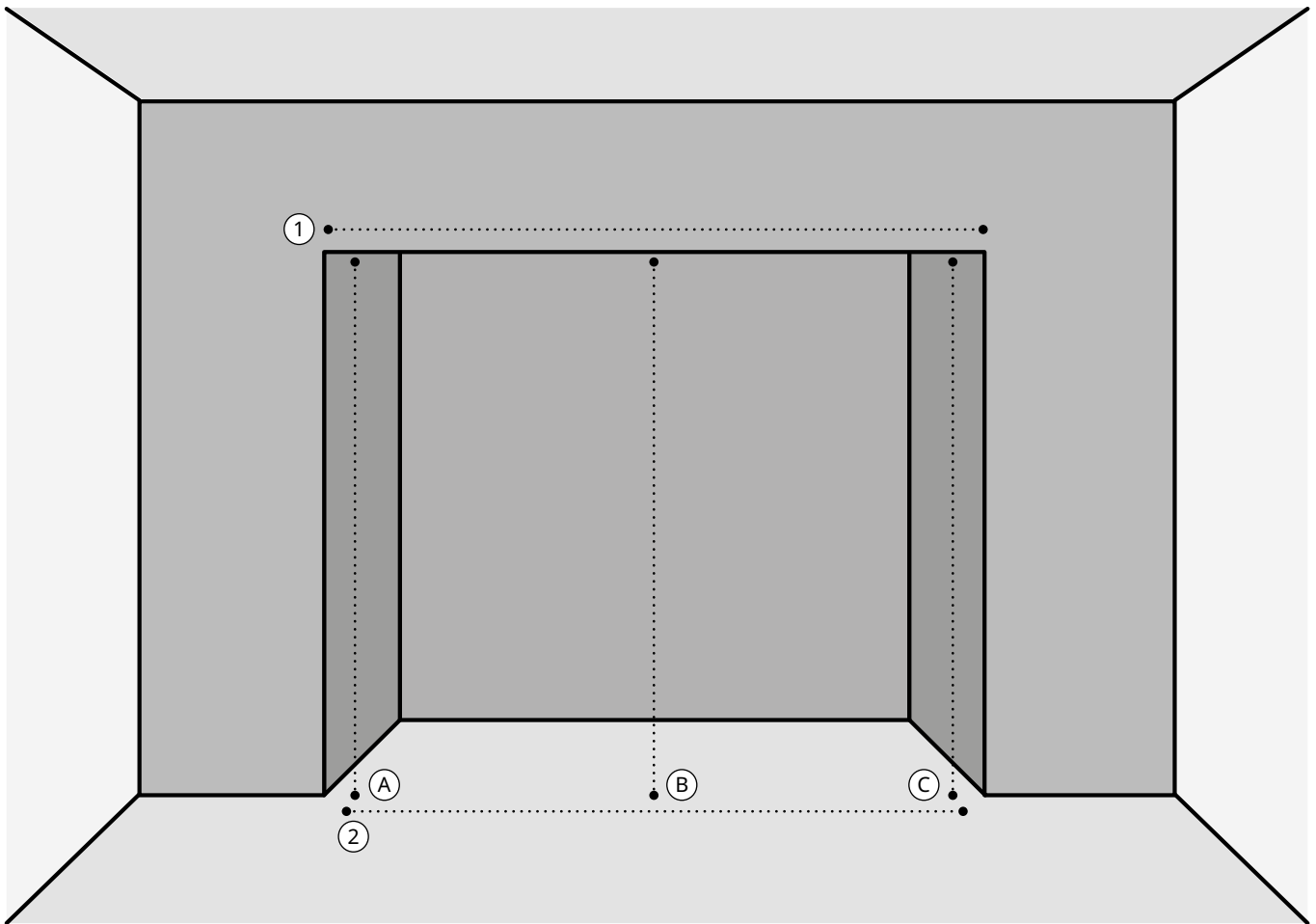

Measure the width (1,2) and height (A, B, C) of your space. Make sure to measure the height in at least three places as the ceiling or floor might be slightly uneven. It's important that you measure the exact spot where you are going to place your doors, and

that each surface is straight. Uneven or angled surfaces need to be adjusted before the doors are installed, for example if you are placing SKYTТА sliding doors against a sloped ceiling.

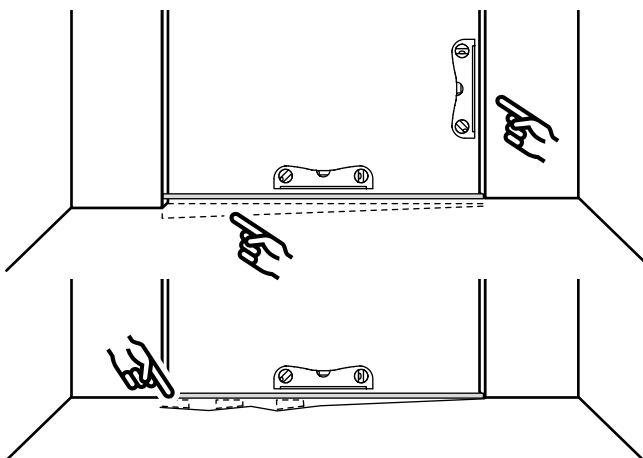

Uneven or angled surfaces need to be adjusted before the doors are installed, for example if you are placing SKYTТА sliding doors against a sloped ceiling.

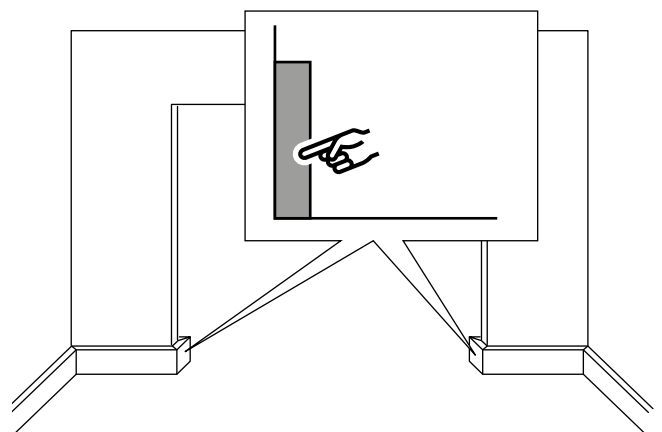

Don't forget about the skirting board or crown molding. We recommend to always remove or cut them, or there will be a gap between the door and wall. It's also possible to use a stop bar, explained more on page 9.

# How to plan – sloped ceiling

SKYTТА ceiling rail must be mounted onto a flat surface which is parallel with the floor. It cannot be mounted directly onto a sloped ceiling. If you want to install SKYTТА sliding doors onto a sloped ceiling, you need to add an extra piece of wall which is wider than the width of the rail, and which creates a 90 degree angle with the wall.

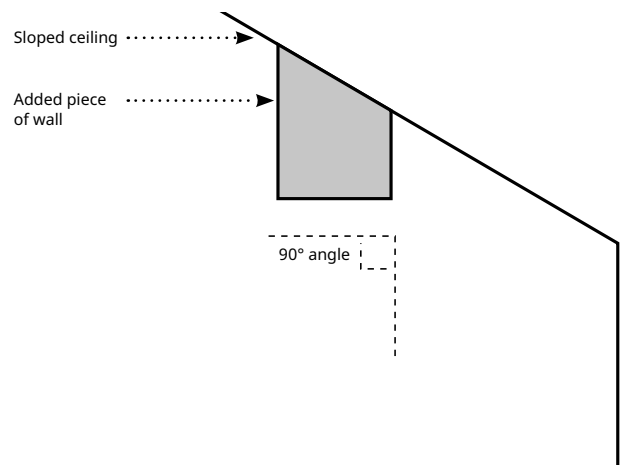

# How to plan – SKYTТА height

Our doors come in two heights but even if your height is a little bit lower, or a lot higher, there's a solution for you.

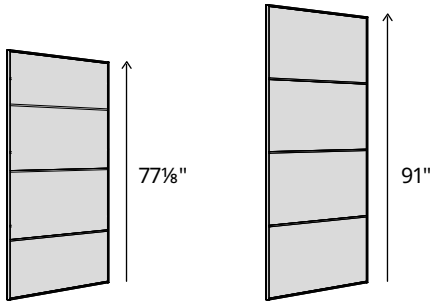

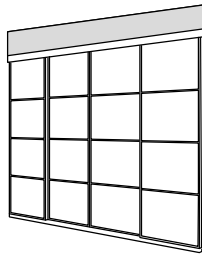
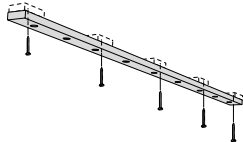
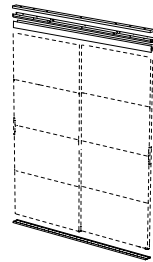
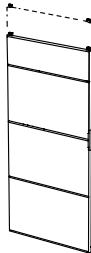
Height	Height	Problem	Solution
82 $\frac{5}{8}$ "-94 $\frac{7}{8}$ "	96 $\frac{1}{2}$ "-108 $\frac{3}{4}$ "	<b>A lot of space left above the doors</b> Compensate the ceiling height with SKYTТА ceiling height reducer and cover panels, or contact a carpenter for a customized solution. See more on page 10.	
80 $\frac{3}{4}$ "-82 $\frac{5}{8}$ "	94 $\frac{5}{8}$ "-98 $\frac{3}{8}$ "	<b>Just a little space left above the doors</b> Compensate the ceiling height with distance pieces toward the ceiling. Not sold by IKEA.	
80 $\frac{1}{4}$ "-80 $\frac{3}{4}$ "	94 $\frac{1}{8}$ "-94 $\frac{5}{8}$ "	<b>The door fits perfectly!</b> Normal assembly with doors and rails. The rails add $\frac{3}{8}$ " to the height of the door and are able to adjust +/- $\frac{1}{4}$ ".	
39 $\frac{3}{8}$ "-40 $\frac{7}{8}$ "	39 $\frac{3}{8}$ "-94 $\frac{1}{8}$ "	<b>The doors are too high</b> It's possible to cut the door and panels. Please note that this option is not applicable for glass or mirror glass panels, as the glass is tempered and will split into tiny pieces. This step needs to be done by a professional carpenter with the appropriate tools.	

# How to plan – SKYTТА total width

You can choose between two widths of doors. They are placed next to each other with a slight overlap so that there will not be any gap between them. That's why you need to count on a width that's slightly smaller than the door.

**The formula to use is as follows:**  
 30% × number of 40% wide doors  
 + 28¾ × number of 30% wide doors  
 + 1% = the total width of the solution.

The extra 1% is to compensate for the fact that there's not any overlap in the ends of the solution. Here's a table of the most common combinations and their total width already counted.

These widths are counted with the recommended overlap. But if your space is just a little narrower it's of course possible to have a bit more overlap, or less if that's the case. Just remember that a big overlap will show through the doors if you choose glass panels.

Amount of 30% doors	Amount of 40% doors	Total width in inches
2	0	59"
1	1	68⅞"
0	2	78¾"
3	0	87¾"
2	1	97"
1	2	107½"
4	0	116½"
0	3	117⅞"
3	1	126⅞"
2	2	136¼"
1	3	146⅞"
0	4	155⅞"

Example of some combinations from the chart above:

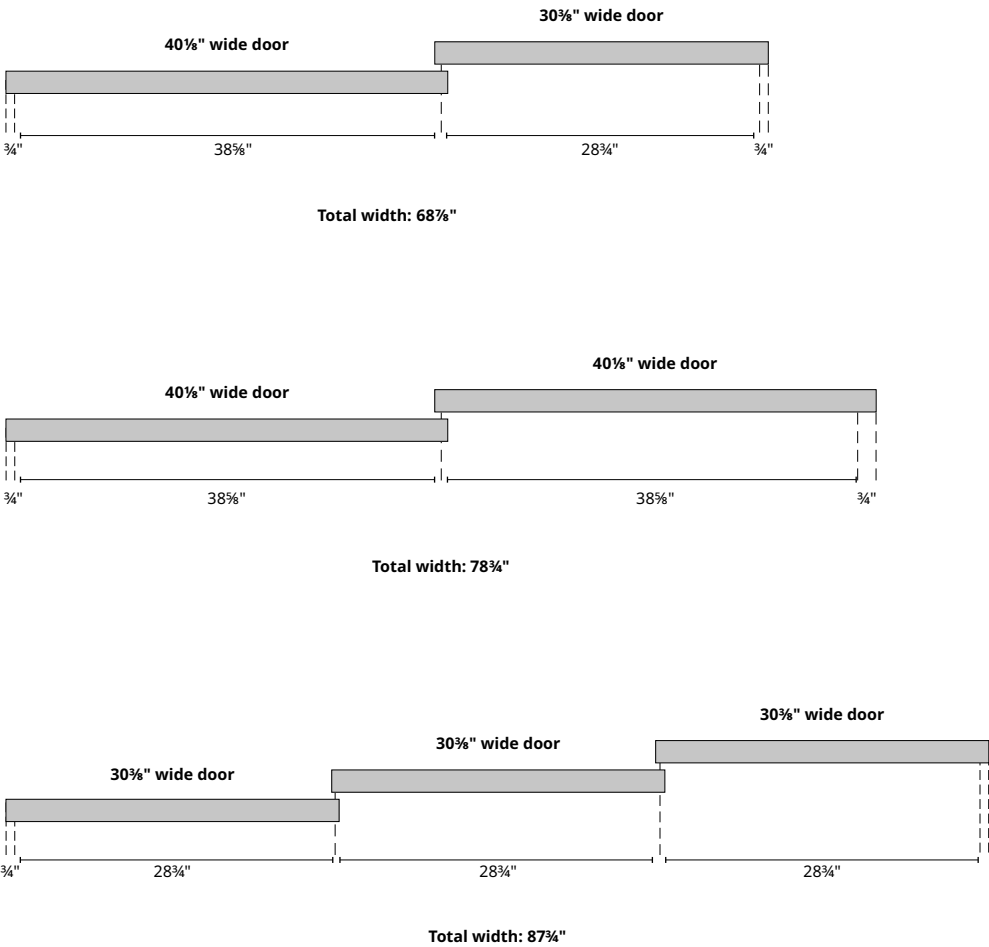

## How to plan – storage behind

When you are placing storage behind your SKYTТА sliding door it's important to plan for that so that you are able to reach and/or open everything.

As an example, a drawer should not be placed behind the overlap of a door unless both doors can be moved, or the drawer cannot be opened.

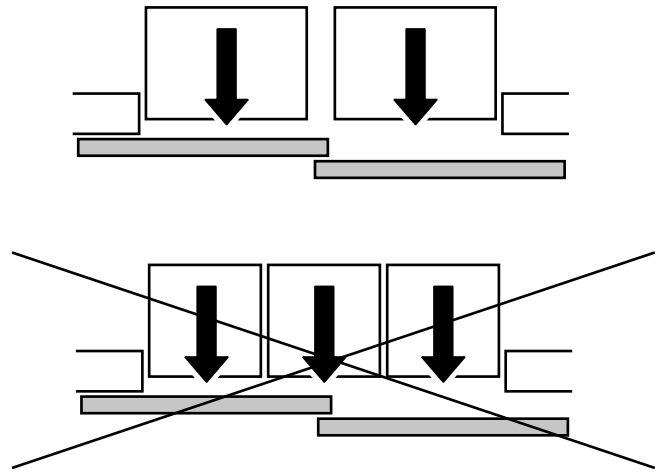

## How to choose color and panels

The SKYTТА sliding door frames comes in white, aluminum and black and you can combine them with all the panels from the PAX range. Either go with a matched solution or create a strong impact with contrasting finishes, it's all up to you!

The panels are sold in a package of four, so for each SKYTТА door you choose, you also need one package of panels. There's a wide variety of colors, materials and finishes to choose from and you can mix them any way you like.

Just keep in mind that some of the panels have a different color or finish on the backside, something that might be good to know if you are planning a solution where you see the doors from both sides.

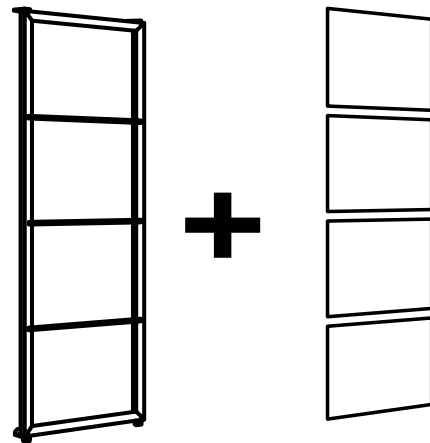

# SKYTTA rails and fittings

## Pick the right amount of rails

When you have decided on the amount of doors, you pick the rails. Each rail is 78¾" long and can be joint and then cut to the correct length to match the width of the doors. They are available in the same finishes as the door frames – white, aluminum and black.

The rails come in two versions, a 2-track and a 3-track. If you have chosen three doors, we recommend using the 3-track rail so that it's possible to slide all the three doors behind each other and get an opening as big as possible.

If you have chosen two, four or more doors, we recommend using the 2-track rails.

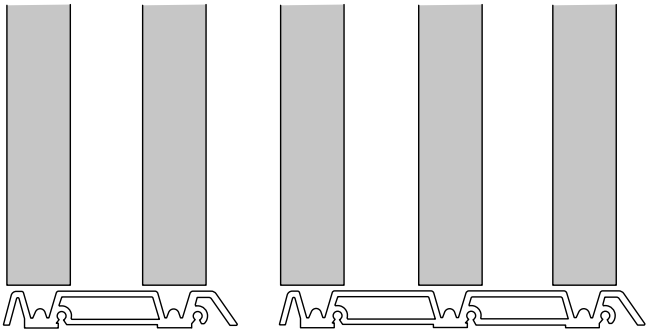

2-track rail with doors

3-track rail with doors

## And the right amount of fittings for the doors

Depending on the rail, you always pick one package of fitting for either 2-track or 3-track rails. They are used for the two doors in the ends. If you have two doors, this is all you need. If you have chosen more than two doors, you also need one package of fittings for middle door per each extra door. Here's a table to help you figure out how many packages of fittings you will need.

Amount of doors	Amount of fitting packages for 2-track rail	Amount of fitting packages for 3-track rail	Amount of fitting packages for middle door
2	1	0	0
3	0	1	1
4	1	0	2
5	1	0	3
6	1	0	4
7	1	0	5
8	1	0	6

## How to plan – total depth

### Get the right depth

Since SKYTTA runs on rails from floor to ceiling, you can pick and choose what storage solution you want to place behind the doors.

Don't forget to add enough space for your storage, as well as the depth of the rails and some extra space. We are suggesting a minimum of 1½" between the sliding doors and the storage behind them.

Please note that the ceiling rail is a little deeper than the floor rail, due to the cover parts, as shown in the illustration. For the 2-track rail you need to count 3¾" depth, and for the 3-track rail you need to count on a depth of 4¾".

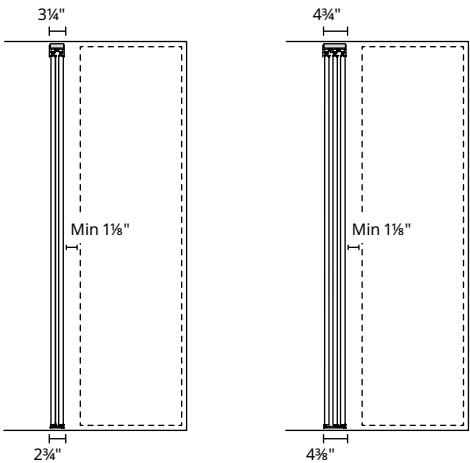



# SKYTTA stop bar

## Frame your doors with a stop bar

A stop bar is a good way of creating a frame around your sliding doors, as well as providing an extra protection for the wall. It can be placed above the skirting board or fitted inbetween as the illustration shows.

Don't forget to measure the thickness of your skirting board, as that can differ from style and brand.

Our SKYTTA stop bar is available in white and comes in two widths to match the rails. It's  $\frac{3}{4}$ " thick and  $9\frac{1}{2}$ " high with the possibility to cut to desired height.

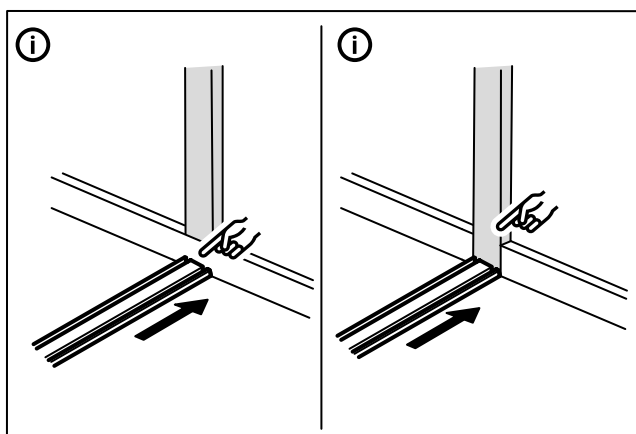

Cut the skirting board and crown molding so that the stop bar fits between the floor and ceiling. The stop bar could be placed above the skirting board, in which case you need to measure the skirting board as the thickness varies from brand and style.

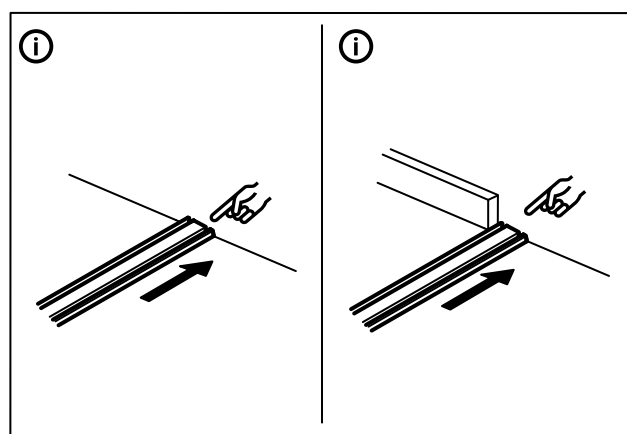

It's possible to use the doors without the SKYTTA stop bar as shown in this illustration or use a customised solution. Keep in mind that walls can be slightly uneven if you let the doors run against the wall, which can cause gaps.

# How to build with ceiling height reducer

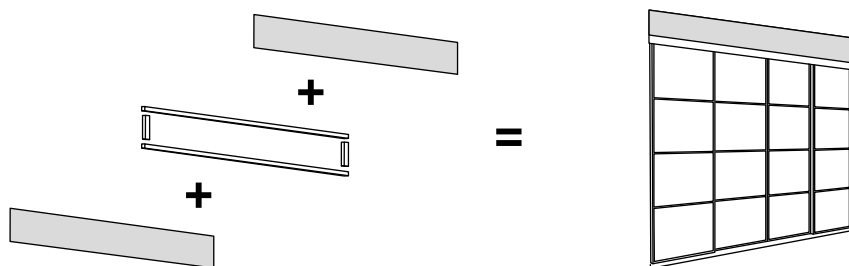

Is your ceiling higher than the SKYTТА sliding doors? No worries. The ceiling height reducer will help you bridge the gap. Use them above your doors and complete with cover panels that you paint to match.

This ceiling height reducer can be mounted above the SKYTТА sliding doors, to bridge the gap if your ceiling height is up to 14 $\frac{3}{8}$ " higher than the doors.

Complete the ceiling height reducer with SKYTТА cover panel on each side and paint it to match your room. Or use pre-treated cover panels from our kitchen range, available in a variety of colors.

# All parts and prices

Overall size: Width×Depth×Height.



**SKYTТА Sliding door frame** Complete each door with one package of panels.

**40½×77½"**

Aluminum	604.977.33
Black	404.977.34
White	104.977.35

**40½×91"**

Aluminum	904.977.36
Black	704.977.37
White	504.977.38

**30½×77½"**

Aluminum	004.977.26
Black	804.977.27
White	604.977.28

**30½×91"**

Aluminum	404.977.29
Black	804.977.32
White	004.977.31



**SKYTТА Rail for sliding doors** Note! Each package of rails contains one floor rail, one ceiling rail and one wooden beam, all of them 78¾" long.

**Aluminum**

2-tracks	305.000.63
3-tracks	704.670.85

**Black**

2-tracks	205.126.41
3-tracks	805.126.43

**White**

2-tracks	405.126.40
3-tracks	005.126.42



**SKYTТА Fitting packages** Choose one set of package for either 2-track or 3-track rail, and then one package for middle door for each door that is placed in the middle. For example, a four door solution needs one package of 2-track rail fittings, and two packages of fittings for middle doors.

for 2-track rail	105.000.64
for 3-track rail	805.000.65
for middle door	605.000.66

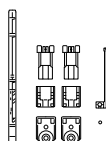

**SKYTТА Stop bars**, white, set of 2. Choose the stop bar that matches the type of rail you have.

2-tracks	005.132.36
3-tracks	805.132.37



**SKYTТА Ceiling height reducer** Choose the ceiling height reducer that matches the type of rail you have.

2-tracks	405.000.67
3-tracks	005.110.96

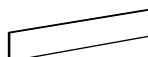

**SKYTТА Top cover panel** Note! The panel comes in a paper foil that needs to be painted to match your wall.

Paintable beige	205.000.68
-----------------	------------

# Combinations

Pick among some ready-made sliding door solutions, or create your own combination of metal frames and panels. The metal frame is available in white, black and aluminum and the panels come in a variety of materials and colors. Choose one package of panels per sliding door frame.

You will find all sliding door frames and panels on our website [IKEA-USA.com](http://IKEA-USA.com) along with a SKYTТА planner tool to help you out!

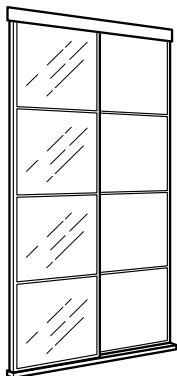

**SKYTТА/MEHAMN Sliding door combination, white.**

Available in two heights.

Overall size: 59×80¾"

**This combination** 094.227.36

Overall size: 59×94½"

**This combination** 894.240.48

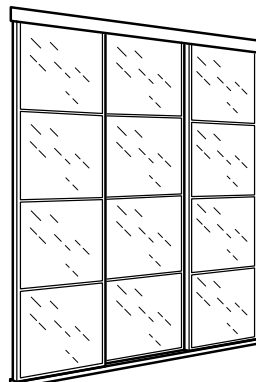

**SKYTТА/HOKKSUND Sliding door combination, high-gloss**

light gray. Available in two heights.

Overall size: 87¾×80¾"

**This combination** 694.227.43

Overall size: 87¾×94½"

**This combination** 194.240.42

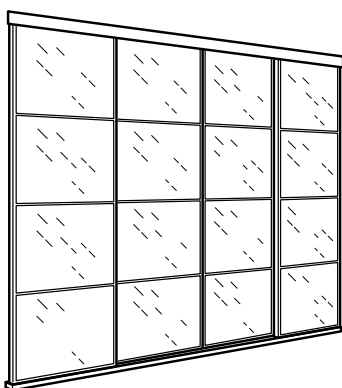

**SKYTТА/HOKKSUND sliding door combination, high-gloss**

light gray. Available in two heights.

Overall size: 116½×80¾"

**This combination** 794.227.33

Overall size: 116½×94½"

**This combination** 794.240.44

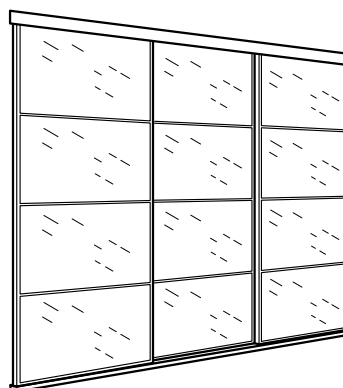

**SKYTТА/HOKKSUND sliding door combination, high-gloss**

light gray. Available in two heights.

Overall size: 117¾×80¾"

**This combination** 094.227.41

Overall size: 117¾×94½"

**This combination** 994.240.43

# Combinations

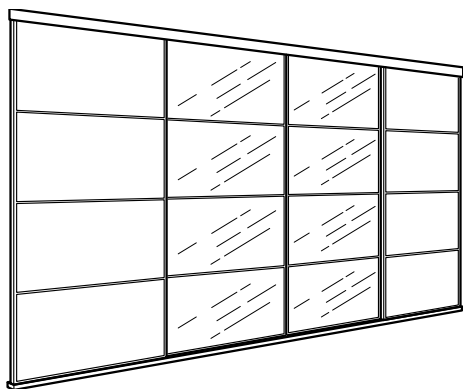

**SKYTТА/MEHAMN/AULI sliding door combination**, white-stain oak and mirror glass. Available in two heights.

Overall size: 155 $\frac{7}{8}$ ×80 $\frac{3}{4}$ "

**This combination** (894.227.42)

Overall size: 155 $\frac{7}{8}$ ×94 $\frac{1}{2}$ "

**This combination** (094.240.47)





# SERVICES

IKEA products are designed to be taken home and assembled by you. That way, you'll save the most money. But if you would like some help, we can offer a range of services. Assembly and delivery services are fulfilled by an Independent Service Provider. Contact your local IKEA store or visit the IKEA website for details: [IKEA-USA.com/services](https://www.IKEA-USA.com/services)



## DELIVERY SERVICE

Most of our products are designed and packaged so that you can take them home yourself. If you prefer, we can arrange for delivery of your purchases directly to your home or business. Same day, next day or same week deliveries are available. We can also arrange for delivery at a later date if you would like.



## IKEA Projekt Credit Card

Your dream home is now within reach and more affordable than ever. With the IKEA Projekt Credit Card\*, you don't have to put off loving every room in your home.

\*Credit card offers are subject to approval.

IKEA Projekt Credit Card Accounts are issued by Comenity Capital Bank.

To learn more visit [IKEA-USA.com/creditcard](https://www.IKEA-USA.com/creditcard) or drop by your local IKEA store.