

Bathroom Installation Guide



Step-by-step installation of your cabinets

We do a lot of groundwork to make it as simple as possible for you to assemble and install your new bathroom furniture yourself. We even design our bathrooms with this in mind from the beginning. The guide you have in your hand will give you tips and ideas on how to plan, prepare and install your new bathroom – step by step.

Before you begin

This guide takes you through the preparation and installation process in clear steps. Read through it carefully before starting to install your bathroom furniture.

We're here if you need a hand

If, at any point, you decide that you would like help installing your bathroom or parts of it – just contact your IKEA store and ask for information about getting assistance. You can do a part of the job yourself (e.g. take away the old bathroom and assemble the new furniture) and have professional installers help with the

rest (e.g. mounting and installation).

Hire professionals

It's a good idea to contact qualified specialists early on to discuss the help you'll need with plumbing, tiling and electricity. If you need to modify the location of water or electricity supplies to suit your new bathroom, hire qualified specialists to do a safe and professional job.



Tools and materials

The materials and tools you need checklist:

Tools:

- Carpenter's ruler/measuring tape
- Adjustable wrench
- Flat/Phillips head screwdriver
- Pencil
- Hammer
- Caulking gun
- Level
- Tri-square

- Electric screwdriver/drill
- Goggles – we recommend you wear protective glasses when using an electric drill or keyhole saw.

Materials:

- The right types of plugs and screws for your walls
- Sanitary silicone sealant
- Masking tape , to be used when adding silicone sealant

Carpenter's ruler
(or tape-measure)



Adjustable wrench



Flat and Phillips
head screwdriver



Pencil



Caulking gun and silicone



Level



Hammer



Tri-square



Electric screwdriver/drill



Goggles



Preparation is the basis of success

Removing your old bathroom

Turn off the electricity and water supply before you start. Then disconnect all lines to the sink and disconnect appliances. Be careful when working with electricity. If in doubt, call in a qualified electrician.

Removing old furniture

Wear safety gloves and goggles when removing the old bathroom furniture. Start with base cabinets and then move on to wall cabinets. If the base cabinet supports a sink, you will need to begin with that. If it has been glued into place, you may need a crowbar to pull it off. You can then remove drawers, doors and, lastly, the cabinet itself. Once this is removed you will have better access to remove wall cabinets.

Responsible disposal

Contact your local authorities to find out how to dispose of your old bathroom in an environmentally friendly way.

Evening out walls and floor

Flat, level surfaces are important for a good installation. With the room empty, now is the time to prime walls, apply paint, change tiles and/or install new flooring. Keep in mind that new flooring is easier to install at this stage, but remember to protect the new floor surface until the bathroom is finished.

Check everything and start to assemble

Check all parts

Double-check to make sure you have all the parts for your bathroom. Sort the packages into groups to avoid confusion over which pieces belong to the cabinet assembly and which belong to drawers, for example. Check again that you have all the required tools and the silicon sealant.

Use the right mounting hardware

Plaster, wood or concrete? Because there are many different types of wall, mounting hardware is not supplied with your furniture. Most hardware stores or home improvement stores stock appropriate mounting hardware and can help you choose the right type for your walls.

Assemble wall cabinet frames first...

If you are installing wall cabinets, it's easiest to start by assembling and installing them first. Follow the assembly instructions included in each package. Don't add the handles, shelves or doors at this stage – wait until later.

... then assemble the base cabinet.

Follow the instructions for assembling the base cabinet. Don't add drawers, handles, or interior organizers at this stage. Wait until later, when the furniture and sink have been properly mounted to the wall.



Mounting the cabinet to the wall

You're now ready to mount your assembled furniture onto the wall. The following information is a guide that is applicable to all IKEA bathroom cabinets and sinks. However, be sure to consult the assembly instructions that came with your product for measurements that are specific to that piece of furniture. In this guide, we use GODMORGON bathroom products to illustrate steps that apply to all IKEA bathroom cabinets.

Measuring

The recommended height for the top level of your sink is 33½"-35¾". Because there are different heights of sink, in the assembly instructions you will find a minimum and maximum recommended height for the holes you need to drill for the cabinet. Below, are 2 examples of height measurements for different types of cabinets. Note that these measurements are intended as a recommendation only. These measurements can be

changed according to your personal height preference. Once you have established the height of your drilling points, you can concentrate on the width between them. These measurements are given in the assembly guide of your cabinet. Use a level to ensure your measurements will result in an even line. You should mark the intersecting points (height + width) with a cross (+) to give you a precise drilling point.

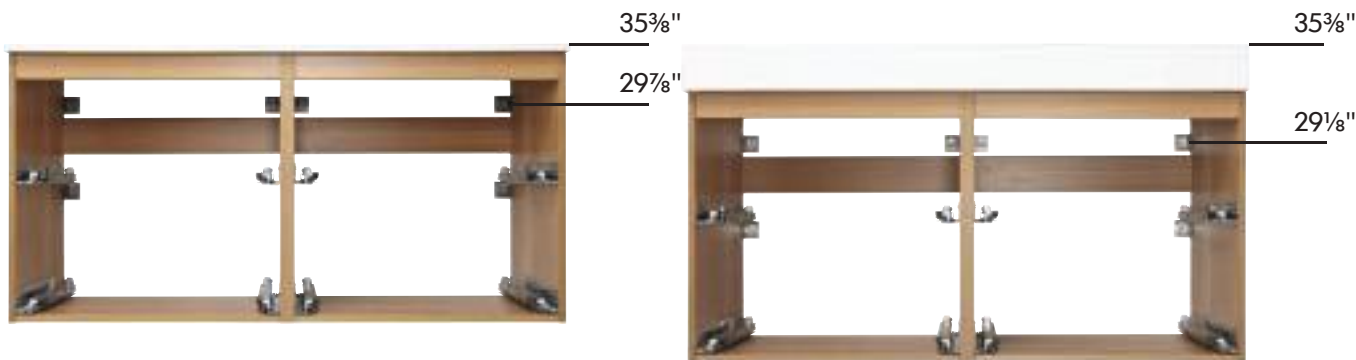

Example 1

For a sink with a lower edge, the holes you drill would be higher (e.g. 29¾") to accommodate the lower profile of the sink.

Example 2

For a sink with a higher edge, the holes you drill would be slightly lower (e.g. 29¼") to accommodate the extra height of the sink.

Think about

It is important to ensure your bathroom walls can support the weight of the cabinet. If your walls can't support the weight of the furniture, use supporting legs. Contact the IKEA store for details.

Mounting

Take your time and ensure you have some help at this stage of the process. Double check your measurements against the assembly instructions and check you have all the required tools, silicon and mounting hardware close at hand. Also, take the time to remove any unnecessary items cluttering up the area.



Mark drill points

Using a pencil, you should now have marked intersecting measurements at the points where you will drill (height + width) as shown in the assembly instructions. It's important to use a level to ensure you get an even horizontal line between left and right points.



Drill and silicon

You can then drill the holes and insert mounting screws at the marked points. Do not fully tighten the screws at this point. Don't forget to fill the drill holes with silicon sealant before inserting plugs and/or screws.



Mounting the furniture

Ensure you have attached the mounts at the rear of the cabinet according to the assembly instructions. Then, with the help of 1 or 2 others, gently lift the cabinet onto the mounting screws.



Fine adjustment

Use the level again to ensure your cabinet is even. The mounts allow some adjustment if it is not perfectly even. You can then tighten the screws.

Placing sink, water trap and faucet



Connecting the faucet
First, switch off the main water valve. Then, mount the faucet onto the sink according to the instructions. Do this before you mount the sink onto the cabinet.



Add sanitary silicone sealant
Add sanitary silicone sealant to the top edge of the cabinet sides, place the sink on top and let dry overnight. You can then add a bead of silicon between the sink and the wall. Finally, add silicone between the sink and side panels of the cabinet.



Connect the water trap to the sink
You can now attach the water trap to the sink according to the instructions. Installation must be performed in compliance with current local construction and plumbing regulations. If in doubt, contact a professional.



Test drive your faucet and water trap
You can now connect all hoses and turn on your main water valve. Remove the filter from the faucet and let the water run for 5 minutes. Check there is no leakage around hose connections or the water trap. Then screw the filter back in place.

 **Caution! Do not tighten hose connections too hard: this can damage hoses/pipes and washers.**

The finishing touches make all the difference

You're nearly done. All that remains is to assemble and install the drawers according to the instructions provided. And, with just a few details and fine adjustments, your bathroom will be complete. Now is a good time to attach handles and fittings to all cabinets. You can add organizers and storage units that will help

manage your everyday bathroom necessities. You can then start to personalize your new bathroom with our range of lighting and organizers.



Enjoy your new bathroom today! And tomorrow.

You're done!

Time to step back and admire your new bathroom – and admire yourself for saving so much money by assembling and installing it yourself! If you follow our care and maintenance advice that comes with the product in the packaging your new IKEA bathroom furniture will keep looking its best for many years to come.

Ventilation and moisture

Make sure your bathroom is properly ventilated and avoid placing furniture close to the bathtub or shower. Our bathroom furniture has been specially adapted for bathrooms. However, the furniture should never be exposed to excessive water contact or extremely high humidity. All wet marks should be dried off as soon as possible to stop moisture penetration.

Caring for your faucet

Wipe clean with a soft wet cloth and a mild non-abrasive cleaner or soap, if necessary. Never use scouring powder, steel wool or a detergent that is calcium-dissolving, sour or contains alcohol or an abrasive. Use household vinegar to remove lime stains and rinse off with water. Since all IKEA bathroom faucets are equipped with a water saving aerator, we recommend removing the filter/aerator and cleaning it from time to time. If it has a build-up of calcium, wash it in a vinegar solution.

Caring for your furniture; base cabinets, wall/mirror and high cabinets

Clean the doors, cabinet interiors and wood surfaces with a soft, damp cloth. Only use cleaning products intended for these materials. Do not use cleaning agents that contain ammonia, alcohol, bleach or abrasives. Rinse with clean water, then dry with a clean, dry cloth. If you happen to spill, do not allow the liquid to stay in contact with the surface, wipe off immediately.

Caring for your sink

Different materials require different care. Depending on which material and finish you have chosen for your sink – the use, care and maintenance instructions differ. By following the simple steps below, you will have a sink that will look good for many years to come.

Porcelain sink

The sink has a surface that is easy to clean. It is resistant to most chemicals, except for strong acids and strong alkalis. Clean your sink with a soft wet cloth and a mild non-abrasive cleaner or soap, if necessary.

Crushed Marble sink with matte finish



To maintain the original finish, a crushed marble sink in matte finish should not come into contact with acids, ammonia, strong detergents, hair dye or chlorine. For daily cleaning of the sinks, simply use wet cloth or a non-abrasive detergent.

Over time the surface of the sink may lose its appearance. To maintain the brushed look of the surface, use the enclosed polishing kit. Polish the sink with the green surface of the sponge facing downwards; this will maintain the brushed look of the surface and remove any dull appearance. The polishing kit can also be purchased at your local IKEA store.

Crushed marble sinks – High gloss finish



To maintain the original finish, a crushed marble sink in high gloss should not come into contact with acids, ammonia, strong detergents that contain abrasives, hair dye or chlorine. For daily cleaning of the sinks, simply use a wet cloth or a non-abrasive detergent.

To maintain the high gloss look of the sink and to remove small scratches and stains, use the enclosed polishing kit. The polishing kit can also be purchased at your local IKEA store.

If you want a really good shine you can finish off by polishing with traditional car wax. If you do this regularly you will get a finish that will look as good as new for many years to come. Please note that sponges with rough coatings will damage the surface of sink with a high gloss finish.

If you have questions, give us a call!



If you need help or have questions about how to
install your bathroom, call us on 1 800 434 IKEA

