

# BROGRUND

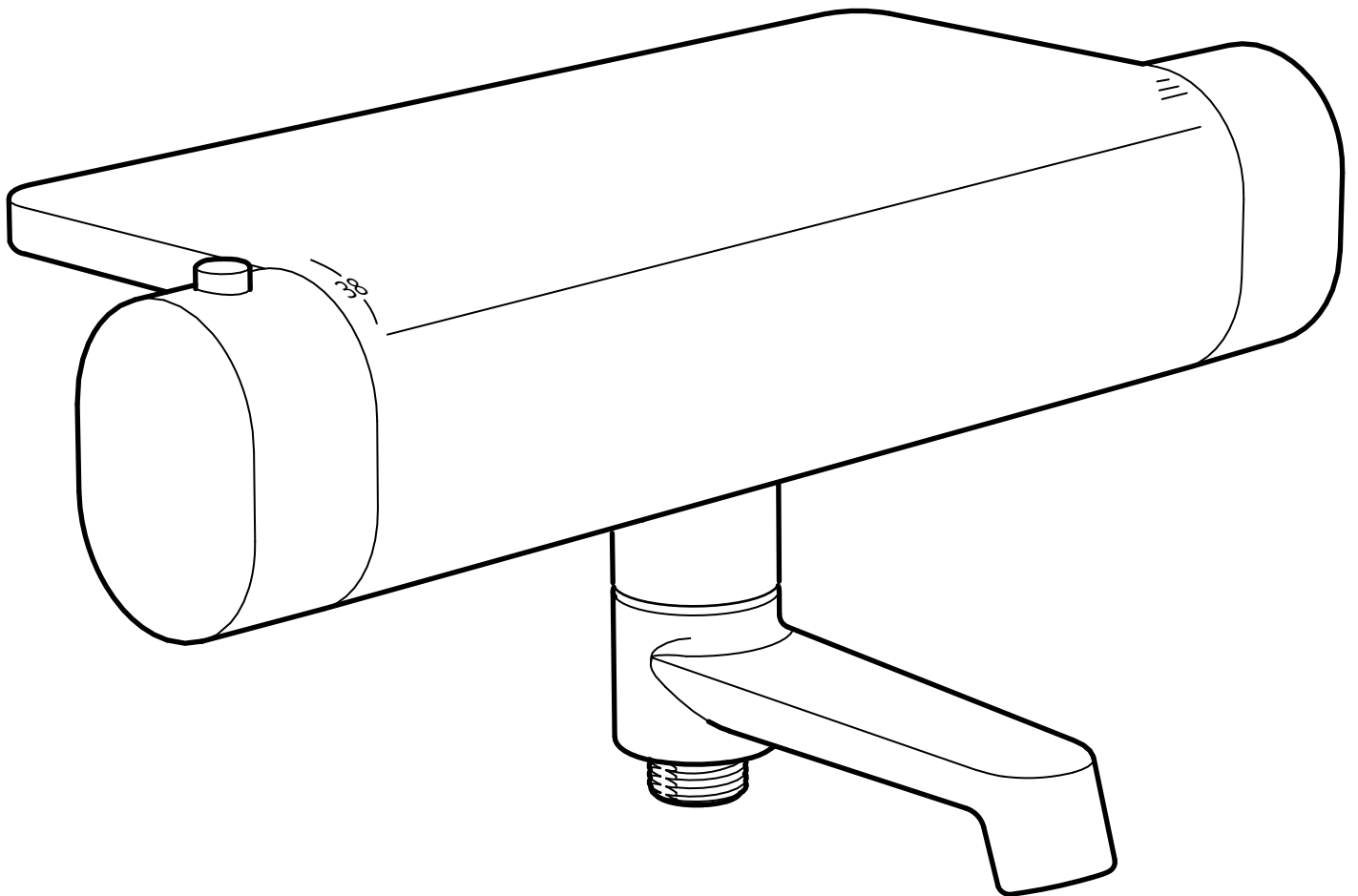

Design and Quality  
IKEA of Sweden

**Svenska****Innehåll:**

Verktyg	4
Montering av produkt	7
Illustration av produkt, delar och artikelnummer.	16

**English****Contents:**

Tools	4
Product assembly	7
Illustration of product, parts and part numbers	16



**Svenska**

Stäng av huvudkranen innan du byter blandare.

**English**

Switch off main shut-off valve before changing mixer tap.



**Svenska**

Installationen ska utföras i enlighet med branschreglerna Säker Vatteninstallation.

**English**

Installation shall be carried out in accordance with Industry Regulations Säker Vatteninstallation.



**Accepterad**  
monteringsanvisning  
2026:1



TG 1382



1913

EN 1111 | EN 1717

**Svenska**

RSK Nr: 8350395

**English**

RSK No: 8350395



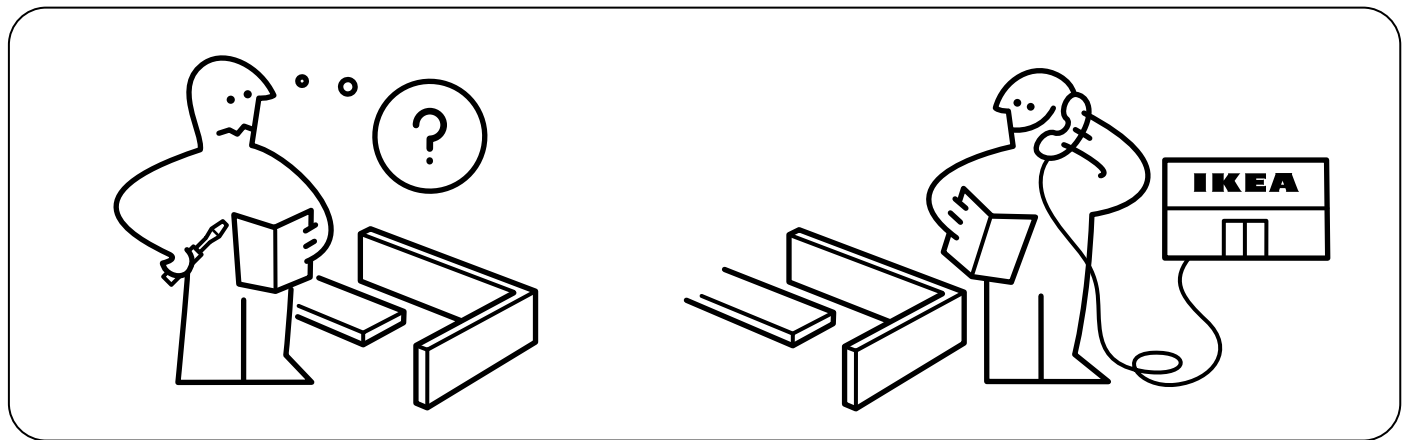
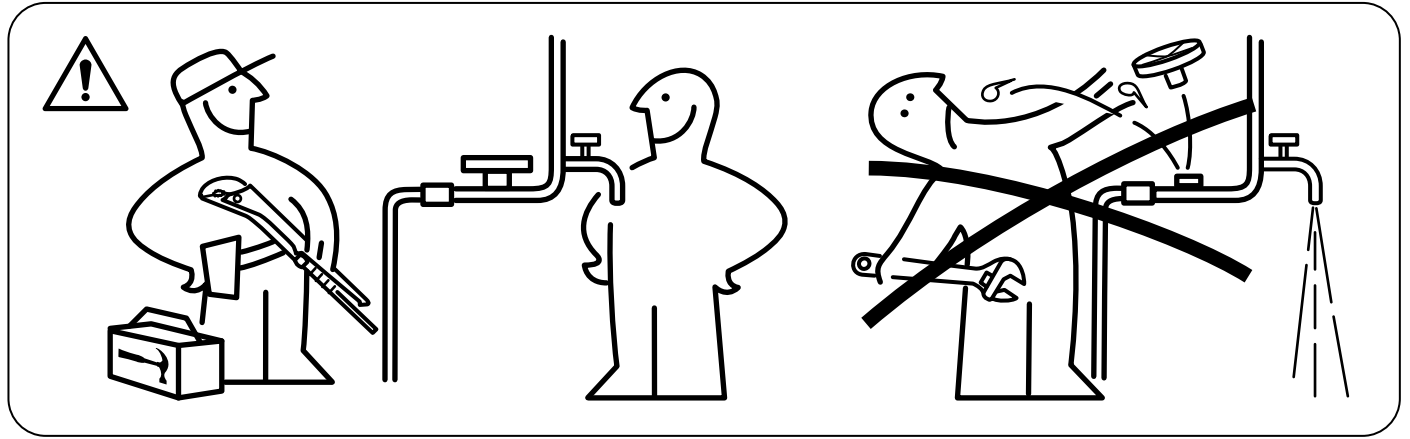
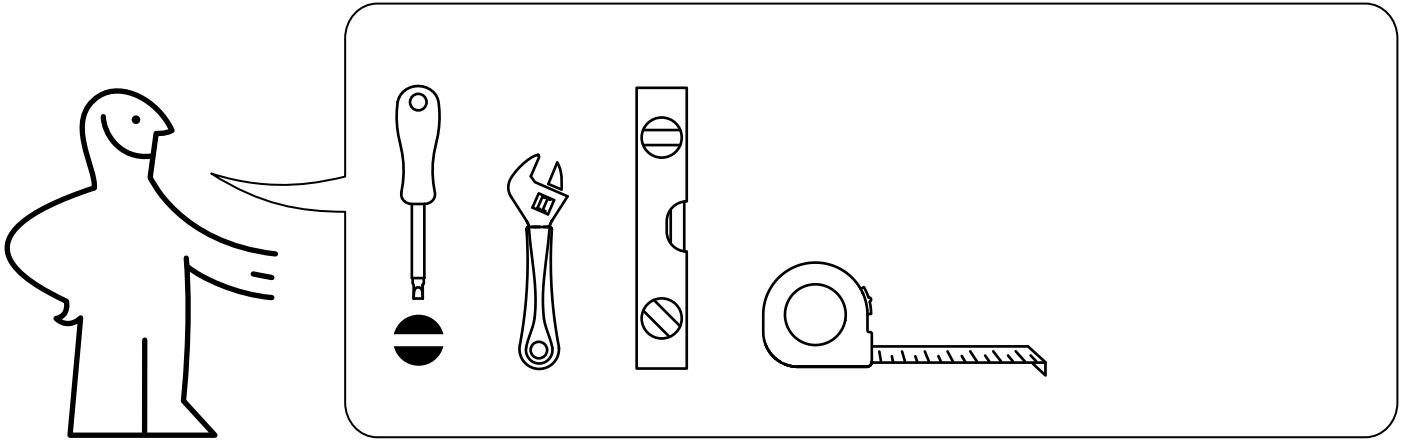

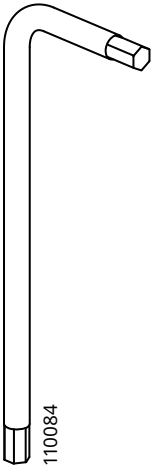

110084

1x

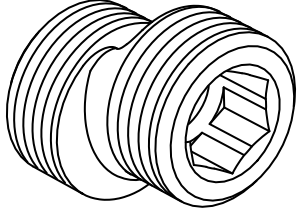

190083

2x

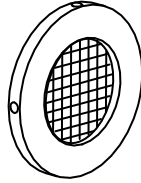

190552

2x

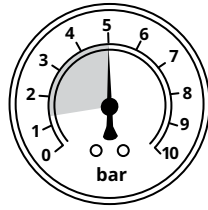
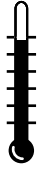

**Svenska**

Rekommenderad  
varmvattentemperatur: 60°C  
Max. varmvattentemperatur:  
80°C

**English**

Recommended hot water  
temperature: 60°C  
Max. hot water temperature:  
80°C

**Svenska**

Rekommenderat arbetstryck:  
1,4 - 5 bar  
Max. statiskt tryck: 10 bar  
Max. provningstryck: 16 bar

**English**

Recommended working  
pressure: 1,4 - 5 bar  
Max. static pressure: 10 bar  
Max. test pressure: 16 bar

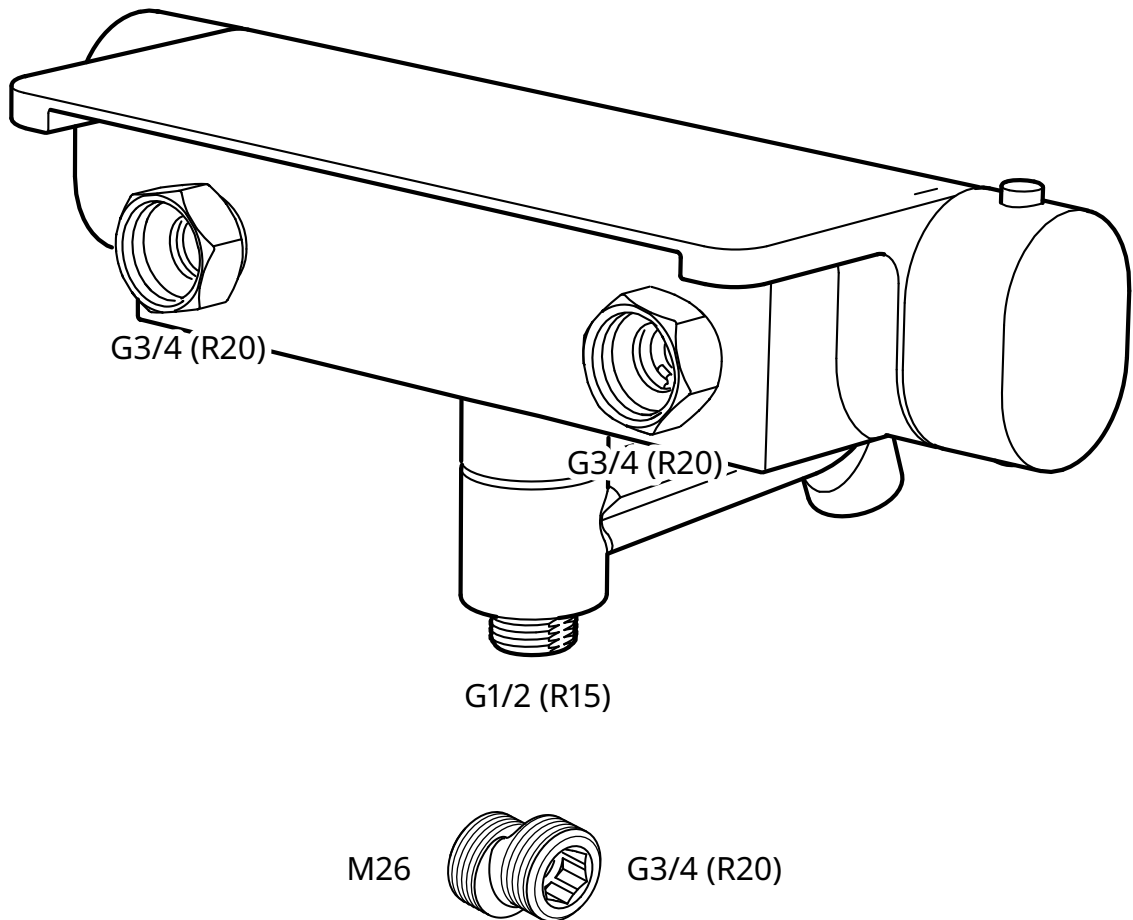

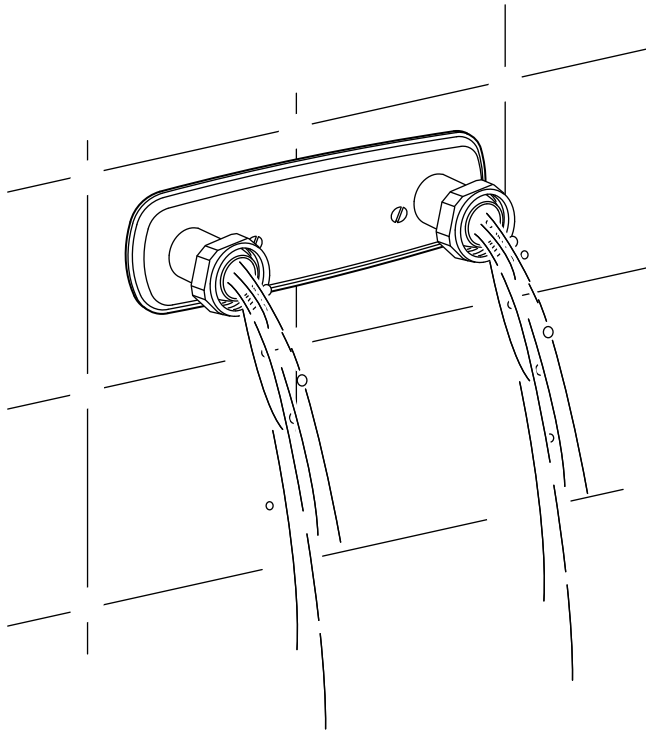

**Svenska**

Innan du ansluter produkten till vattenförsörjningssystemet bör man spola vatten genom systemet för att avlägsna skräp.

**English**

Before connecting the product to the water supply system, water should be flushed through the system to remove all debris.

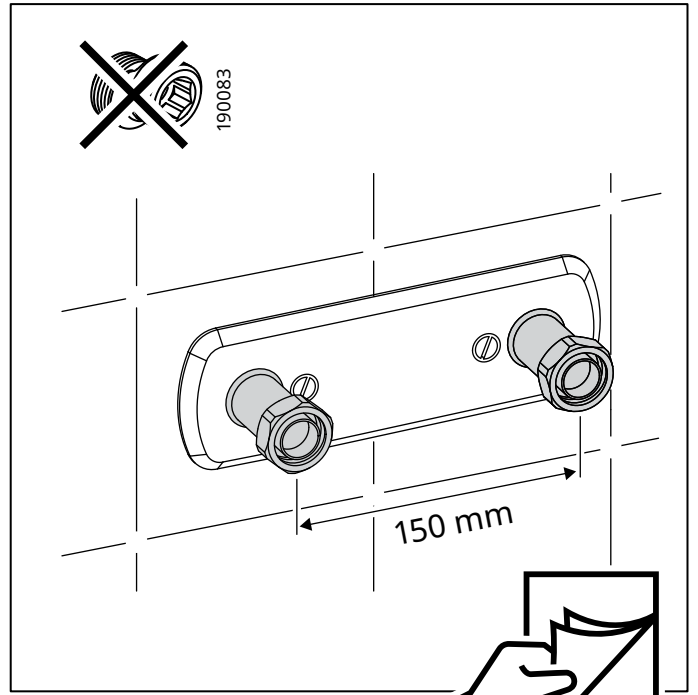
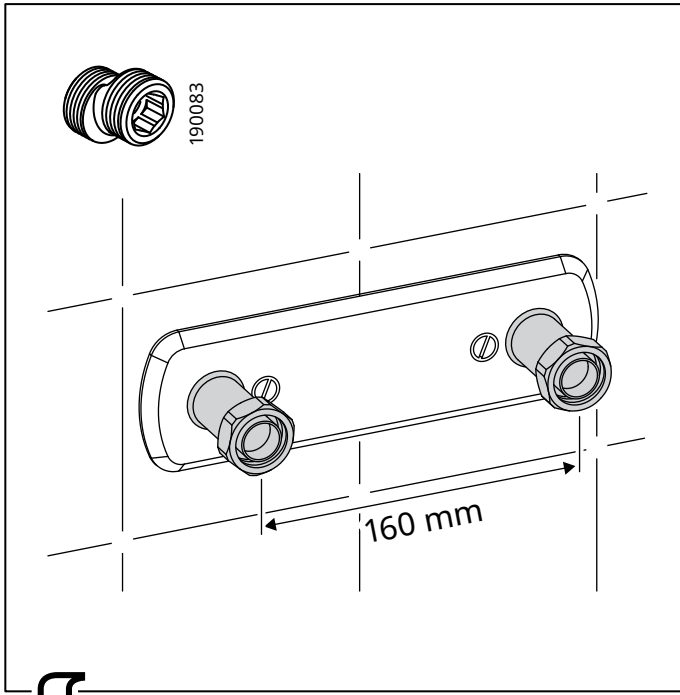

**1**

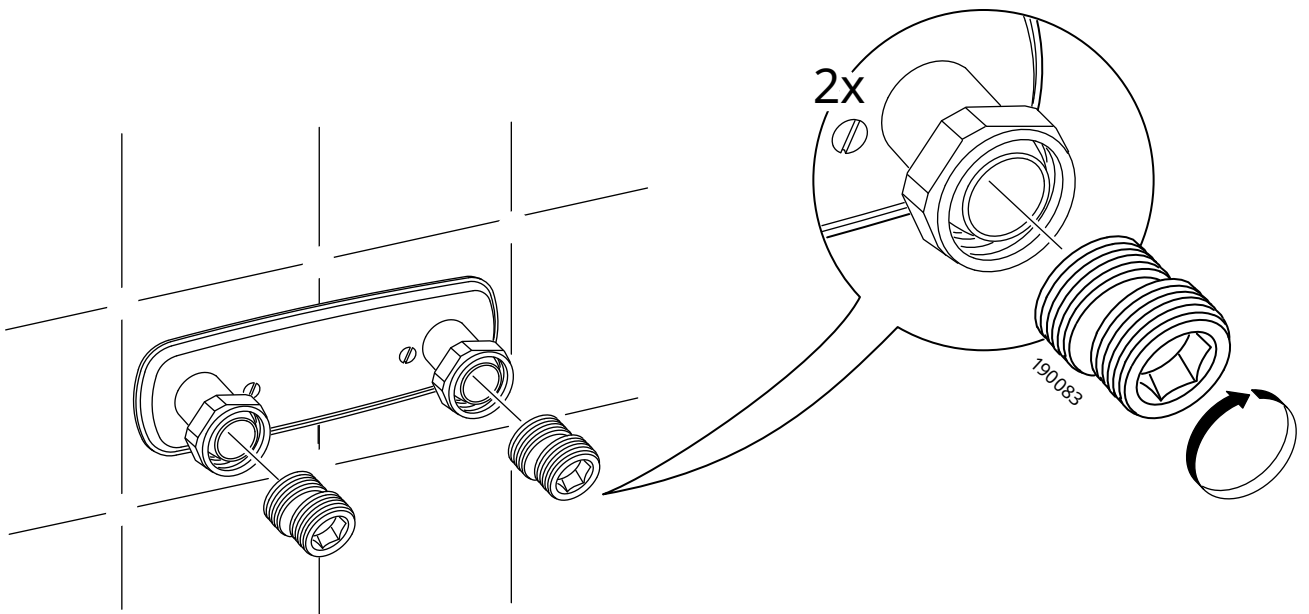
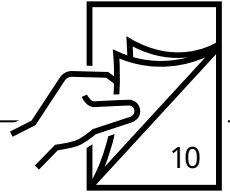

2

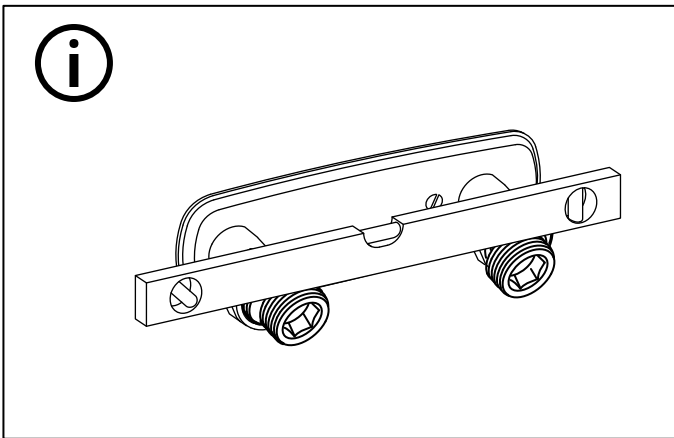
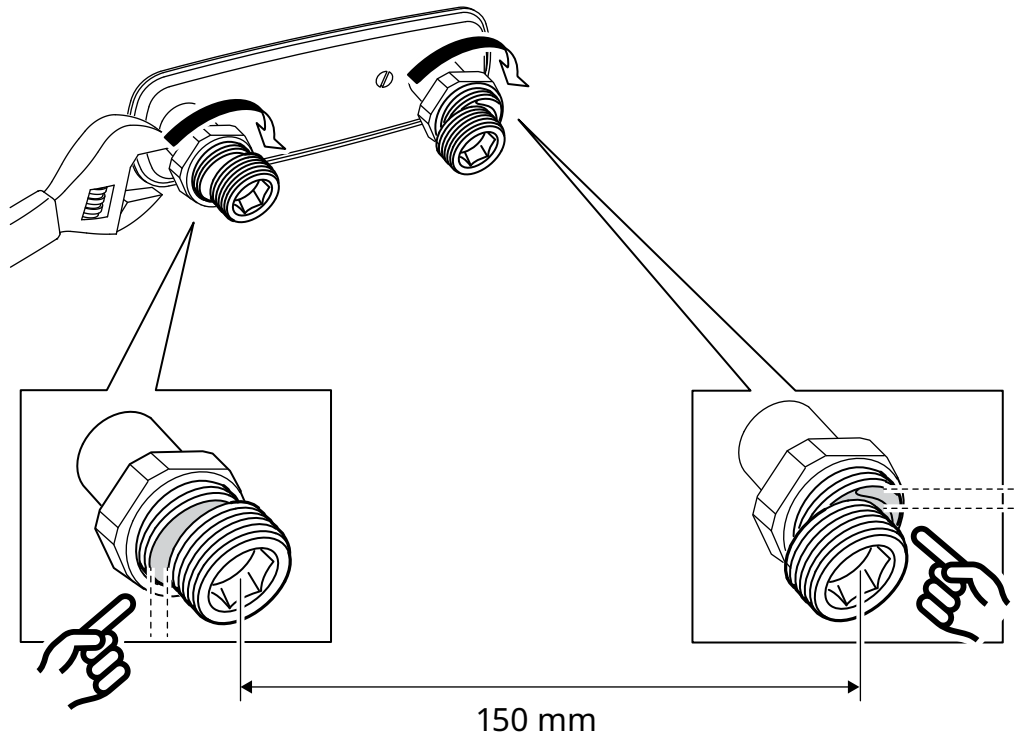

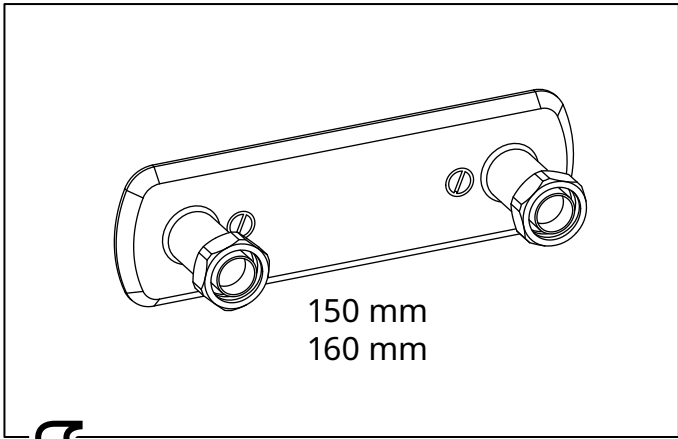

**3**

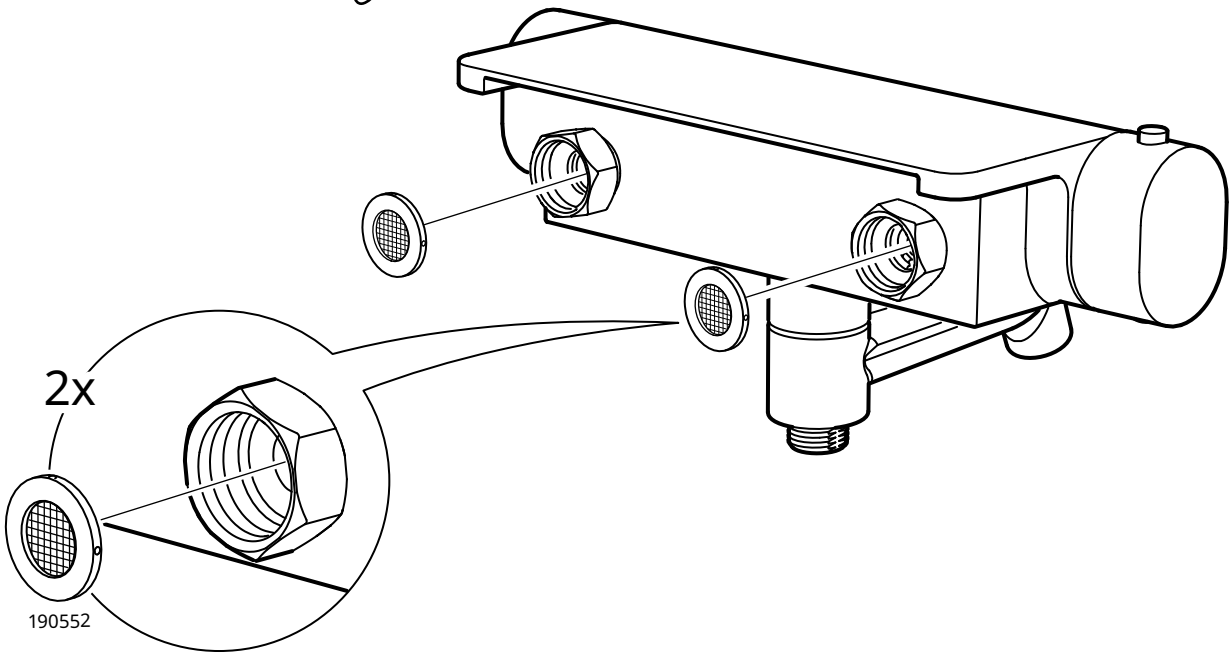

# 4

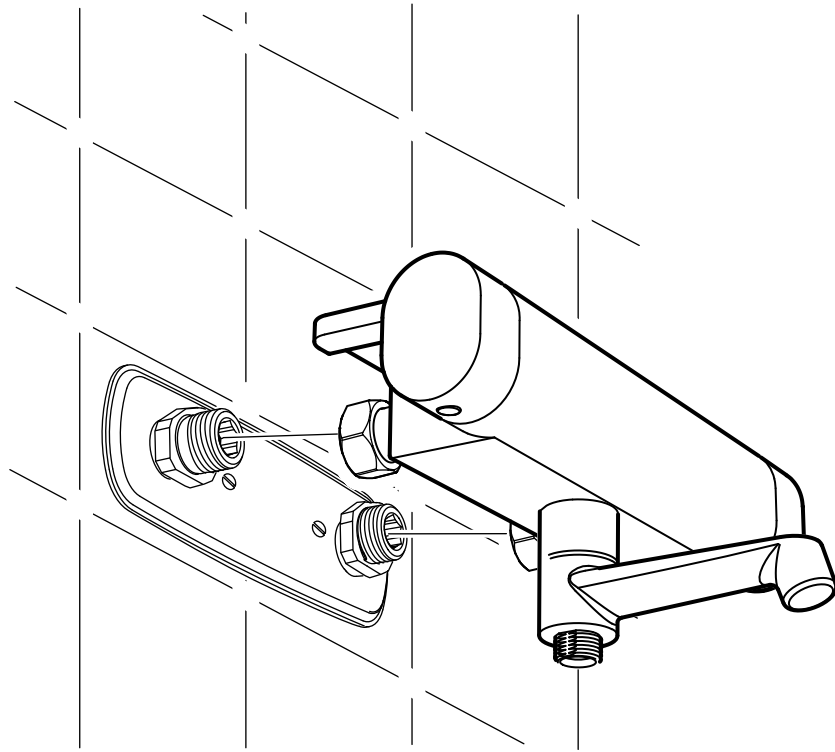

# 5

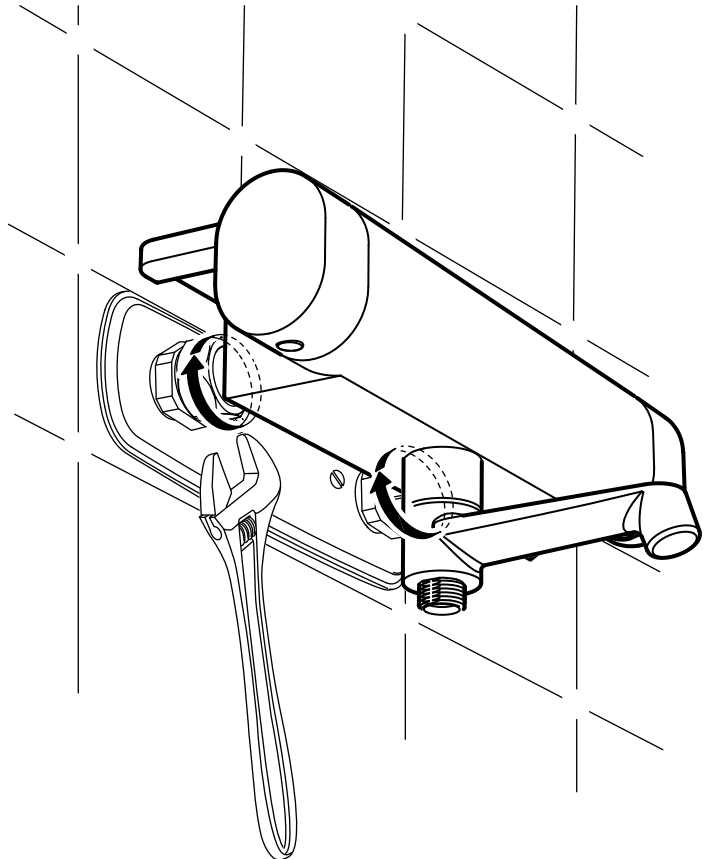

**Svenska**

OBS! Dra aldrig åt för hårt; slangar och packningar kan skadas.

**English**

IMPORTANT! Do not tighten too hard: this can damage hoses/pipes and washers.

# 6

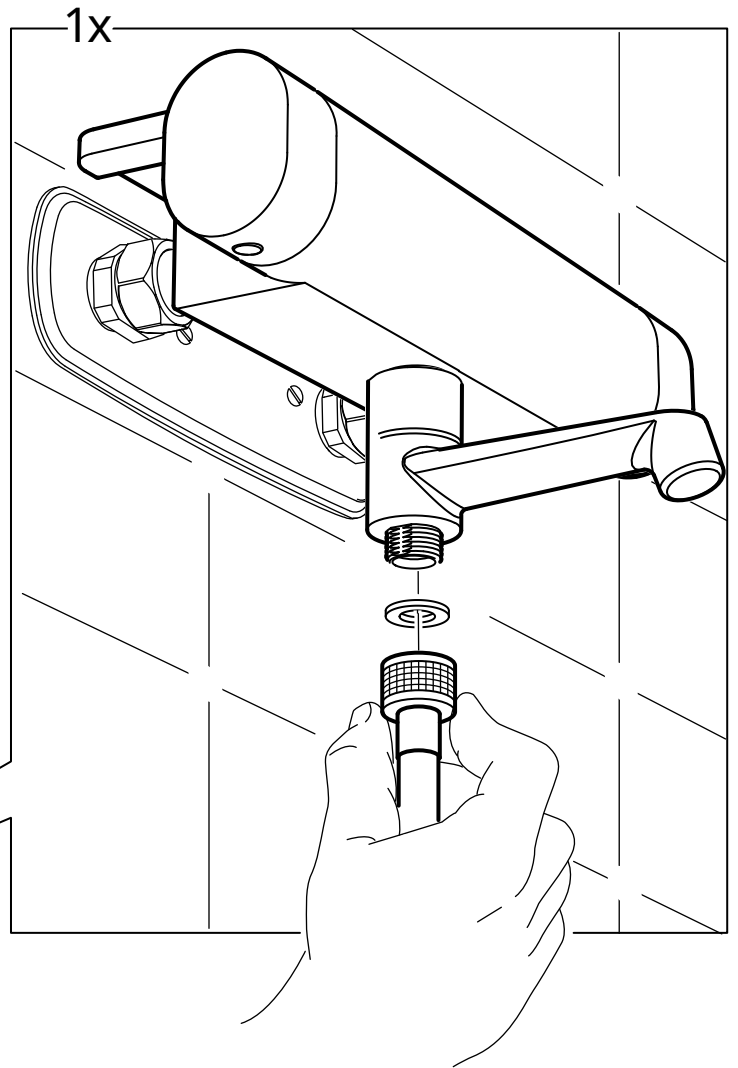
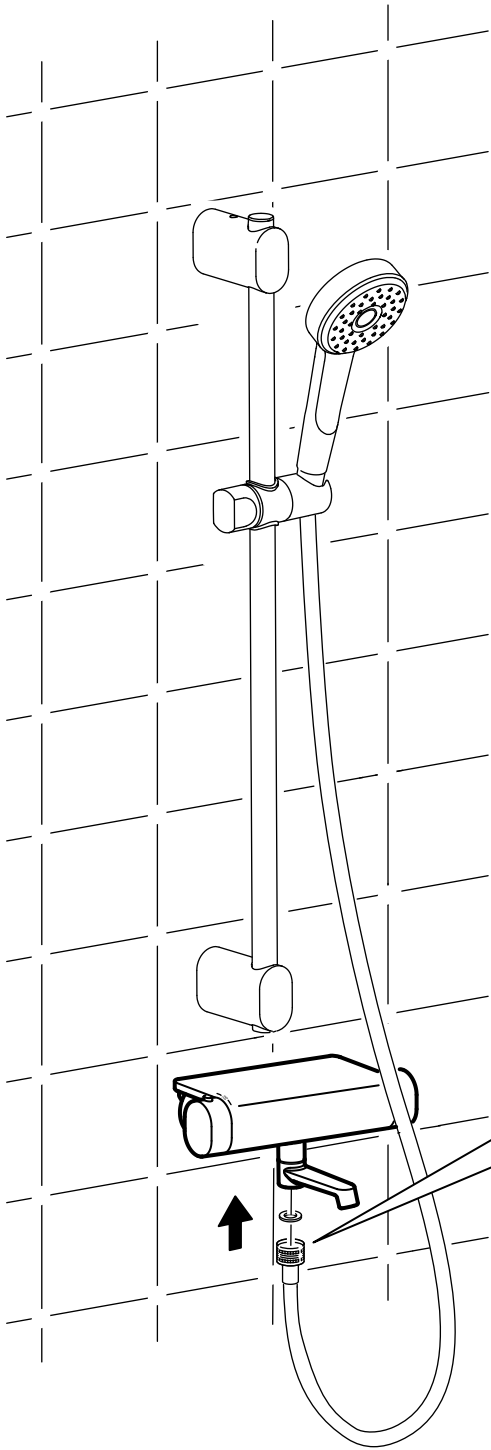

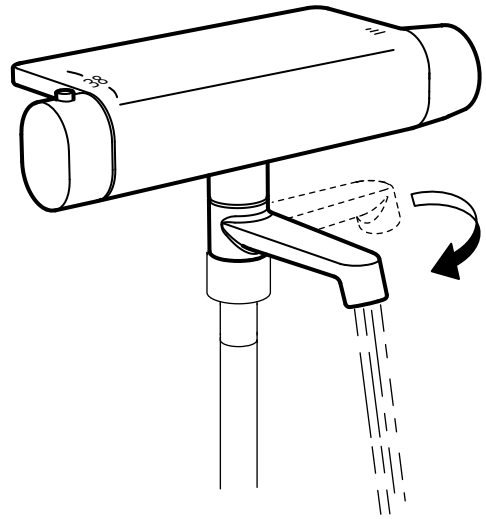
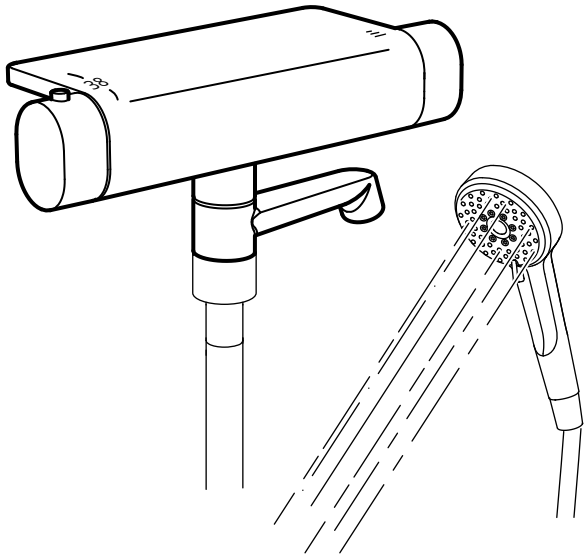

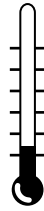
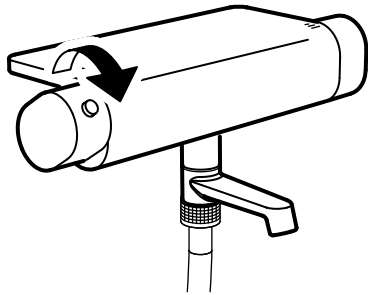

**Svenska**  
Kallt.

**English**  
Cold.

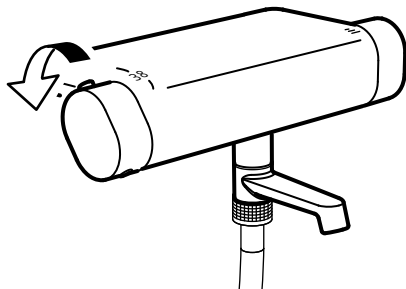

**Svenska**  
Varmt.

**English**  
Hot.

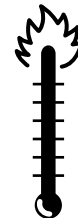
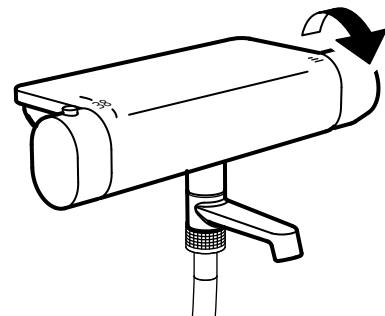
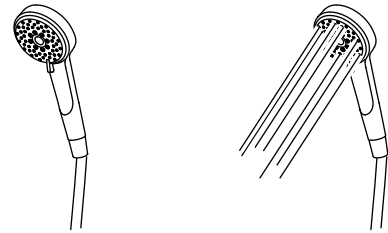

Max. 48C°

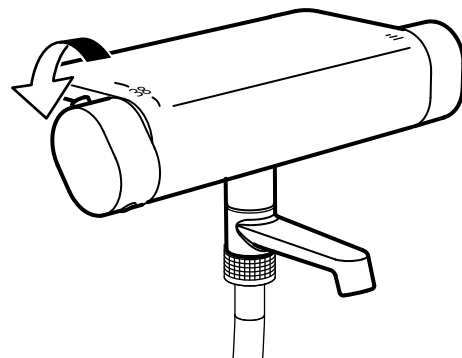
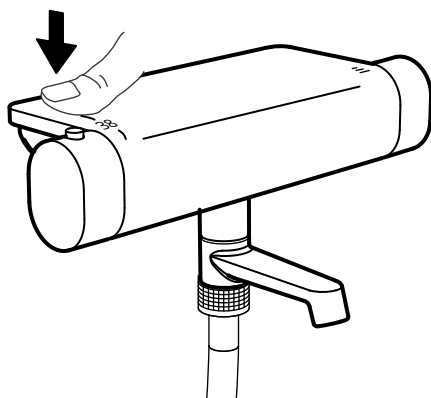

**Svenska**

Beroende på den individuella försörjningen kan det vara nödvändigt att justera mixern att leverera korrekt och säker vattentemperatur.

**English**

Depending on your individual supply system it might be necessary to adjust the mixer to supply the correct and safe water temperature.

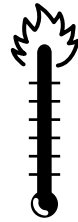
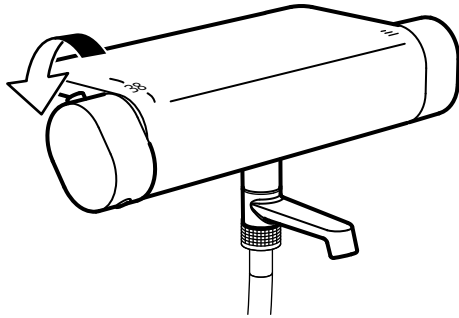

Max 48C°

1

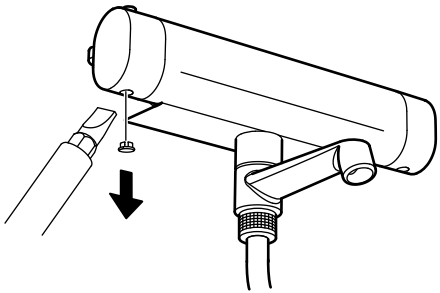

2

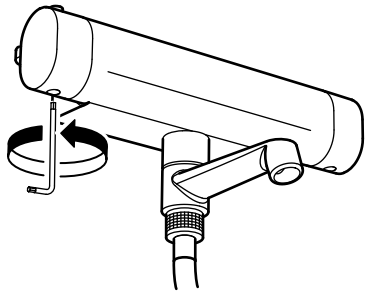

3

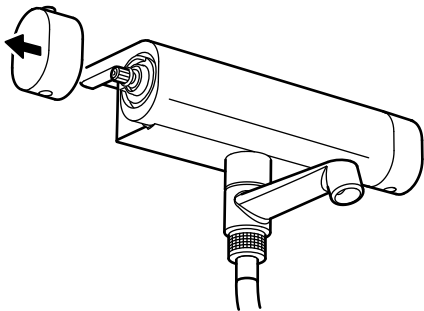

4

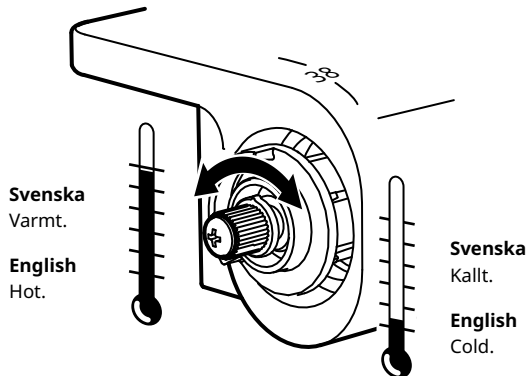

5

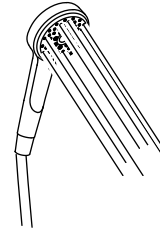

37 - 39° C

6

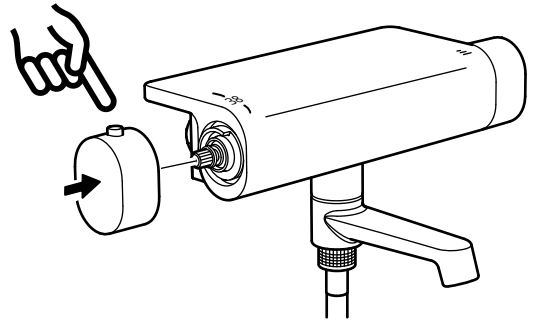

7

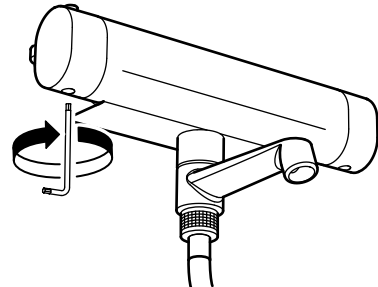

8

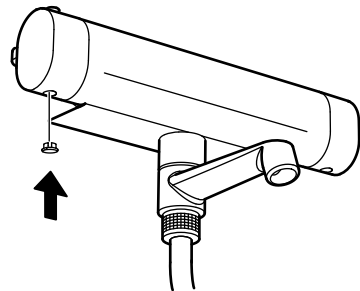



**Svenska**

Kontrollera regelbundet att installationen är tät.

**English**

Check at regular intervals to make sure that the installation is not leaking.

