

BROGRUND

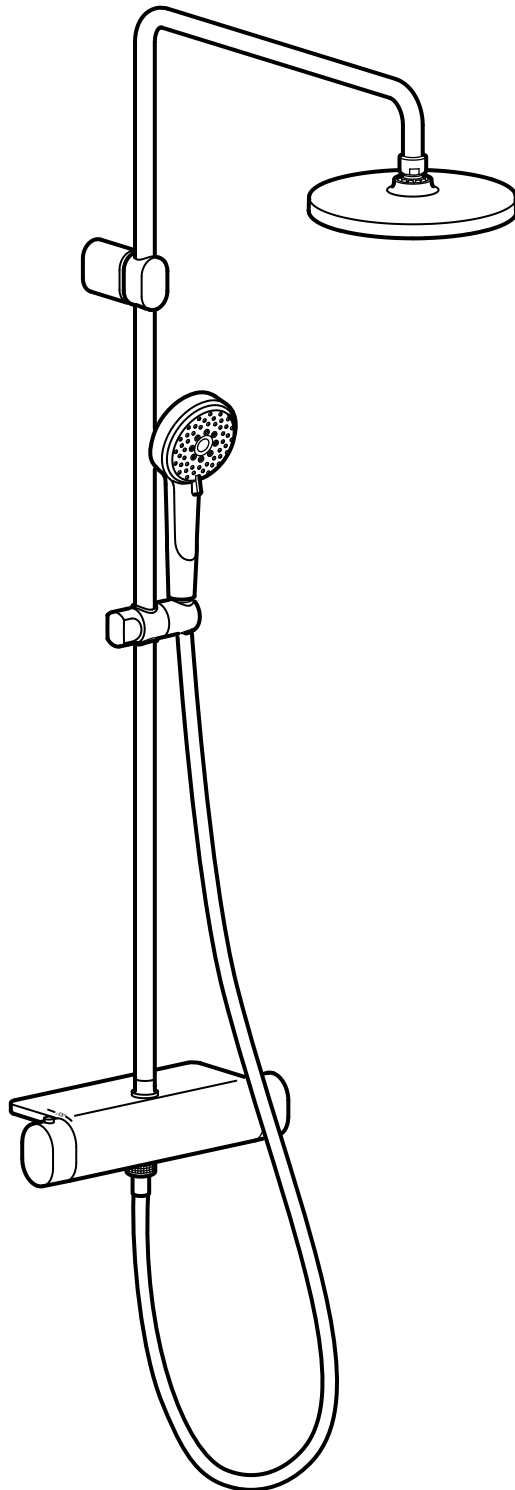

Design and Quality
IKEA of Sweden

Svenska**Innehåll:**

Verktyg	4
Montering av produkt	7
Illustration av produkt, delar och artikelnummer	27

English**Contents:**

Tools	4
Product assembly	7
Illustration of product, parts and part numbers	27



Svenska

Stäng av huvudkranen innan du byter blandare.

English

Switch off main shut-off valve before changing mixer tap.



Svenska

Installationen ska utföras i enlighet med branschreglerna Säker Vatteninstallation.

English

Installation shall be carried out in accordance with Industry Regulations Säker Vatteninstallation.



Accepterad
monteringsanvisning
2026:1



TG 1382



1913

EN 1111 | EN 1717

Svenska

RSK Nr: 8231146

English

RSK No: 8231146



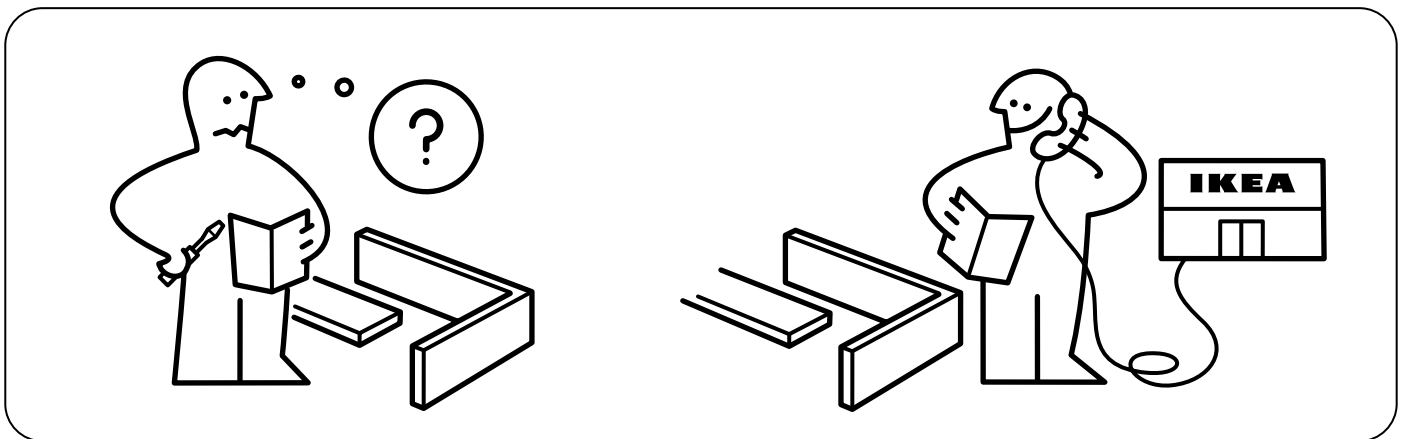
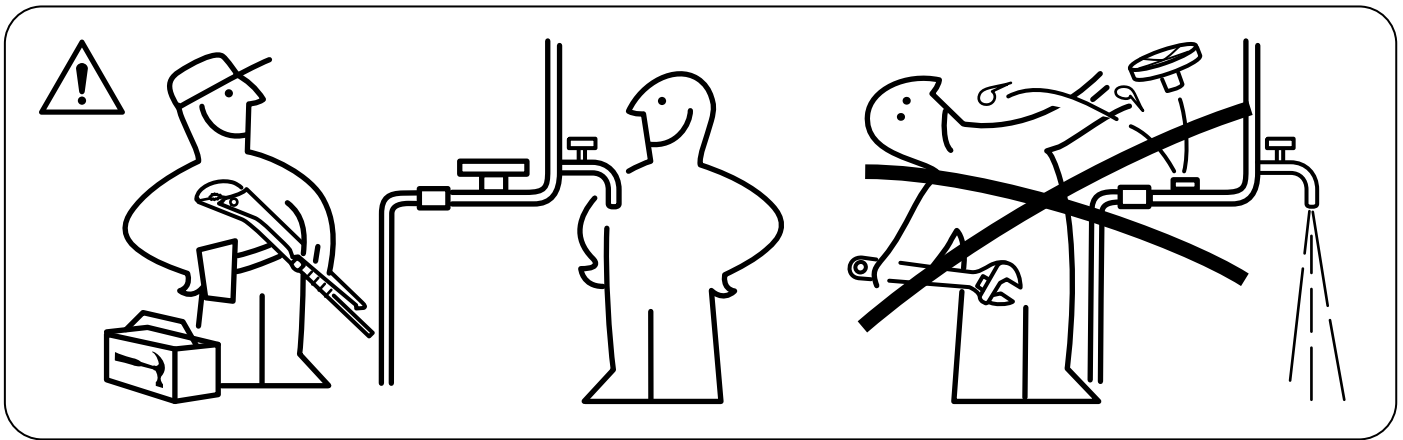
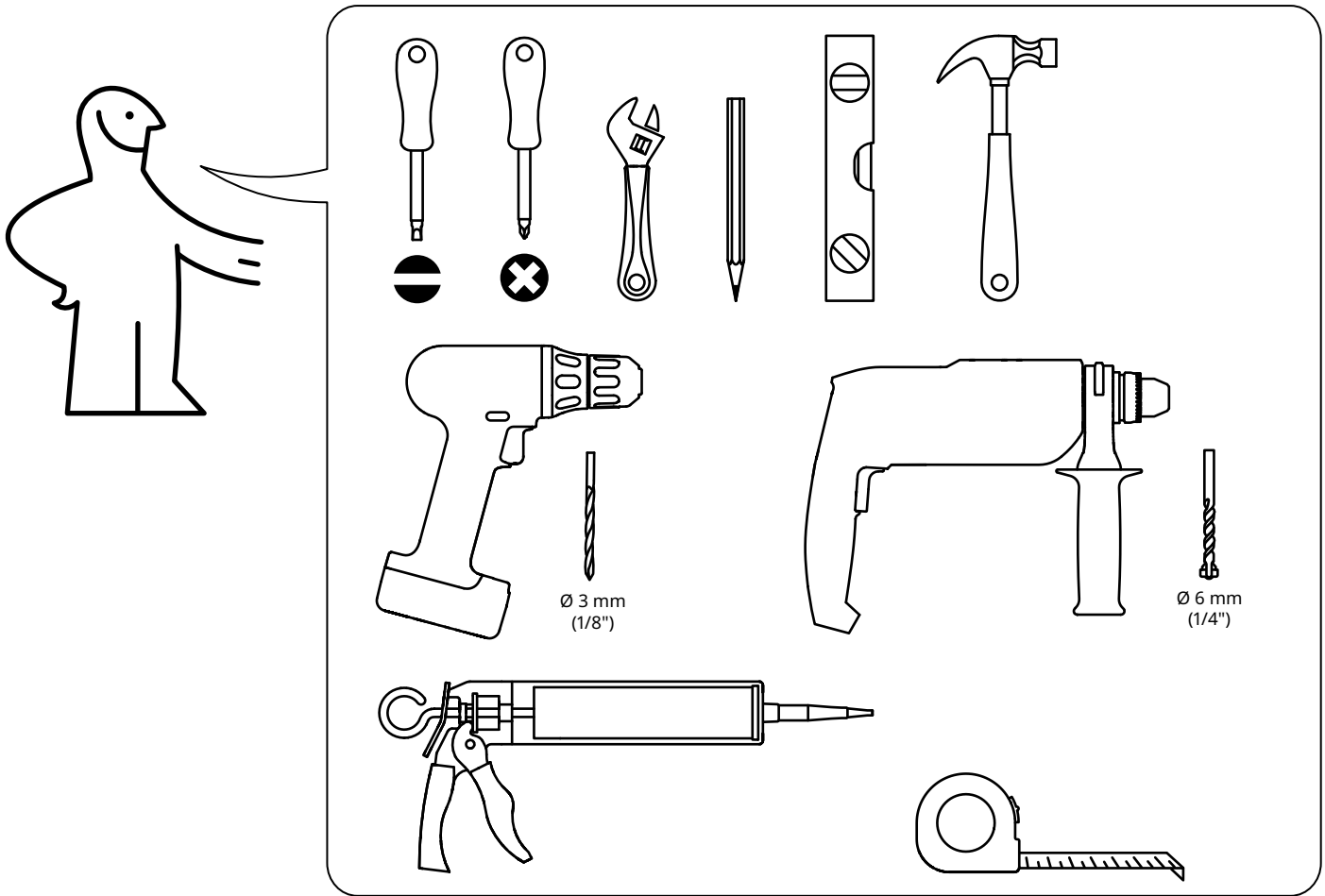

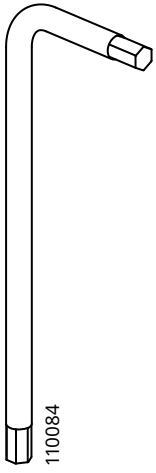

1x

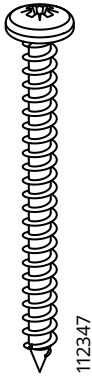

1x

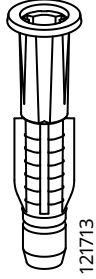

1x

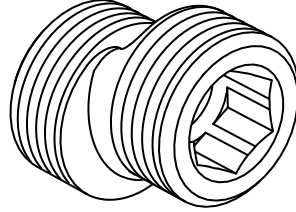

2x

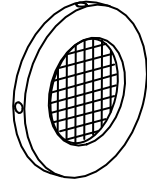

2x

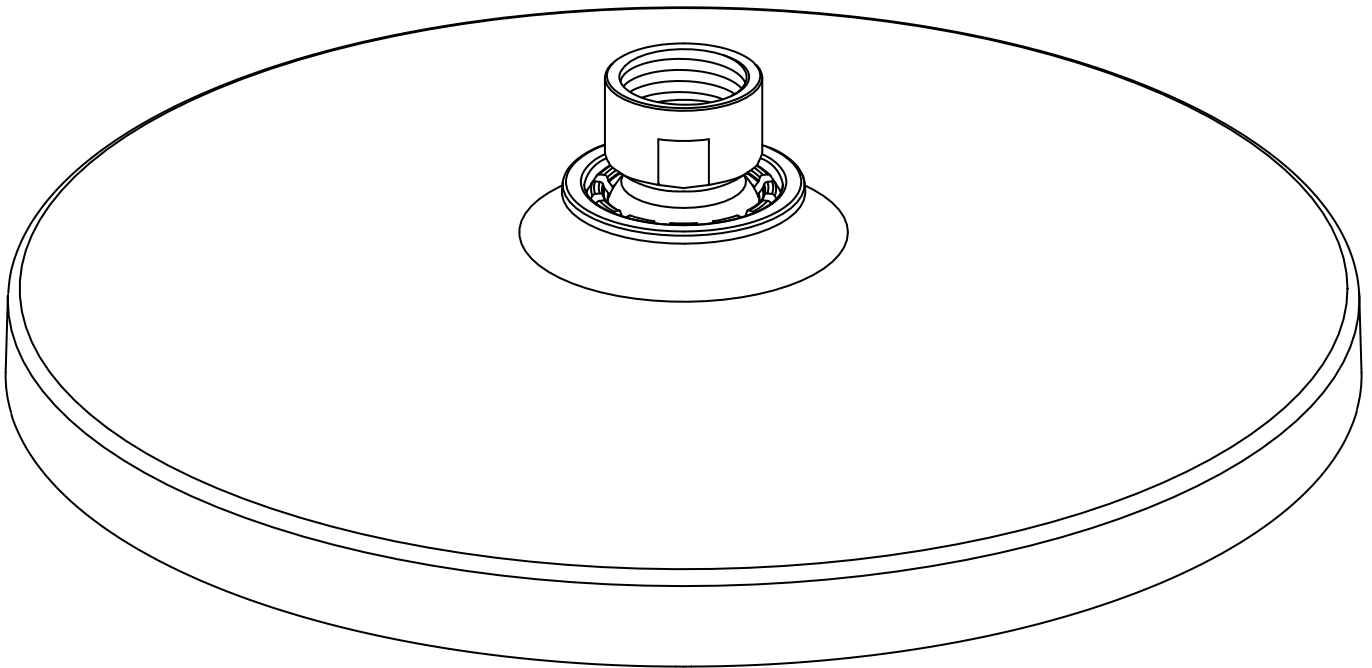

1x

190070

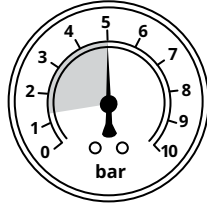
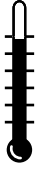

Svenska

Rekommenderad
varmvattentemperatur: 60°C
Max. varmvattentemperatur:
80°C

English

Recommended hot water
temperature: 60°C
Max. hot water temperature:
80°C

Svenska

Rekommenderat arbetstryck:
1,4 - 5 bar
Max. statiskt tryck: 10 bar
Max. provningstryck: 16 bar

English

Recommended working
pressure: 1,4 - 5 bar
Max. static pressure: 10 bar
Max. test pressure: 16 bar

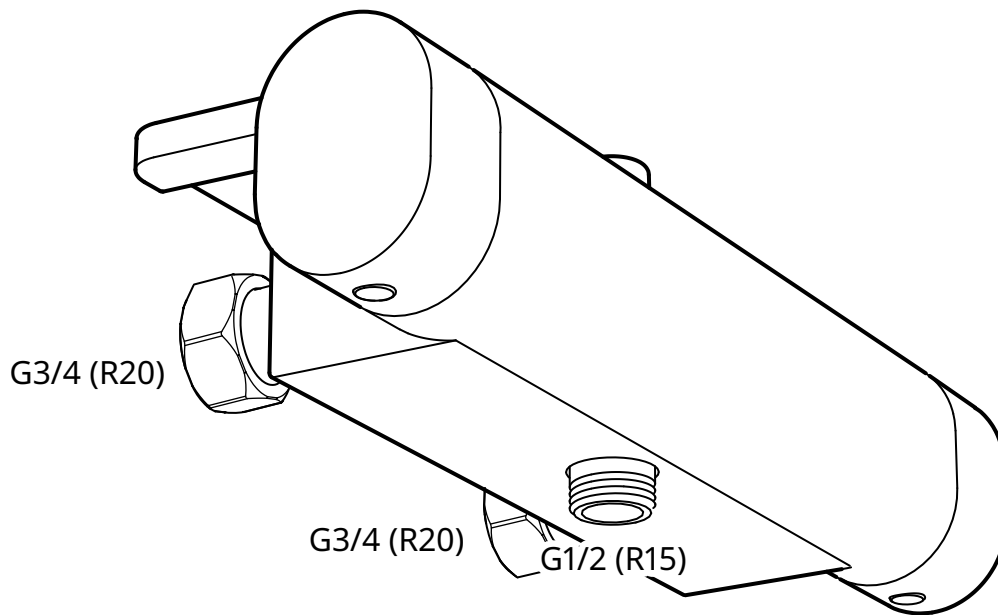

M26

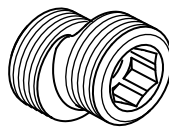

G3/4 (R20)

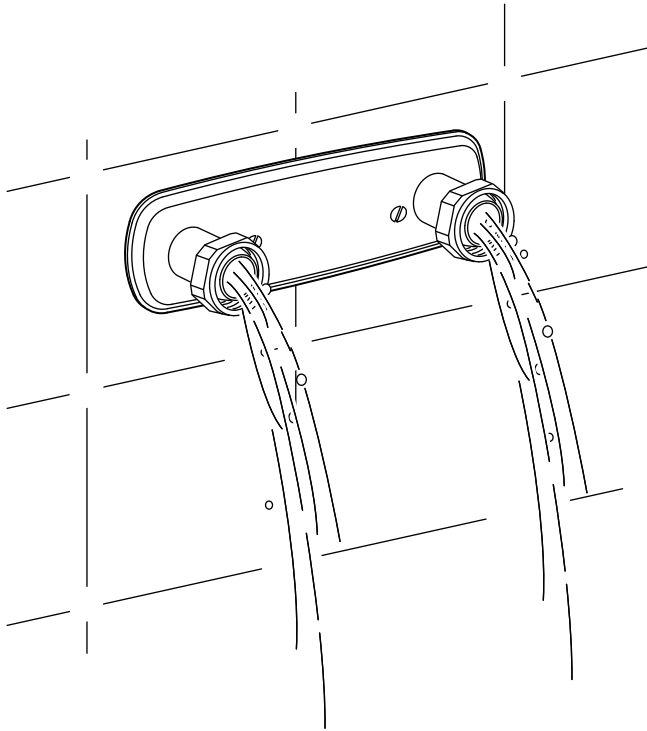

Svenska

Innan du ansluter produkten till vattenförsörjningssystemet bör man spola vatten genom systemet för att avlägsna skräp.

English

Before connecting the product to the water supply system, water should be flushed through the system to remove all debris.

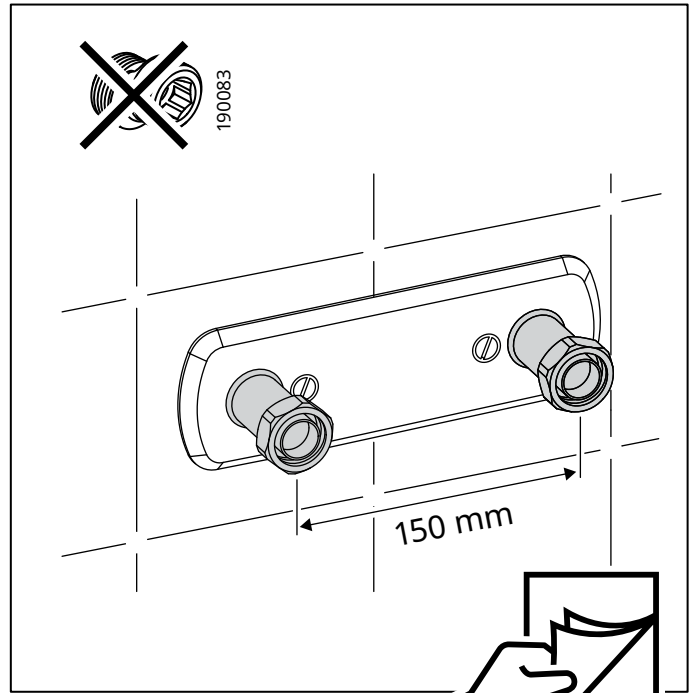
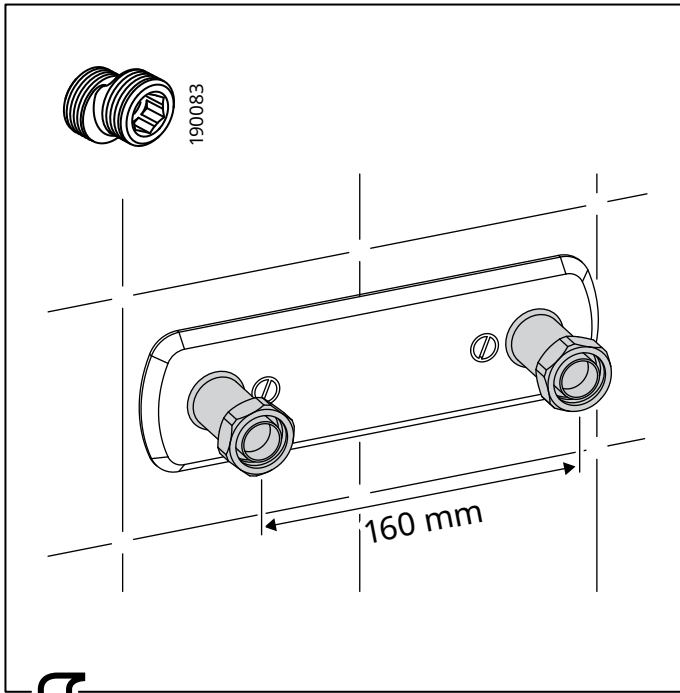

1

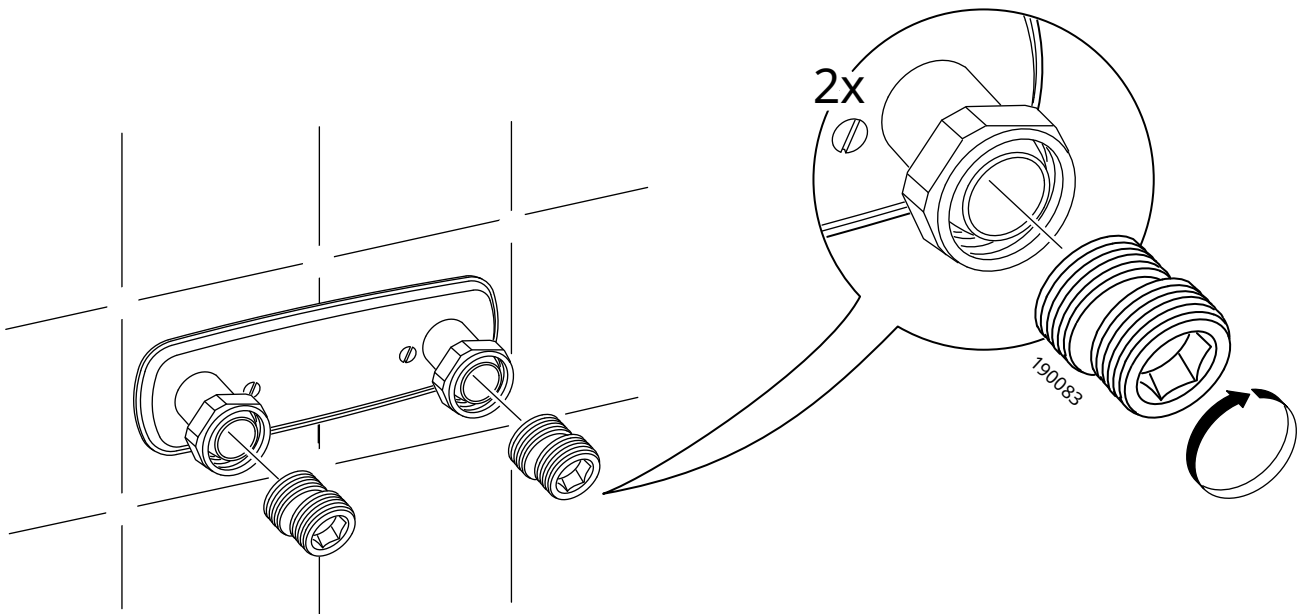
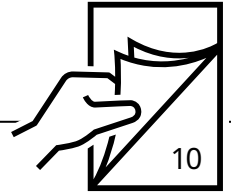

2

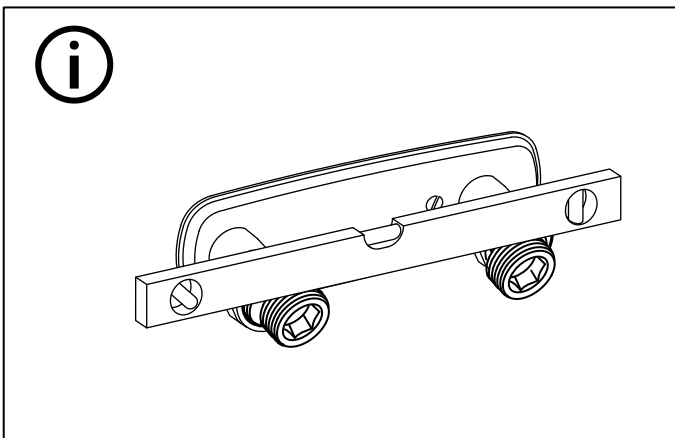
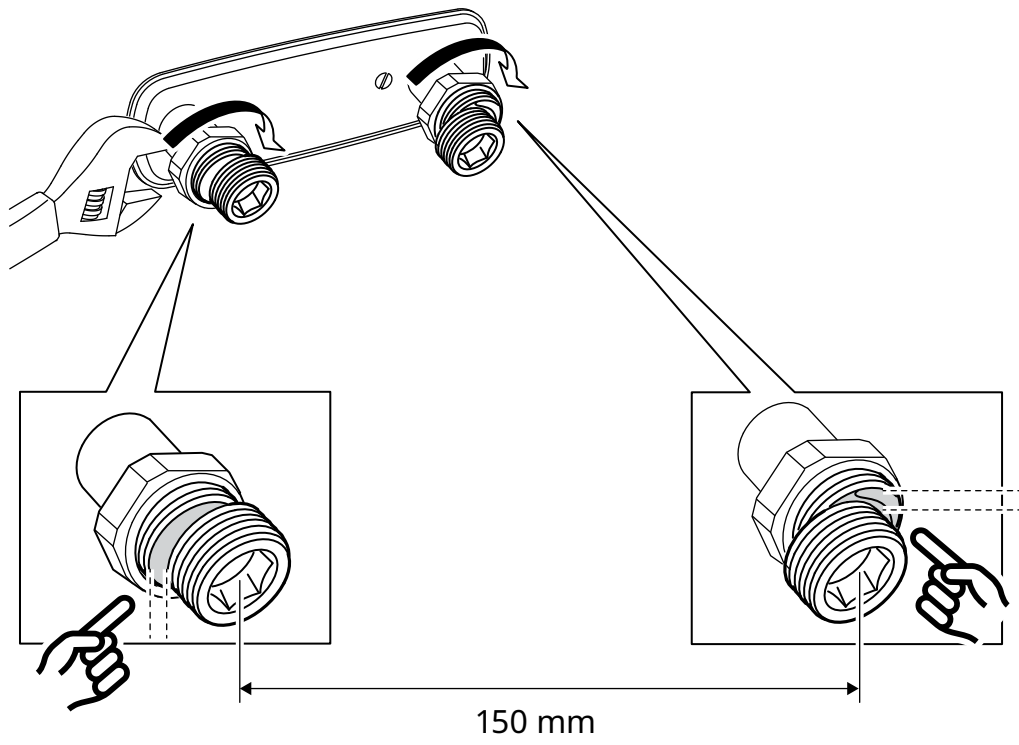

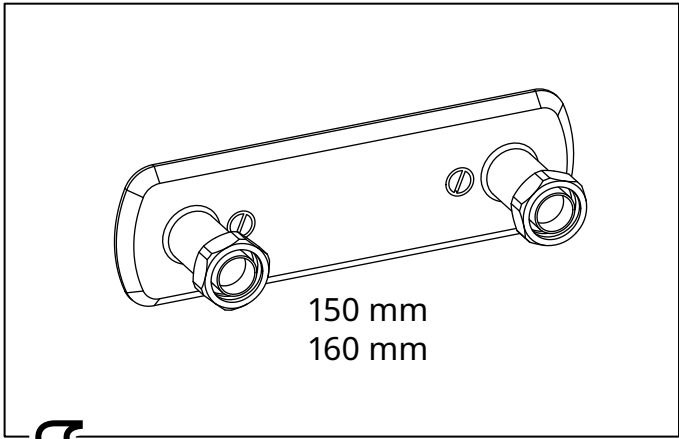

3

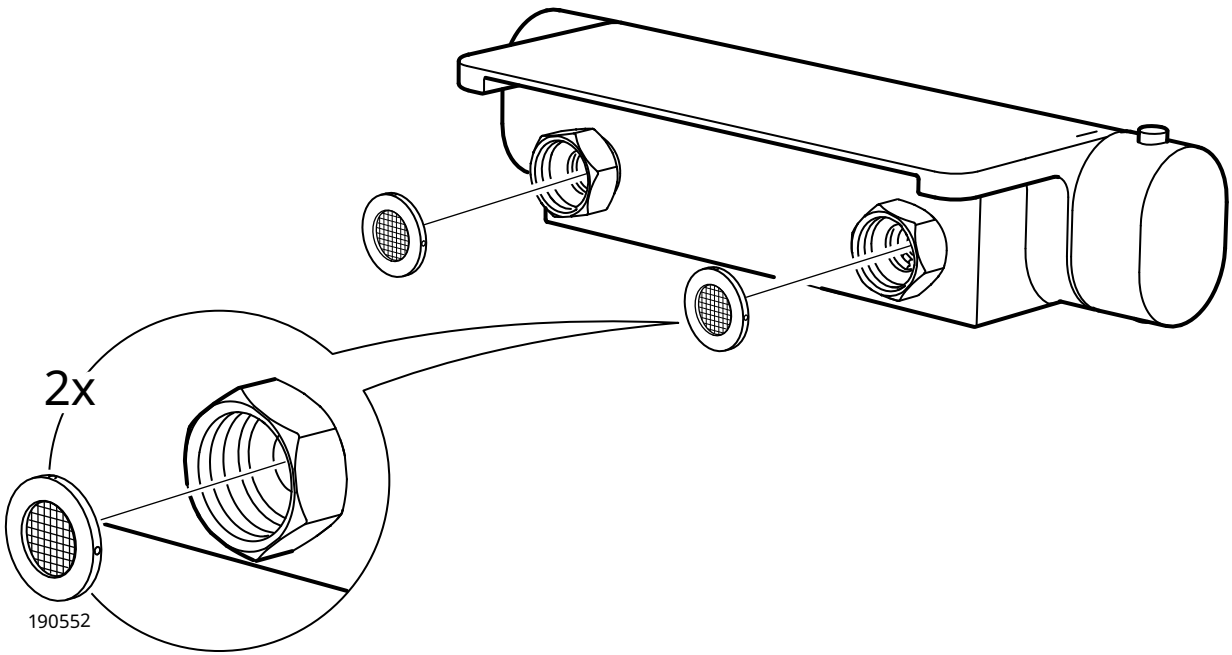

4

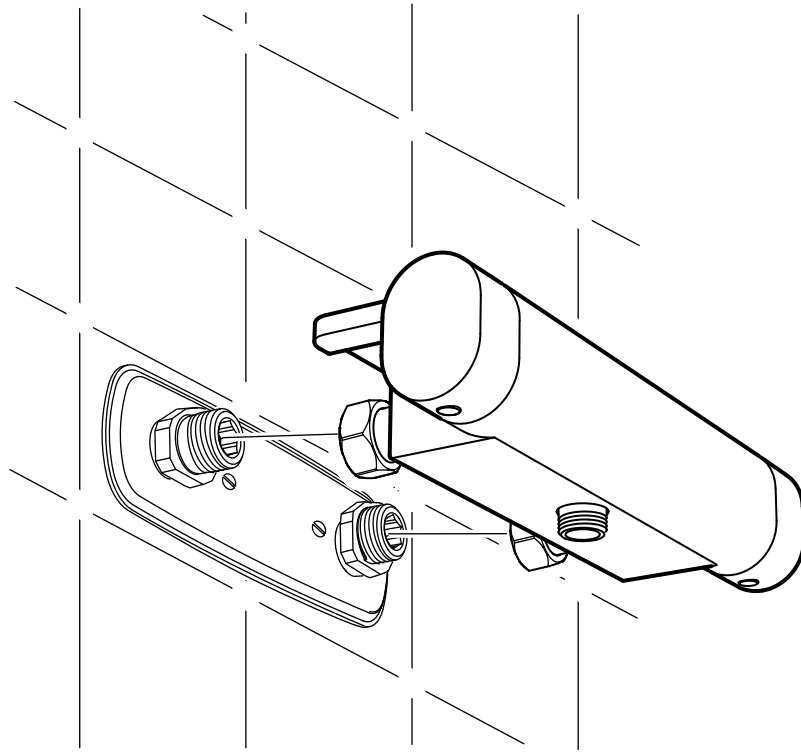

5

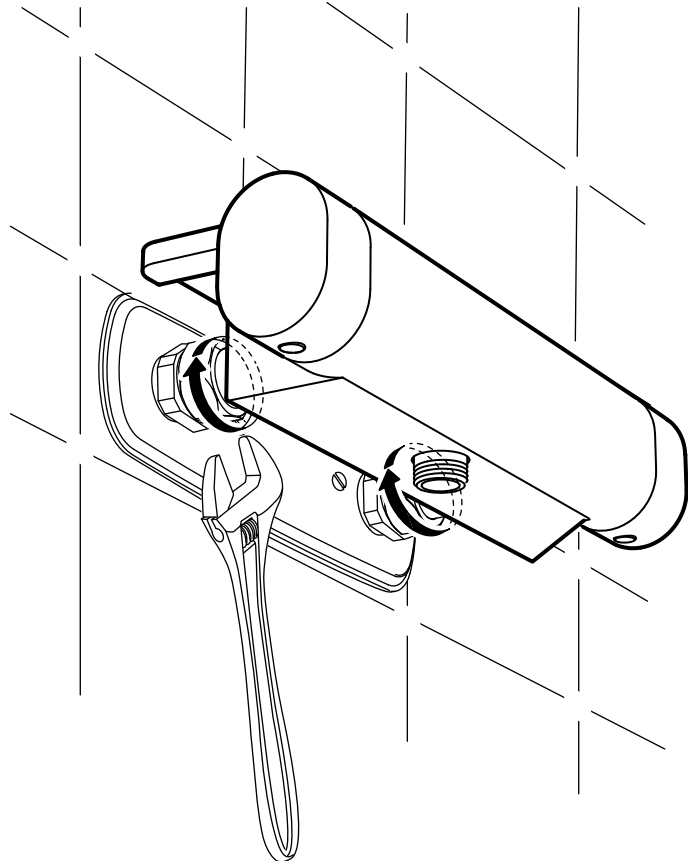

Svenska

OBS! Dra aldrig åt för hårt; slangar och packningar kan skadas.

English

IMPORTANT! Do not tighten too hard: this can damage hoses/pipes and washers.

6

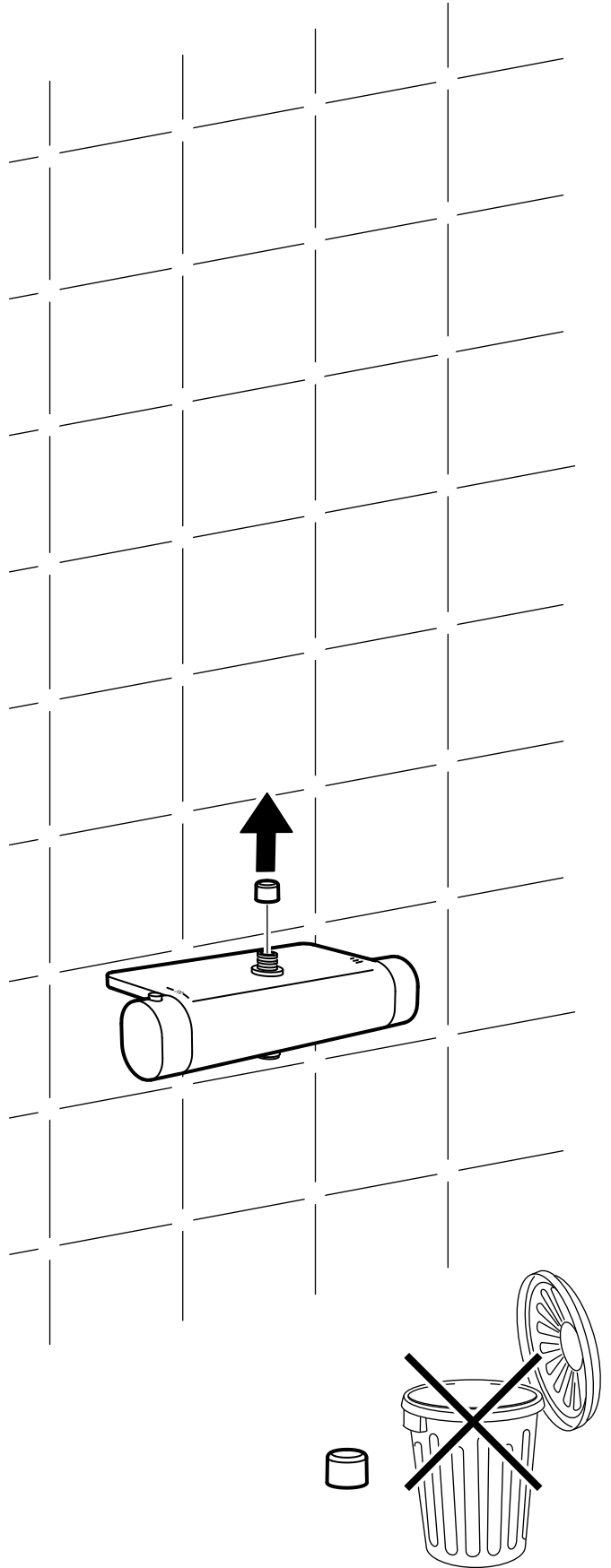
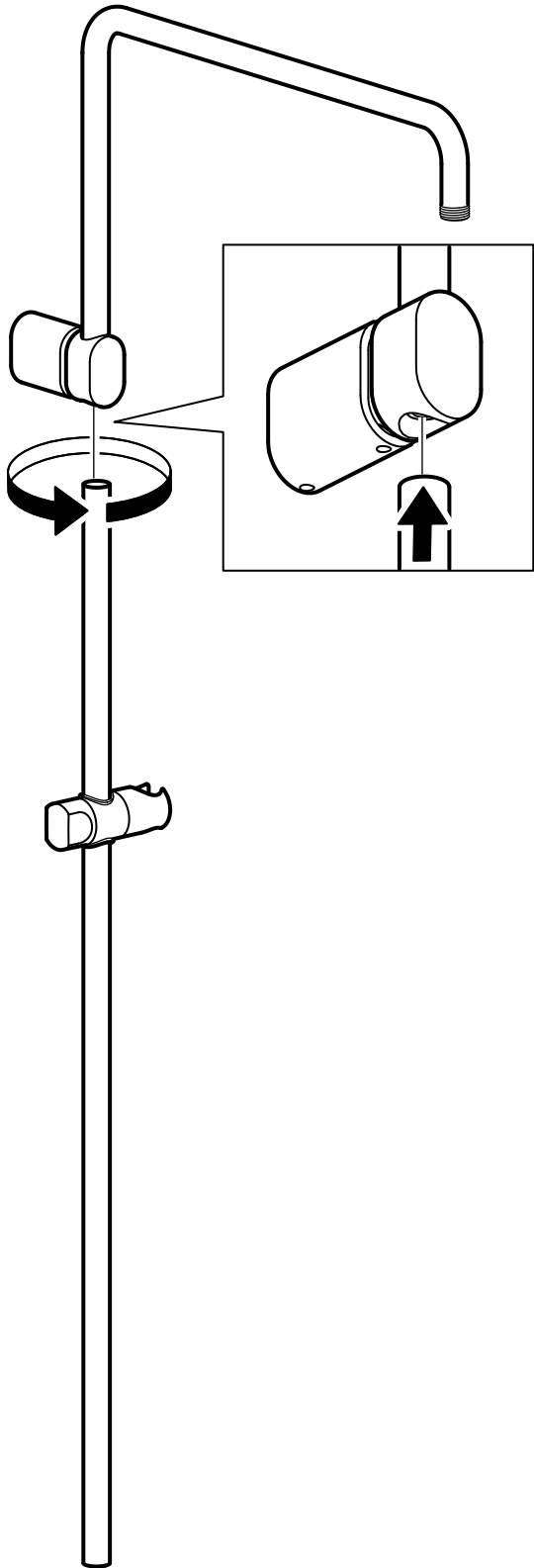

7

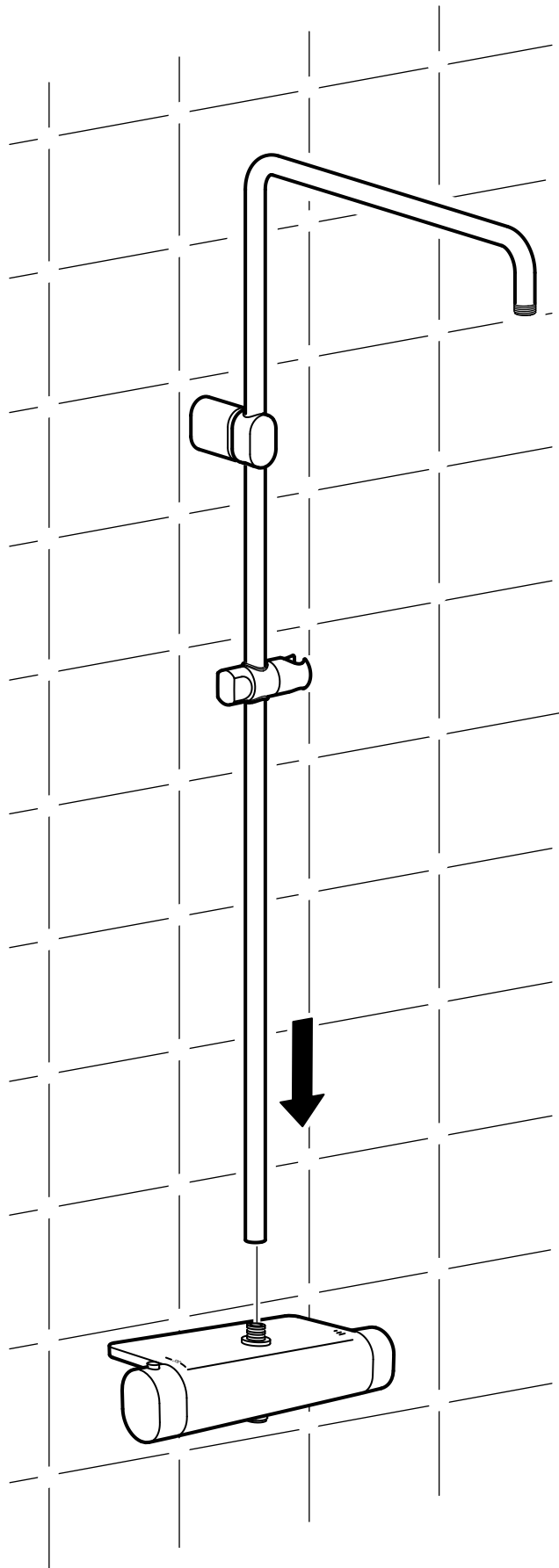

8

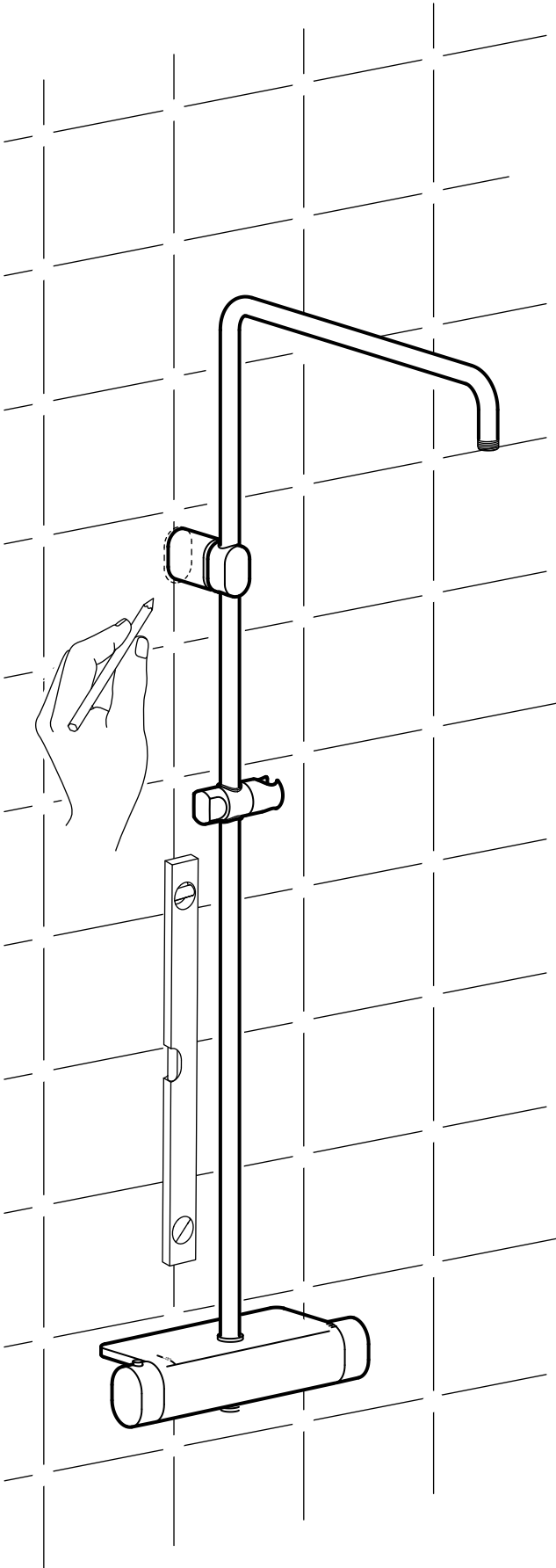

9

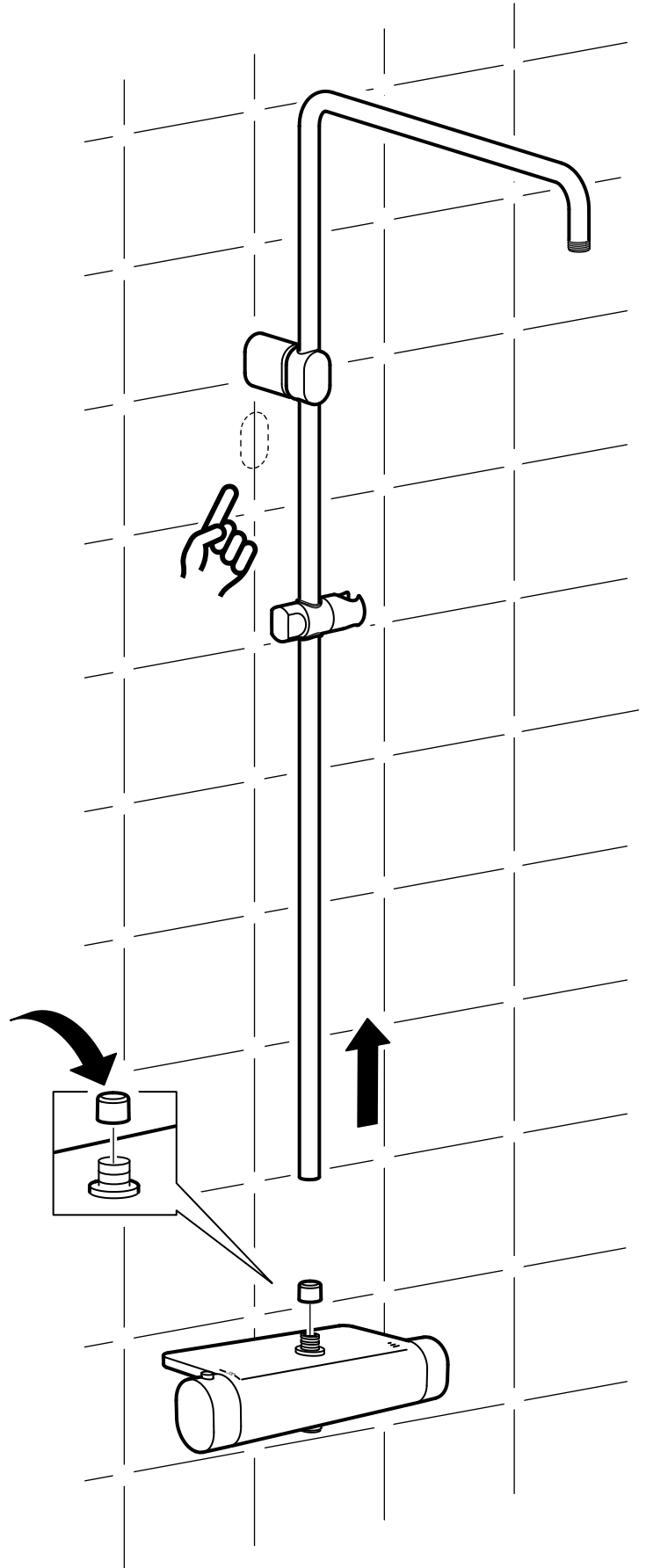

A

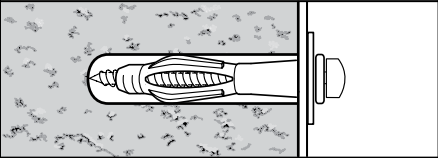

Ø 6 mm
(1/4")

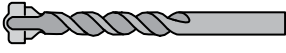

1

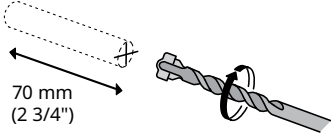

2

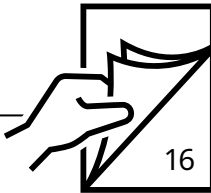
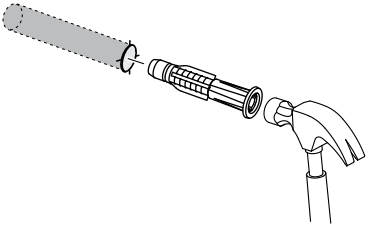

16

B

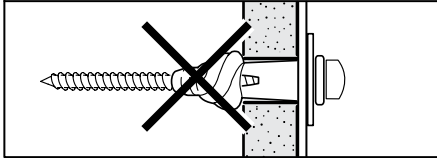

C

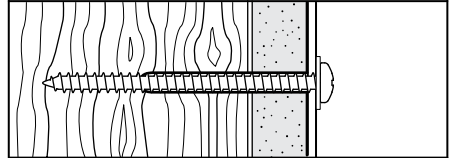

Ø 3 mm
(1/8")



1

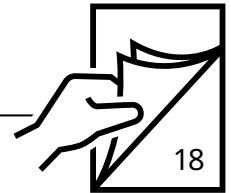
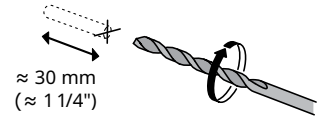

18

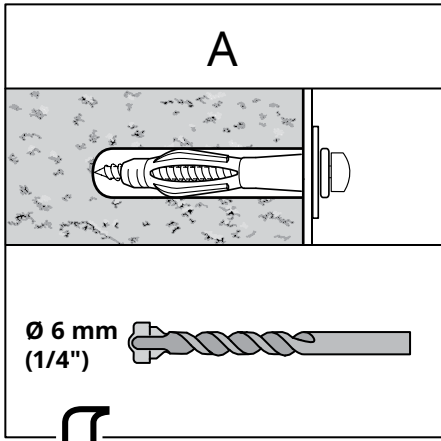

Svenska

Innan borrning se till att inga vattenledningar eller elektriska kablar finns inne i väggen där du vill borra.

English

Before drilling make sure no water pipes or electric cables are located inside the wall where you want to drill.



10

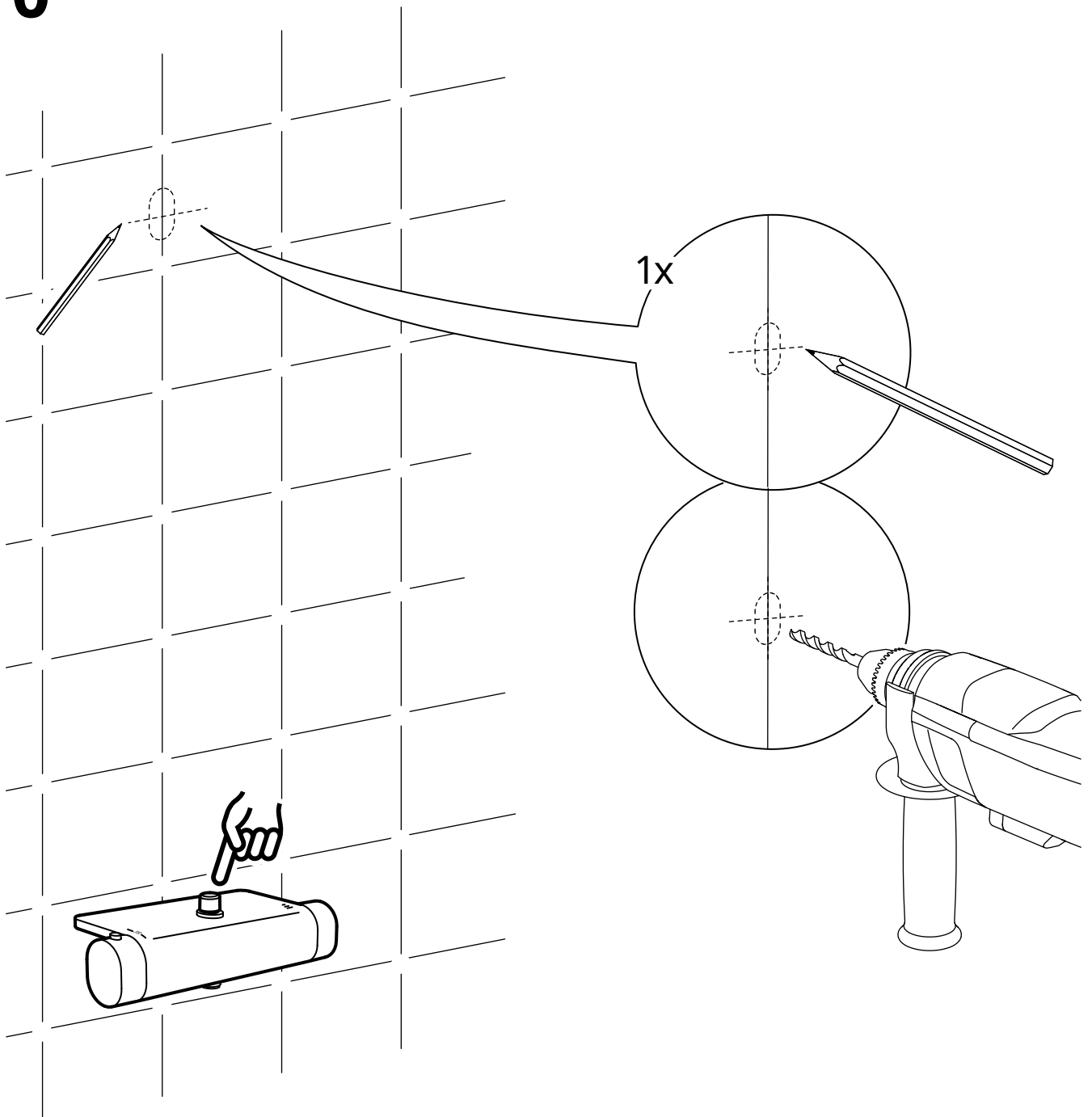

11

Svenska

Silikonfogmassan måste vara vatten- och mögelbeständig och lämplig för installationen, i enlighet med EN 15651-3, klass XS1.

English

Silicone sealant must be water- and mould-resistant and suitable for the installation, according to EN 15651-3, Class XS1.

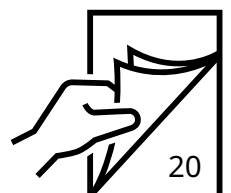
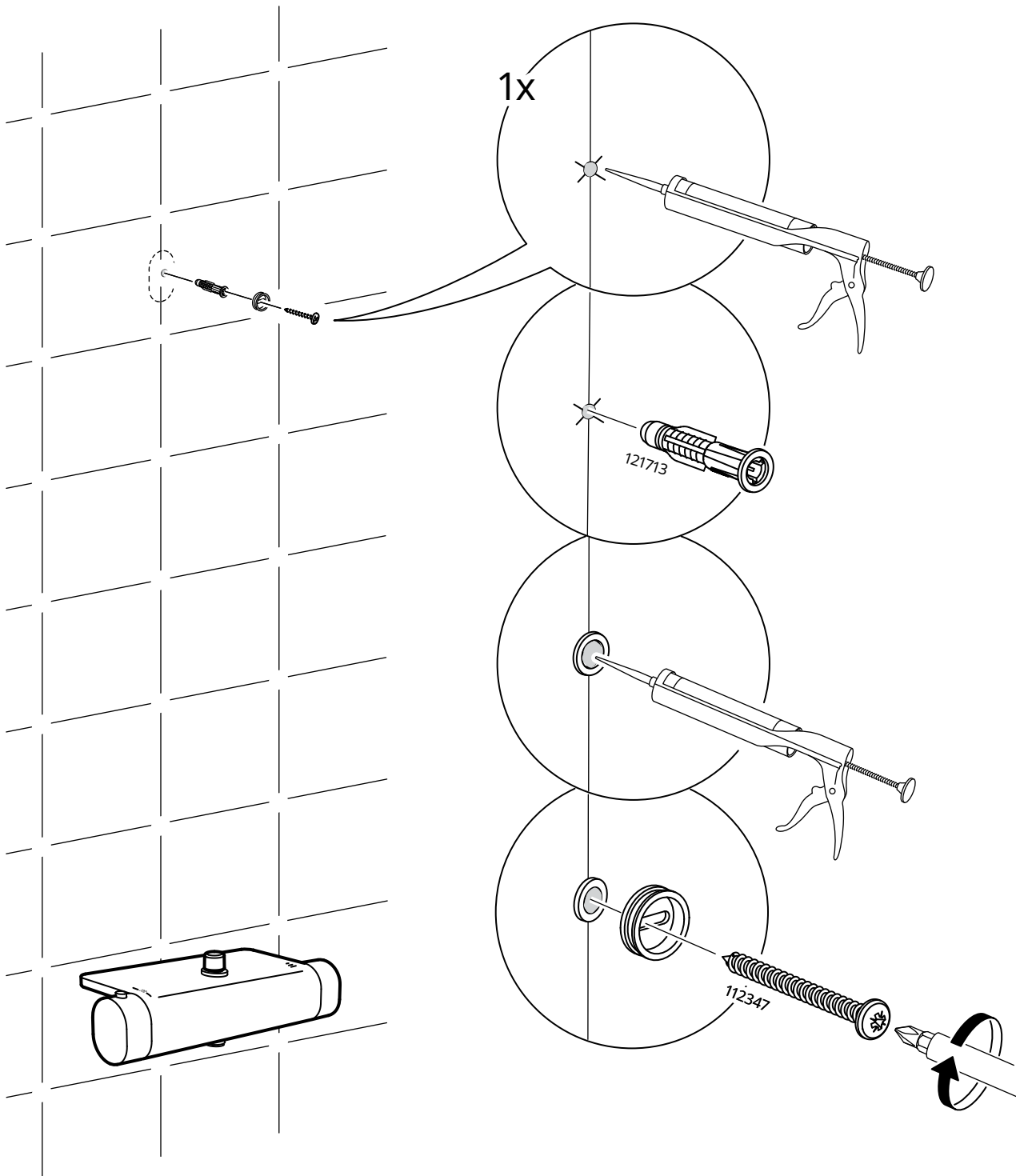

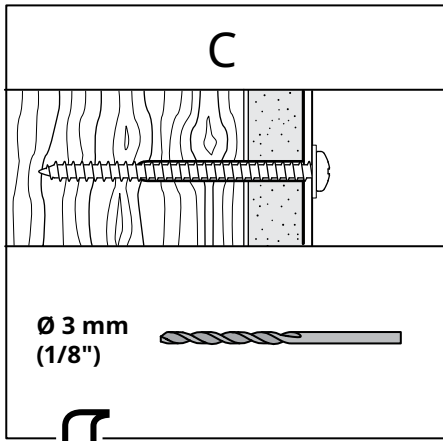

Svenska

Innan borrning se till att inga vattenledningar eller elektriska kablar finns inne i väggen där du vill borra.

English

Before drilling make sure no water pipes or electric cables are located inside the wall where you want to drill.



10

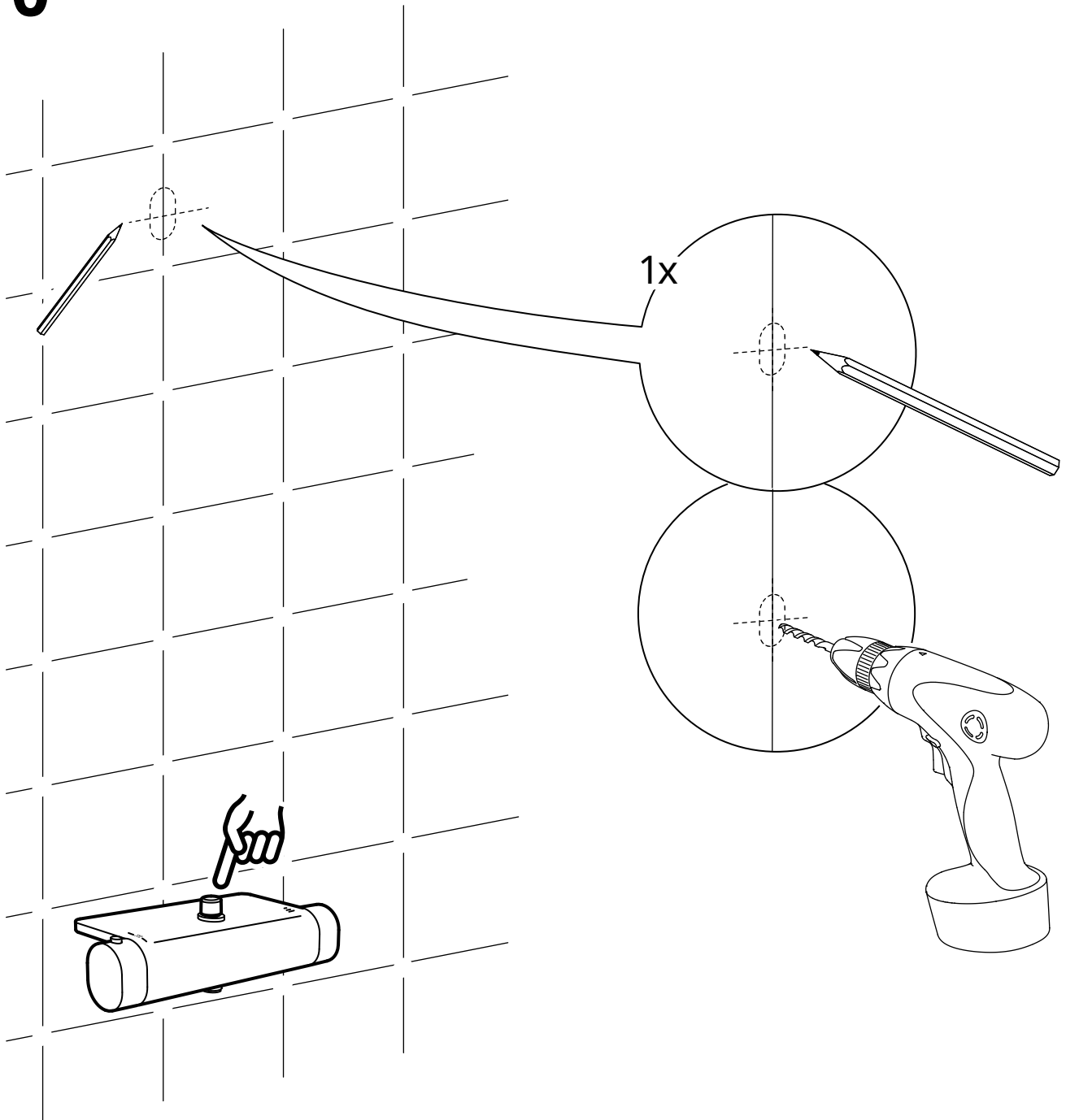

11

Svenska

Silikonfogmassan måste vara vatten- och mögelbeständig och lämplig för installationen, i enlighet med EN 15651-3, klass XS1.

English

Silicone sealant must be water- and mould-resistant and suitable for the installation, according to EN 15651-3, Class XS1.

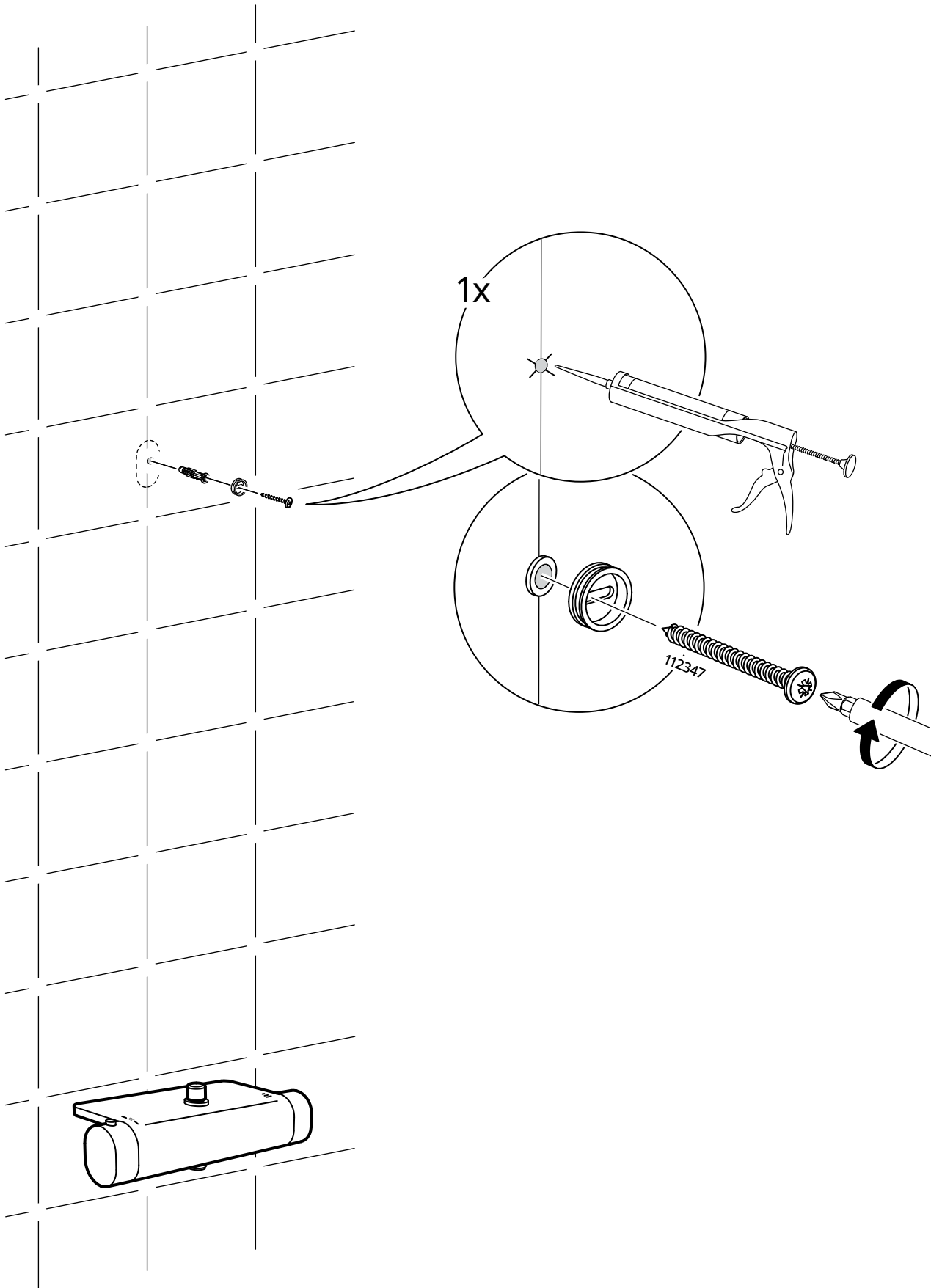

12

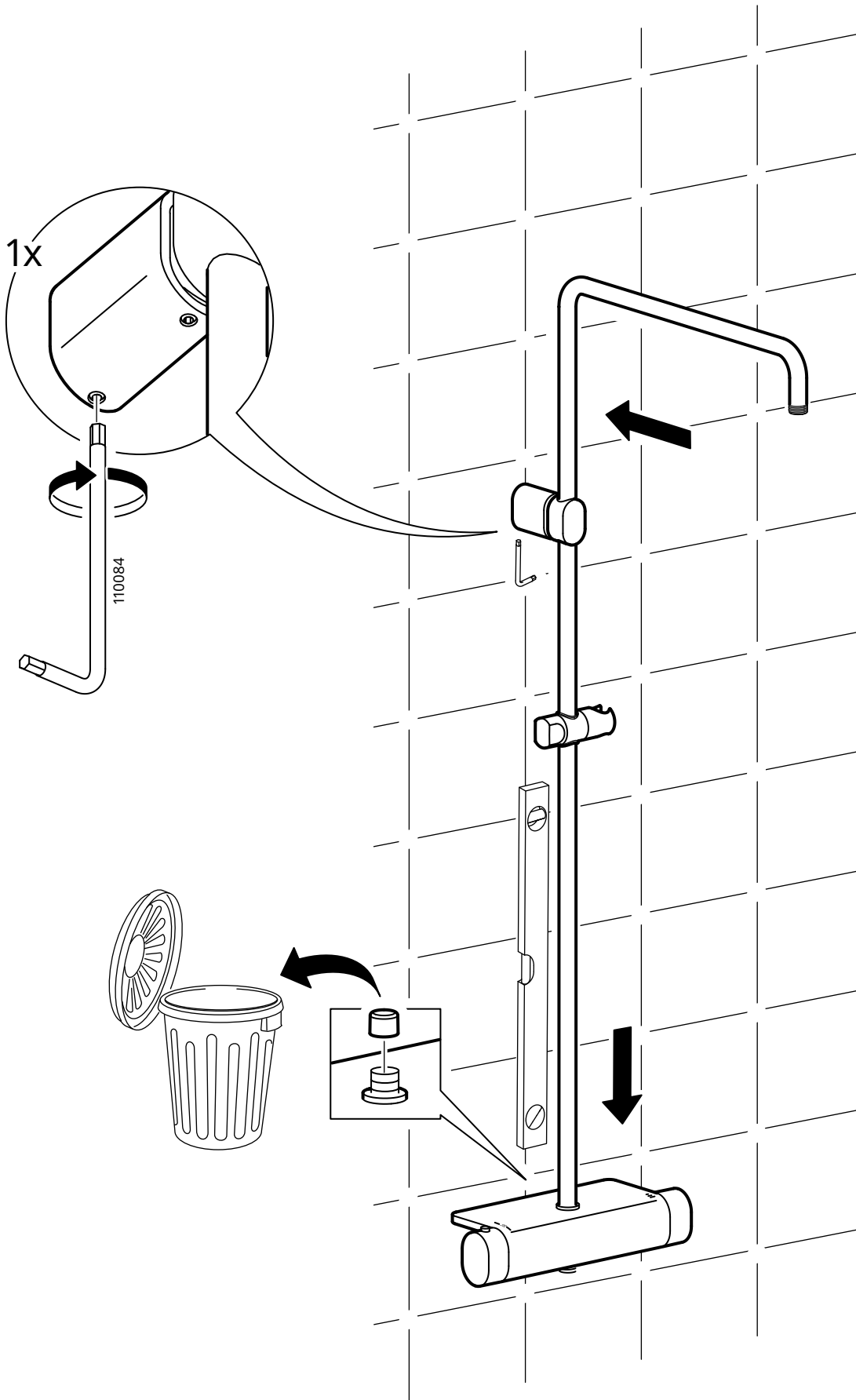

13

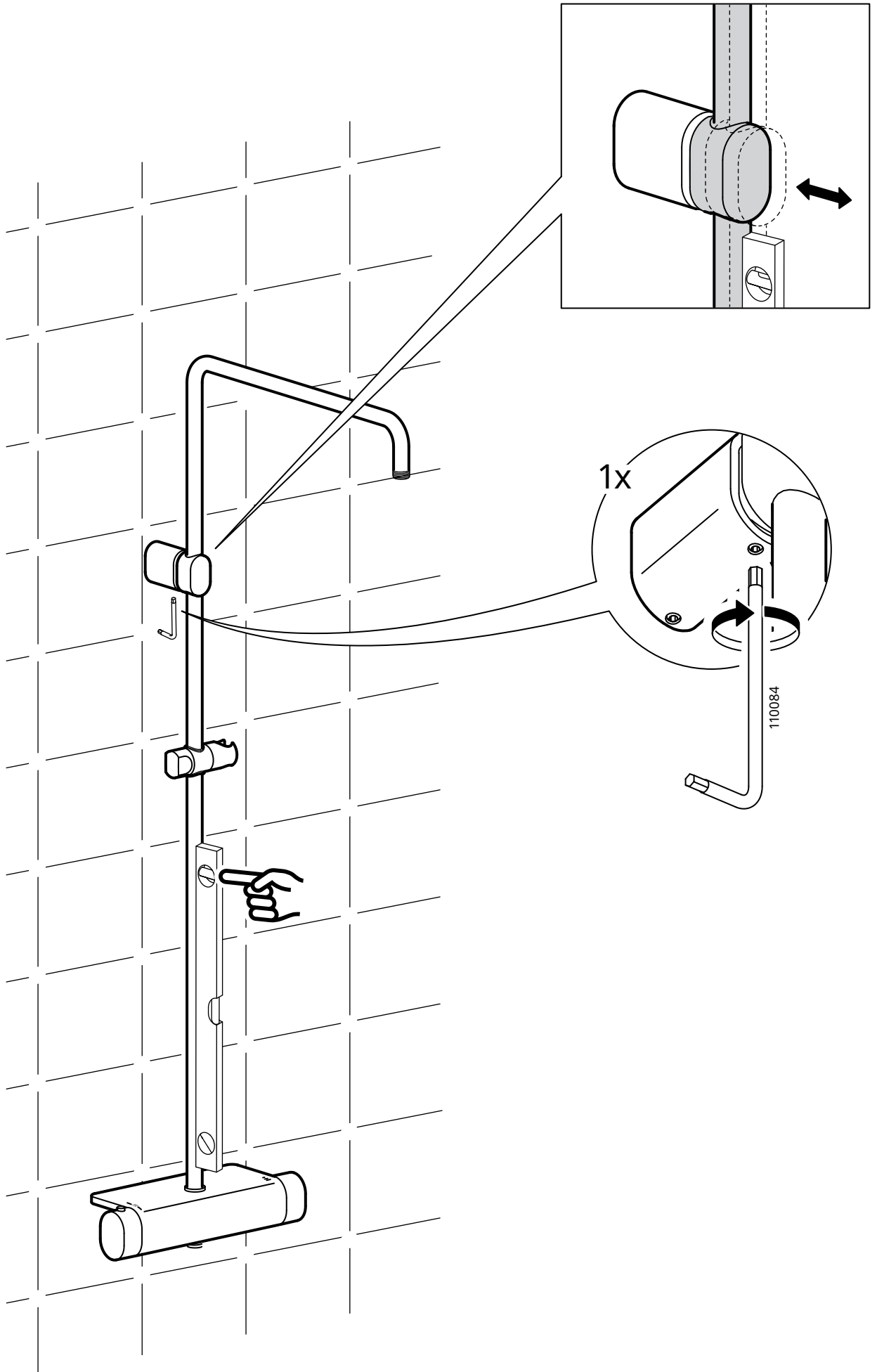

14

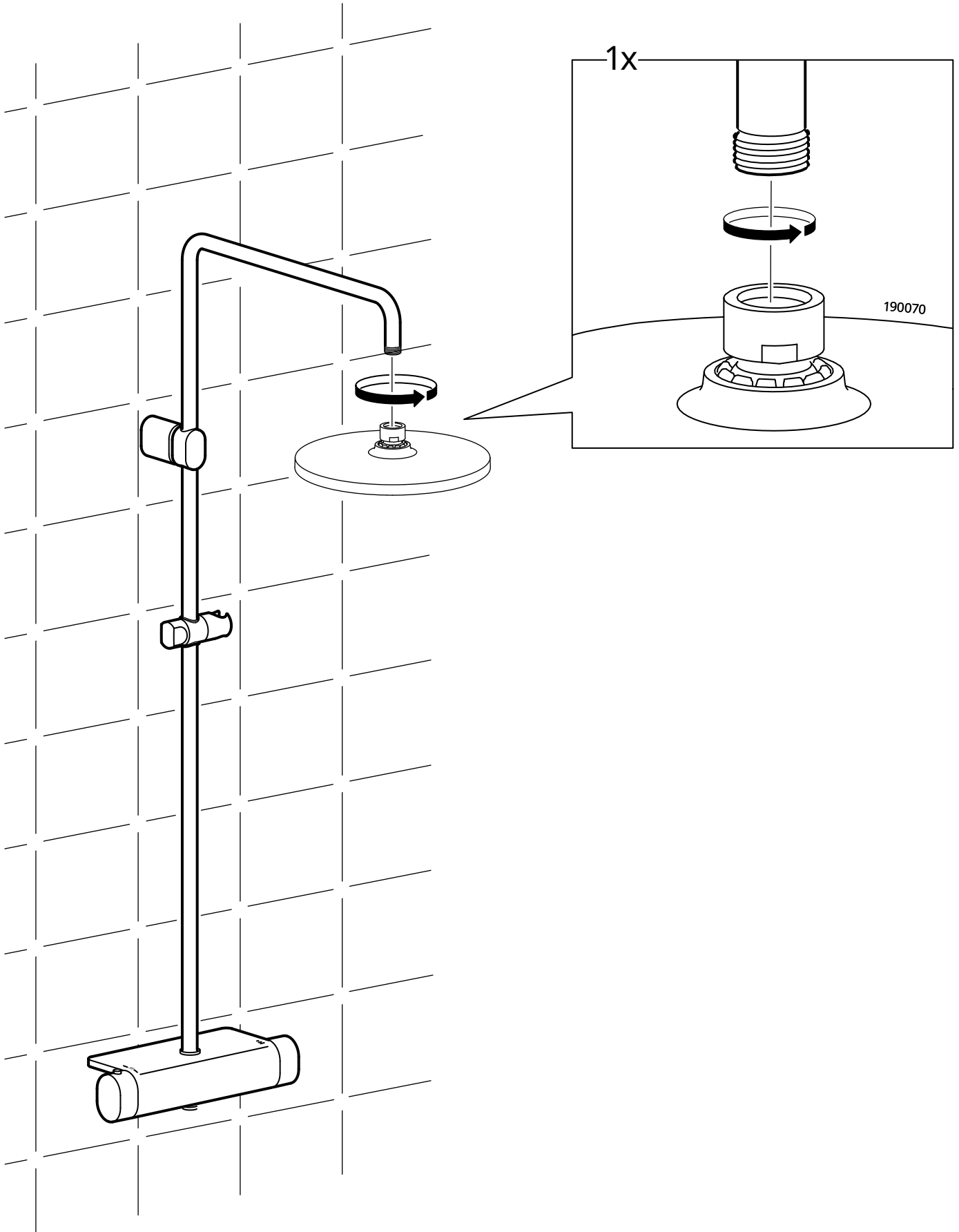

15

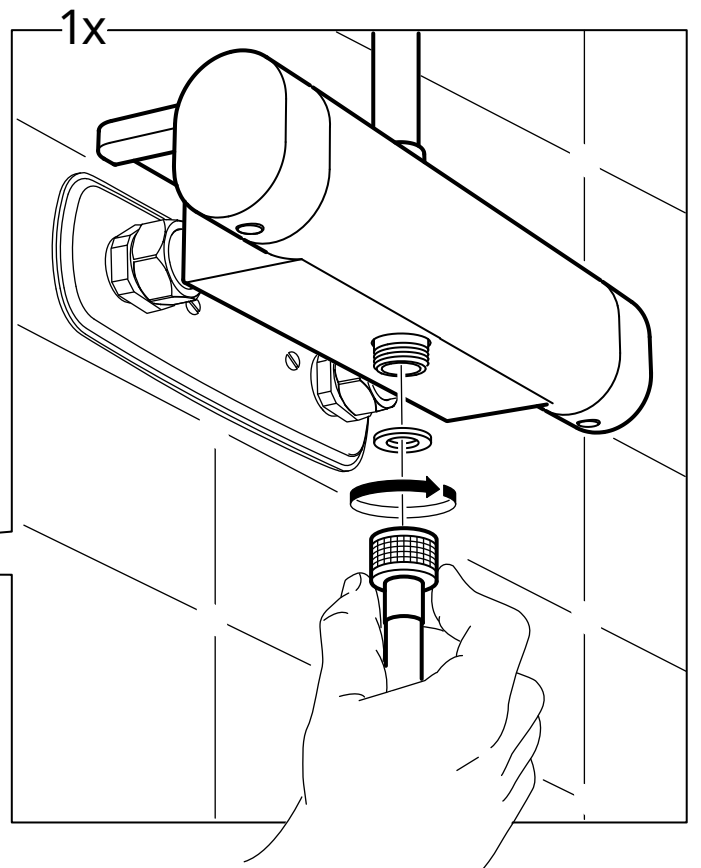
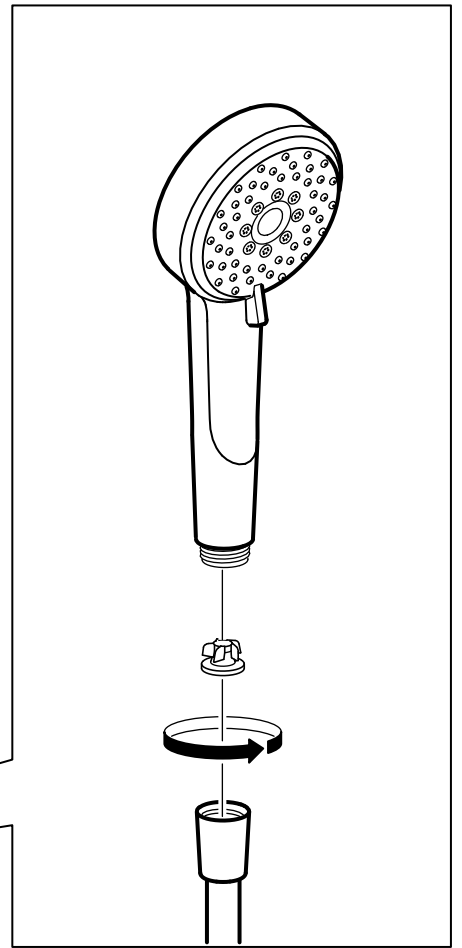
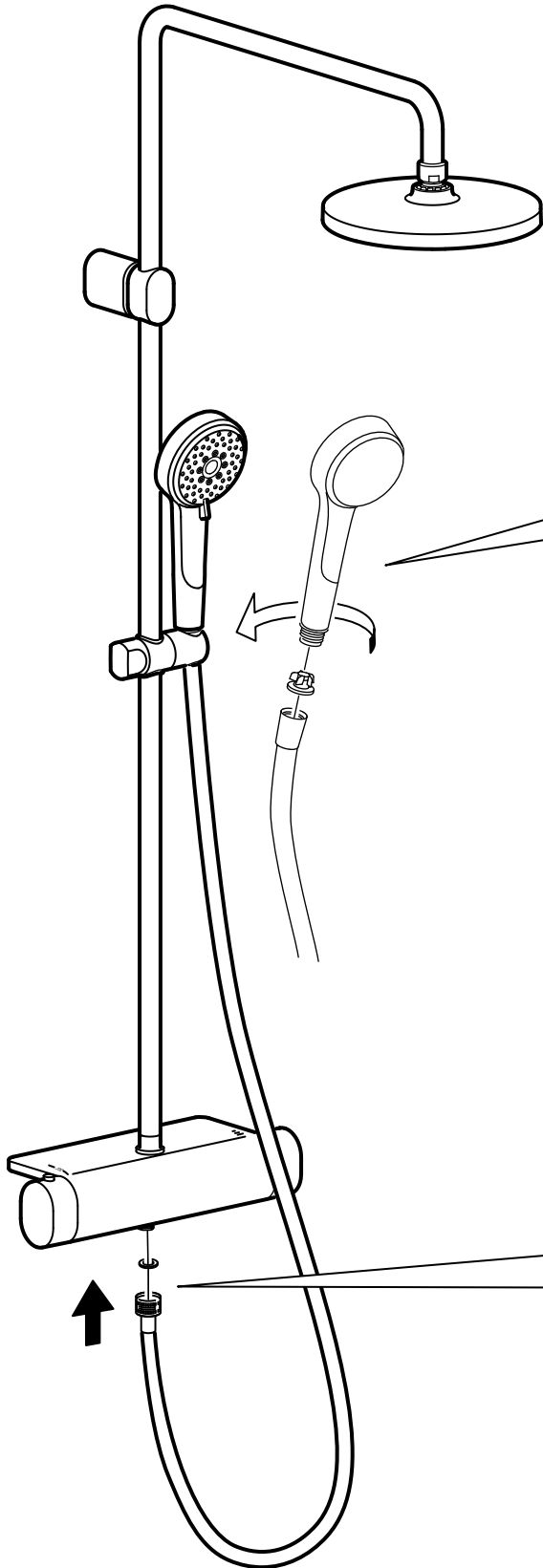

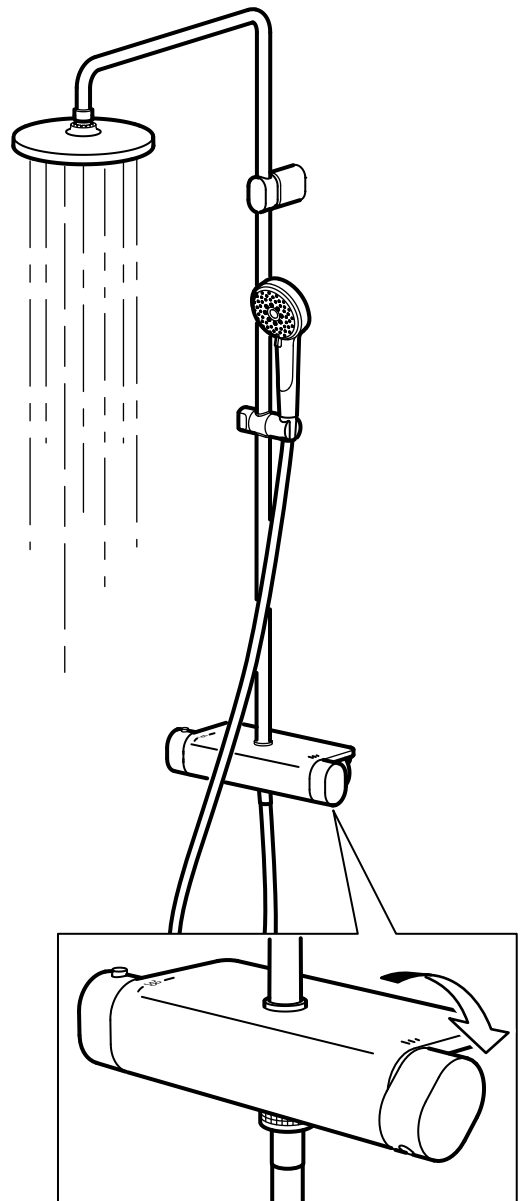
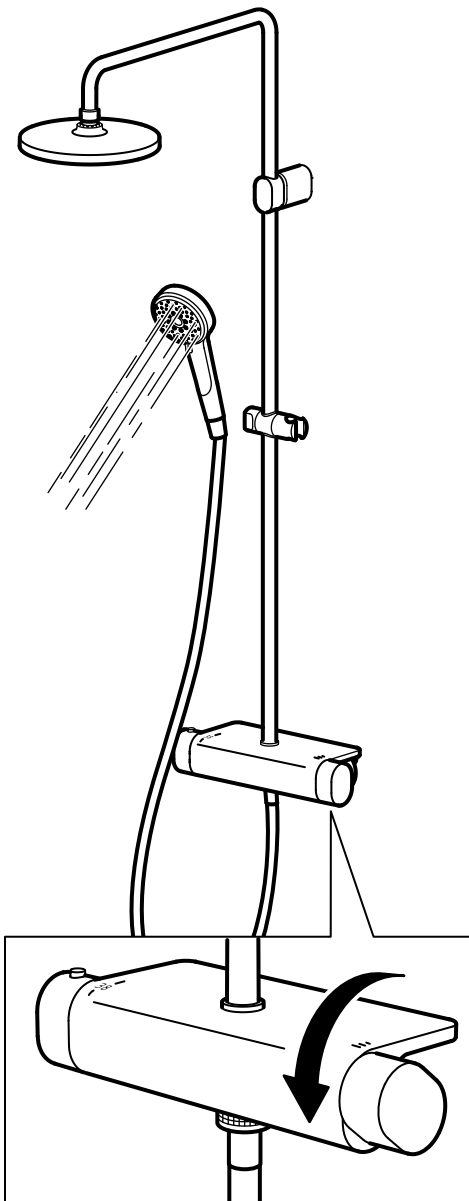
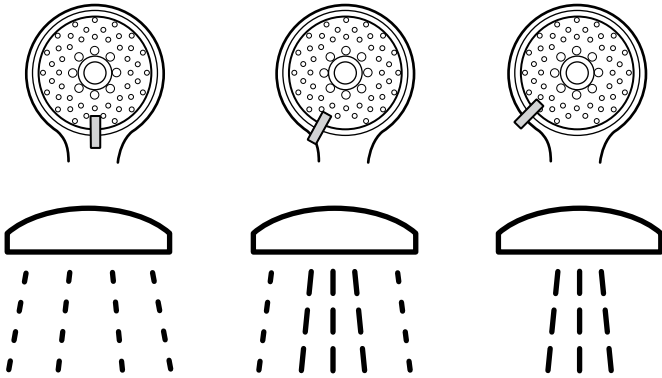



Svenska

Kontrollera regelbundet att installationen är tät.

English

Check at regular intervals to make sure that the installation is not leaking.

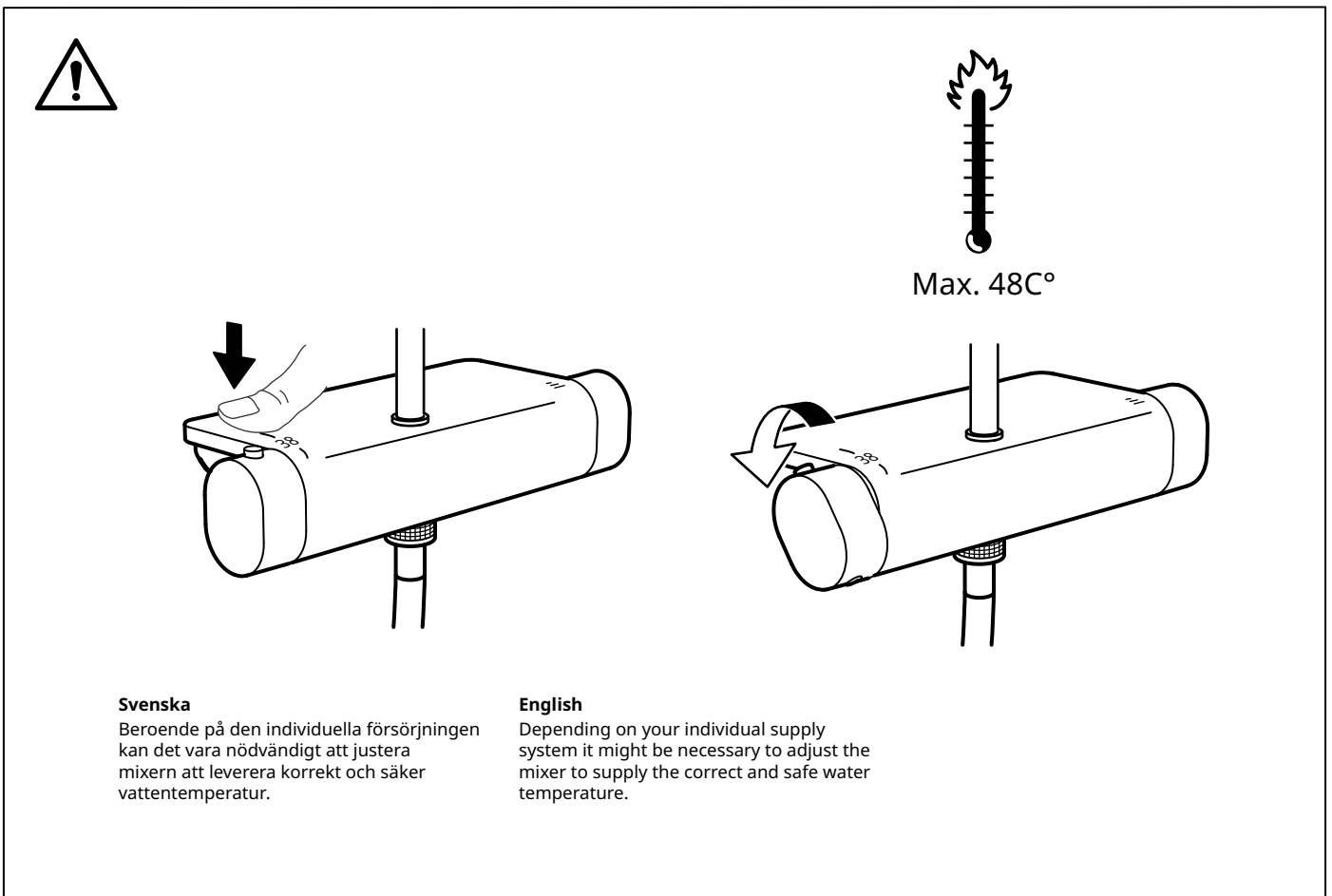
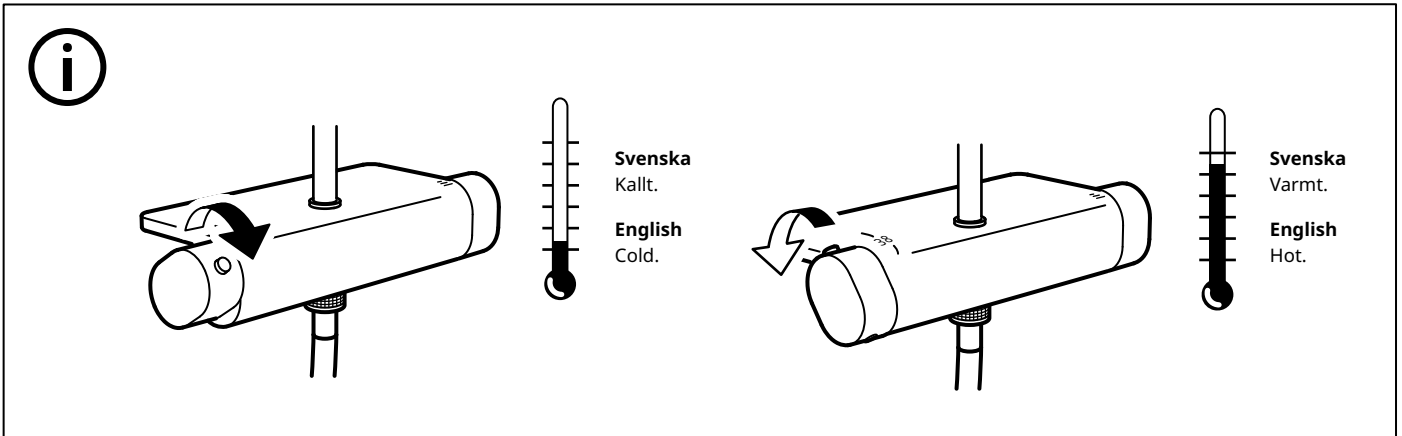

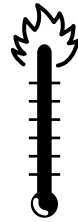
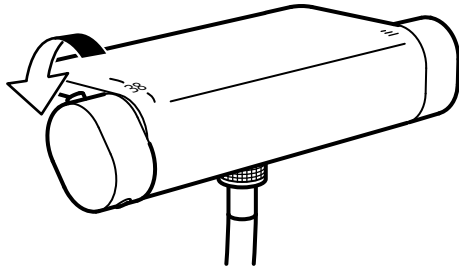

Max 48C°

1

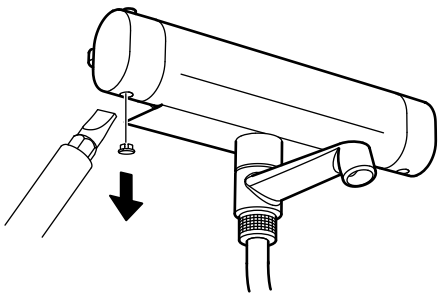

2

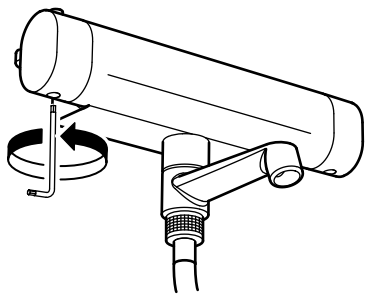

3

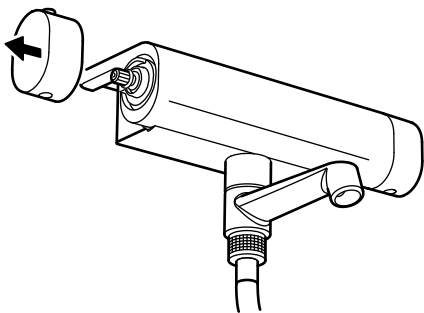

4

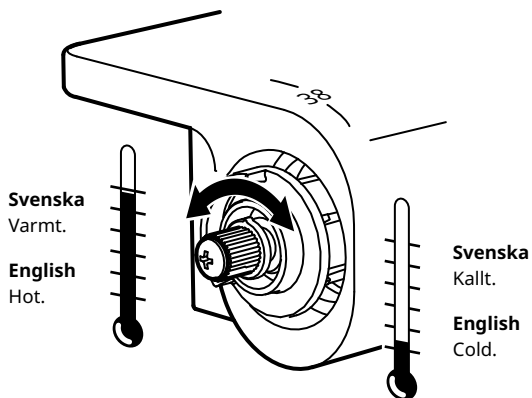

5

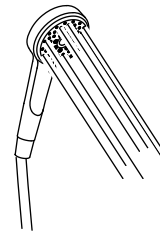

37 - 39° C

6

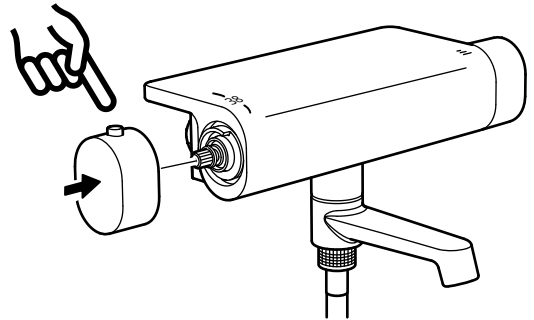

7

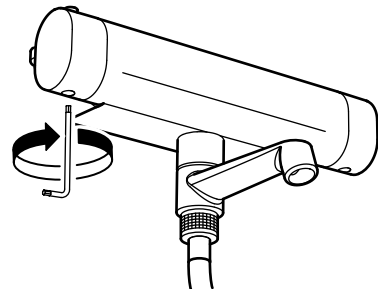

8

