

# KNOXHULT

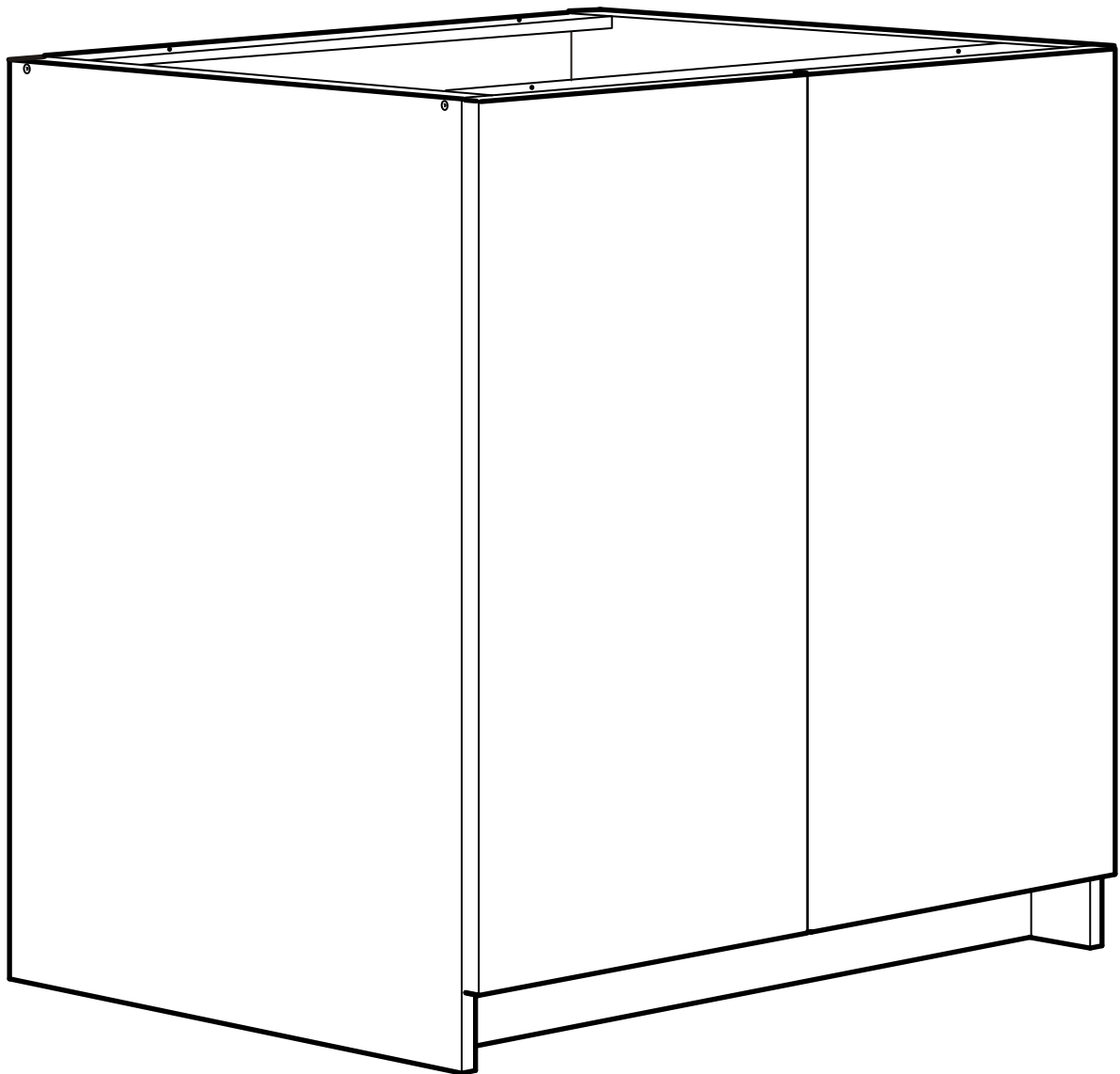

Design and Quality  
IKEA of Sweden



#### ENGLISH

Important information

Read carefully

Follow each step of the instruction carefully

**Keep this information for further reference**

## WARNING

**Serious or fatal crushing injuries can occur from furniture tip-over. To prevent this furniture from tipping over it must be permanently fixed to the wall with the included wall attachment devices.**

Fastening devices for the wall are not included since different wall materials require different types of fastening devices. Use fastening devices suitable for the walls in your home. For advice on suitable fastening devices, contact your local specialized dealer.

#### 日本語

この説明書には重要な情報が含まれていますよくお読みになり、正しくご使用ください  
説明書の手順にそって組み立て・設置を行ってください

**この説明書はいつでも参照できるように大切に保管してください**

#### 警告

家具の転倒により、家具の下敷きになって大ケガ、あるいは生命にかかわるような傷害を負う危険があります。家具の転倒を防ぐため、付属の壁固定具で家具をしっかりと壁に固定してください。

壁の材質により使用できるネジの種類が異なるため、専用の取り付けネジは含まれていません。壁の材質に適したネジをご使用ください。取り付けに適したネジに関しては、お近くの専門店にご相談ください。

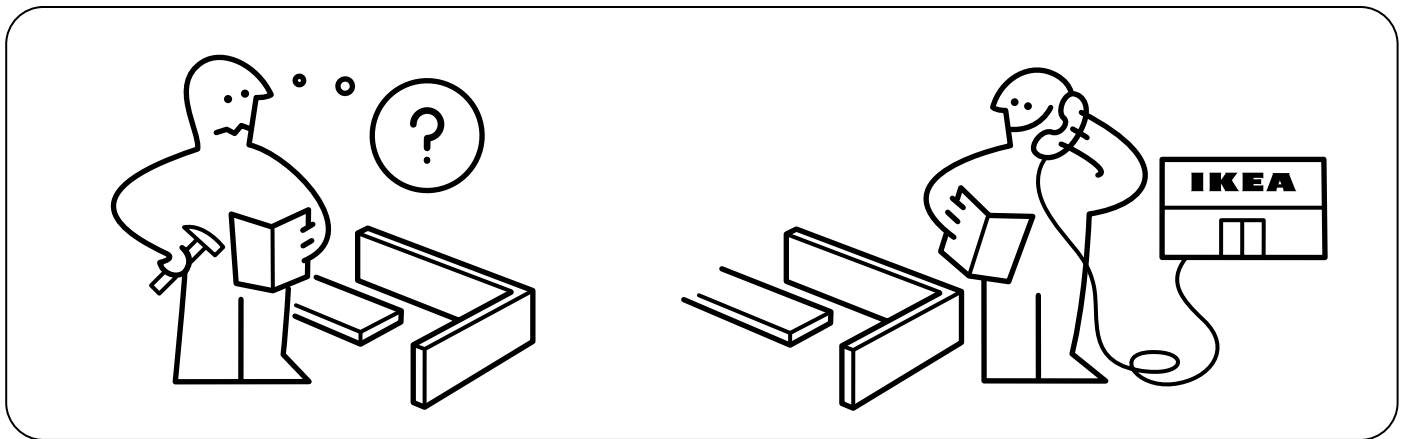
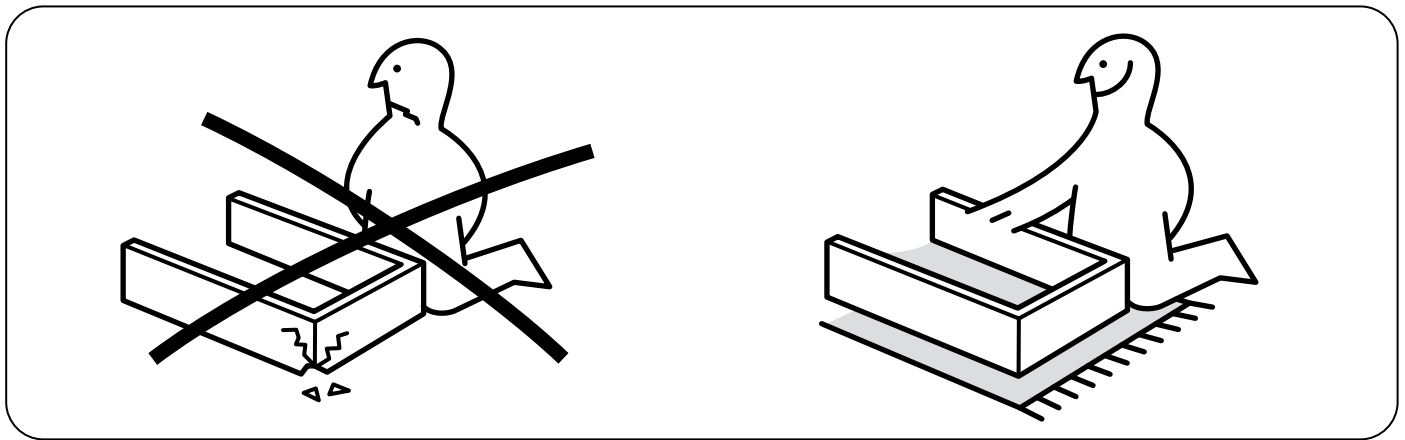
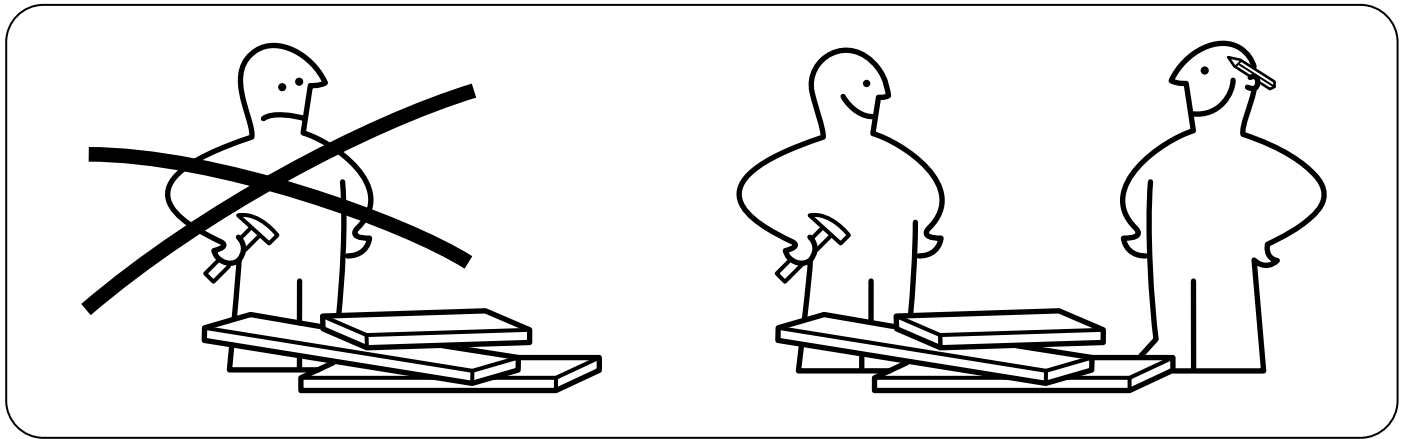
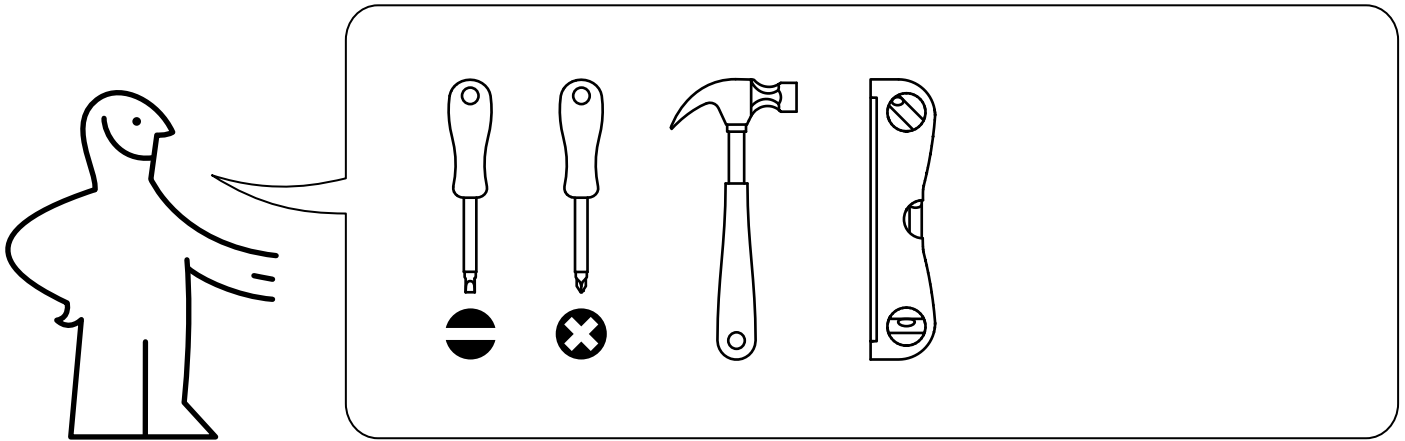

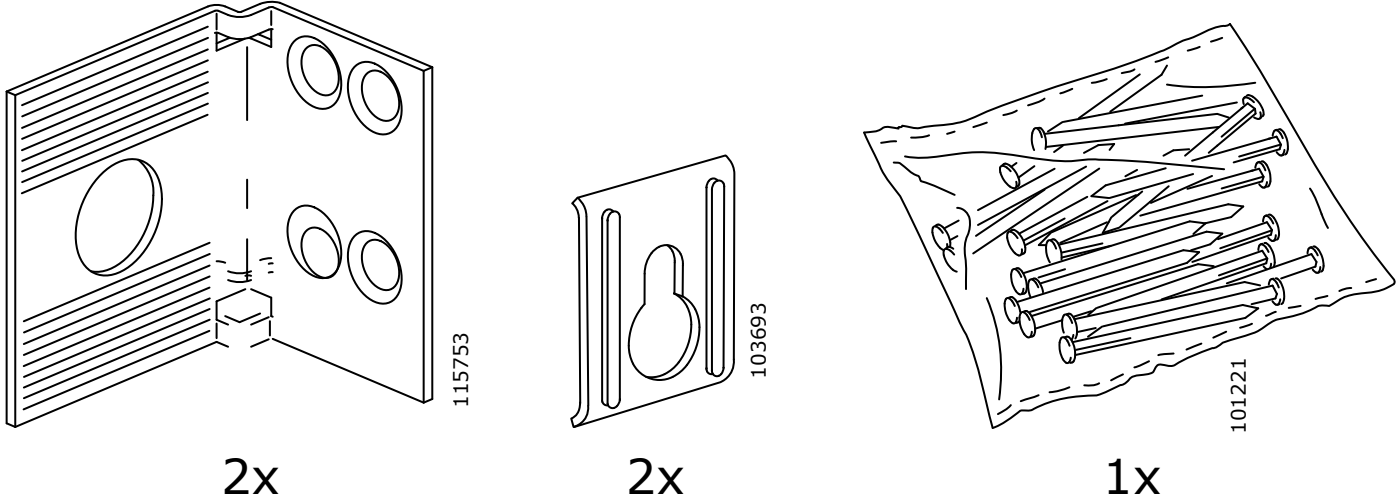
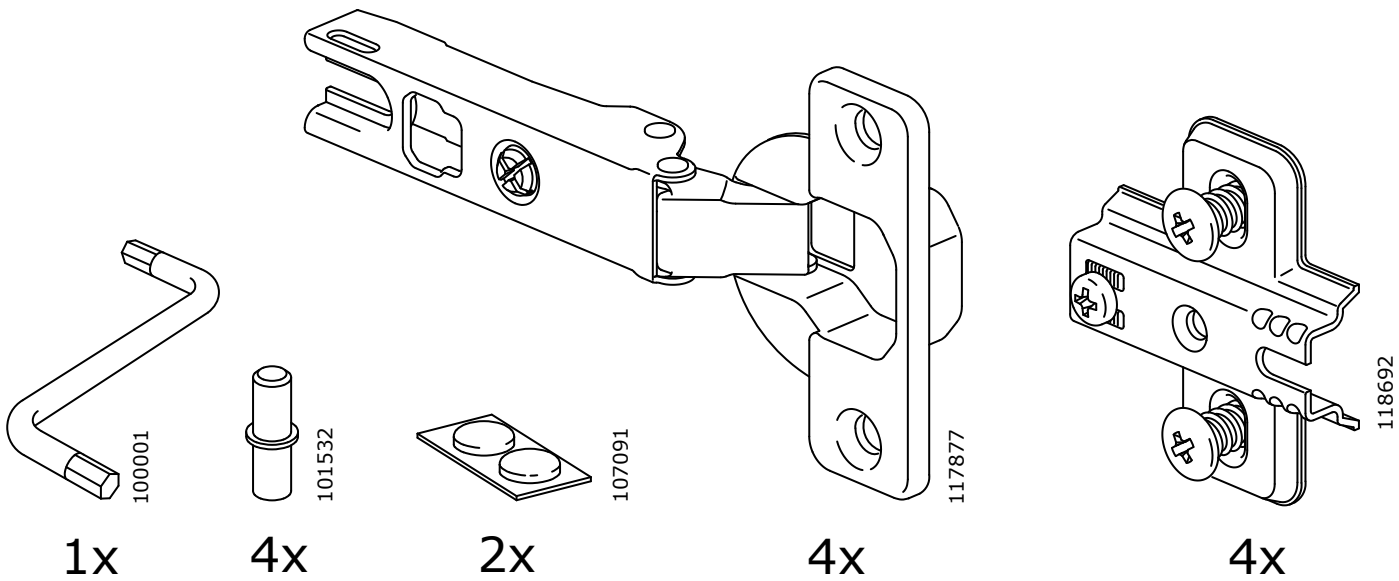
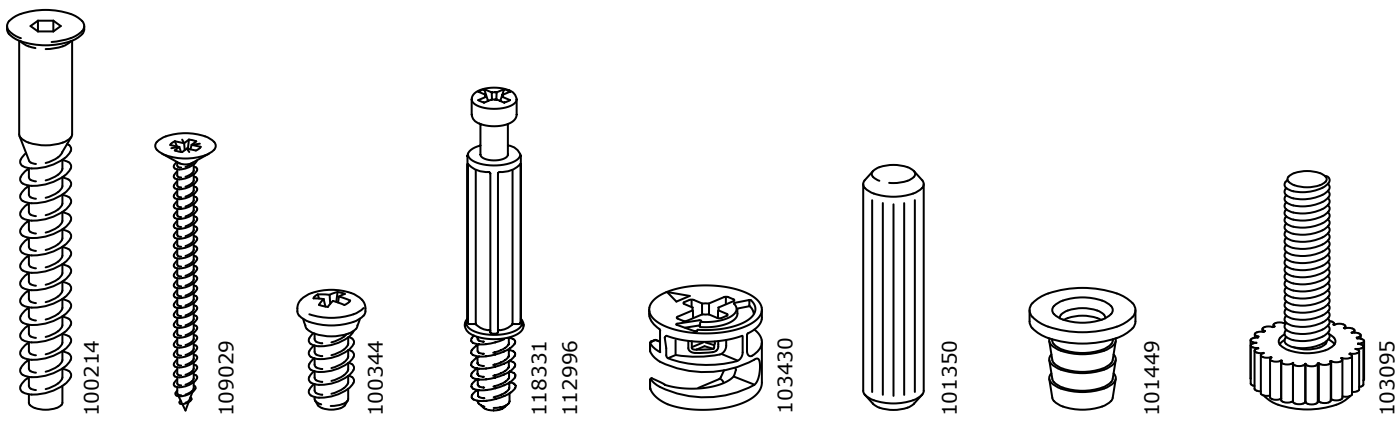
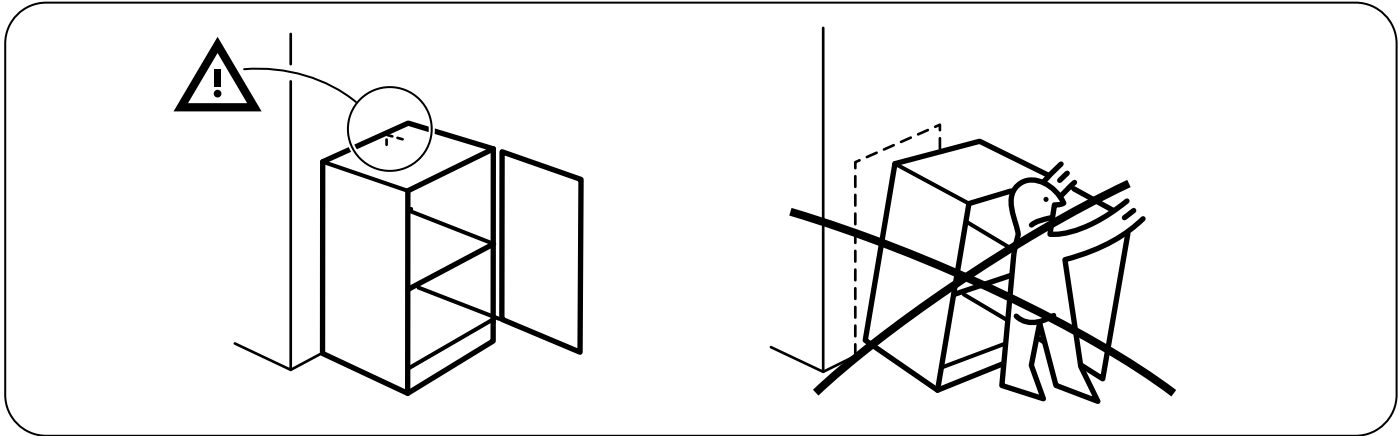

1

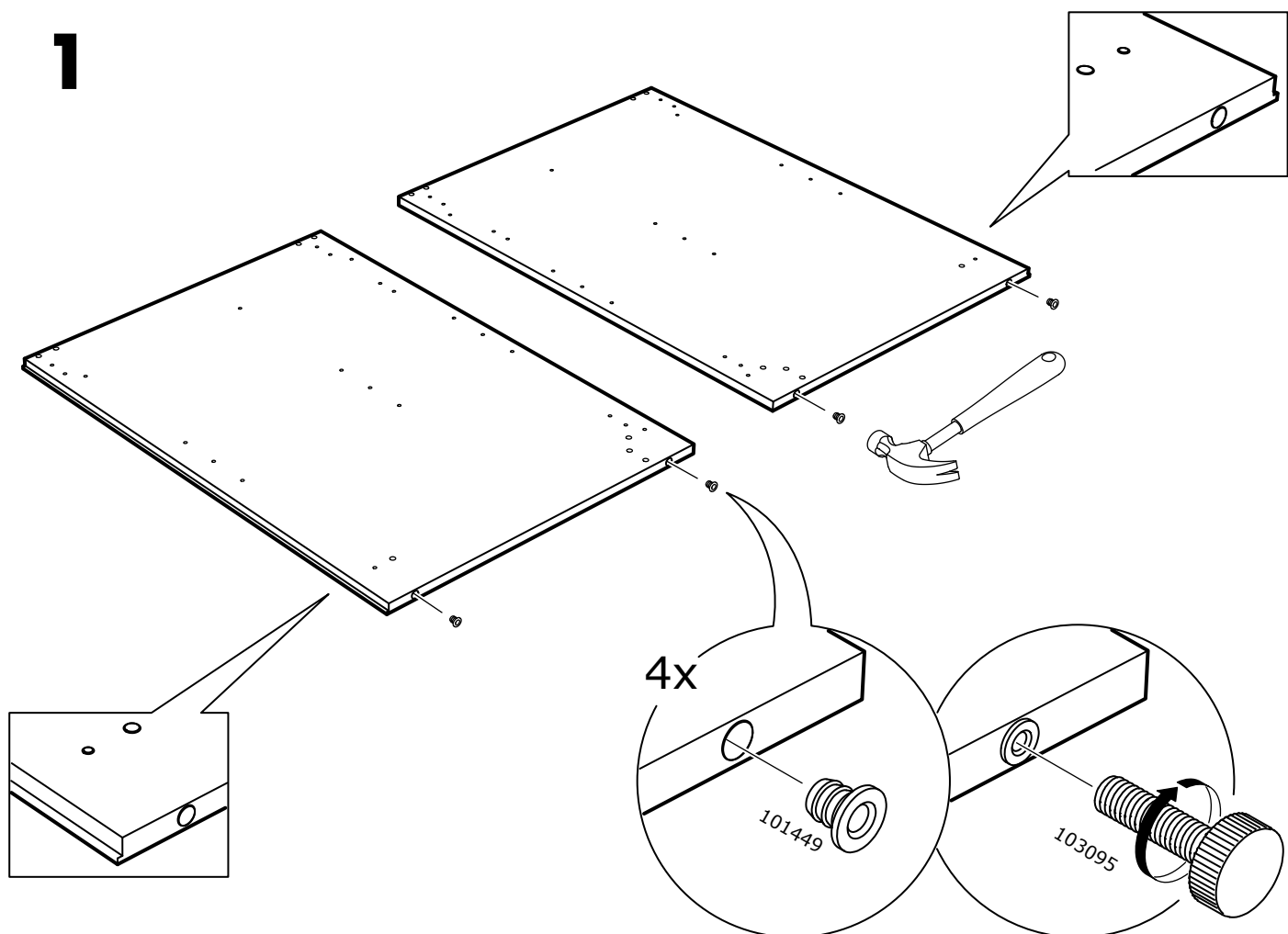

2

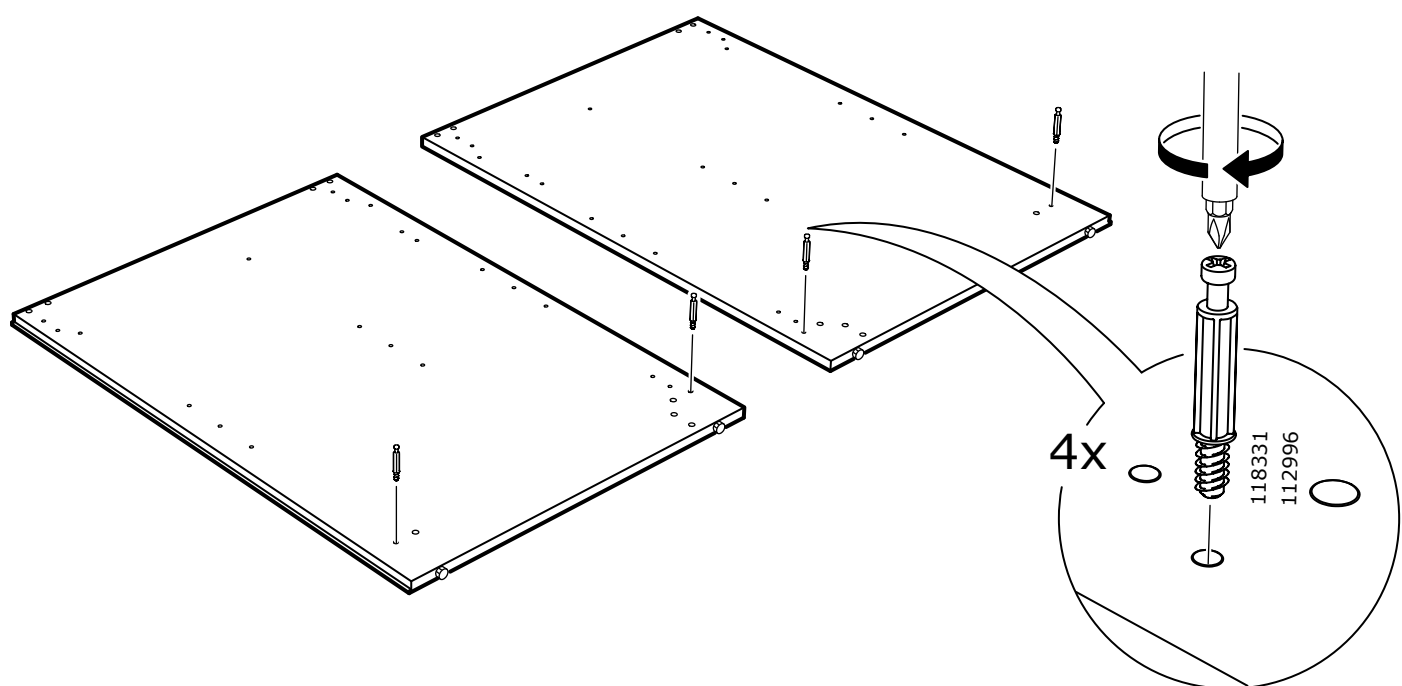

3

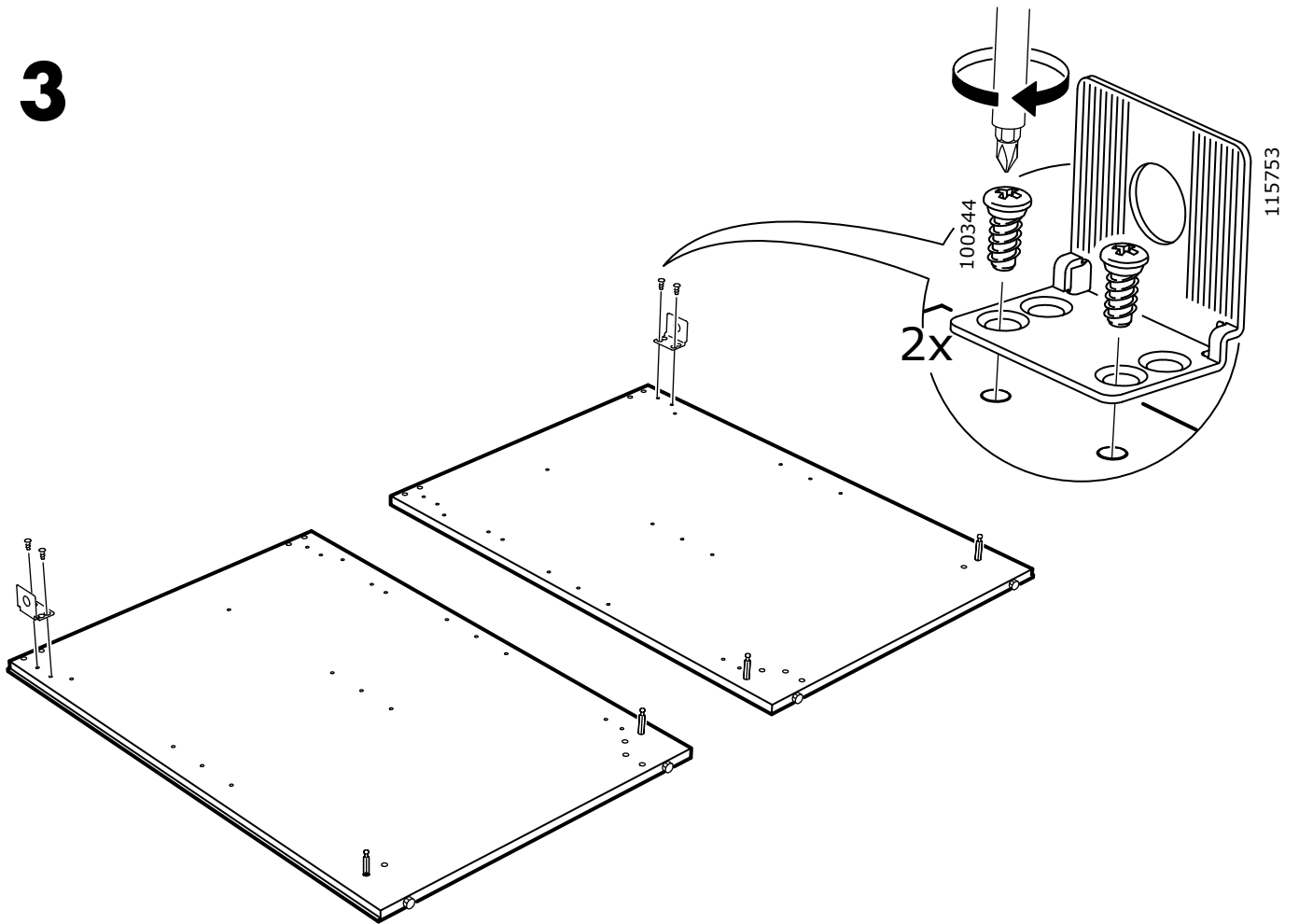

4

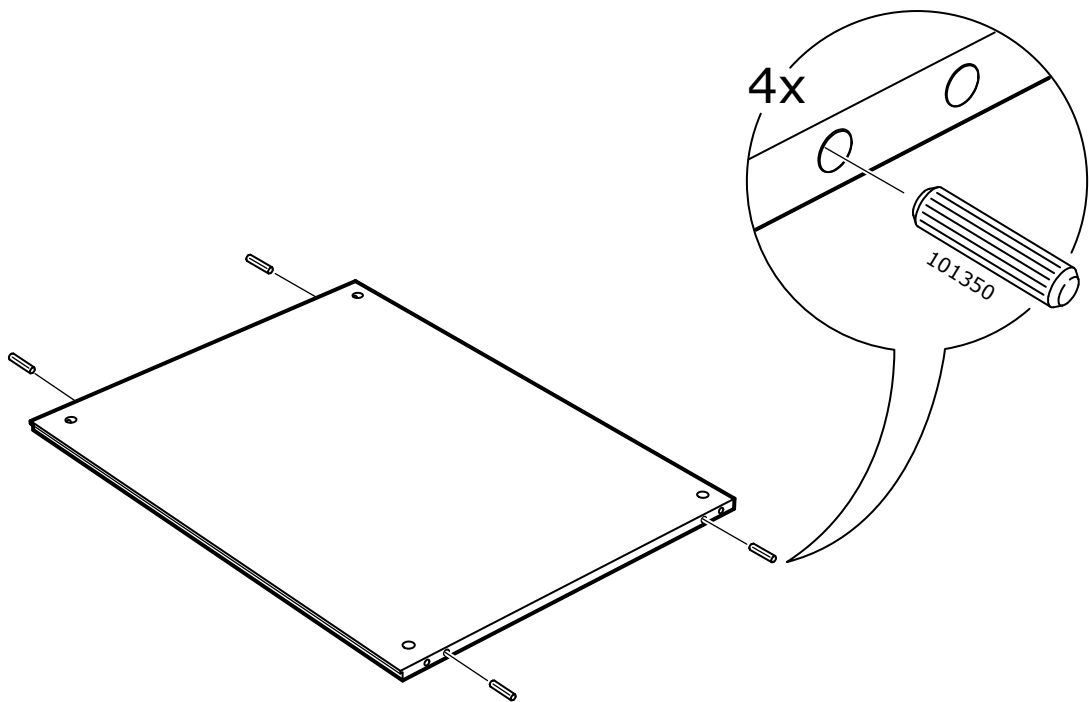

5

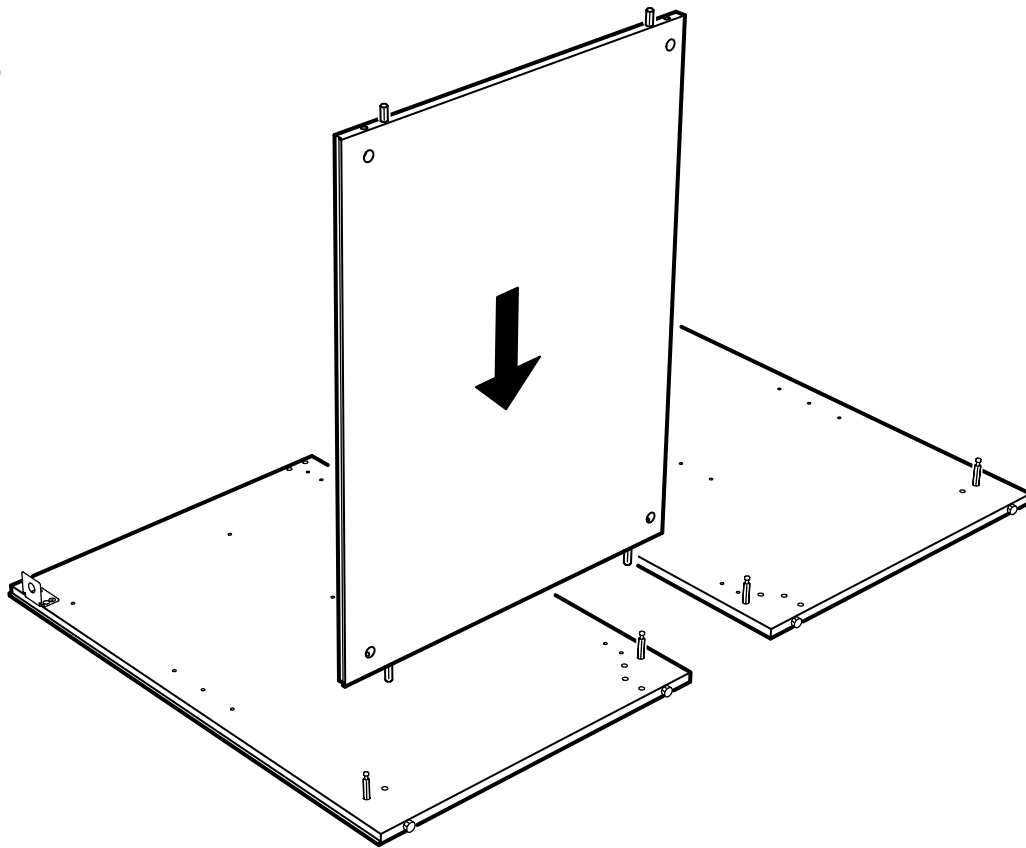

6

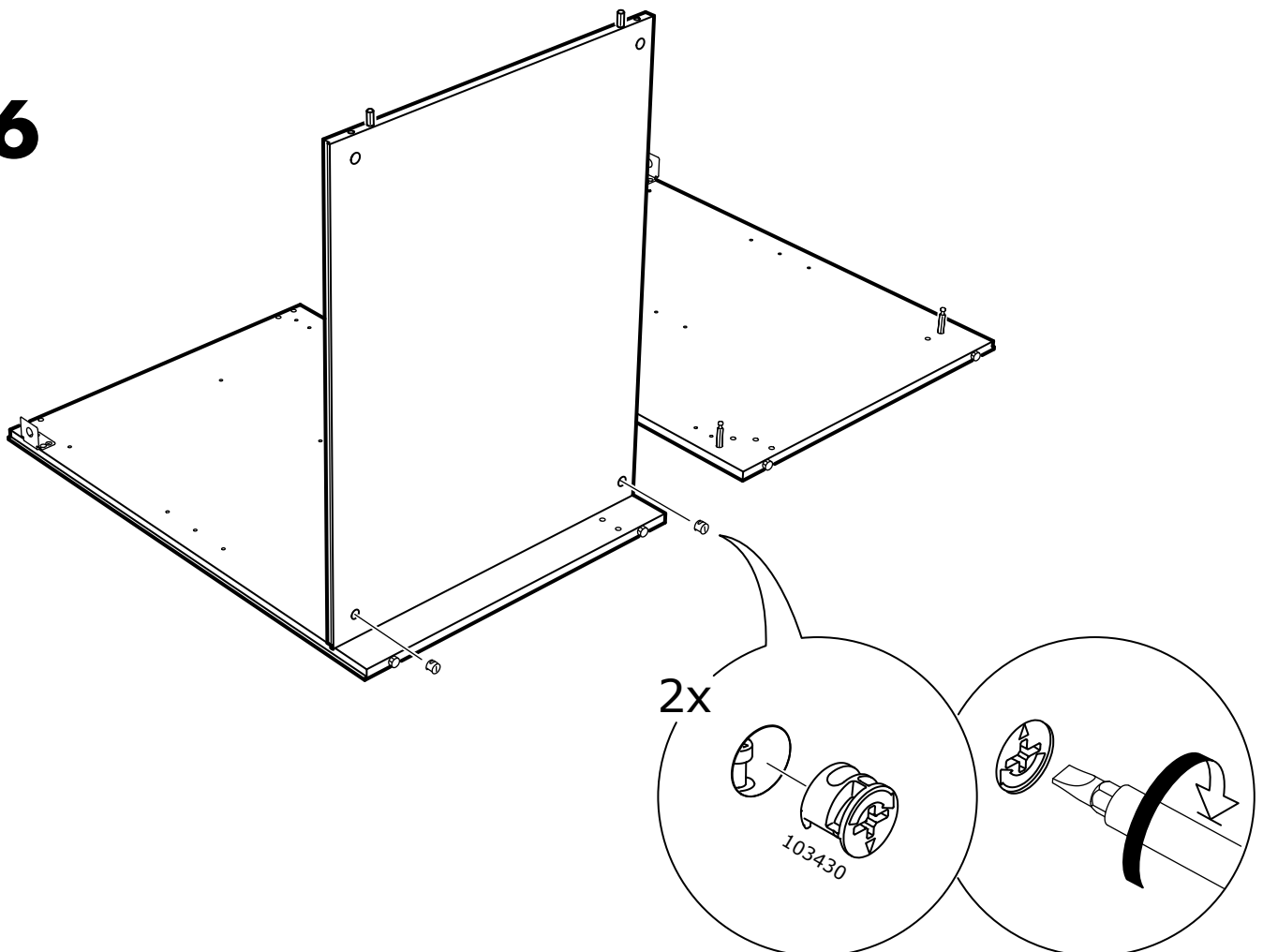

7

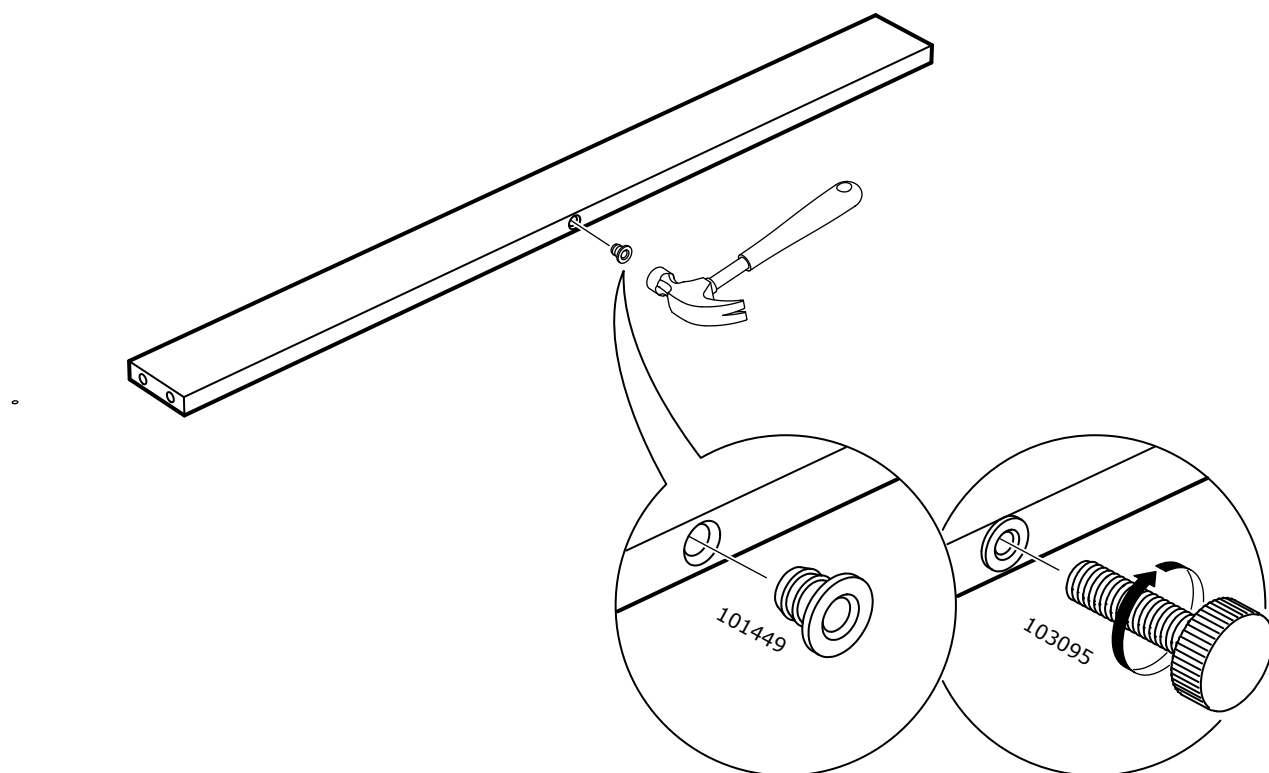

8

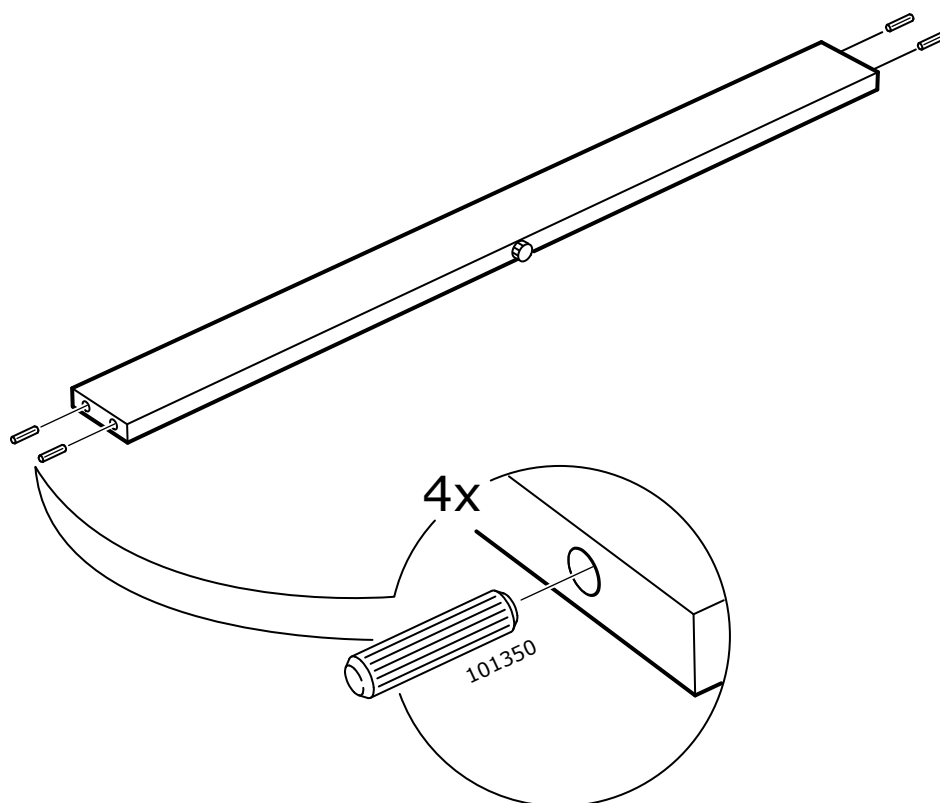



9

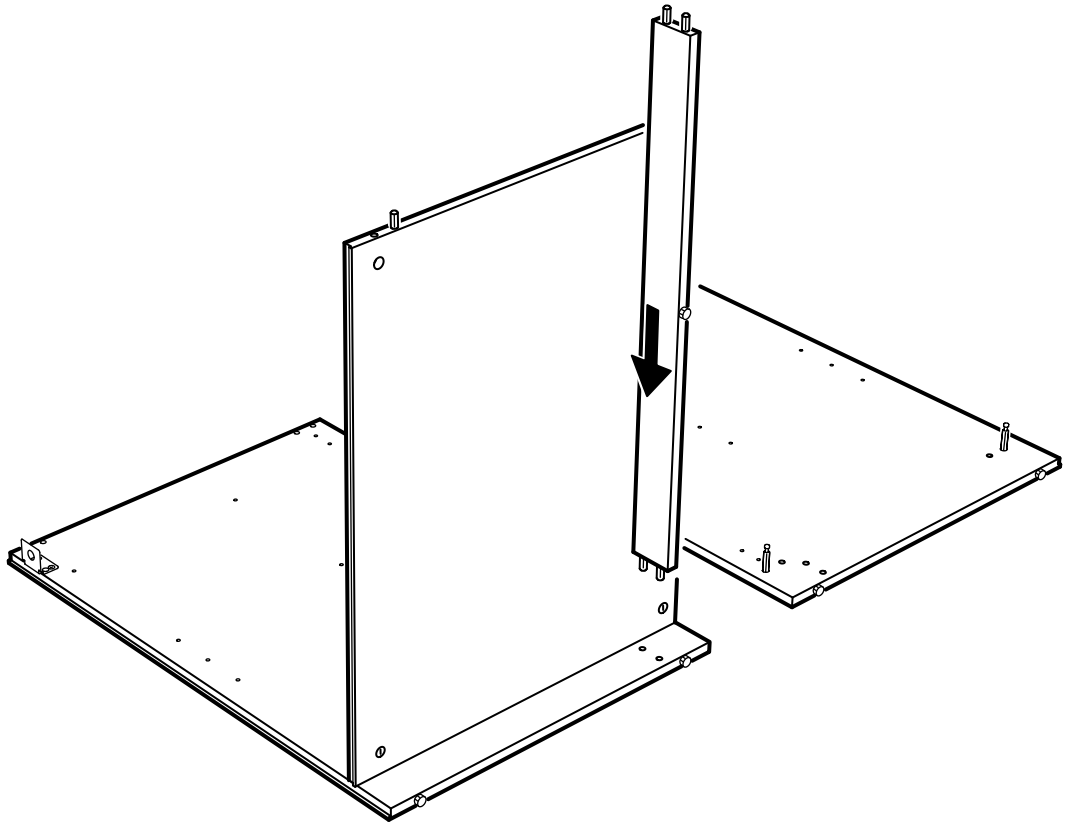

10

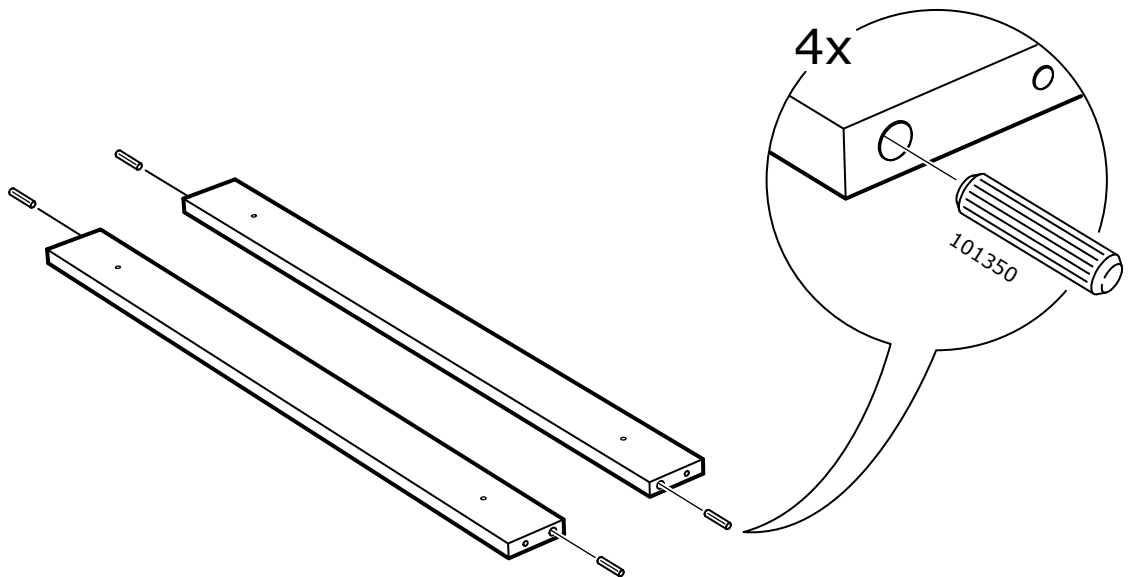

11

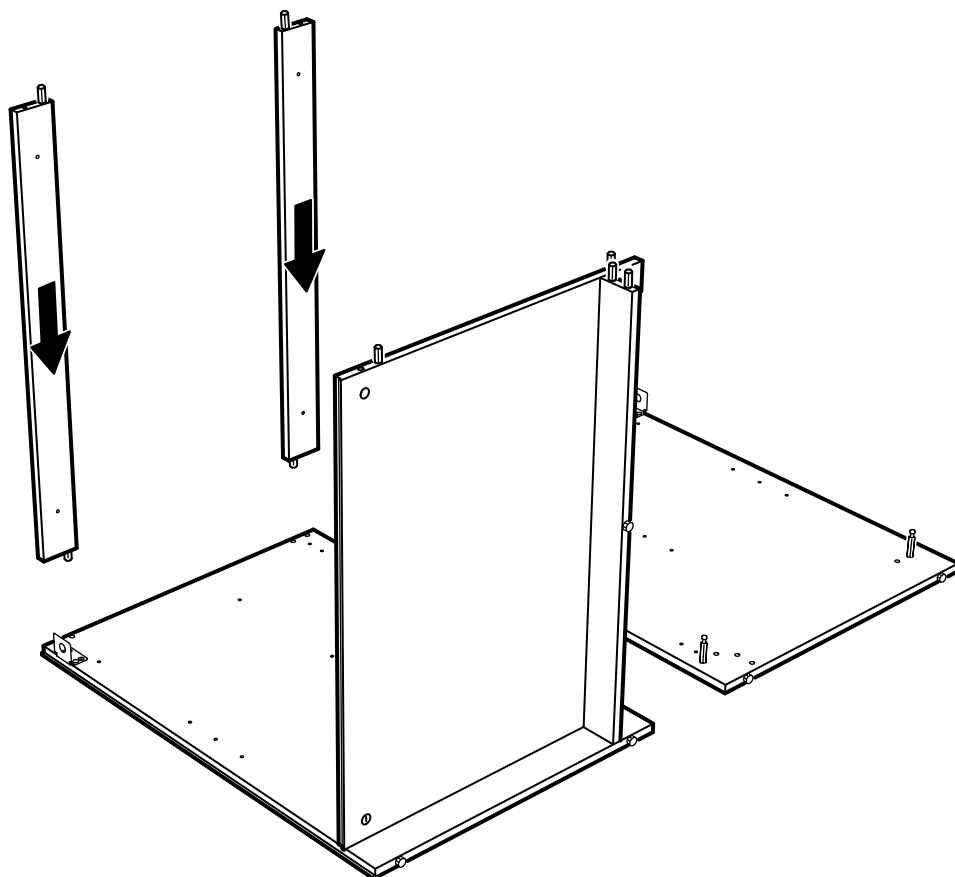

12

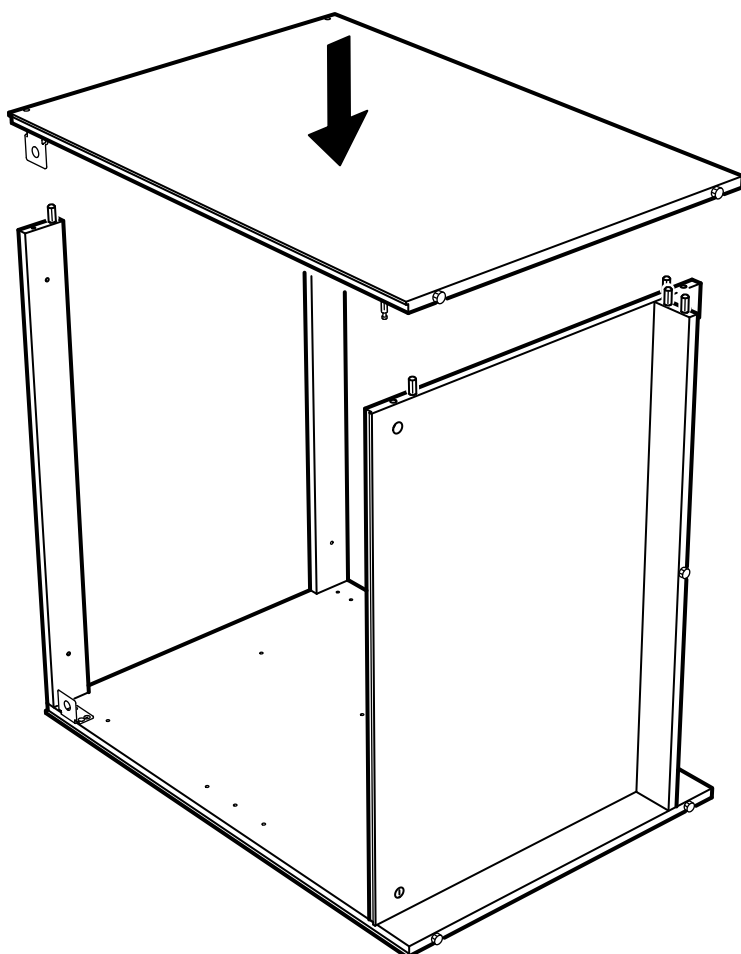

# 13

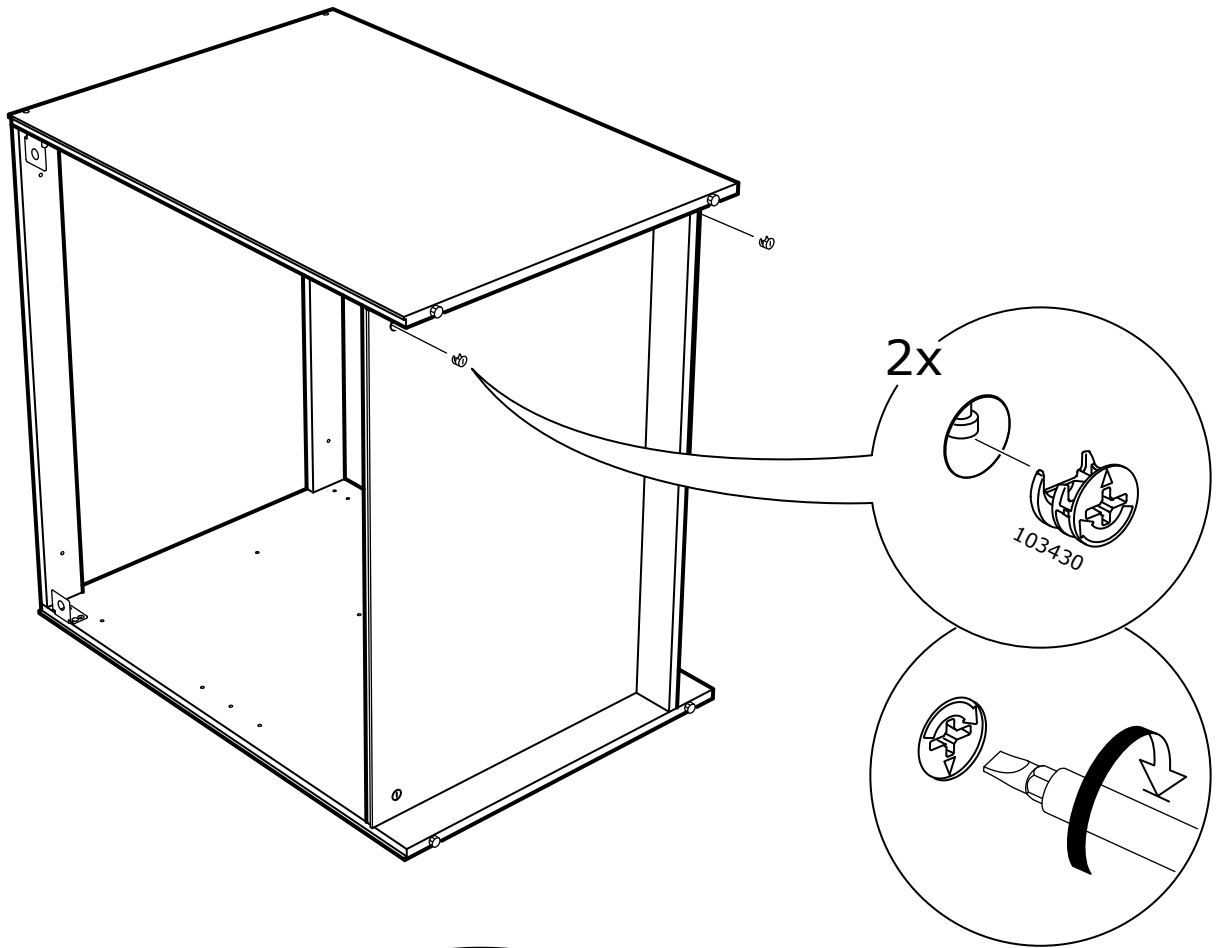

# 14

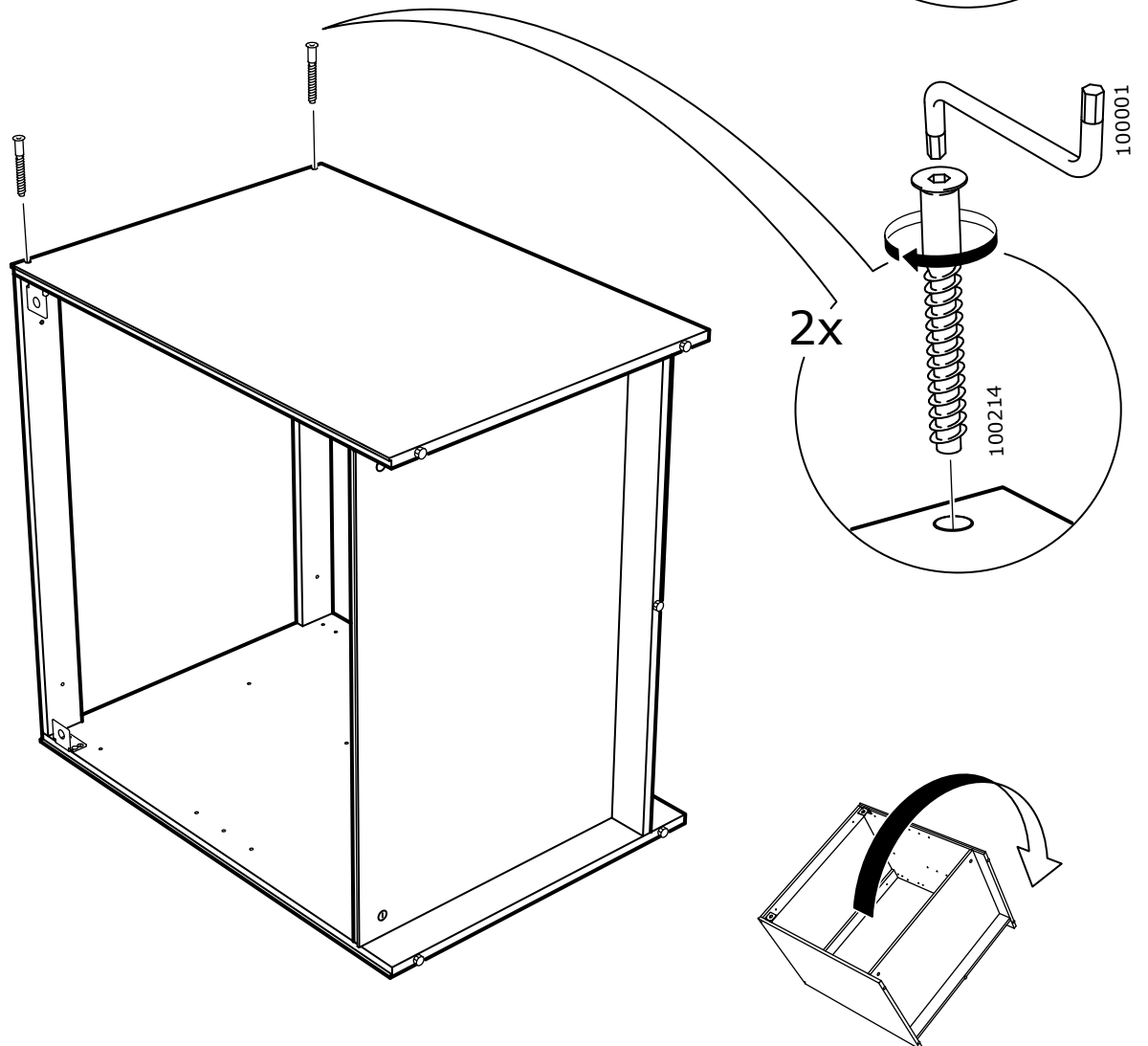

# 15

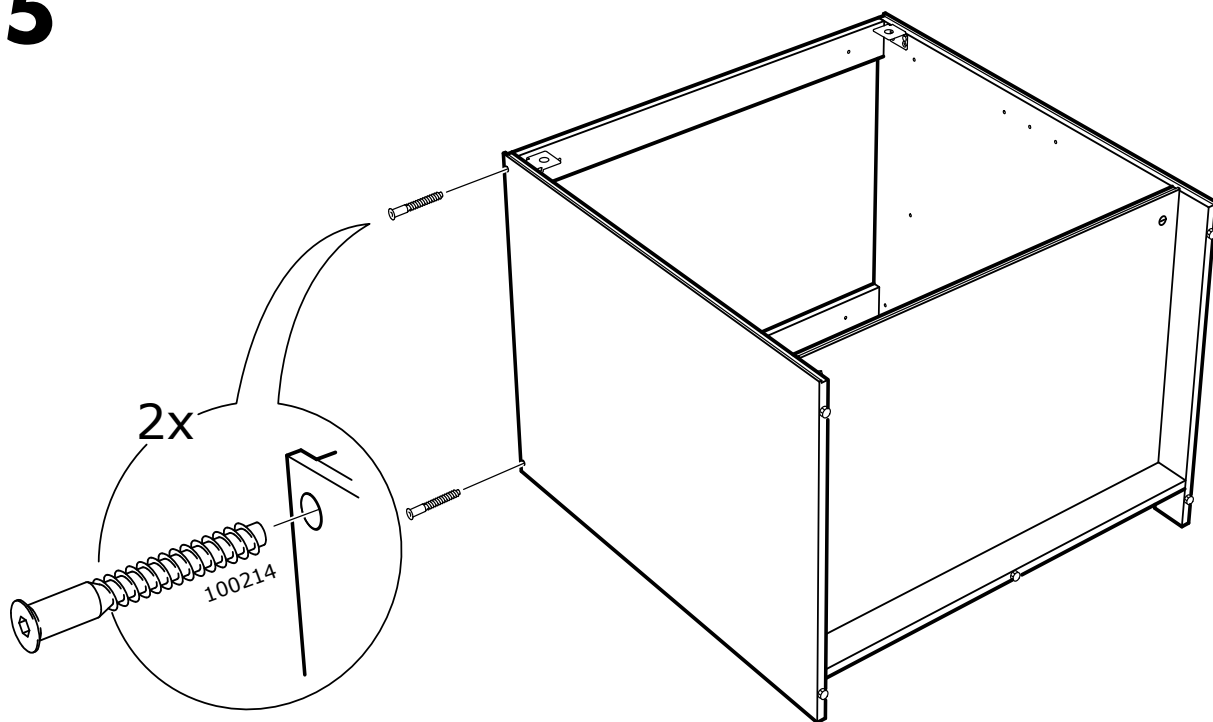

# 16

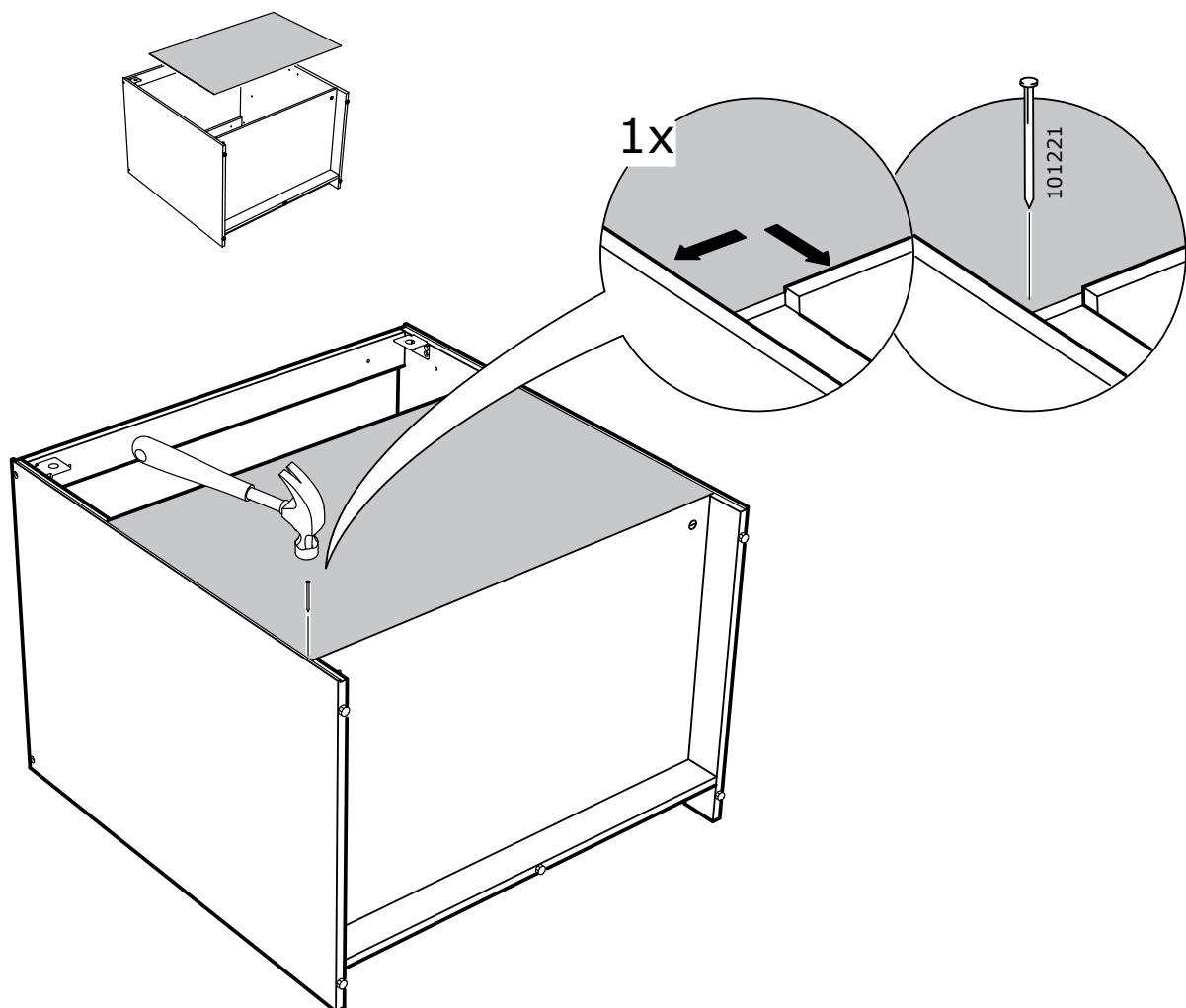

# 17

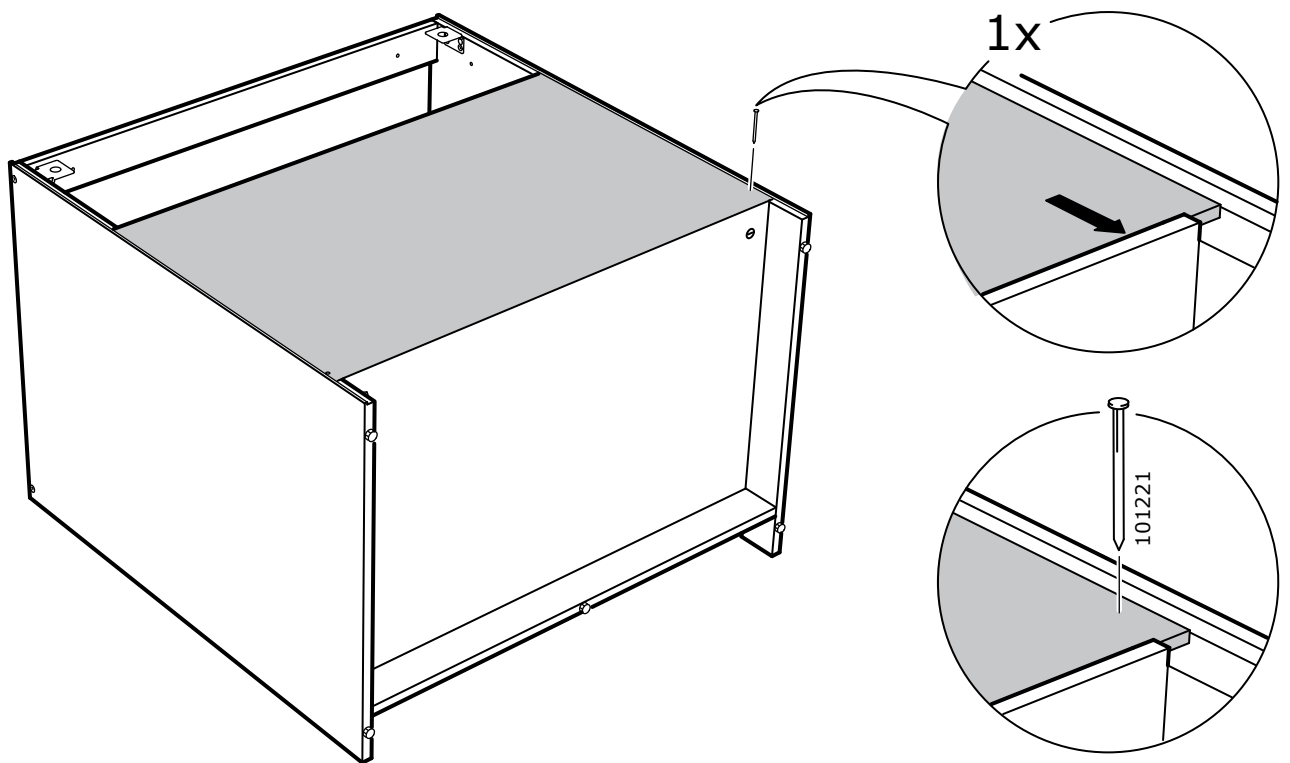

# 18

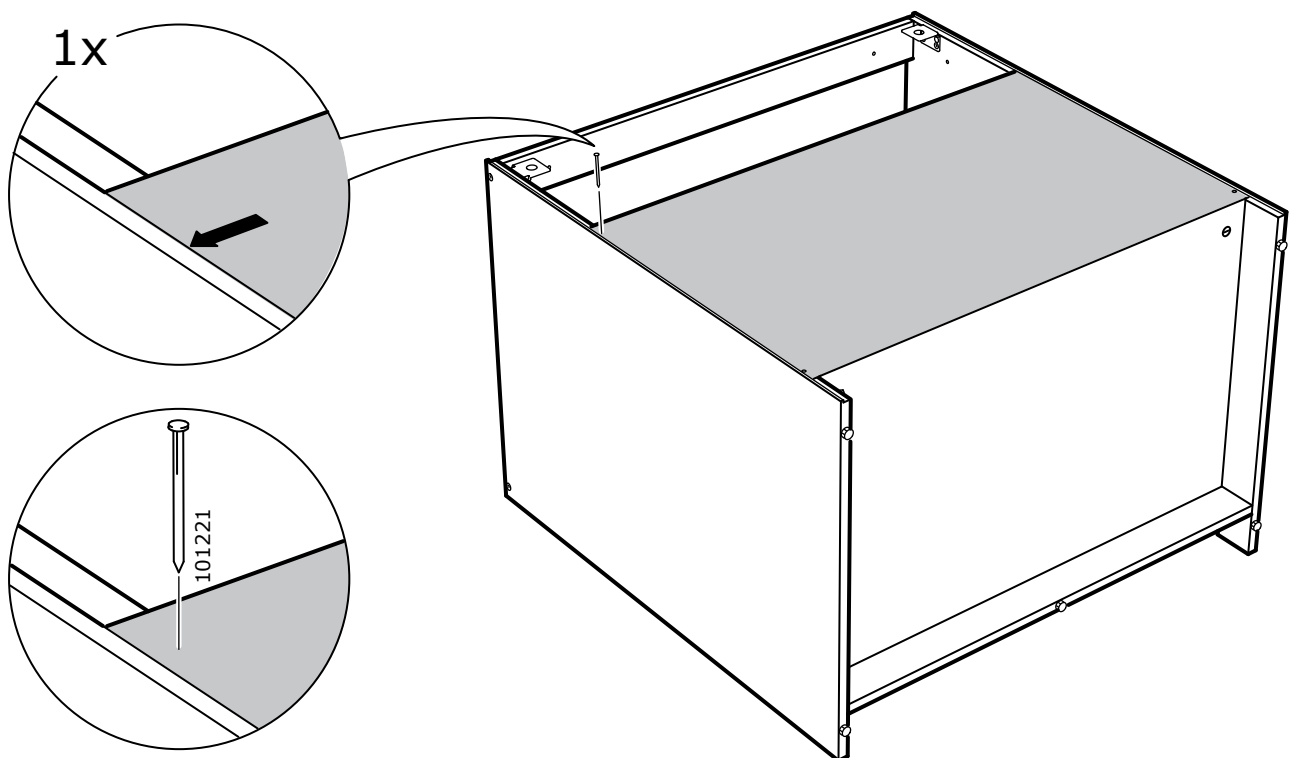

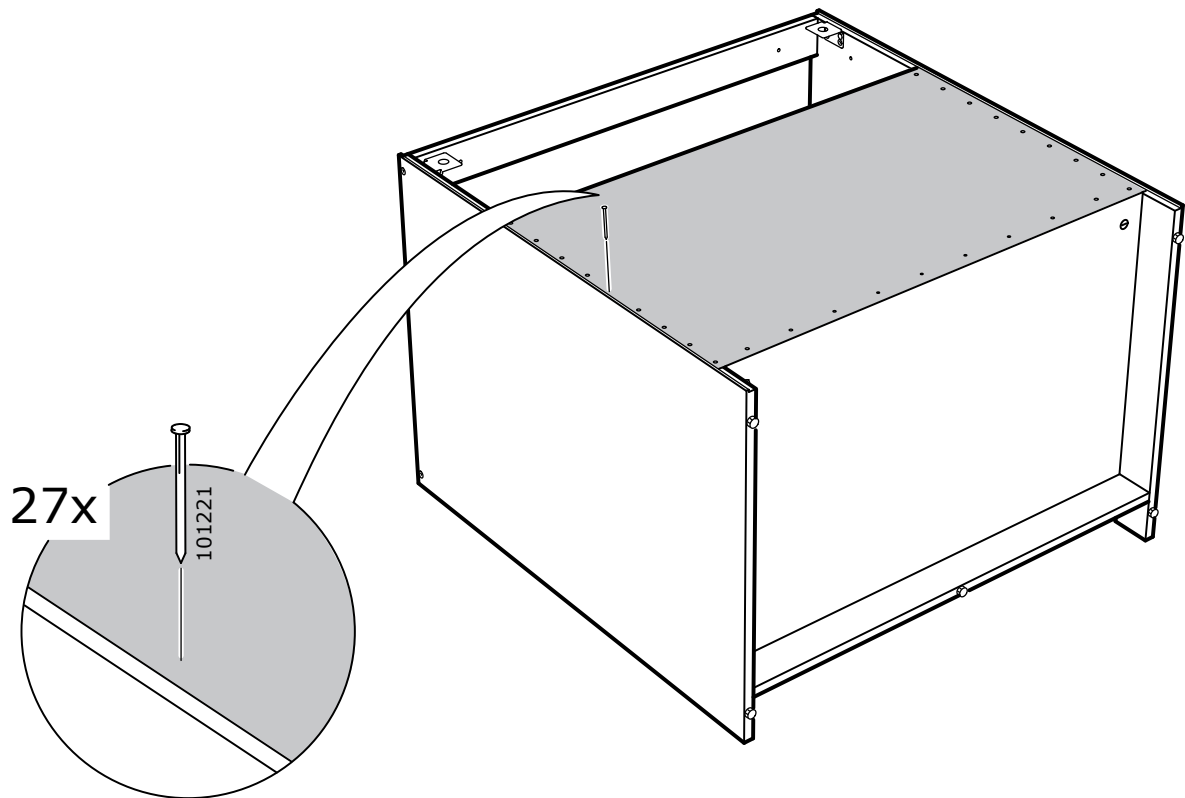

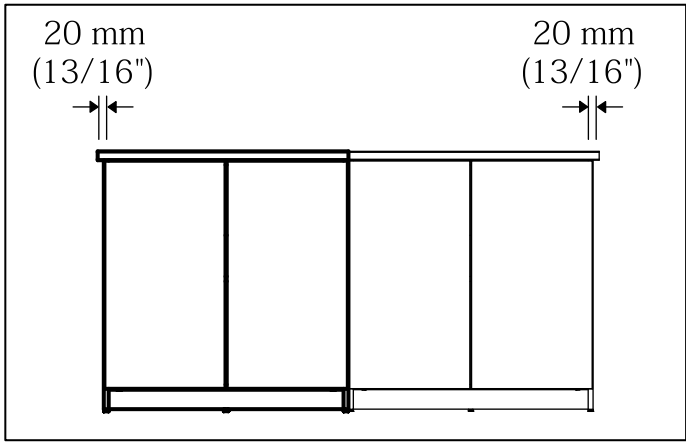
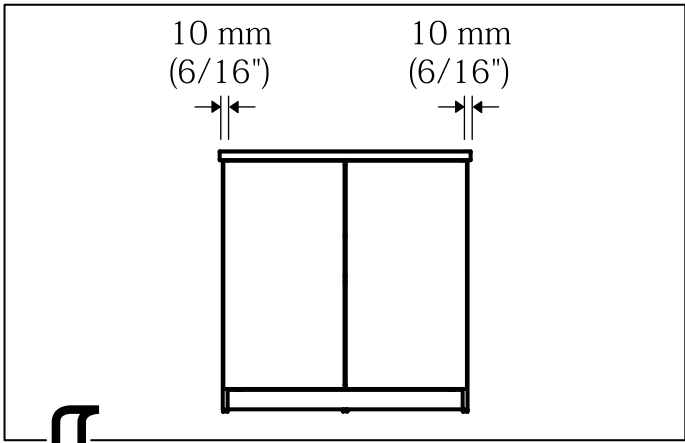

⇓  
**20**

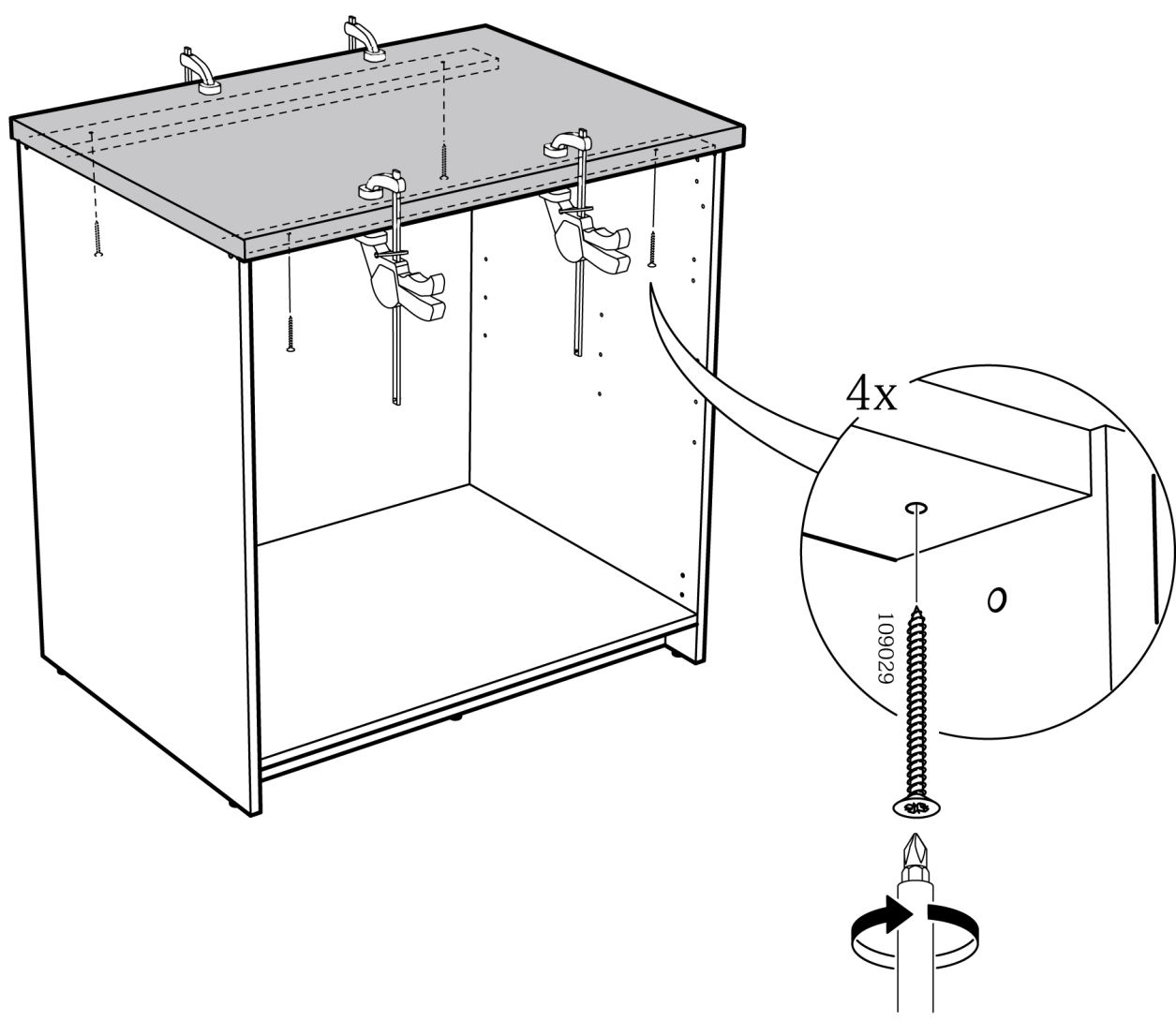

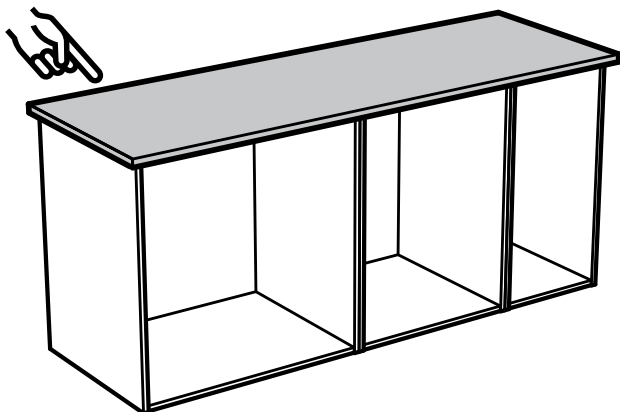

**English**

Sold separately.

**日本語**

別売り。

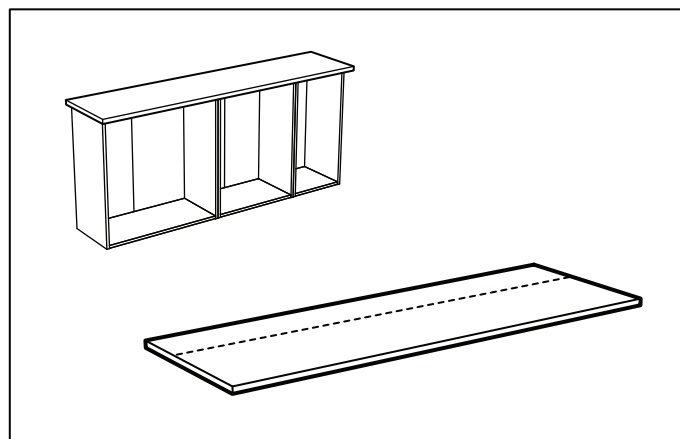
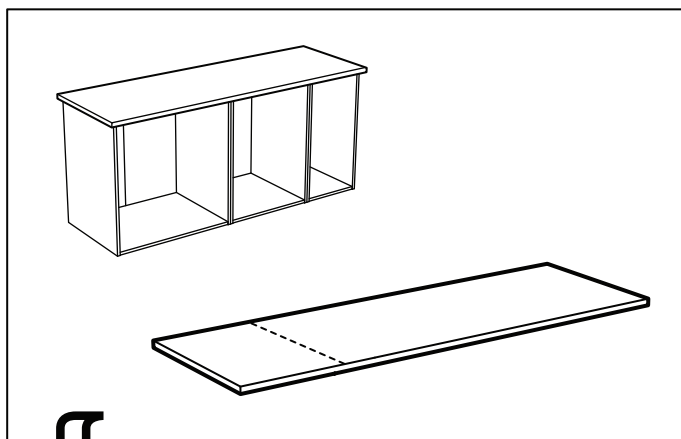

**1**

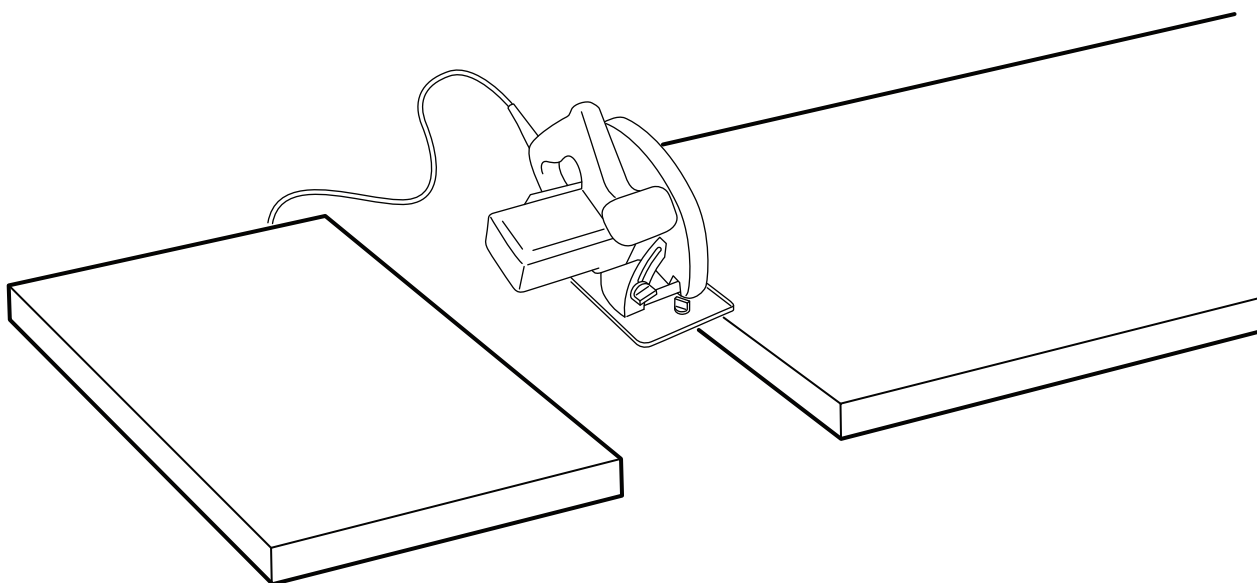

**English**

It is important to saw the worktop straight.  
If uncertain contact your local specialized dealer.

**日本語**

ワークトップは必ずまっすぐにカットしてください。  
ご不明な点は、お近くの専門店にご相談ください。



2

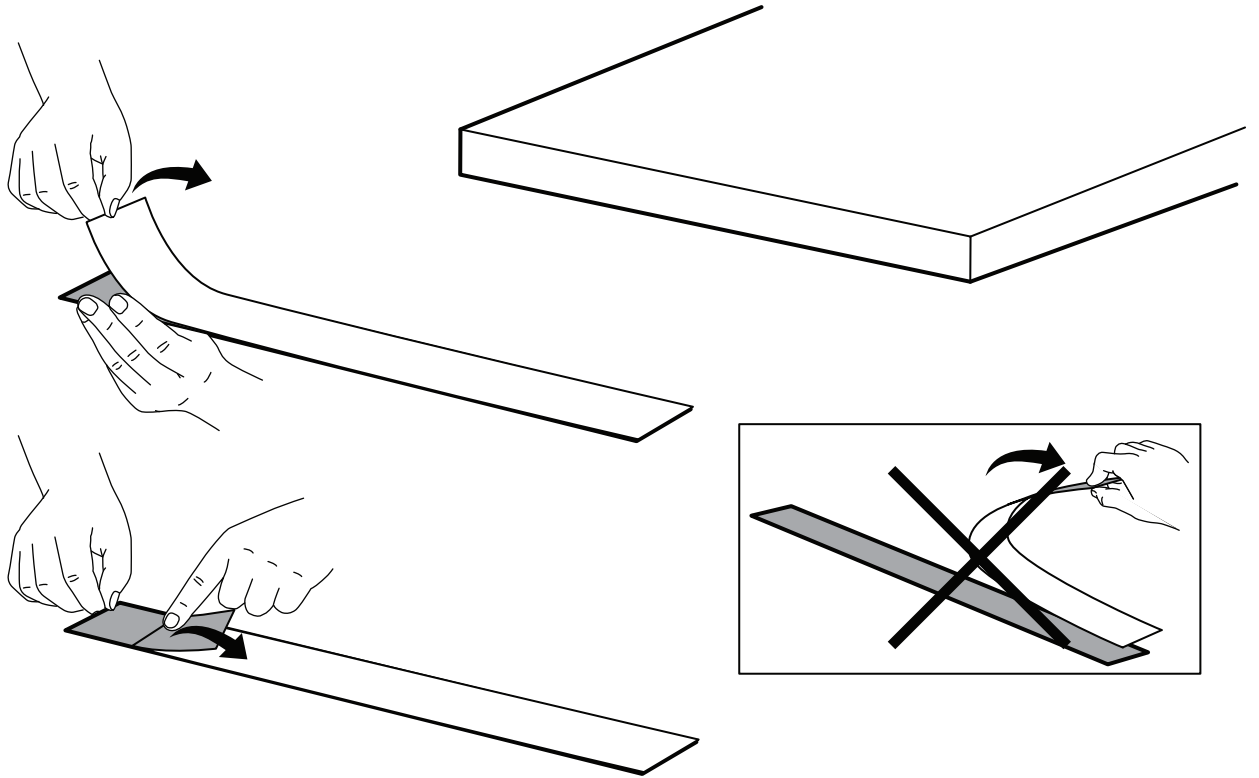

3

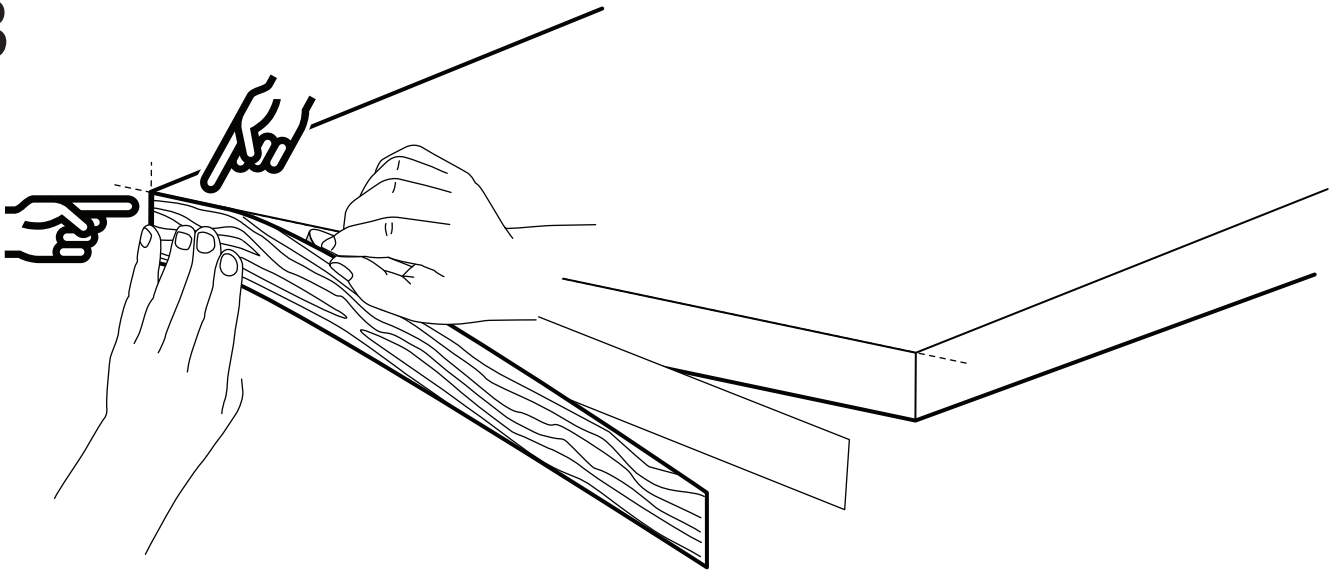

4

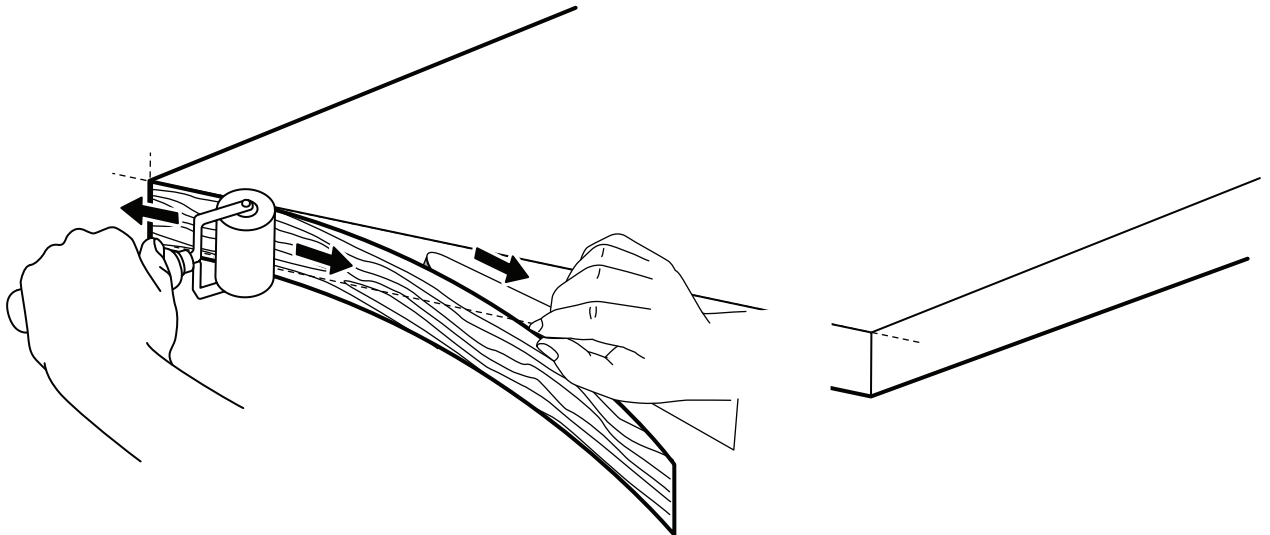

5

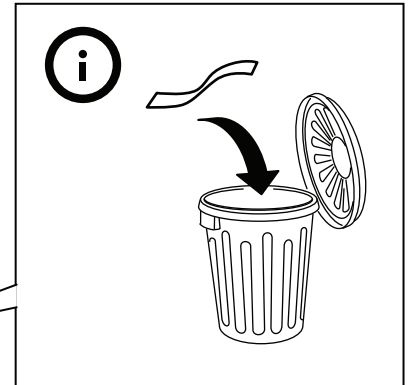
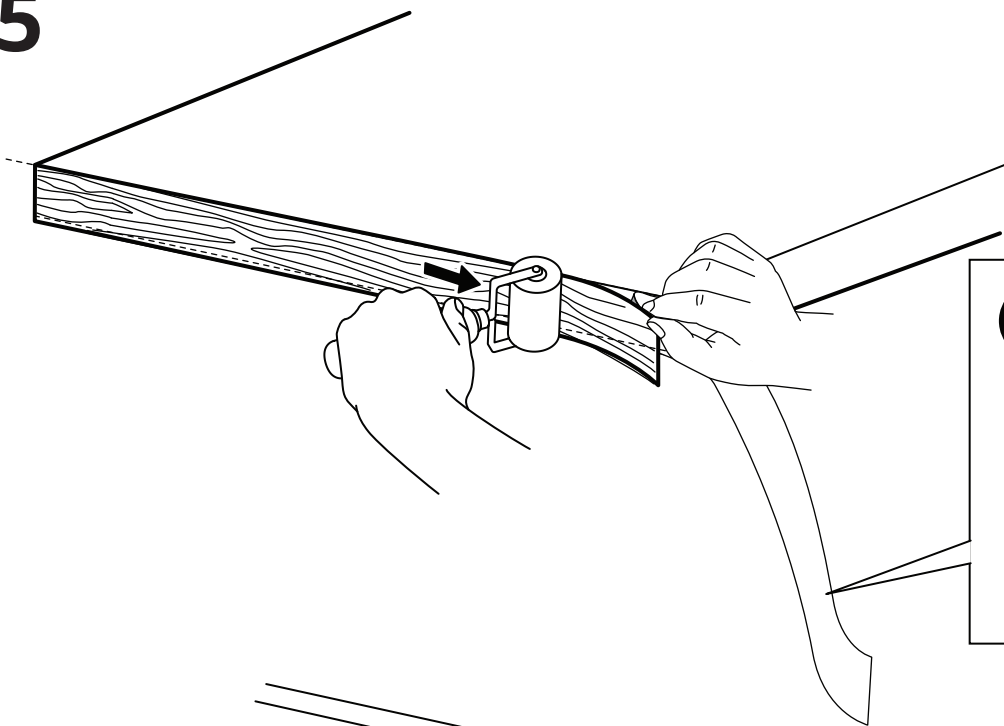

6

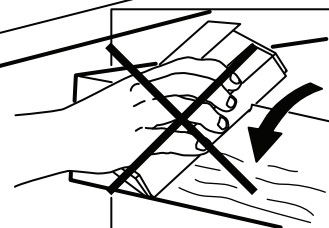
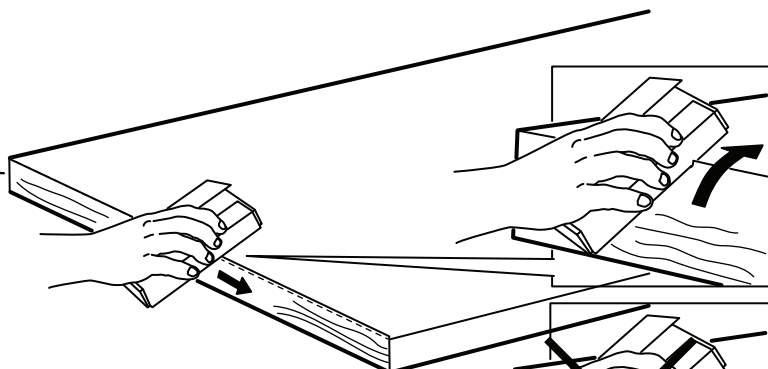
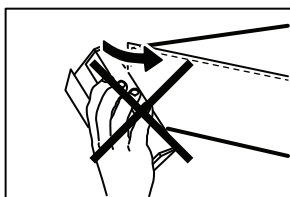
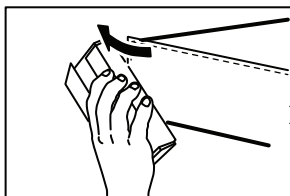
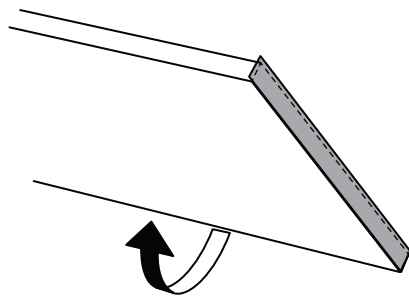

**English**  
NOTE! Oil is not included.

**日本語**  
注意！本製品にオイルは含まれていません。

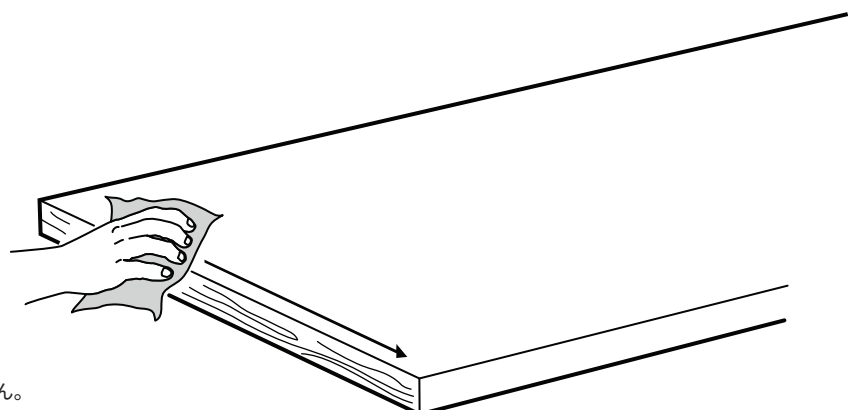

21

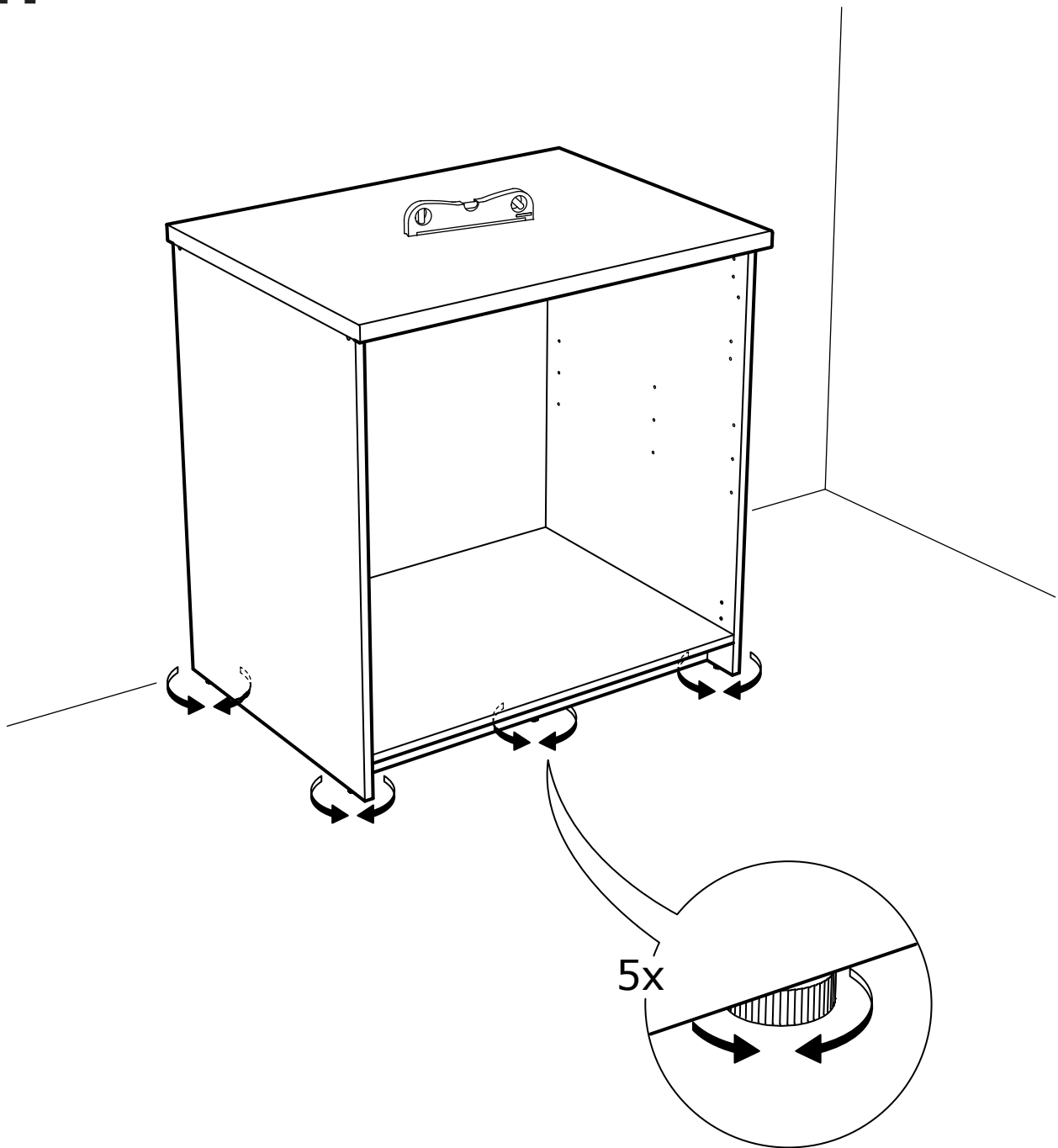

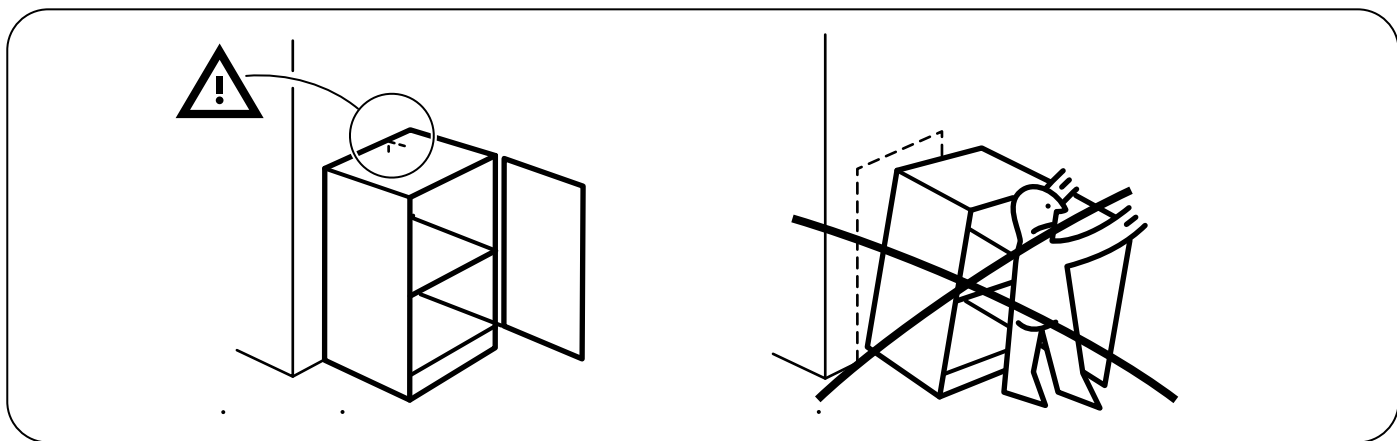

22

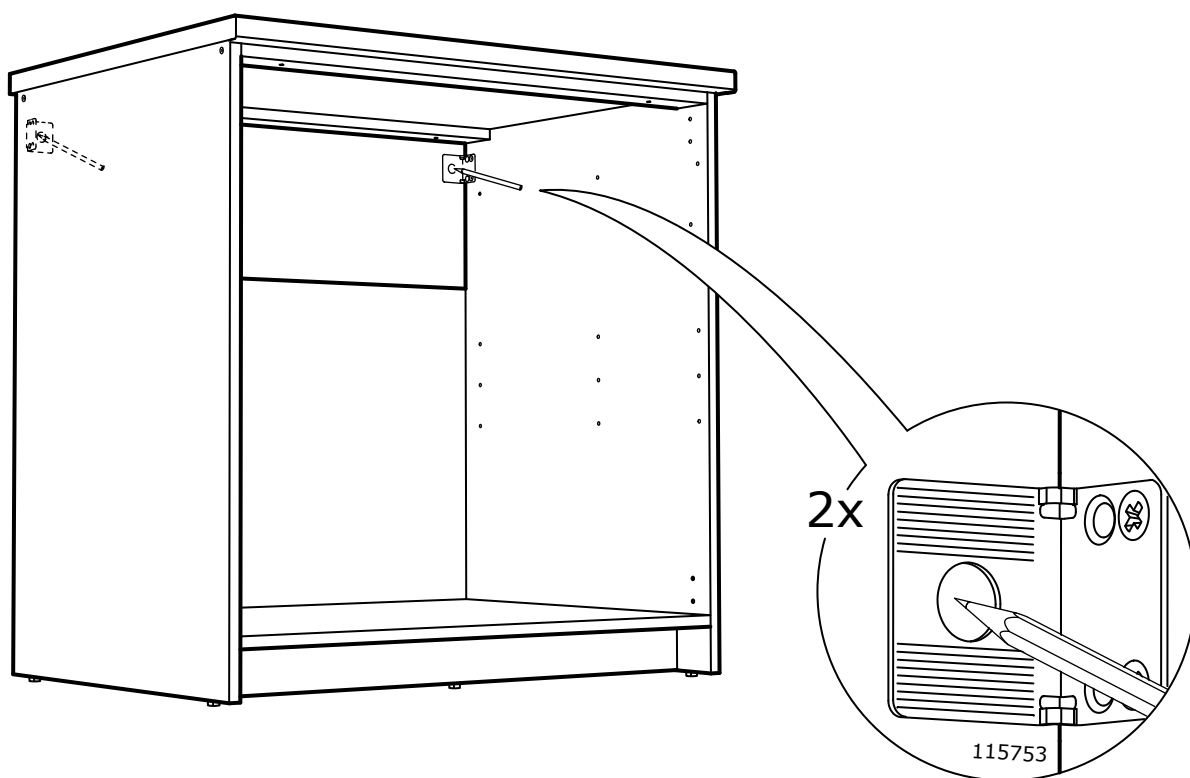

# 23

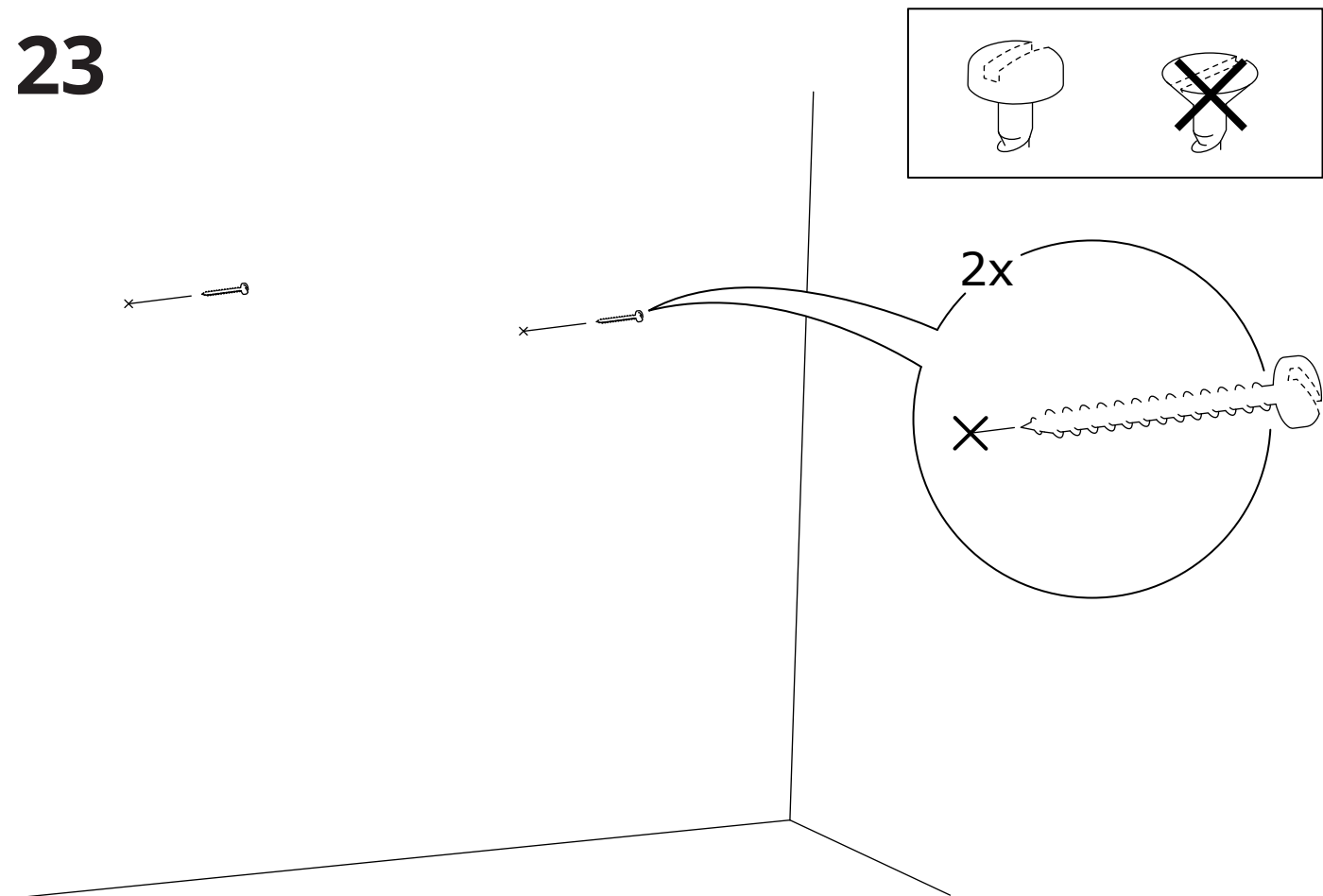

# 24

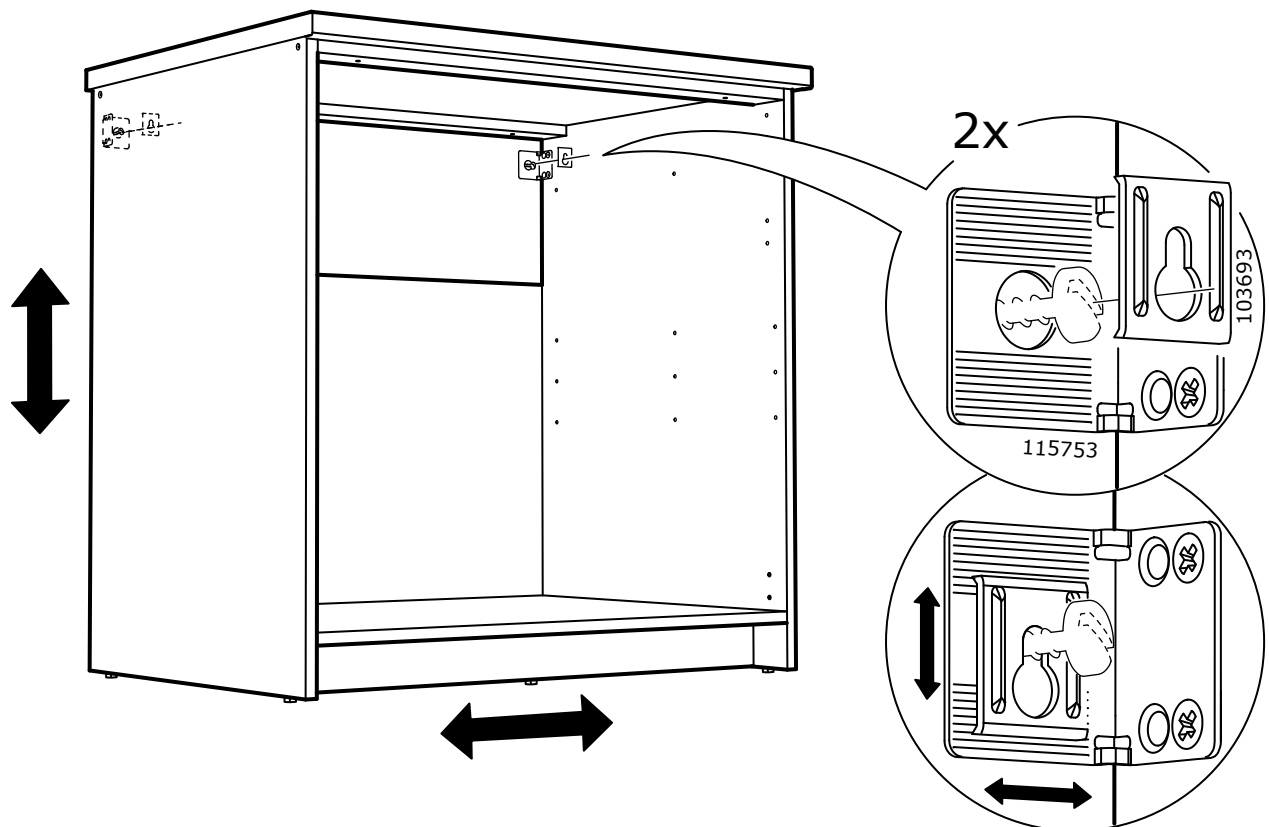

# 25

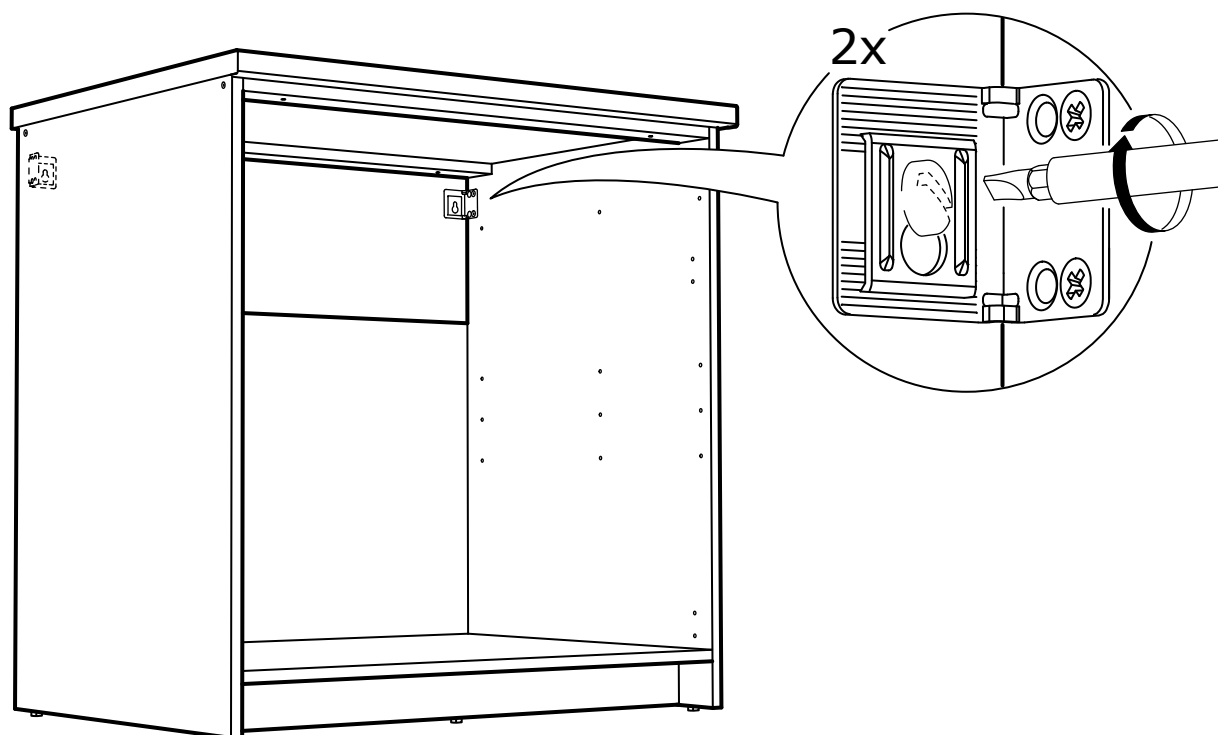

# 26

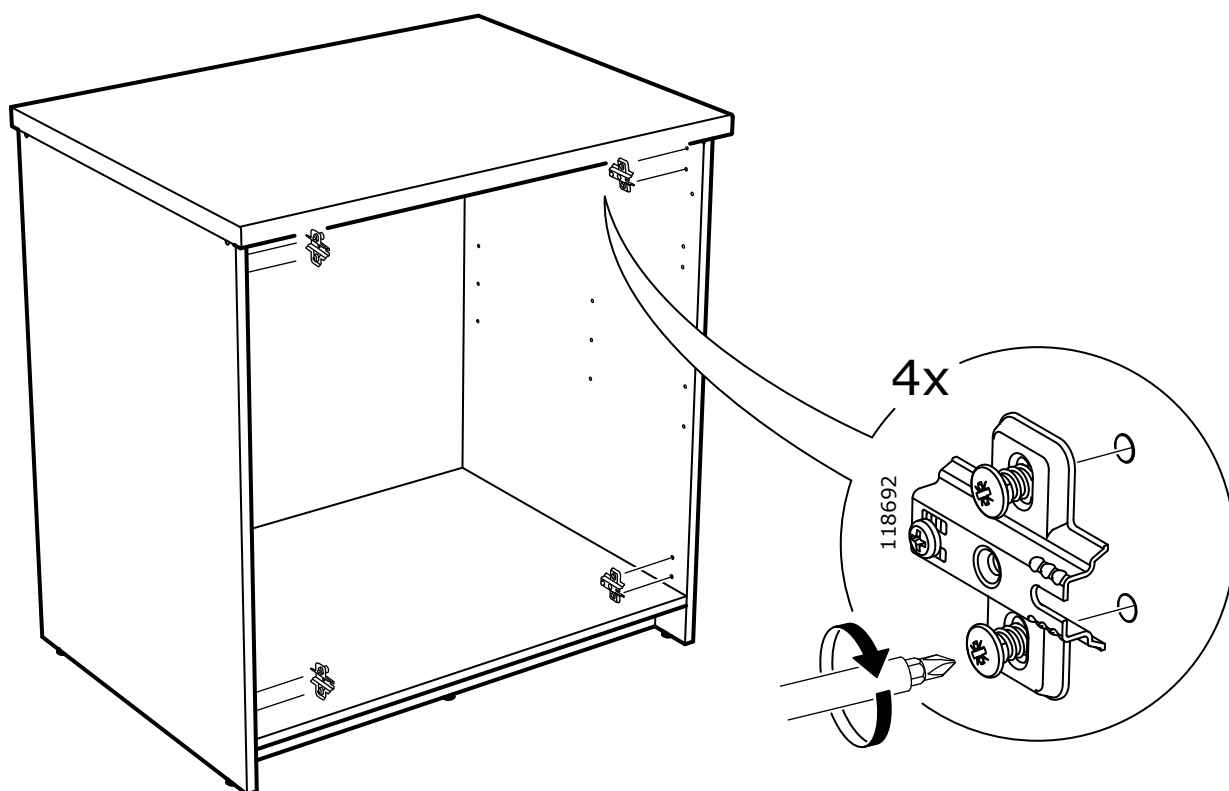

# 27

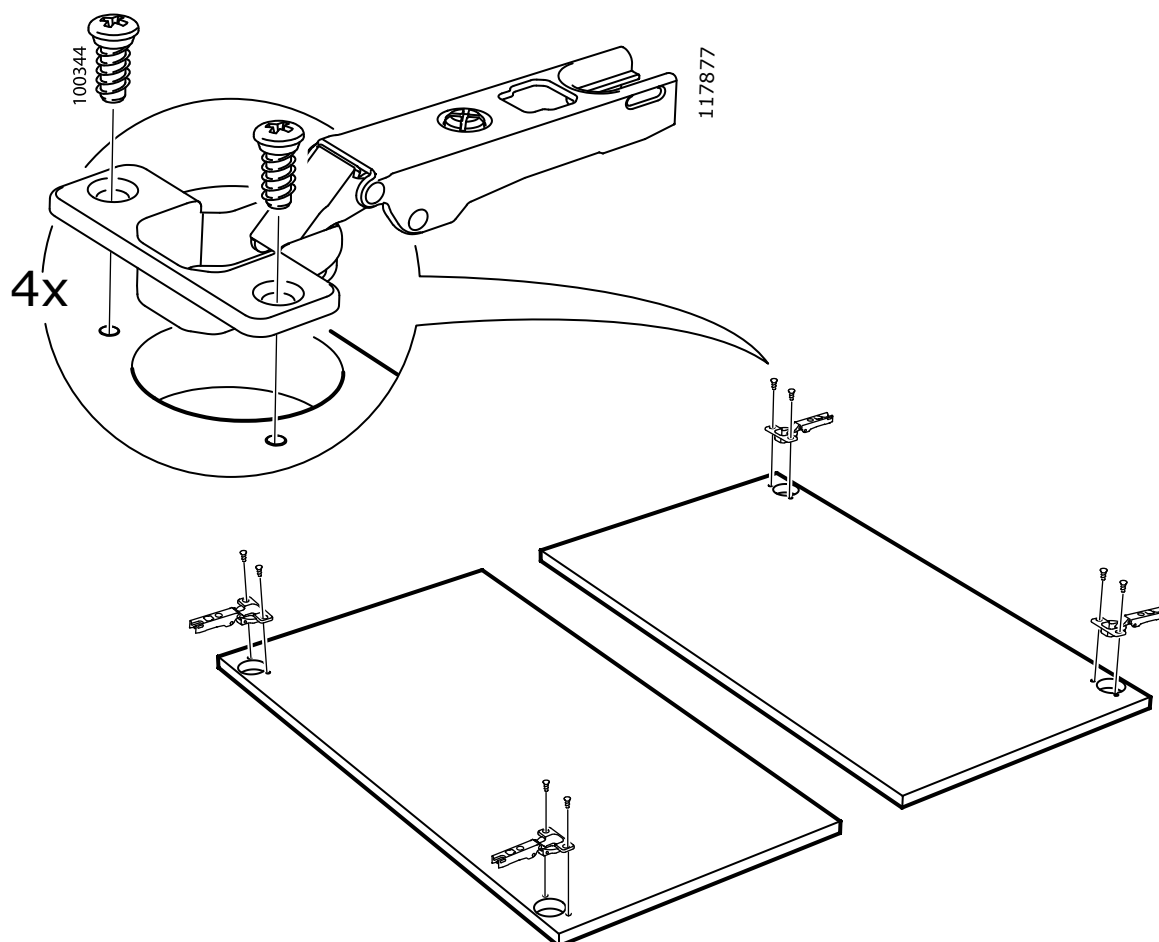

# 28

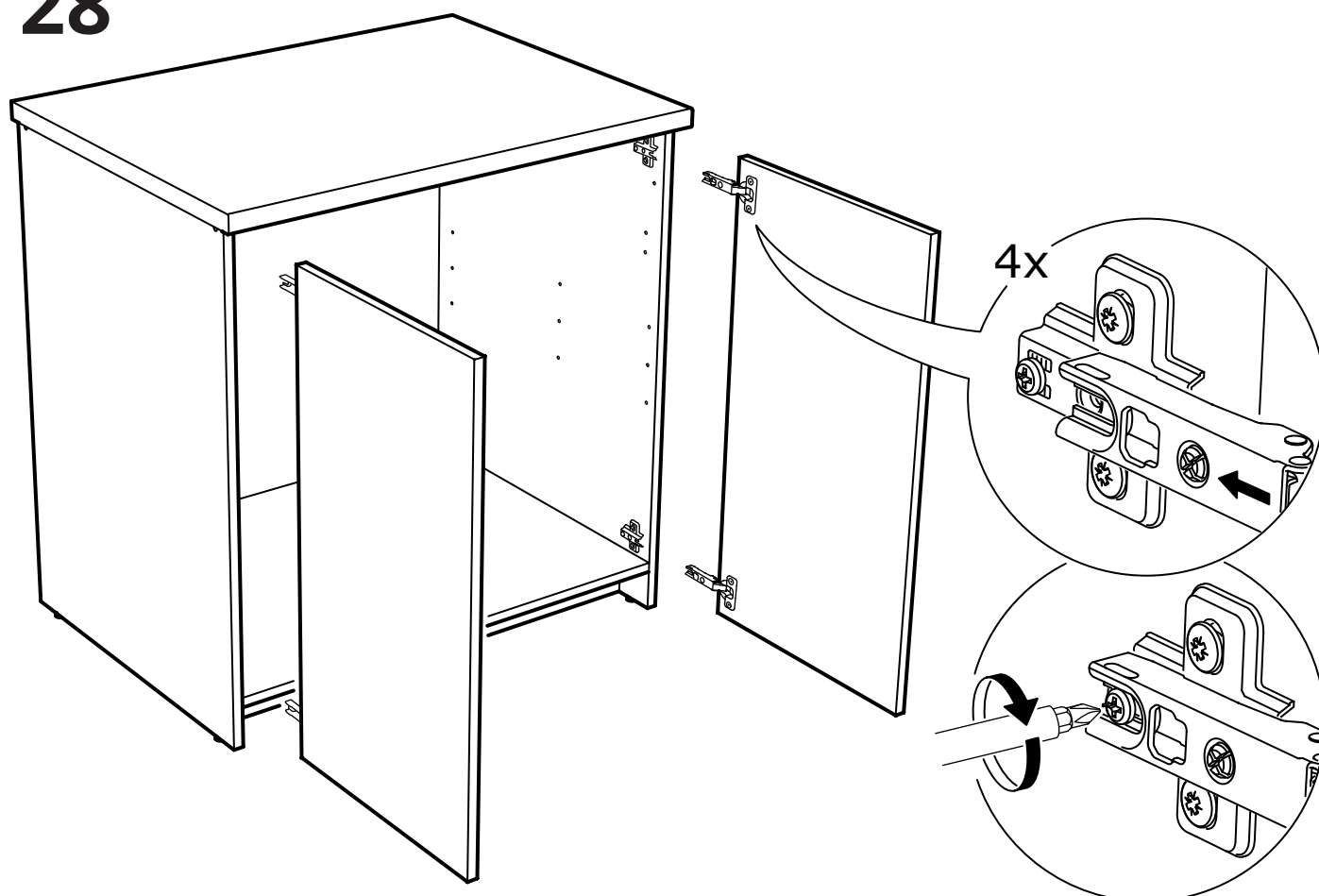

# 29

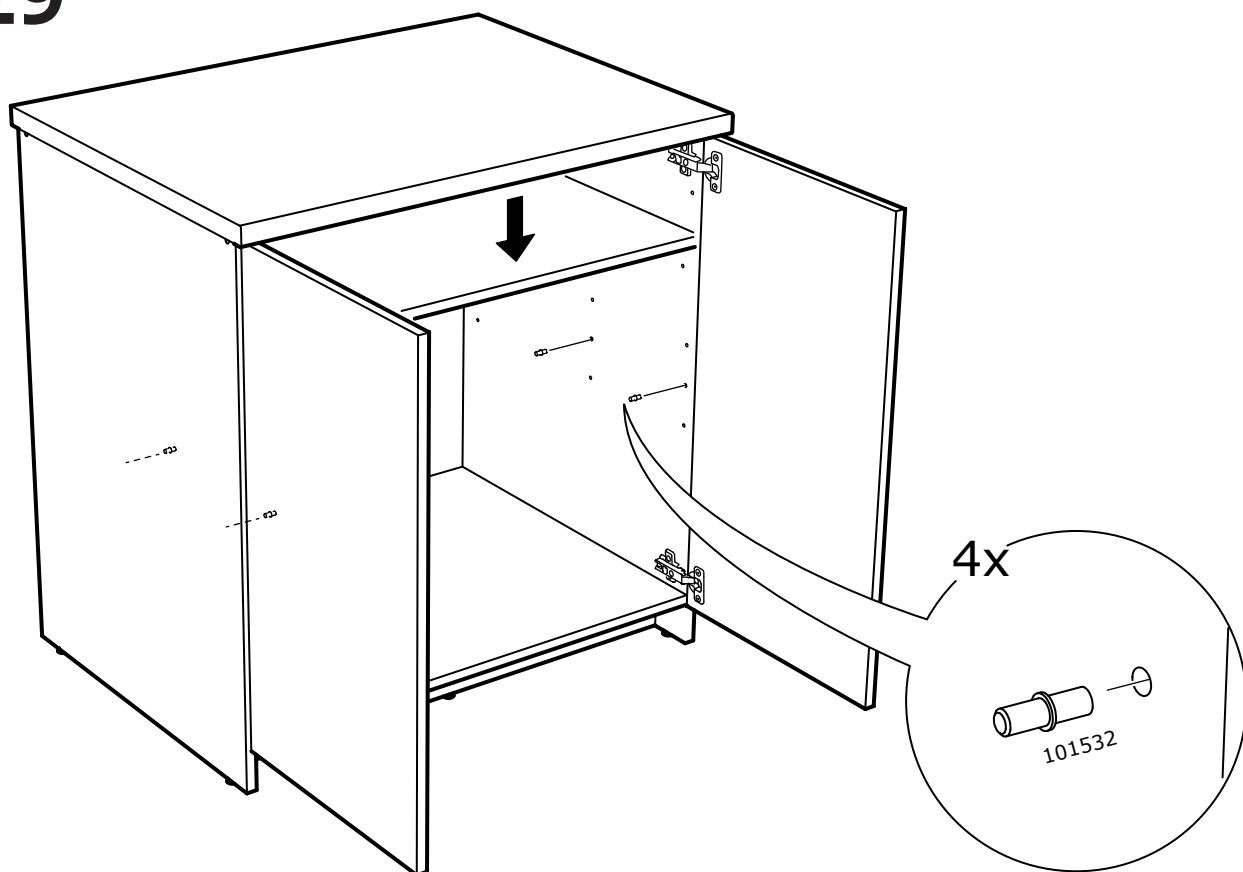

# 30

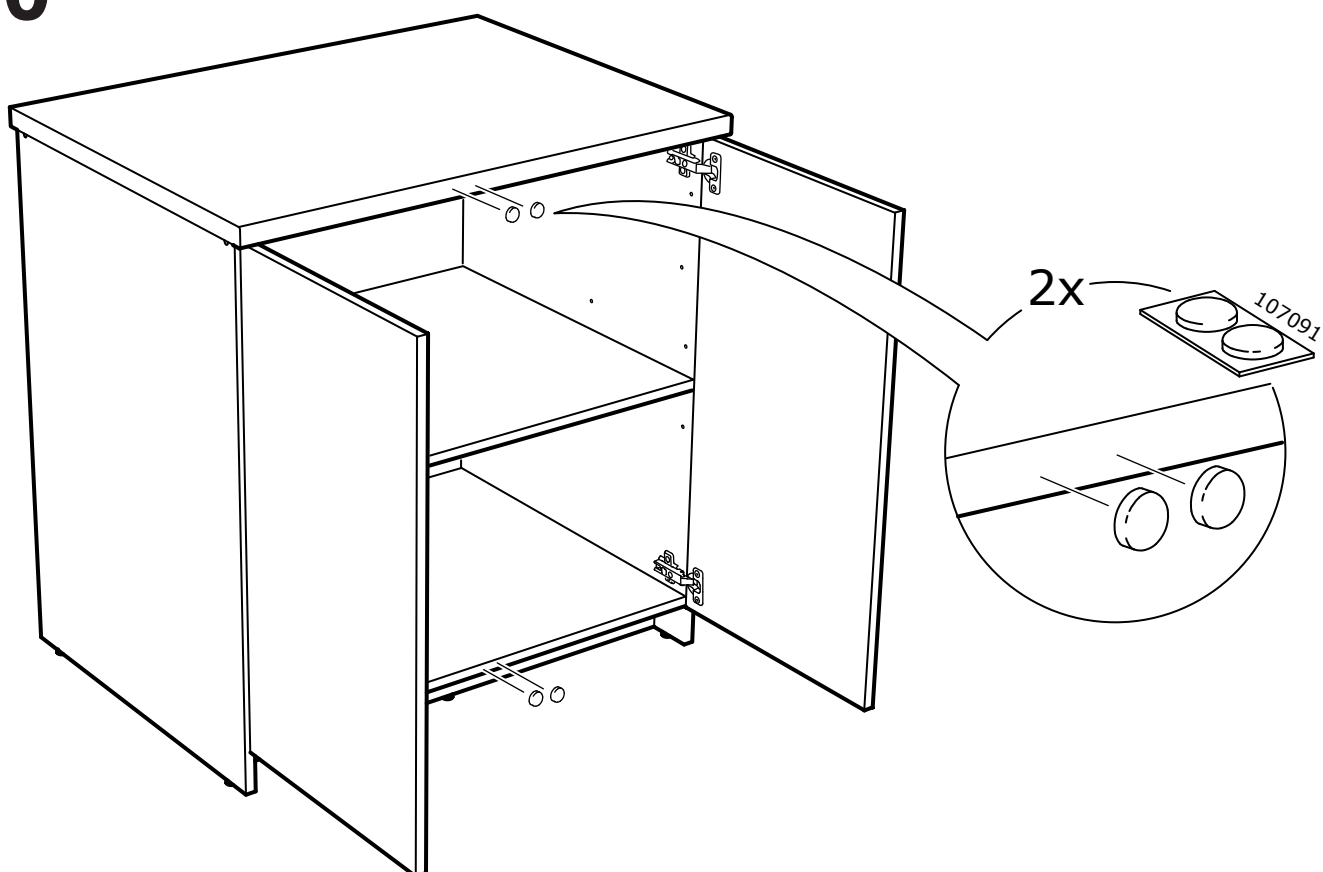



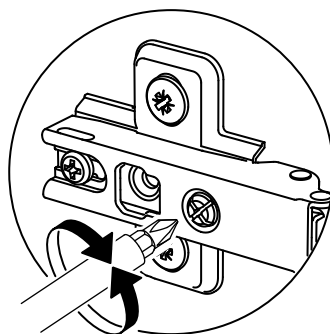
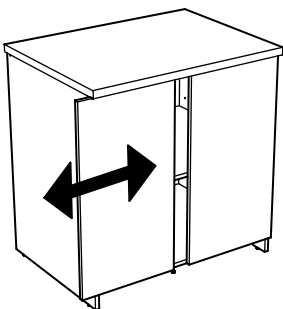
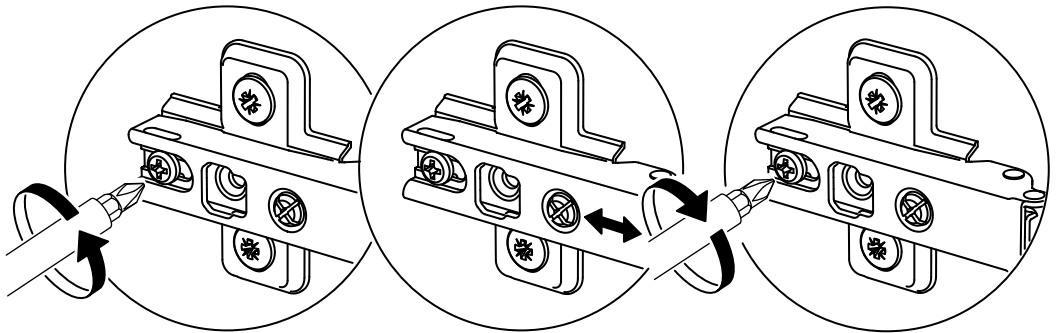
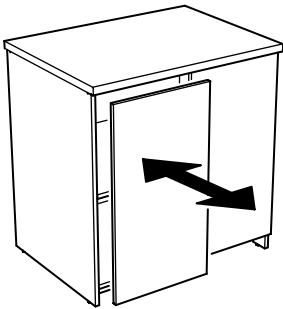
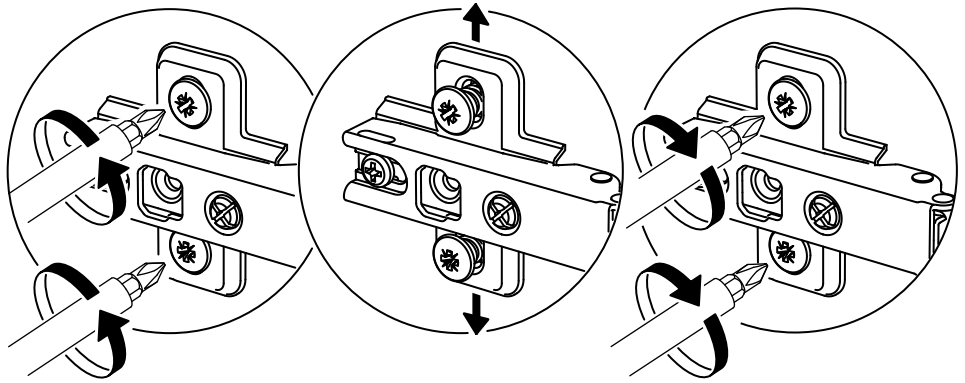
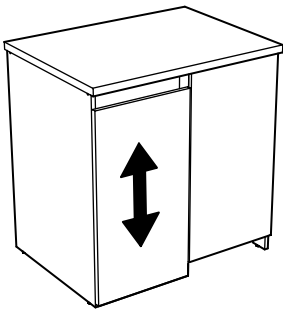

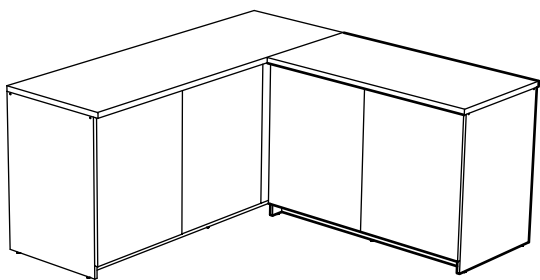

**1**

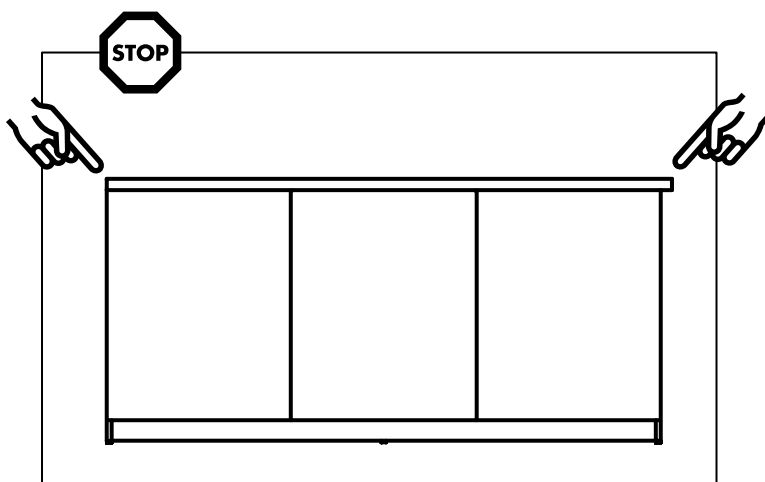
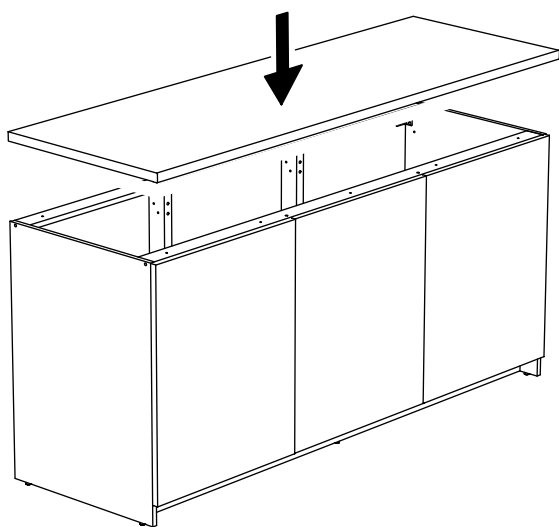

**2**

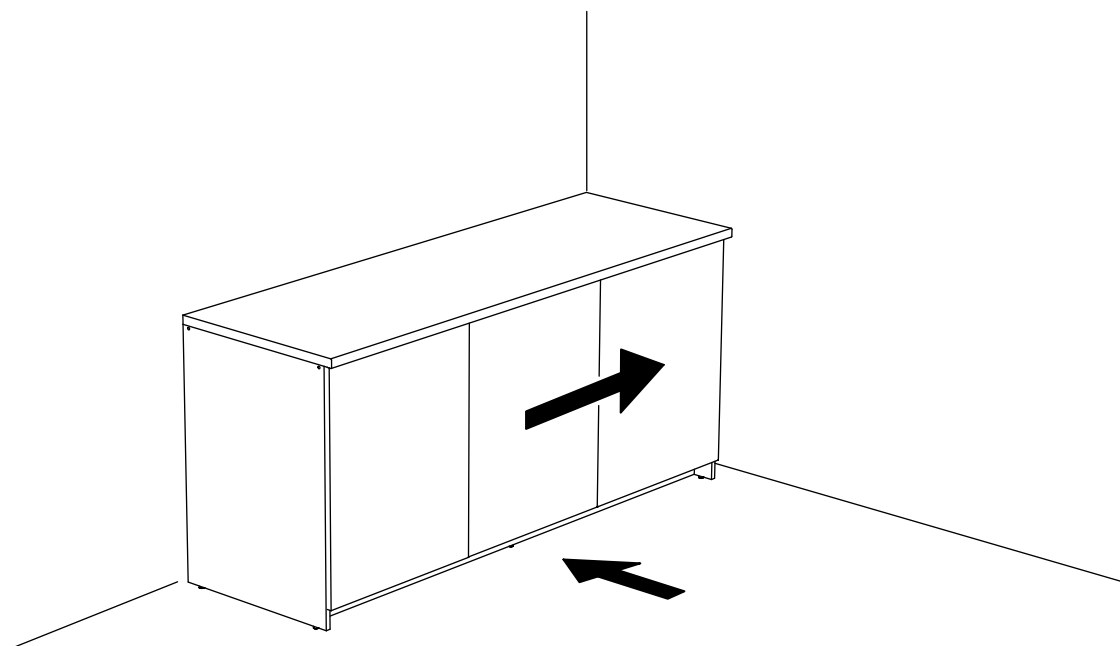

**3**

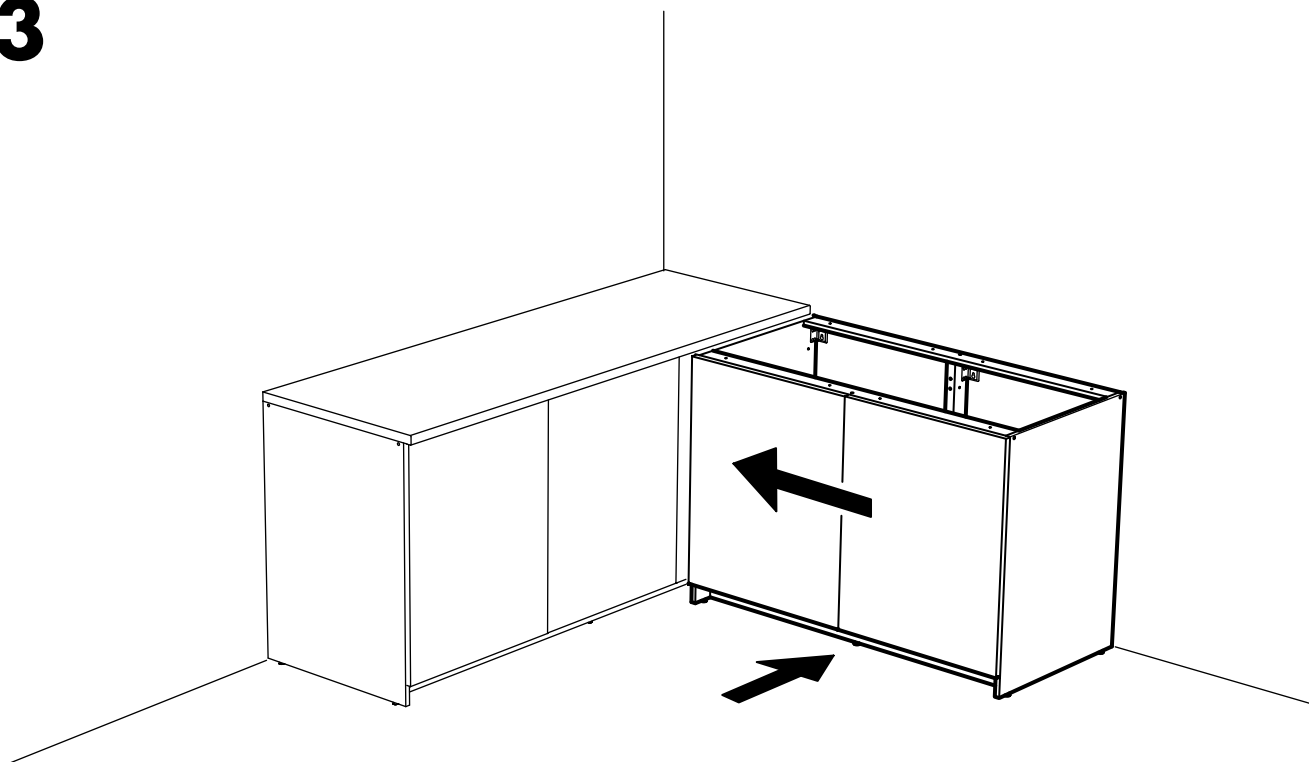

**4**

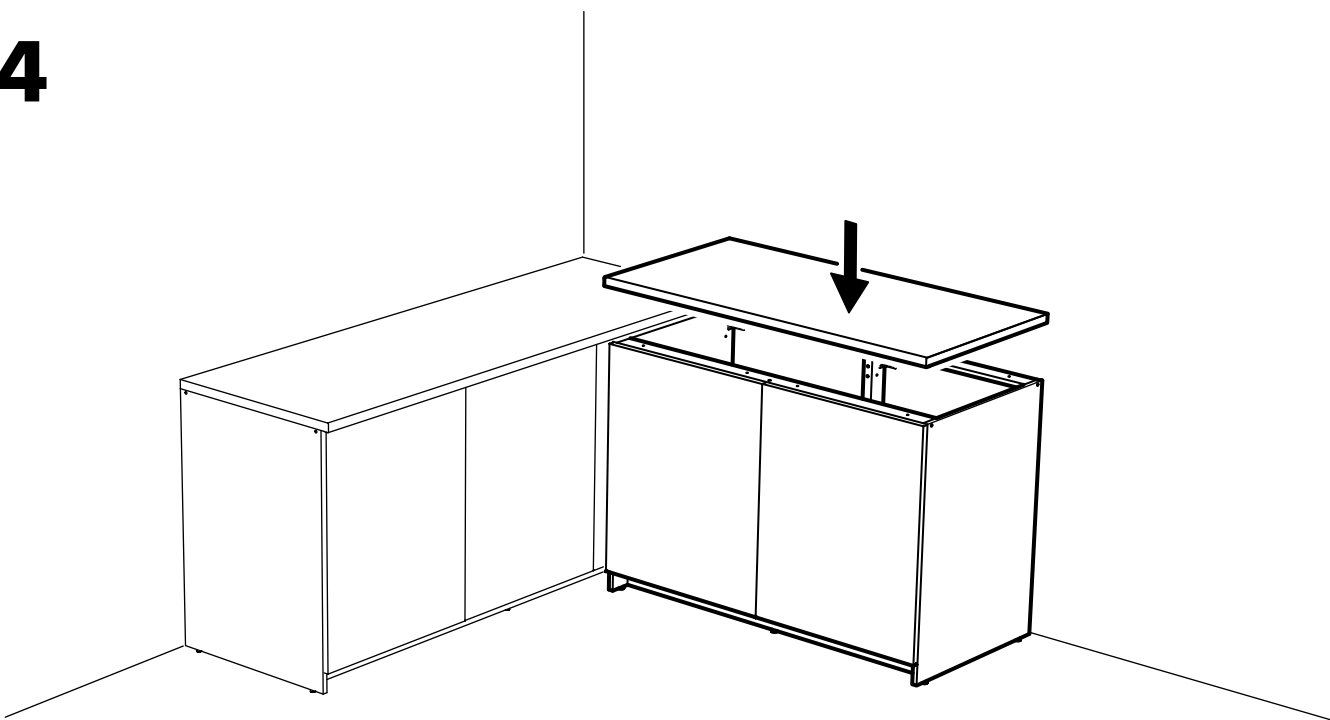

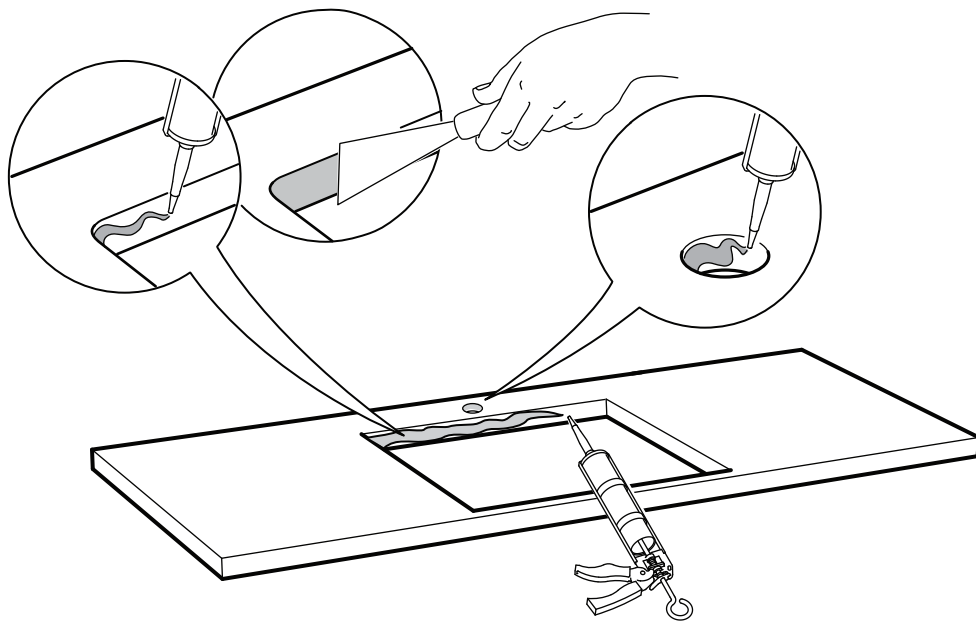
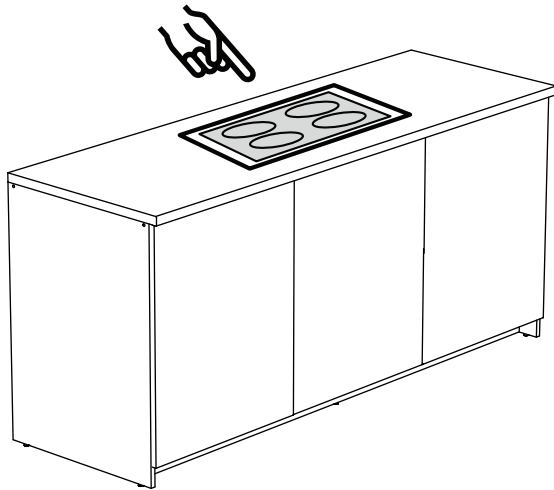

### English

Apply silicone in order to prevent liquids from penetrating into the worktop.

NOTE! Silicone is not included!

### 日本語

ワークトップへの水分の浸入を防ぐため、接合部分はシリコンコーキングしてください。シリコンは含まれていません。