

# MÖCKLERYD

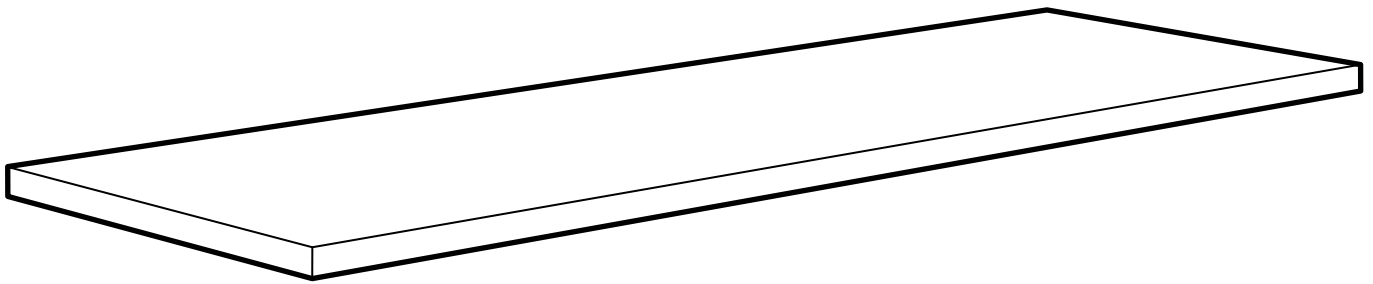

Design and Quality  
IKEA of Sweden

**日本語**

壁の材質により使用できるネジの種類が異なるため、専用の取り付けネジは含まれていません。適切なネジを選ぶには、お近くの専門店にご相談ください。

**English**

As wall materials vary, screws for fixing to wall are not included. For advice on suitable screw systems, contact your local specialised dealer.

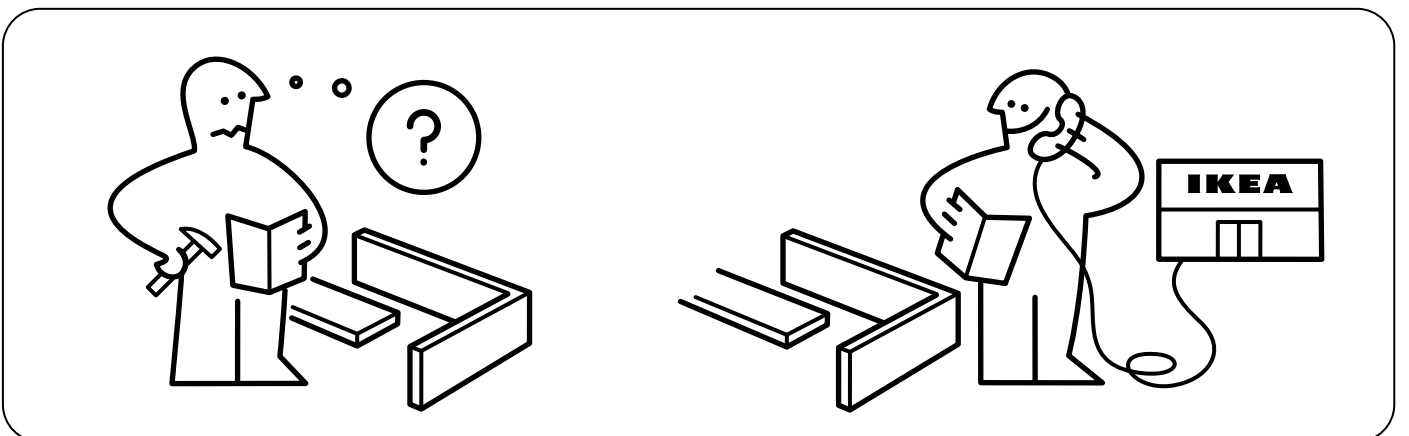
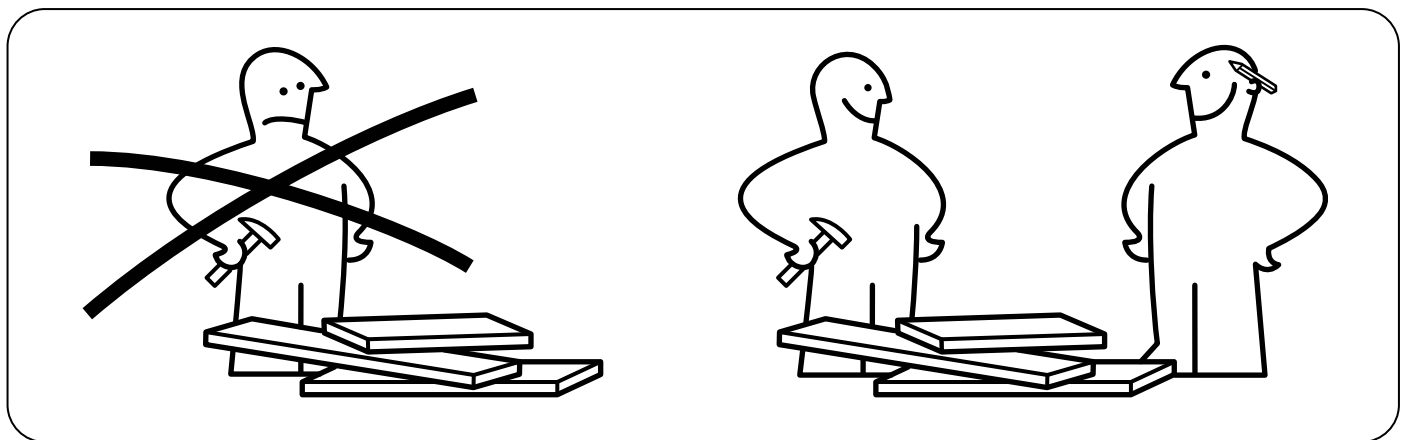
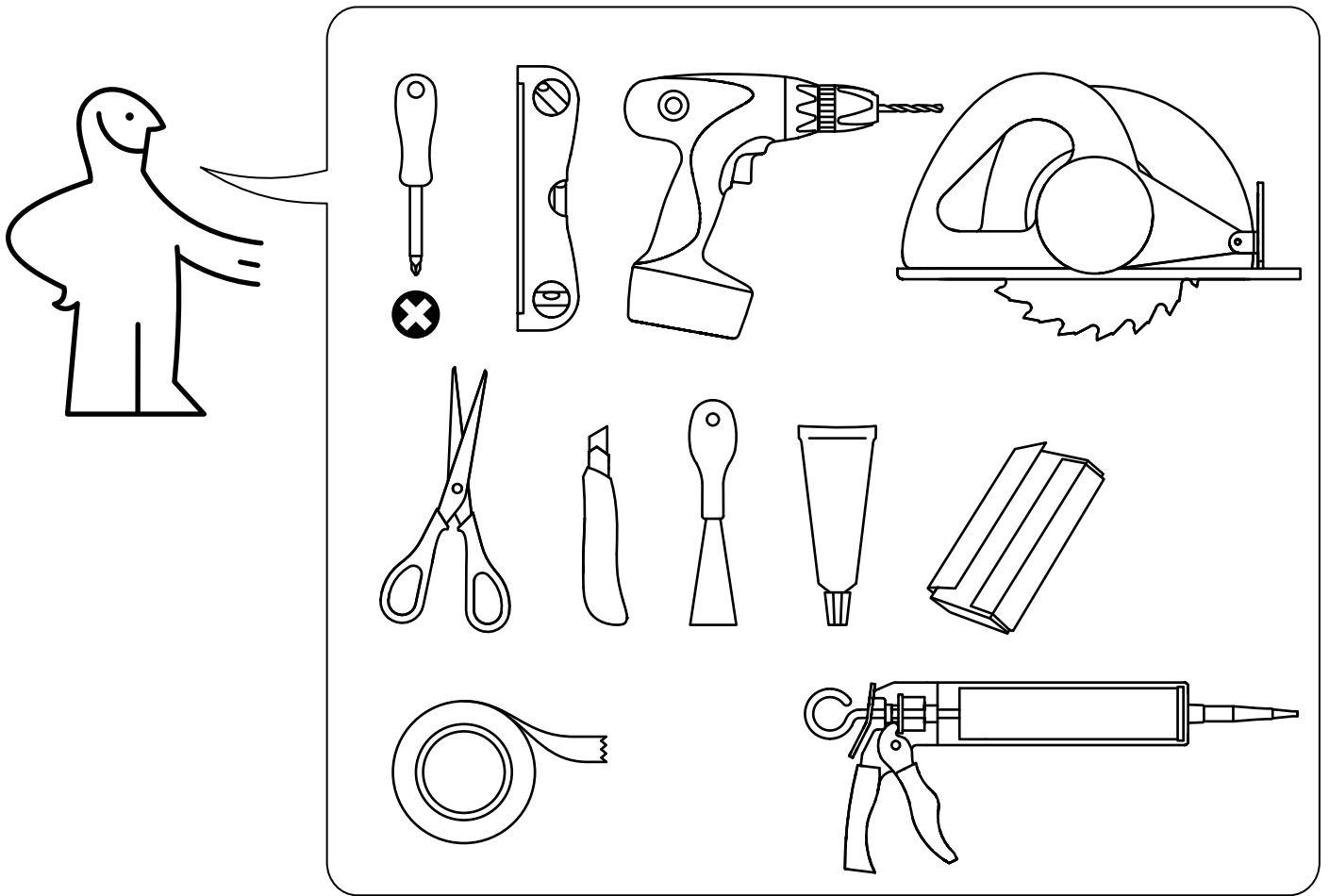

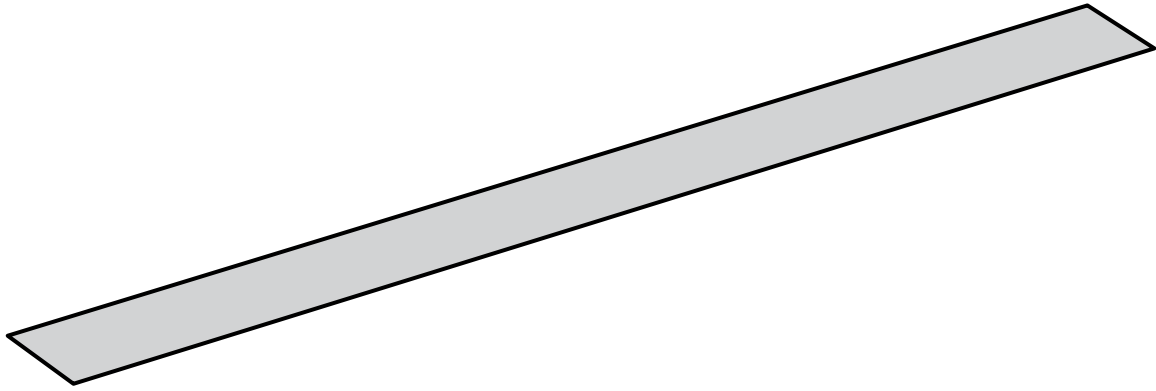

1x

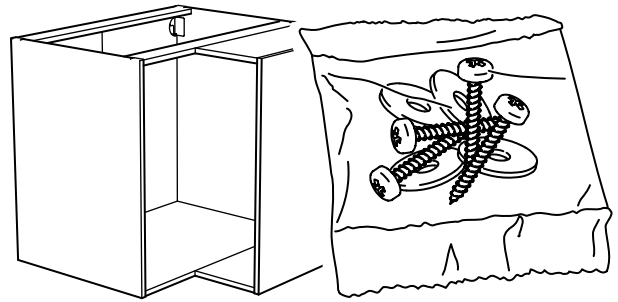
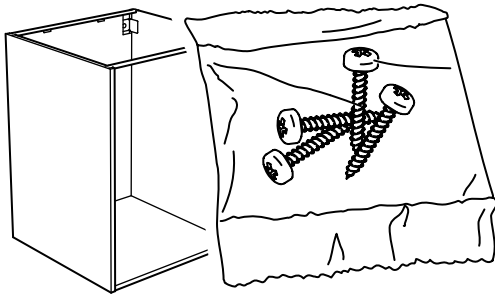

10 cm  
(3 7/8")

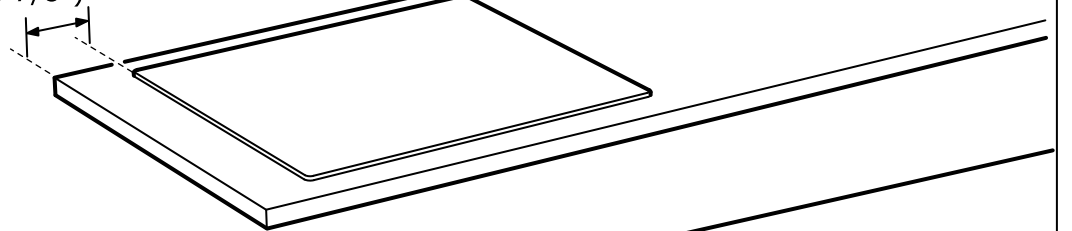

10 cm  
(3 7/8")

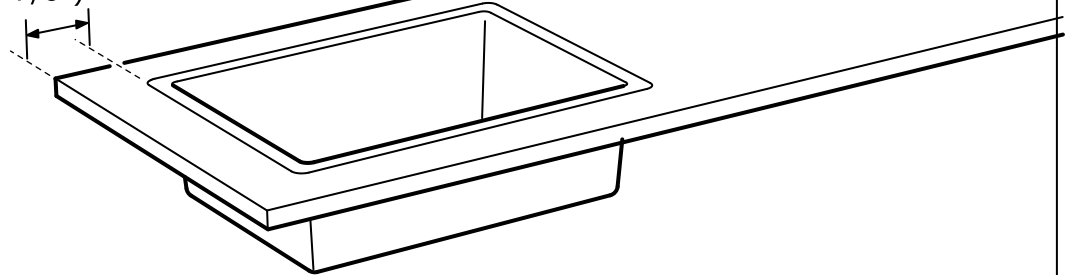

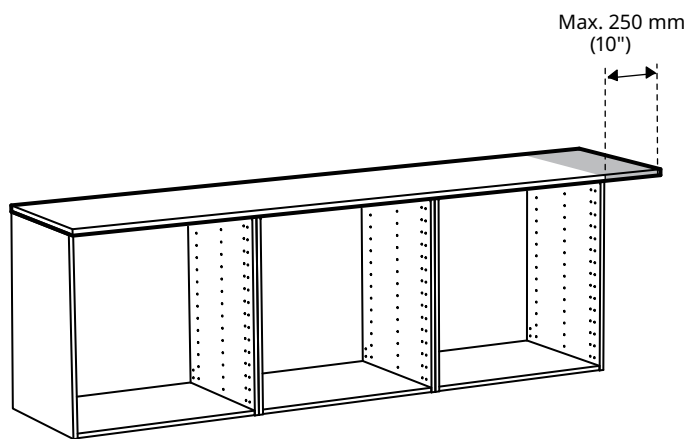
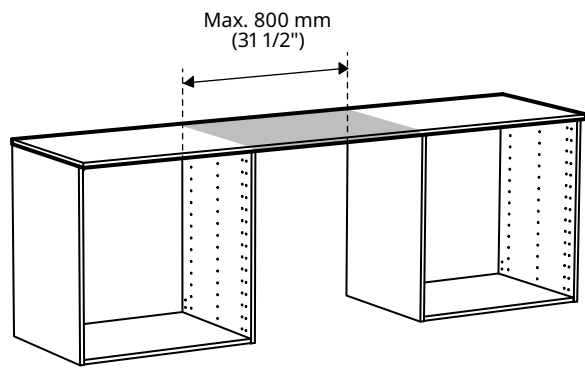

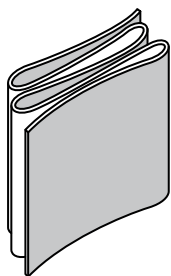
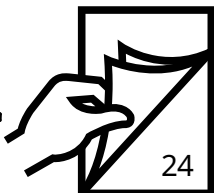

**FIXA/FENSJÖ**

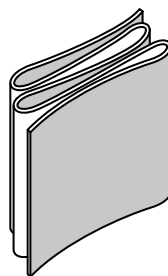
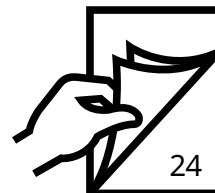
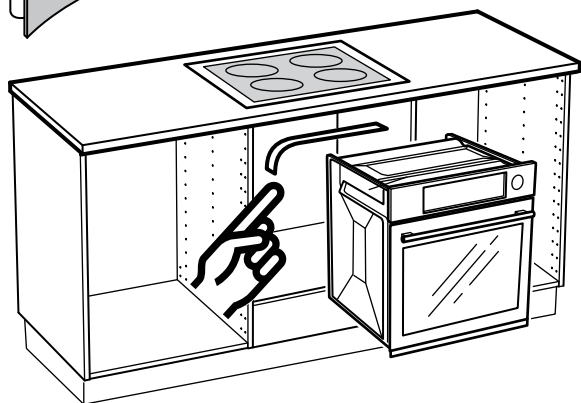

**FIXA/FENSJÖ**

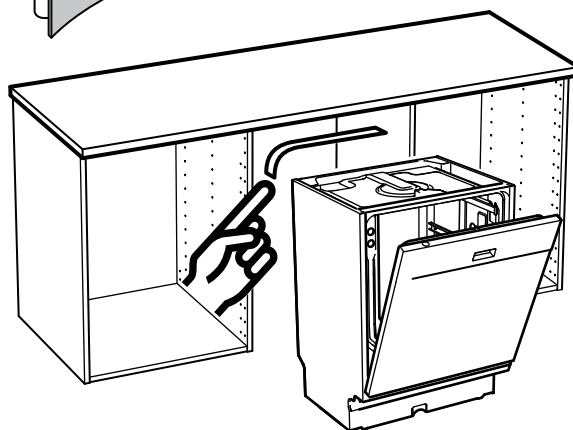

日本語  
別売り。

English  
Sold separately.

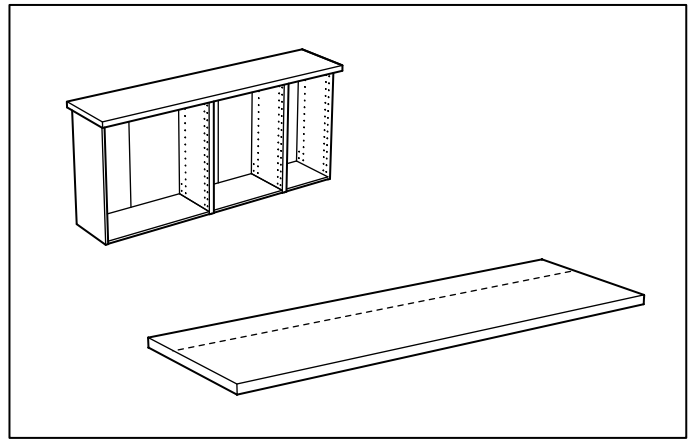
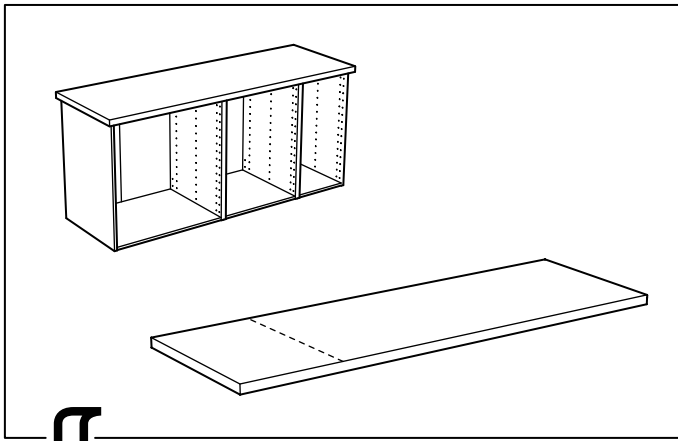

1

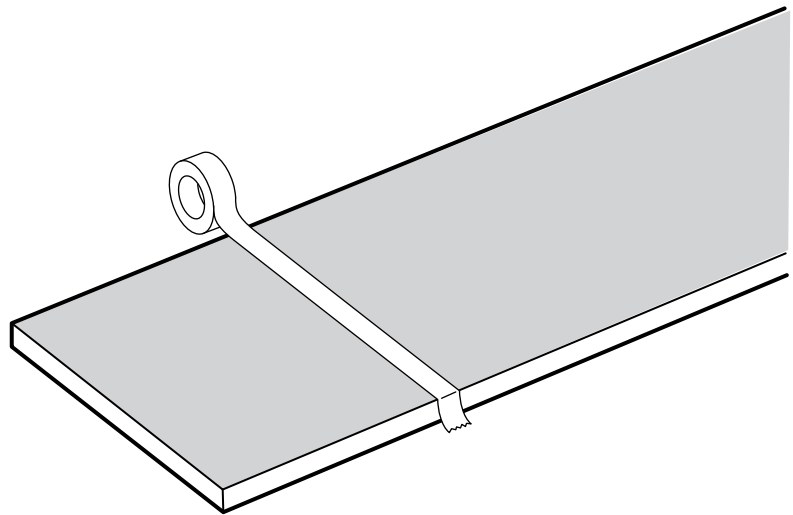
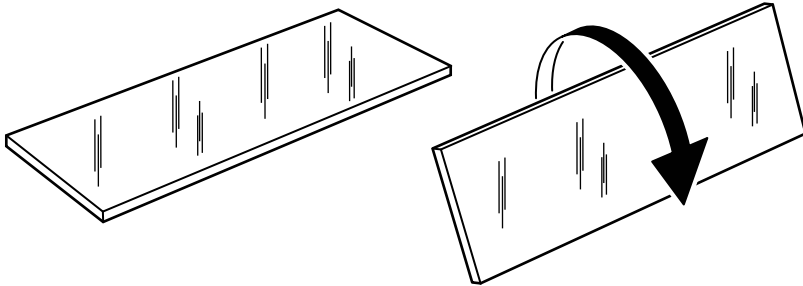



# 2

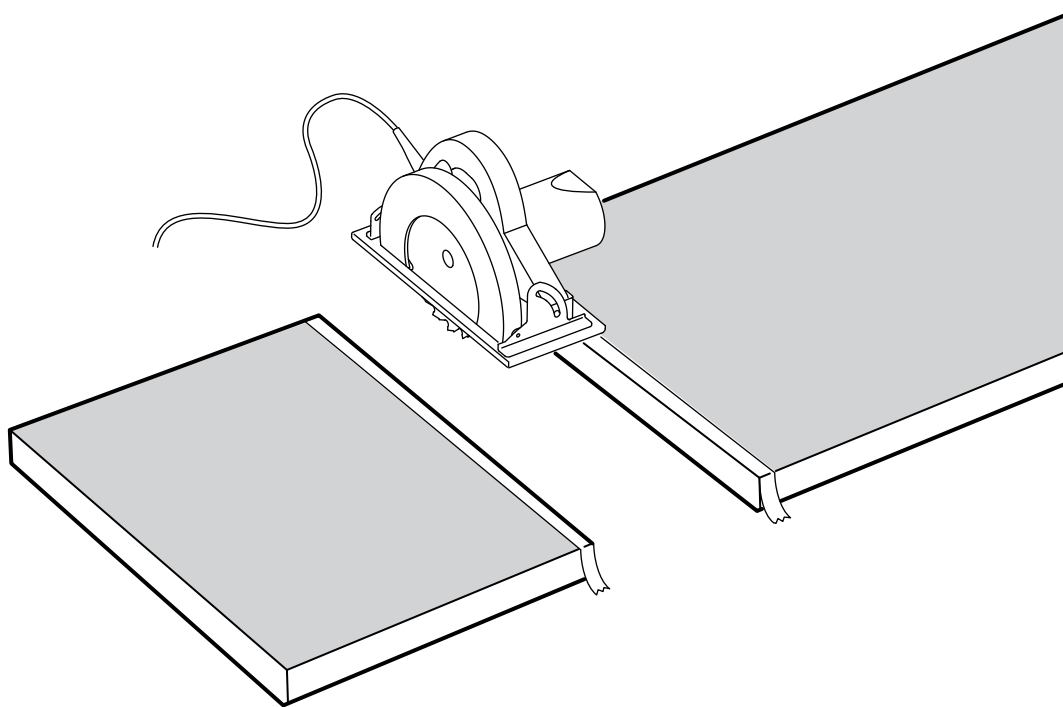

## 日本語

ワークトップは必ずまっすぐにカットしてください。  
ご不明な点は、お近くの専門店にご相談ください。

## English

It is important to saw the worktop straight.  
If uncertain contact your local specialized dealer.

# 3

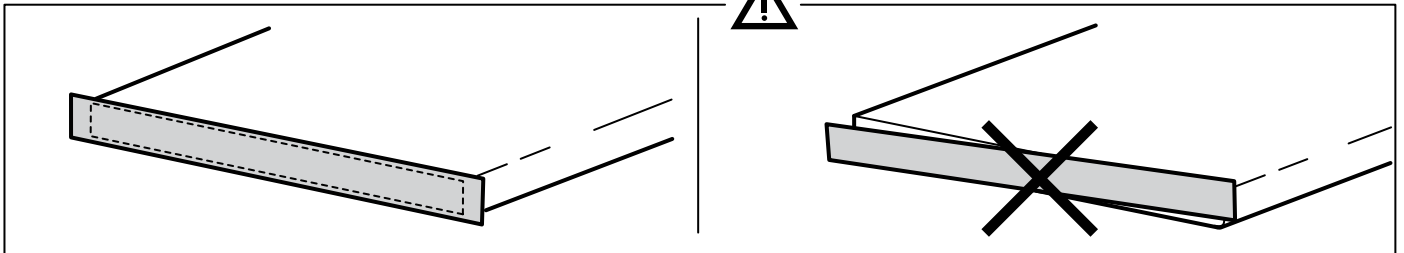
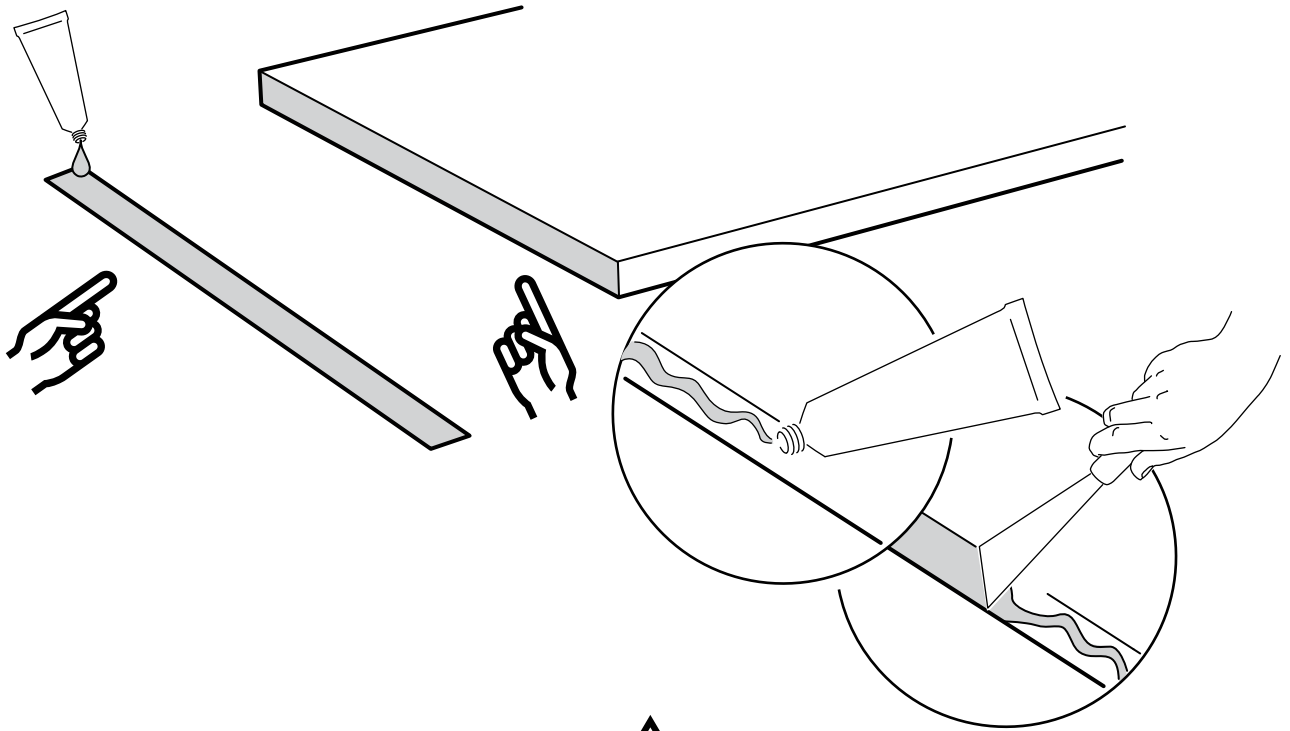

## 日本語

カウンタートップを切断する必要がある場合には、コンタクト接着剤（ゴム系接着剤）を使用して切断面にエッジ板を貼り付けます。コンタクト接着剤は添付されていません。

## English

If the worktop has to be cut, use contact adhesive to fix the edgeband to the cut end. Please note that contact adhesive is not included.

4

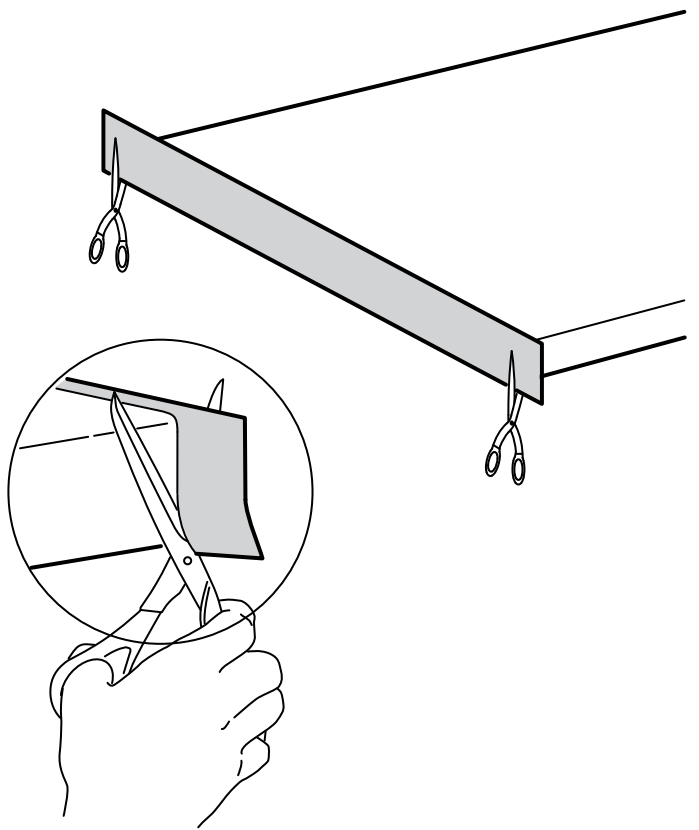
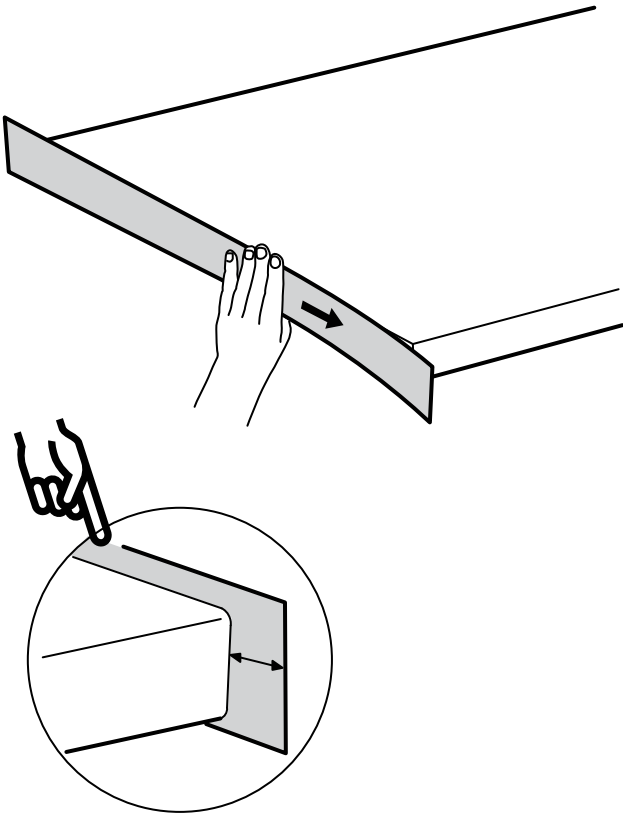

5

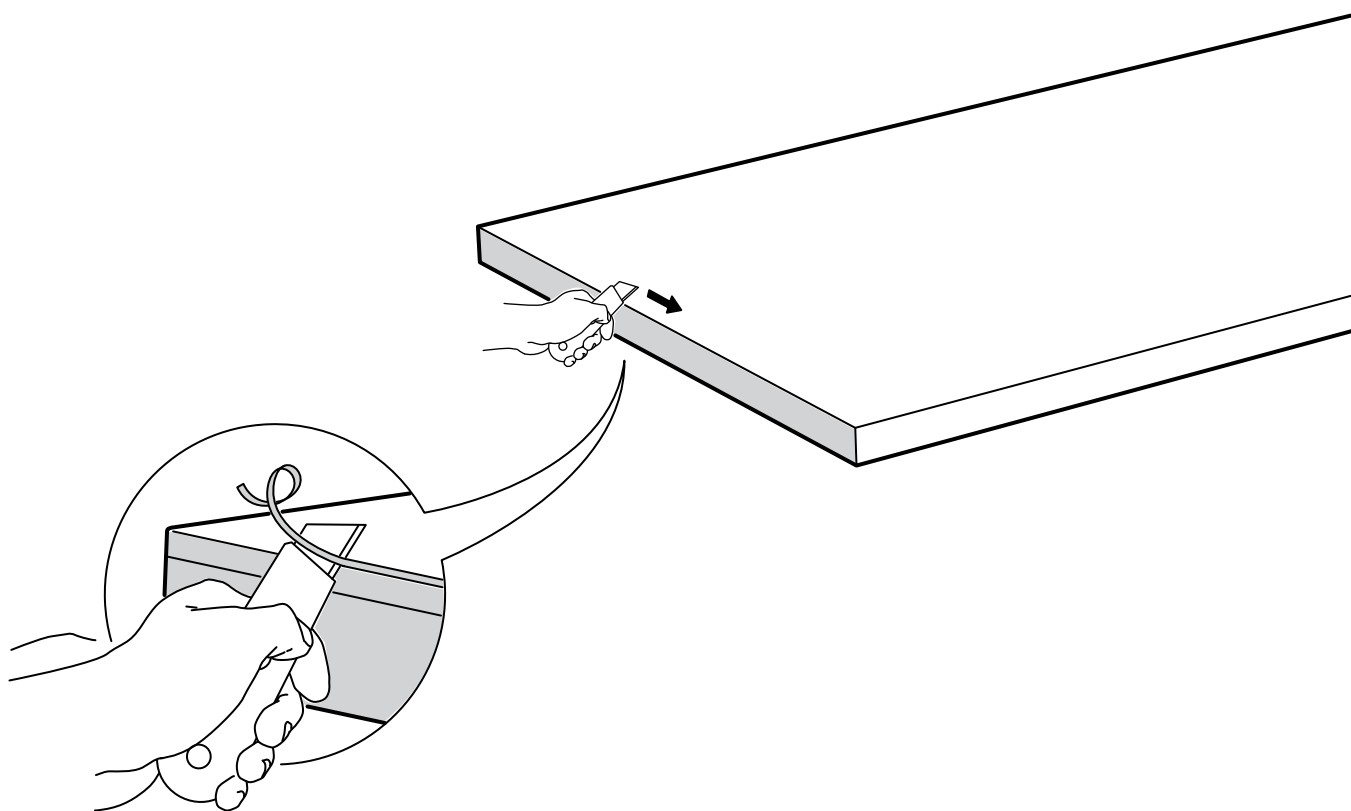

6

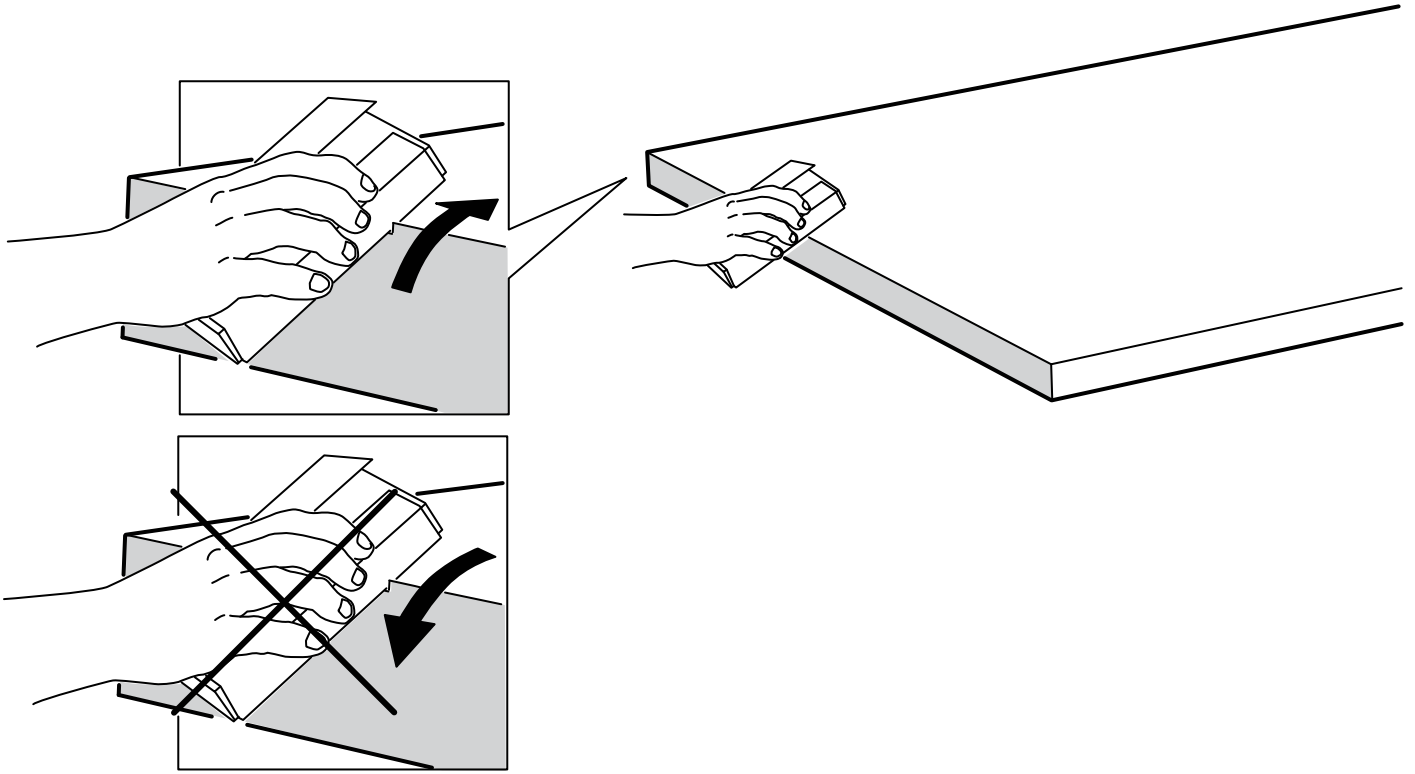

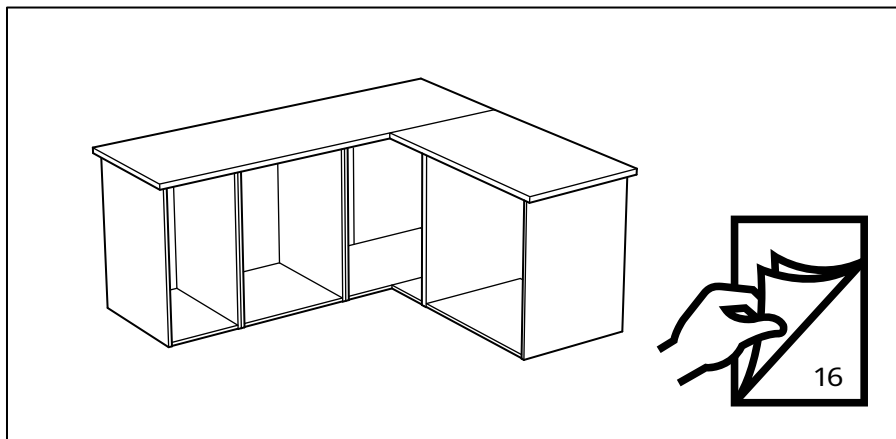
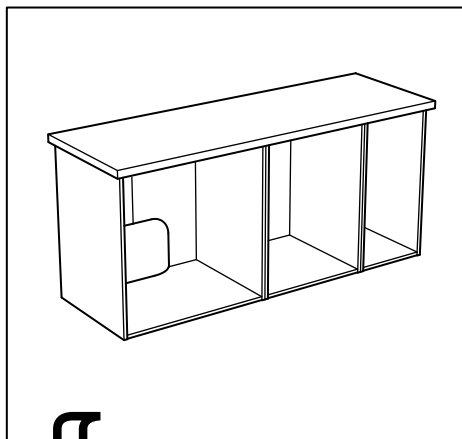

7

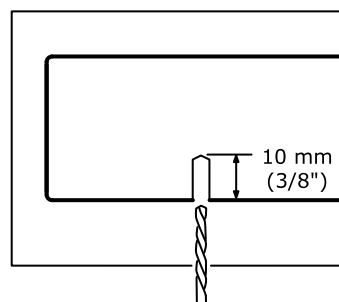
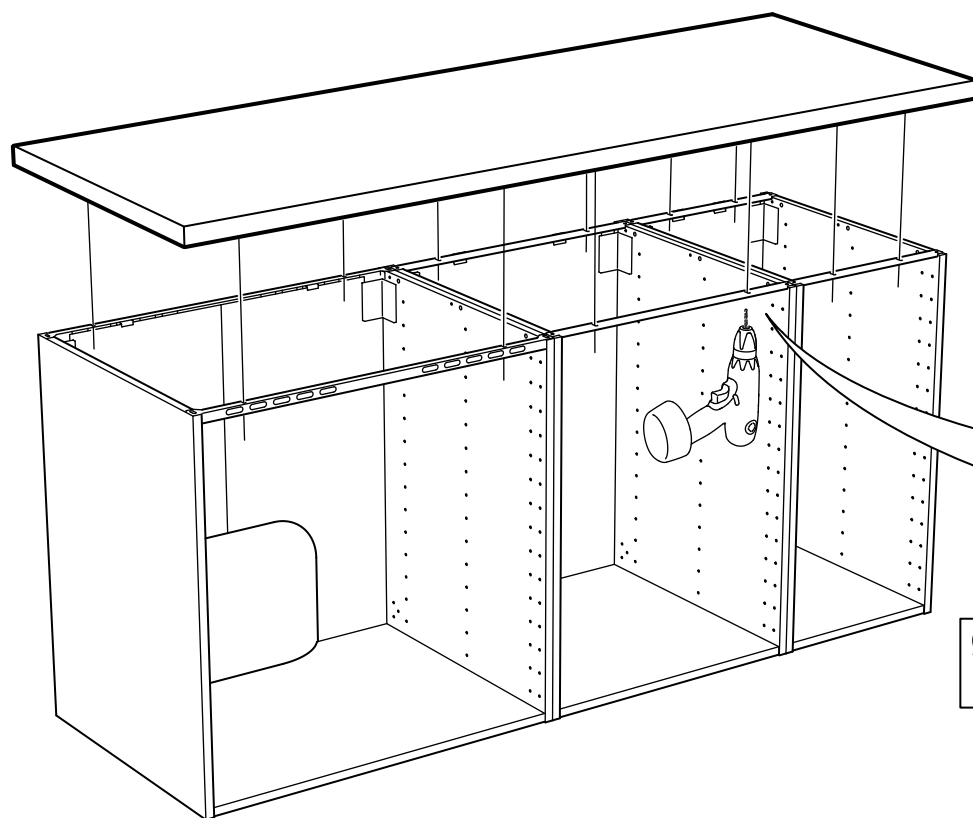

12x

Ø 3 mm  
(1/8")

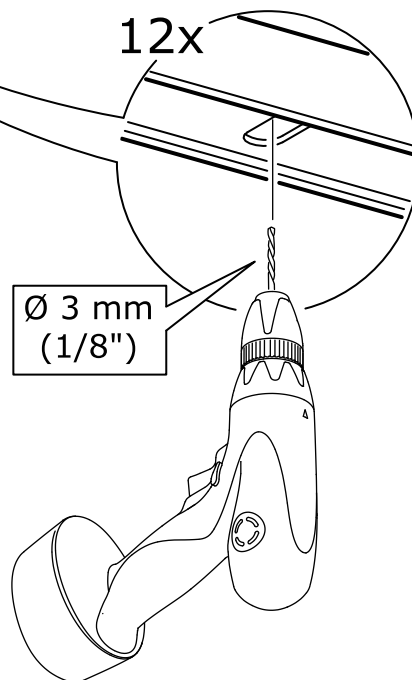

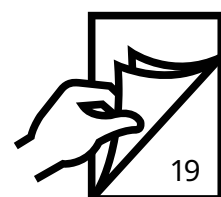
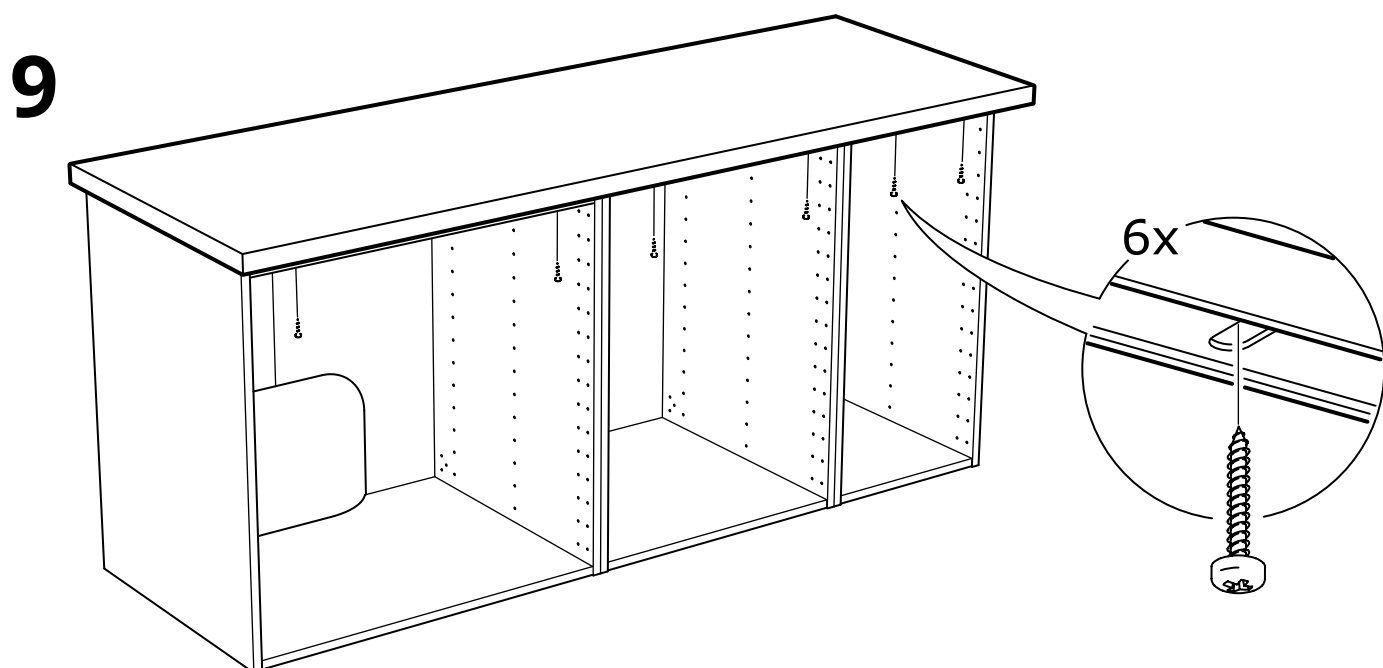
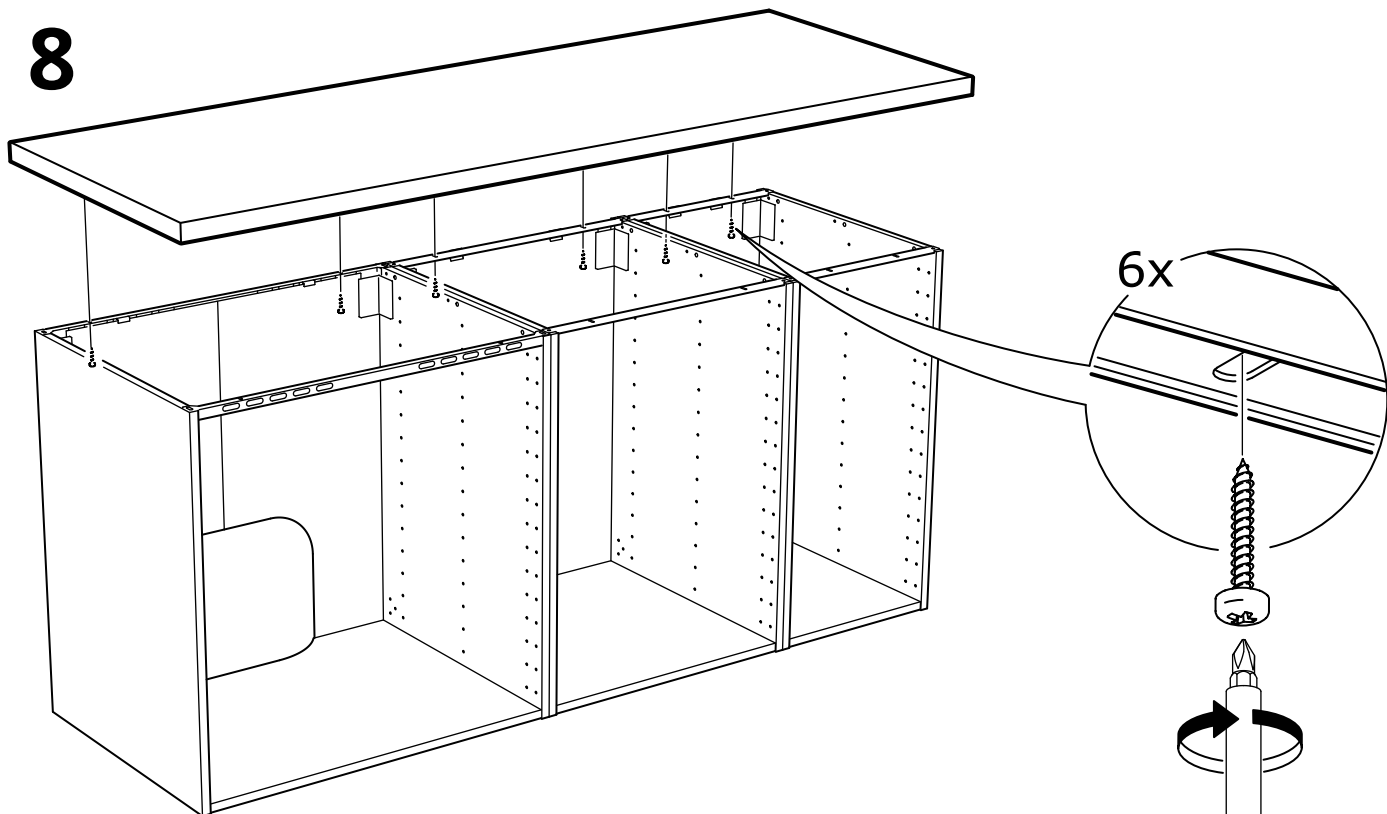

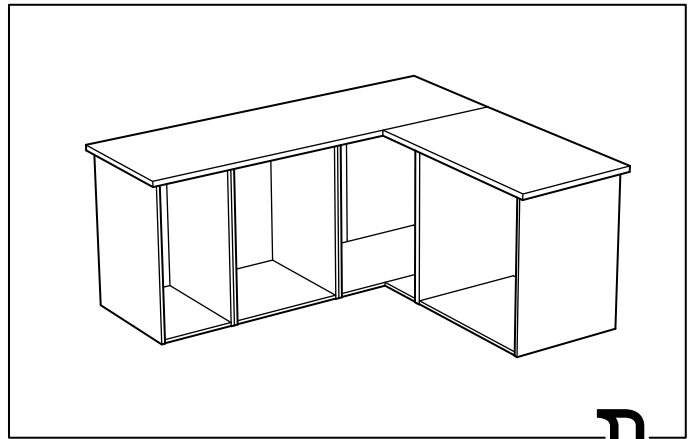

↓  
7

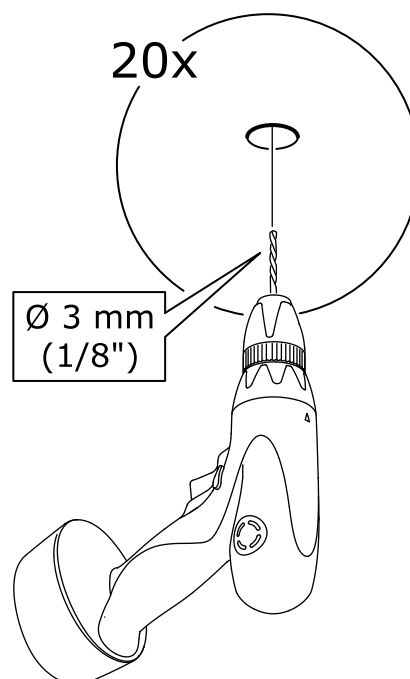
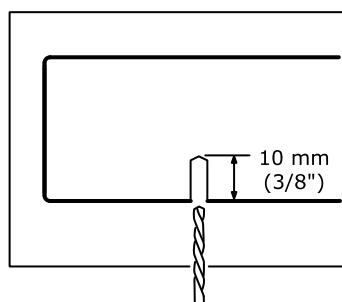
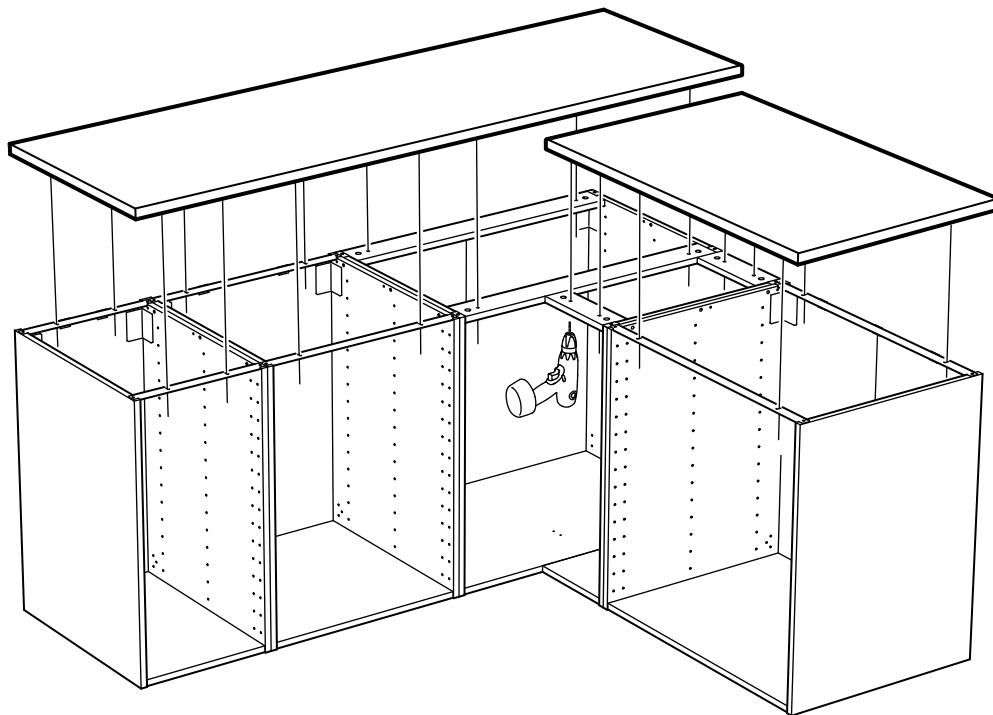



8

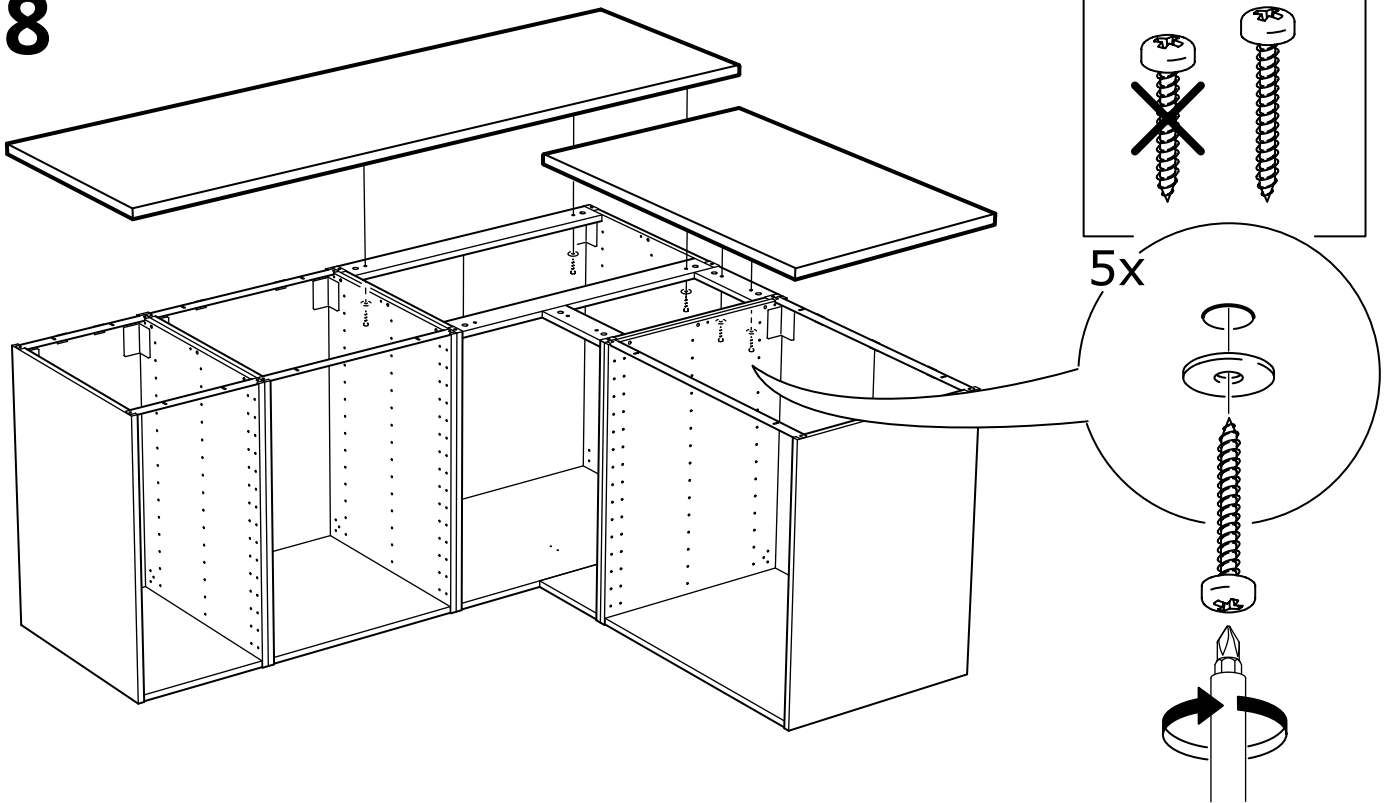

9

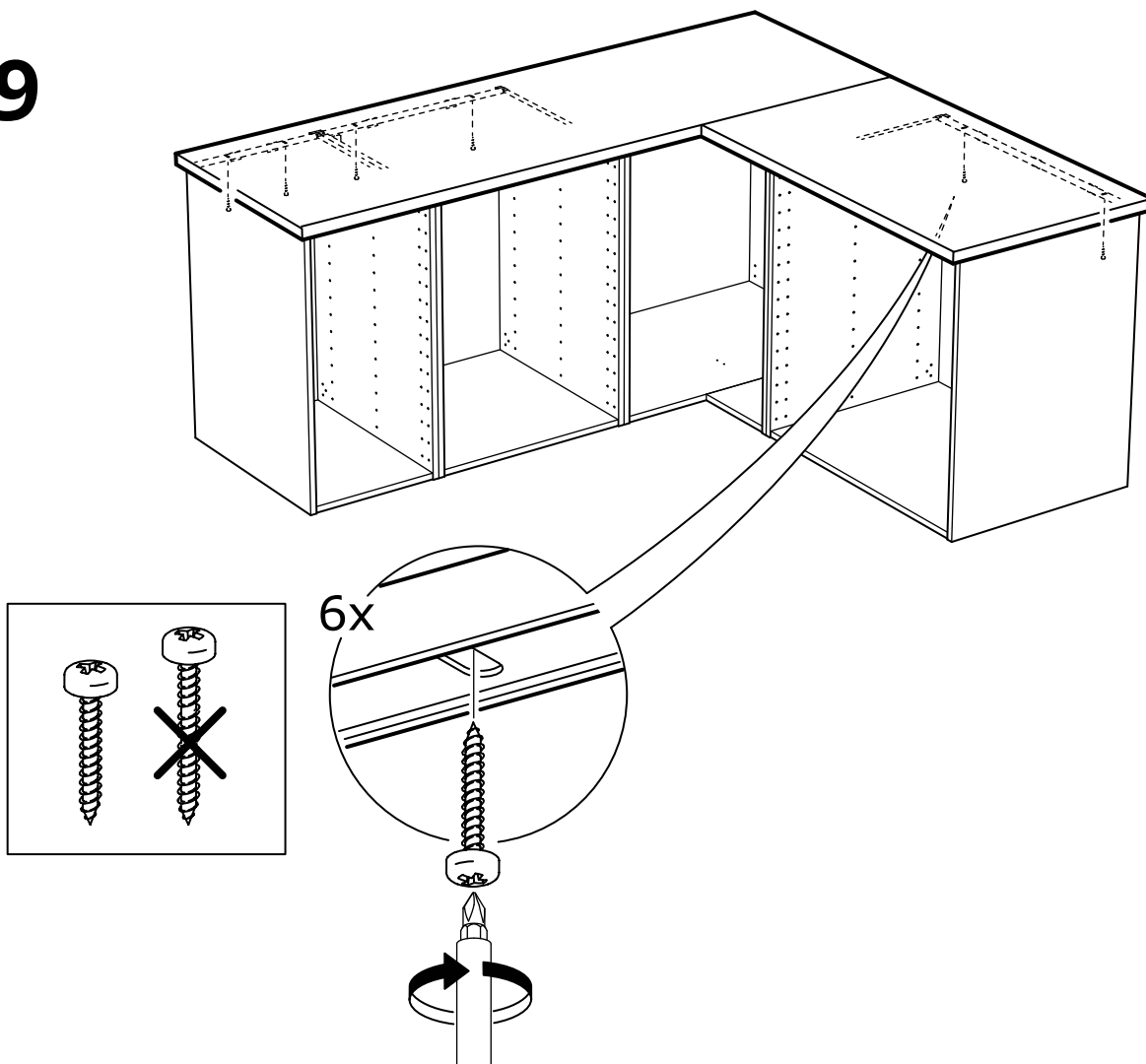

# 10

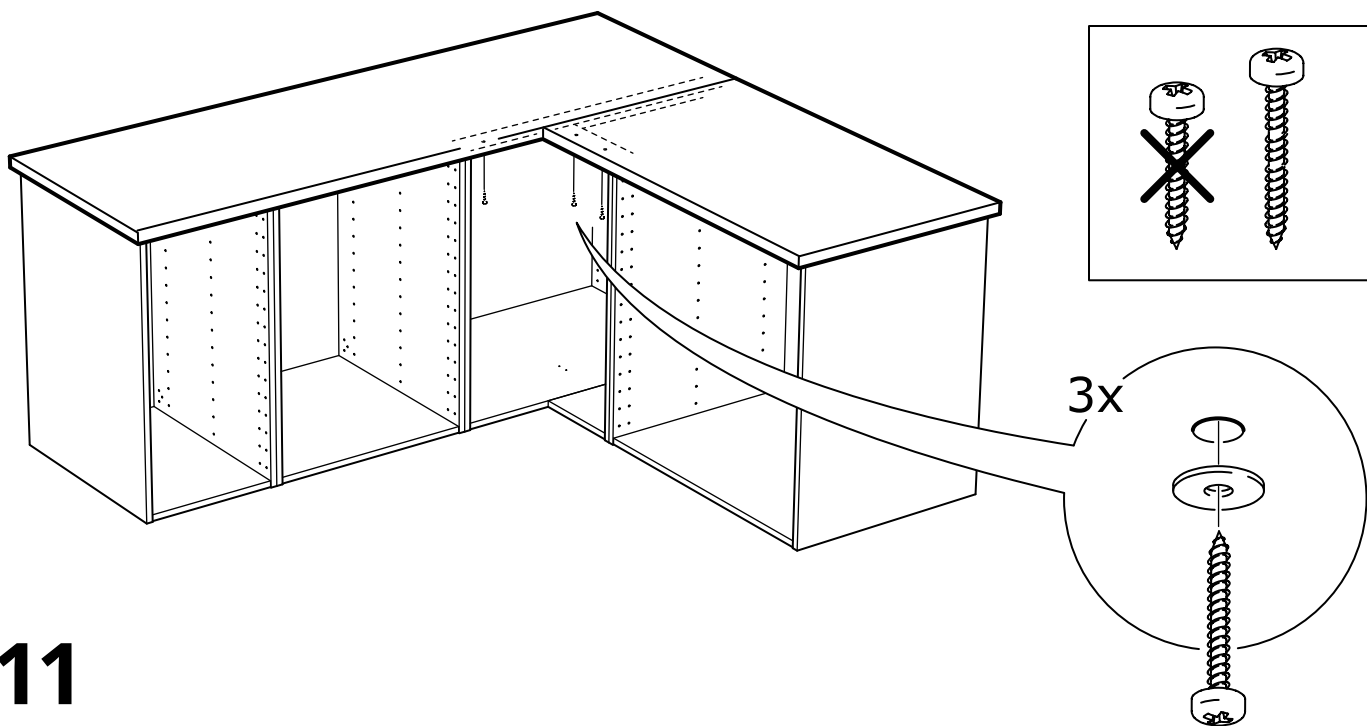

# 11

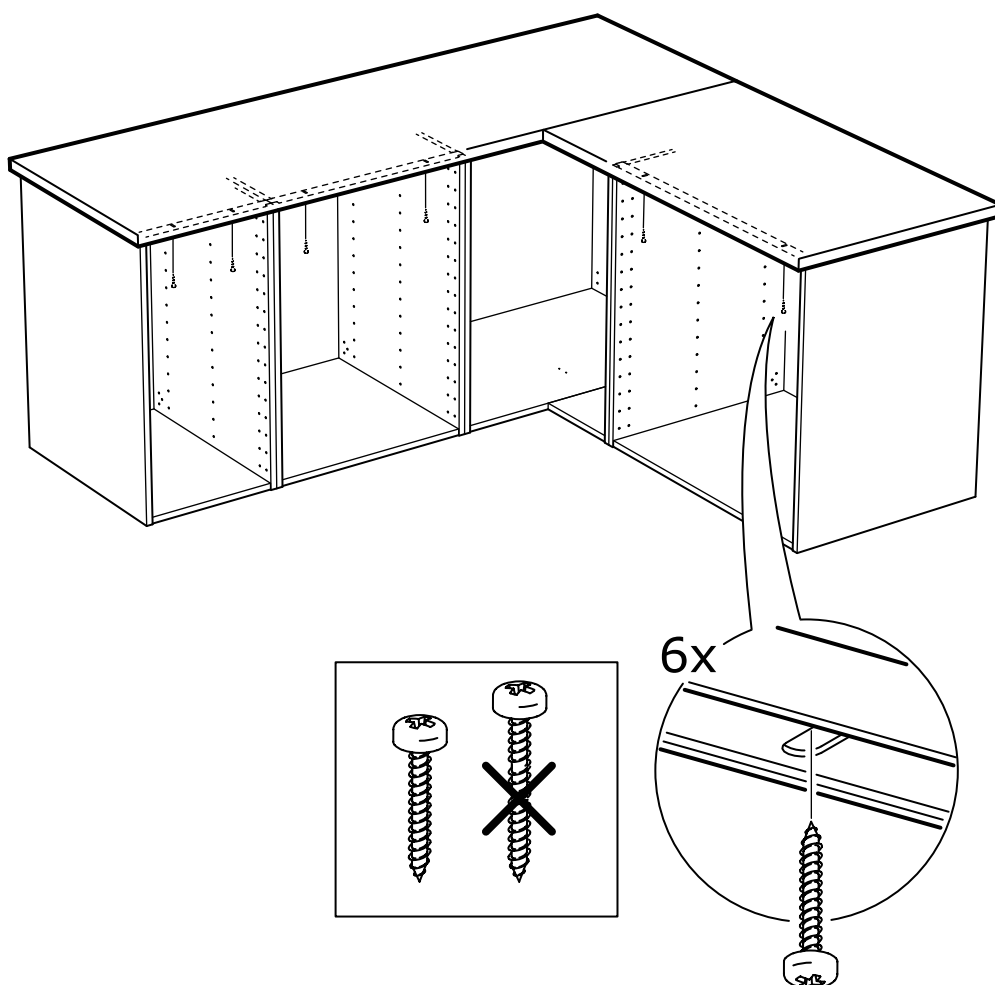



**日本語**

注意！シリコンは付属していません。

**English**

NOTE! Silicone is not included.

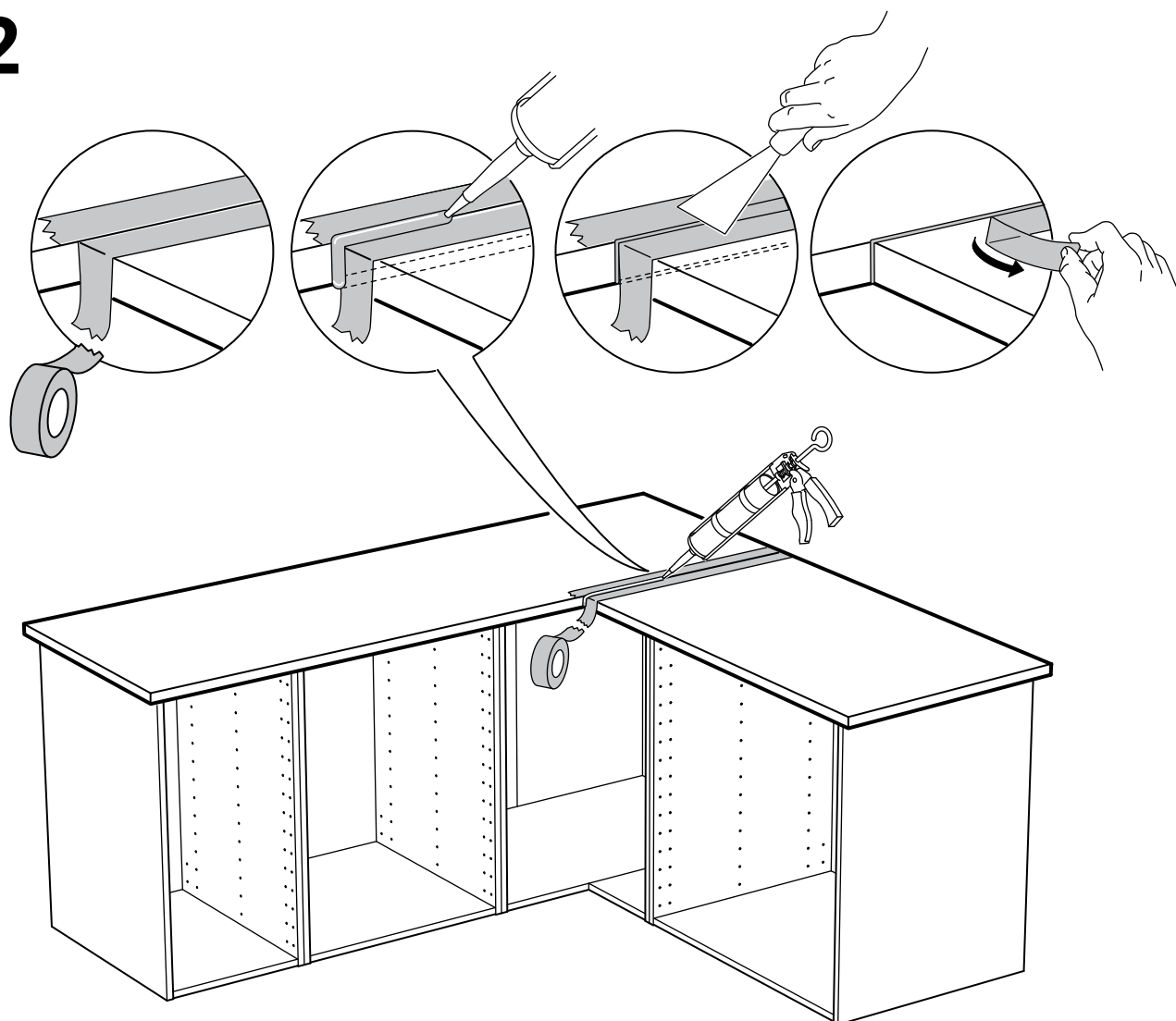

## 日本語

ワークトップへの水分の浸入を防ぐため、接合部分はシリコンコーキングしてください。シリコンは含まれていません。

## English

Apply silicone in order to prevent liquids from penetrating into the worktop.

NOTE! Silicone is not included!

# 13

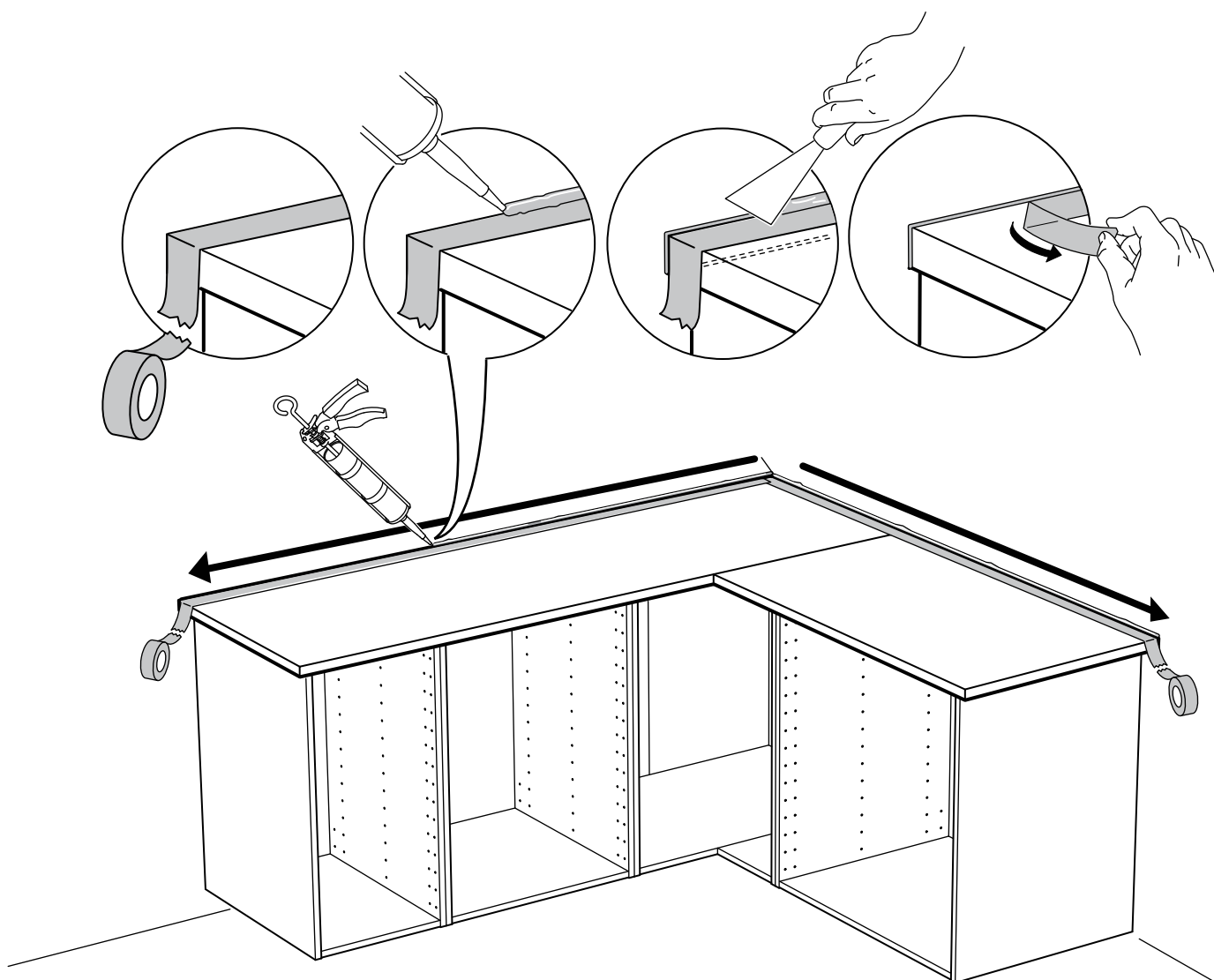

## 日本語

残ったコーキング材（シーリング材）は石けん水を含ませた布で拭き取ってください。しつこい汚れはアセトンを使って取り除くことができます。アセトンの塗布時間は20分以内にとどめてください。

## English

Wipe off remaining sealant with soapy water, stubborn stains can be removed with acetone within 20 min after application.

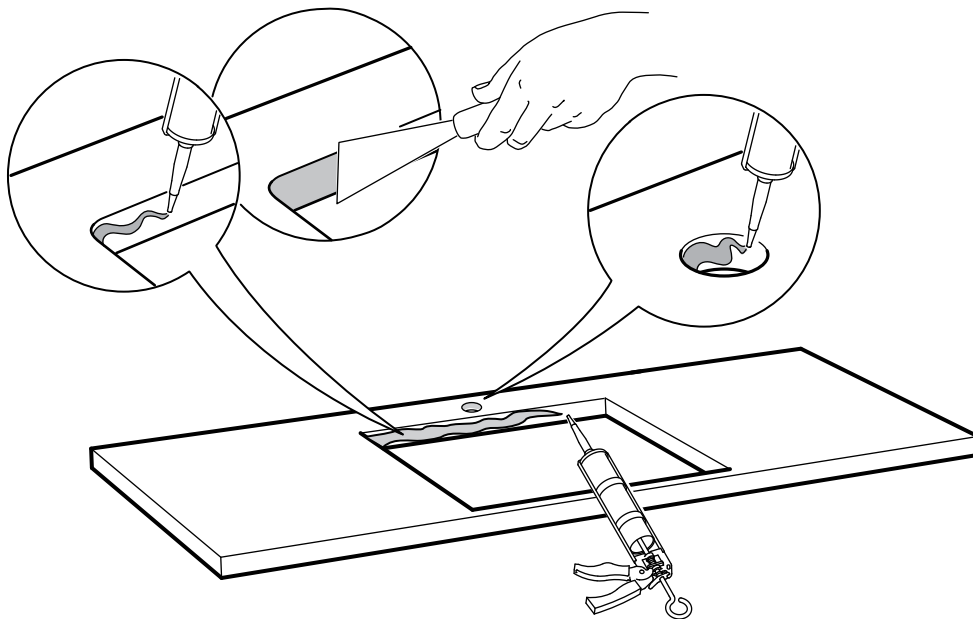
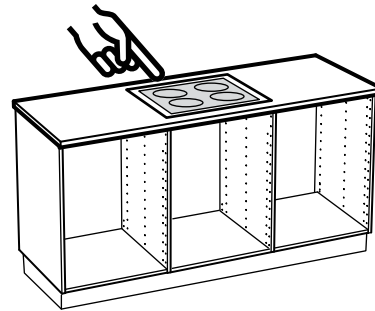
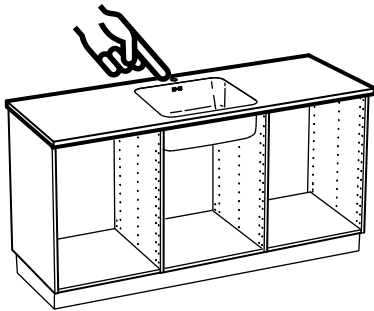
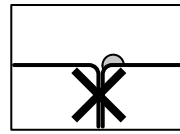
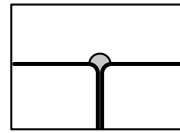
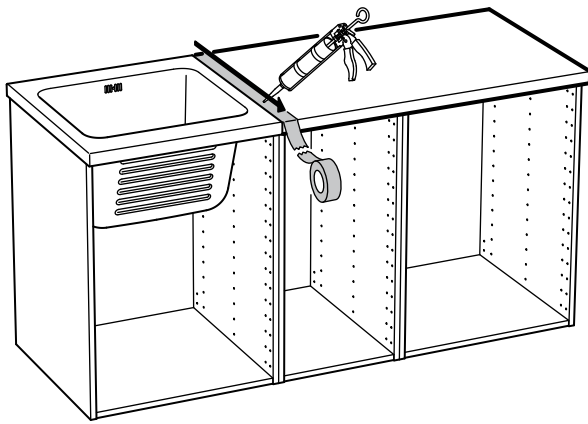

**日本語**

ワークトップの下に電化製品を設置する場合は、ワークトップを湿気や水気から守るため、ワークトップの裏面に保護シートを取り付けてください。

**English**

Fit a diffusion barrier on the underside of the worktop above white goods to provide extra protection against condensation and moisture.

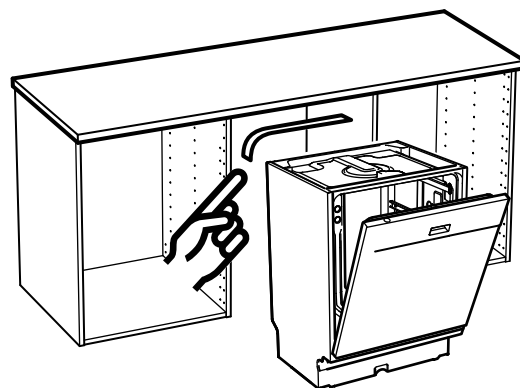
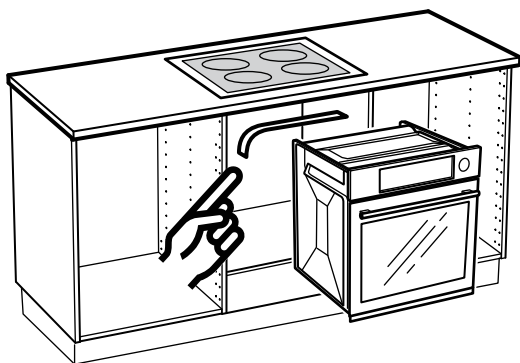
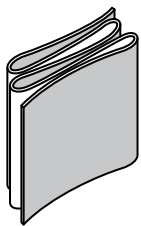

## FIXA/FENSJÖ

