

SOLVINDEN

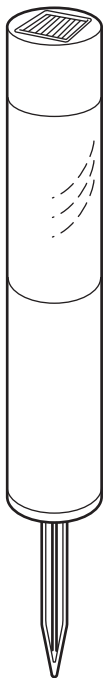

Design and Quality
IKEA of Sweden

**English**

ALWAYS REMOVE THE BATTERIES
BEFORE STORING.

English

Only use batteries that are
intended for the product. Do
not mix old and new batteries,
different brands or types.

עברית

הקפידו להוציא את הסוללות לפני
האחסון.

עברית

השתמשו רק בסוללות המיועדות למוצר.
אין לערבב סוללות ישנות וחדשות,
מחברות וסוגים שונים.

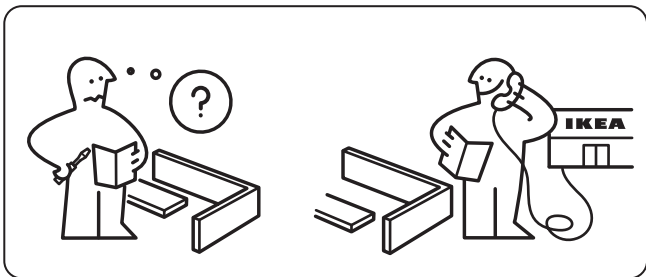

1



3

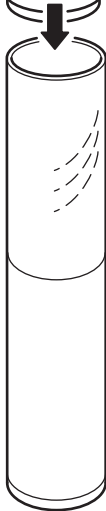
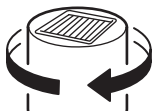

2

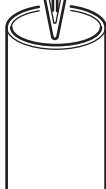
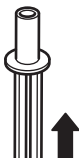

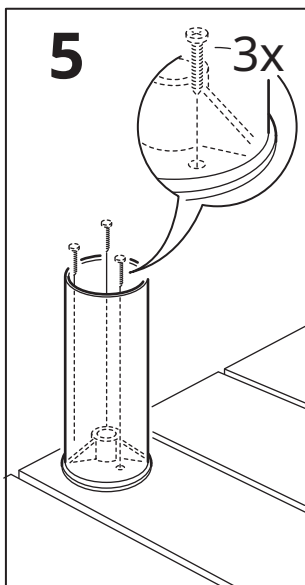
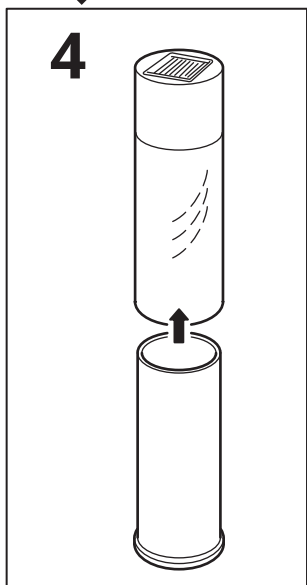
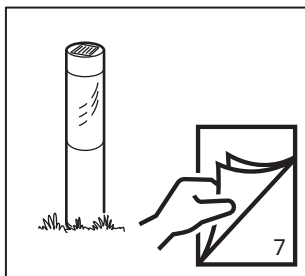
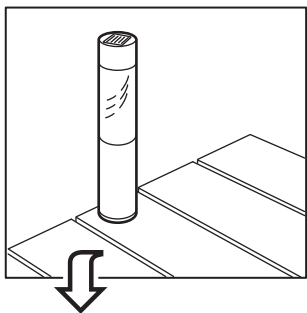

6

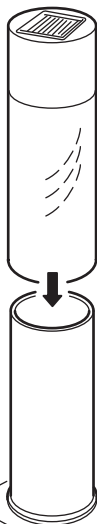

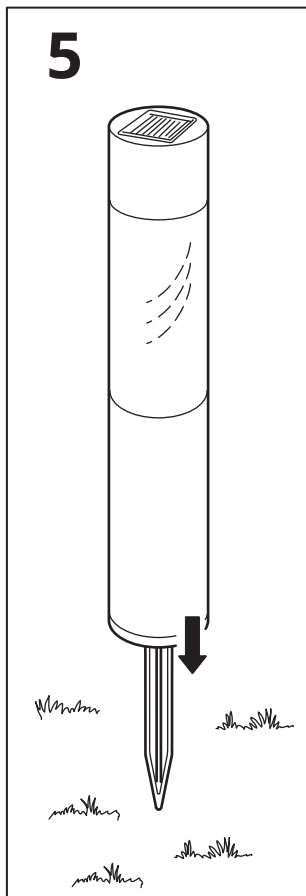
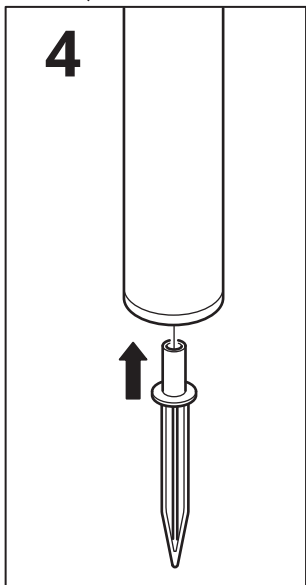
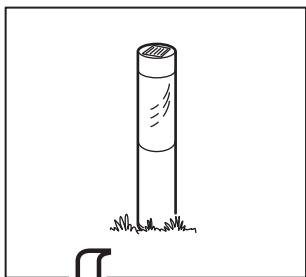

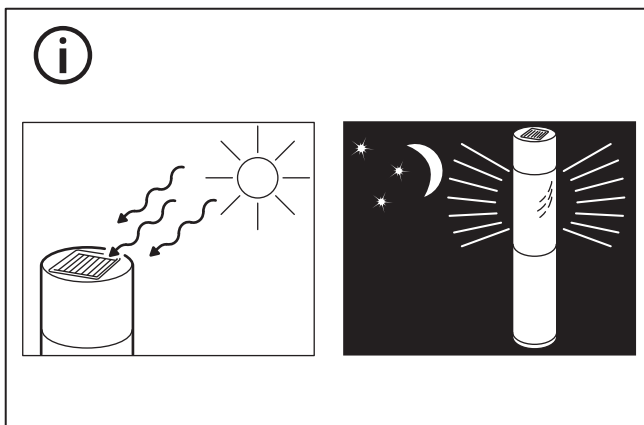
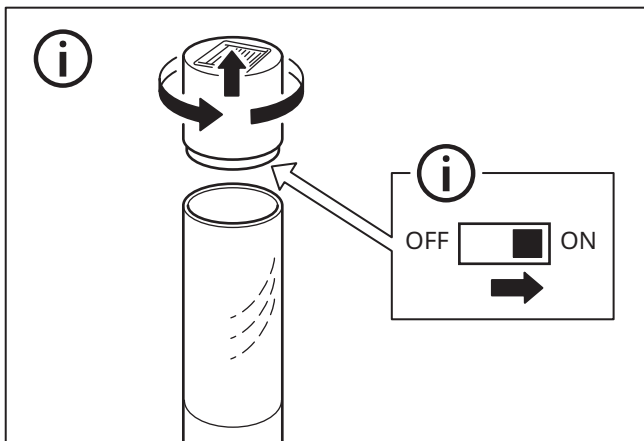



OFF ☐ ON
➔

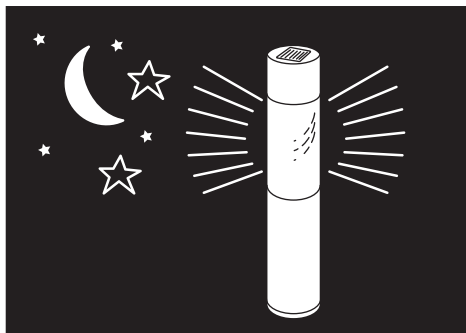
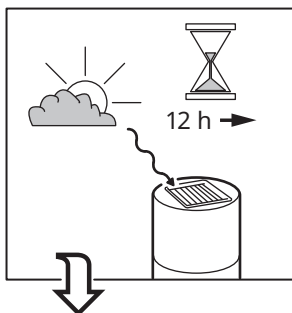
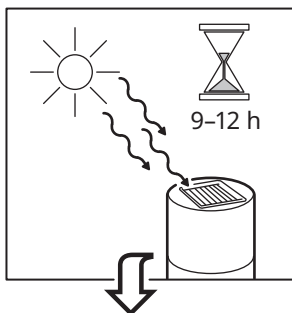

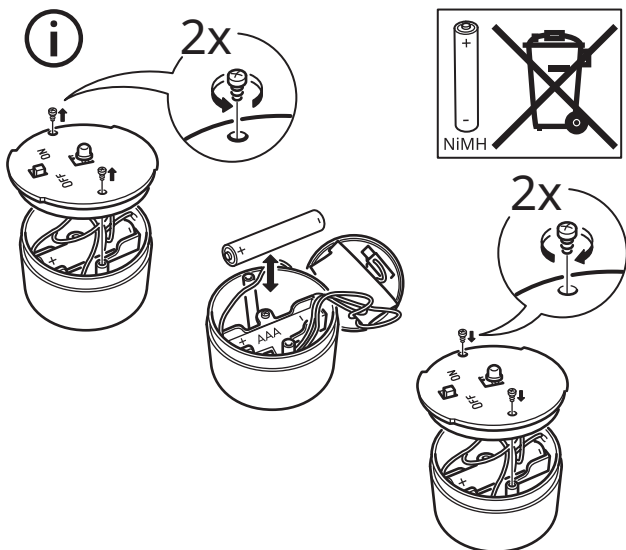

English

After approximately 2 years, the rechargeable battery needs to be replaced when the lamp doesn't light up. Replace only with Ni-MH rechargeable 1.2V, 750mAh, AAA type batteries.

The light source of this luminaire is not replaceable; when the light source reaches its end of life the whole luminaire shall be replaced. SAVE THESE INSTRUCTIONS FOR FUTURE USE.

עברית

לאחר כשנתיים, יש להחליף את הסוללות הנטענות כאשר המנורה אינה נדלקת. יש להחליף אך ורק בסוללת Ni-MH נטענת, 1.2V, 750mAh, AAA. מקור האור אינו ניתן להחלפה; לכן, כשמקור האור יגיע לסוף תוחלת חייו, יהיה עליכם להחליף את המנורה כולה. שמרו הוראות אלה לשימוש עתידי.