

NORBERG

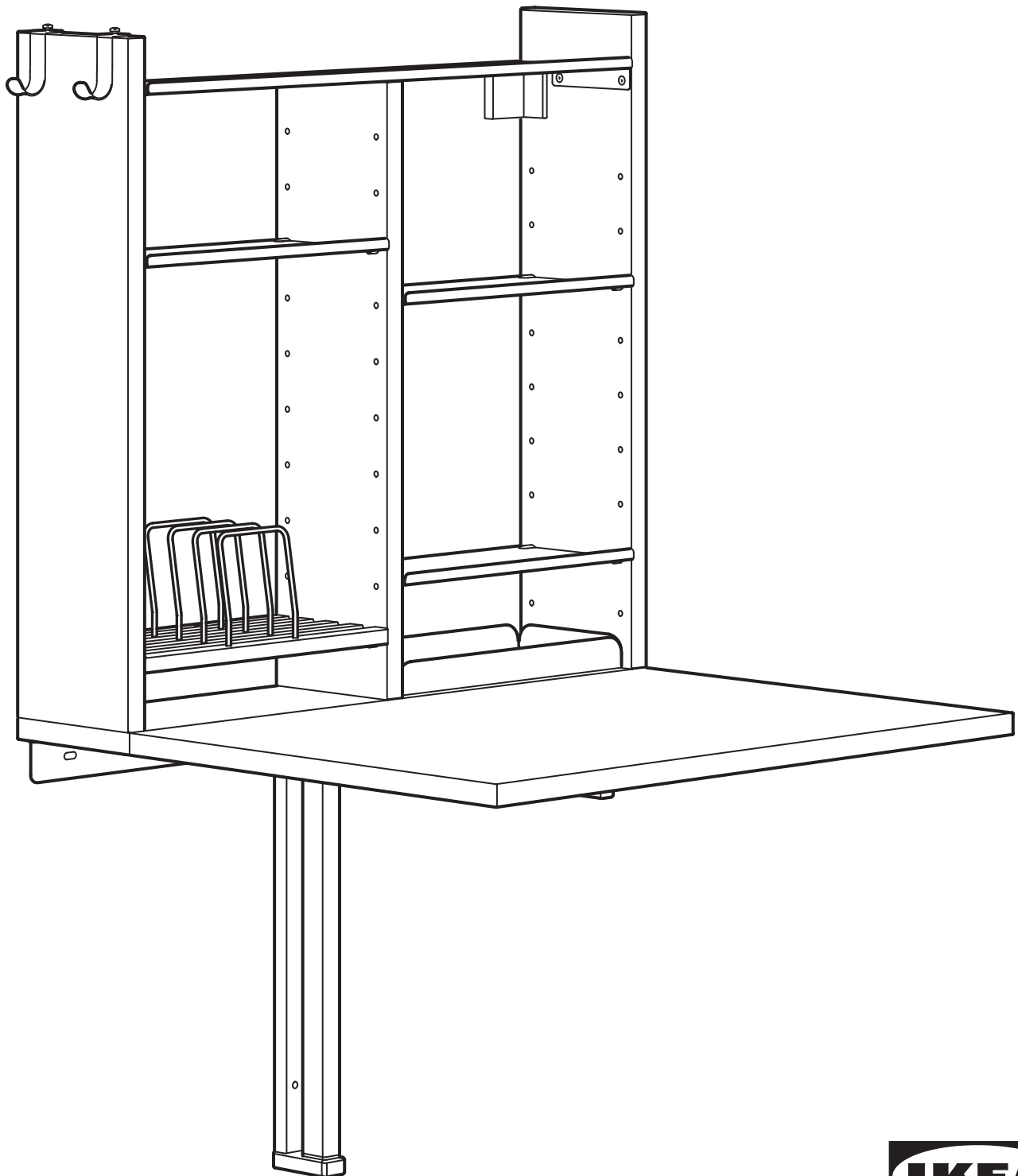

Design and Quality
IKEA of Sweden

English

The assembly should be carried out by a qualified person due to the fact that wrong assembly can lead to that the furniture/object topples or falls resulting in personal injury or damage.

NOTE! Screws or fittings to fix the furniture/object to the wall/ceiling are not included. Always choose screws and fittings that are specially suited to the material in your wall/ceiling and have sufficient holding power. If you are uncertain, contact your local specialised retailer.

עברית

להרכבה על ידי אדם מיומן בלבד, היות ורהיט שהורכב בצורה שגויה עלול להתמוטט או ליפול ולגרום לפציעה או נזק אחר. יש לוודא כי חלק הקיר המיועד חזק מספיק לתליית או קיבוע רהיטים. שימו לב! קירות שונים עשויים מחומרים שונים, לכן האריזה אינה כוללת אבזרי חיבור. בחרו ברגים על פי משקל הרהיטים שברצונכם לתלות או לקבע. אם אינכם בטוחים, מומלץ להתייעץ עם איש מקצוע או לפנות לחנות מתמחה בנוגע לאבזרי החיבור המתאימים לכם.

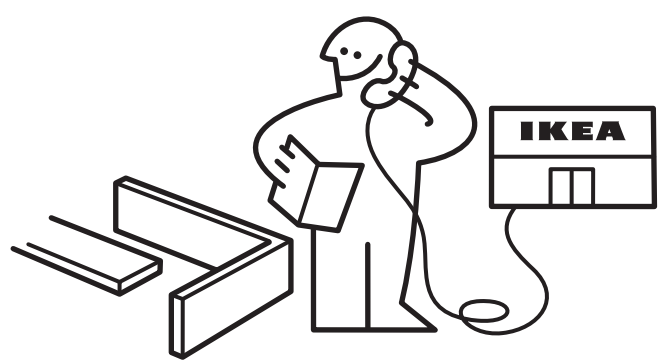
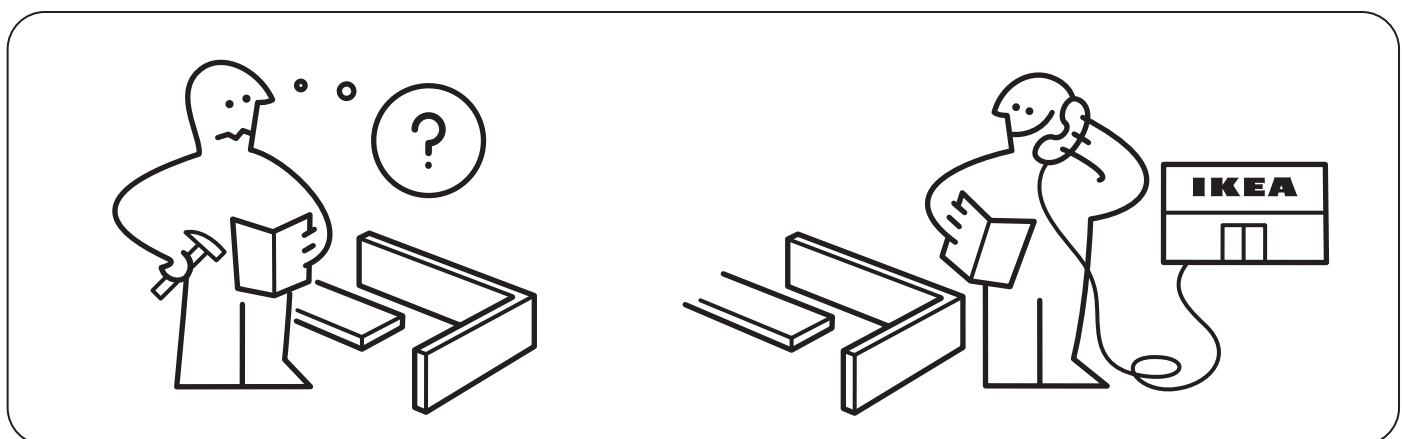
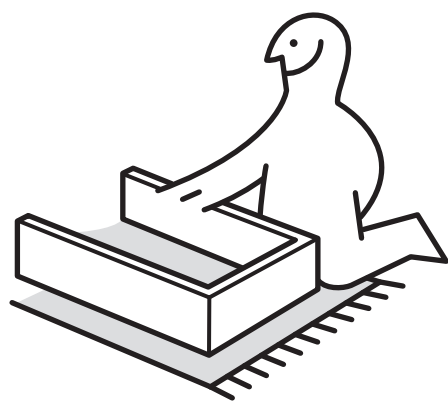
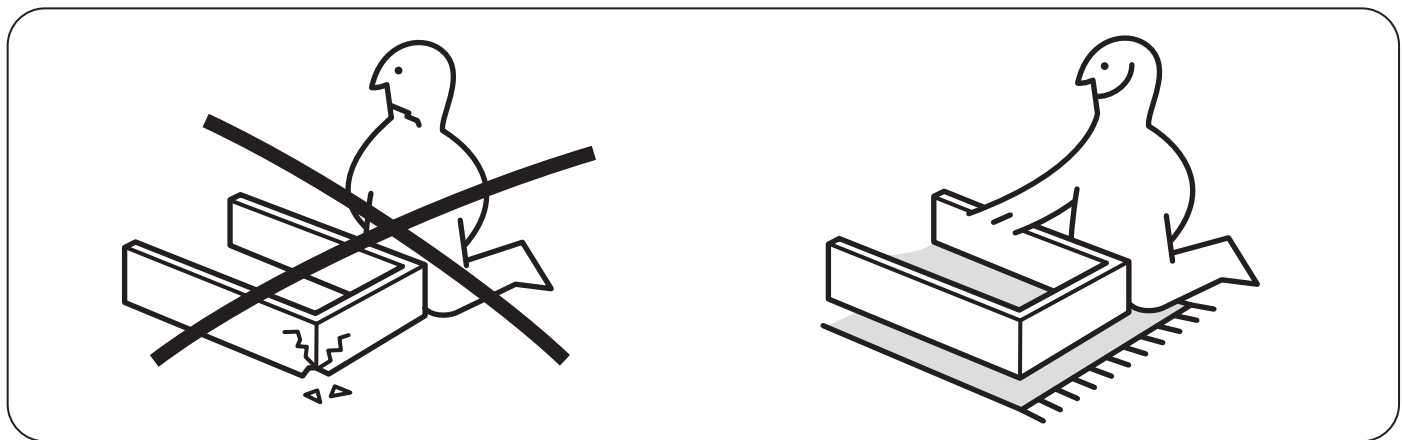
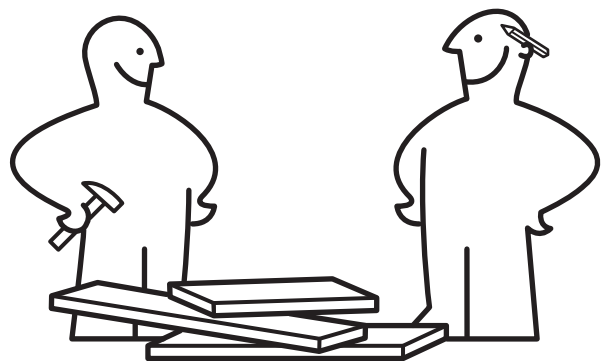
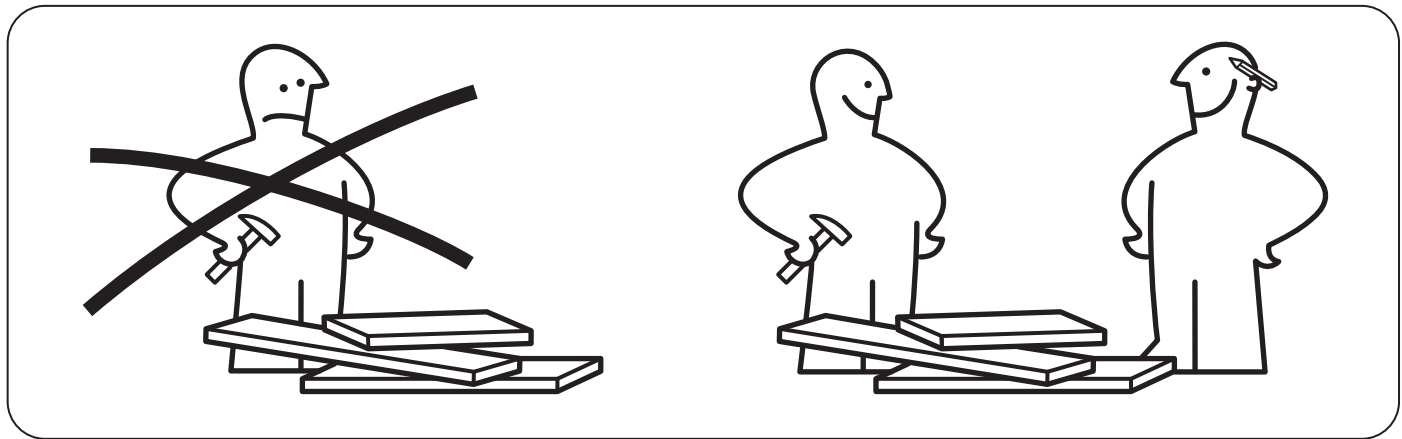
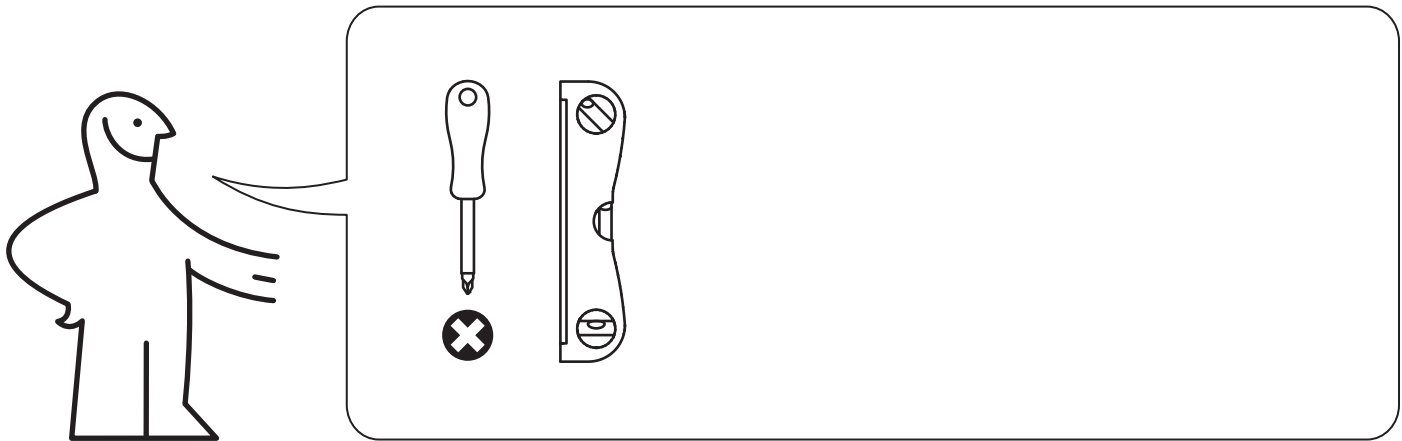

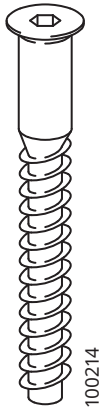

100214

4x



100372

30x

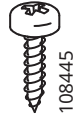

108445

2x

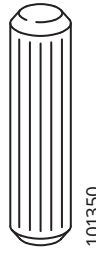

101350

4x

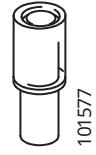

101577

16x

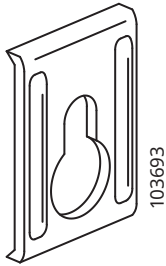

103693

2x

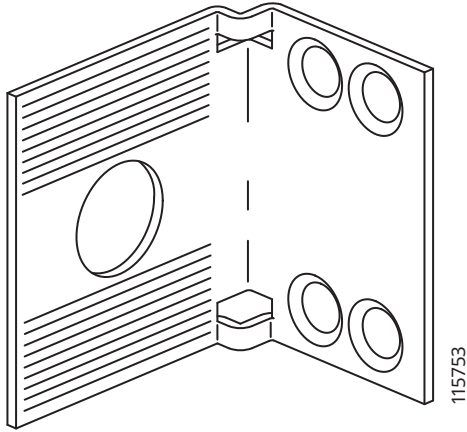

115753

2x

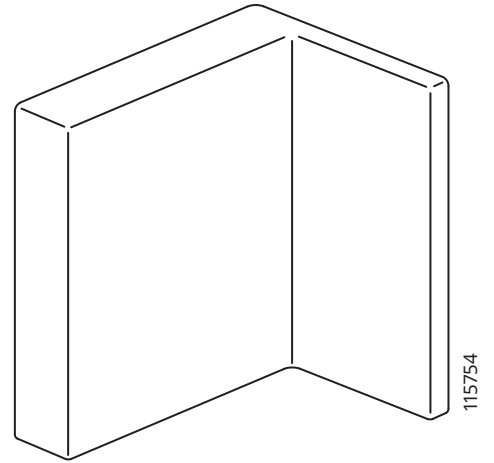

115754

2x

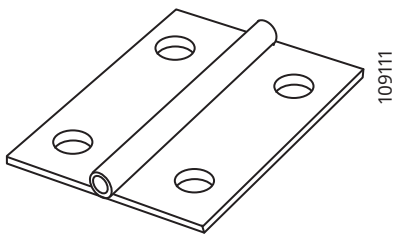

109111

3x

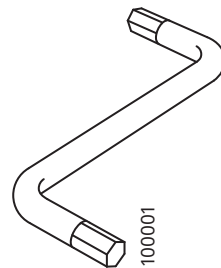

100001

1x

1

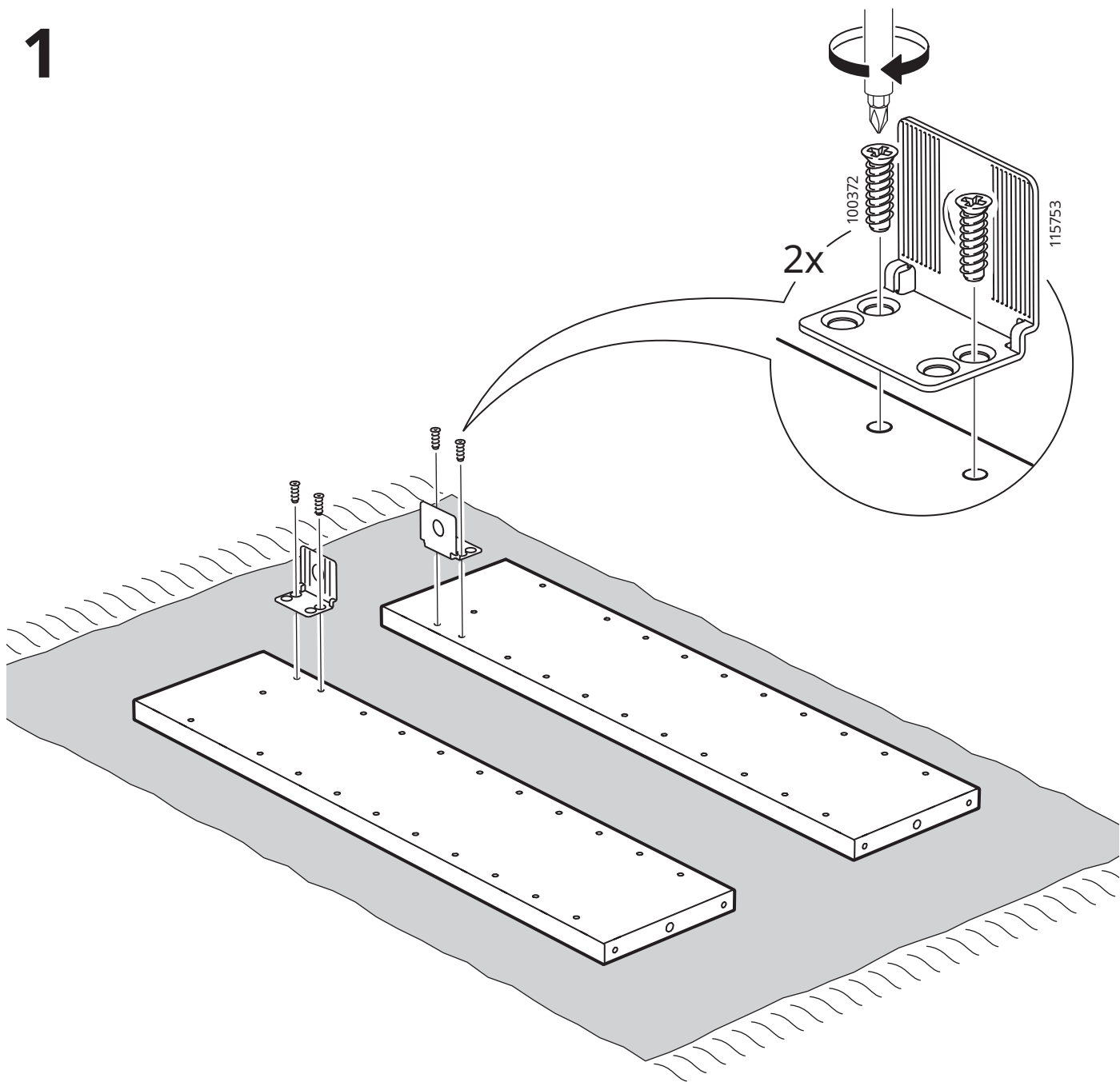

2

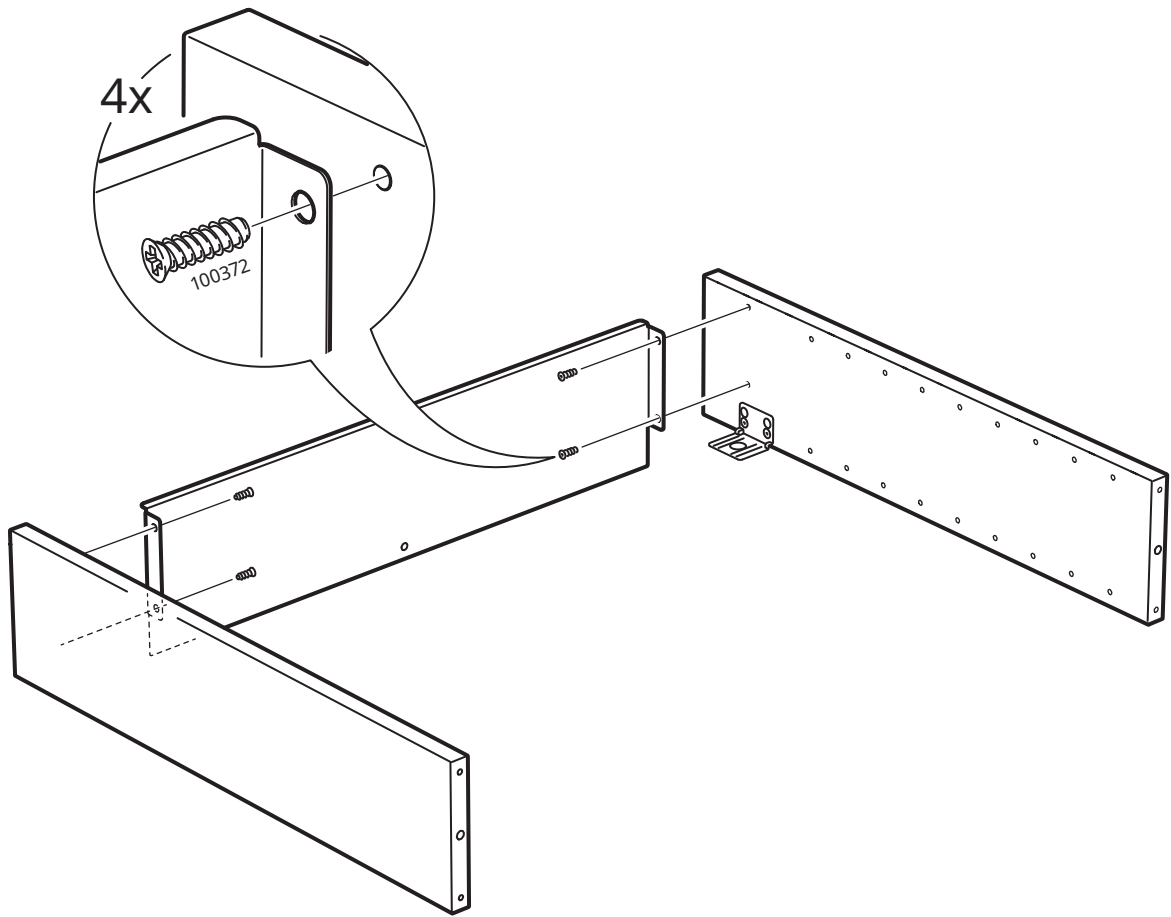

3

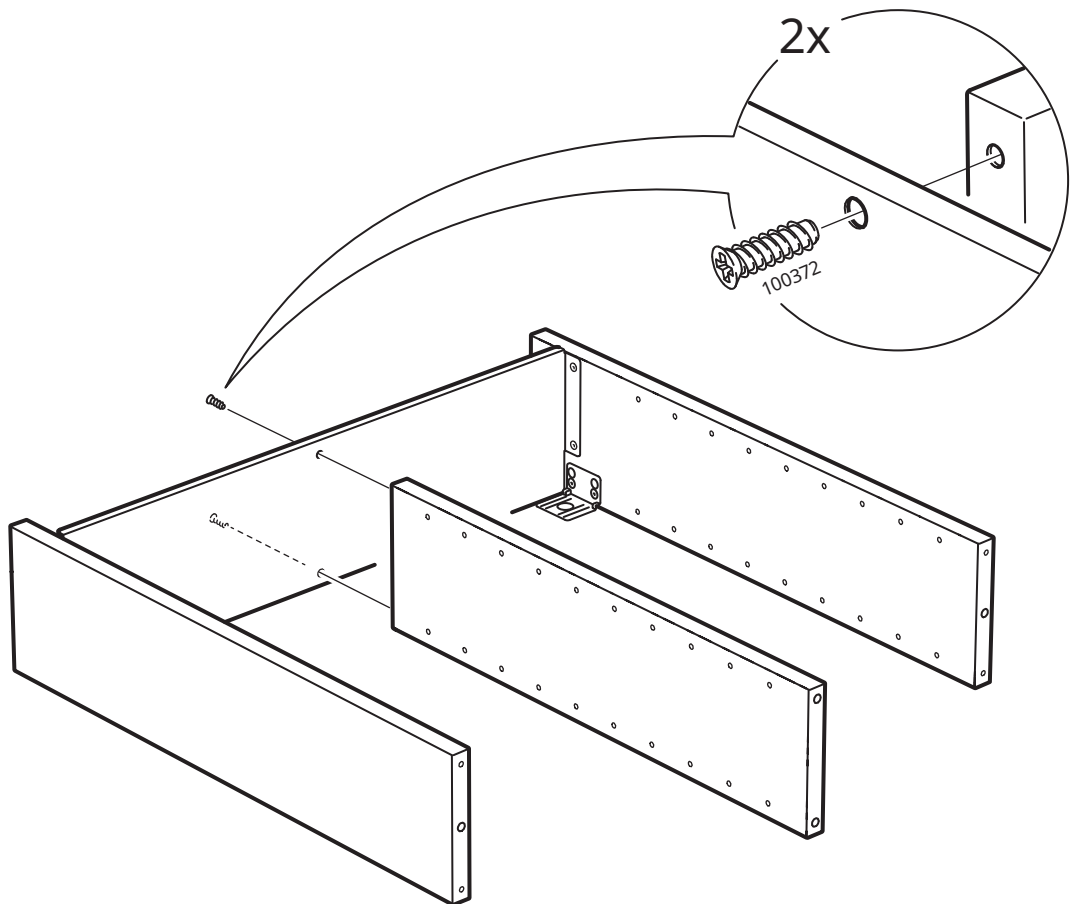

4

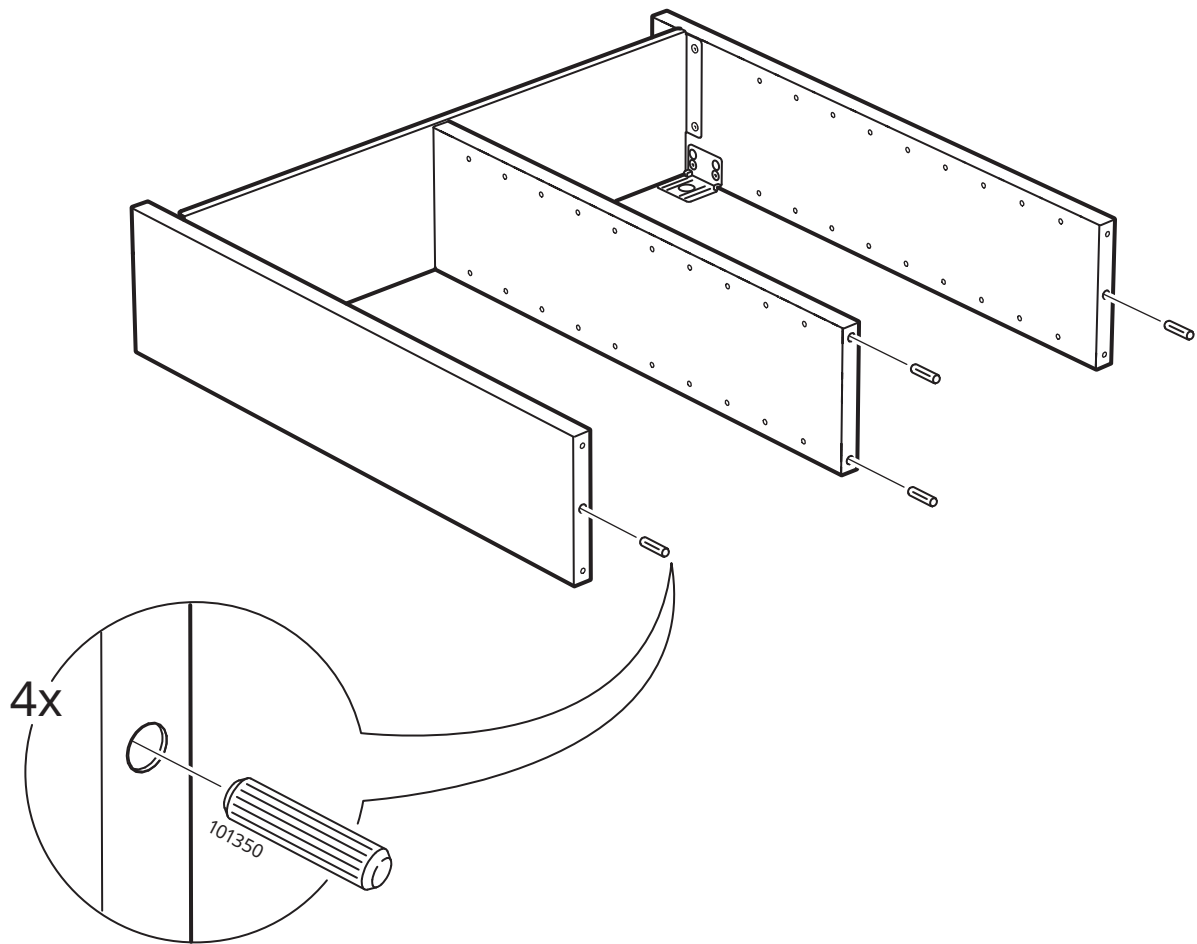

5

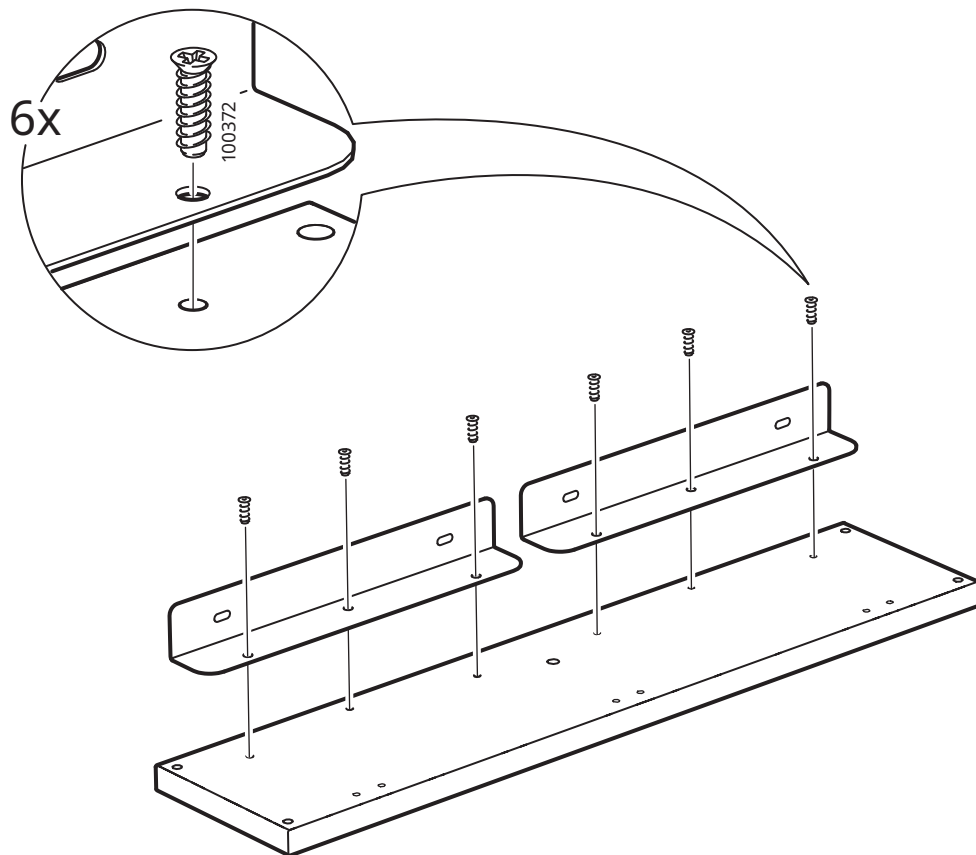

6

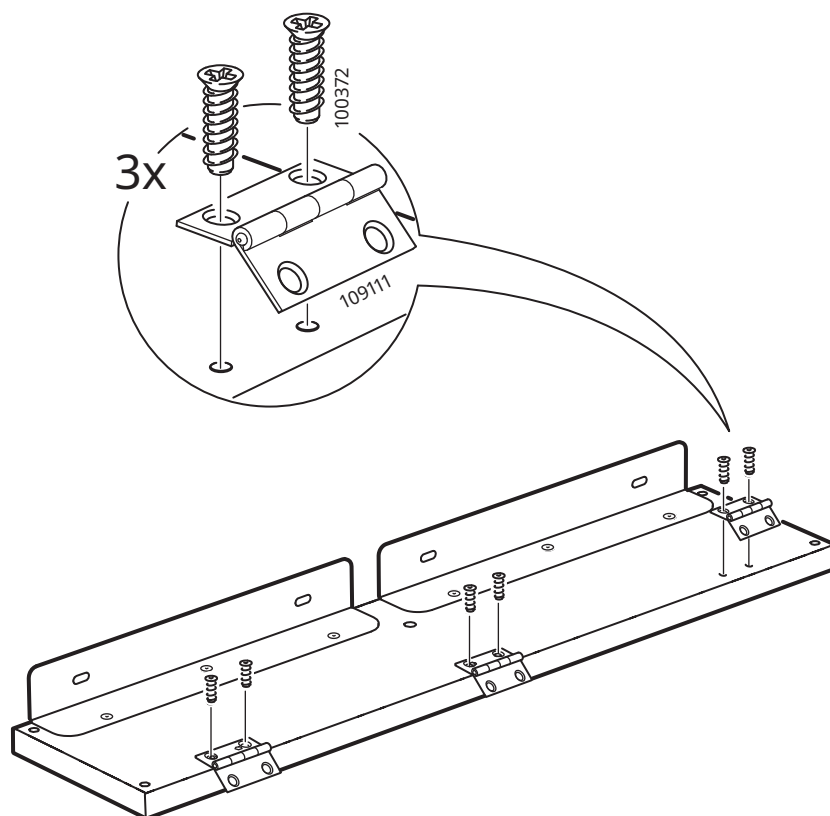

7

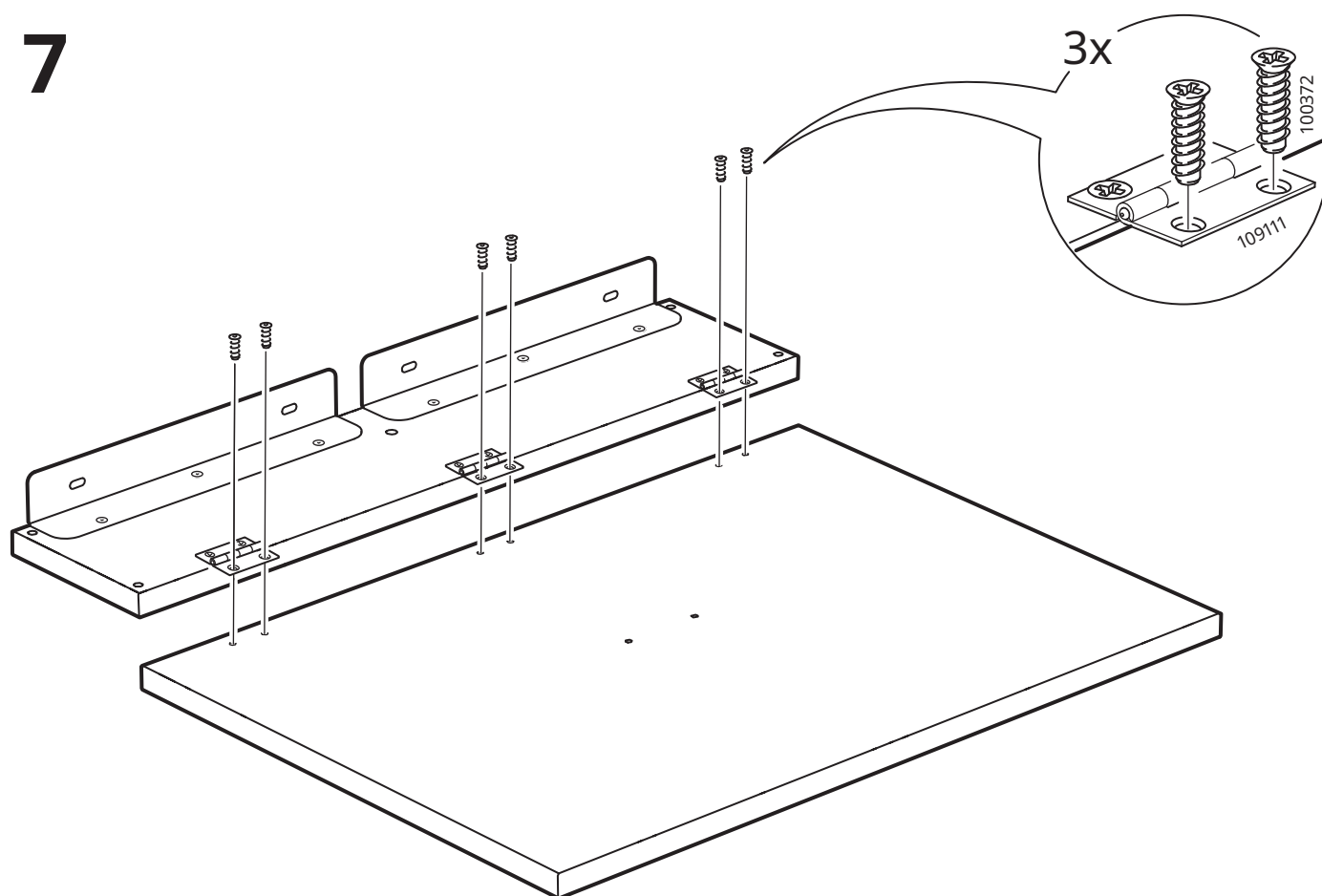

8

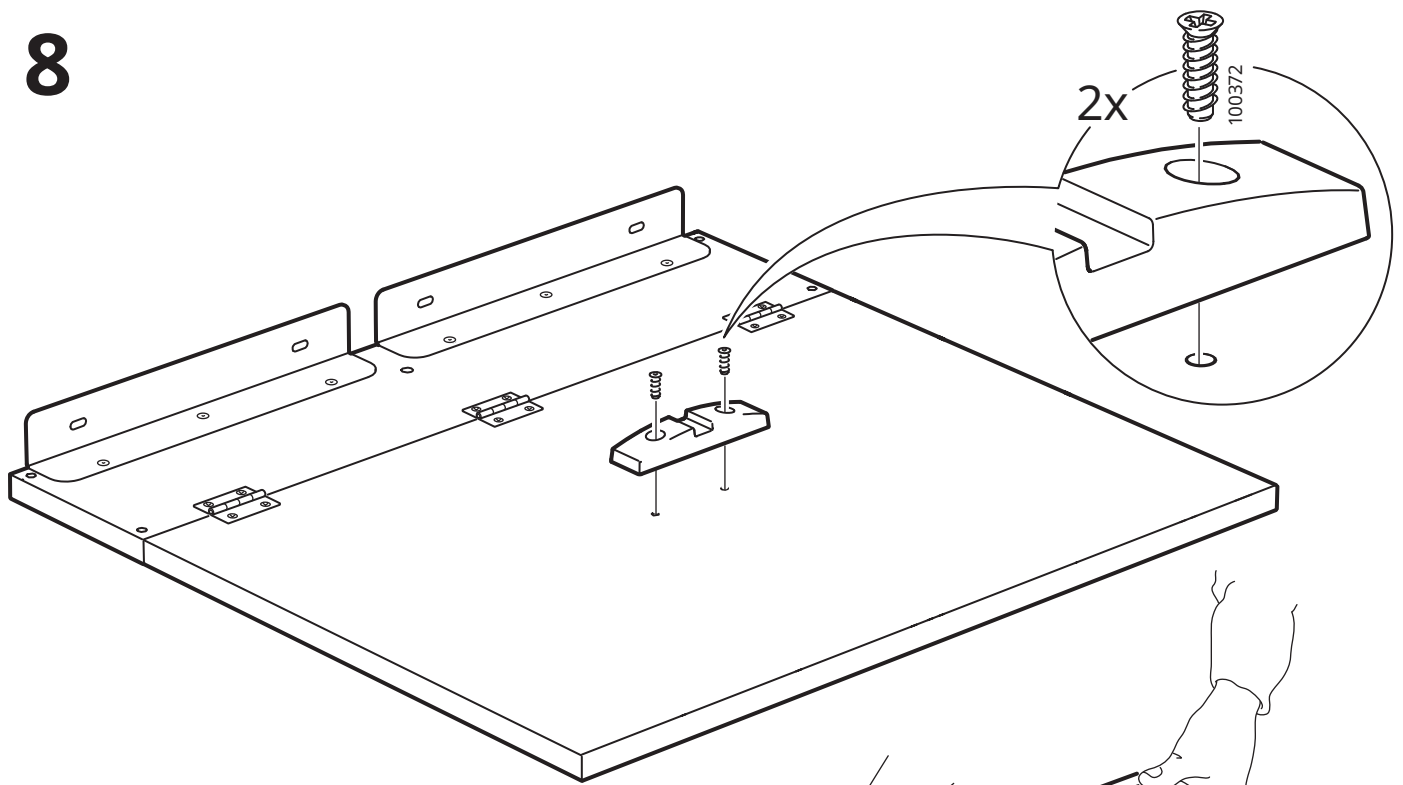

9

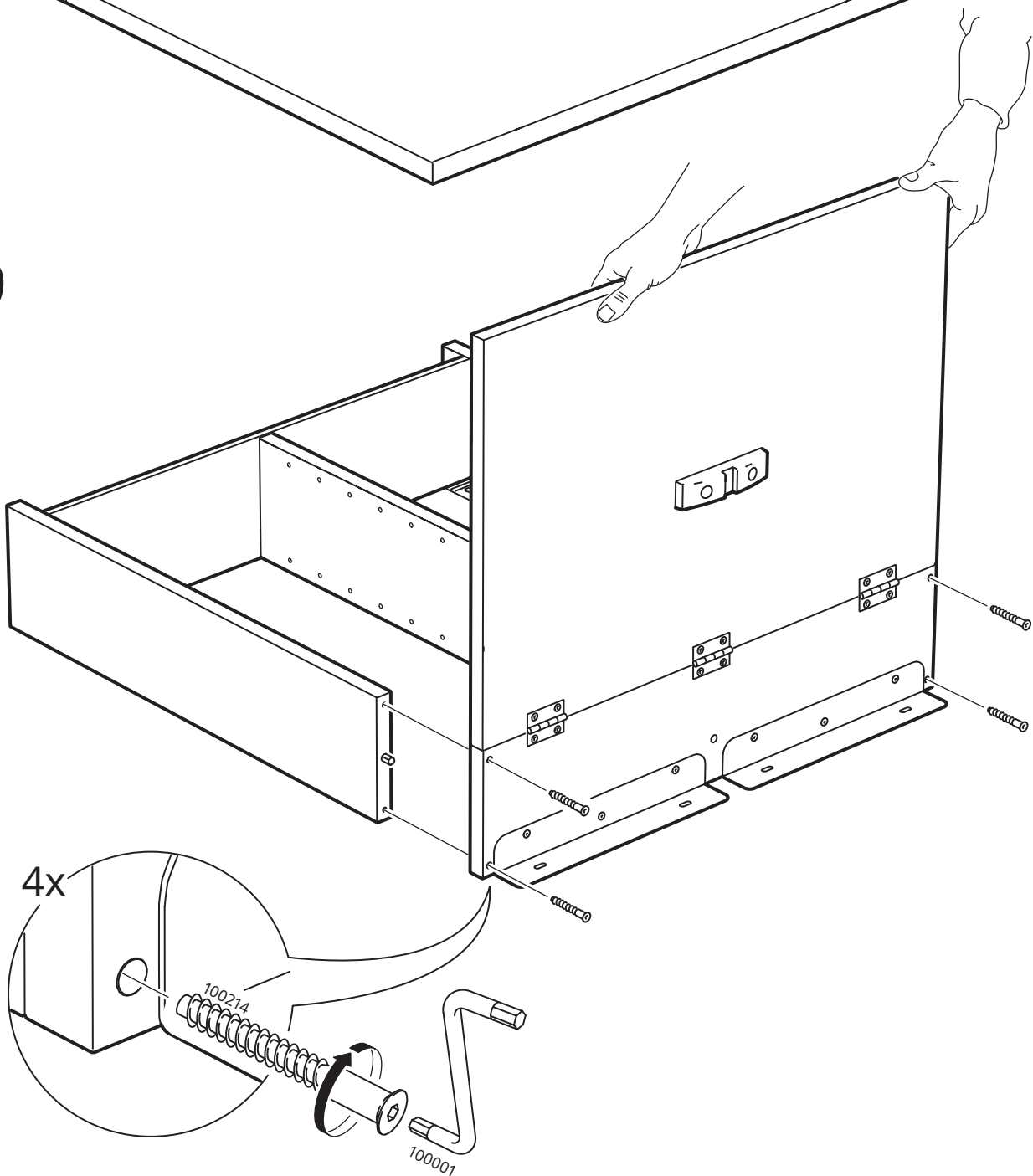

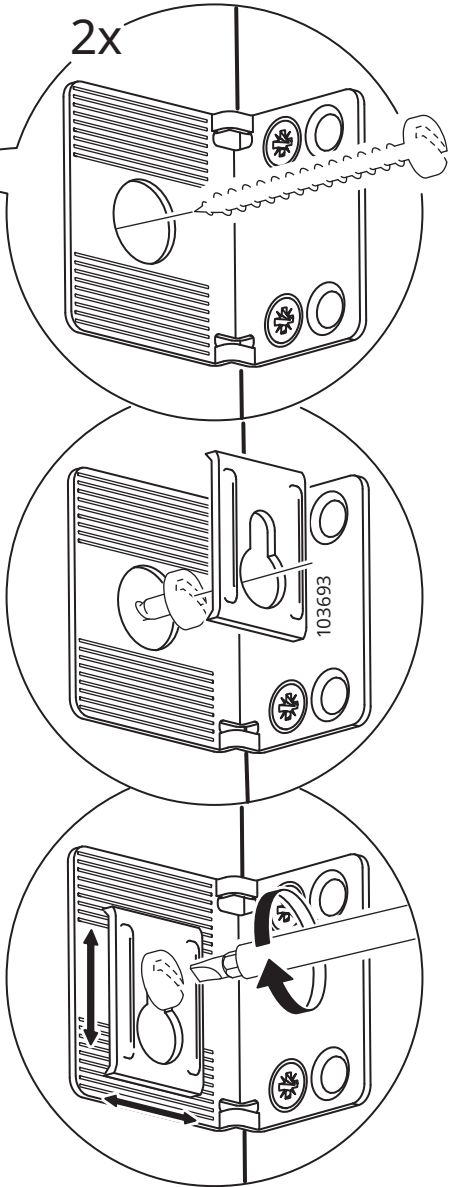
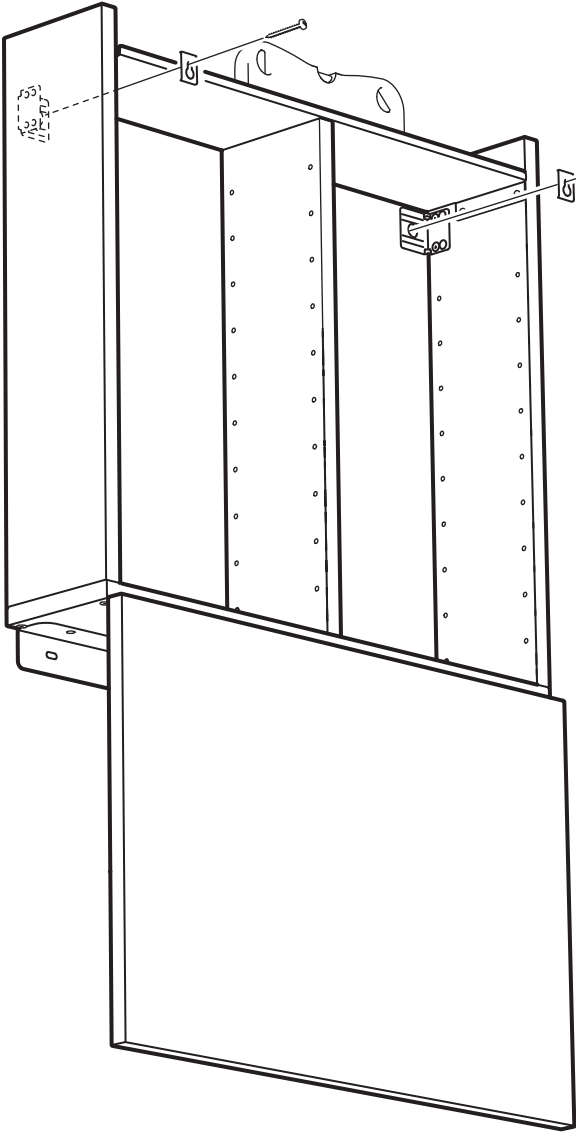

11

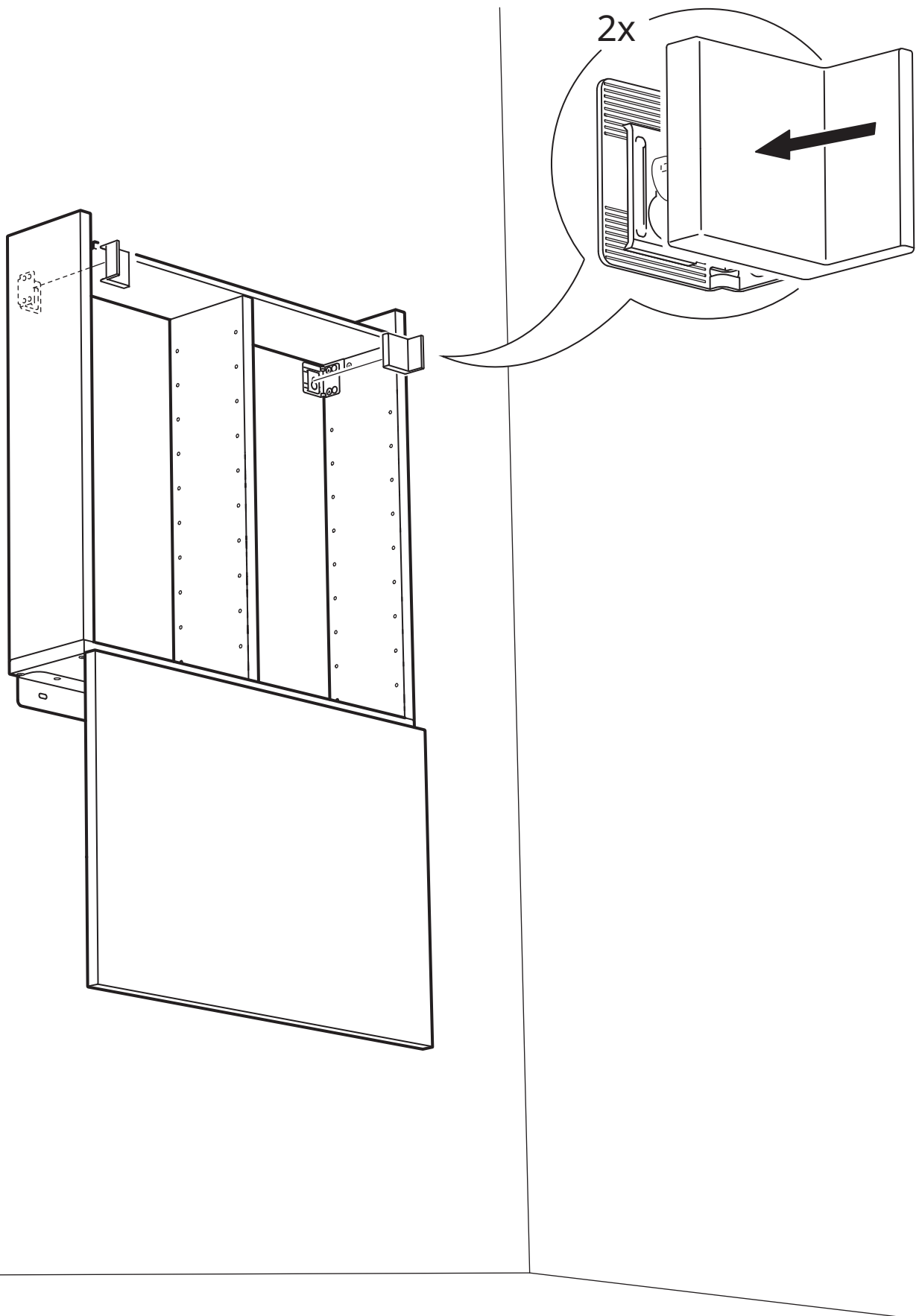

12

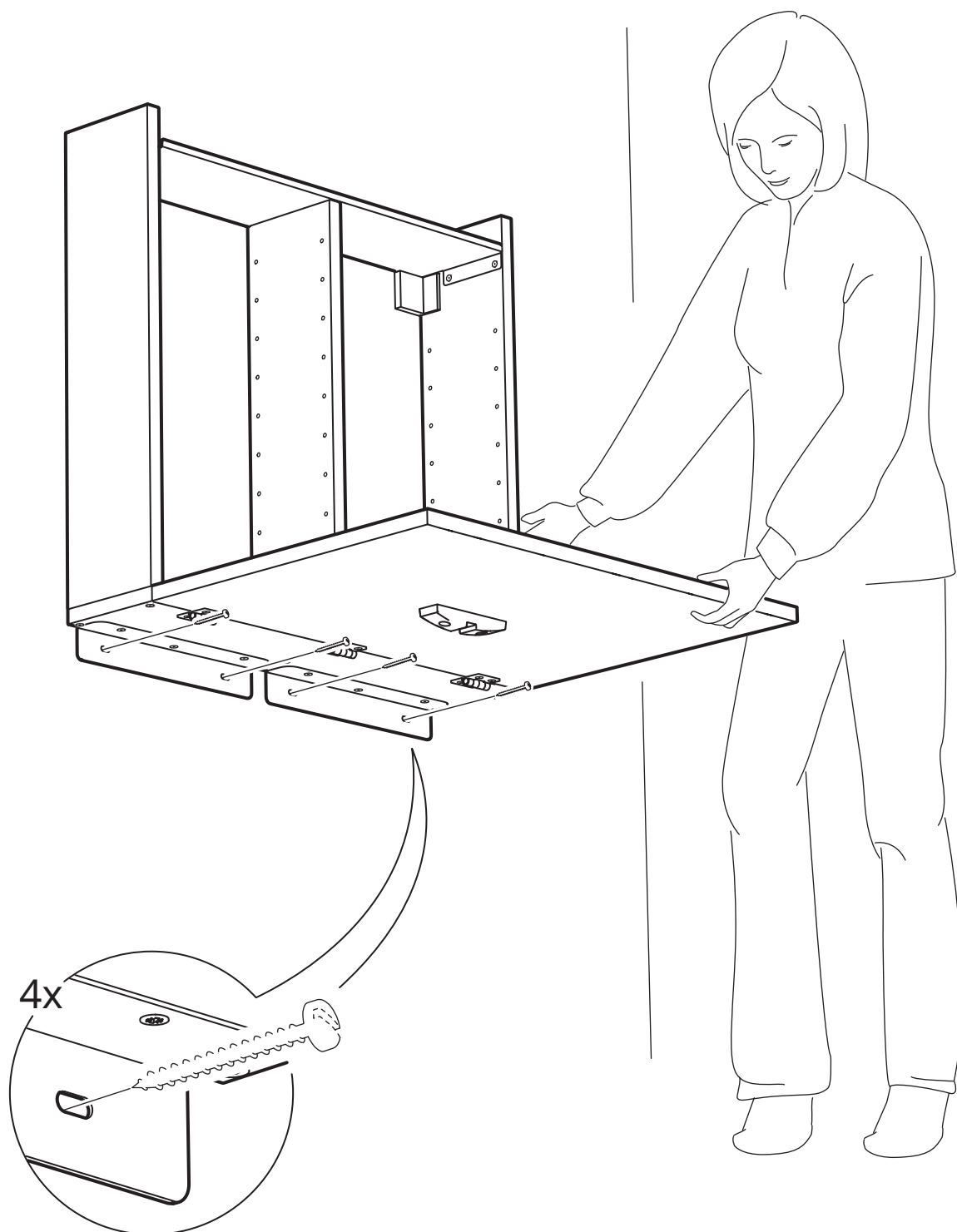

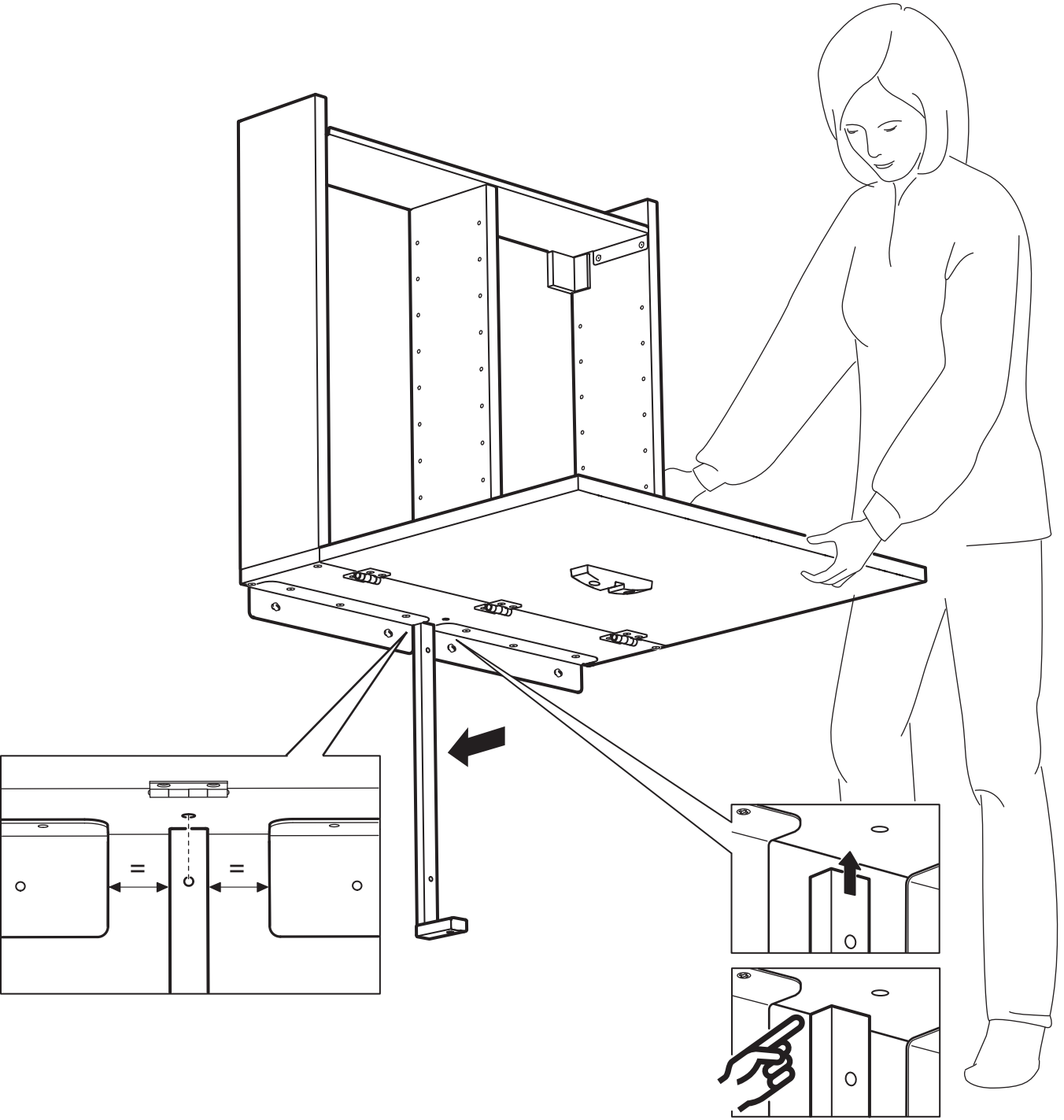

14

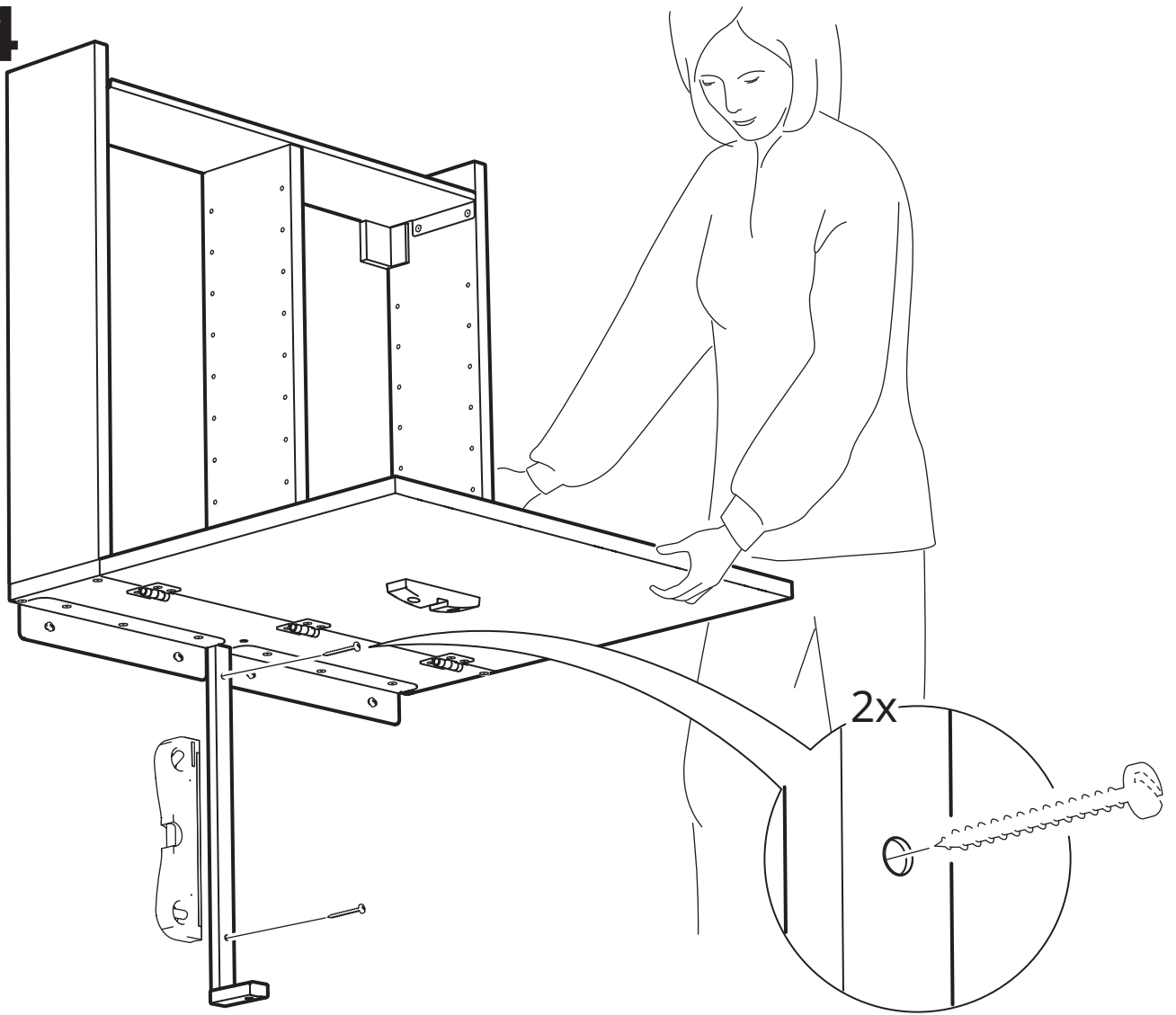

15

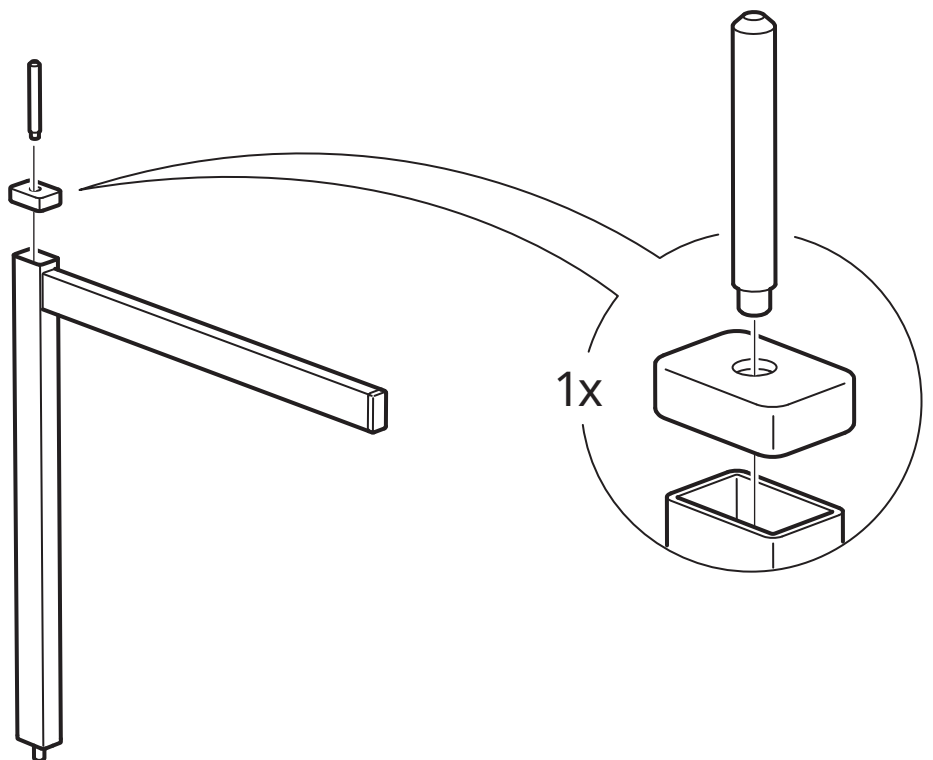

16

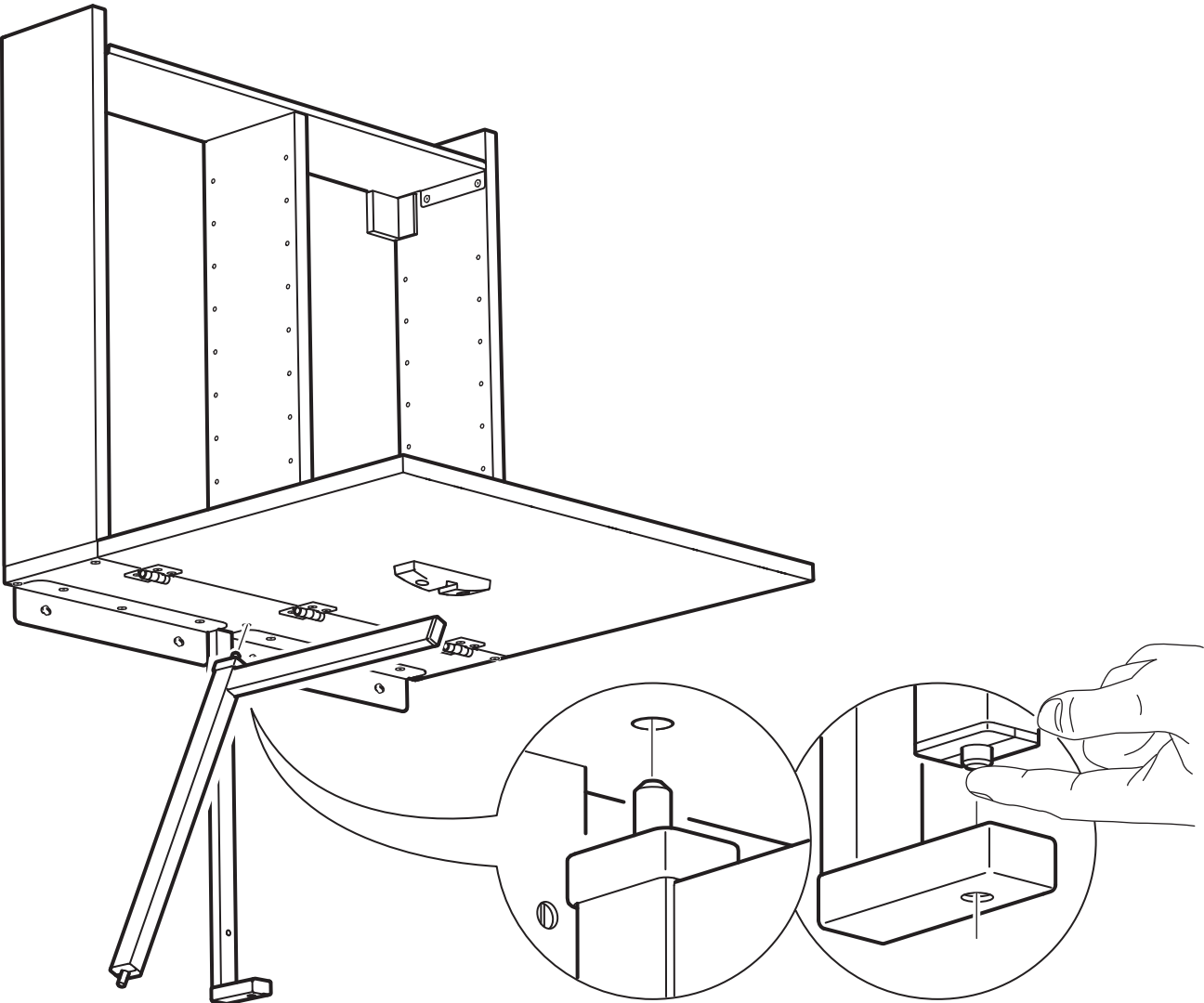

17

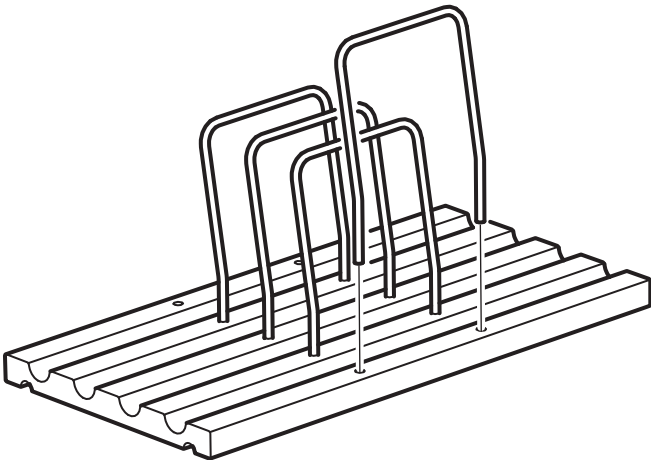

18

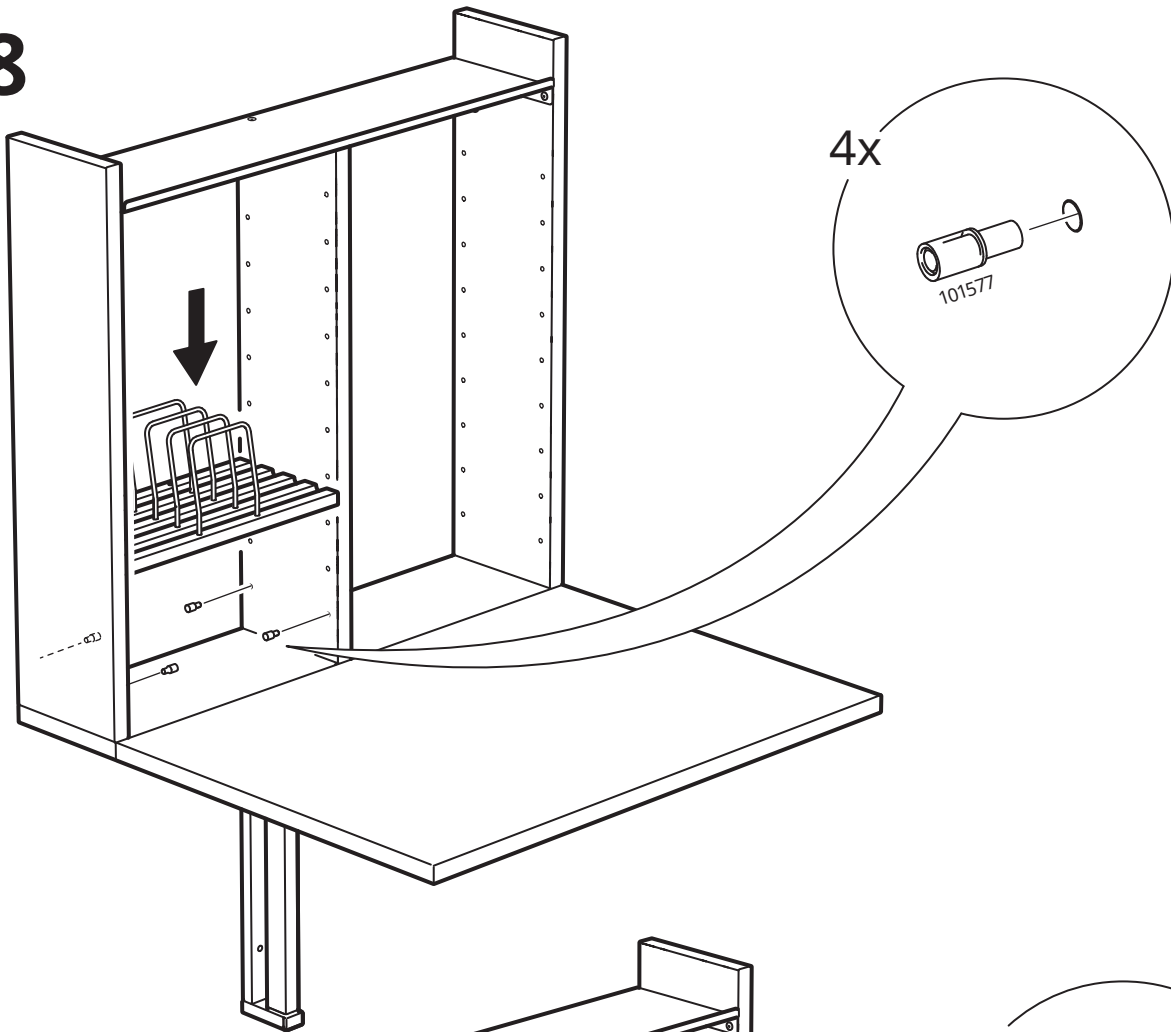

19

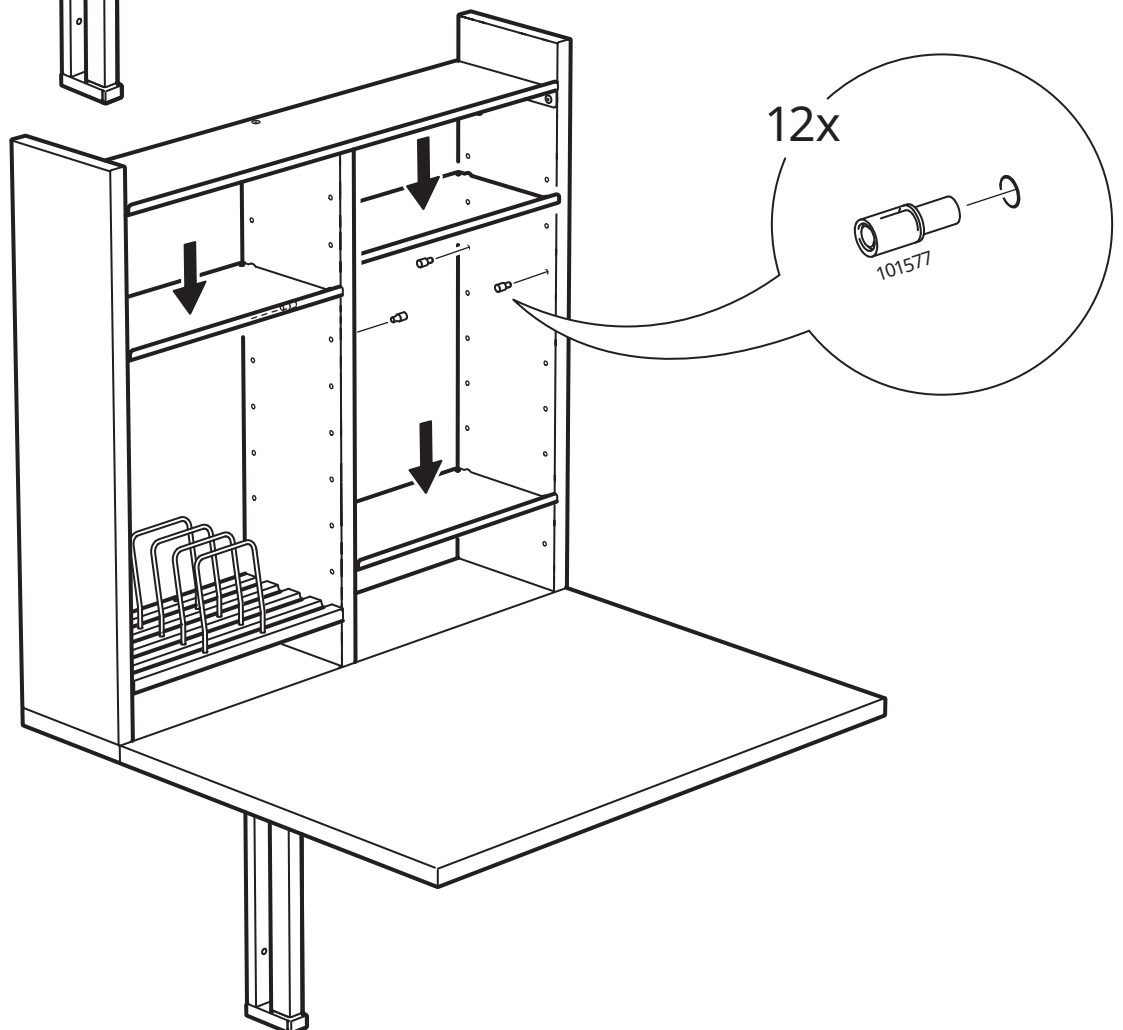

20

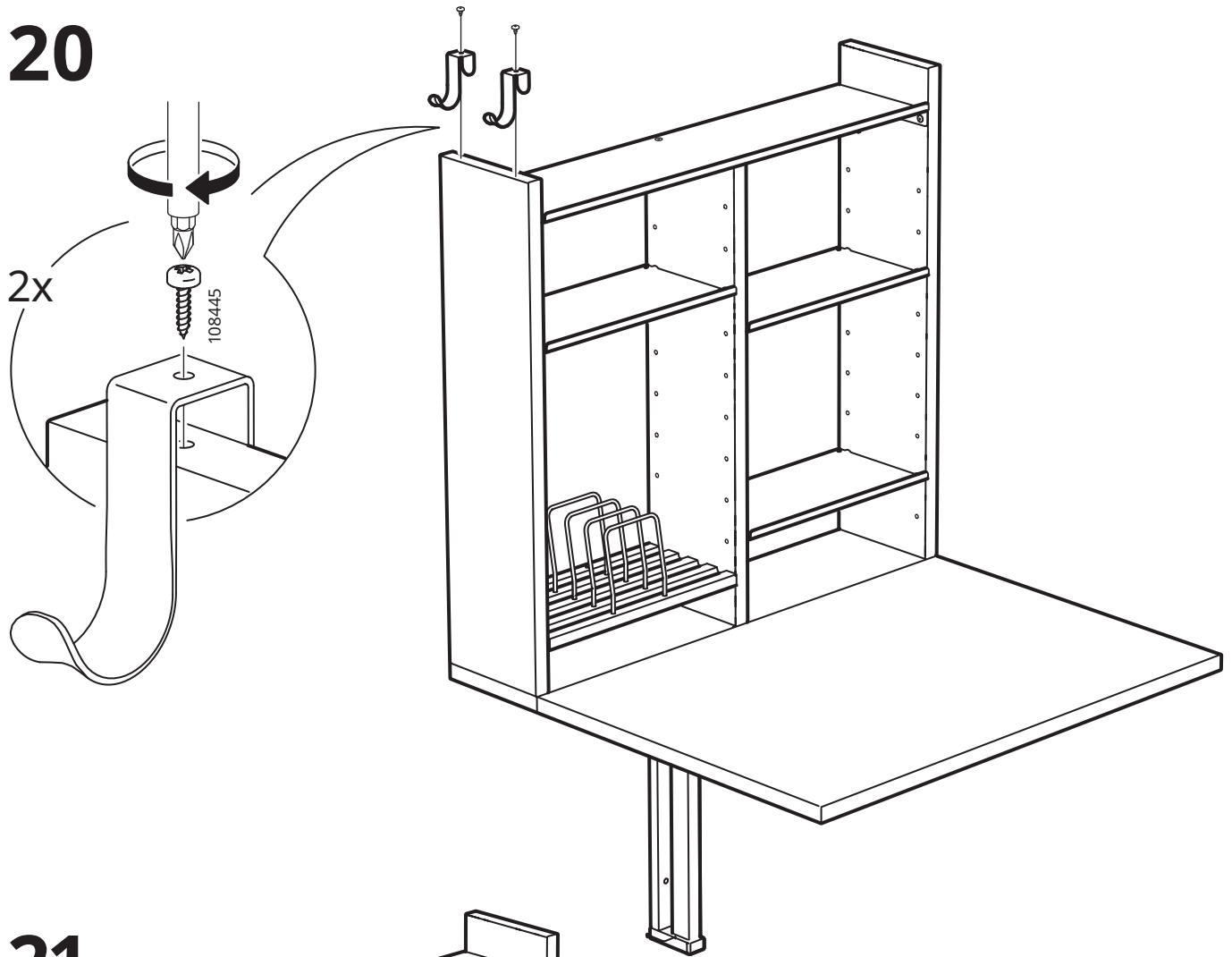

21

