

# SMAKSAK

GB



Design and Quality  
IKEA of Sweden



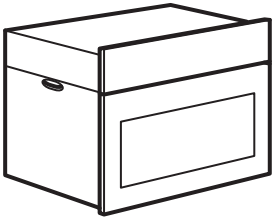
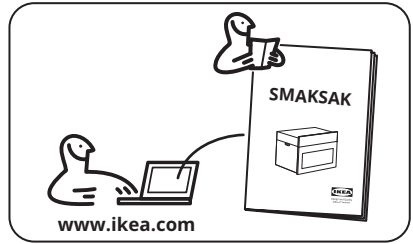
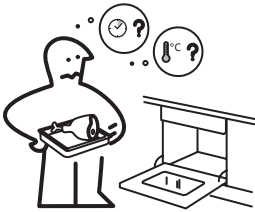

1x

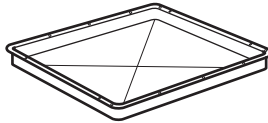

1x



1x



1x

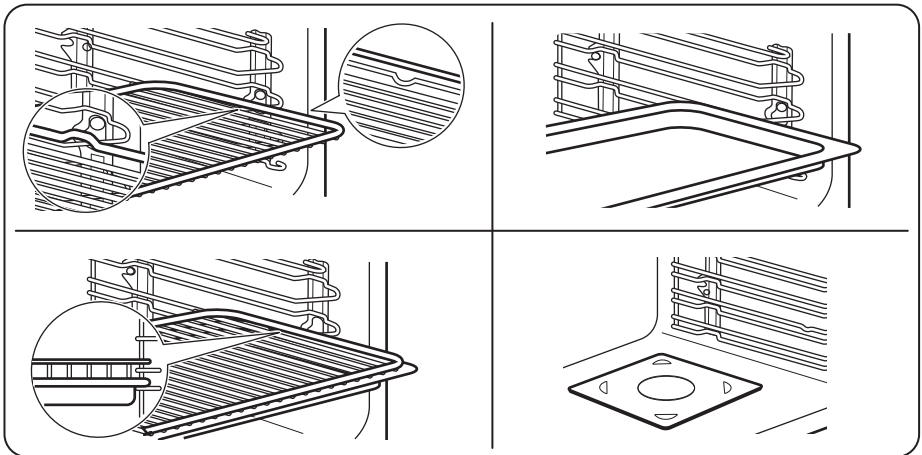

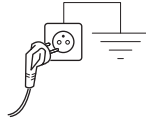

- 1
- 2

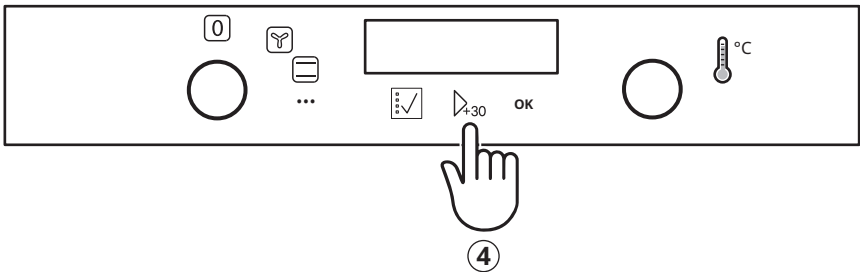
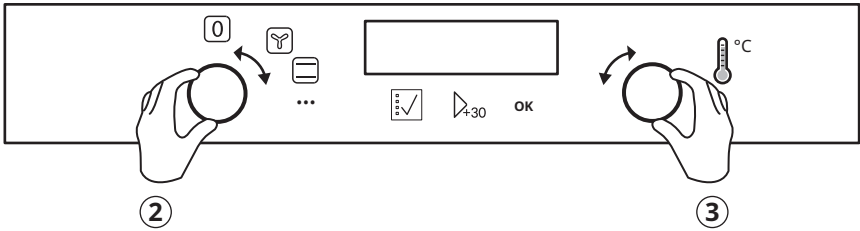
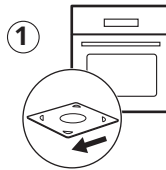

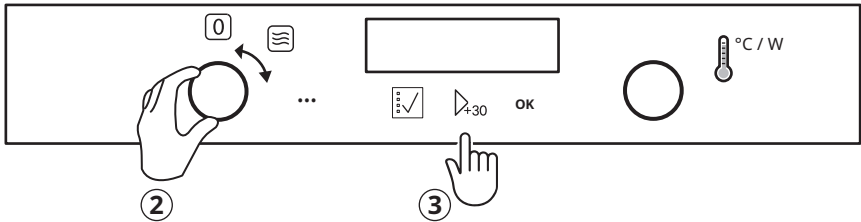
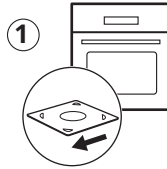
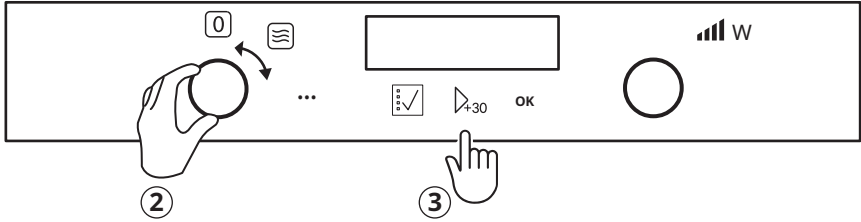
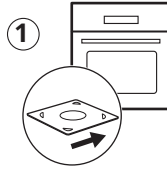

**General overview**

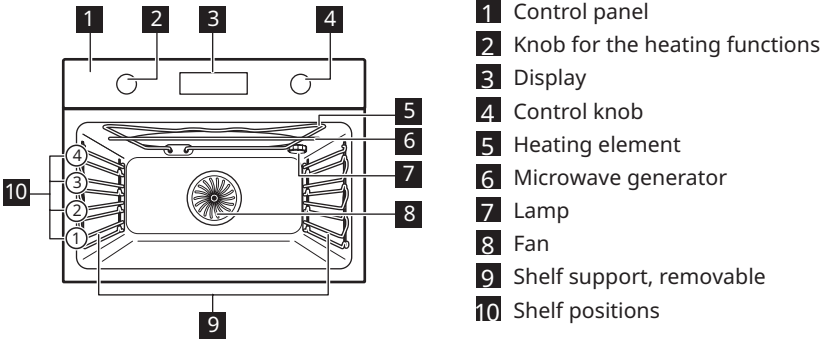

**Buttons**

		OK
To set the clock functions, microwave power. To check the oven temperature. Use only while a heating function operates.	To start a heating function. Press to extend Microwave function duration for 30 seconds. Also to extend Microwave function duration for 30 seconds.	To confirm.



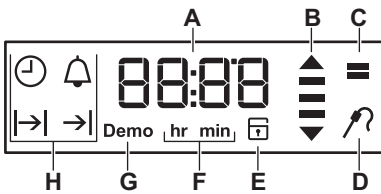





**Display**



- A. Timer / Temperature / Microwave power
- B. Heat-up and residual heat indicator
- C. Microwave mode
- D. Food Sensor (selected models only)
- E. Door lock (selected models only)
- F. Hours / minutes
- G. Demo mode (selected models only)
- H. Clock functions

**Heating Functions**

- Off position**      The oven is off
- Forced Air Cooking**      Even baking, tenderness, drying
- Conventional (Top and Bottom Heat)**      Traditional baking
- Grilling**      Grilling, toasting

-  **True Fan** Baking
-  **Cooking + MW**
-  **Conventional Cooking + MW** Baking, roasting
-  **Grill + MW** Cooking, browning.
-  **Microwave** Heating up, cooking, power range: 100 - 1000 W
-  **Liquids** Heating up drinks and soups, power range: 800 - 1000 W
-  **Defrost** Defrosting meat, fish, cakes, power range: 100 - 200 W
-  **Reheating** Heating up pre-prepared meals and delicate food, power range: 300 - 700 W

## Microwave suitable cookware and materials

For the microwave use only suitable cookware and materials. Use below table as a reference.

Check the cookware / material specification before use.

Cookware / Material	Microwave function		Microwave Combi function e.g. 
	Defrosting	Heating, Cooking	
Ovenproof glass and porcelain with no metal components, e.g. heat-proof glass	✓	✓	✓
Non-ovenproof glass and porcelain without any silver, gold, platinum or other metal decorations	✓	X	X
Glass and glass ceramic made of ovenproof / frost-proof material	✓	✓	✓
Ceramic and earthenware without any quartz or metal components and glazes which contain metal	✓	✓	X
Ceramic, porcelain and earthenware with unglazed bottom or with small holes, e.g. on handles	X	X	X
Heat-resistant plastic up to 200 °C	✓	✓	X
Cardboard, paper	✓	X	X
Clingfilm	✓	X	X
Roasting film with microwave safe closure	✓	✓	X
Roasting dishes made of metal, e.g. enamel, cast iron	X	X	✓
Baking tins, black lacquer or silicon-coated	X	X	✓
Baking tray	X	X	X
Wire shelf	X	X	✓
Microwave glass bottom plate	✓	✓	X
Cookware for microwave use, e.g. crisp pan	X	✓	X

## Troubleshooting

If you encounter an issue with your appliance, check "Troubleshooting" chapter

in the full version of the User Manual available on: [www.ikea.com](http://www.ikea.com).

## Technical data

Dimensions (internal)	Width Height Depth	480 mm 217 mm 411 mm
Usable volumes	43 l	
Area of baking tray	1424 cm <sup>2</sup>	
Top heating element	1900 W	
Bottom heating element	1000 W	
Grill	1900 W	
Ring	1650 W	
Total rating	3000 W	
Voltage	230 - 240 V	
Frequency	50 Hz	
Number of functions	10	









867371702-A-222022

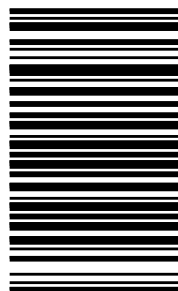

© Inter IKEA Systems B.V. 2022

21552

AA-2336062-2