

LAGAN

Freezer

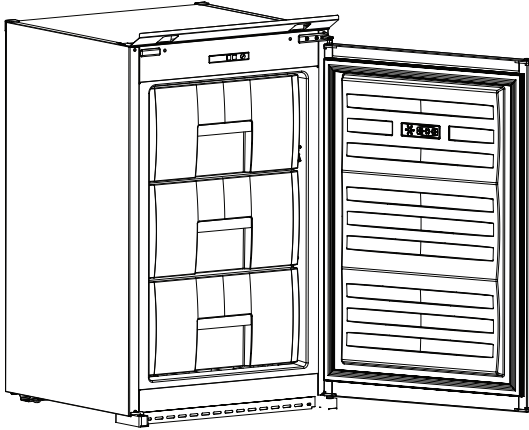

Design and Quality
IKEA of Sweden



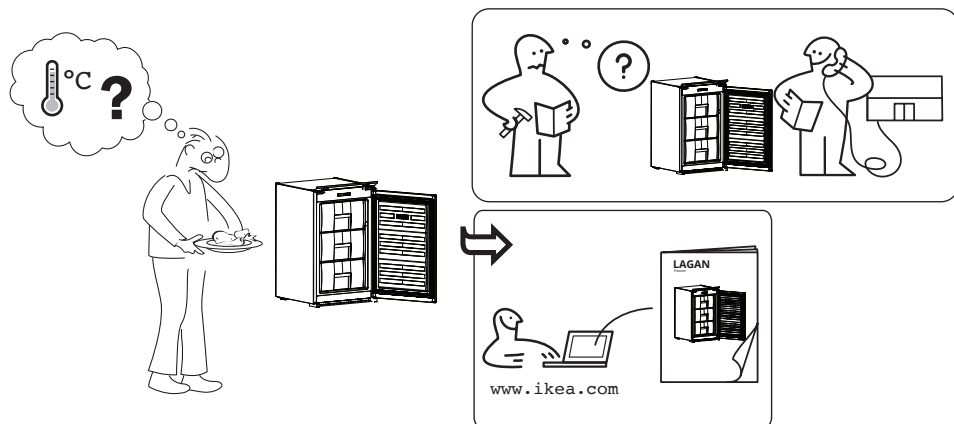

Product description

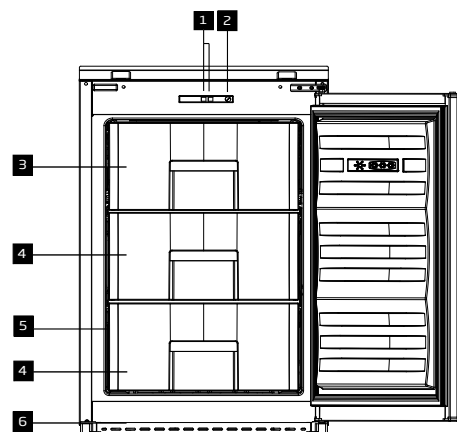

- 1 Indicator lights
- 2 Thermostat knob
- 3 Fast-freeze compartment
- 4 Freezer drawer
- 5 Rating Plate
- 6 Ventilation grid

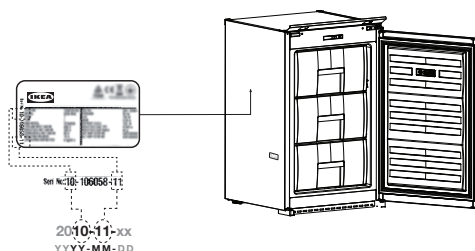

First Use

Before using your refrigerator, make sure the necessary preparations are made in line with the instructions in "Safety Information" and "Installation" sections.

If the product is transported horizontally, do not plug the product to power supply for first 4 hours.

Keep the product running without placing any food inside for 12 hours and do not open the door, unless absolutely necessary.

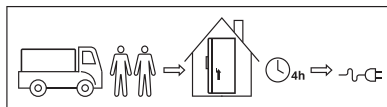

Daily use

Setting the operating temperature

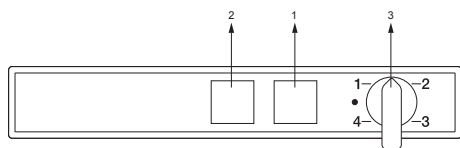

LED indicators and control panel

There are two coloured indicator lights located on the front of the appliance which shows the operating mode of the freezer.

Green Indicator (1):

Illuminates when the appliance is connected to the mains and will glow as long as electricity is available. The green light will not glow if the thermostat is set to '0' position. The green indicator does not give any indication of the temperature inside the freezer.

To turn off the appliance (0 position) please rotate the knob by applying slightly more force.

Red Indicator (2) Illuminates:

- a) If the pre-set temperature can not be maintained.
- b) If excessive amounts of fresh food are placed inside.
- c) If the appliance door is left open accidentally.

Thermostat knob (3)

Thermostat knob is located on the indicator light set. The operating temperature is regulated by the temperature control.

Cold ← ● 1 2 3 4 ● Coldest
(Or) Min. Colder Max.

1 = Lowest cooling setting

4 = Highest cooling setting

(Or)

Min. = Lowest cooling setting

Max. = Highest cooling setting

Please choose the setting according to the desired temperature.

The interior temperature also depends on ambient temperature, the frequency with which the door is opened and the amount of food kept inside.

Frequently opening the door causes the interior temperature to rise.

For this reason, it is recommended to close the door again as soon as possible after use.

The normal storage temperature of your appliance should be -18 °C (0 °F). If the thermostat knob is turned counter clockwise from position 1, the appliance will be switched off and "click" sound will be heard. Lower temperatures can be obtained by adjusting the thermostat knob towards Position 4.

We recommend checking the temperature with a thermometer to ensure that the storage compartments are kept to the desired temperature.

Remember to take the reading immediately since the thermometer temperature will rise very rapidly after you remove it from the freezer.

Freezing food

The freezing area is marked with  symbol on the door liner.

You can use the appliance for freezing fresh food as well as for storing pre-frozen food.

Please refer to the recommendations given on the packaging of your food.

⚠ Attention

Do not freeze fizzy drinks, as the bottle may burst when the liquid in it is frozen.

Be careful with frozen products such as coloured ice-cubes.

Do not exceed the freezing capacity of your appliance in 24 hours. See the rating label.

In order to maintain the quality of the food, the freezing must be effected as rapidly as possible.

Thus, the freezing capacity will not be exceeded, and the temperature inside the freezer will not rise.

⚠ Attention

Keep the already deep-frozen food always separated with freshly placed food.

When deep-freezing hot food, the cooling compressor will work until the food is completely frozen. This can temporarily cause excessive cooling of the refrigeration compartment.

If you find the freezer door difficult to open just after you have closed it, don't worry. This is due to the pressure difference which will equalize and allow the door to open normally after a few minutes.

You will hear a vacuum sound just after closing the door. This is quite normal.

Defrosting of the appliance

Excessive build-up of ice will affect the freezing performance of your appliance.

It is therefore recommended that you defrost your appliance at least twice a year, or whenever the ice build-up exceeds 7 mm.

Defrost your appliance when there is only little or no food in it.

Take out the deep-frozen food from the drawers. Wrap the deep-frozen food in several layers of paper, or a blanket, and keep it in a cold place.

Unplug the appliance or switch off the circuit breaker to start the defrosting process.

Take out the accessories (like shelf, drawer etc.) from the appliance and use a suitable container to collect the thawing water.

Use a sponge or a soft cloth to remove thawing water if necessary

Keep the door open during defrosting.

For quicker defrosting, place containers with warm water inside the appliance.

Never use electrical devices, defrosting sprays or pointed or sharp-edged objects such as knives or forks to remove the ice.

After the defrosting is done, clean the inside.

Reconnect the appliance to the mains. Place the frozen food into the drawers and slide the drawers into the freezer.

Installation

To make the product ready for use, be careful that the electrical wiring and plumbing are appropriate by referring to the information in the user manual. If not, call a qualified electrician and plumber and have the necessary arrangements made.

⚠WARNING: The manufacturer is not liable for damages caused by operations by unauthorized persons. To avoid shaking, place the product on a flat surface.

⚠WARNING: During the installation, the power plug of the product should not be plugged in. Otherwise, there is a danger of death or serious injury!

⚠WARNING: If the doorway of the room to where the product will be placed is so narrow that the product cannot pass through, pass the product by turning it to side; otherwise, call an authorized service.

- Do not expose the product to direct sunlight and do not store it in humid place.
- Do not install the product where the temperature drops below 10 °C.

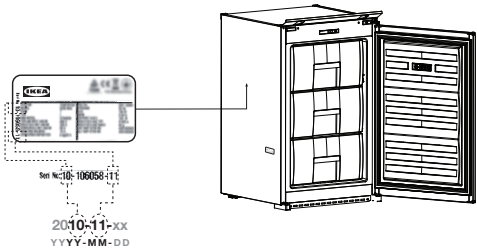

Inspection check list

Please follow the inspection checklist before using your appliance.
If any answer is NOT please follow the relevant action.
Please remember to write down the product serial number and article number as required and attach your receipt to this page.

Product serial number (rating plate)	
Product artical number (rating plate)	
Purchasing date	

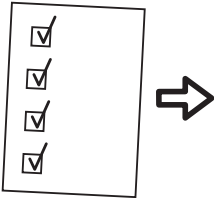

	If the answer is YES	Actions to do if NOT
Condensation Tray Check that the tube is inside the tray	<input checked="" type="checkbox"/> No action	Put the tube inside the tray
Making sure gasket seals all around the door when the door is closed	<input checked="" type="checkbox"/> No action	Refer to the AI - door alignment step
Checking no collision between parts/furniture while opening/closing the cooling door	<input checked="" type="checkbox"/> No action	Refer to the AI - door alignment step
Secure the installation inside any kitchen system and fixed as required	<input checked="" type="checkbox"/> No action	Follow the AI for the proper installation

Technical data

IKEA	LAGAN	6,5	168	37	E
Brand	Model	Freezing capacity (kg/24h)	Energy consumption (kw/year)	Noise level (dba)	Energy class

Potential Noise Reason

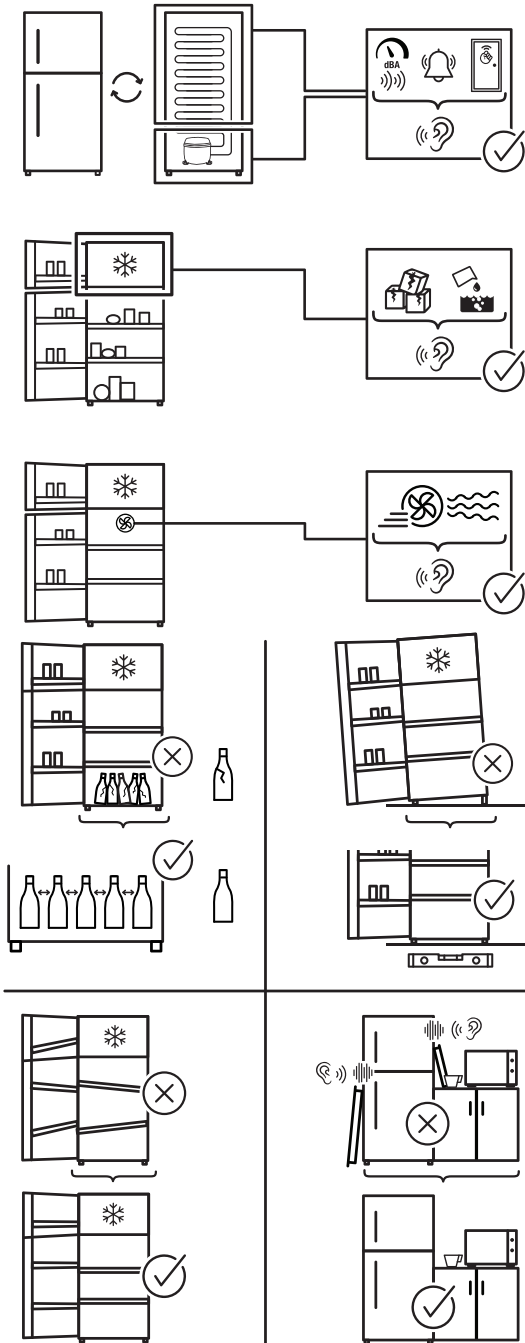

This refrigerator contains biocidal products in the following parts to prevent dry film fungal growth and unwanted odours.

Active substance:

- Silver (CAS: 7440-22-4) contains (nano) silver for door handle and carbon filter
- Titanium dioxide (CAS: 13463-67-7) contains (nano) titanium dioxide for carbon filter
- IPBC (CAS: 55406-53-6) for seal

The concentrations of biocidal products are very low hence they should not pose unacceptable health risks.

