

**A guide to
install a new
KNOXHULT kitchen**

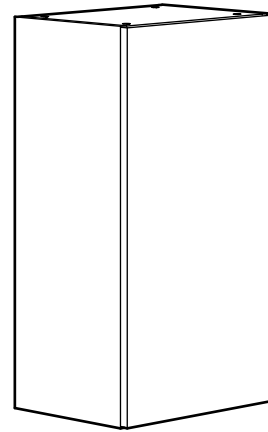

KNOXHULT installation guide

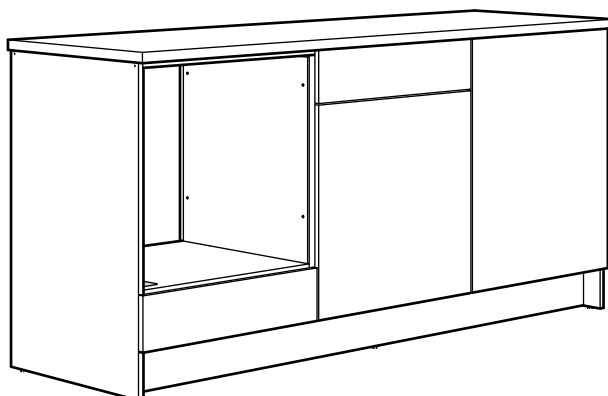
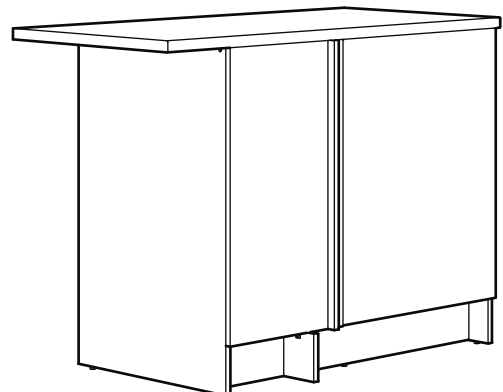
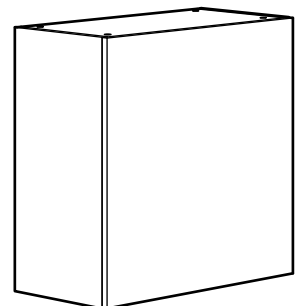
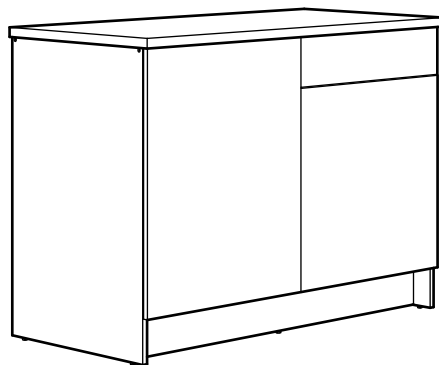
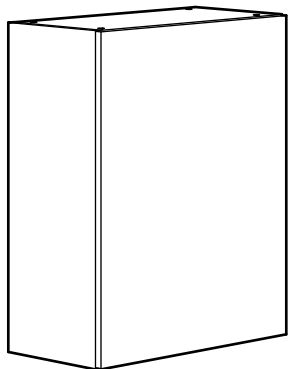

Before you begin installing your new KNOXHULT kitchen

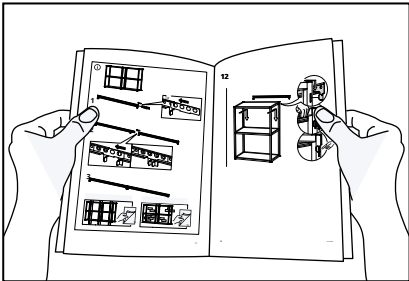

This is your guide to successfully installing a new IKEA kitchen. In it, you will find clear steps to follow when preparing and installing your kitchen, along with useful tips and ideas. Use this guide together with the assembly instructions to ensure your kitchen is installed correctly.

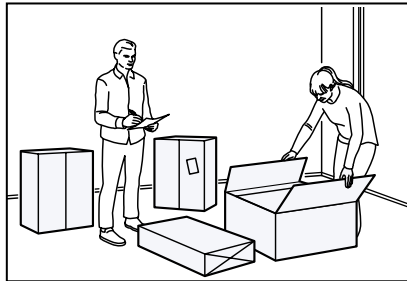

Make sure you have all parts ready before starting installation of your new kitchen. Opening all the packages at once can cause confusion, and you risk mixing up or losing the parts you need.

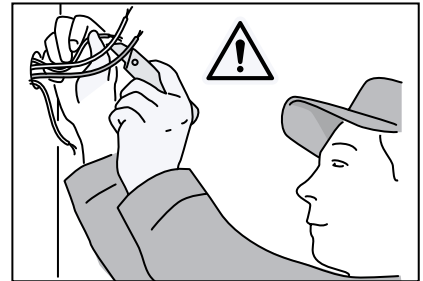

Ensure that your electricity, water, and gas are turned off. Always use a qualified professional to disconnect these utilities.

Table of contents

This guide provides you with tips and step-by-step instructions on how to install your kitchen by yourself.

Before you begin.....	02
Tools and materials	03
Wall anchoring safety.....	04
Knowing your walls.....	05
Prepare your room	06
Installing base cabinet	07
Installing wall cabinet.....	08
Installing high cabinet.....	09
Installing extractor hood.....	10
Installing sink and tap	11
Finishing touches.....	12
Maintenance.....	13

Tools and materials

Here is a summary of the basic tools you'll need. In addition you'll find what tools to use for each product in their respective assembly instructions.

Basic (cabinets only)

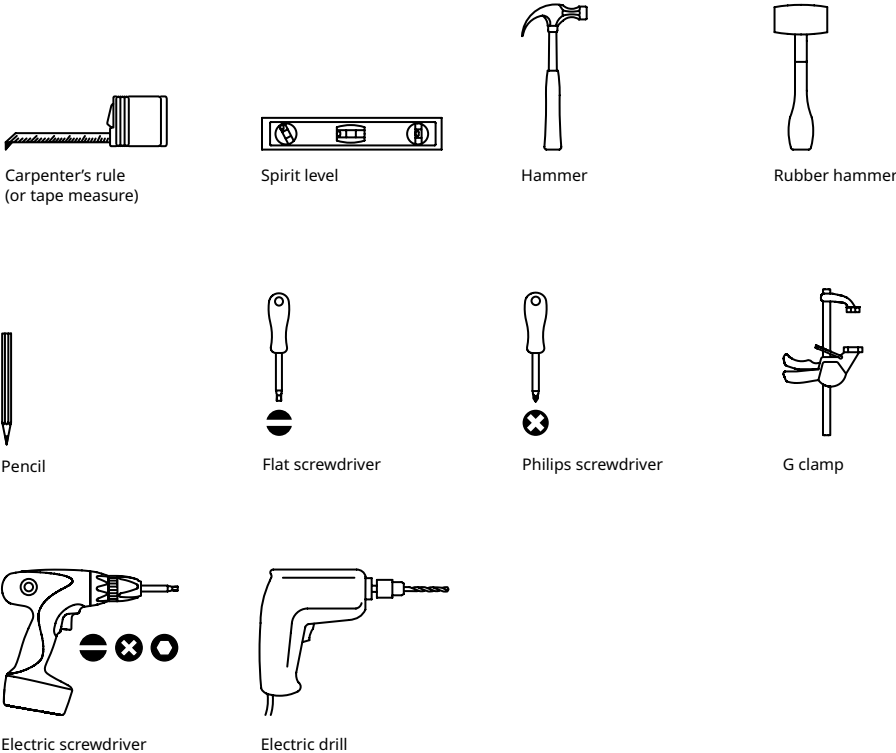

Advanced (extractor hood, sink and tap)

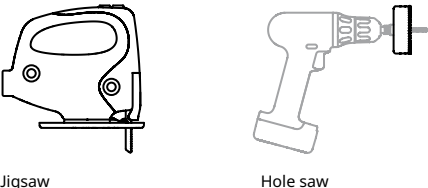

Wall anchoring safety

Warning!

Serious or fatal crushing injuries can occur from furniture falling down. To prevent this furniture from falling down it must be used with the wall attachment device(s) provided. Screw(s) and plug(s) for the wall are not included. Assess the suitability of the wall to ensure that it will withstand the forces generated. Use

screw(s) and plug(s) suitable for your walls and the intended load. If you are uncertain, seek professional advice. Read and follow each step of the instruction carefully.

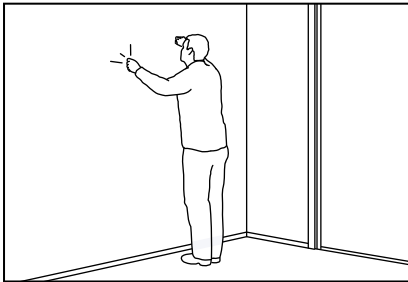

It is crucial for your safety and the safety of others that you assess what type of wall you have.

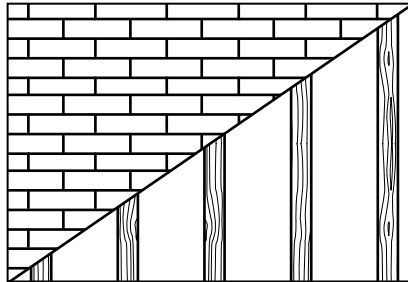

There are mainly two types of walls: solid walls or stud walls. For more info, see next page.

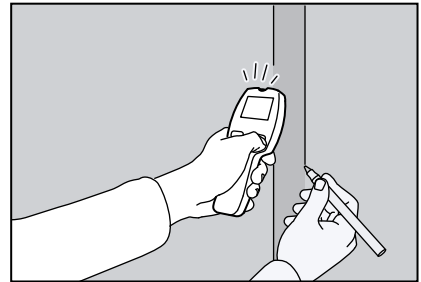

An electrical stud finder can be very helpful for locating studs and support beams.

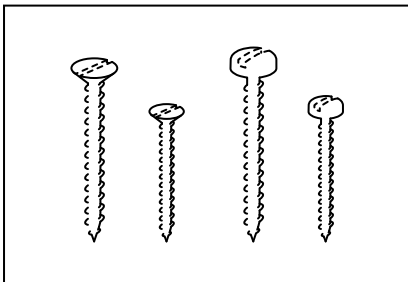

Ask your local hardware store for the appropriate screws and screw sizes for your walls.

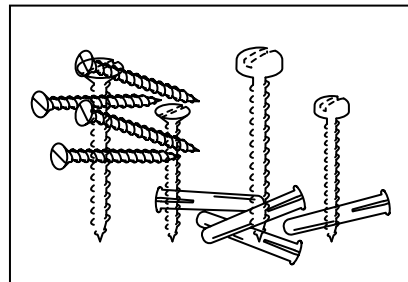

Depending on your wall material, you may also need to use wall plugs. Please be aware that we do not recommend using wall plugs for stud walls, due to that the furniture must be attached to a structural part of the wall.

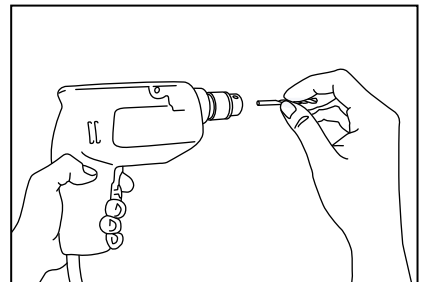

You will also need a drill bit suited to your specific wall material.

Knowing your walls

Before you start, you need to know what type of wall you have. There are many different types of walls. But basically, they all fall into one of two categories – stud walls and solid walls.

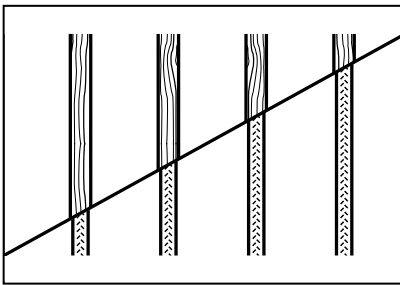

Stud walls

Built on a structure of vertical studs made of wood or metal. You must anchor the furniture to the studs in order to secure that the cabinet will stay firmly and safely attached to the wall.

Drywall: The most common wall type. Made of sheets of gypsum that are easy to drill into.

Lath and plaster: A layer of plaster applied to a structure of wooden studs and laths. Common in US homes built before the 1950s.

Wood paneling: Decorative wood panels come in many shapes and styles.

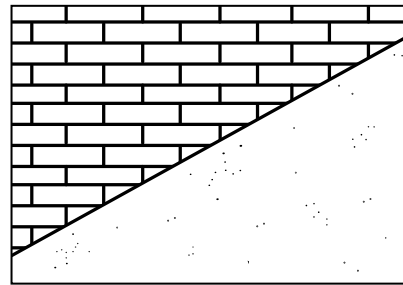

Solid walls

A bit tougher to drill into. But use a proper hammer drill with a masonry drill bit and you'll be fine.

Masonry: Bricks or stones bound together with mortar make up this classic wall type.

Concrete: As sturdy as they come – ranging from light-weight concrete to reinforced with steel bars. Made of blocks or complete wall sections.

Cinder block: A special type of concrete blocks with a cavity in the middle

Here are a couple of ways to find out what type of wall you have:

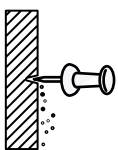

The push pin trick

If you can easily stick a push pin into the wall, it's most likely made of drywall. (You might also spot some white dust.)



The knock test

A stud wall often sounds hollow when you knock on it. A solid wall doesn't.

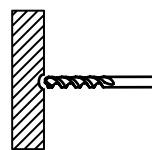

Drilling a hole

Drilling a small hole often can reveal a bit more about what's inside your wall. Try to find a hidden spot, and don't drill too deep.

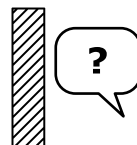

Just asking someone

Do you have a landlord or knowledgeable friend to ask? Great.

Prepare your room

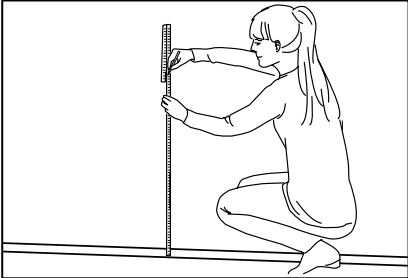

Measure your space to make sure that your chosen modules will fit.

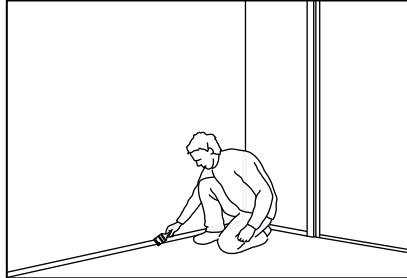

Now is a good time to paint your walls, tile or change the floor if needed.

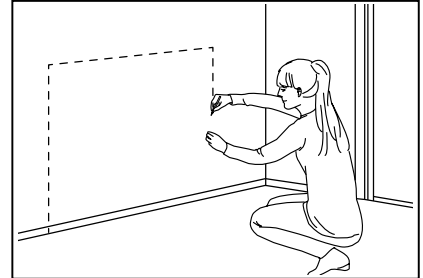

Mark the positions of your cabinets on the walls. Use a pencil to outline the cabinet positions to ensure that the plumbing, electricity, and gas align with where you want them.

Installing base cabinets

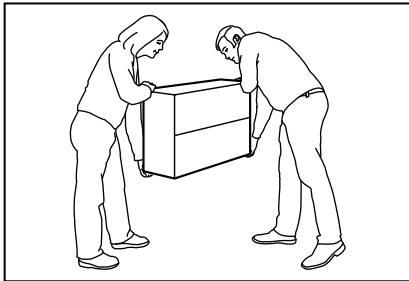

Carefully carry the packages inside. Sort out which cabinets you will assemble first and set the others aside.

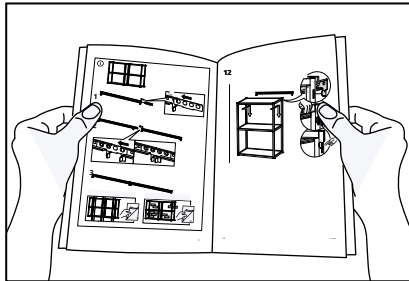

Open the package and follow the assembly instructions carefully when putting the cabinet together.

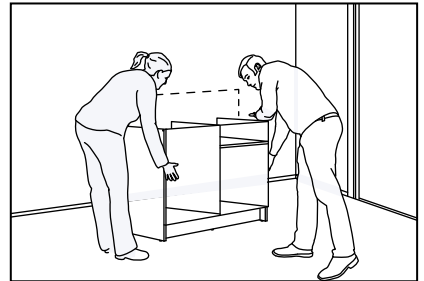

Once the cabinet is assembled, it's time to move it to the wall that we marked with a pencil earlier. It's best to be two when moving.

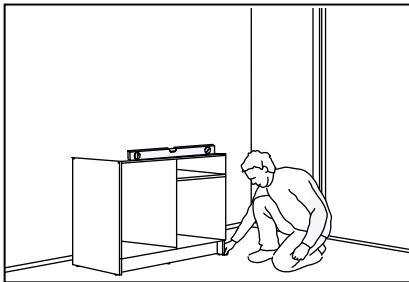

Next, level the cabinet using a spirit level and adjust the cabinet feet as needed.

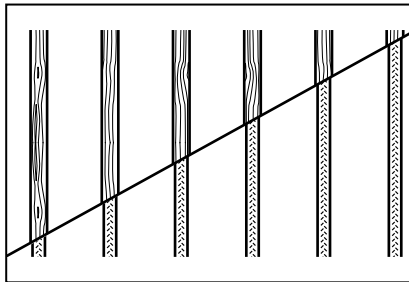

If you found out that you have a stud wall, you need to make sure that you fasten the cabinet into at least one stud.

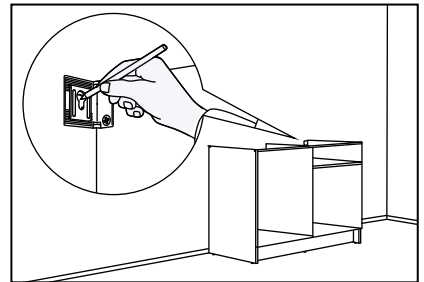

Use a pencil to mark where the holes of the brackets should go on the wall, using the holes in the metal bracket located in each upper corner of the cabinet as a guide.

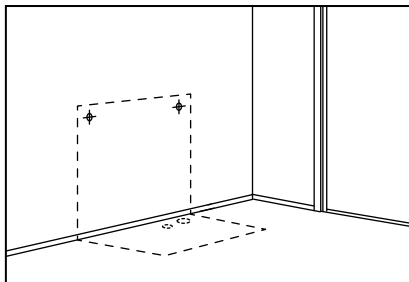

Ensure the markings for the holes are correct and that there are no water pipes or electrical wiring in the areas where you will drill.

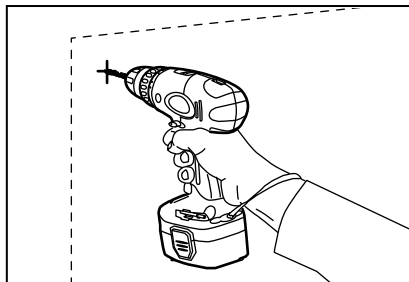

The type of drill, drill bit, screws, and plugs you need will depend on your wall type.

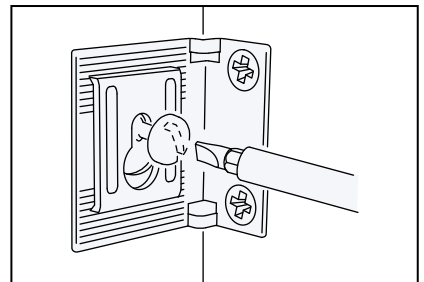

Secure the cabinet to the wall using the fixation washers that come with the cabinet. Using the correct screws for your wall material, fix the cabinet to the wall.

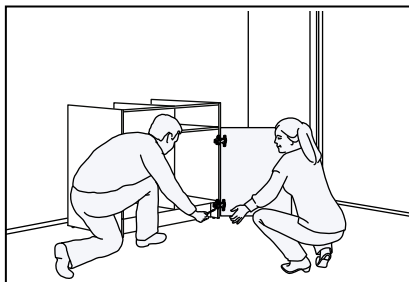

Once the cabinet is securely fixed, you can mount the doors and drawers. Don't worry if you don't get it right on the first try! The doors can be adjusted afterwards.

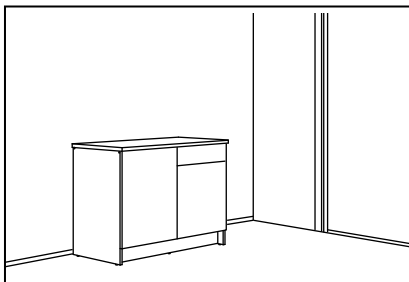

Congratulations! You just finished installing your base cabinet. Now, let's add some wall cabinets!

Installing wall cabinets

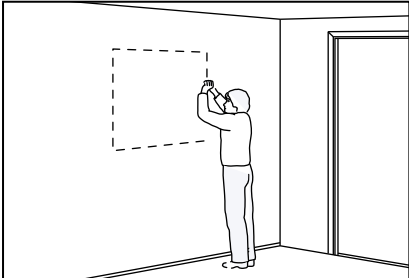

Start by measuring where you want your wall cabinets positioned, and mark the spot on the wall using a pencil.

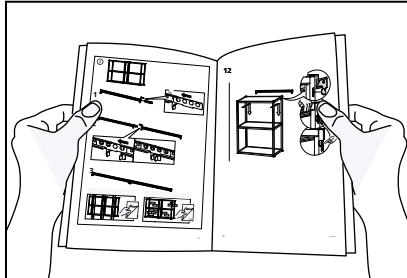

Carefully follow the assembly instructions while putting the cabinet together.

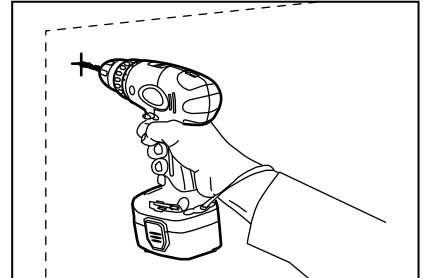

Drill the holes using the correct type of drill and drill bit for your wall material, and use the appropriate screws and plugs, just as you did with the base cabinet.

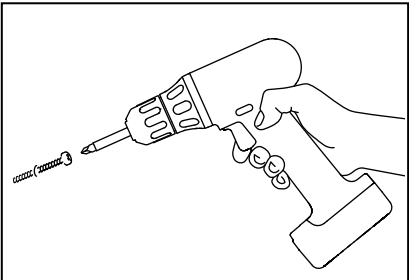

Screw the screws halfway into the wall.

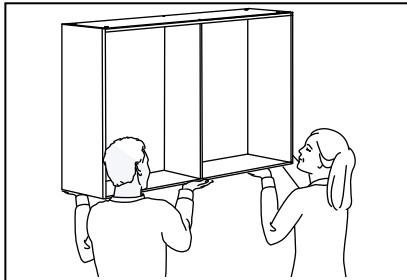

With a little help from a friend, lift the cabinet and hang it on the screws.

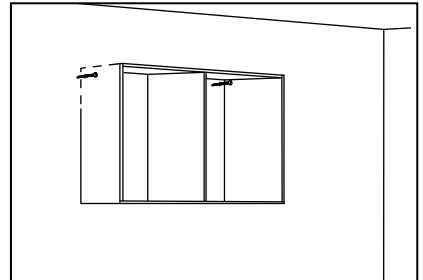

Great! The cabinet is now on the wall.

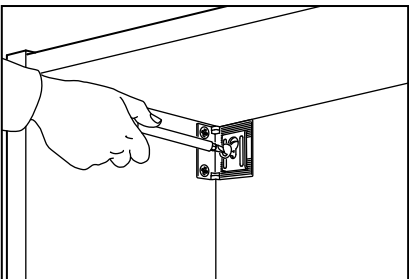

Add the enclosed brackets over the screws, then fully tighten the screws into the wall.

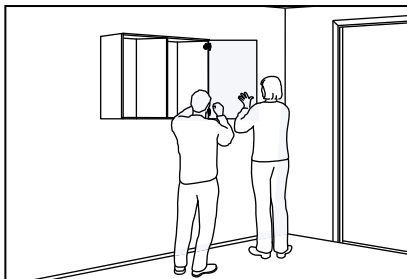

Now you can add the doors and adjust the hinges to ensure they are level and close properly without any issues.

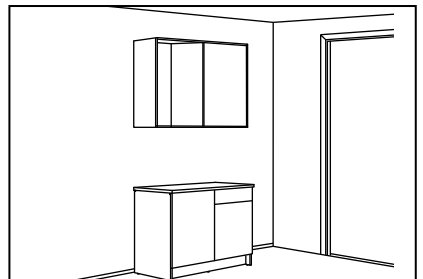

Congratulations! You now have a fully functional kitchen with base and wall cabinets. The next step is to install the extractor hood and/or sink and tap. Let's go!

Installing high cabinets

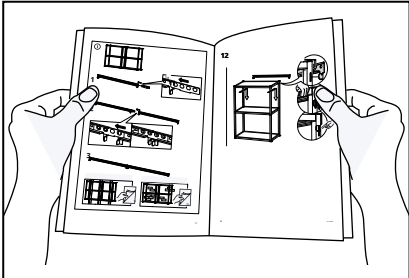

Open the package and carefully follow the assembly instructions when putting the cabinet together.

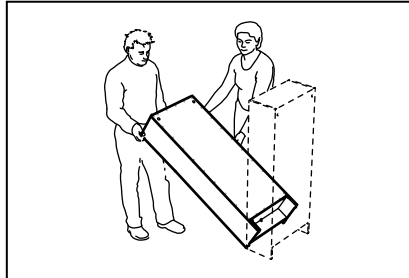

With the help of a friend, position the cabinet against the wall.

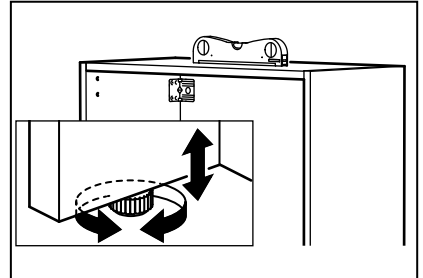

Adjust the feet if necessary to ensure the cabinet is level.

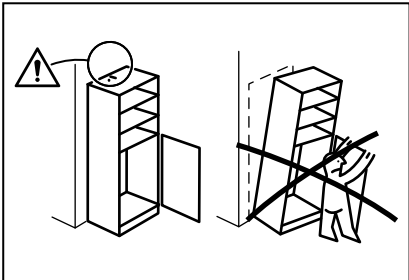

It is crucial that the high cabinet is securely attached to the wall to prevent tipping, which could lead to injury.

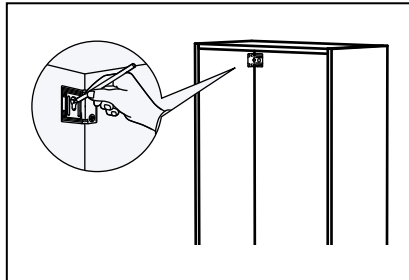

Use a pencil to mark where the holes should go on the wall, using the holes in the metal brackets located in each upper corner of the cabinet as a guide.

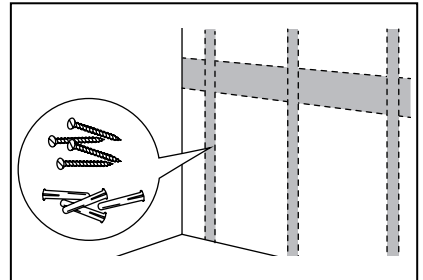

If you have a stud wall, ensure the cabinet is secured to the studs. For other types of walls, you will need screws and wall plugs that are appropriate for your wall material.

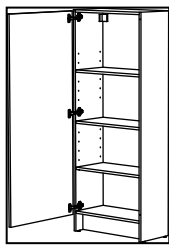

Once the cabinet is securely attached to the wall, it is safe to attach the door and, finally, add the shelves to the cabinet. You can place the shelves according to your needs.

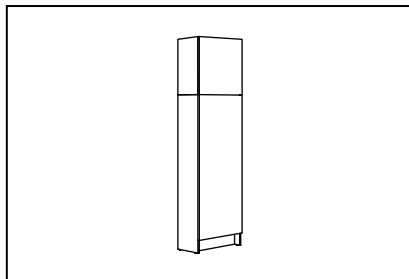

You can add a KNOXHULT wall cabinet of the same width as your high cabinet on top to make it taller.

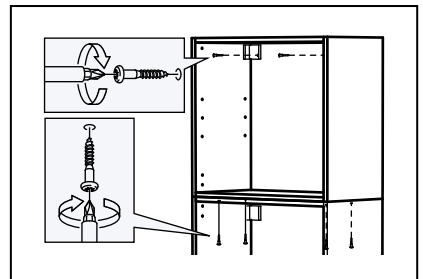

Attach the upper cabinet to the wall (as you would with a regular wall cabinet - see the "Installing Wall Cabinet" section) and to the high cabinet.

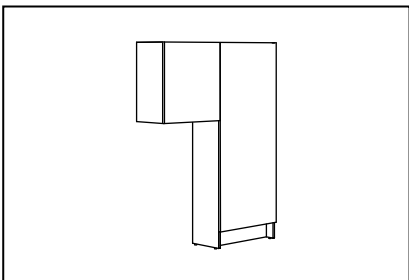

Alternatively, you can add a wall cabinet to the side of your high cabinet to extend it in one direction.

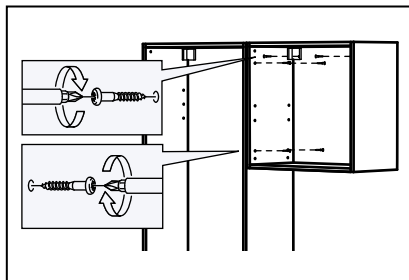

Attach the cabinet to the wall (as you would with a regular wall cabinet - see the "Installing Wall Cabinet" section) and to the side of the high cabinet.

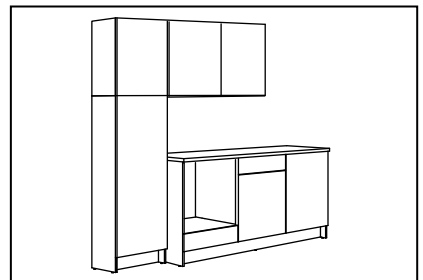

Great job! Your kitchen is now ready for the installation of the sink, tap, and appliances.

Installing extractor hood

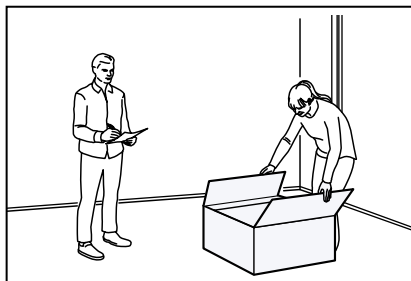

Now it's time to unpack your new extractor hood. The assembly instructions will guide you through the process. The instructions will show the required distance between the worktop surface and the bottom edge of the extractor hood.

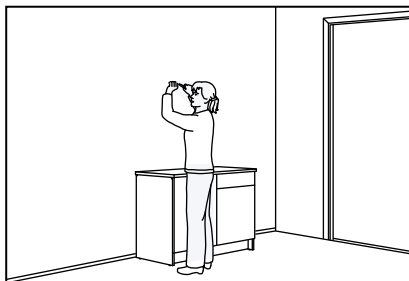

Carefully measure the height for the extractor hood cabinet, and mark it on the wall with a pencil.

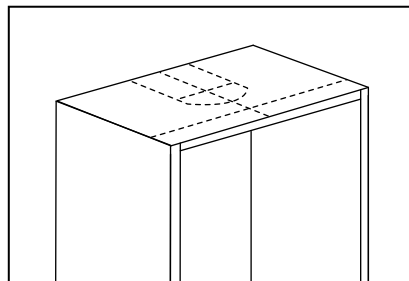

Use the folded paper template that comes with the extractor hood to mark where the extractor tube should be placed.

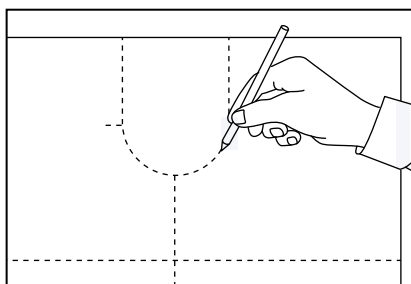

Tape the template to the back or top of the cabinet, depending on your ventilation's location, and use a pencil to mark the spot for the hole.

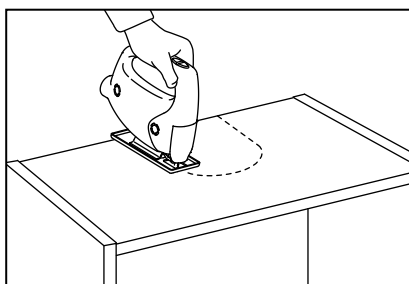

Now, use a jigsaw to cut a hole in the cabinet according to your marking.

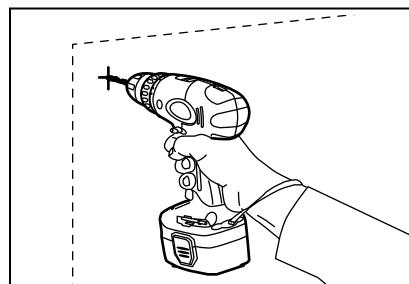

Attach the cabinet to the wall using the correct screws and plugs for your wall material.

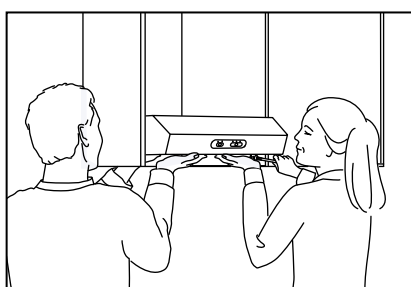

With the help of a friend, lift the extractor hood to the bottom of the cabinet and secure it with the provided screws.

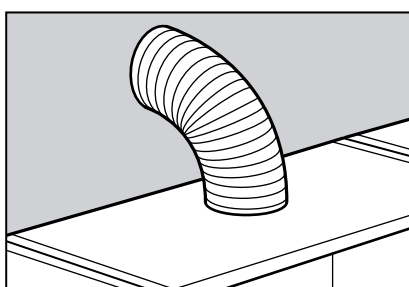

Insert the extractor tube through the cut-out hole and connect it to your ventilation.

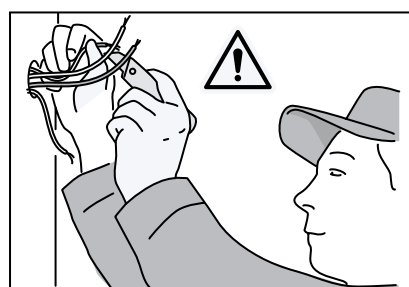

Warning: All electrical connections must be made by a qualified electrician. If you are unsure, seek professional advice.

Installing sink and tap

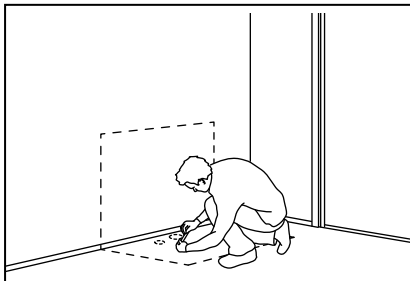

If you have pipes protruding from the floor or wall, carefully measure their position and mark it on your base cabinet. Remember: measure twice, cut once!

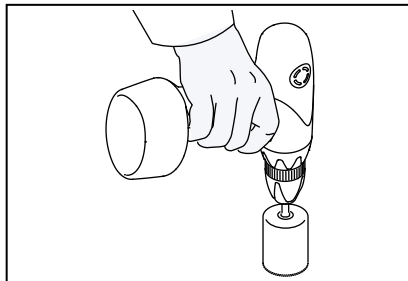

Use a hole saw or jigsaw to create openings for the pipes to pass through. If the opening is on the bottom of the cabinet, the edges need to be sealed with polyurethane silicone to prevent water damage to the cabinet.

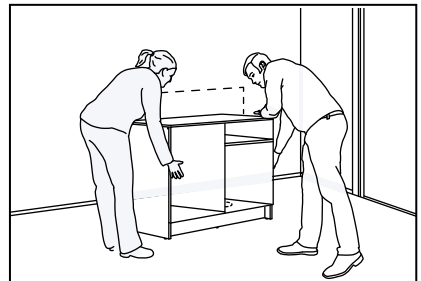

With the help of a friend, lift the cabinet and carefully position it over the pipes.

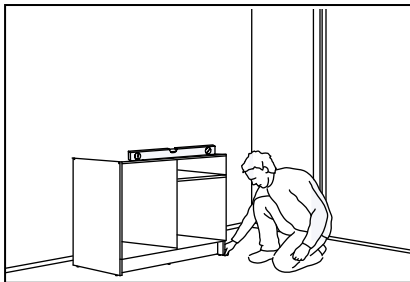

Use a spirit level to ensure the cabinet is level. You can adjust the position by using the cabinet feet if necessary.

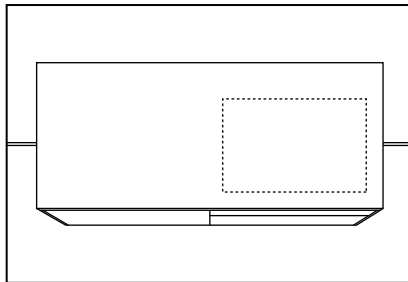

You can install the sink in the cabinet yourself without needing any plumbing skills. The next few steps will show you how.

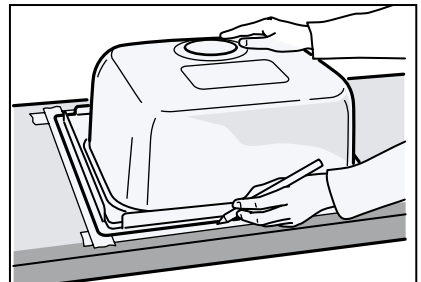

Mark the perimeter of the sink on the worktop with a pencil, following the enclosed assembly instructions.

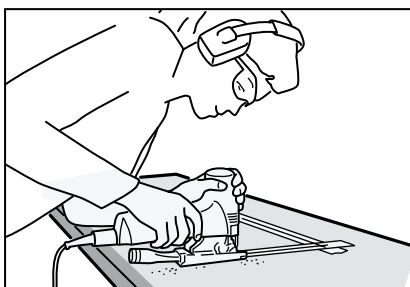

Use a jigsaw to cut out space for the sink. It's helpful to drill a hole at the inner corners of your outline before cutting, so you can make a clean cut.

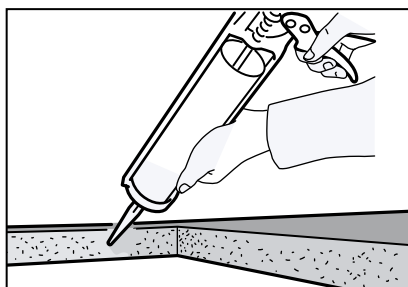

To prevent moisture from penetrating the countertop, apply polyurethane silicone along the sawn edges.

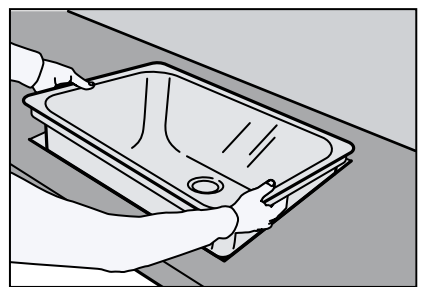

Secure the sink in place according to the assembly instructions.

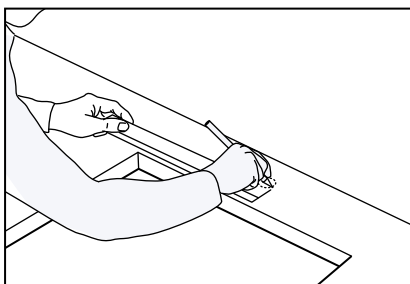

Carefully measure on the worktop where you want the tap and how large a hole you need for it. Then mark the location using a pencil.

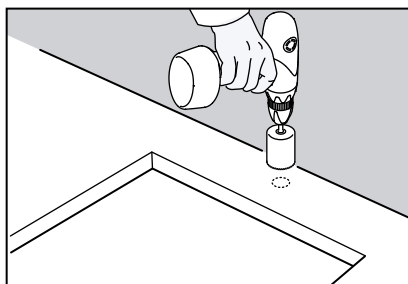

Use a hole saw to create an opening for the tap in the worktop according to your markings.

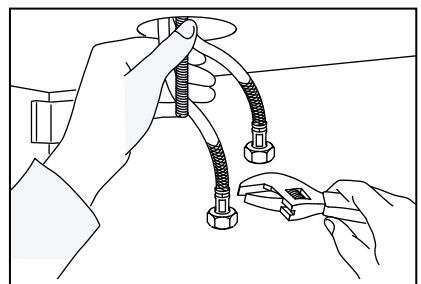

Now you can attach the tap on the worktop using the assembly instructions. Sink and tap is in place. The rest of the plumbing should be made by a qualified plumber.

Finishing touches

We are almost there! Now, let's add the finishing touches to your KNOXHULT kitchen to tie it all together.

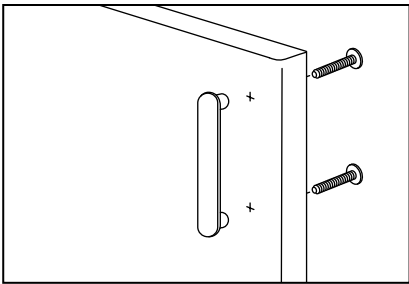

To complete the look, let's add knobs and handles to the cabinet doors and drawers. Make sure to measure carefully and mark with a pencil where you want to place the knobs and handles.

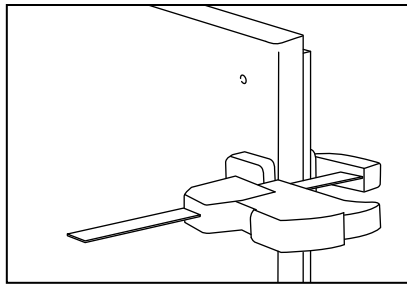

To prevent splintered edges and achieve a clean-cut hole, secure small pieces of wood to the back of the door using G-clamps at the point where the drill will pass through. This helps stabilize the material.

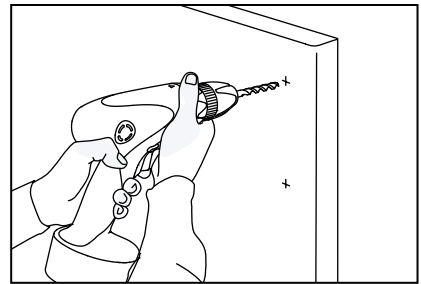

Drill holes in the marked places for the knobs or handles and install them with the provided screws.

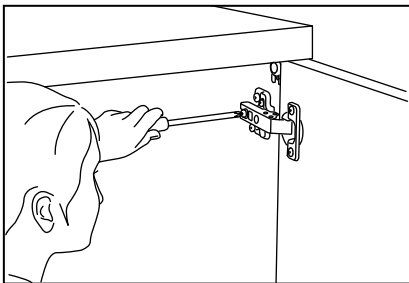

Uneven doors can be leveled by adjusting the hinges.

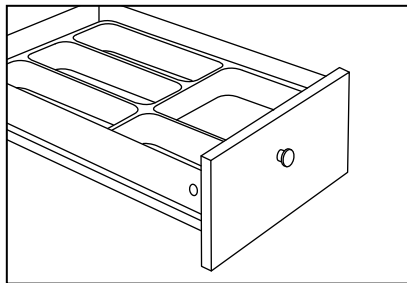

Lastly, add interior organizers and accessories to complete your kitchen.

Caring for your kitchen

Congratulations, you're done!

It's time to step back and admire your new KNOXHULT kitchen—and congratulate yourself for saving so much money by assembling and installing it yourself! With a little care and maintenance, your new IKEA kitchen will keep looking its best for many years to come.

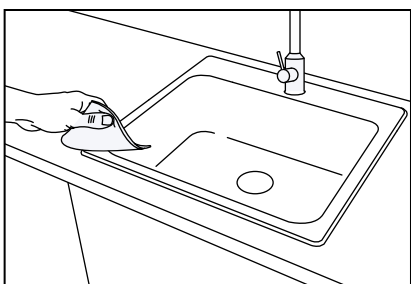

After each use, wipe the sink clean with a cloth or sponge dampened with water or a non-abrasive detergent, if necessary. Rinse the bowl with water and then wipe the sink with a dry cloth. Avoid scouring powder, steel wool, or hard objects that can scratch the stainless steel surface. The damp surface can be discolored if substances containing iron, such as steel wool, nails, or gravel, are allowed to remain on it. Discoloration is caused by foreign materials.

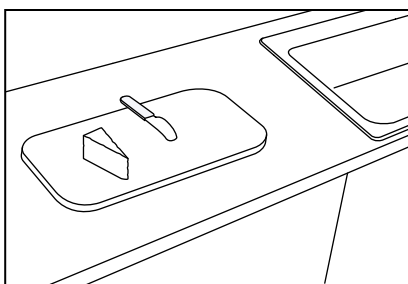

Keep your countertop in top condition by cleaning spills quickly with water and a mild detergent. Be sure to keep the countertop as dry as possible after use.

To keep the laminate worktops looking new, do not use knives directly on the surface; always use a chopping board. Avoid dragging objects with rough edges over the surface, as this may cause scratches.

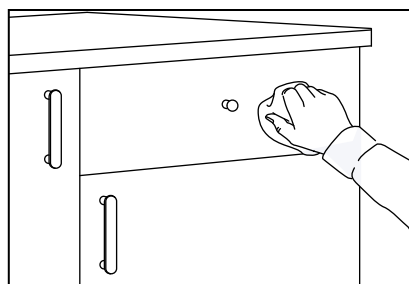

Clean the doors and cabinet interiors with a soft, damp cloth. Only use cleaning products intended for these materials. Do not use products that contain ammonia, alcohol, bleach, or abrasives. For tougher stains, use a microfiber cloth with a mild, non-abrasive cleaning detergent and rub carefully in circular motions. Rinse with clean water, then dry with a clean, dry cloth. Make sure to clean up spills quickly.

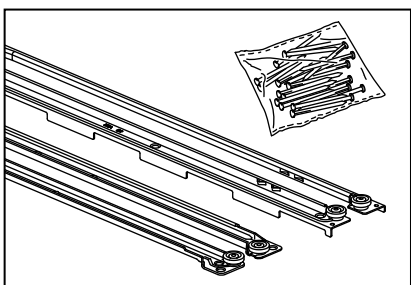

With proper care, your new kitchen will last for many years. However, if any parts break or go missing, you can order replacements for most components of your KNOXHULT kitchen. Visit the IKEA website to explore the available spare parts for your kitchen.

