

SALLSJÖN

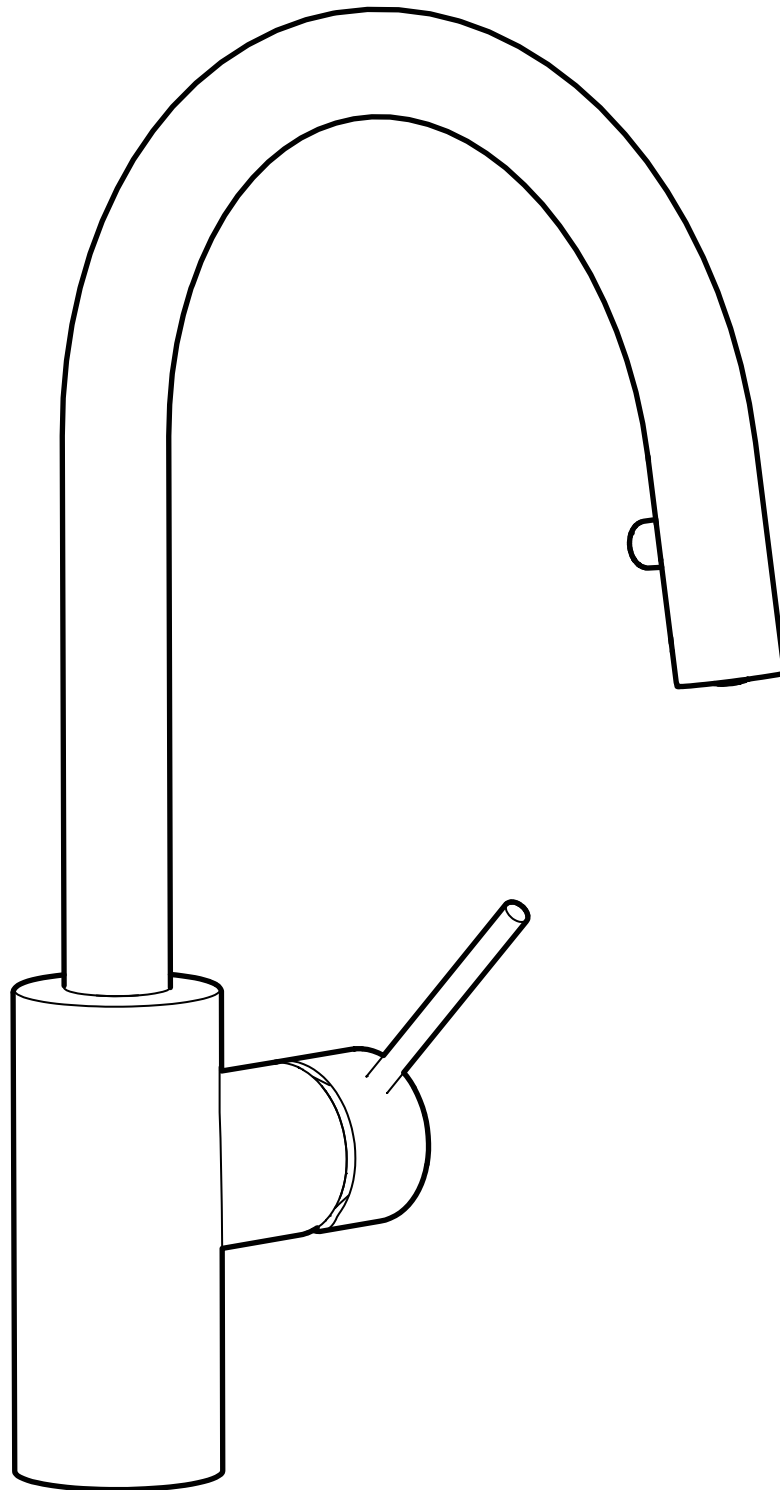

Design and Quality
IKEA of Sweden



English

Installation must be performed in compliance with current local construction and plumbing regulations. If in doubt, contact a professional.



English

Switch off main shut-off valve before changing mixer tap.

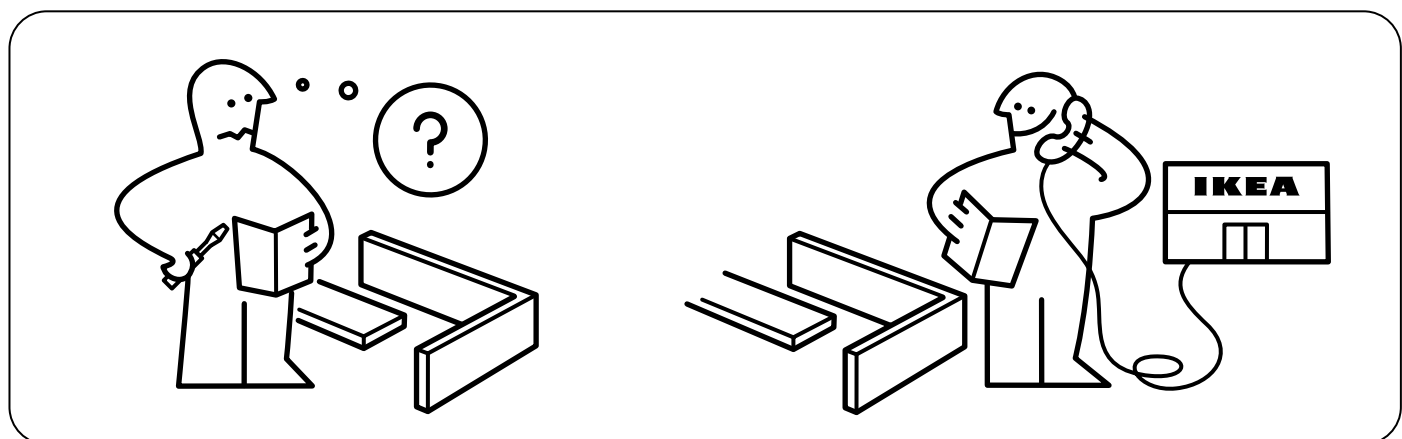
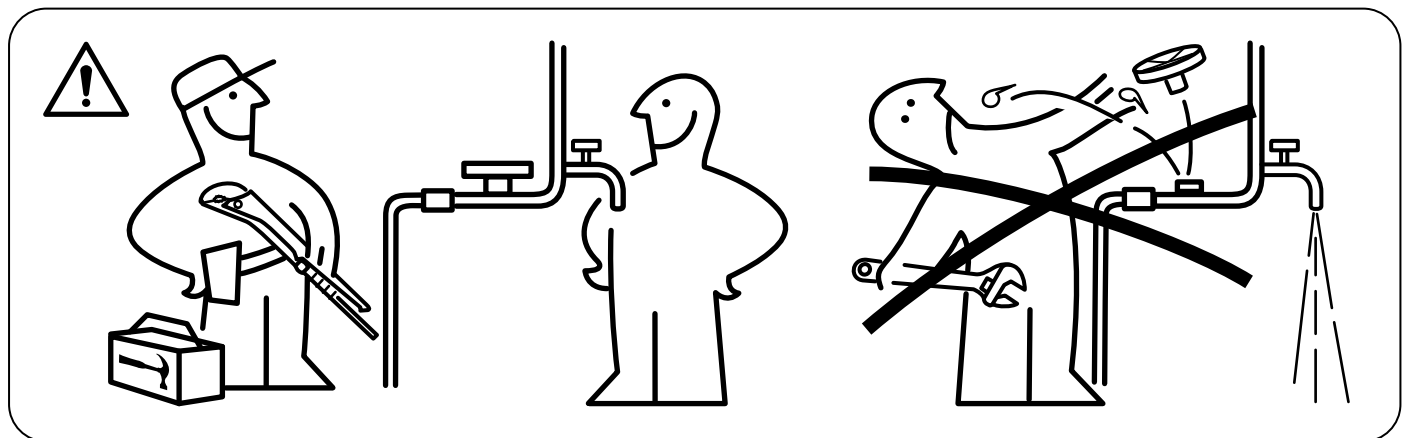
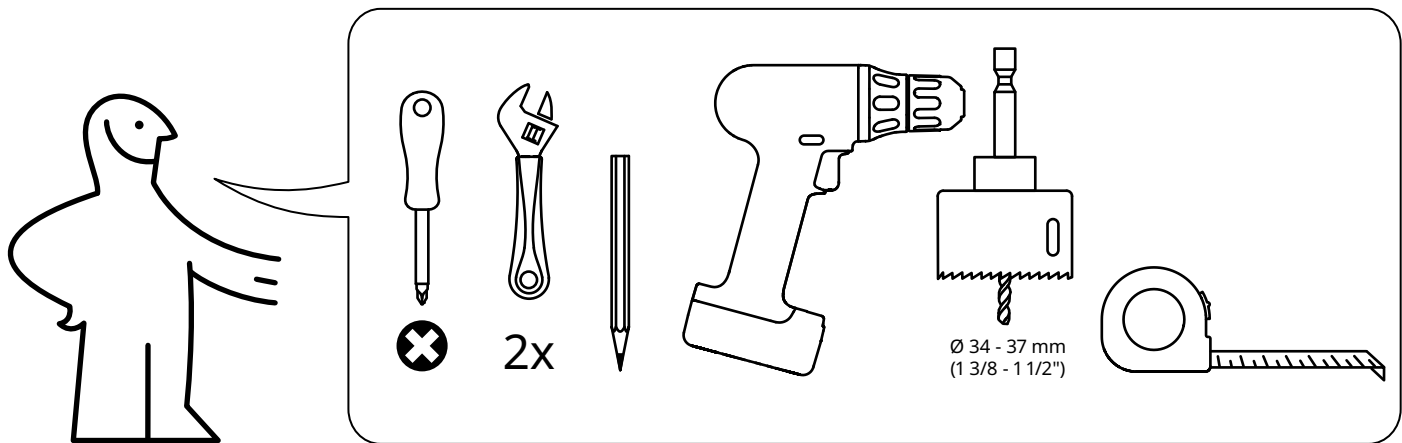

1

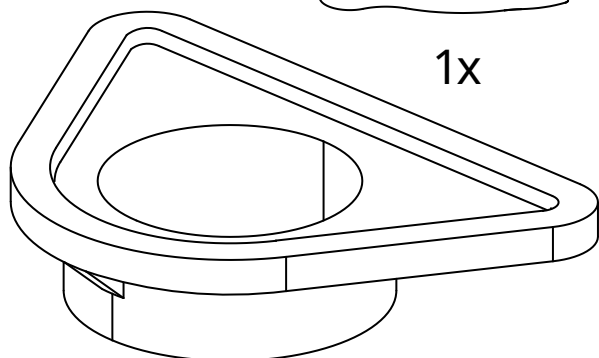

1x

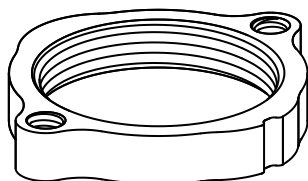

1x

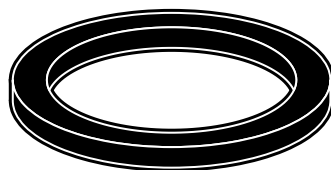

1x

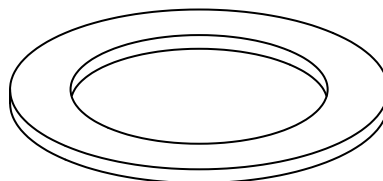

1x

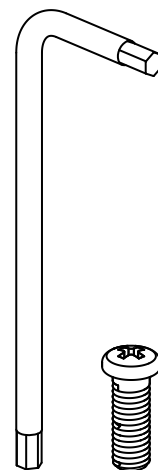

1x

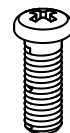

2x

10140225

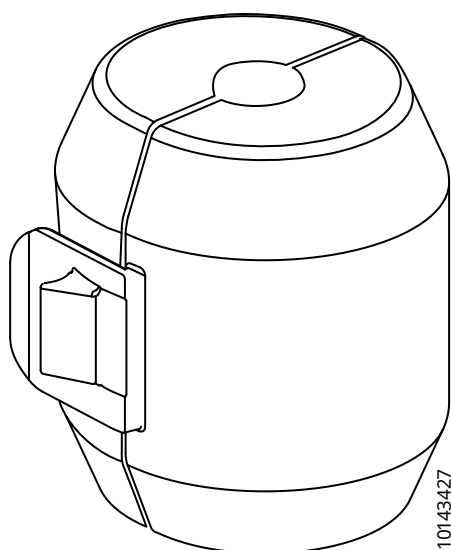

10143427

1x

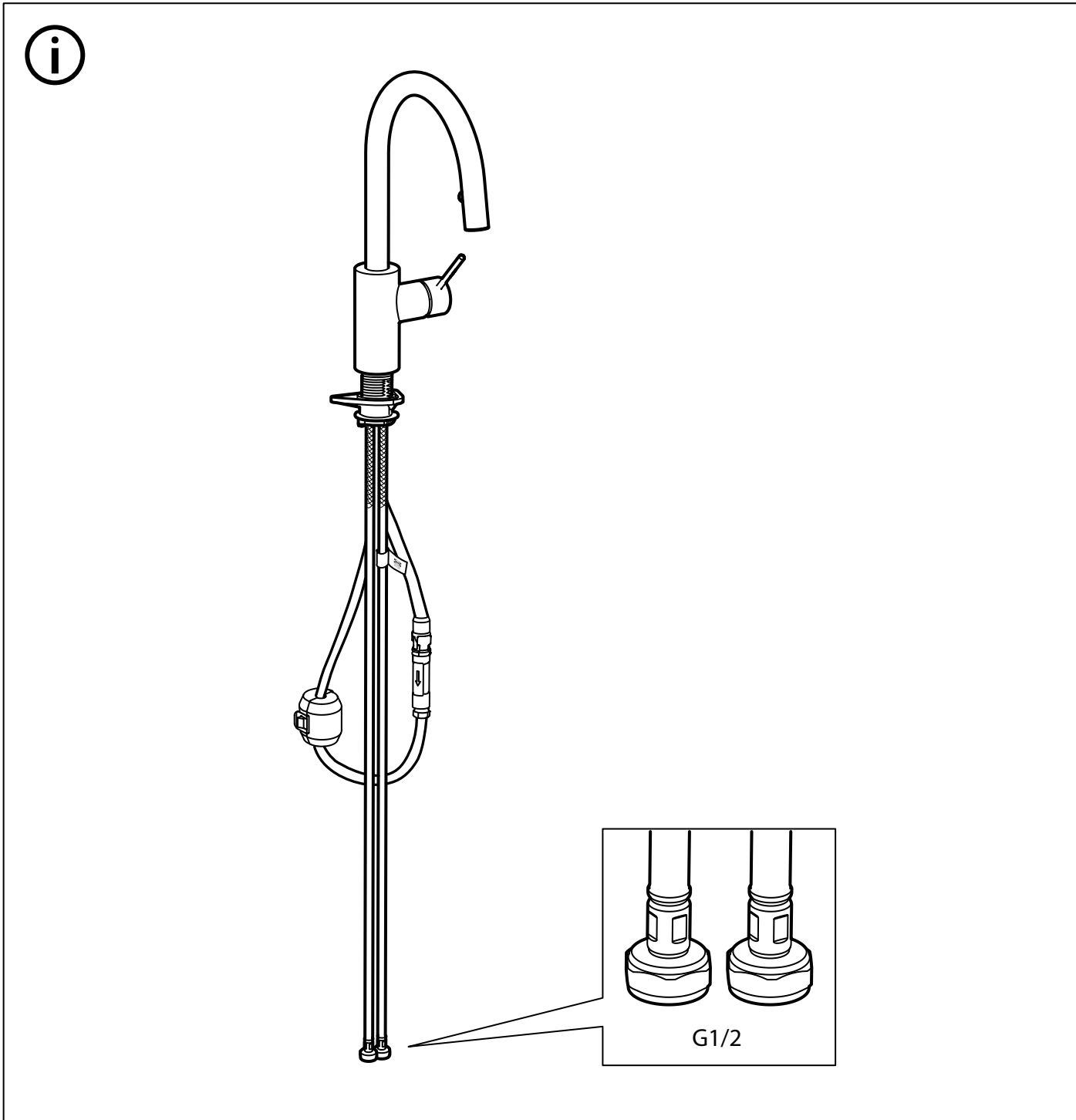
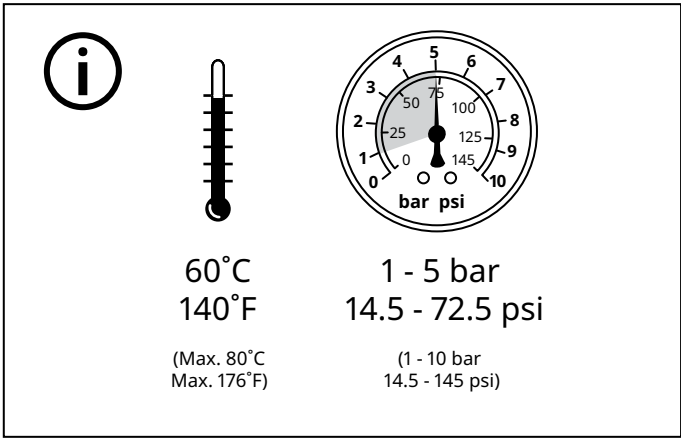
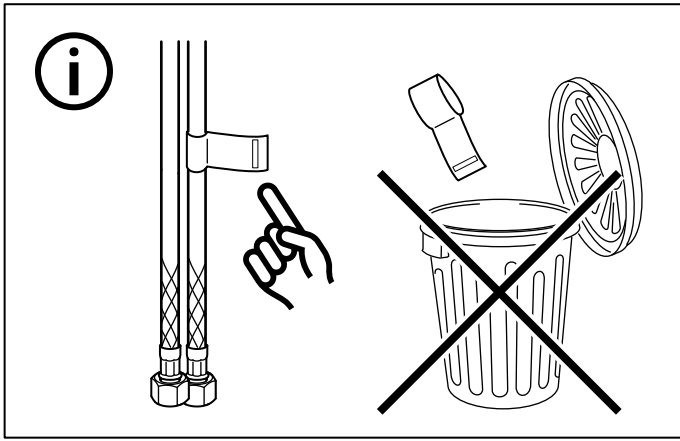

1

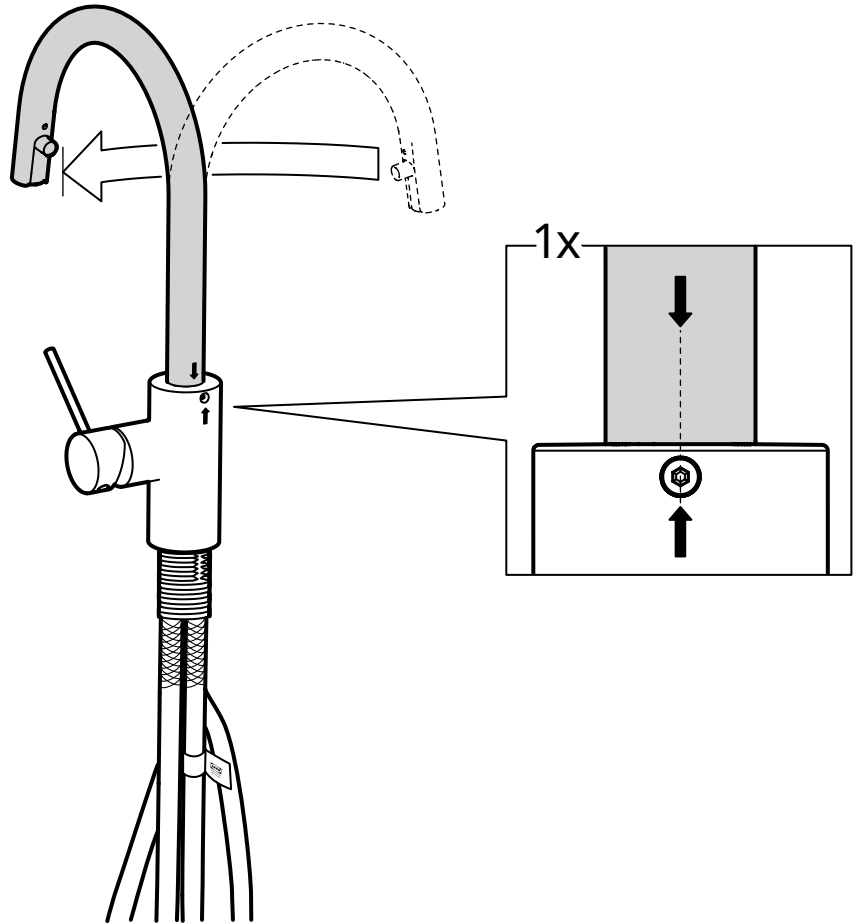

2

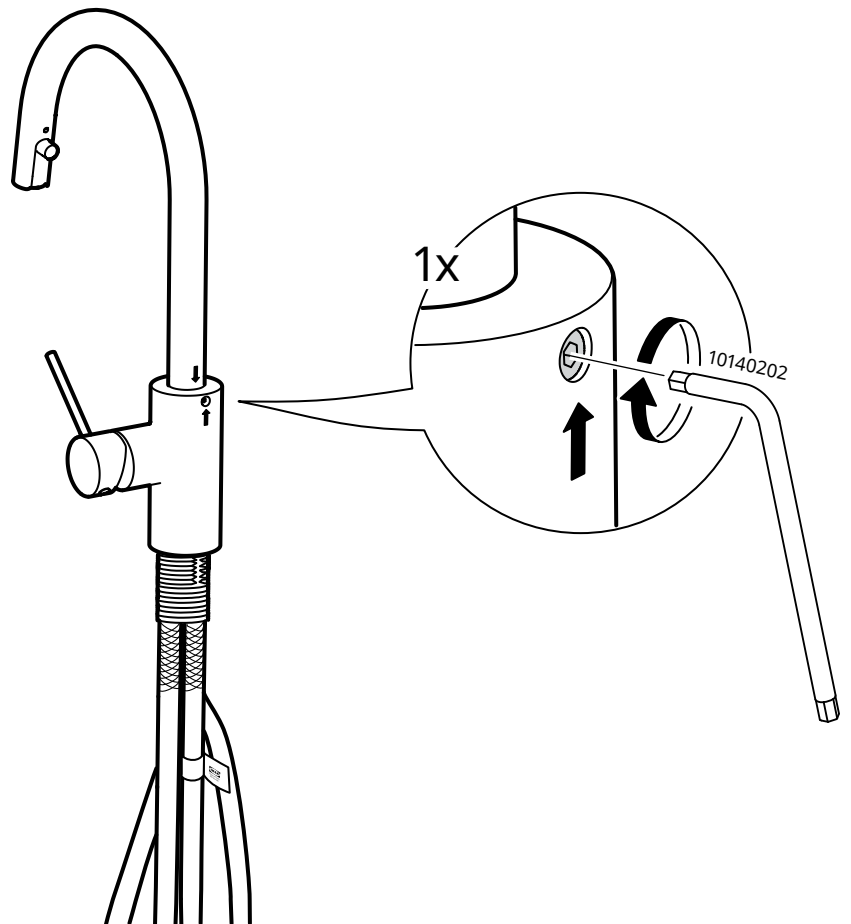

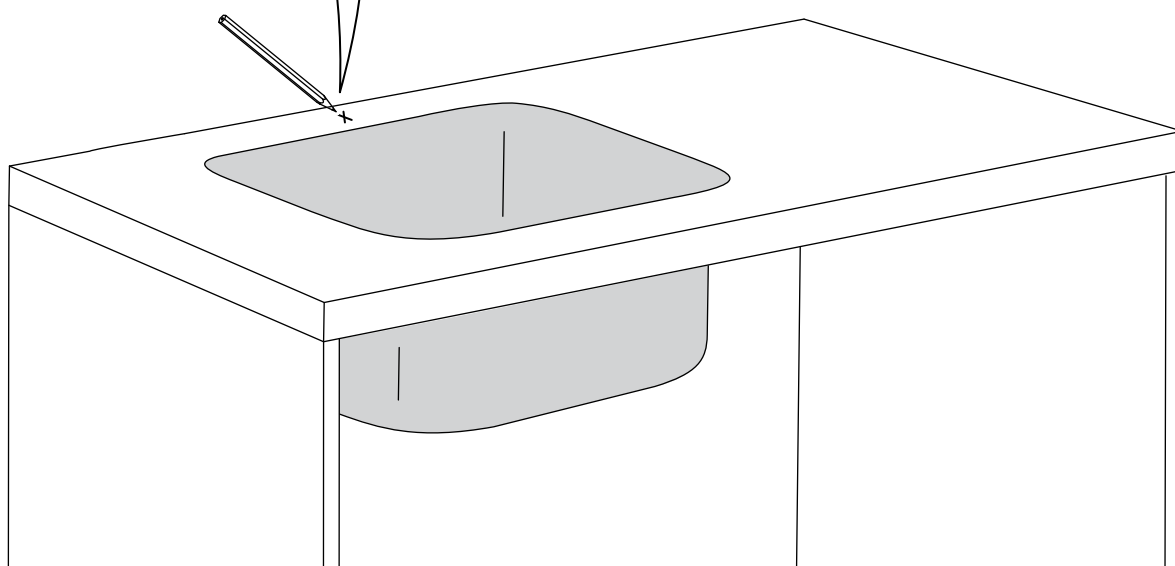
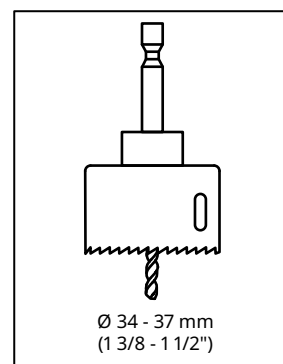
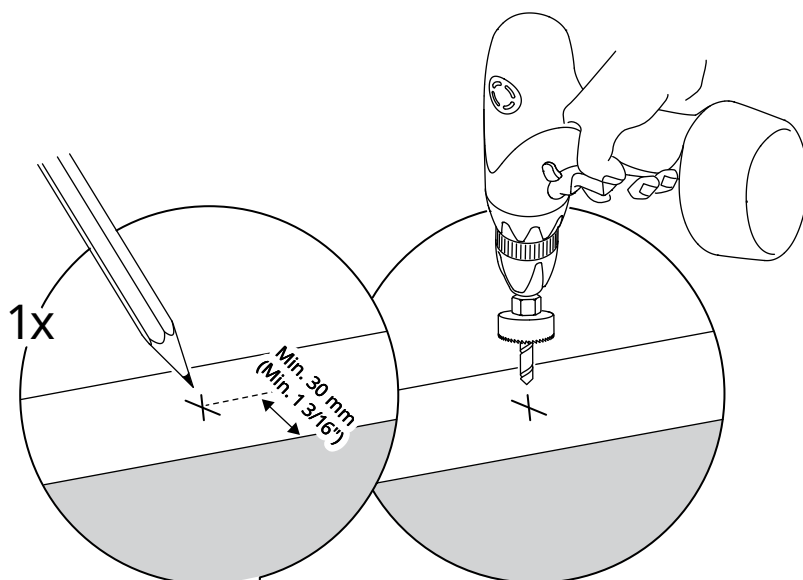
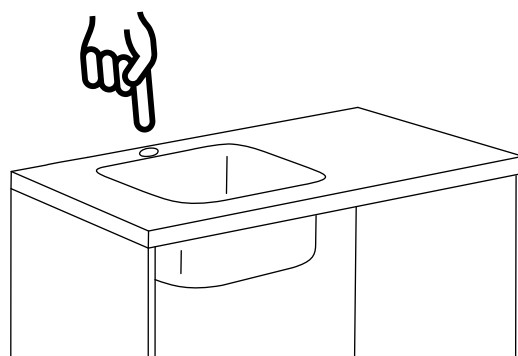
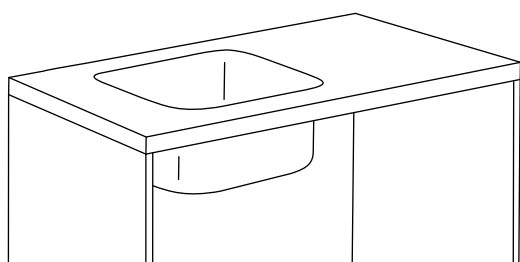

3

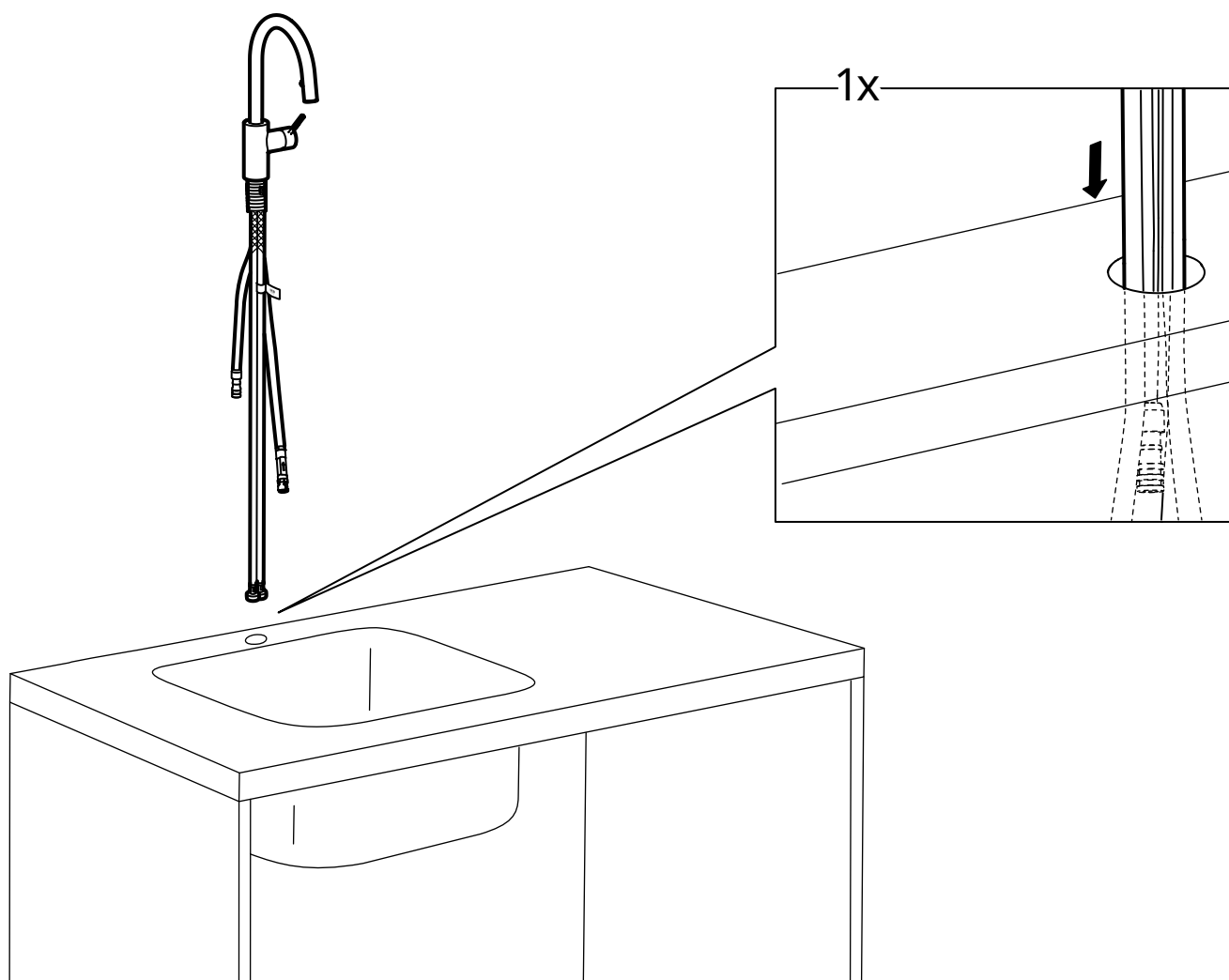

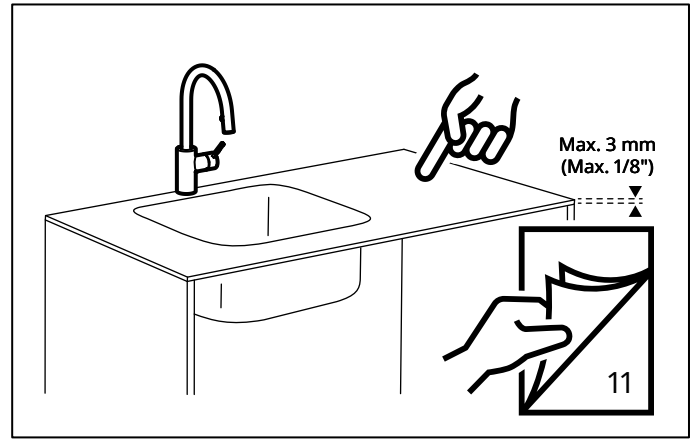
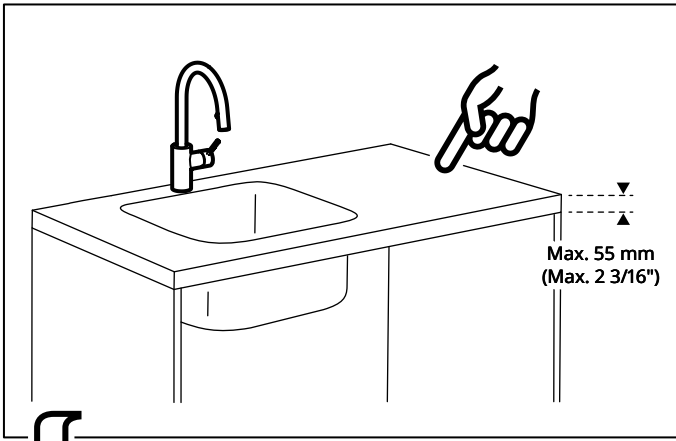

4

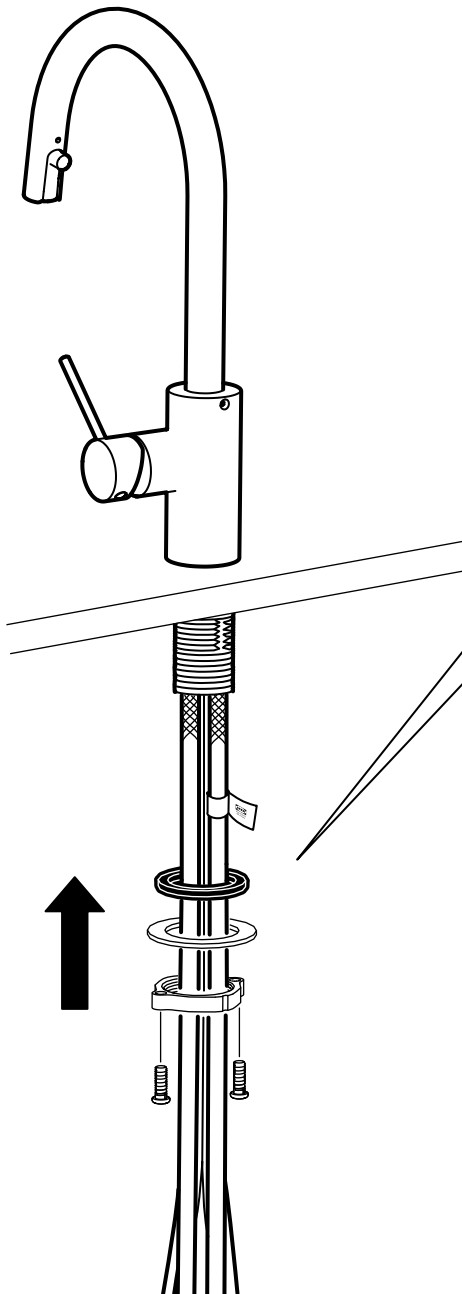

1x

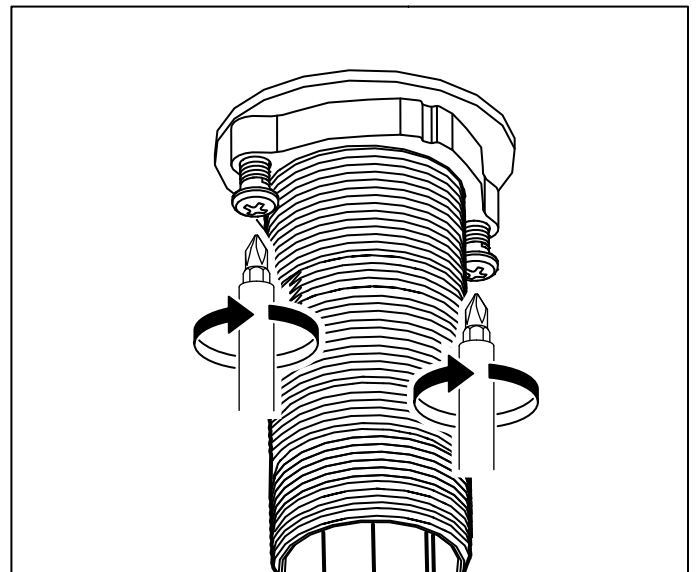
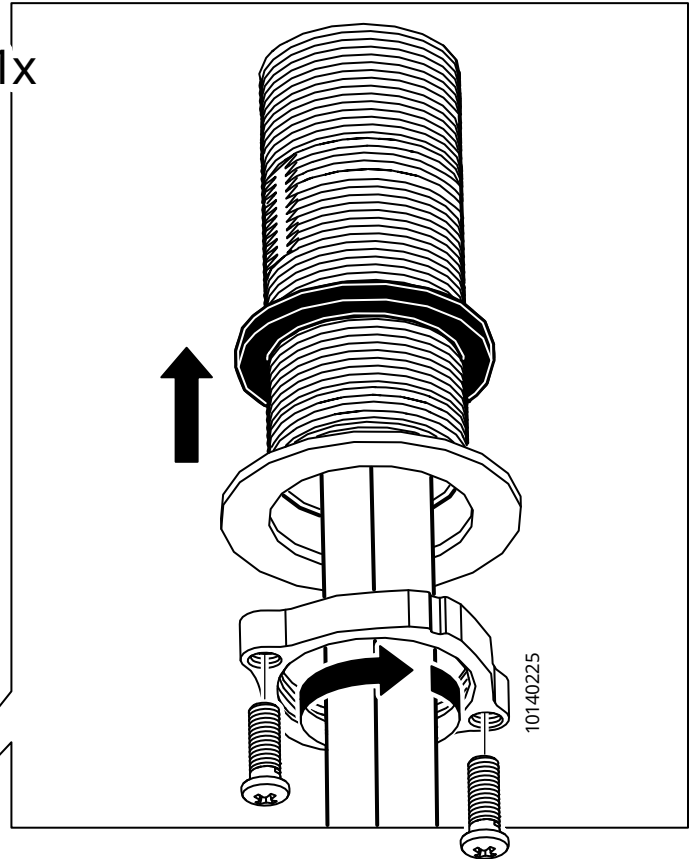

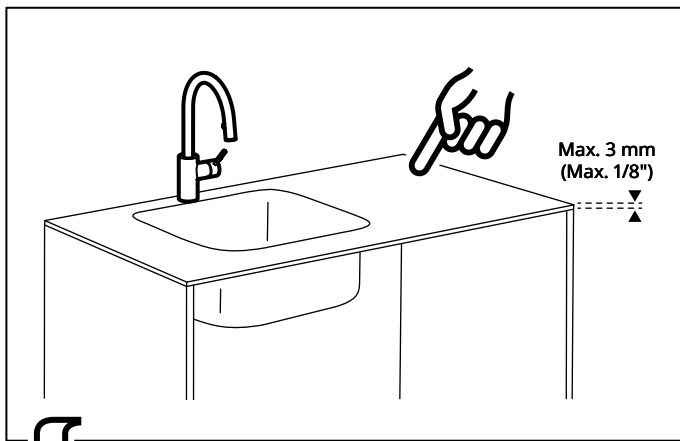

4

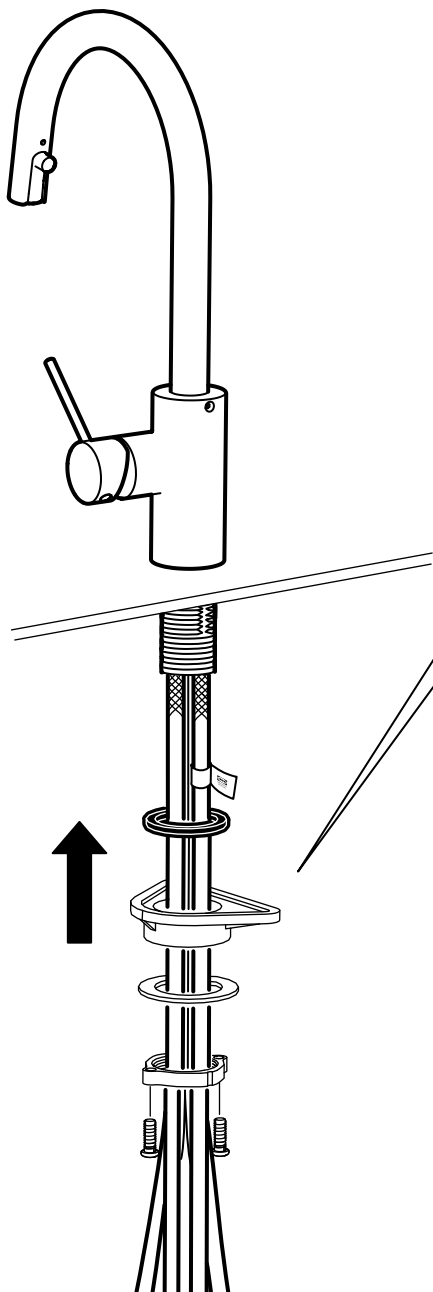

1x

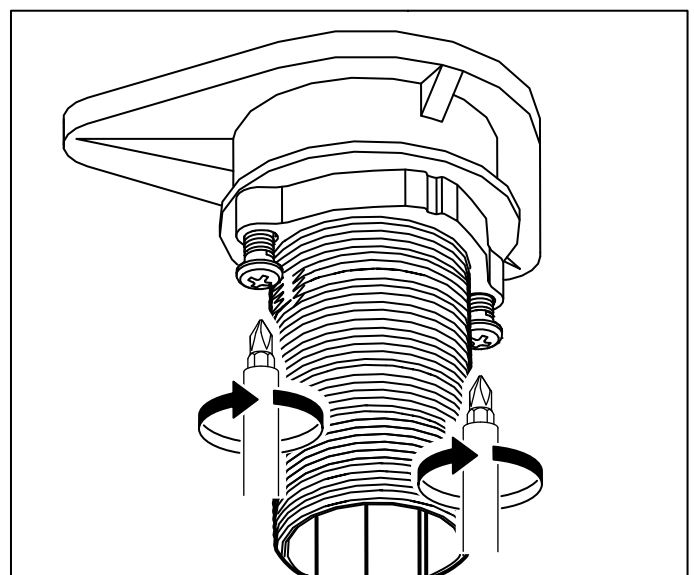
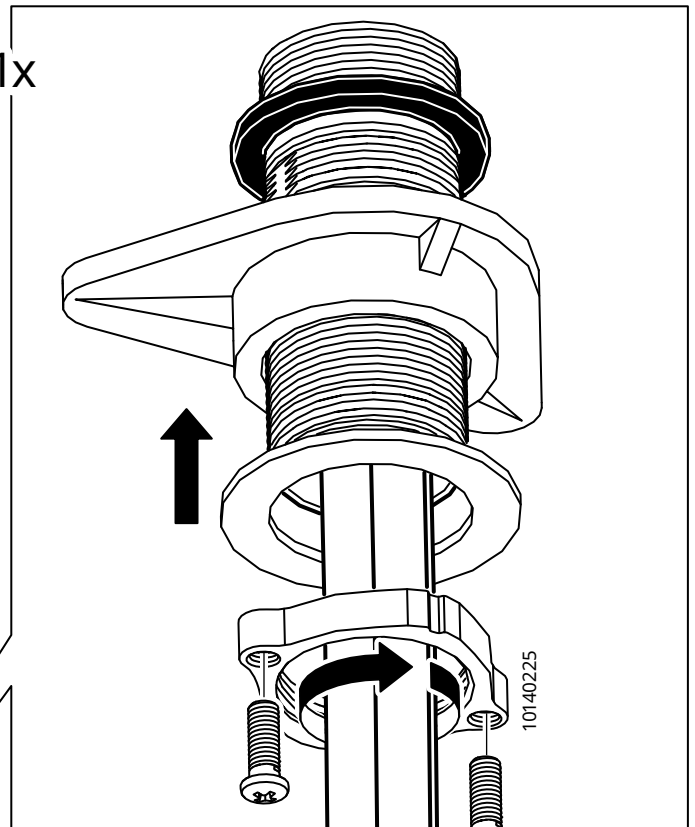

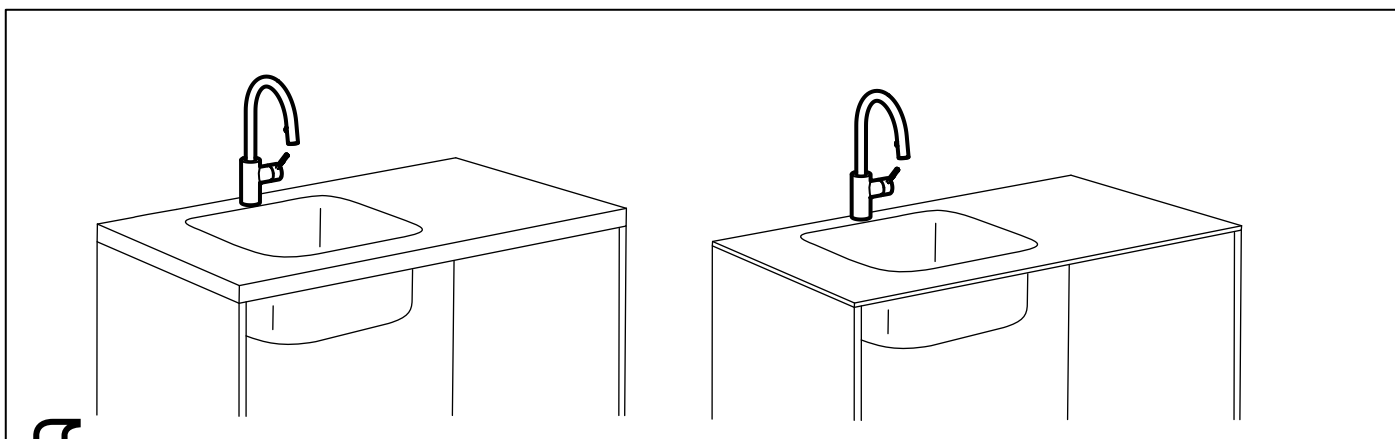

5

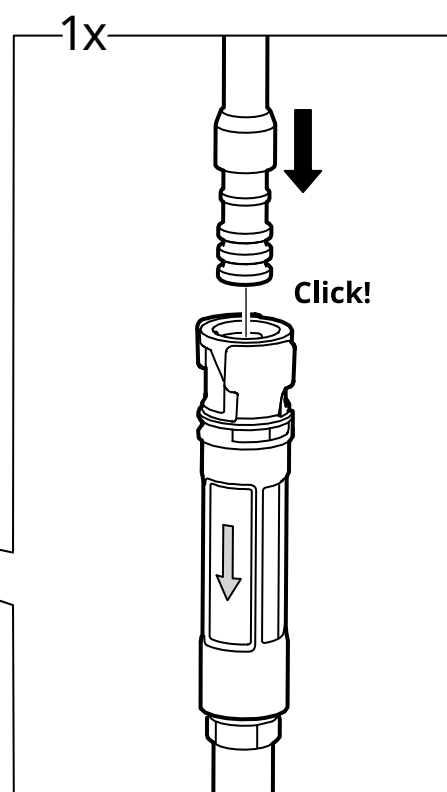
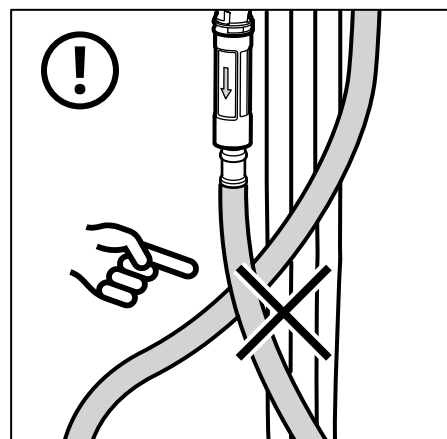
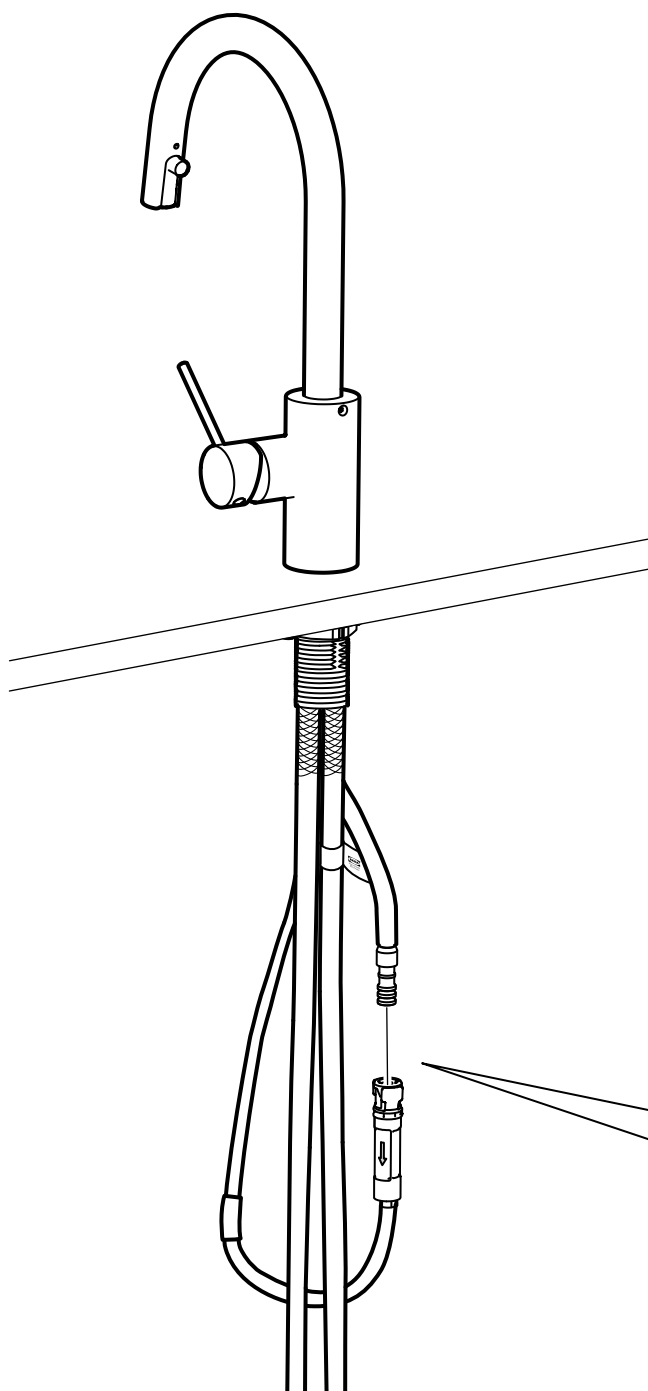

6

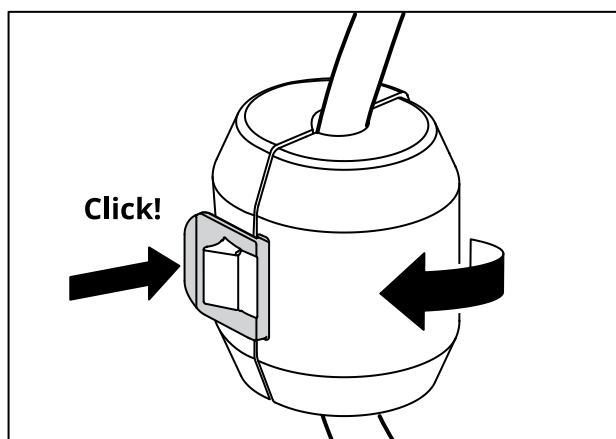
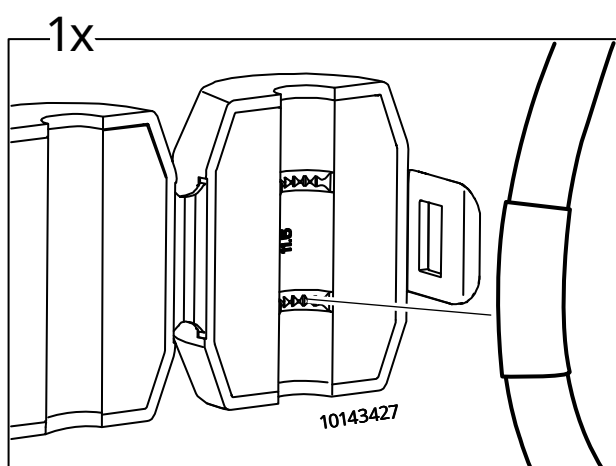
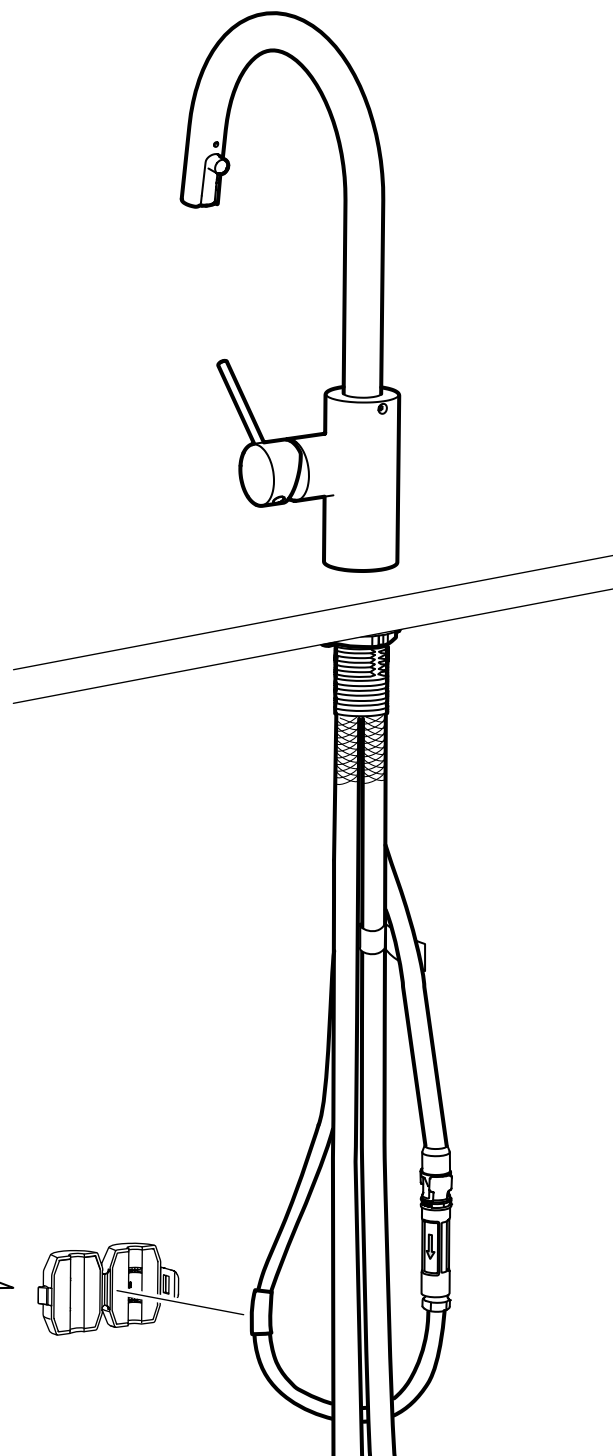

7

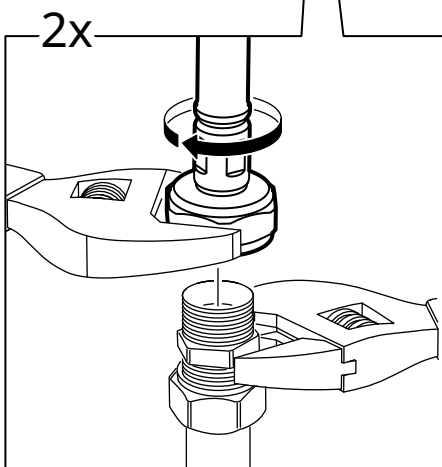
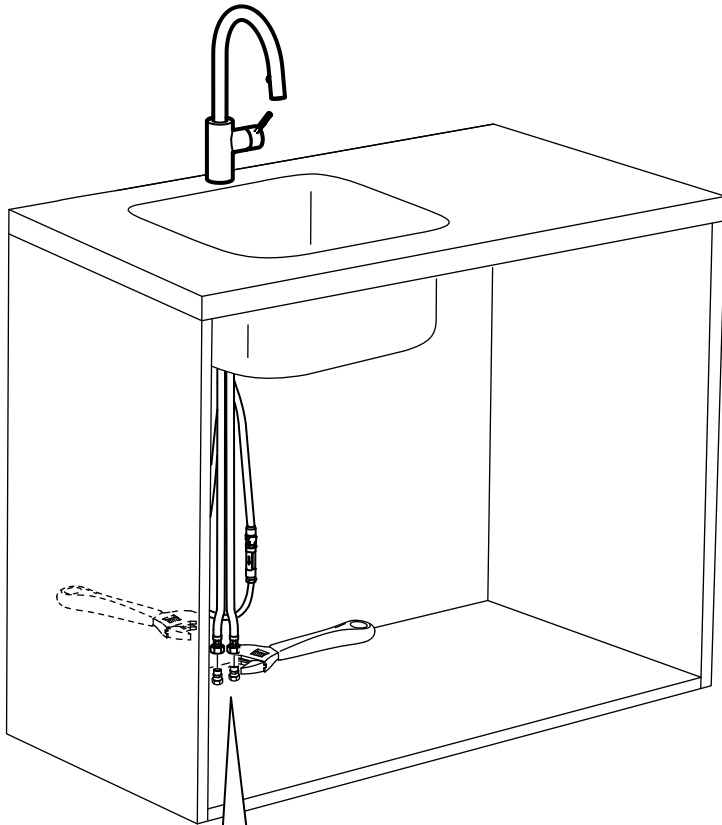

English

IMPORTANT! Do not tighten too hard: this can damage hoses/pipes and washers.

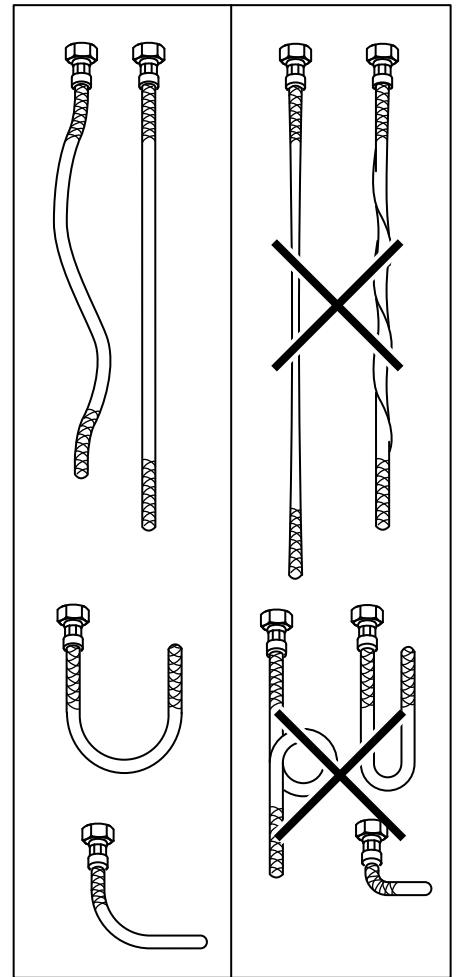

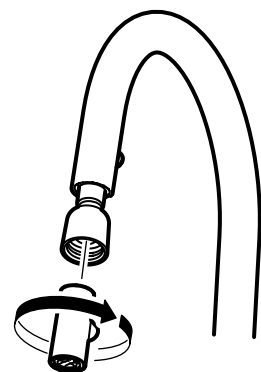
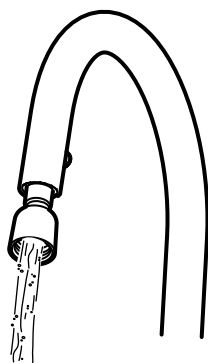
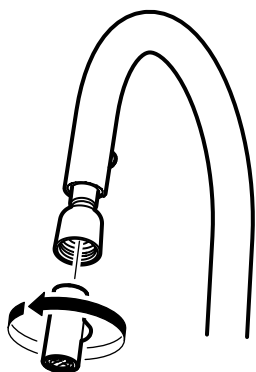

English

Before use: unscrew the hand spray and allow the water to run freely for 5 minutes. Then screw the hand spray back in place.



English

Check at regular intervals to make sure that the installation is not leaking.

