

RUNSKÄR

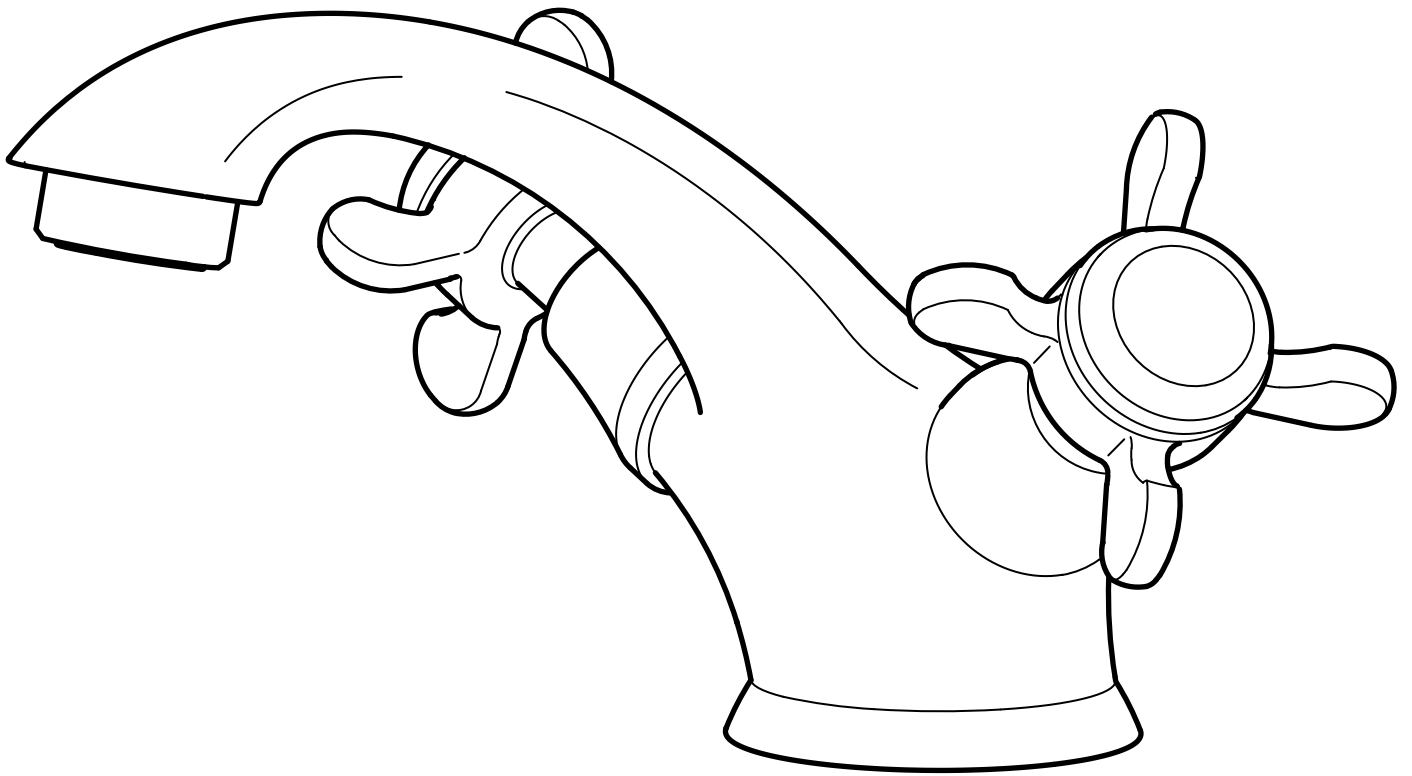

Design and Quality
IKEA of Sweden



English

Installation must be performed in compliance with current local construction and plumbing regulations. If in doubt, contact a professional.



English

Switch off main shut-off valve before changing mixer tap.

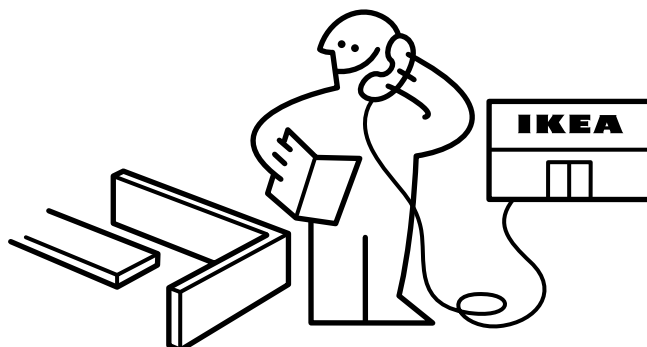
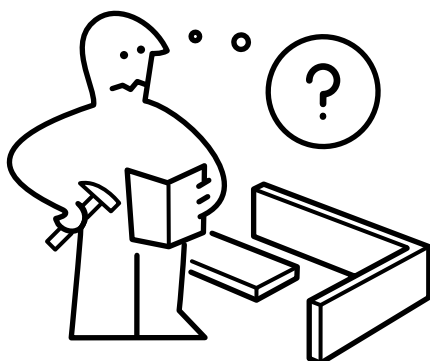
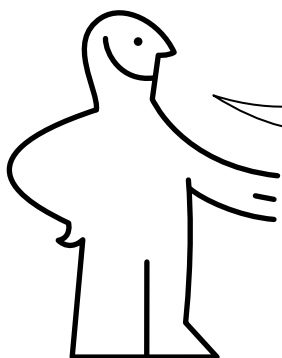

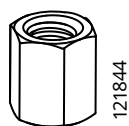
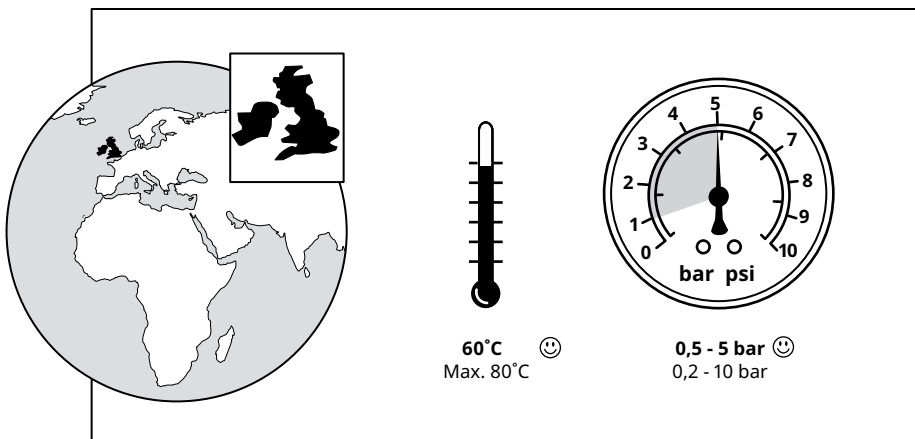
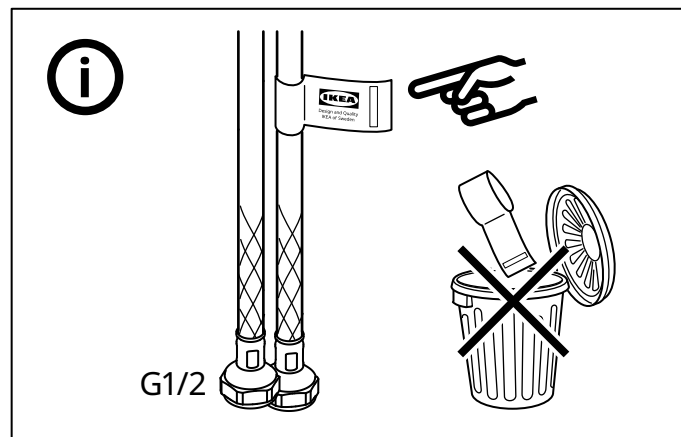
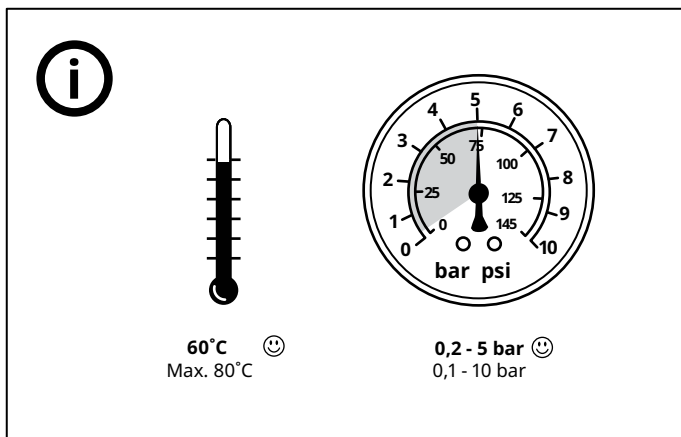

2x

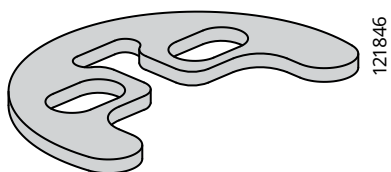

1x

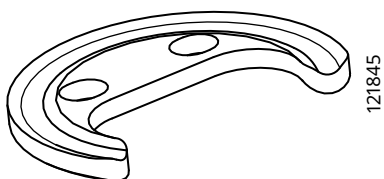

1x

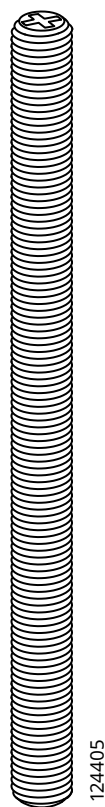

2x

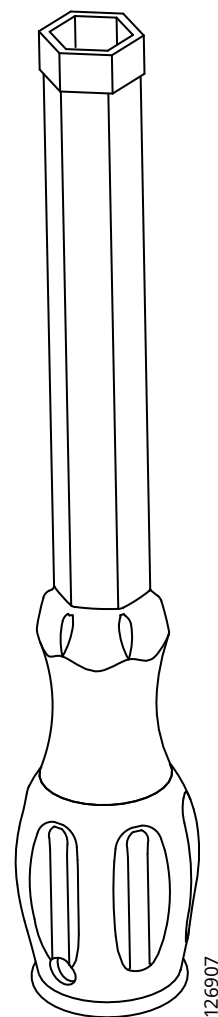

1x

1

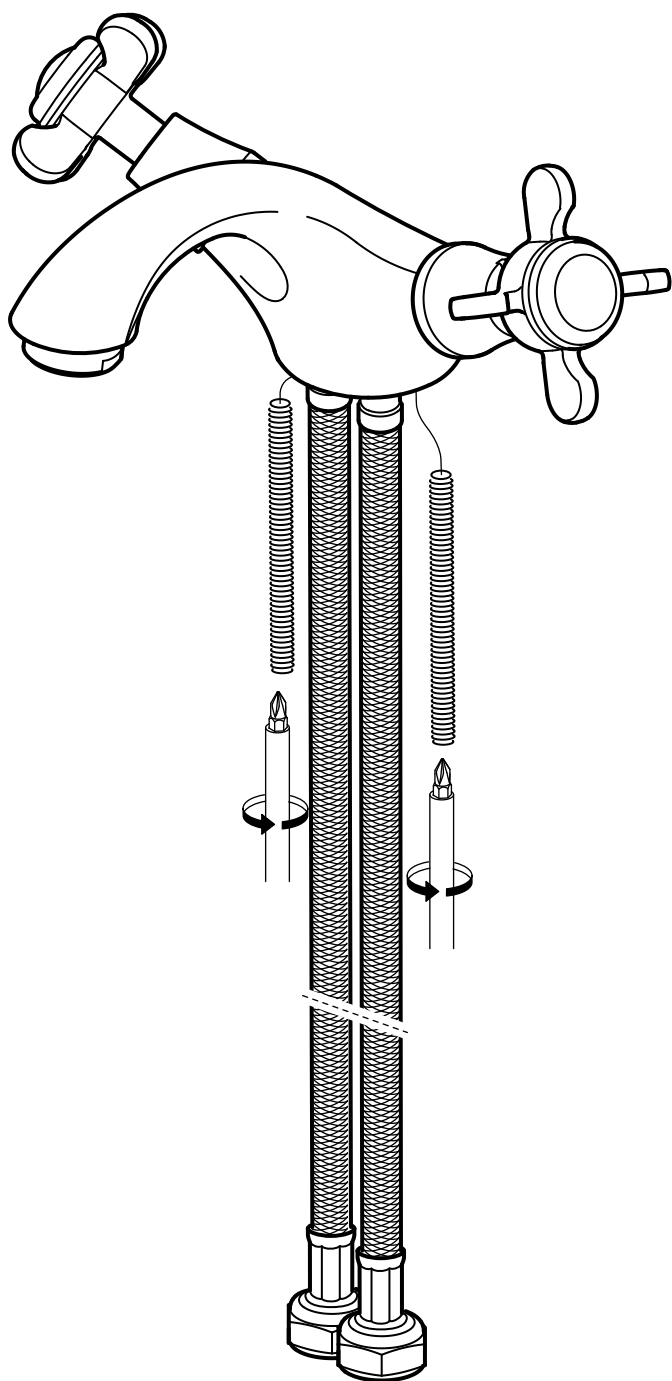

2

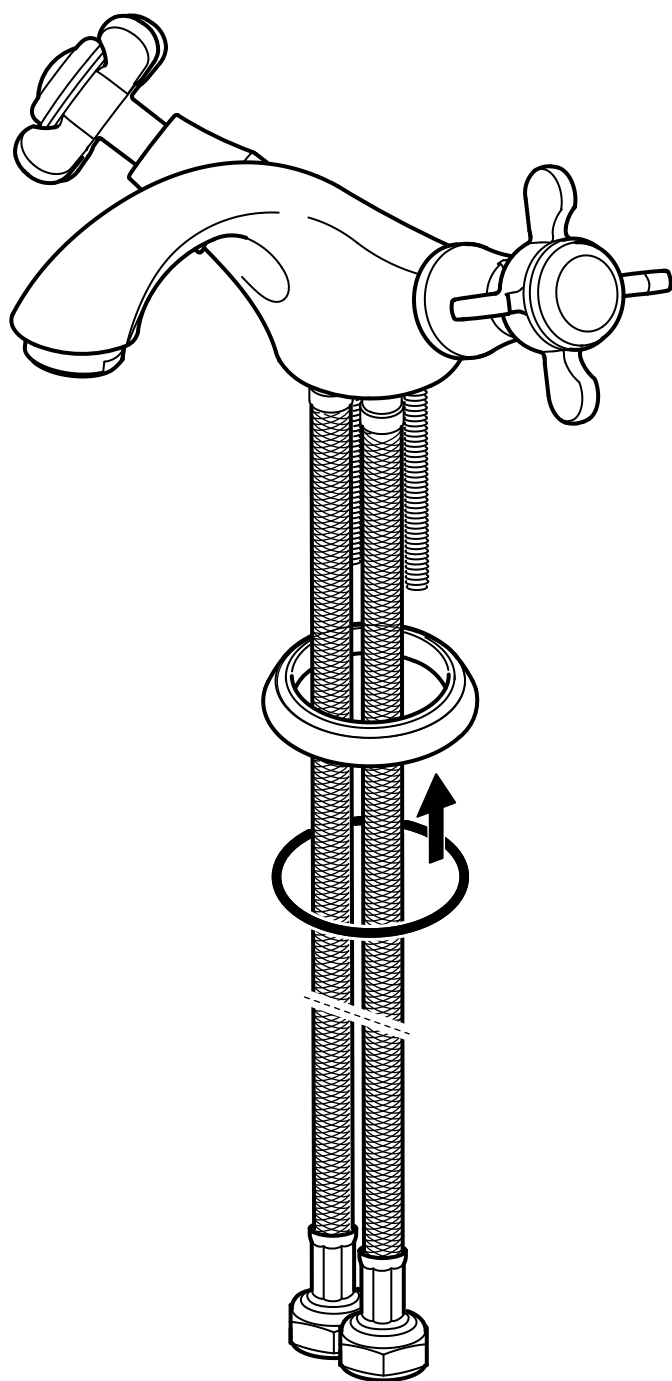

3

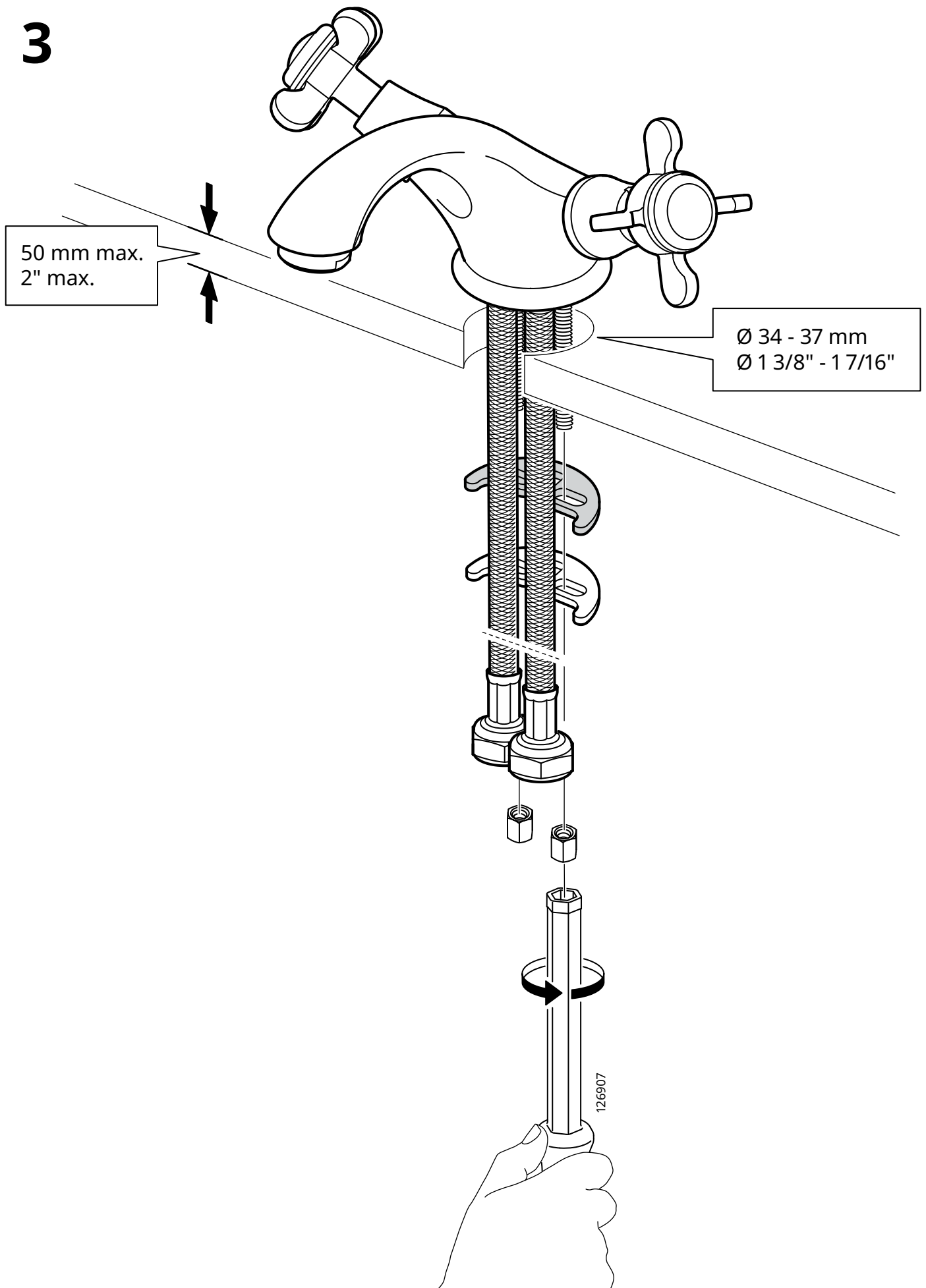

4

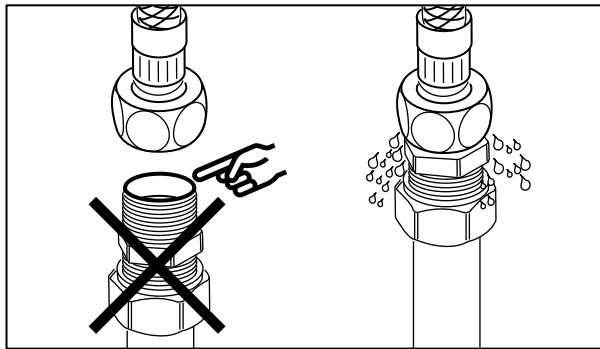
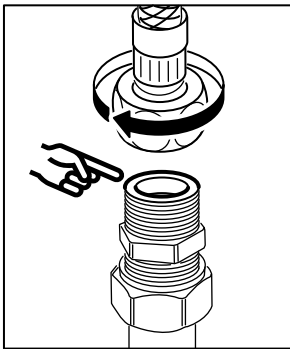
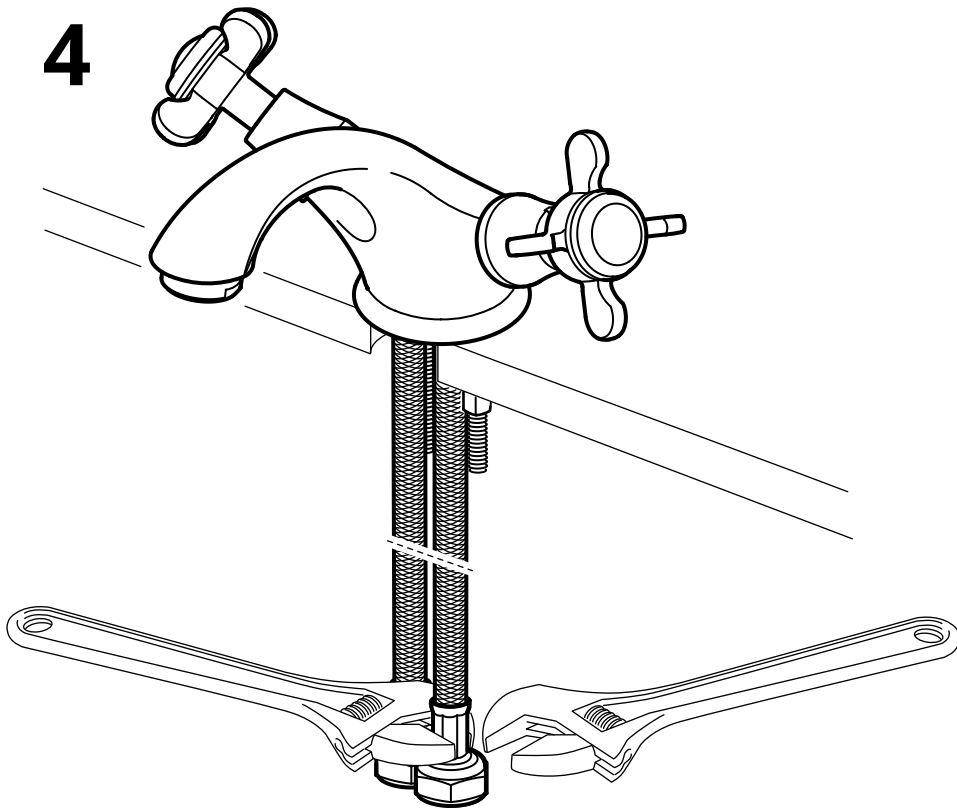

English

IMPORTANT! Do not tighten too hard: this can damage hoses/pipes and washers.

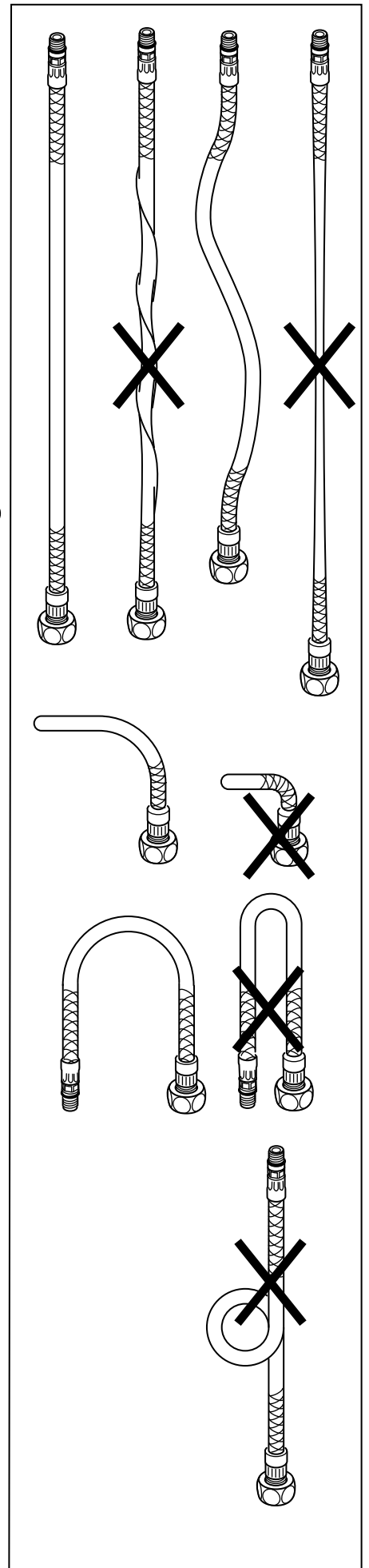

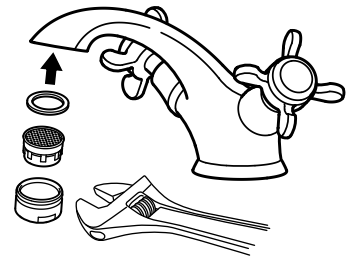
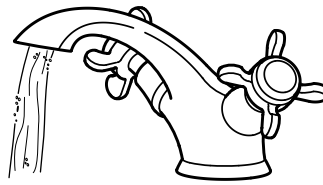
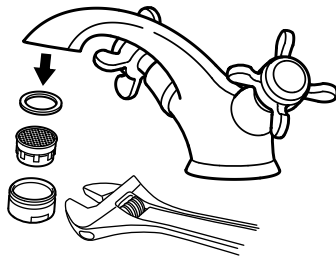

10004087
High pressure



Pre-fitted
Low pressure



10004087
Pre-fitted
High pressure



Low pressure

English

Before use: Unscrew the Aerator/Flow Guide and allow the water to run freely for a few minutes. Then screw the Aerator/Flow Guide back in place. Ensure that it is tight to prevent removal by hand.



English

Check at regular intervals to make sure that the installation is not leaking.

