



A guide to installing
a new ENHET bathroom

ENHET bathroom installation guide



Step-by-step guide to installing your new bathroom

This brochure is your guide to preparing and installing your new bathroom furniture or cabinetry yourself. Inside you'll find tips and ideas, clear steps to follow and the tools you'll need. Use this guide along with your assembly instructions to make sure your bathroom is installed in the correct way.

We're here if you need a hand

Our bathrooms are designed to be as simple as possible for you to assemble and install yourself, but some steps might be a bit more complex and require special skills. That is why we offer a wide range of services to assist you along the way. Maybe you just need a little help, or perhaps someone to do the whole job for you. We are happy to put together a service package that's just right for you. For more information about the services, visit our website at IKEA.ca or get in contact with your local IKEA store.

Before you begin

Before you get started, take a look at this brochure to see what stages are involved in putting in your new bathroom and organize what tools you'll need. When you have received your new bathroom, make sure that it contains all parts. A good way to do this is to check the packages you have at home against the order list. You should only dismantle your old bathroom when you are certain that you have all your new furniture parts. Make sure that the electricity and water supply are shut off before you begin removing your old bathroom and installing your new one.

Hire professionals

It's a good idea to contact qualified specialists early on to discuss the help you'll need with plumbing, tiling and electricity. If you need to modify the location of water or electricity supplies to suit your new bathroom, hire qualified specialists to do a safe and professional job. This will ensure that your home insurance will apply if anything goes wrong now or in the future.

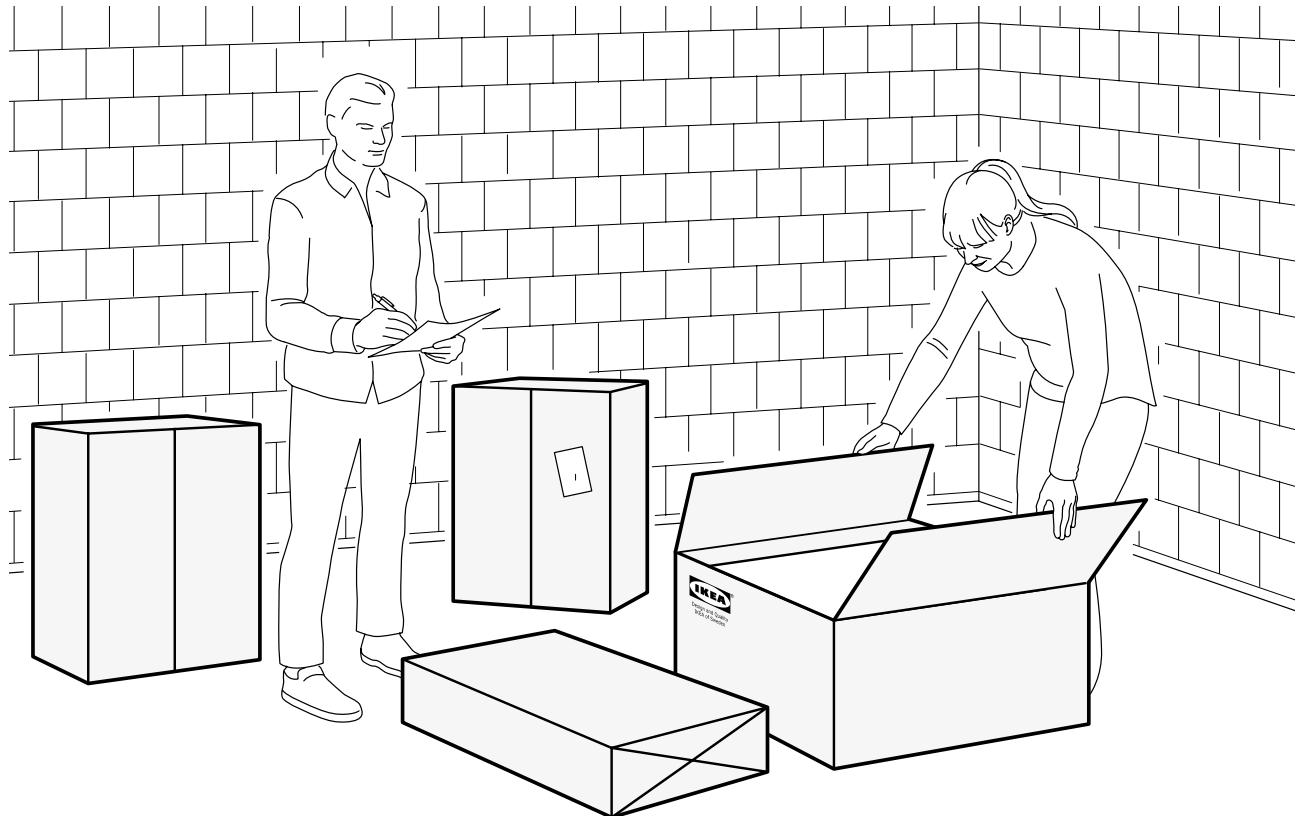

Tools and materials

Here is a summary of the basic tools you'll need.
In addition you'll find what tools to use for each product in their respective assembly instructions.

Tools

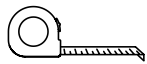

Tape measure

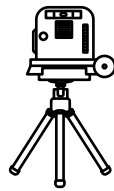

Cross line laser level



Try square



Spirit level

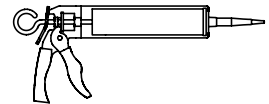

Caulking gun



Step ladder



Stud finder



Pencil



Philips screwdriver



Awl

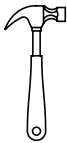

Hammer



Wrench



Protective gloves and goggles

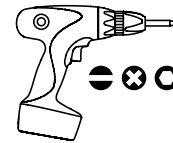

Electric screwdriver

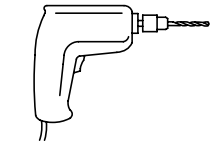

Electric drill

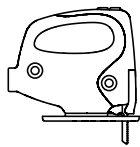

Jigsaw

Materials

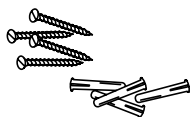

The right types of plugs and screws for your walls

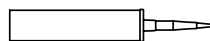

Silicone sealant



Masking tape, to be used when adding the silicone sealant

Preparation is the basis of success

Removing your old bathroom

Turn off the electricity and water supply before you start. Then disconnect all lines to the sink and disconnect appliances. Take care when working with electricity. If in doubt, call in a qualified electrician.

Removing old furniture

Wear safety gloves and goggles when removing the old bathroom furniture. Start with base cabinets and then move on to wall cabinets. If the base cabinet supports a sink, you will need to begin with that. If it has been glued into place, you may need a crowbar to remove it. You can then remove drawers, doors and, lastly, the cabinet itself. Once this is removed it will be easier to remove the wall cabinets.

Responsible disposal

Contact your local authorities to find out how to dispose of your old bathroom in an environmentally friendly way.

Prepare the room

With the room empty, now is the time to prime walls, apply paint, change tiles and/or install new flooring. Keep in mind that new flooring is easier to install at this stage, but remember to protect the new floor surface until the bathroom is finished.

Before you install your new bathroom, make sure that the room is fully prepared for the installation – tiles, pipework and electrical outlets need to be in place according to your plan. You may require some professional assistance to make it safe and secure according to your local plumbing and electrical regulations.



Assess your walls

Since your walls will hold the weight of your bathroom cabinets and frames, start by evaluating the quality and construction of your walls.

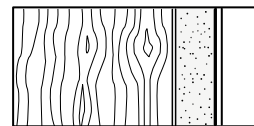

Drywall or plaster with available wood stud



Drywall without available wood stud

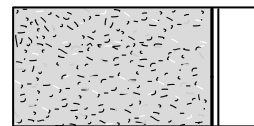

Masonry

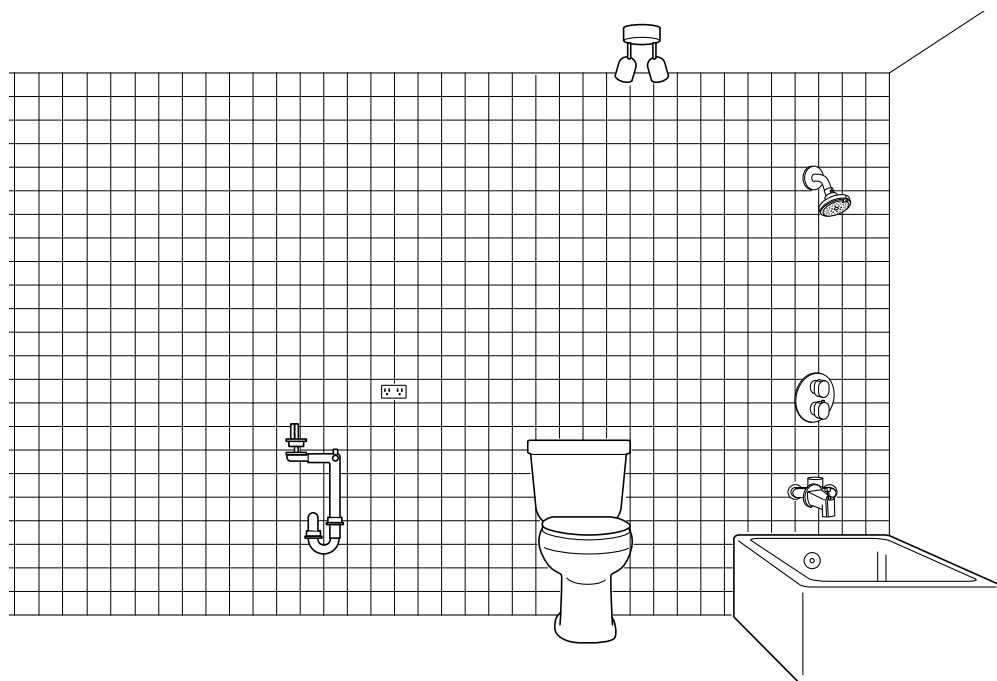

Double-check that your plumbing is where you want it and fits with your layout plan.

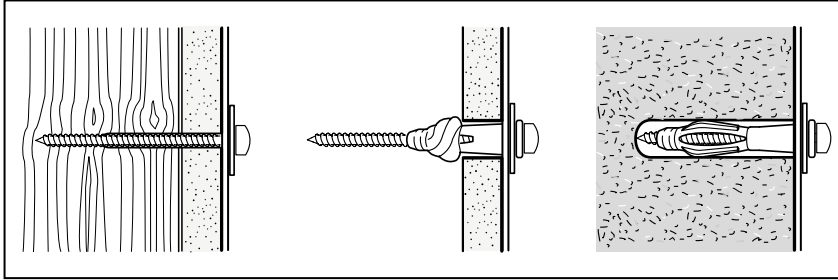

Your walls will hold the weight of your bathroom cabinets/frames so it is critical that you check if your walls are suitable to carry the different bathroom units. Fastening devices for the wall are not included since different wall materials require different types of fastening devices. Use fastening devices suitable for the walls in your home. For advice on suitable fastening devices, contact your local specialized dealer.

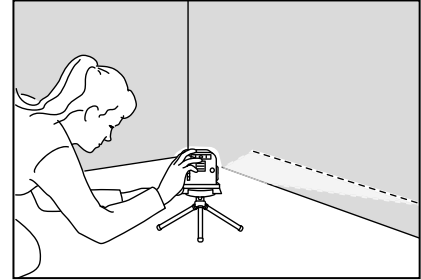

You'll need to find the highest point of the floor and mark where that is on the wall. This will be the point from which to measure the correct level work height for the bathroom furniture.

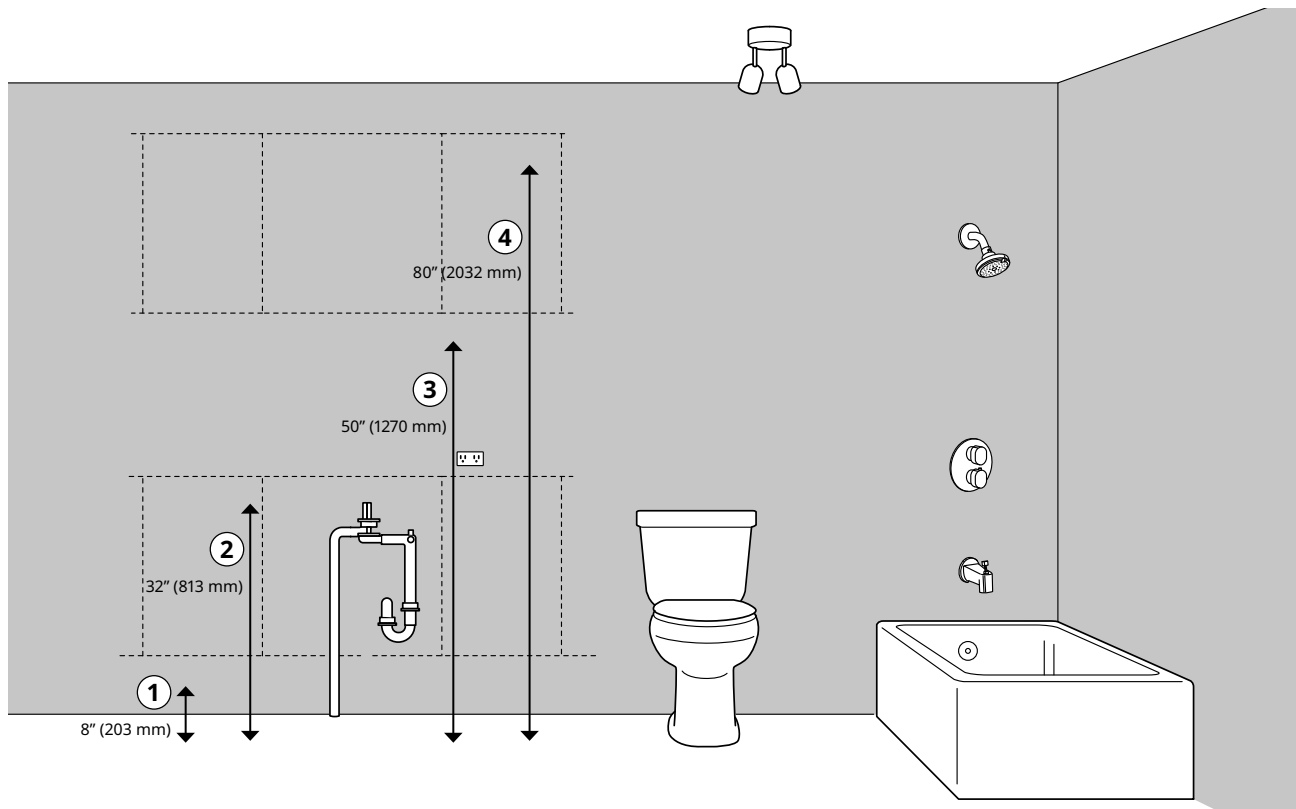

Marking key measurements

There are some key measurements you need to consider and mark on your walls in order to secure proper positioning and alignment of your bathroom furniture. Remember to consider the space needed for doors and drawers to open properly, making sure there are no collisions with, for instance, radiators or windowsills when drawers and doors are opened. If you are uncertain about the ability of the wall to support heavy weight, we recommend that you add legs.

NOTE! These measurements are based on the dimensions of the ENHET system. They can be changed according to your personal preferences.

1. Sink/leg base line 8" (203 mm).
2. Sink cabinet top line 32" (813 mm).
3. Wall cabinet bottom line 50" (1270 mm).
4. Wall units top line 80" (2032 mm).
5. Remember to measure from the highest point of the floor (see previous step).

Check everything and start to assemble

Work area and workflow

Now you are ready to start assembling your cabinets. But instead of rushing into things, prepare the area where you will assemble the cabinets and make sure you have a work area that is safe and big enough. Select an area that is flat, where you can place the cabinet parts. Also be sure to protect the floors.

Check all parts

Double-check to make sure you have all the parts for your bathroom. Sort the packages into groups to avoid confusion over which pieces belong to the cabinet assembly and which belong to the sink, for example. Check again that you have all the required tools and the silicone sealant.

Use the right fastening hardware

Plaster, wood or concrete? Because there are many different types of wall, fastening hardware is not supplied with your furniture. Most hardware stores or home improvement stores stock appropriate fastening hardware and can help you choose the right kind for your walls.

Assembling the cabinets

For a good workflow, it is a good idea if you assemble all frames one by one and push them aside until it is time to install them. Follow the assembly instructions that come with each module and assemble all cabinet frames. Wait until later to fit drawers, shelves and fronts.

It is important to secure that your bathroom walls can support the weight of the sink cabinet. If you are uncertain about the ability of the wall to support heavy weights, we recommend that you add ENHET legs.

Follow the assembly instructions for your cabinet and/or frame to make sure that you are using the correct legs.

Be aware that ENHET system has different types of units, closed cabinets and open frames that have different ways of installation.

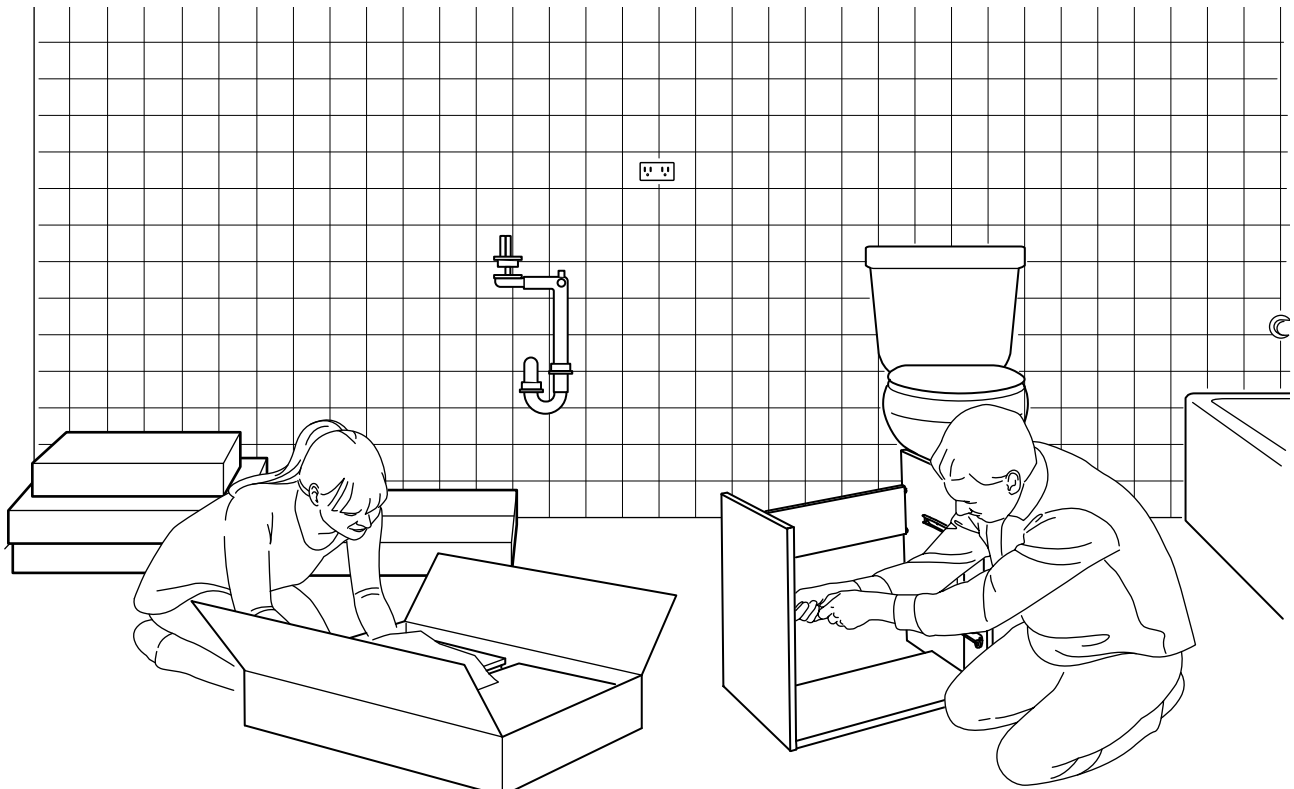

Installing the sink cabinet

Be aware that the ENHET system has different types of units, closed cabinets and open frames that have different ways of installation.

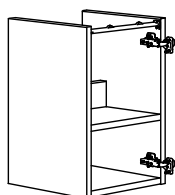

Closed cabinet

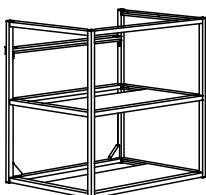

Open frame

Take your time and make sure that you have a helping hand during this stage of the process. Also make sure you have all the required tools, silicone and fastening hardware close at hand.



IMPORTANT

Fastening devices for the wall (i.e. screws and plugs) are not included with the cabinets and frames since different wall materials require different types of fastening devices. Use fastening devices suitable for the walls in your home. For advice on suitable fastening devices, contact your local specialized dealer.

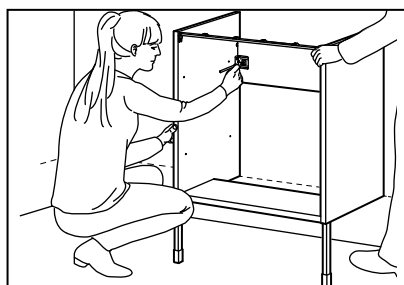

Locate the drill points. Align the bottom of the cabinet/frame with the base line 8" (203 mm) and hold it against the wall while marking the holes for the wall fastening. Then, remove the cabinet/frame and drill at the marked positions.

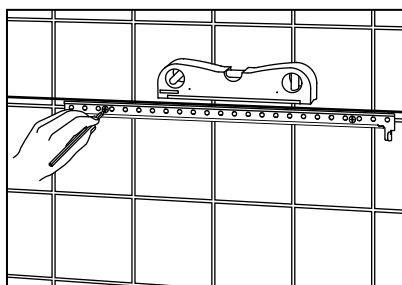

NOTE: For open frame installation you will need to install the suspension rail first. Align the suspension rail with the top sink cabinet line 32" (813 mm) and hold it against the wall while marking the holes for the wall fastening. Then, remove the suspension rail and drill at the marked positions.



Drill and use silicone. Drill the mounting holes and insert mounting screws at the marked points. Do not fully tighten the screws at this point. A diamond-tipped drill bit helps avoid tile damage. If you haven't got one, the next best thing is to put masking tape on the tile to prevent the drill from slipping.

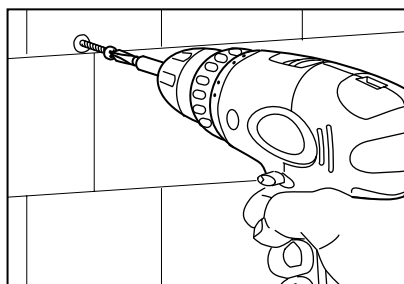

Before you fasten the screws, remember to fill the drill holes with silicone. As you fasten the screws, keep in mind not to fully tighten the screws at this point.

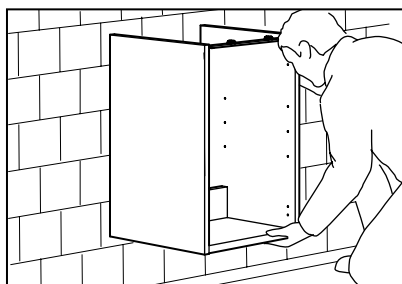

Ensure you have fastened the mounts at the rear of the sink cabinet according to the assembly instructions. Then gently lift the cabinet onto the mounting screws.

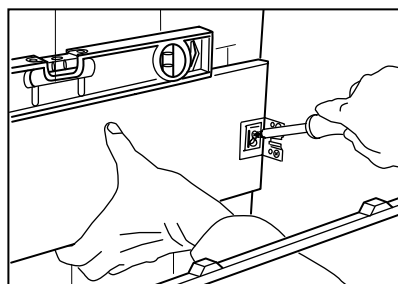

Use the spirit level again to ensure your sink cabinet is even. The mounts allow some adjustment if it is not perfectly even. When the cabinet is level, tighten the screws.



If you build a solution with frames placed next to each other, be sure to connect them with the clamps included with the frames.

Installing wall and high cabinet/frame(s)

Take your time and make sure that you have a helping hand during this stage of the process. Also make sure you have all the required tools, silicone and fastening hardware close at hand.

It is important to make sure that your bathroom walls can support the weight of the cabinets/frames. If your walls can't support the weight of the high cabinet/frame, it is possible to use the ENHET legs for support. Follow the assembly instructions for your cabinet and/or frame to make sure you are using the correct leg.



After you have installed the sink cabinet, draw a vertical line from the side of the sink cabinet.

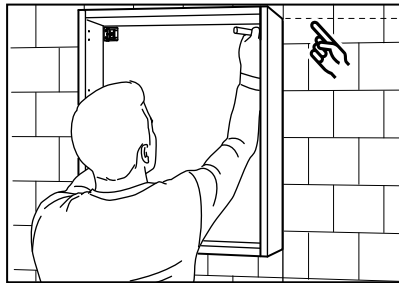

Then, hold the wall cabinet in a position that aligns with the previously marked wall cabinet top line and the vertical line that you have just drawn. Once aligned, mark the holes for wall mounting.

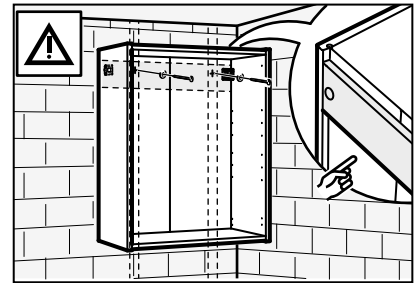

NOTE! If you do not have a horizontal structural support between the studs and you have problems to hit two studs with the metal brackets you should use the wall back rail that gives you the opportunity to hit both studs. Please follow the Assembly Instruction steps where this option is presented.

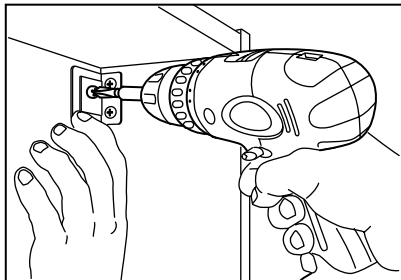

Next, repeat the process of drilling and sealing before fastening the screws halfway in (step 2 on the previous page). After you have mounted and aligned the cabinet with the horizontal wall cabinet line, tighten the screws.

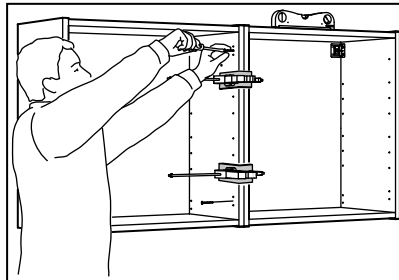

If you have more than one cabinet, level and align the second cabinet with the first. After you've mounted the second cabinet, attach the two with the screws provided with the cabinet.

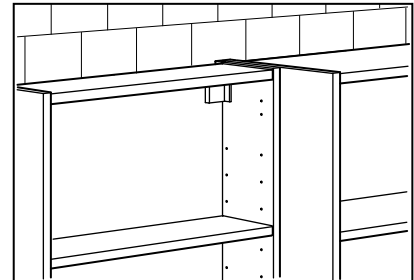

When installing a high cabinet, align the high cabinet with the adjacent wall cabinet or the previously marked high cabinet line. After you've marked the holes for wall fastening, repeat the process of drilling, sealing and mounting the cabinet or frame. Make sure all units align before you tighten the screws.

Installing suspension rail for wall and base open frames

Now it's time to install the open frames. For the frames installation, you will use a suspension rail that will help secure the frames to the wall.



Fastening devices for the wall (i.e. screws and plugs) are not included with the cabinets and frames since different wall materials require different types of fastening devices. Use fastening devices suitable for the walls in your home. For advice on suitable fastening devices, contact your local specialized dealer.

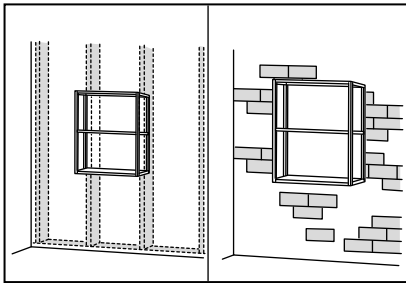

IMPORTANT! Before installing wall cabinets/frames, it's important to check the type of material used to build the wall.

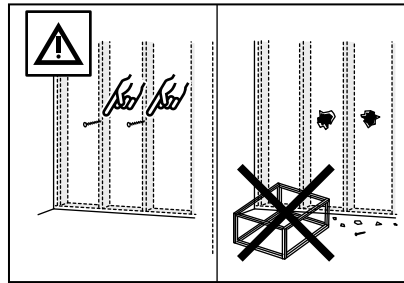

When you have studs in the wall, it's important to find them before you start the wall installation. This is to secure that the wall cabinets and frames are safely attached to the wall.

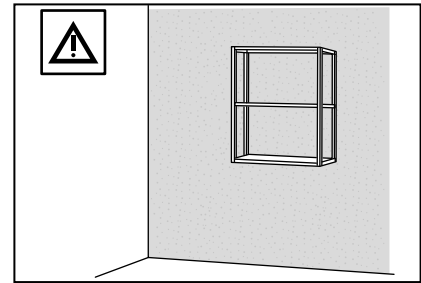

When you have concrete walls to work with it's important to know what kind of fittings to use and tools. **NOTE!** The screws provided by IKEA do not work in concrete. Contact your local dealer to find out which fastening hardware to use.

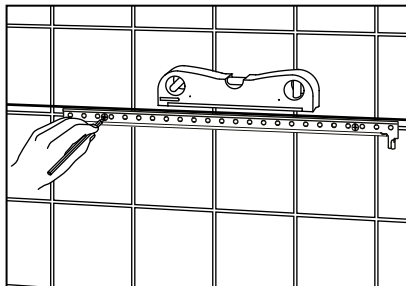

When you install the suspension rail, use the wall units' top line. This way you will align the top of the open frame with the top of the adjacent cabinet before you fasten the frame to the wall. Mark and level to prepare the installation of the suspension rail where you will apply your open frames.

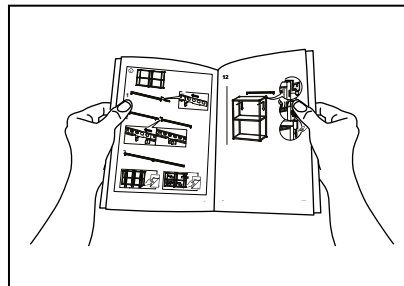

NOTE! Please go to the Assembly instructions provided with the product. There, you will find more information on how to install the suspension rail on different walls.

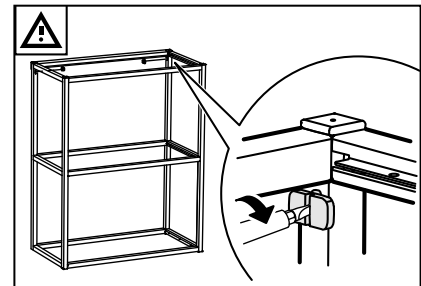

Next, follow the assembly instructions to apply and safely secure the open frame to the suspension rail.

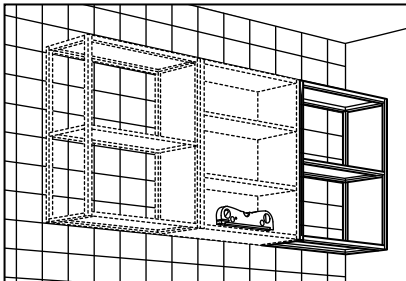

At this point, you should be done with mounting your wall combination. Check that it's level to be sure that it has been secured correctly.

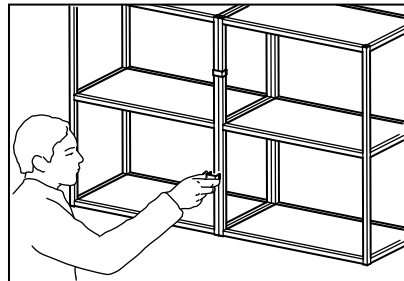

If you build a solution with frame(s) placed next to each other, be sure to connect them with the clamp (fitting) included with the frames.

Installing sink, water trap and faucet

Before you start installing the sink and faucet, make sure the water connections are compatible (water supply with faucet hoses.) Then, switch off the main water valve.

NOTE!

If you plan to install a sink without a cabinet underneath, see this installation option in the sink assembly instructions.

Keep in mind that installation must be performed in compliance with current local construction and plumbing regulations. If in doubt, contact a professional.



Turn the sink upside down and attach the water trap according to the assembly instructions.

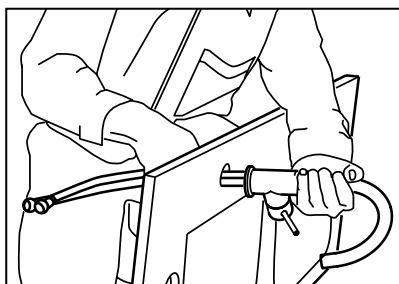

Follow the faucet assembly instructions to fit the faucet onto the sink. Loosely tighten the two nuts that attach the faucet to the sink, so you can adjust the position of the faucet once it's in position on the sink cabinet.

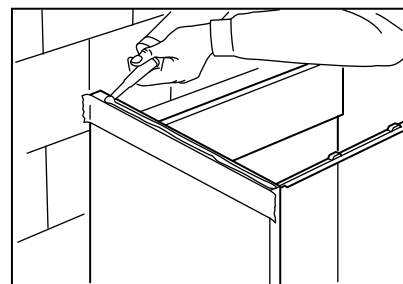

Add silicone sealant on the top edge of the sink cabinet sides. Using tape before you apply the silicone helps prevent smearing the silicone.

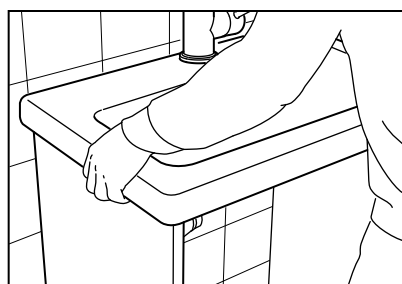

Next, place the sink on top, remove the tape, and let dry for at least 3 hours. You can then add a bead of silicone between the sink and the wall.

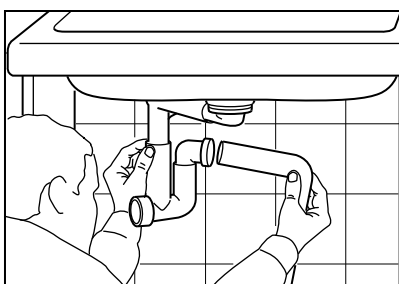

Once the silicone has dried, finalize the water trap installation and connect all the faucet hoses according to the assembly instructions.

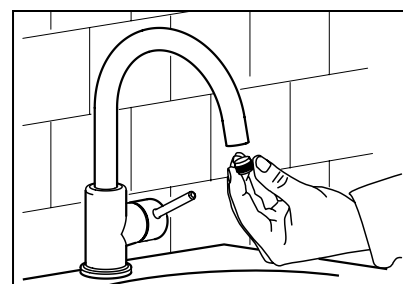

You can now turn on your main water valve. Remove the filter from the faucet and let the water run freely for 5 minutes. Check there is no leakage around the hose connections or the water trap. Then screw the filter back in place.

Installing lighting, drawers, doors, shelves, knobs and handles

With your cabinets, countertops and appliances in place, it's time to move onto installing your lighting as well as fitting the cabinet interiors.

NOTE! Always use your assembly instructions for help.

Then, take your time assembling doors, fronts, knobs and handles to make sure everything looks the way you want.

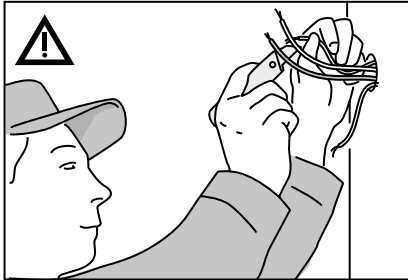

When installing lighting, keep in mind that all electrical connections must be made by a qualified person.

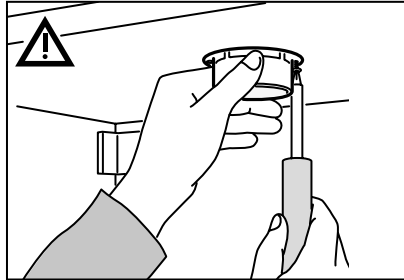

If drilling holes, use a piece of wood to meet the drill as it penetrates the surface to prevent the edges from splintering.

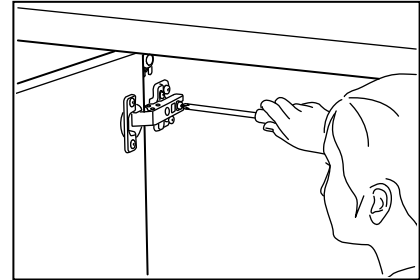

Next, follow the assembly instructions to mount the doors and install the drawers. Once the doors and drawers are in position, you can adjust any potential misalignment by adjusting the hinges and drawers.

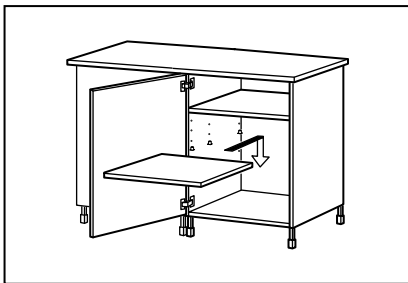

Now it's time for you to install your shelves inside your cabinets using the shelf support that comes with the shelves.

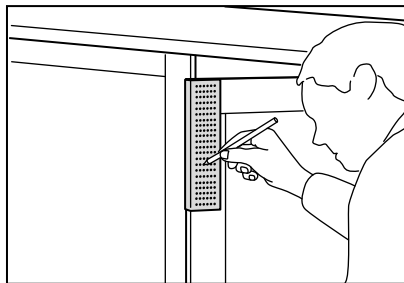

Once you have decided on the placement of your knobs and/or handles, we recommend using the FIXA drilling template to assemble the knobs and/or handles, for an easier process and a better result.

The finishing touches make all the difference

Your dream bathroom starts with thorough planning. From considering you and your family's activities and needs, to preparing the room and installing your bathroom furniture. But to complete your solution you may want to personalize it by making it even more functional and coordinated. You can add accessories, such as the ENHET swivel shelf or ENHET hooks along with SKATTÅN container, which can be easily fitted to your open ENHET frames.

IKEA also offers a wide range of colorful bath textiles, bathroom accessories and lighting for every taste and style. Textiles help you complete your dream bathroom by adding softness and beauty that suit you and your family.



Services

Our broad service offer gives you the freedom to decide how much you want to do yourself and how much you want us to do for you.

Below you'll find all the services that we can offer, please visit [IKEA.ca](https://www.ikea.ca) or contact your local IKEA store for more information.



Planning

Get help with the planning of your new bathroom by booking an appointment with one of our experts at IKEA. You bring the measurements and drawing or a picture of the area – we help you with inspiration and functional solutions for everything, from the placement of cabinets and appliances, desks and storage to lighting, and sinks.



Delivery

Whether you're shopping in store or online, and no matter how big the purchase, we'll do the heavy lifting and bring it to your home or business. We offer a range of delivery options that suit your needs.

Notes

[illegible]

A high level of accuracy has been sought in preparing this installation guide, we cannot guarantee that there are no errors or omissions nor will we be bound by them. Please see an IKEA co-worker or visit [IKEA.ca](https://www.IKEA.ca) if more information is needed.

