

LAGAN L

en



Design and Quality
IKEA of Sweden



ENGLISH

Please refer to

www.IKEA.com/au

and select your local store for local store phone numbers and opening time.

The electronic user manual is available at www.ikea.com.

Contents

Safety information	5	Freezer compartment.....	11
Safety instructions	6	Daily use.....	12
Installation	8	Cleaning and maintenance.....	12
First use.....	9	Troubleshooting.....	13
Product description	9	Technical information.....	15
Operation.....	10	Environmental concerns	15
Refrigerator compartment	11	IKEA GUARANTEE	16

Safety information

Before the installation and use of the appliance, carefully read the supplied instructions. The manufacturer is not responsible if an incorrect installation or use causes injuries or damages. Always keep the instructions with the appliance for future reference.

Children and vulnerable people safety



WARNING: Risk of fire /
Flammable materials

- This appliance is not intended for use by persons (including children) with reduced physical, sensory or mental capabilities, or lack of experience and knowledge, unless they have been given supervision or instruction concerning use of the appliance by a person responsible for their safety. Children shall not play with the appliance. Cleaning and user maintenance shall not be made by children without supervision. Children should be supervised to ensure that they do not play with the appliance.
- Do not let children play with the appliance.
- Children shall not carry out cleaning and user maintenance of the appliance without supervision.
- Keep all packaging away from children and dispose of it appropriately.

General Safety

- This appliance is intended to be used in household and similar applications such as:

- staff kitchen areas in shops, offices and other working environments;
- farm houses and by clients in hotels, motels and other residential type environments;
- bed and breakfast type environments;
- catering and similar non-retail applications.
- **WARNING:** Keep ventilation openings, in the appliance enclosure or in the built-in structure, clear of obstruction.
- **WARNING:** Do not use mechanical devices or other means to accelerate the defrosting process, other than those recommended by the manufacturer.
- **WARNING:** Do not damage the refrigerant circuit.
- **WARNING:** Do not use electrical appliances inside the food storage compartments of the appliance, unless they are of the type recommended by the manufacturer.
- **WARNING:** Do not use water spray and steam to clean the appliance.
- **WARNING:** Clean the appliance with a moist soft cloth. Only use neutral detergents. Do not use abrasive products, abrasive cleaning pads, solvents or metal objects.
- **WARNING:** Do not store explosive substances such as aerosol cans with a flammable propellant in this appliance.
- **WARNING:** If the supply cord is damaged, it must be replaced by the manufacturer, its service agent or

similarly qualified persons in order to avoid a hazard.

- **WARNING:** When positioning the appliance, ensure the supply cord is not trapped or damaged.
- **WARNING:** Do not locate multiple portable socket-outlets or portable power supplies at the rear of the appliance.

To avoid contamination of food, please respect the following instructions:

- Opening the door for long periods can cause a significant increase of the temperature in the compartments of the appliance.
- Clean regularly surfaces that can come in contact with food and accessible drainage systems.
- Clean water tanks if they have not been used for 48 hours; flush the water system connected to a water supply if water has not been drawn for 5 days.

- Store raw meat and fish in suitable containers in the refrigerator, so that it is not in contact with or drip onto other food.
- If the refrigerating appliance is left empty for long periods, switch off, defrost, clean, dry, and leave the door open to prevent mould developing within the appliance.
- This refrigerating appliance is not intended to be used as a built-in appliance.
- Two-star frozen-food compartments are suitable for storing pre-frozen food, storing or making ice-cream and making ice cubes.
- One-, two- and three-star compartments are not suitable for the freezing of fresh food.
- **WARNING:** To avoid a hazard due to instability of the appliance, it must be fixed in accordance with the instructions.

Safety instructions

Installation

⚠ WARNING! Only a qualified person can install this appliance.

- Remove all the packaging.
- Do not install or use a damaged appliance.
- Follow the installation instructions supplied with the appliance.
- Always take care when moving the appliance as it is heavy. Always use safety gloves and enclosed footwear.
- Be careful not to damage the floors (e.g. parquet) when moving the appliance.
- Make sure the appliance is not near a heat source.
- Install and level the appliance on a floor strong enough to take its weight and in a place suitable for its size and use.
- Make sure the air can circulate around the appliance.
- At first installation or after reversing the door wait at least 4 hours before connecting the appliance to the power supply. This is to allow the oil to flow back into the compressor.
- Before carrying out any operations on the appliance (e.g. reversing the door), remove the plug from the power socket.
- The rear of the appliance must stand against the wall.

- Do not install the appliance where there is direct sunlight.
- Do not install this appliance in areas that are too humid or too cold such as wine cellars.

Electrical connection

⚠ WARNING! Risk of fire and electrical shock.

⚠ WARNING! When positioning the appliance, ensure the supply cord is not trapped or damaged.

⚠ WARNING! Do not use multi-plug adapters or extension cables.

- The appliance must be earthed.
- Make sure that the parameters on the rating plate are compatible with the electrical ratings of the mains power supply.
- Always use a correctly installed shockproof socket.
- Make sure not to cause damage to the electrical components (e.g. mains plug, mains cable, compressor). Contact an Authorised Service Centre or an electrician to change the electrical components.
- The mains cable must stay below the level of the mains plug.

- Connect the mains plug to the mains socket only at the end of the installation. Make sure that there is access to the mains plug after the installation.
- Do not pull the mains cable to disconnect the appliance. Always pull the mains plug.

Use

⚠ WARNING! Risk of injury, burns, electrical shock or fire.



The tubes of the refrigeration circuit contain a small quantity of the environmentally friendly but flammable refrigerant R600a. It does not damage the ozone layer and does not increase the greenhouse effect. If refrigerant escapes, it may injure your eyes or ignite. Do not damage the tubes.

- The surface of the compressor may become hot under normal operation. Do not touch it with hands.
- Do not change the specifications of this appliance.
- Do not put electrical appliances (e.g. ice cream makers) in the appliance unless they are stated applicable by the manufacturer.
- If damage occurs to the refrigerant circuit, make sure that there are no flames and sources of ignition in the room. Ventilate the room.
- Do not let hot items touch the plastic parts of the appliance.
- Do not store bottled drinks in the freezer compartment to prevent burst or other losses.
- Do not store flammable gases or liquids in the appliance.
- Do not put flammable products or items that are wet with flammable products in, near or on the appliance.
- Do not touch the compressor or the condenser. They are hot.
- Do not remove or touch items from the frozen-food compartment if your hands are wet or damp.
- Do not swallow the contents (non-toxic) of the ice packs.
- Do not eat ice cubes or ice lollies immediately after taking them out of the freezer since they may cause cold burns.
- Thawed food should not be put back in the frozen-food compartment.
- Follow the storage instructions on the packaging of frozen food.

Internal lighting

⚠ WARNING! Risk of electric shock.

- The bulb used inside the appliance is specifically designed for domestic appliances and is not suitable for general room lighting within the home.

Care and cleaning

⚠ WARNING! Risk of injury or damage to the appliance.

- Before maintenance, deactivate the appliance and disconnect the mains plug from the mains socket.
- This appliance contains hydrocarbons in the cooling unit. Only a qualified person can do the maintenance and the recharging of the unit.
- Regularly examine the drain of the appliance and if necessary, clean it. If the drain is blocked, defrosted water collects at the bottom of the appliance.

Service

- To repair the appliance contact an Authorised Service Centre.
- Use original spare parts only.

Disposal

⚠ WARNING! Risk of injury or suffocation.

- Disconnect the appliance from the mains supply.
- Cut off the mains cable and discard it.
- Remove the doors to prevent children and pets to be closed inside the appliance.
- The refrigerant circuit and the insulation materials of this appliance are ozone-friendly.
- The insulation foam contains flammable gas. Contact your municipal authority for information on how to discard the appliance correctly.
- Do not cause damage to the part of the cooling unit that is near the heat exchanger.

The manufacturer declines any liability for injury to persons or animals or damage to property if the above advice and precautions are not respected.

Installation

⚠ WARNING! Before installing the appliance, carefully read the safety information in this booklet.

Installation checklist

Door

- Door seals completely to cabinet on all sides
- Door is level

Levelling

- Refrigerator is level

Electrical power

- Wait 4 hours
- House power turned on
- Refrigerator plugged in

Final checks

- Packing materials removed
- Refrigerator temperature set

Positioning

- Follow the separate Assembly Instructions to install this appliance.
- Install this appliance at a location where the ambient temperature corresponds to the climate class indicated on the rating plate of the appliance. This ensures the correct operation of the appliance. Explanation of climate classes is as follows:

Climate class	Ambient temperature range
SN	+10°C to +32°C
N	+16°C to +32°C
ST	+16°C to +38°C
T	+16°C to +43°C

- "SN" indicates that this refrigerating appliance is intended to be used at ambient temperatures ranging from 10°C to 32°C.

- "N" indicates that this refrigerating appliance is intended to be used at ambient temperatures ranging from 16°C to 32°C.

- "ST" indicates that this refrigerating appliance is intended to be used at ambient temperatures ranging from 16°C to 38°C.

- "T" indicates that this refrigerating appliance is intended to be used at ambient temperatures ranging from 16°C to 43°C.

ⓘ For some models of appliances, some functional problems can occur when they operate outside the specified temperature ranges. The correct operation can only be guaranteed within the specified temperature ranges. If you have any doubts regarding installation, please turn to the vendor, our customer service or the nearest Authorised Service Centre.

Location

To ensure best performance, install the appliance well away from sources of heat such as radiators, boilers, and direct sunlight. Make sure that air can circulate freely around the back of the cabinet.

Levelling the appliance

If the appliance tilts in some way, adjust the two feet at the front of the appliance to level the appliance. Refer to the separate Assembly Instructions for detailed instructions.

1. Disconnect the mains plug of the appliance from the power socket.
2. Turn the foot clockwise to raise the appliance. Turn the foot anticlockwise to lower the appliance.

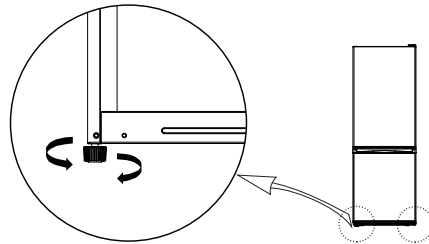

Cleaning the appliance

Before using the appliance for the first time, clean the appliance to remove the typical smell of a brand-new product.

1. Make sure the appliance is disconnected from the power supply.
2. Wipe the interior with a soft, moistened cloth.
3. Wash the internal accessories with lukewarm water and some neutral soap, then dry thoroughly.

CAUTION!

Do not use abrasive, chloride or acidic cleaning agents or solvents.

- Do not use scouring or abrasive sponges. The metallic surfaces may corrode.
- Never clean the accessories using a dishwasher. They may become deformed.

Electrical connection

⚠ CAUTION! Any electrical work required to install this appliance should be carried out by a qualified electrician or competent person.

⚠ WARNING! This appliance must be earthed. Failure to follow these instructions can result in death, fire or electrical shock.

The manufacturer declines any liability should these safety measures not be observed.

First use

Connect the appliance to the power supply. The ideal food storage temperatures are already factory-set (intermediate).

Note: After being switched on, the appliance needs 4-5 hours in order to reach the correct temperature to store a typical volume of food.

Product description

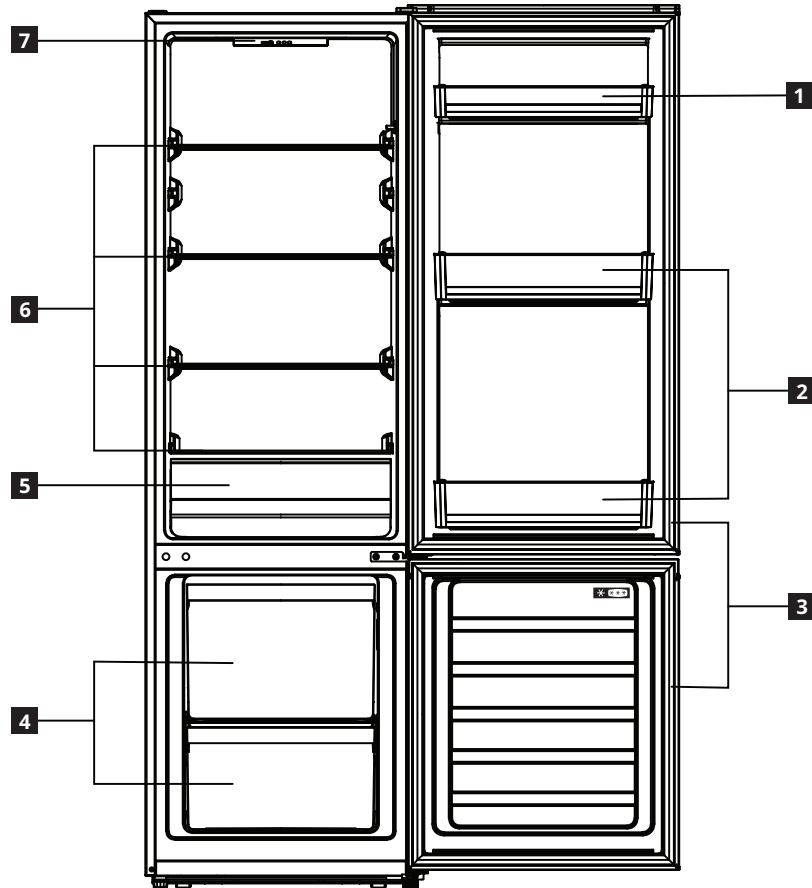

- 1** Door balcony
- 2** Bottle balconies
- 3** Door gaskets
- 4** Freezer drawers

- 5** Vegetable drawer
- 6** Glass shelves
- 7** Control panel

Operation

Control panel

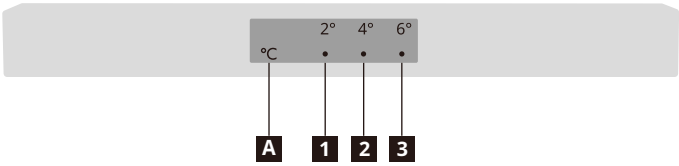

- 1** 2°C indicator
- 2** 4°C indicator
- 3** 6°C indicator

A Temperature setting button

Note: Do not use sharp objects to operate the control panel. They can scratch or damage the control panel.

Switching on

When you connect the mains plug to a power socket, the appliance switches on and starts operating.

Display

In case of a temperature sensor failure, the corresponding indicators will blink.

Indicator status	Fault
The 2°C indicators (1) is blinking.	Refrigerator temperature sensor failure
The 4°C indicators (2) is blinking.	Refrigerator defrosting temperature sensor failure
The 6°C indicators (3) is blinking.	Ambient temperature sensor failure

Note: If there is a flashing failure, please call the service center.

Setting the temperature

Recommended temperature
Refrigerator compartment: +4°C (factory setting)

- You can set the temperature of the refrigerator compartment via the control panel.
- You cannot directly set the temperature of the freezer compartment. But the colder the refrigerator compartment, the colder the freezer compartment.
- When the appliance is plugged in for the first time, it sets the temperature to 4°C. When you plug in or switch on the appliance again, it sets the temperature to the last set temperature.

To set the temperature, press the temperature setting button **A** one or more times until the indicator for the desired set temperature lights up. The appliance will operate according to the new set temperature in 30 seconds.



Tips:

- The lower the set temperature, the longer you can safely store your food and the more electricity the appliance consumes.
- The higher the set temperature, the quicker your stored food decays and the less electricity the appliance consumes.

Super cooling mode

- To put the appliance into super cooling mode, press and hold the temperature setting button **A** for 3 seconds. Both the 2°C and 4°C indicators light up and the appliance enters super cooling mode in 30 seconds.

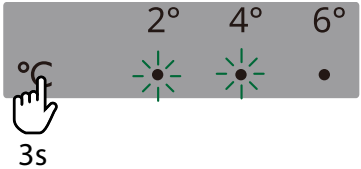

- The appliance will automatically exit super cooling mode after 6 hours. To exit this mode earlier, press the temperature setting button **A**.

Super freezing mode

- To put the appliance into super freezing mode, press and hold the temperature setting button **A** for 6 seconds. Both the 4°C and 6°C indicators light up and the appliance enters super freezing mode in 30 seconds.

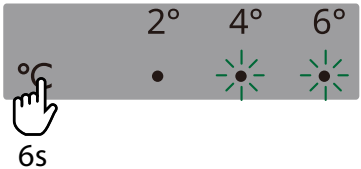

- The appliance will automatically exit super freezing mode after 40 hours. To exit this mode earlier, press the temperature setting button **A**.

Switching off

To switch off the appliance, disconnect the mains plug from the power socket.

Refrigerator compartment

Hints for fresh food refrigeration

- Cover or wrap the food, particularly if it has a strong flavour.
- Position the food so that air can circulate freely around it.
- For best performance, leave enough space in the refrigerator compartment for air to circulate around the packages. Also leave enough room at the front so the door can close tightly.
- Do not store warm food or evaporating liquids in the refrigerator.
- Meat (all types): wrap in suitable packaging and place on the glass shelf above the vegetable drawer. Store meat for at most 1-2 days.
- Cooked foods and cold dishes: cover and place on any shelf.
- Fruit and vegetables: clean thoroughly and place in the vegetable drawer. Bananas, potatoes, onions and garlic must not be kept in the refrigerator if not packed.
- Butter and cheese: place in special airtight containers or wrap in aluminium foil or polythene bags to exclude as much air as possible.
- Bottles: close with caps and place on the door balconies.

Movable shelves

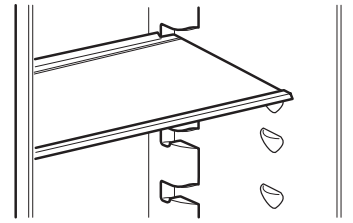

Picture for reference only

- The walls of the refrigerator are equipped with a series of runners so that the safety glass shelves can be positioned as desired.

Vegetable drawer

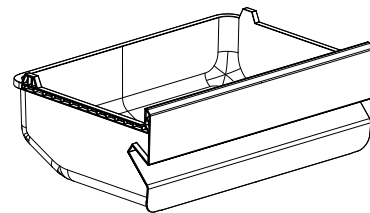

Picture for reference only

- The drawer is suitable for storing fruit and vegetables.
- The drawer can be pulled out for cleaning.

Freezer compartment

Hints for freezing fresh food

- The quantity of fresh food that can be frozen in 24 hours is shown on the rating plate.
- When first starting-up or after a period out of use, before putting the products in the compartment let the appliance run for at least 2 hours on a colder setting.
- Do not allow fresh, unfrozen food to touch food which is already frozen, thus avoiding a rise in temperature of the latter.
- Wrap food to protect it from any water, humidity or condensation; this will prevent the spread of any odours in the refrigerator, while also ensuring better storage of frozen food.
- Lean foods store better and longer than fatty ones; salt reduces the storage life of food.
- Never place warm food in the freezer. Cooling hot foods before freezing saves energy and prolongs the life of the appliance.
- Do not refreeze partially thawed food.
- **Note:** Never put bottled food or drinks in the frozen-food compartment.
- For best performance, leave enough space in the frozen-food compartment for air to circulate around the packages. Also leave enough room at the front so the door can close tightly.

Hints for storing frozen food

To obtain the best performance from this appliance, you should:

- Make sure that the commercially frozen foodstuffs were adequately stored by the retailer.
- Make sure that frozen foodstuffs are transferred from the food store to the frozen-food compartment in the shortest possible time.
- Do not open the door frequently or leave it open longer than absolutely necessary.
- Once defrosted, food deteriorates rapidly and cannot be refrozen.
- Do not exceed the storage period indicated by the food manufacturer.

Thawing

Deep-frozen or frozen food, prior to being used, can be thawed in the refrigerator compartment or at room temperature, depending on the time available for this operation.

Small pieces may even be cooked still frozen, directly from the frozen-food compartment: in this case, cooking will take longer.

Daily use

To lower the energy consumed by the appliance, follow these tips:

- Install the appliance in a dry, well ventilated room far away from any heat source (e.g. radiator, cooker, etc.) and in a place not exposed directly to the sun. If required, use an insulating plate.
- To guarantee adequate ventilation follow installation instructions.
- Insufficient ventilation on back of the product increases energy consumption and decreases cooling efficiency.
- The internal temperatures of the appliance may be affected by the ambient temperature, frequency of door opening, as well as location of the appliance. Temperature setting should take into consideration these factors.

⚠ WARNING! In the event of accidental defrosting, for example the power has been off for longer than the temperature rising time shown on the rating plate of the appliance, the defrosted food must be consumed quickly or cooked immediately and then re-frozen (after being cooked).

- Allow warm food and drinks to cool down before placing in the appliance.
- Do not obstruct the fan (if available) with food items.
- After placing or removing food, ensure you close the door properly, especially the freezer door.
- Reduce to a minimum door opening.
- When thawing frozen food, place them in the refrigerator. The low temperature of the frozen products cools the food in the refrigerator.
- Positioning of the shelves in the refrigerator has no impact on the efficient usage of energy. Food should be placed on the shelves in such way to ensure proper air circulation (food should not touch each other and distance between food and rear wall should be kept).
- Damaged gaskets must be replaced as soon as possible.

Cleaning and maintenance

General tips

- Regularly clean the appliance with a cloth and a solution of warm water and neutral detergent specifically formulated for refrigerator interiors. Do not use abrasive cleaners or tools.
- Use the tube cleaner provided in the accessory bag to regularly clean the defrost water drain hole at the back of the refrigerator compartment. This will ensure the defrost water drains properly, and prevent the water from overflowing and dripping onto the food inside.
- Before servicing or cleaning the appliance, unplug it from the mains or disconnect the power supply.

CAUTION! The refrigerator accessories must not be placed in a dishwasher.

Defrosting the refrigerator compartment

Food moisture evaporating inside the refrigerator or the entry of air moisture into the refrigeration compartment during daily use can both lead to frost formation in the refrigeration compartment. In such cases, manually raising the temperature setting of the refrigerator can facilitate automated defrosting. The formation of water droplets on the rear wall of the refrigerator compartment indicates that the automatic defrosting is underway.

The defrost water automatically runs into the drain outlet and then into a container where it evaporates.

CAUTION! The refrigerator accessories must not be placed in a dishwasher.

Defrosting the freezer compartment

It is perfectly normal for ice to form. The amount of ice which forms and the rate at which it accumulates will depend on ambient temperature and humidity, and on the frequency of door opening.

1. Set the coldest temperature four hours before removing food from the freezer compartment, so as to extend the storage time of food during defrosting.
2. Switch the appliance off and remove the drawers. Place the frozen food in a cool place.
3. Leave the freezer door open to allow the frost to melt. To prevent water leaking onto the floor during defrosting, place an absorbent cloth on the bottom of the freezer compartment and wring it out regularly.
4. Clean the interior of the freezer. Rinse and dry carefully.
5. Switch the appliance on again and place food back in the freezer compartment.

If you do not use the appliance for a prolonged period

1. Switch off the appliance.
2. Disconnect the appliance from the power supply.
3. Remove all food.
4. Defrost and clean the appliance.
5. Leave the doors open just enough to allow air to circulate inside the compartments. This will prevent the formation of mould and unpleasant odours.

In the event of a power cut

- Keep the doors of the appliance closed. This will allow the food to stay cold as long as possible.
- If food has defrosted even partially, do not re-freeze it. Consume within 24 hours.

Replacing the lighting

The appliance is equipped with a LED for interior lighting.

Only an authorized technician is allowed to replace the lighting device. Please contact your Authorised Service Centre.

Troubleshooting

Problem	Possible Cause	Solution
The appliance does not operate.	The appliance is switched off.	Switch on the appliance.
	The mains plug is not connected to the mains socket correctly.	Connect the mains plug to the mains socket correctly.
	There is no voltage in the mains socket.	To find out if the mains socket is working, connect a different electrical appliance to it. Contact a qualified electrician to repair the socket.
The appliance is noisy.	The appliance is not placed stably.	Level the appliance. Refer to "Levelling the appliance", or the separate Assembly Instructions.
The lamp does not work.	The lamp is defective.	Refer to "Replacing the lighting".
The compressor runs continuously.	The set temperature is too low.	Set a higher temperature. Refer to "Operation".
	Many food products were inserted at the same time.	Wait some hours and then check the temperature again.
	The room temperature is too high.	Reposition the appliance if possible. Refer to "Positioning".
	Food products placed in the appliance were too warm.	Allow food products to cool to room temperature before storing.
	The door is not closed correctly.	Refer to "Closing the door".
The temperature in the appliance is too low/too high.	The temperature was not set correctly.	Set a higher/lower temperature.
	The door is not closed correctly.	Refer to "Closing the door".
	Food products placed in the appliance were too warm.	Allow food products to cool to room temperature before storing.
	Many food products were inserted at the same time.	Insert less food products at the same time.
	The thickness of ice in the freezer compartment is greater than 4-5 mm.	Defrost the freezer compartment. Refer to "Defrosting the freezer compartment".
	Door was opened too frequently.	Open the door only when necessary.
	There is not enough cold air circulation in the appliance.	Reposition the food so that air can circulate freely in the appliance.

Problem	Possible Cause	Solution
There is too much condensed water on the rear wall of the refrigerator.	Door was opened too frequently.	Open the door only when necessary.
	Door was not closed completely.	Make sure the door is closed completely. Refer to "Closing the door".
	Stored food was not wrapped.	Wrap food in suitable packaging before storing it in the appliance.
Water flows inside the refrigerator.	The drain hole at the back of the appliance is clogged.	Clean the drain hole with the supplied tool.
	Food products prevent water from flowing into the water collector.	Make sure that food products do not touch the rear wall.
Water flows on the floor.	The door is not closed well.	Refer to "Closing the door".
	The appliance tilts forward.	Tilt the appliance slightly backward (6mm lower at the back). Refer to the separate Assembly Instructions for more details.
	The drip pan cracked.	Contact an Authorised Service Centre listed at the end of this manual.
	The drain hole at the back of the appliance is clogged.	Clean the drain hole with the supplied tool.
The door does not close completely.	Refer to "Closing the door".	Refer to "Closing the door".

Normal noises

It is normal for the refrigeration system to produce some noises, such as gurgling and hissing.

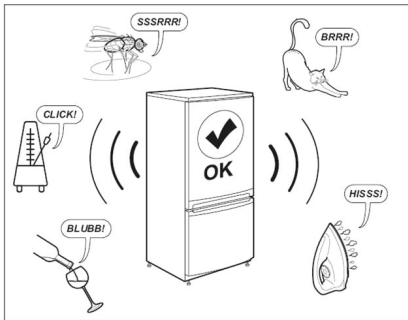

Closing the door

If	Do
Door gaskets are dirty.	Clean them.
Door gaskets are damaged.	Contact the After Sales Service to replace them.
The door is blocked by shelves, drawers, food items, etc.	Position correctly or remove the objects that block the door.
The appliance is not level.	Level the appliance. Refer to "Levelling the appliance", or the separate Assembly Instructions.
The door is not aligned with the cabinet.	Adjust the door. Refer to the separate Assembly Instructions.

Before contacting the After-sales Service:

Restart the appliance to see if the fault has been remedied. If it persists, switch the appliance off again and repeat the operation after an hour.

If your appliance still does not work properly after carrying out the checks listed in the troubleshooting guide and switching the appliance on again, contact the After-sales Service, clearly explaining the problem and specifying:

- the nature of the problem
- the date of purchase
- the model and serial number of the appliance

i The article number and serial number are shown on the rating plate on the internal left side of the appliance.

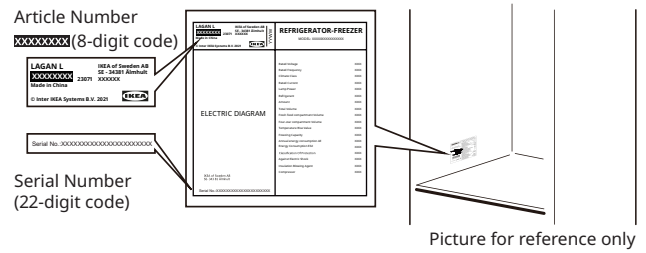

Technical information

Product category	
Product type	Refrigerator-Freezer
Installation type	Freestanding
Product dimensions	
Height	1773 mm
Width	547 mm
Depth	568 mm
Net volume	
Fridge	193 L
Freezer	64 L
Defrost system	
Fridge	Manual
Freezer	Manual
Other specifications	
Energy consumption	250 kWh/year
Noise level	38 dB(A)
Energy class	MEPS 4 stars
Rated voltage	220 - 240 V~
Rated frequency	50 Hz

Environmental concerns

Recycle materials with the symbol ♻️. Put the packaging in relevant containers to recycle it. Help protect the environment and human health by recycling waste of electrical and electronic appliances. Do not dispose of this product with the household waste. Return the product to your local recycling facility or contact your municipal office.

IKEA GUARANTEE

How long is the IKEA guarantee valid?

This guarantee is valid for **five (5) years** from the original date of purchase of your appliance at IKEA. The original sales receipt is required as proof of purchase. If service work is carried out under guarantee, it will not extend the guarantee period for the appliance.

Which LAGAN appliances are not covered by the IKEA 5-year guarantee?

LAGAN appliances purchased from IKEA before 1 May 2026 are covered by a 2-year guarantee, starting from the original date of purchase.

Who will execute the service?

IKEA service provider will provide the service through its own service operations or authorized service partner network. Contact IKEA for further information.

If you encounter any trouble with the appliance and wish to register a service call or make a claim, please refer to www.ikea.com.au for your local store after sales customer service center phone number, online email and opening times.

The principal address and contact details in Australia are:

IKEA Service Office
L1 Clock Tower, 630 Princes Highway
Tempe, NSW 2044

What does this guarantee cover?

The guarantee covers faults of the appliance, which have been caused by faulty construction or material faults from the date of purchase from IKEA. This guarantee applies to domestic use only. The products have been designed and tested for domestic purposes only and this guarantee does not cover damage arising from use of the Product in a commercial environment.

The exceptions are specified under the headline "What is not covered under this guarantee?" Within the guarantee period, the costs to remedy the fault e.g. repairs, parts, labour and travel will be covered, provided that the appliance is accessible for repair without special expenditure. Replaced parts become the property of IKEA.

The guarantee exists only if the appliance complies and is installed in accordance with:

- The technical specifications.
- The Assembly Instructions and user manual Safety Information.

IKEA's guarantee is subject to Australian Consumer

Law - see Schedule 2 to Competition and Consumer Act, 2010. This guarantee is in addition to (and does not exclude, restrict or modify in any way) any non-excludable statutory warranties in Australia.

What will IKEA do to correct the problem?

IKEA appointed service provider will examine the product and decide, at its sole discretion, if it is covered under this guarantee. They will notify you as to whether your claim is covered under this guarantee. If your claim is approved, the IKEA service provider or its authorized service partner, will then, at its sole discretion, either repair the defective product or replace it with the same or a comparable product.

What is not covered under this guarantee?

- Normal wear and tear.
- Deliberate or negligent damage, damage caused by failure to observe operating instructions, incorrect installation or by connection to the wrong voltage, damage caused by chemical or electro-chemical reaction, rust, corrosion or water damage including but not limited to damage caused by excessive lime in the water supply, damage caused by abnormal environmental conditions.
- Consumable parts including batteries and lamps.
- Non-functional and decorative parts which do not affect normal use of the appliance, including any scratches and possible colour differences.
- Accidental damage caused by foreign objects including insect or vermin infestation or substances and cleaning or unblocking of filters, drainage systems or soap drawers.
- Damage to the following parts: ceramic glass, accessories, crockery and cutlery baskets, feed and drainage pipes, seals, lamps and lamp covers, screens, knobs, casings and parts of casings. Unless such damages can be proved to have been caused by production faults.
- Cases where no fault could be found during a technician's visit.
- Repairs not carried out by our appointed service providers and/or an authorized service contractual partner or where non-original parts have been used.
- Repairs caused by installation which is faulty or not according to specification.
- The use of the appliance in a non-domestic environment i.e. professional use.
- Transportation damages. If a customer transports the product to their home or other address, IKEA is not liable for any damage that may occur during transport. However, if IKEA delivers the product to the customer's delivery address, then damage to the product that occurs during this delivery will be covered by this guarantee.

- Cost for carrying out the initial installation of the IKEA appliance. However, if an IKEA service provider or its authorized service partner repairs or replaces the appliance under the terms of this guarantee, the service provider or its authorized service partner will re-install the repaired appliance or install the replacement, if necessary.
- The appliance's serial number or warranty seal has been removed or defaced.

How country law applies

Our goods come with guarantees that cannot be excluded under the Australian Consumer Law (ACL). You are entitled to a replacement or refund for a major failure and compensation for any other reasonably foreseeable loss or damage.

You are also entitled to have the goods repaired or replaced if the goods fail to be of acceptable quality and the failure does not amount to a major failure.

This guarantee is not intended in any way to limit or exclude such rights and remedies that you may have under law.

You can find out more information about the Australian Consumer Law on the ACCC website: www.accc.gov.au

Area of validity

This IKEA guarantee applies only to products purchased and installed in AUSTRALIA .

What you must do to make a claim under the guarantee:

To make a claim under the guarantee, contact IKEA after sales customer service center at the above address or refer to www.ikea.com.au for your local store customer service phone number, online email and opening times. Please describe the problem that you are facing with the appliance in detail along with your product article number (8 digit code) and date of purchase at the time of call registration.

Please do not hesitate to contact the dedicated after sales customer service center for IKEA appliances to:

1. Make a service request under this guarantee;
2. Ask for clarification on installation of the IKEA appliance in the dedicated IKEA kitchen furniture.
3. Ask for clarification on user manual contents and specifications of the IKEA appliance.

To ensure that we provide you with the best assistance, please read carefully the Assembly Instructions and/or the User Manual section of this booklet before contacting us.

How to reach us if you need our service



The IKEA after sales customer service centre will assist you on the phone with basic troubleshooting for your appliance at the time of service call request. Please refer to www.ikea.com.au and select your local store for local store phone numbers and opening times.

- ⓘ Please describe the problem that you are facing with the appliance in detail along with your product article number (8 digit code), the Serial Number (8 digit code that can be found on the rating plate) and date of purchase at the time of call registration.
- ⓘ **SAVE THE SALES RECEIPT!** Kindly keep all these details and original invoice of purchase handy during the service technician's visit to enable him to carry out the job. It is your proof of purchase and required for the guarantee to apply. Note that the receipt reports also the IKEA article name and number (8 digit code) for each of the appliances you have purchased.

