

STOCKHOLM

2025

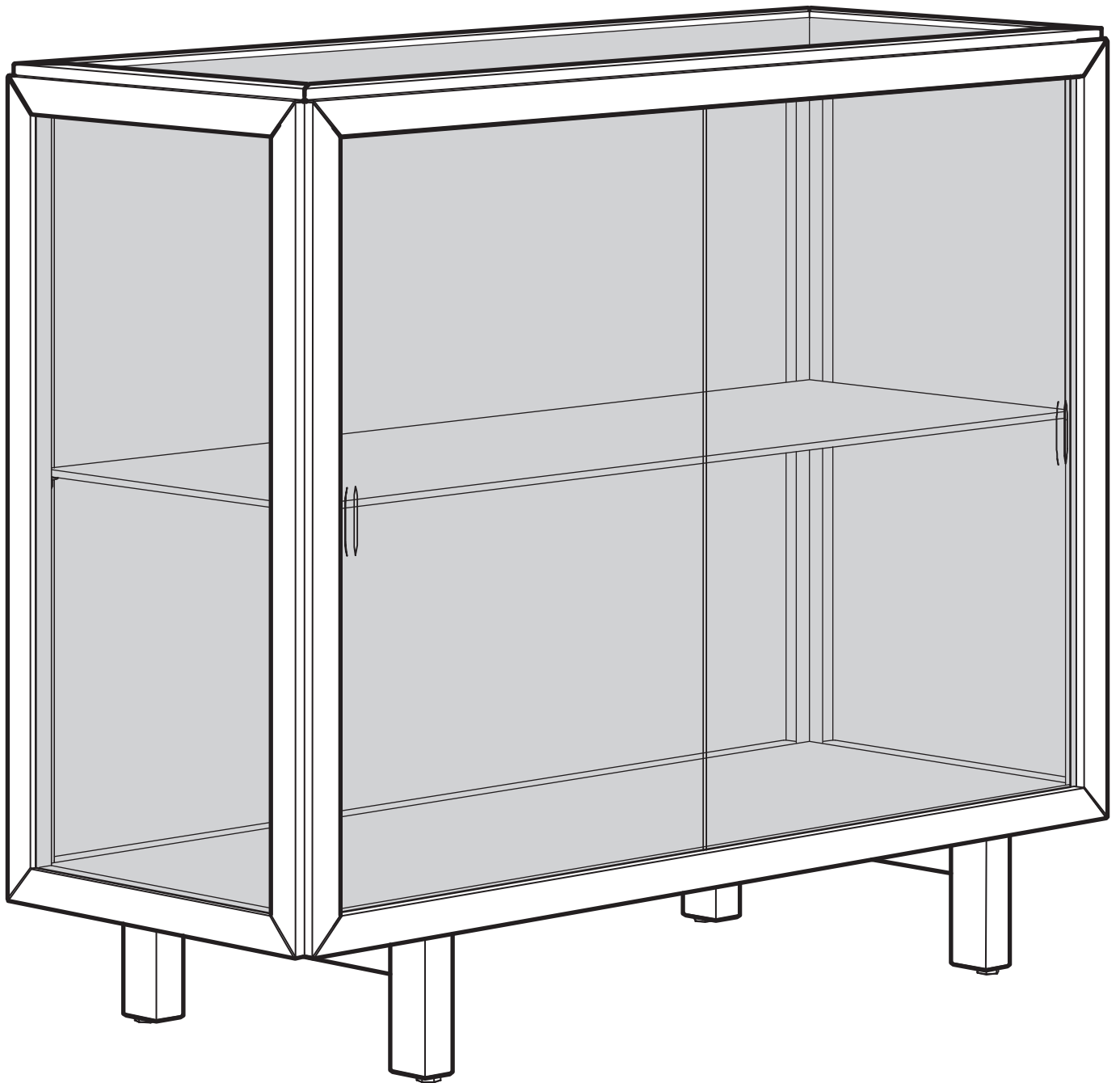

Design and Quality
IKEA of Sweden



English

WARNING

Children have died from furniture tipover. To reduce the risk of furniture tipover:

Always anchor your furniture with an anti-tip device.

NEVER put a TV on this product.

NEVER allow children to stand, climb, or hang on any drawers, doors, or shelves.

NEVER open more than one drawer at a time.

Place heaviest items in the lowest drawers.

English

Read and follow each step of the instruction carefully.

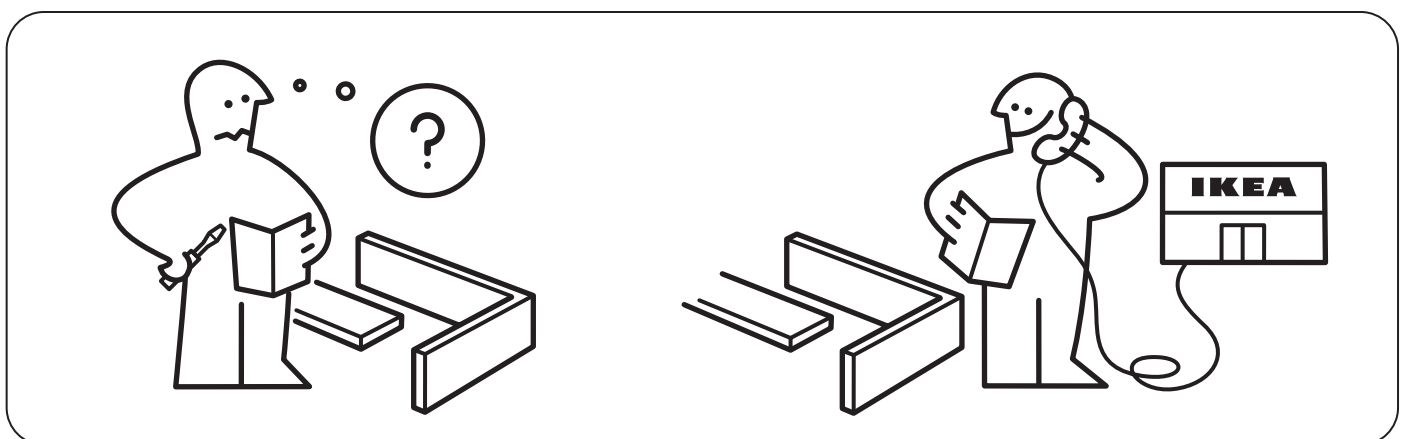
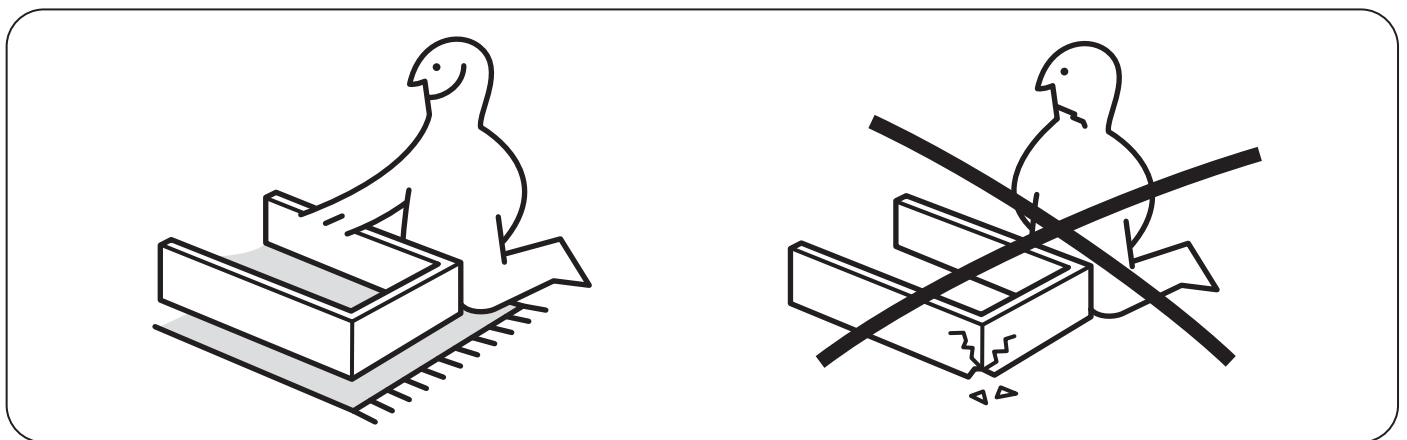
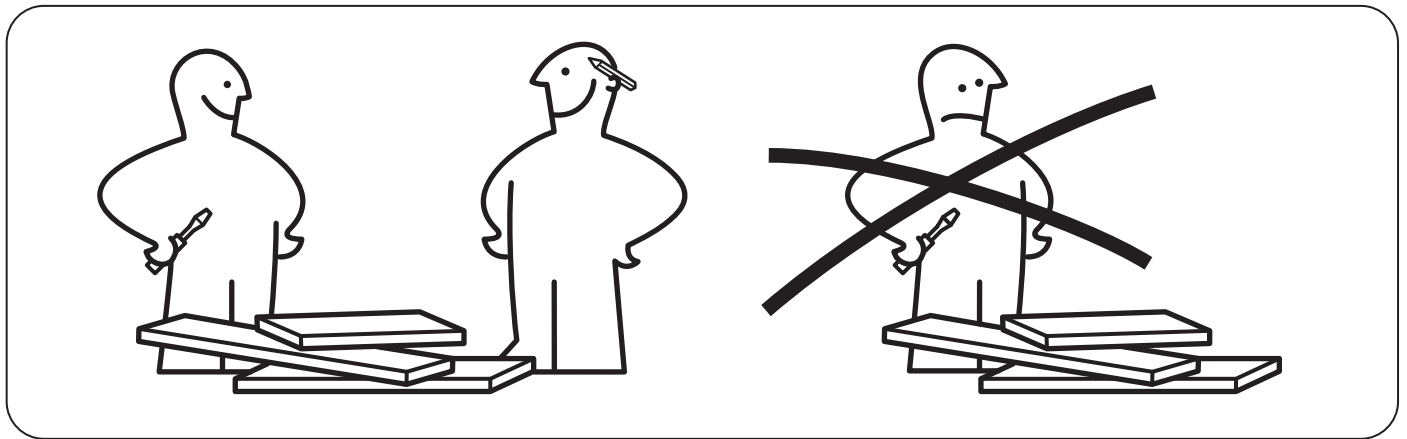
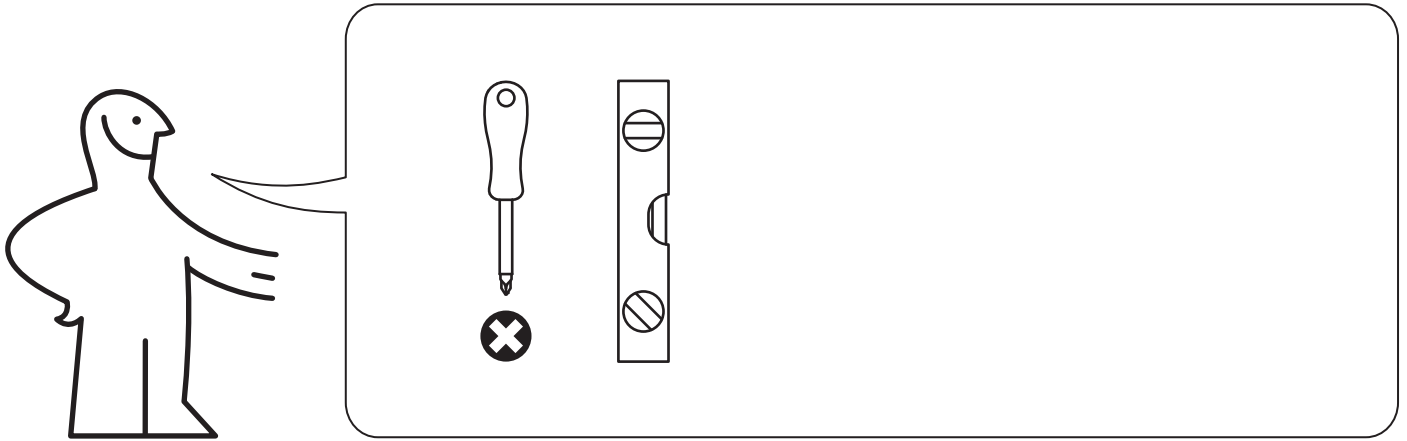

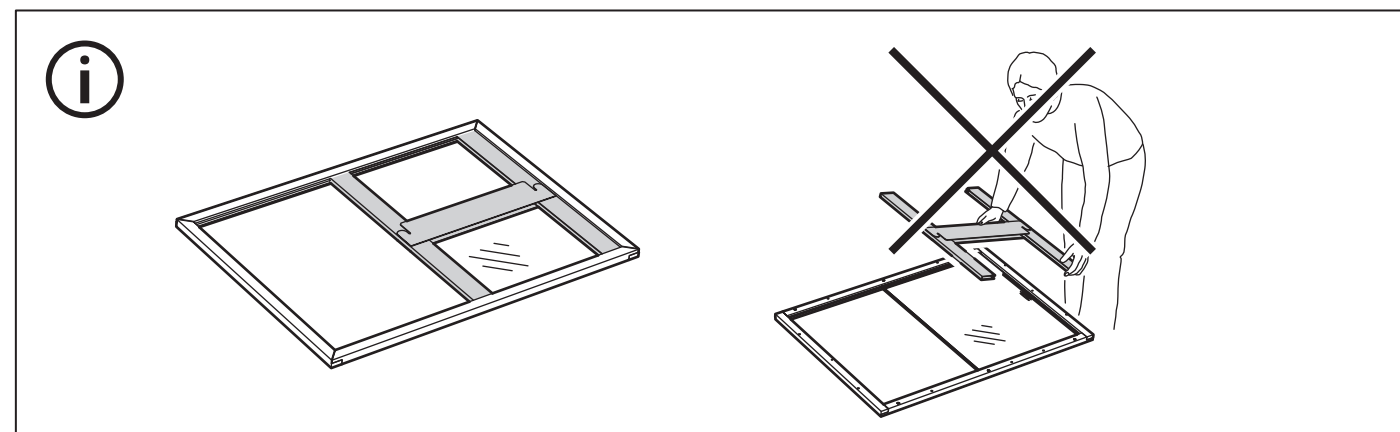
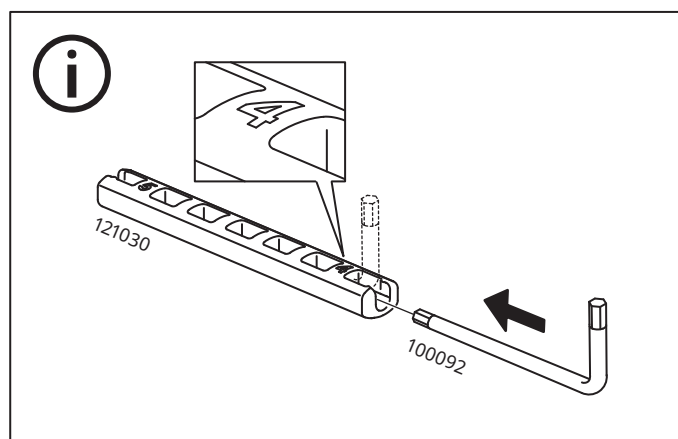
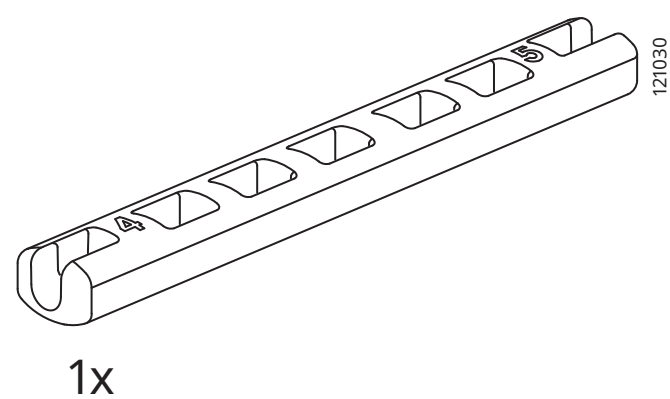
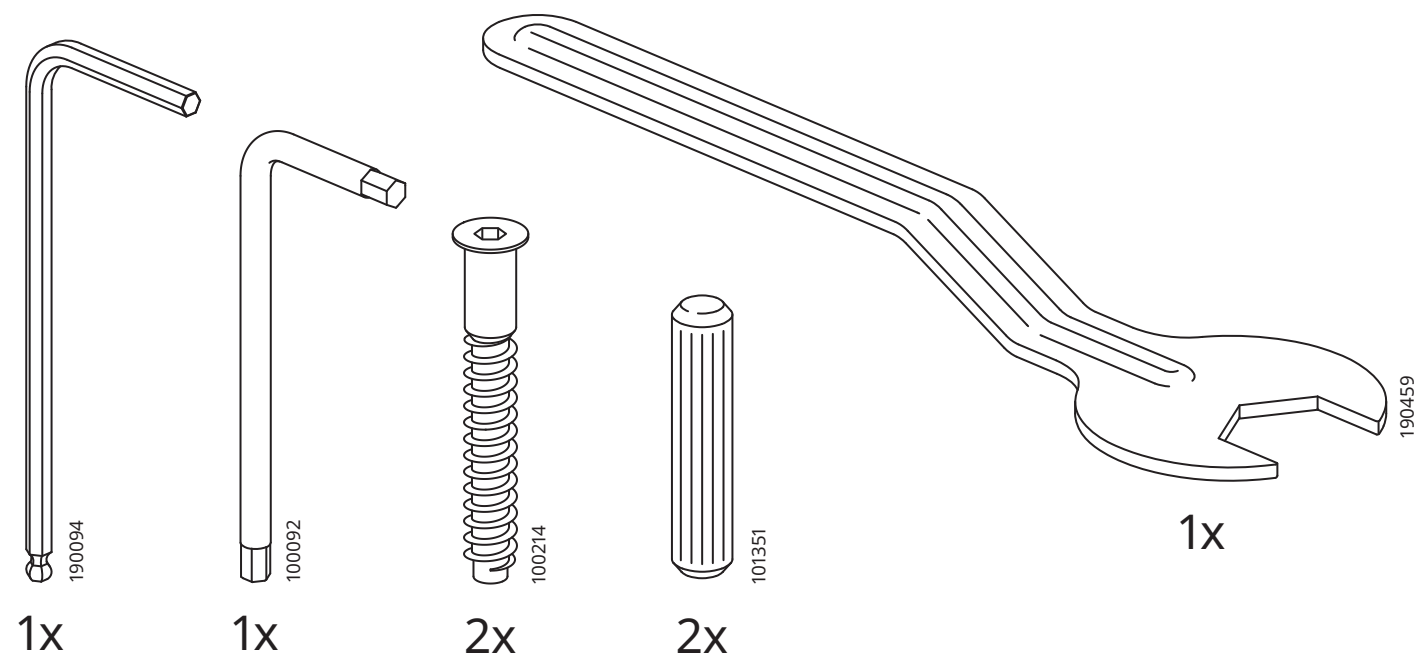
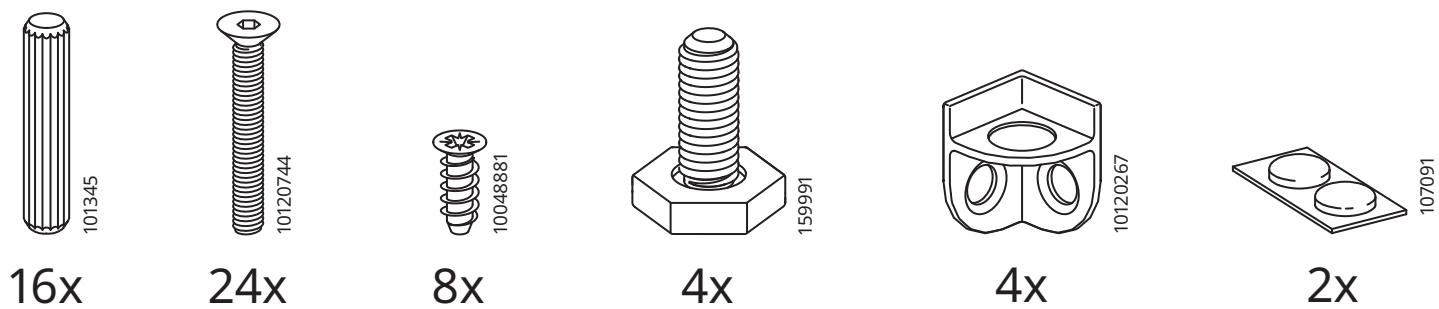

1

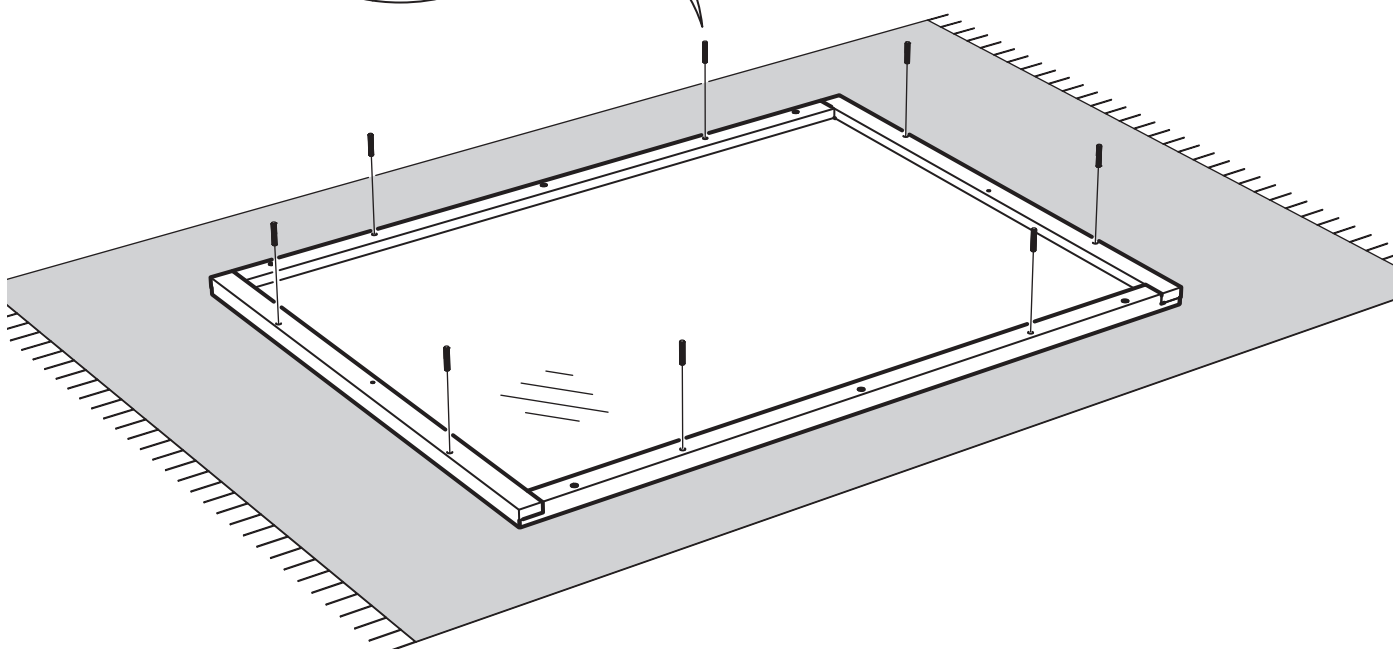
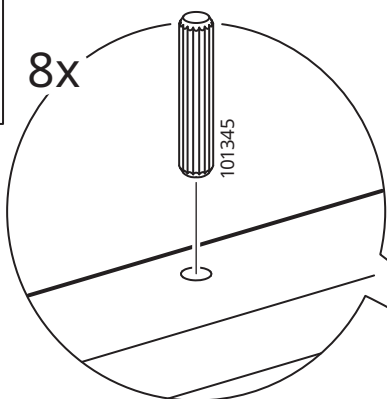
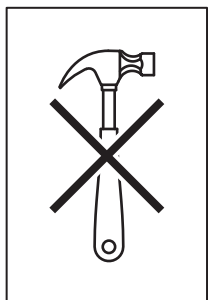
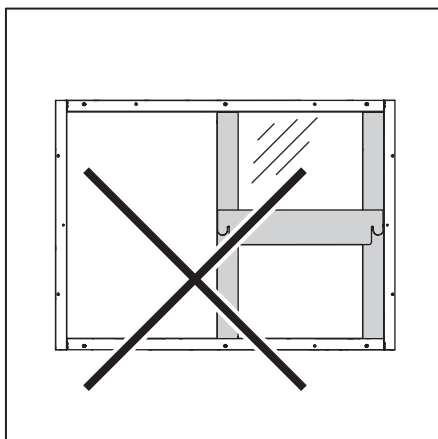
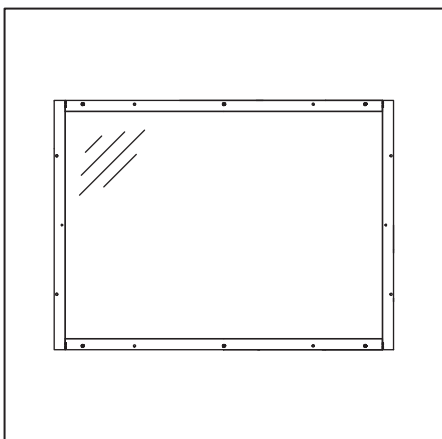

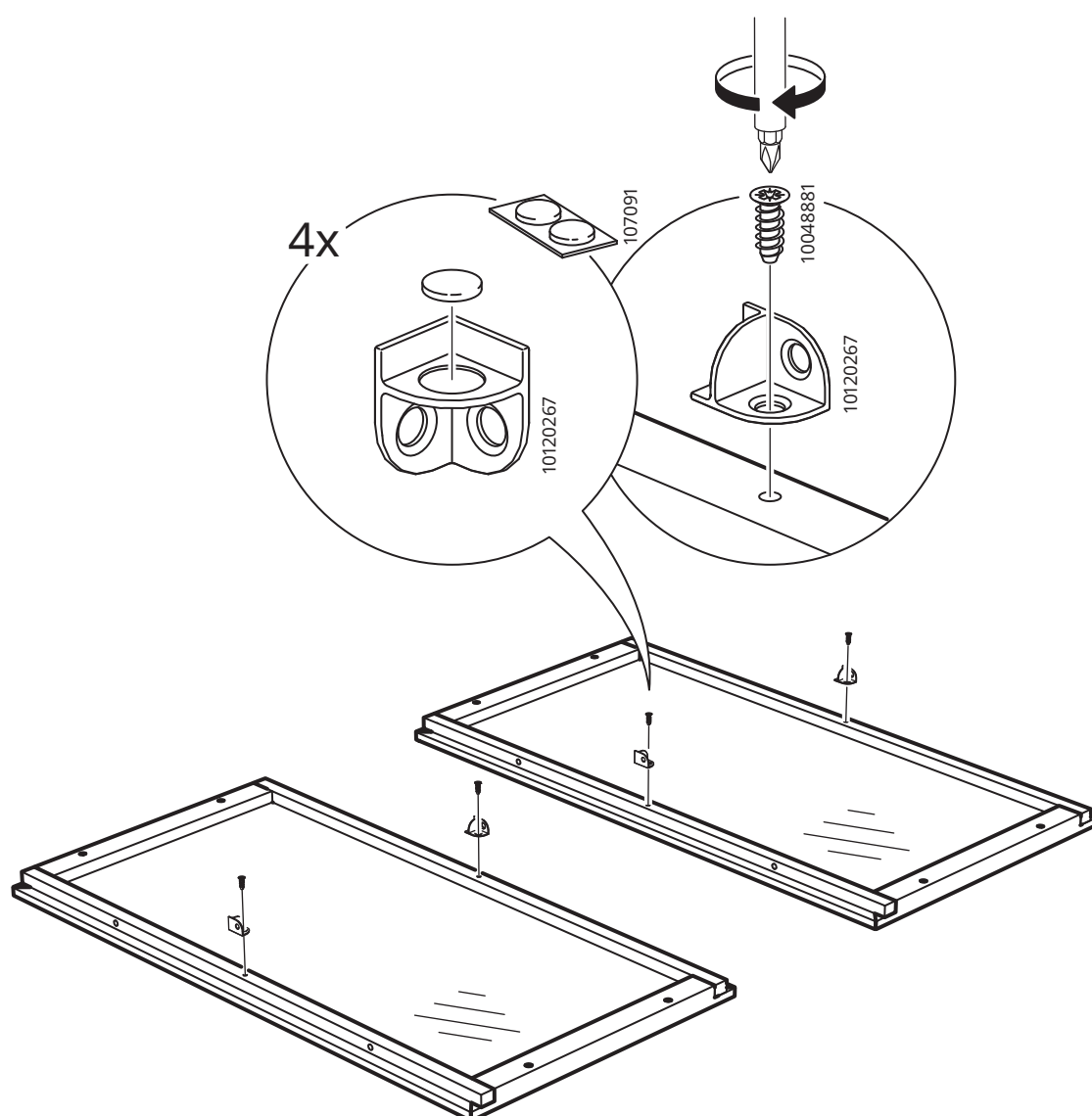

3

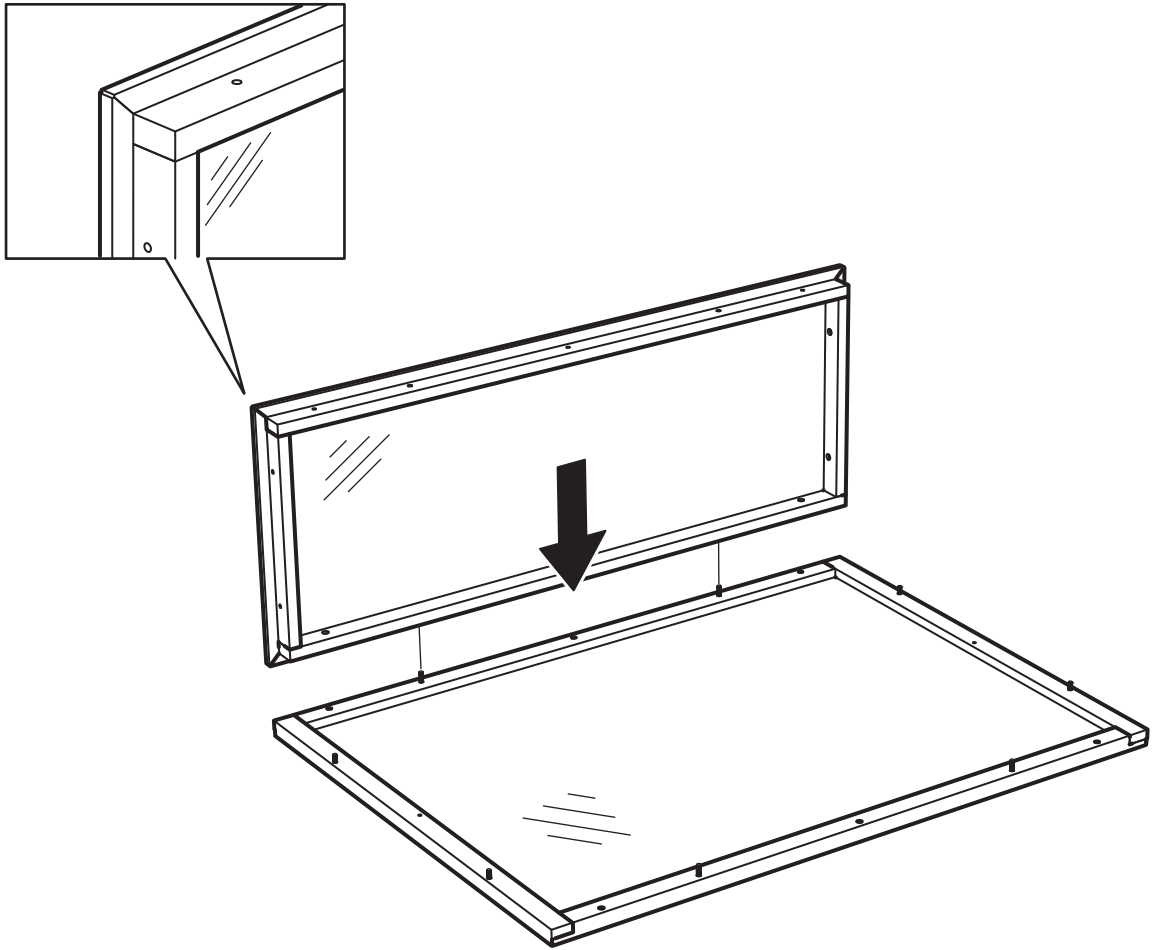

4

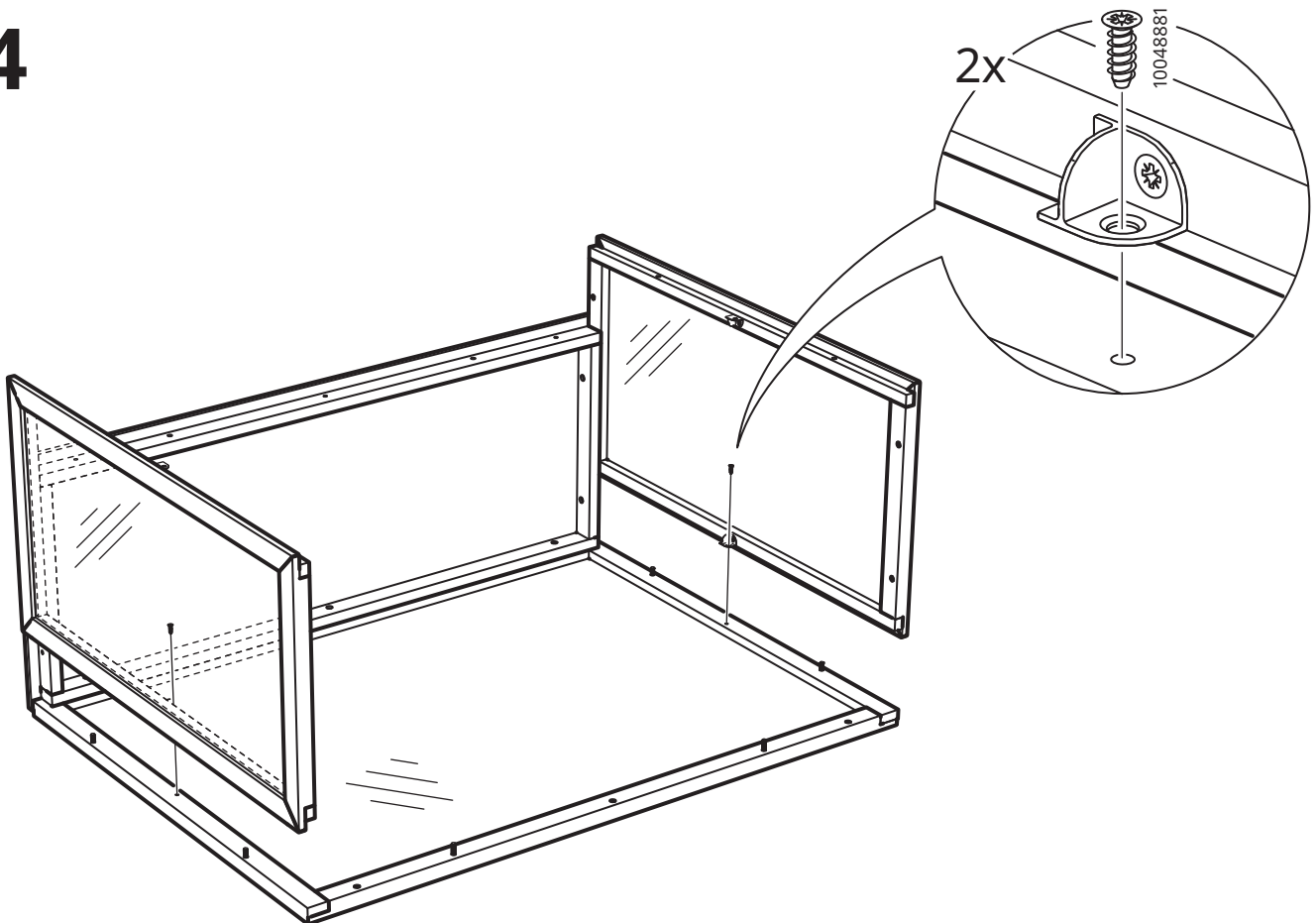

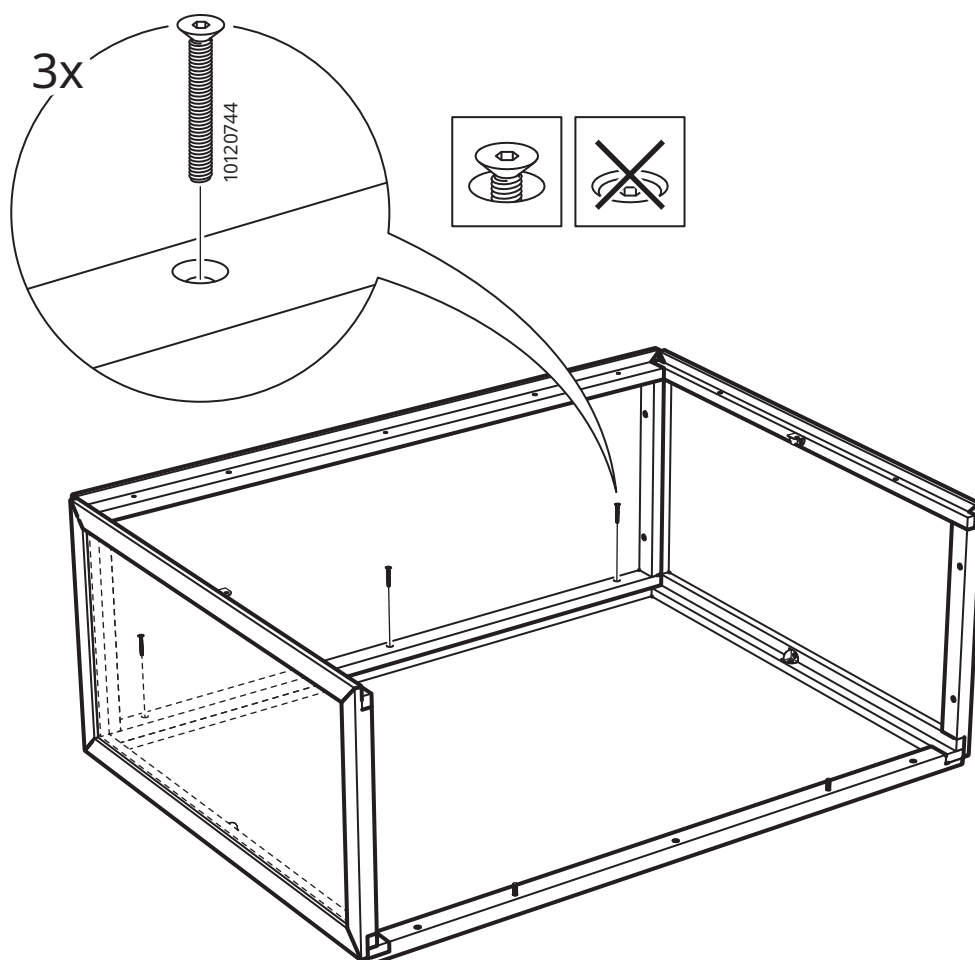
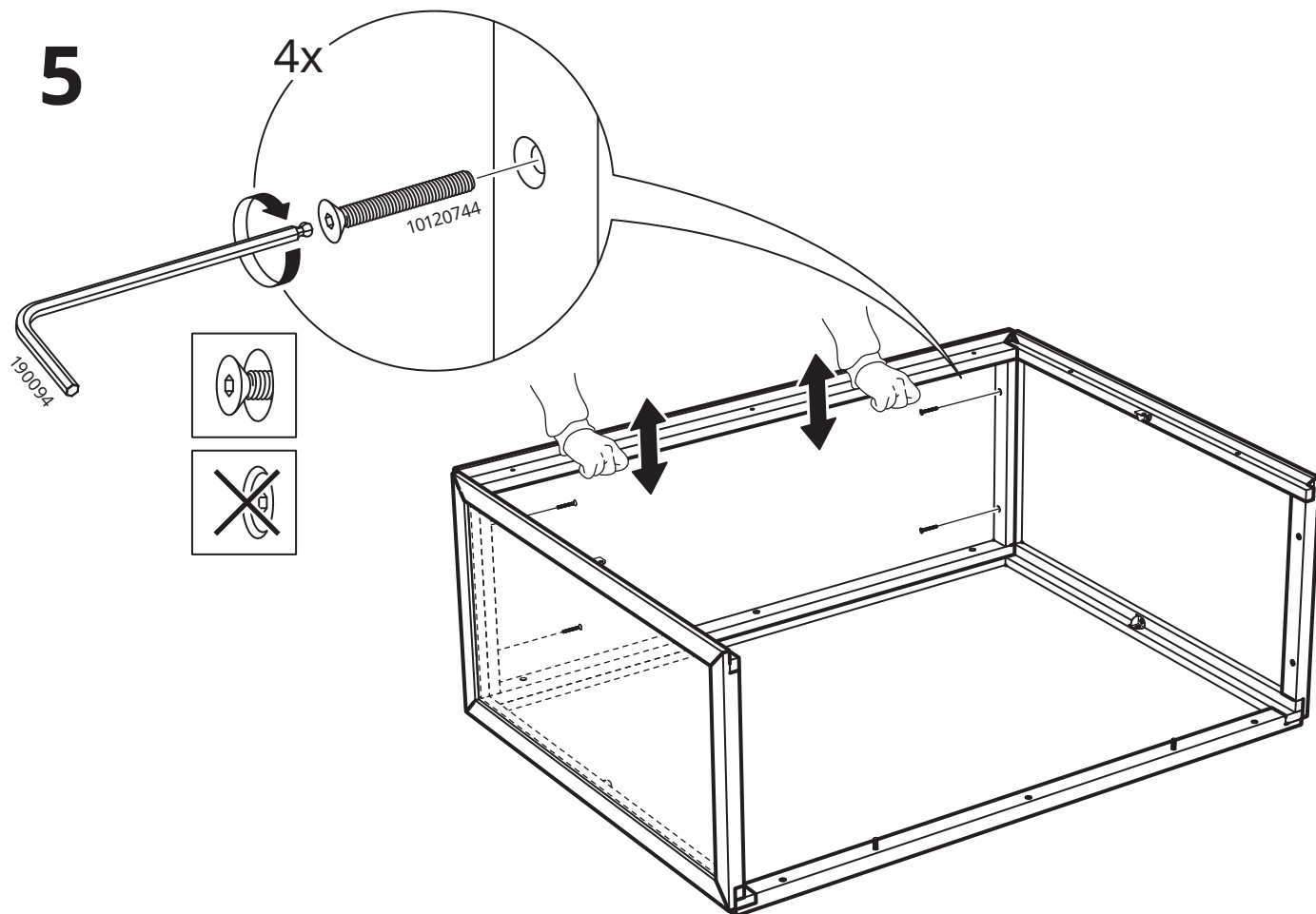

7

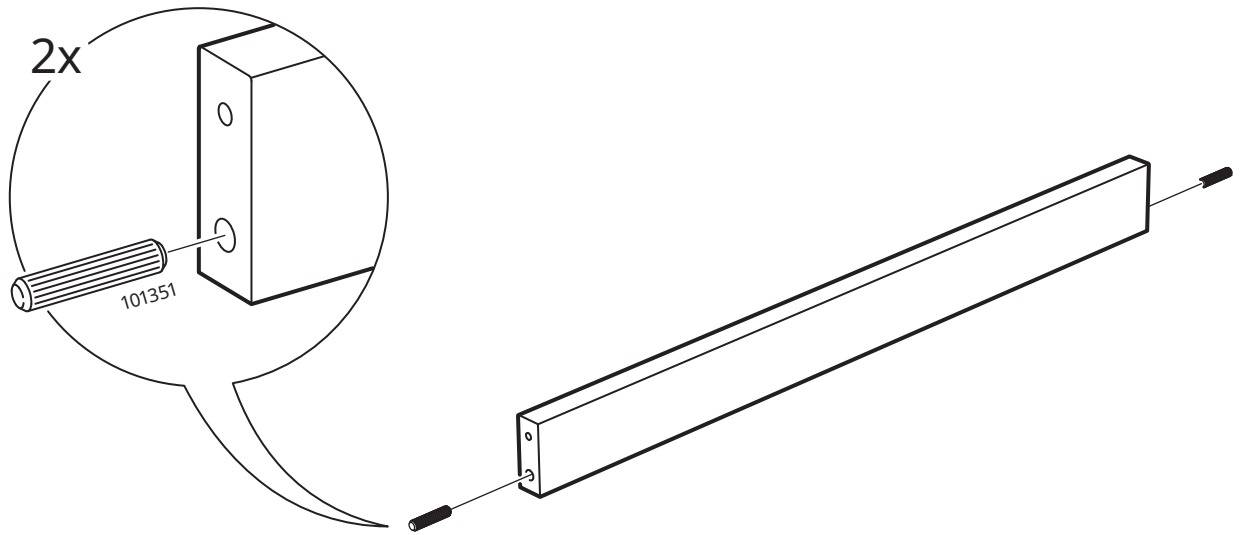

8

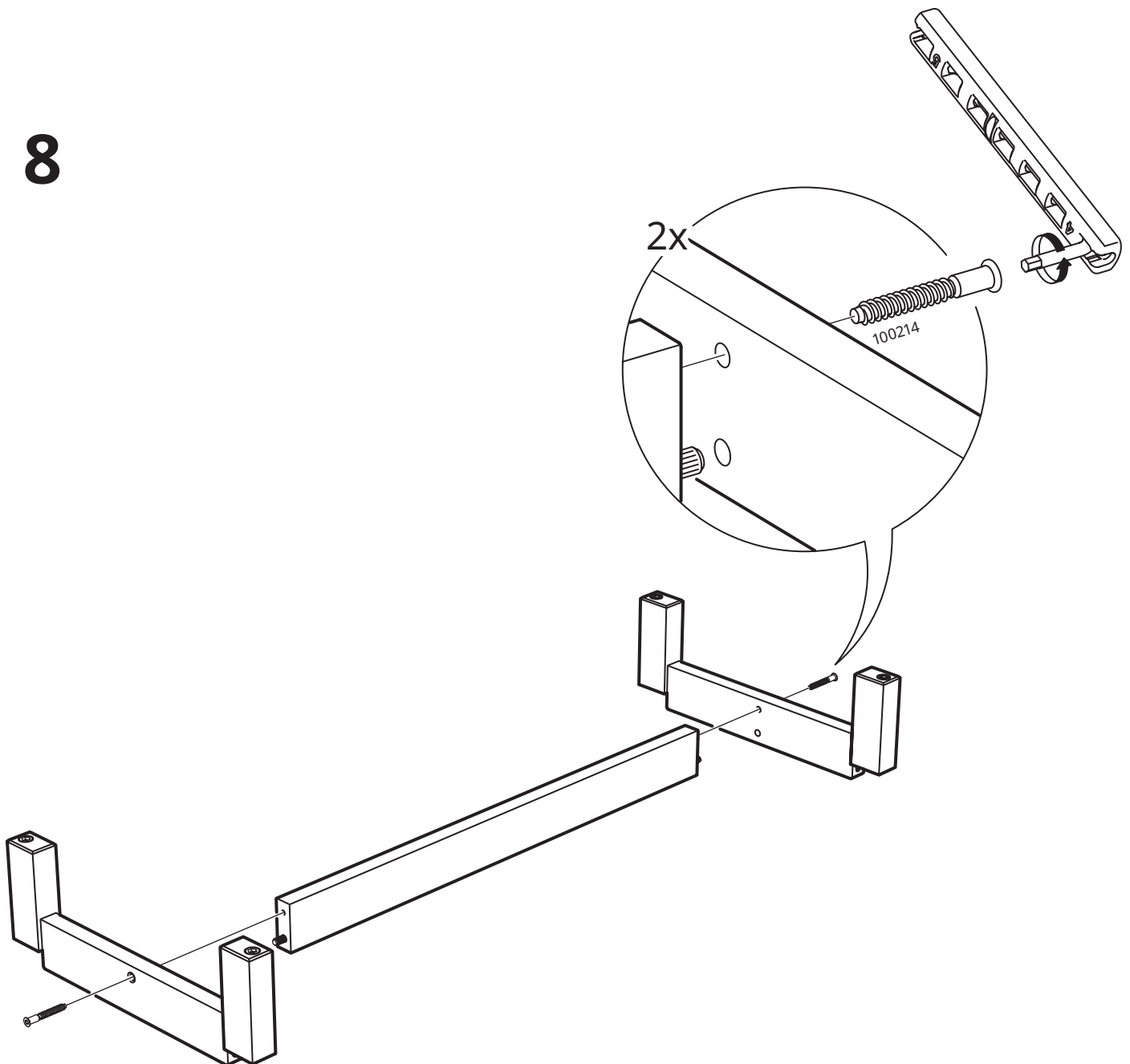

9

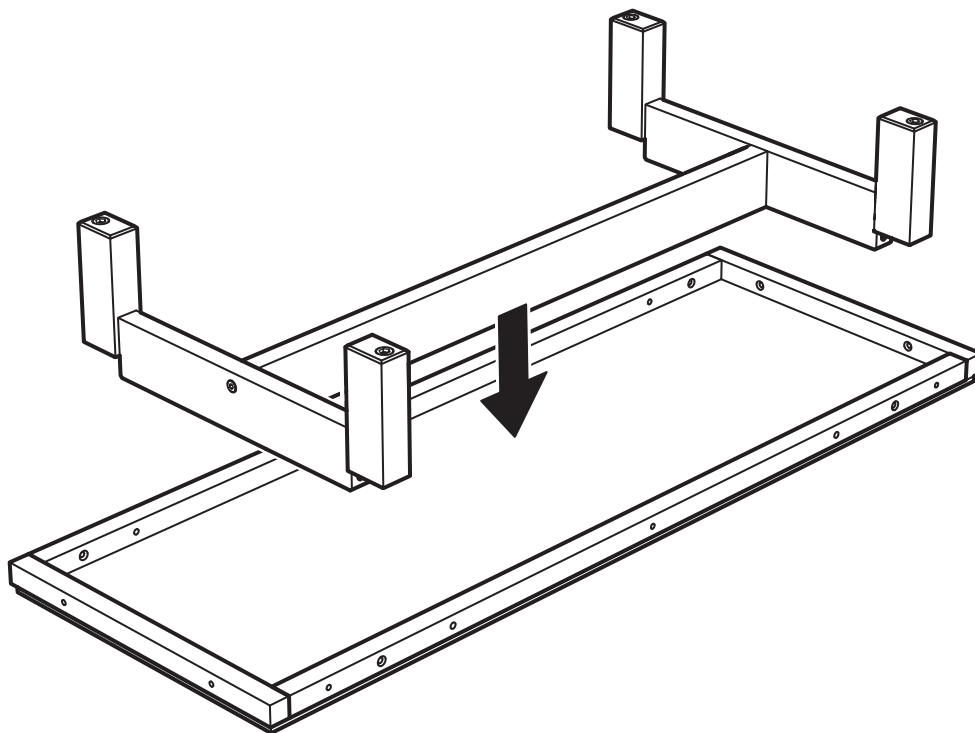

10

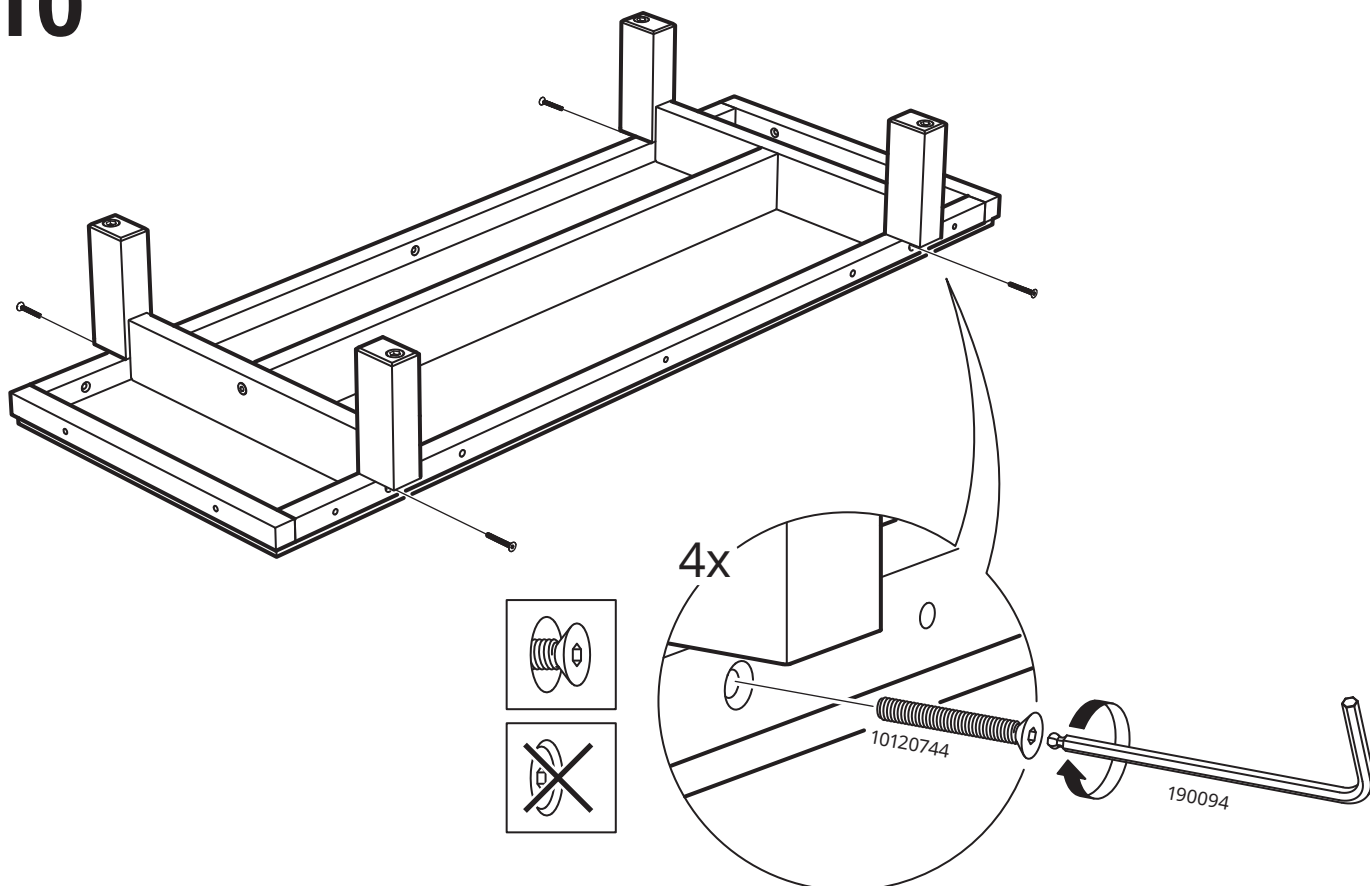

11

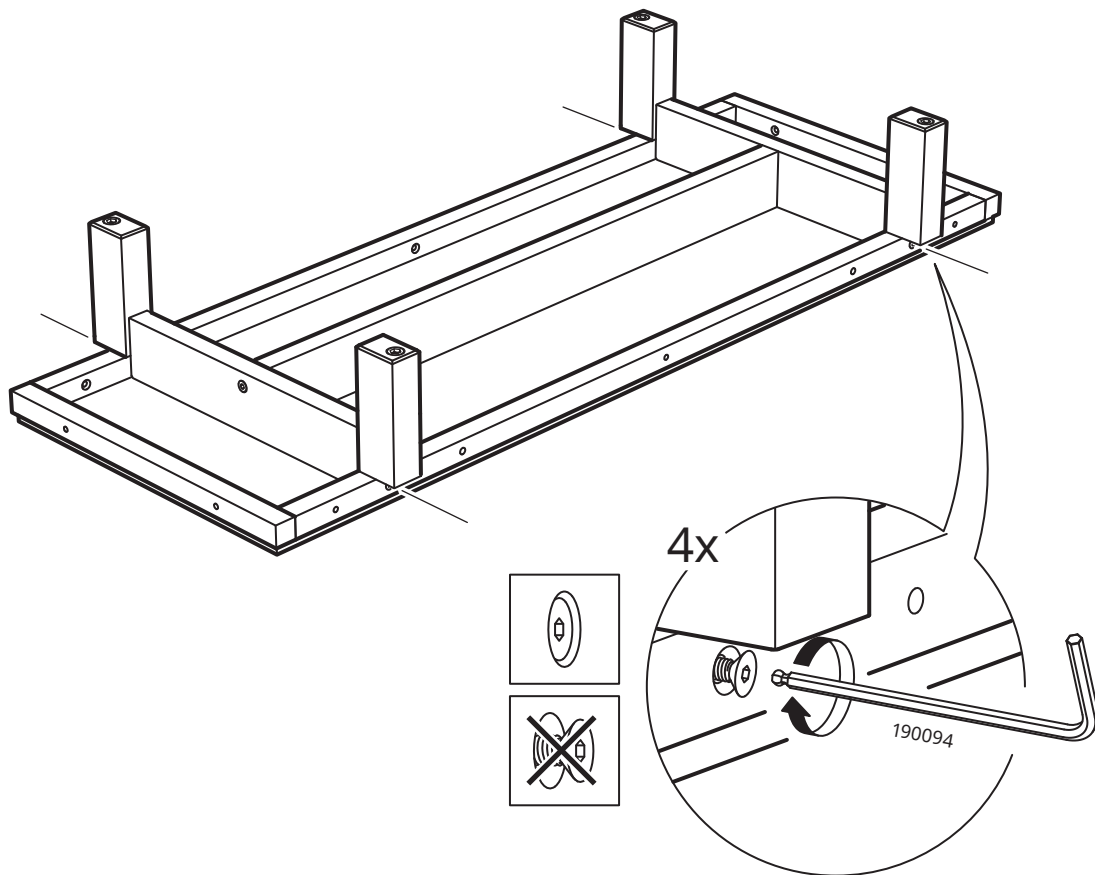

12

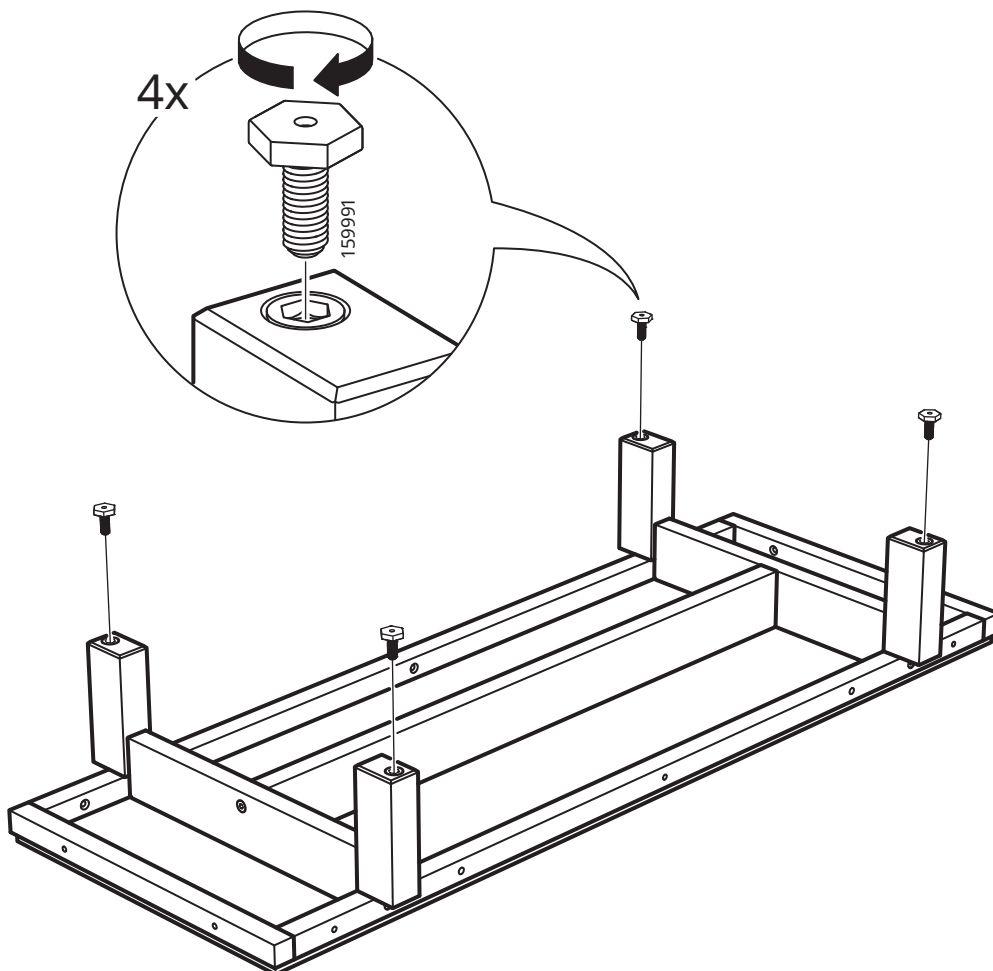

13

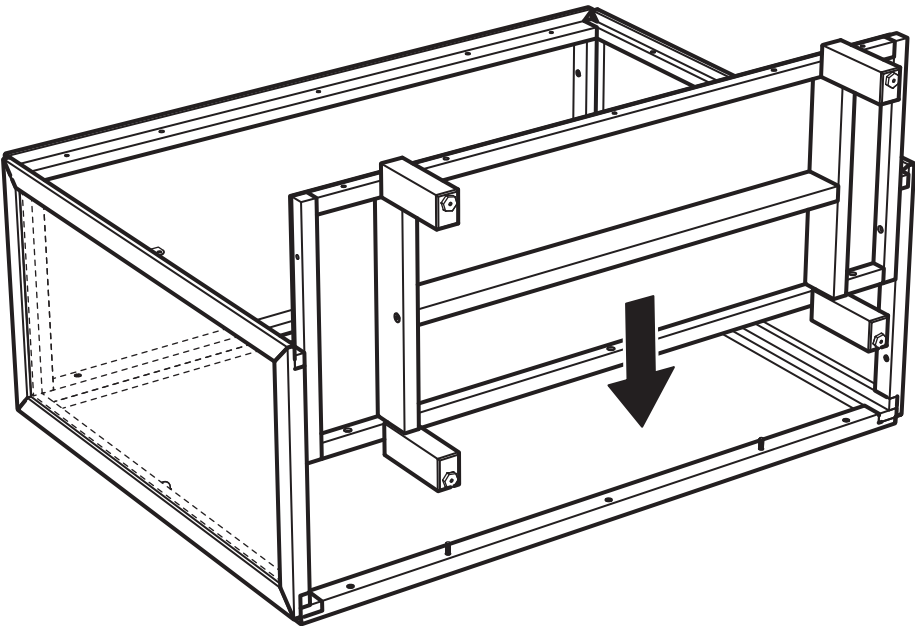

14

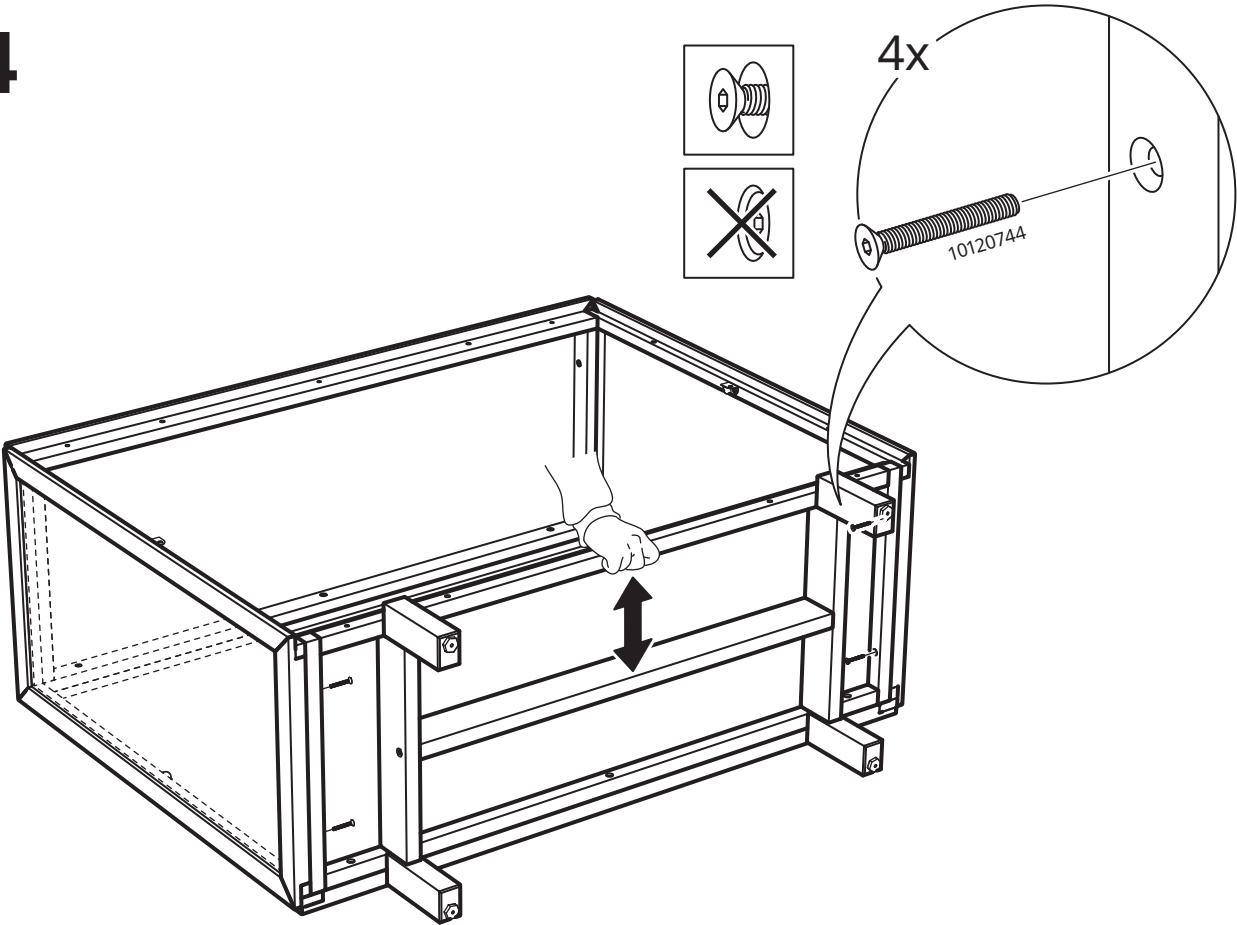

15

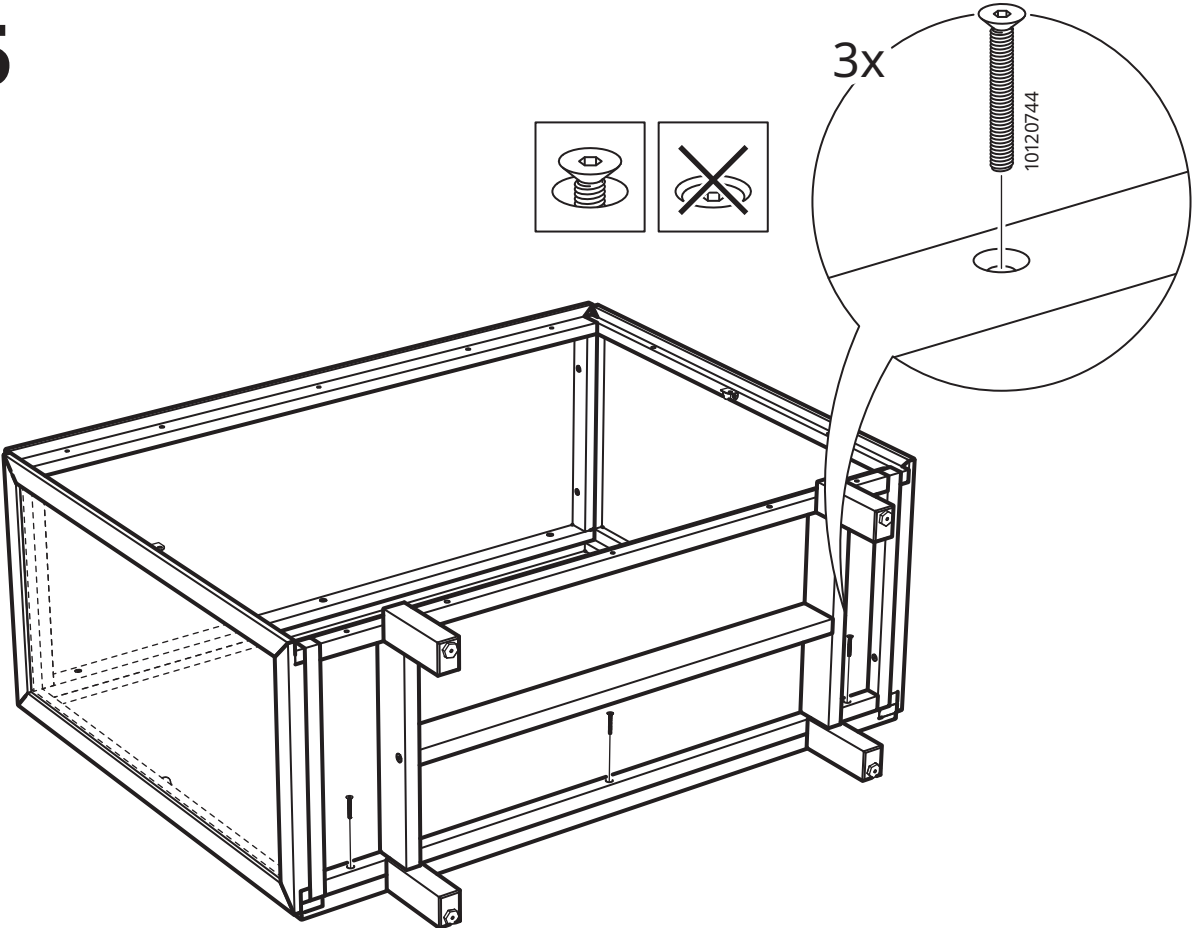

16

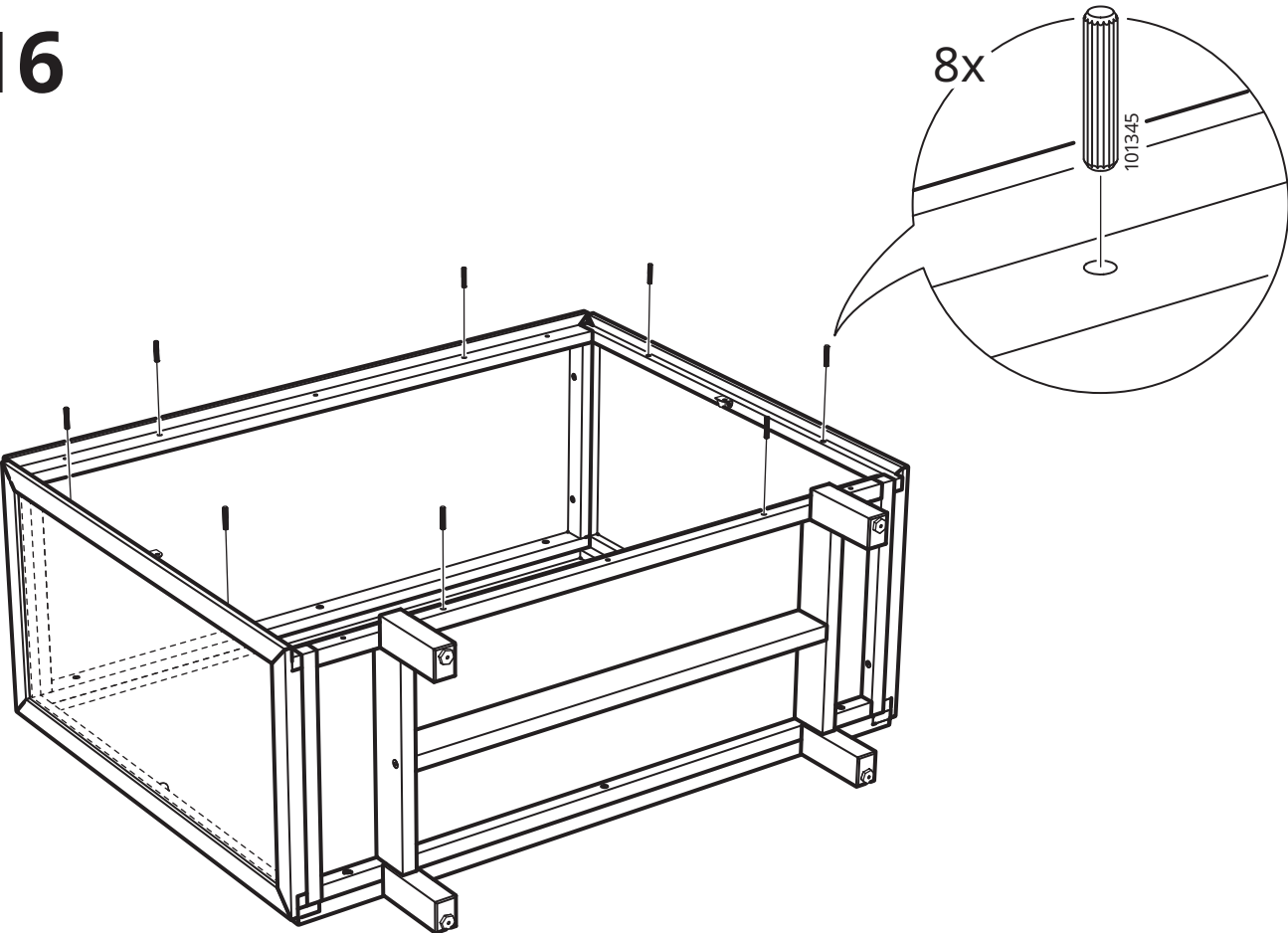

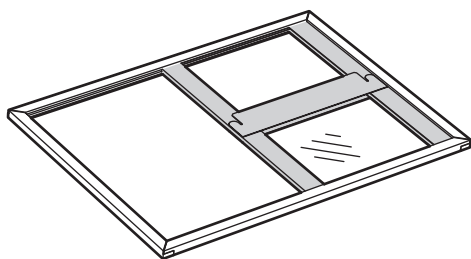

17

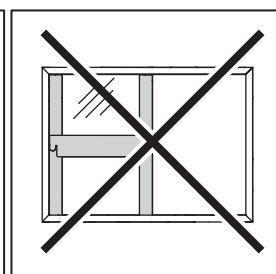
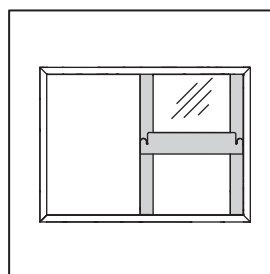
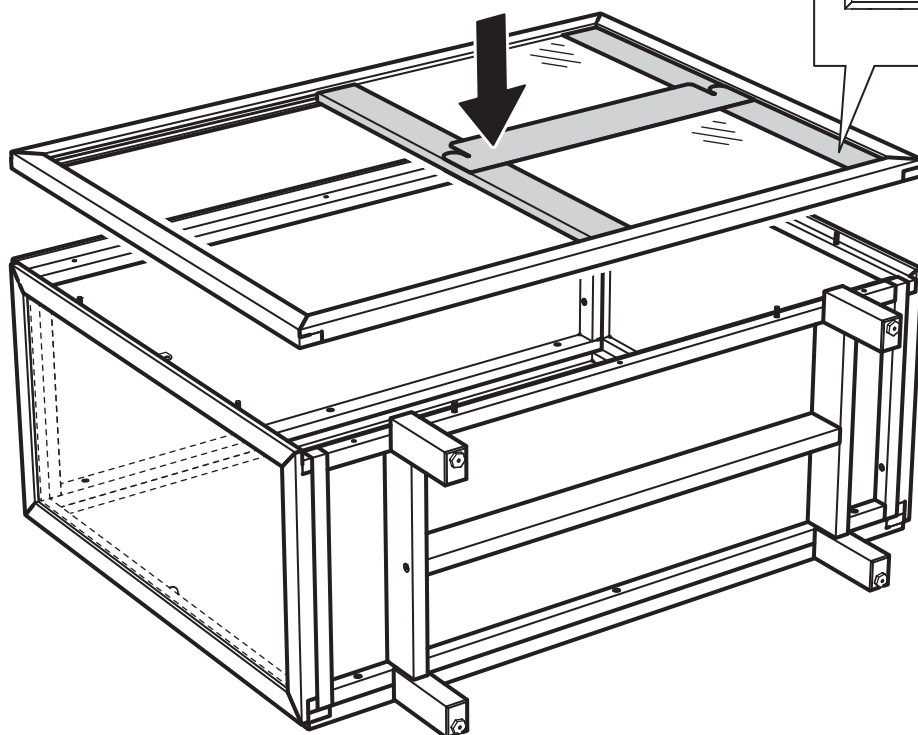

18

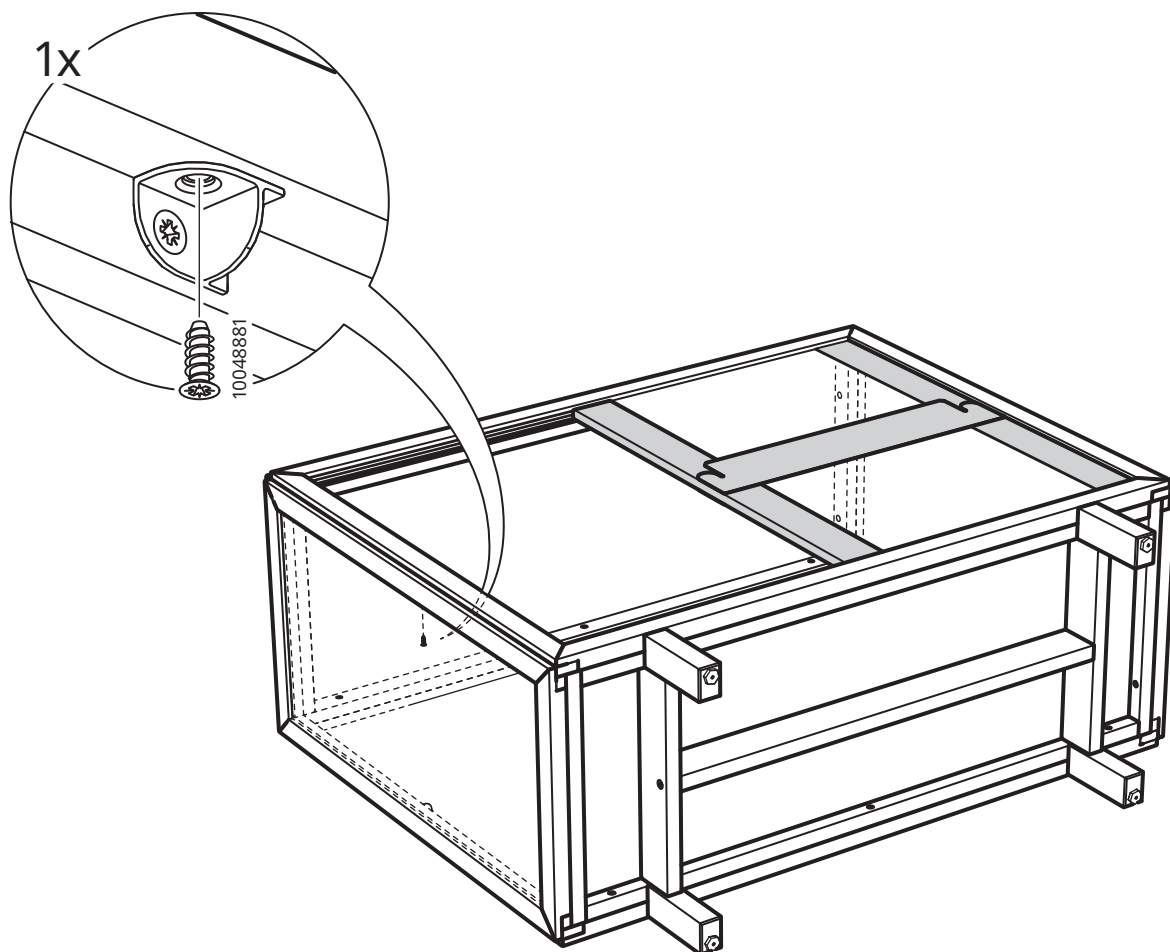

19

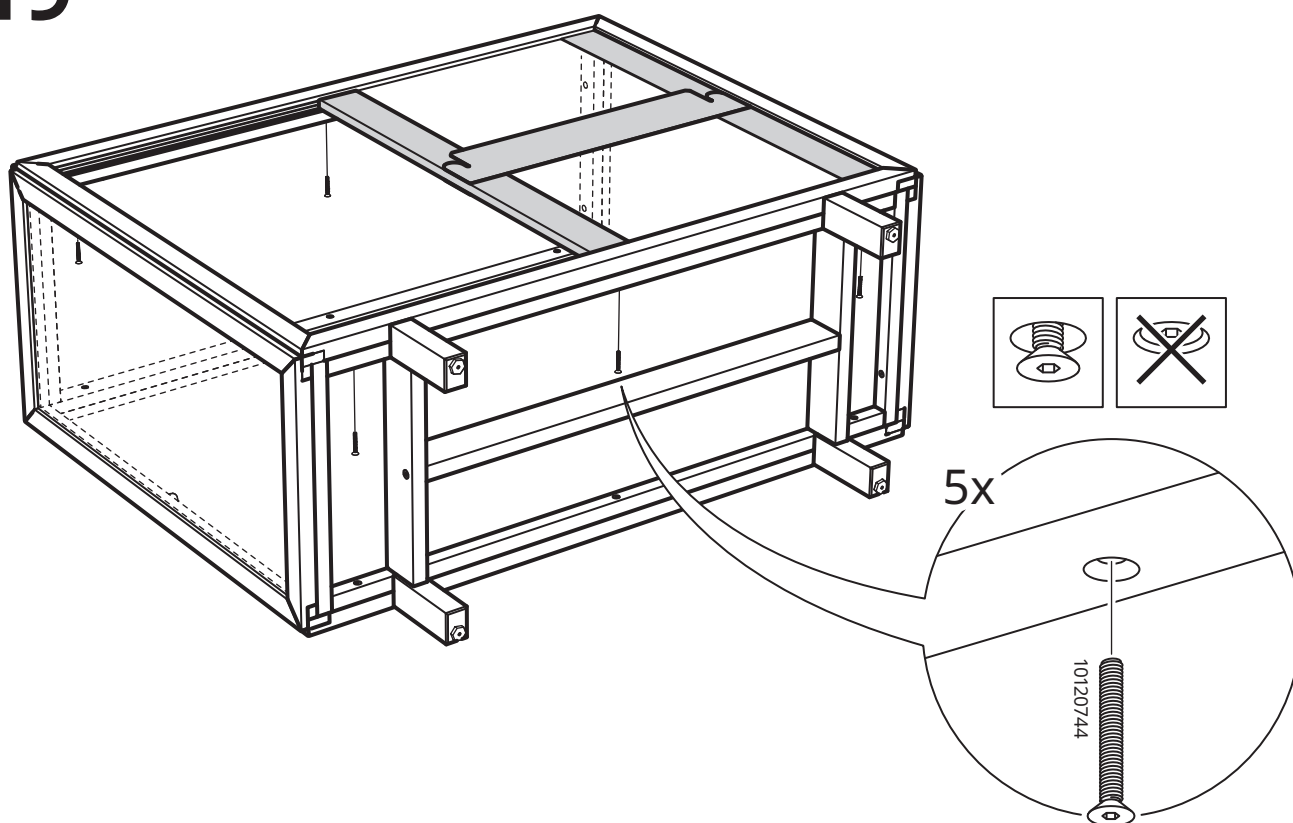

20

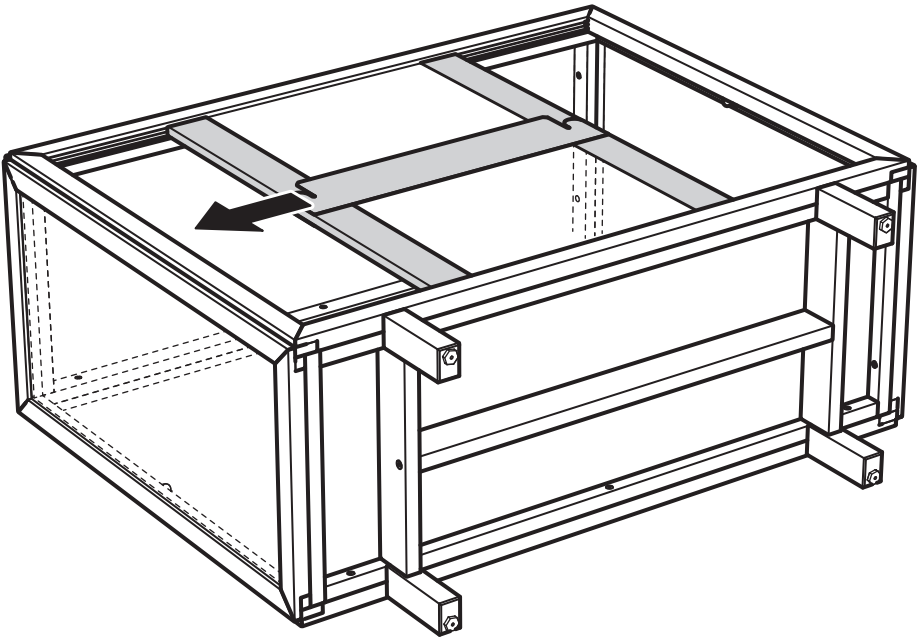

21

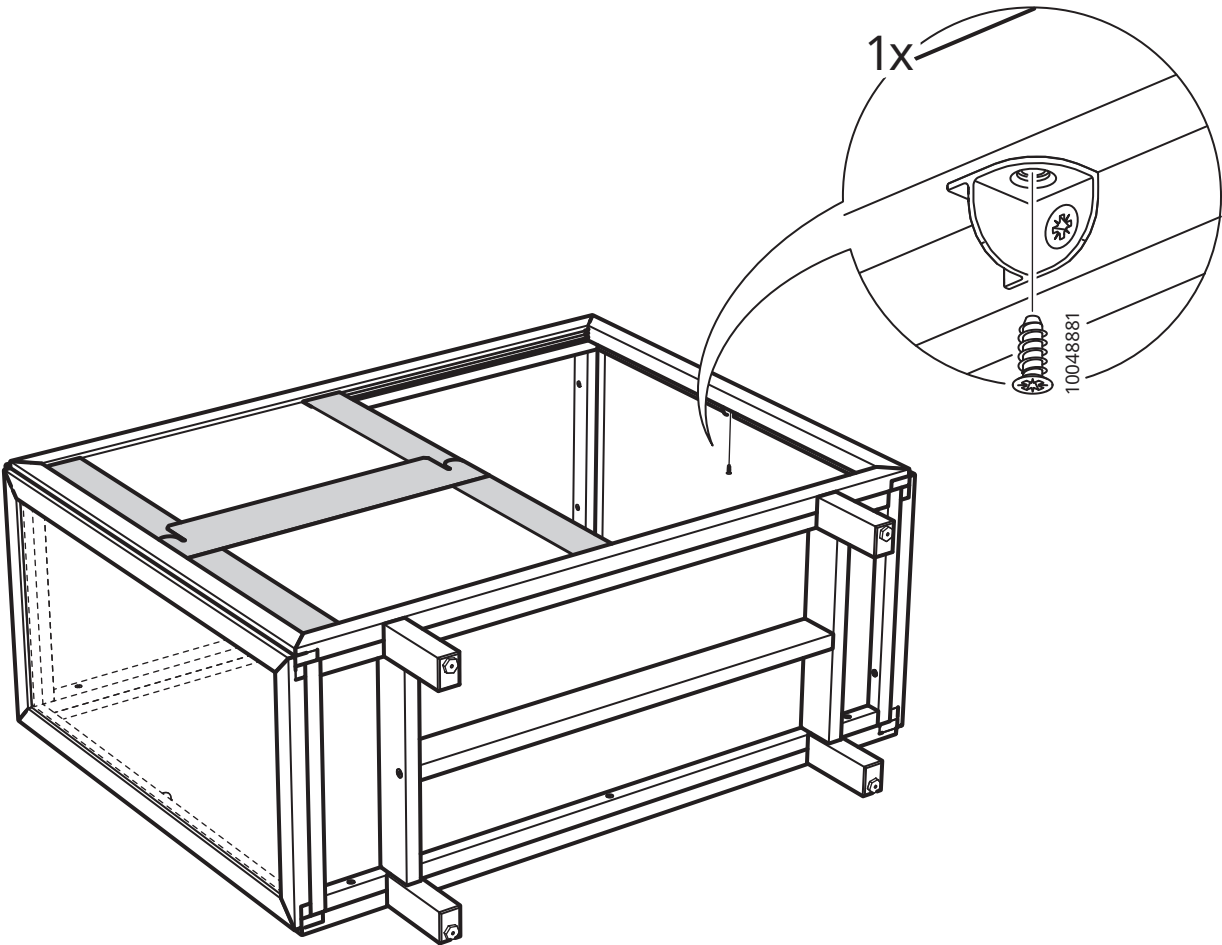

22

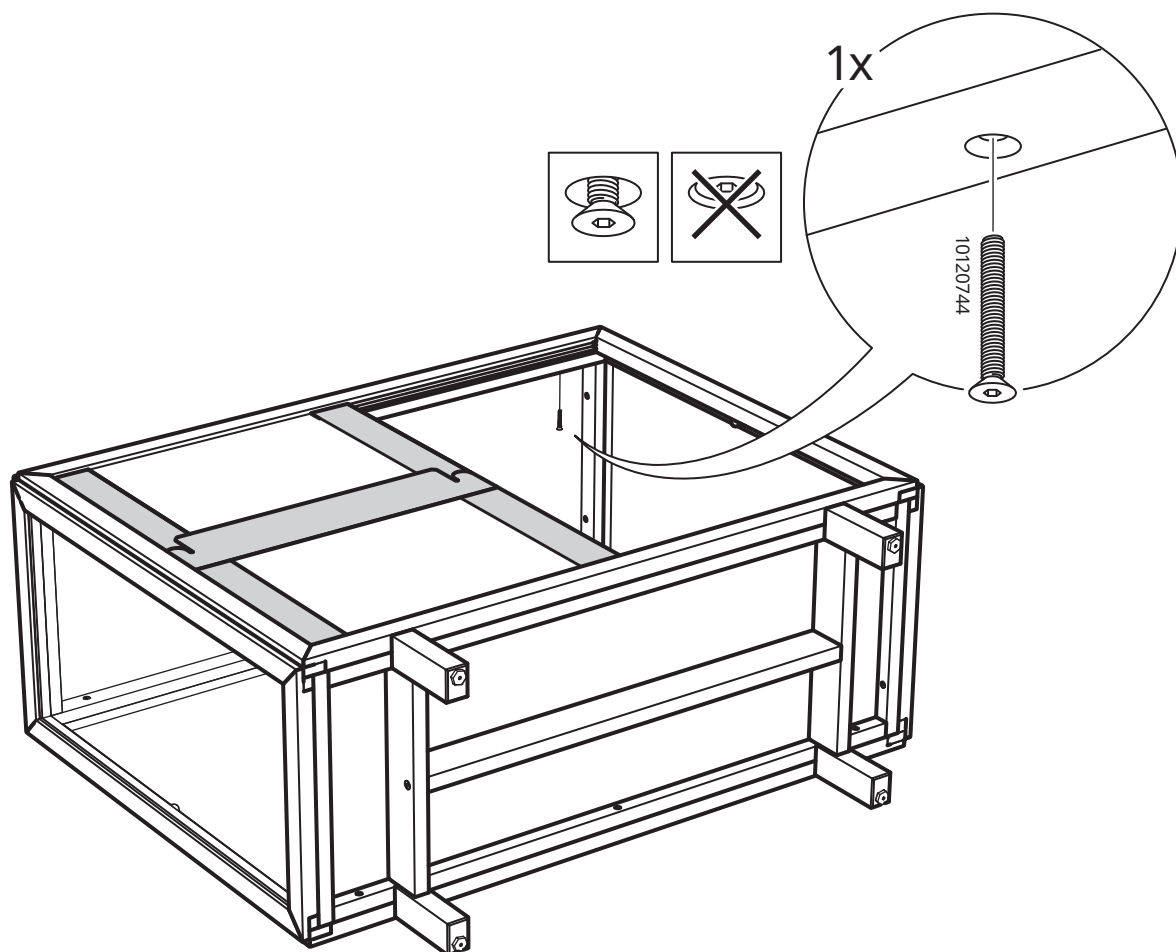

23

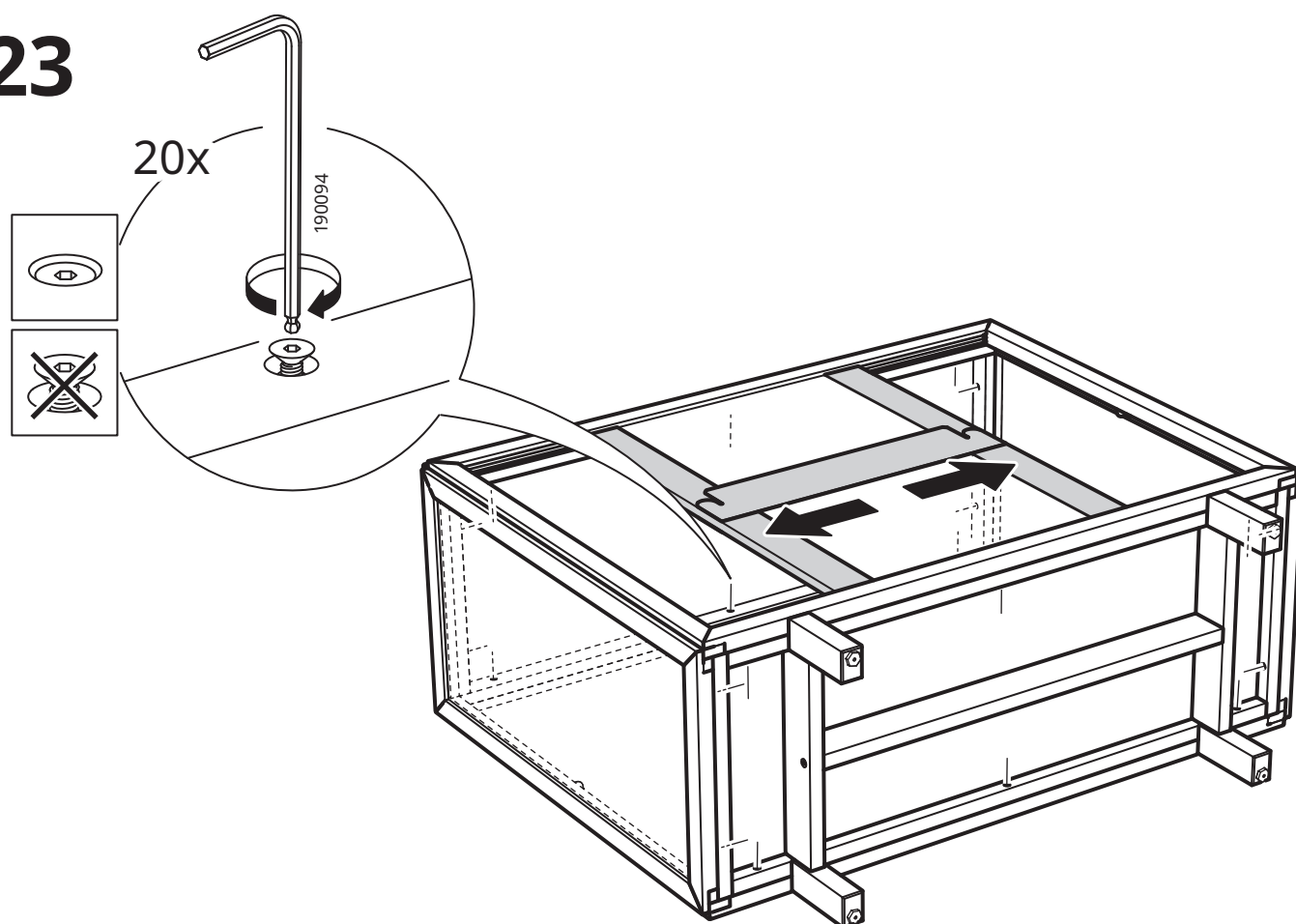

24

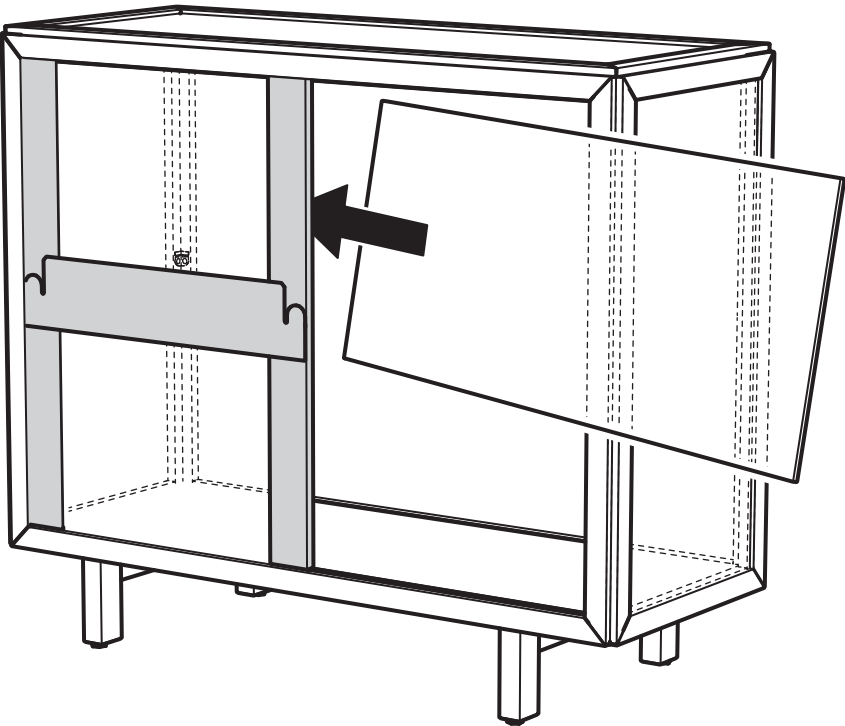

25

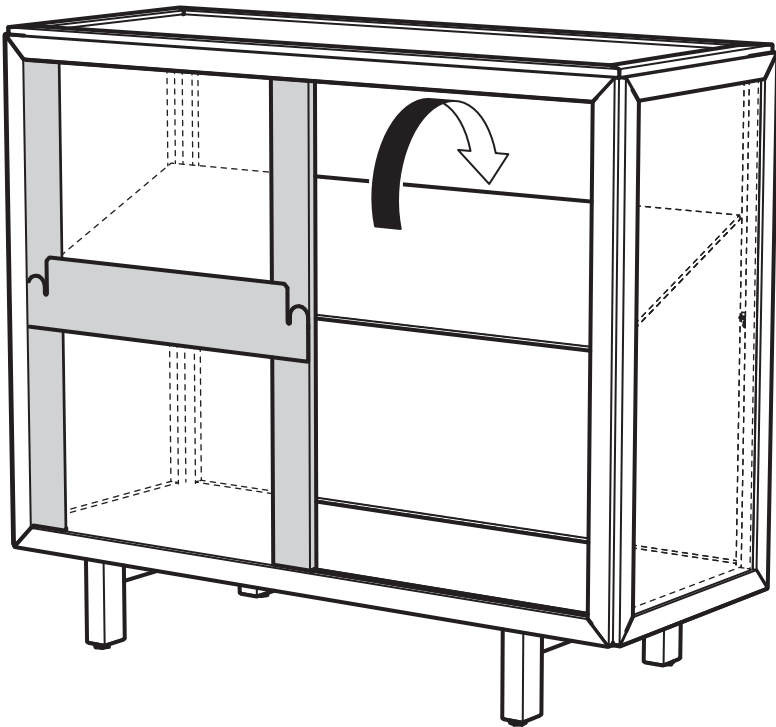

26

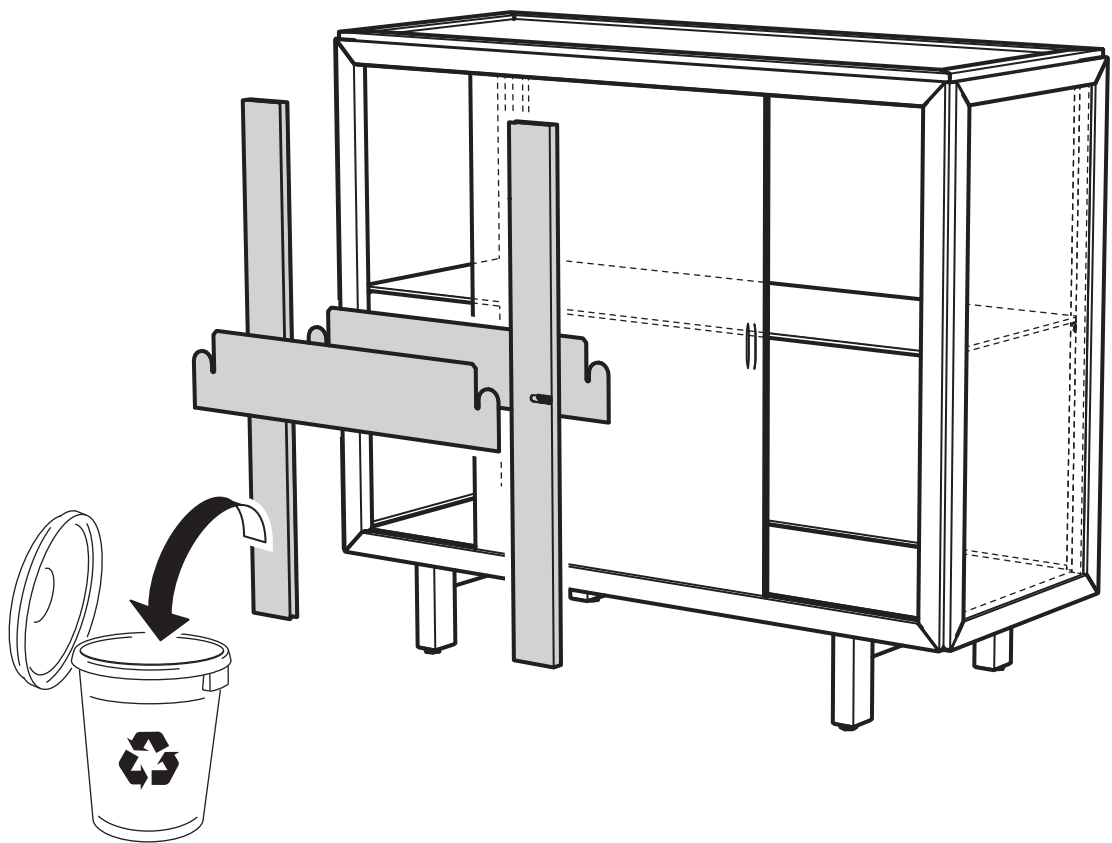

27

