

MALM

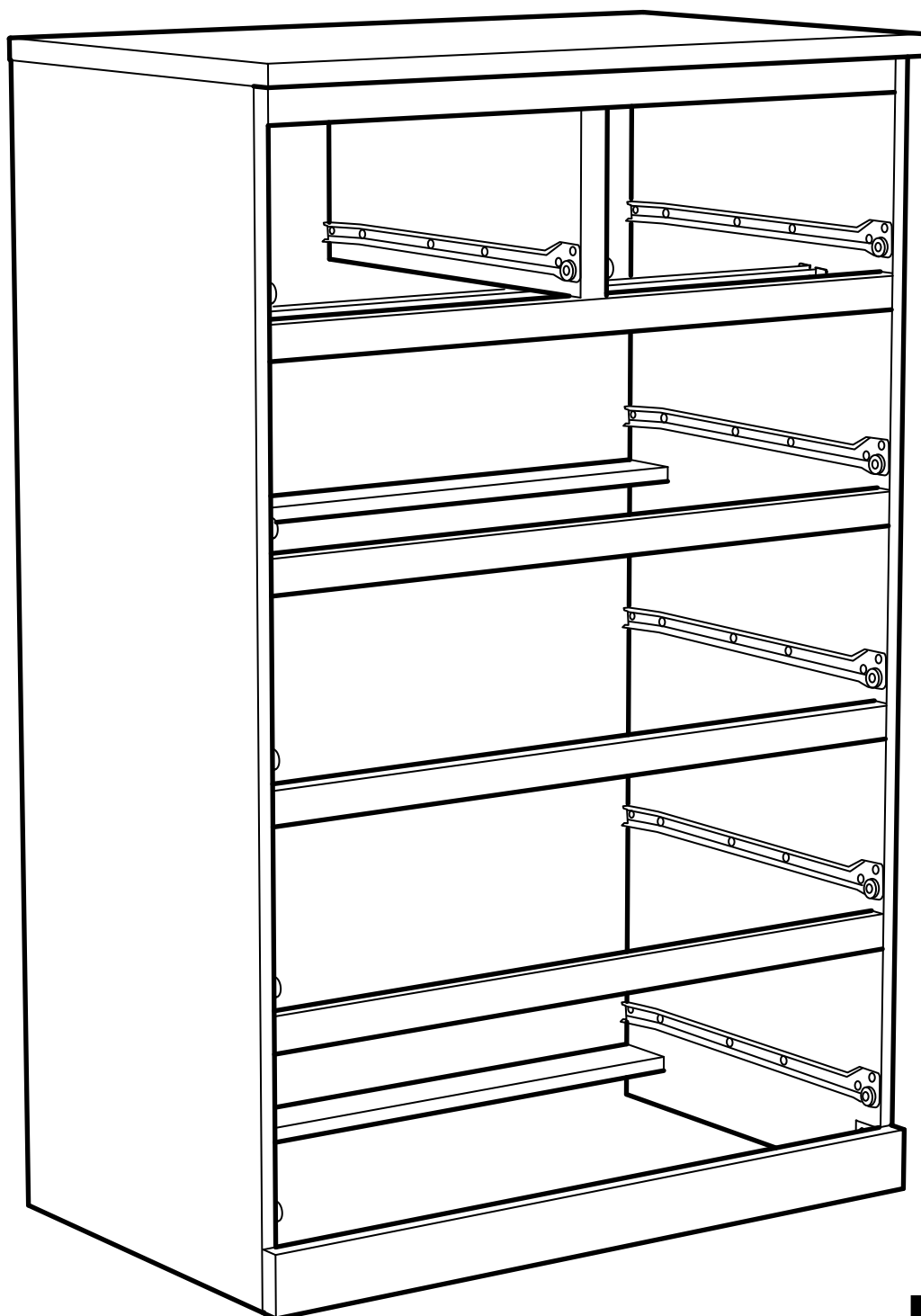

Design and Quality
IKEA of Sweden

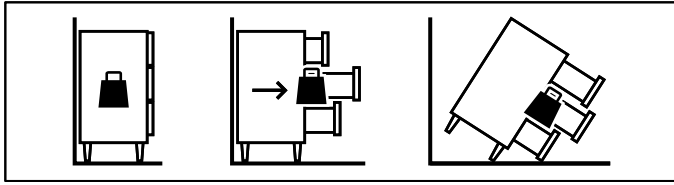

English

WARNING

Children have died from furniture tipover. To reduce the risk of furniture tipover:

ALWAYS install anti-tip device provided.

NEVER put a TV on this product.

NEVER allow children to stand, climb, or hang on any drawers, doors, or shelves.

NEVER open more than one drawer at a time.

Place heaviest items in the lowest drawers.

English

Read and follow each step of the instruction carefully.

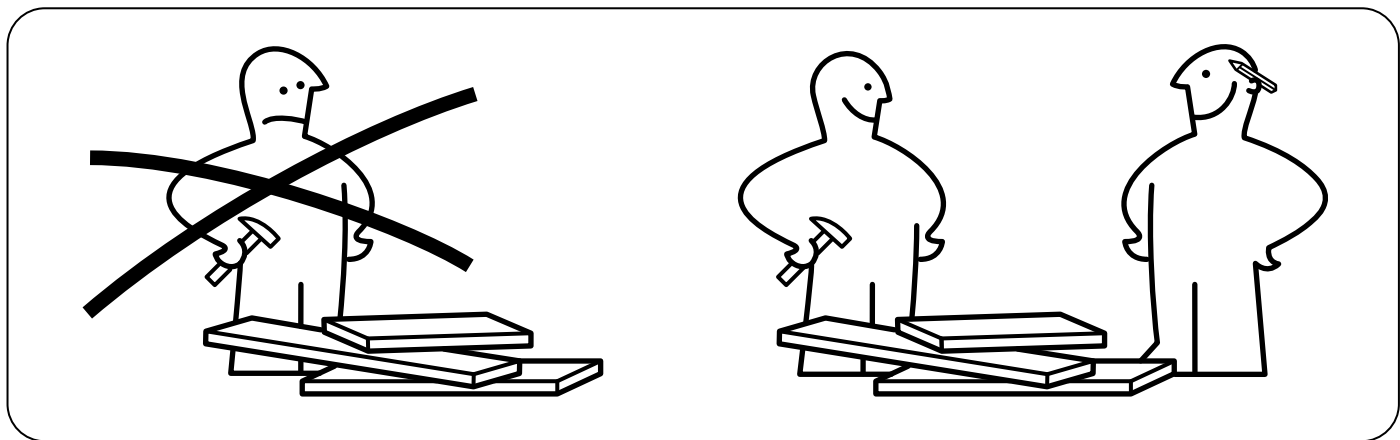
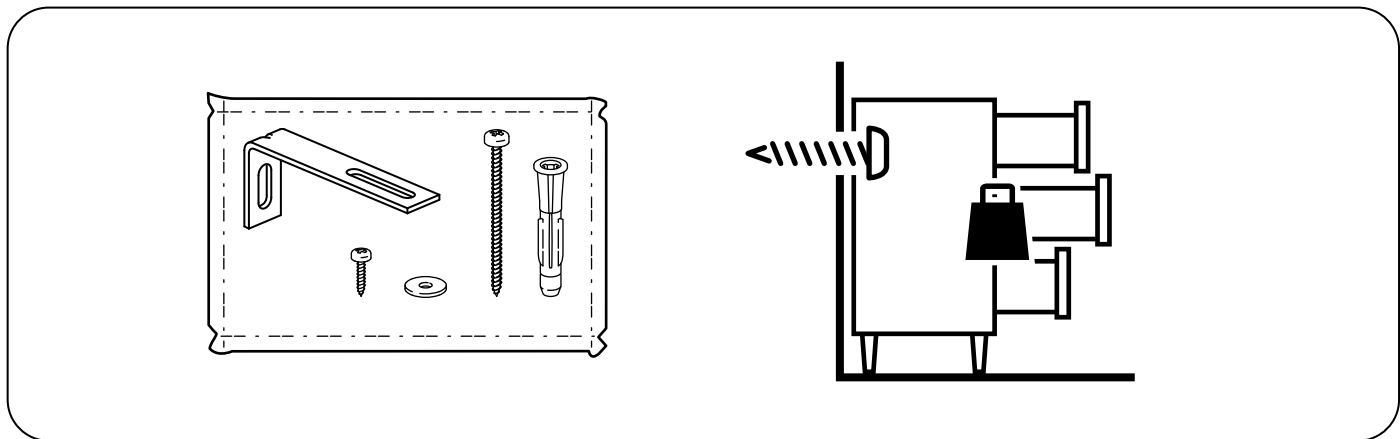
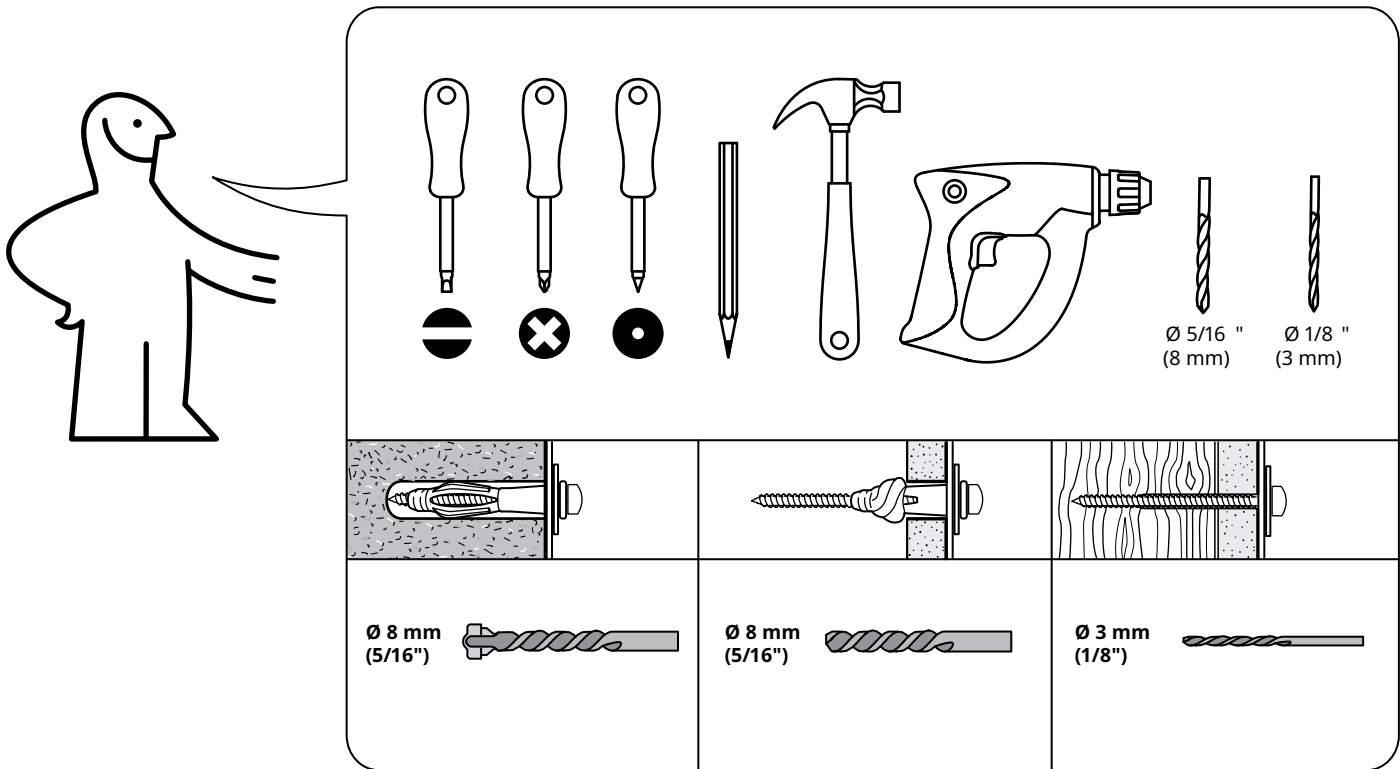

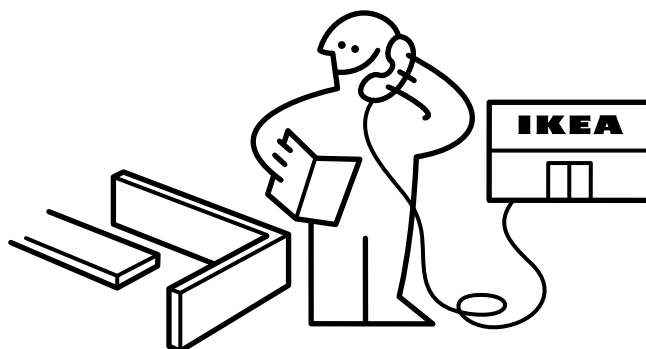
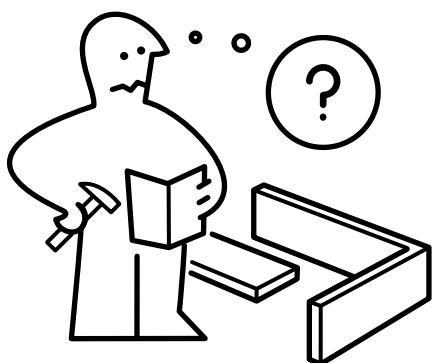
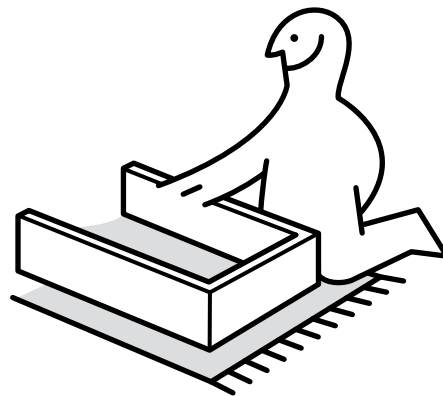
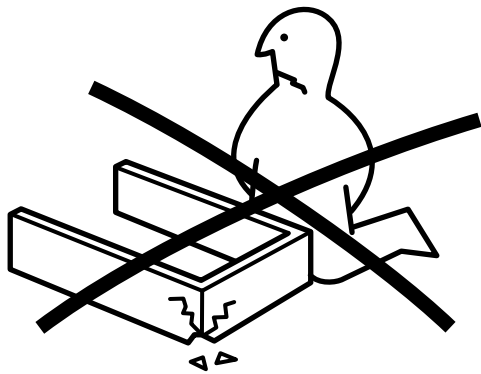

1

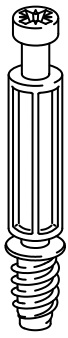

18x

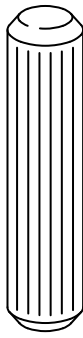

2x

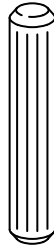

18x

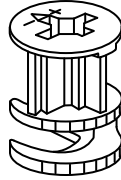

2x

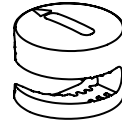

16x

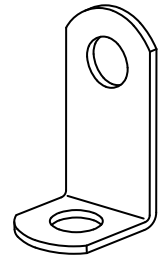

2x



8x

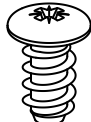

8x



4x

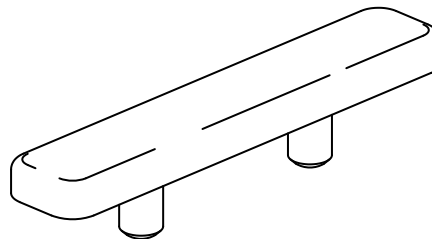

6x

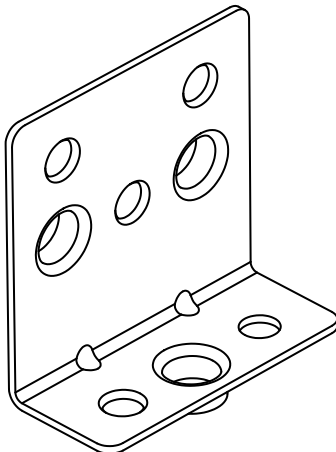

2x

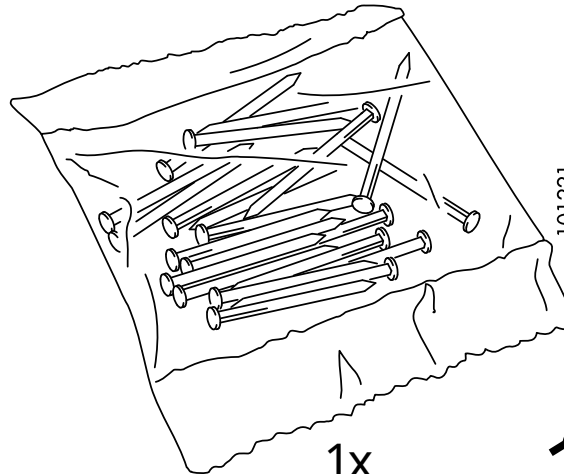

1x



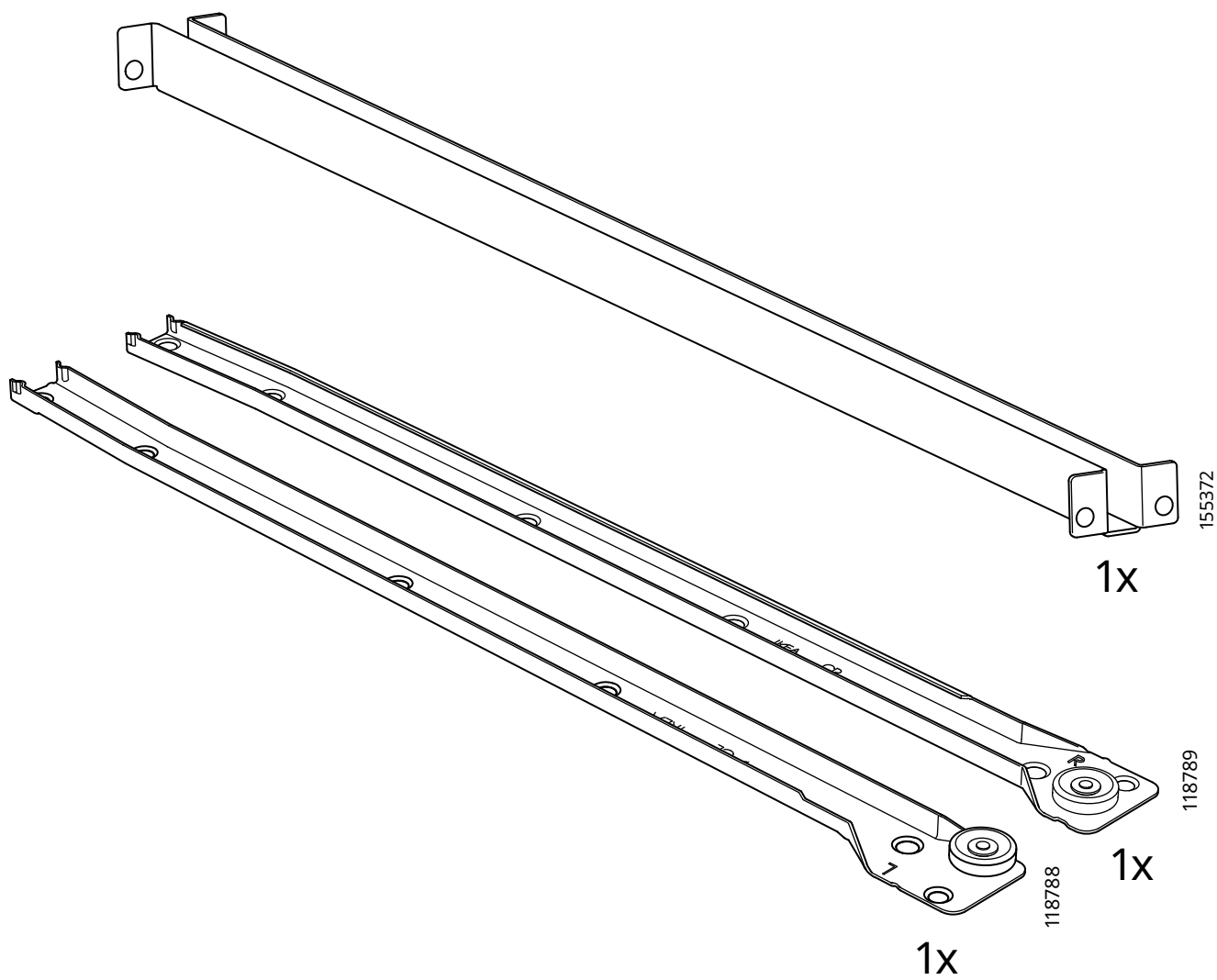
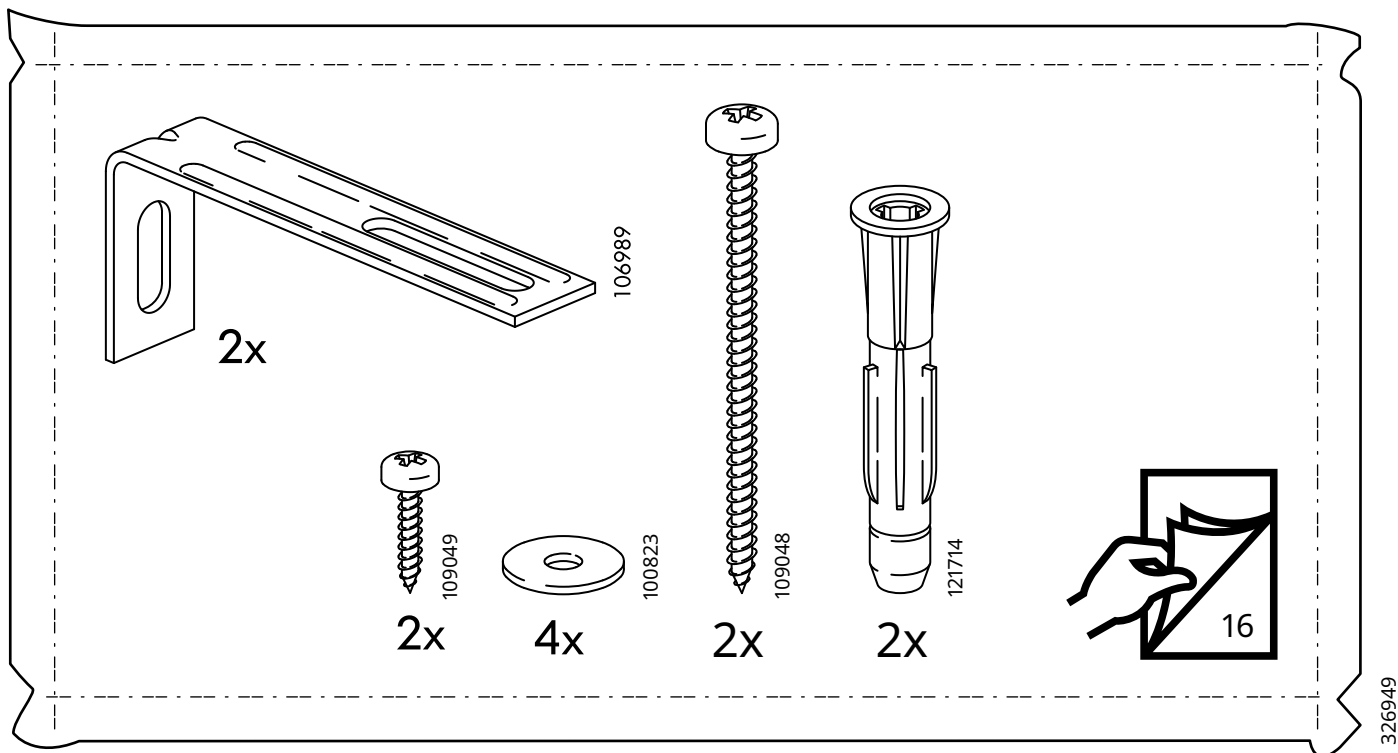

This image displays a variety of mechanical hardware. At the top left is a large number '1'. Below it are several items: a long threaded bolt with a hexagonal head, a long threaded rod with a hexagonal head, a short threaded rod, a hex nut, a flat washer, and a L-shaped bracket. In the middle row, there are three different sizes of screws and a long, rectangular handle with two mounting feet. At the bottom left is a rectangular plate with four circular holes and two pre-drilled slots. To the right is a crumpled paper bag filled with numerous small pins or nails.

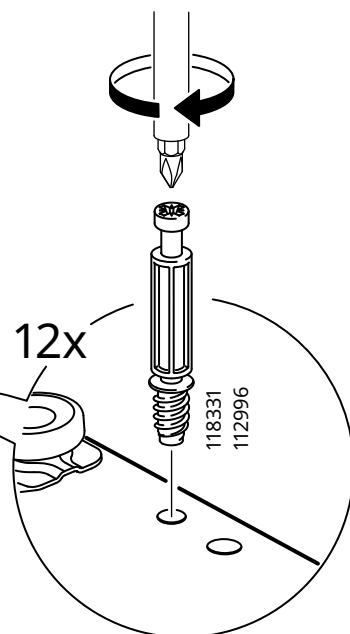

2

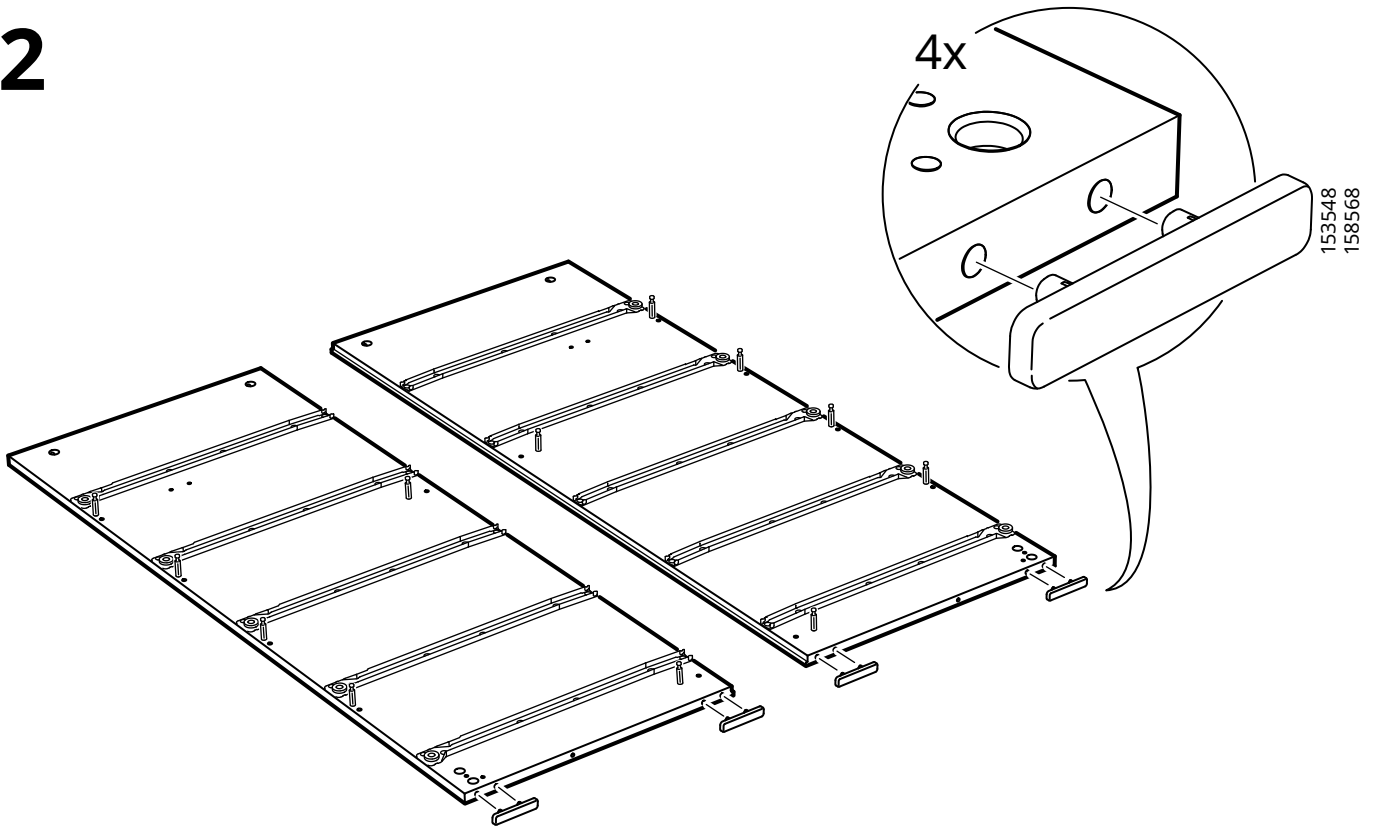

3

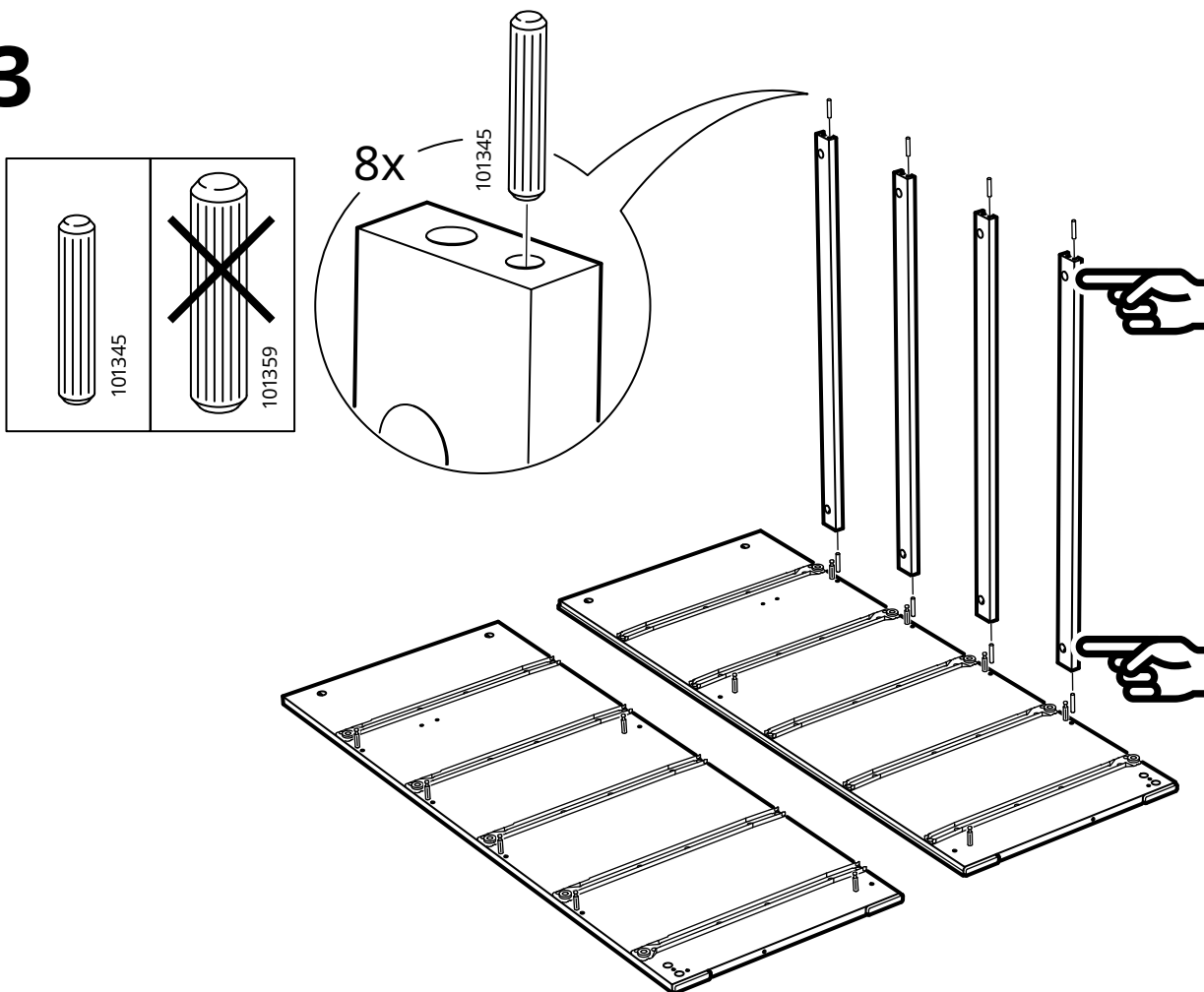

4

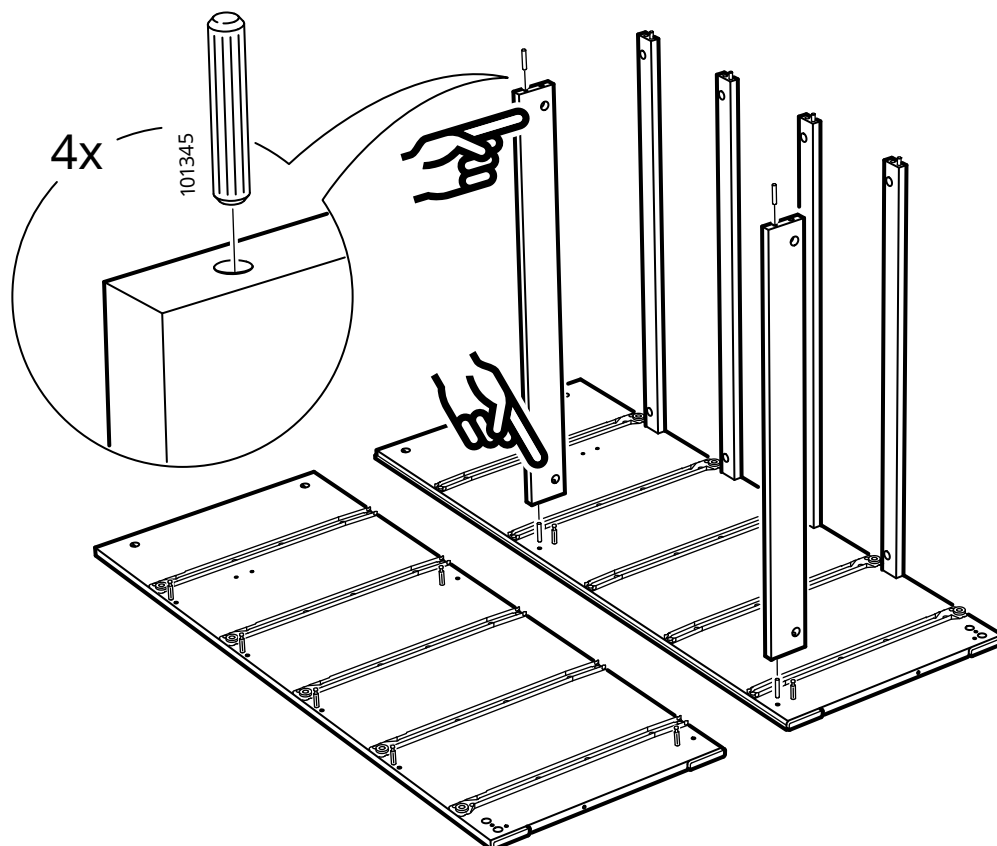
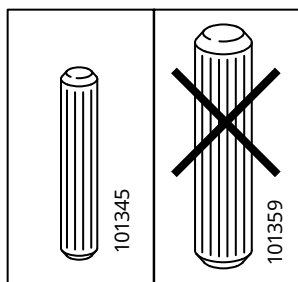

5

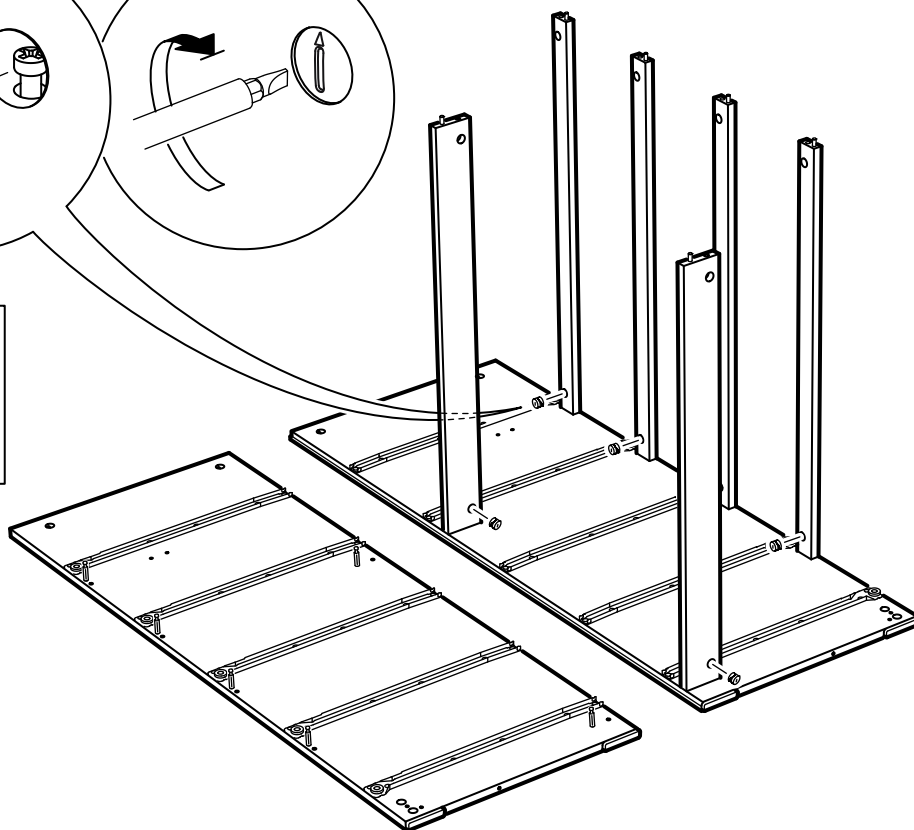
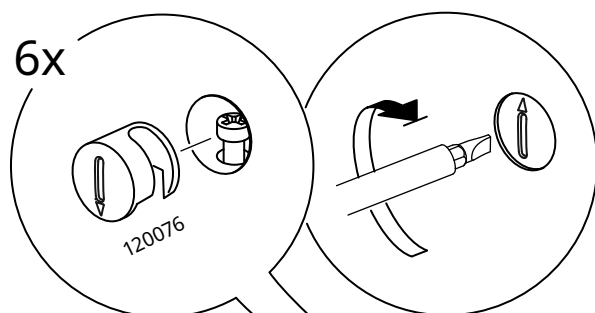
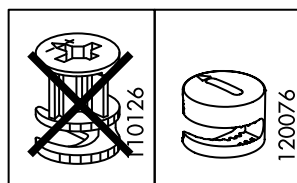

6

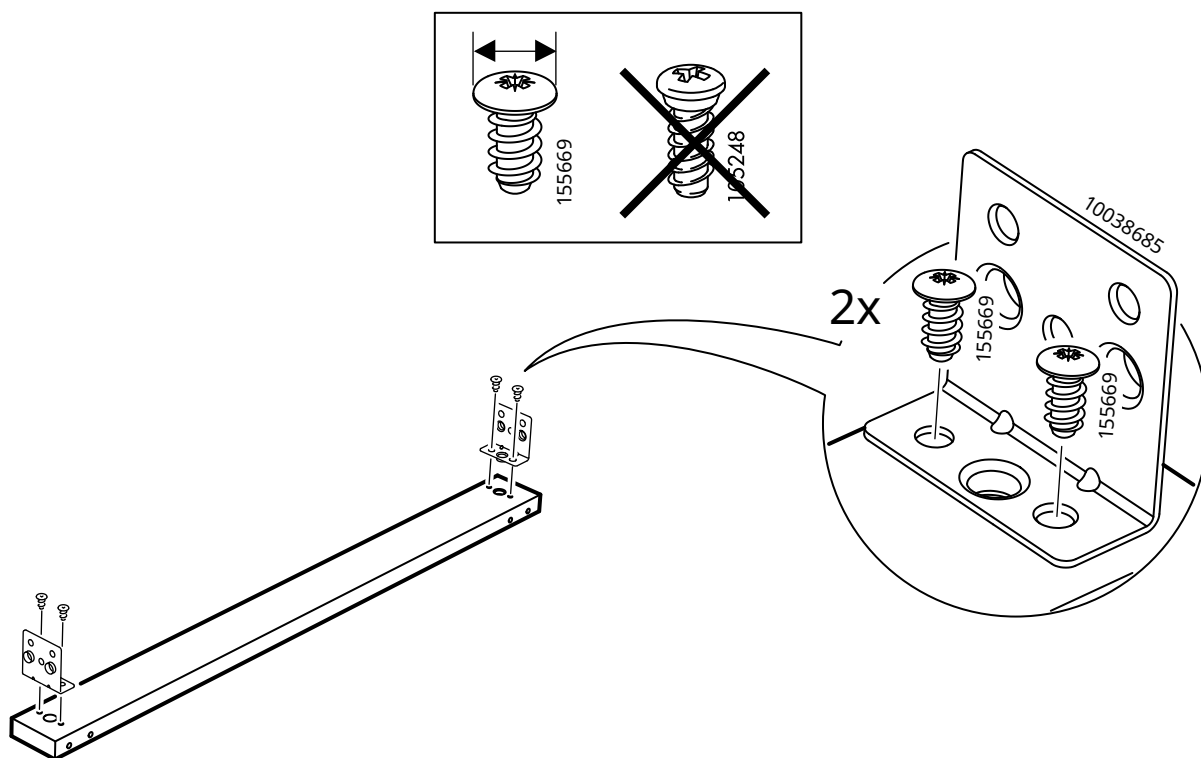

7

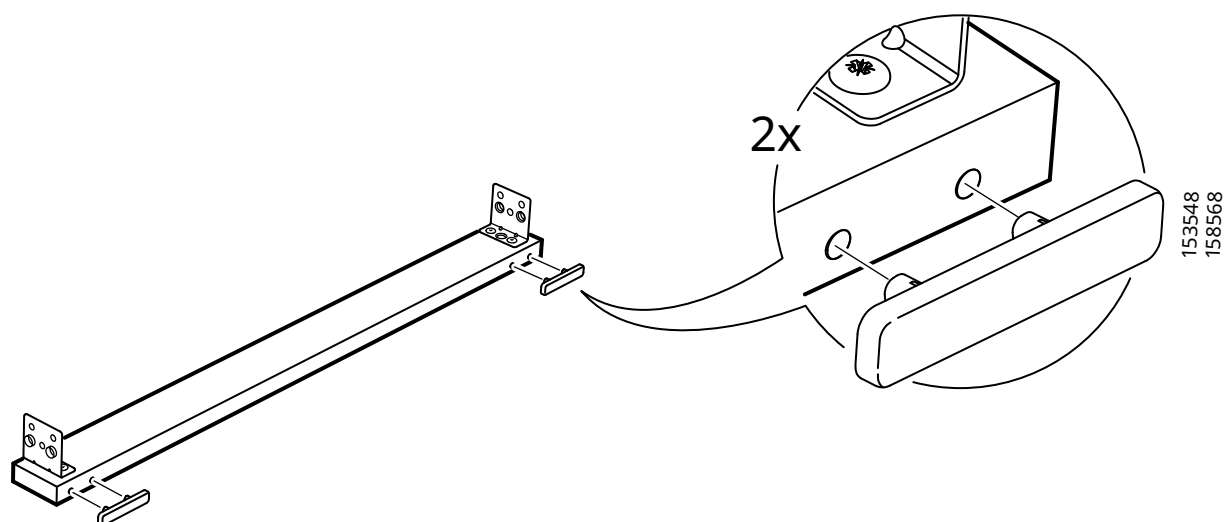

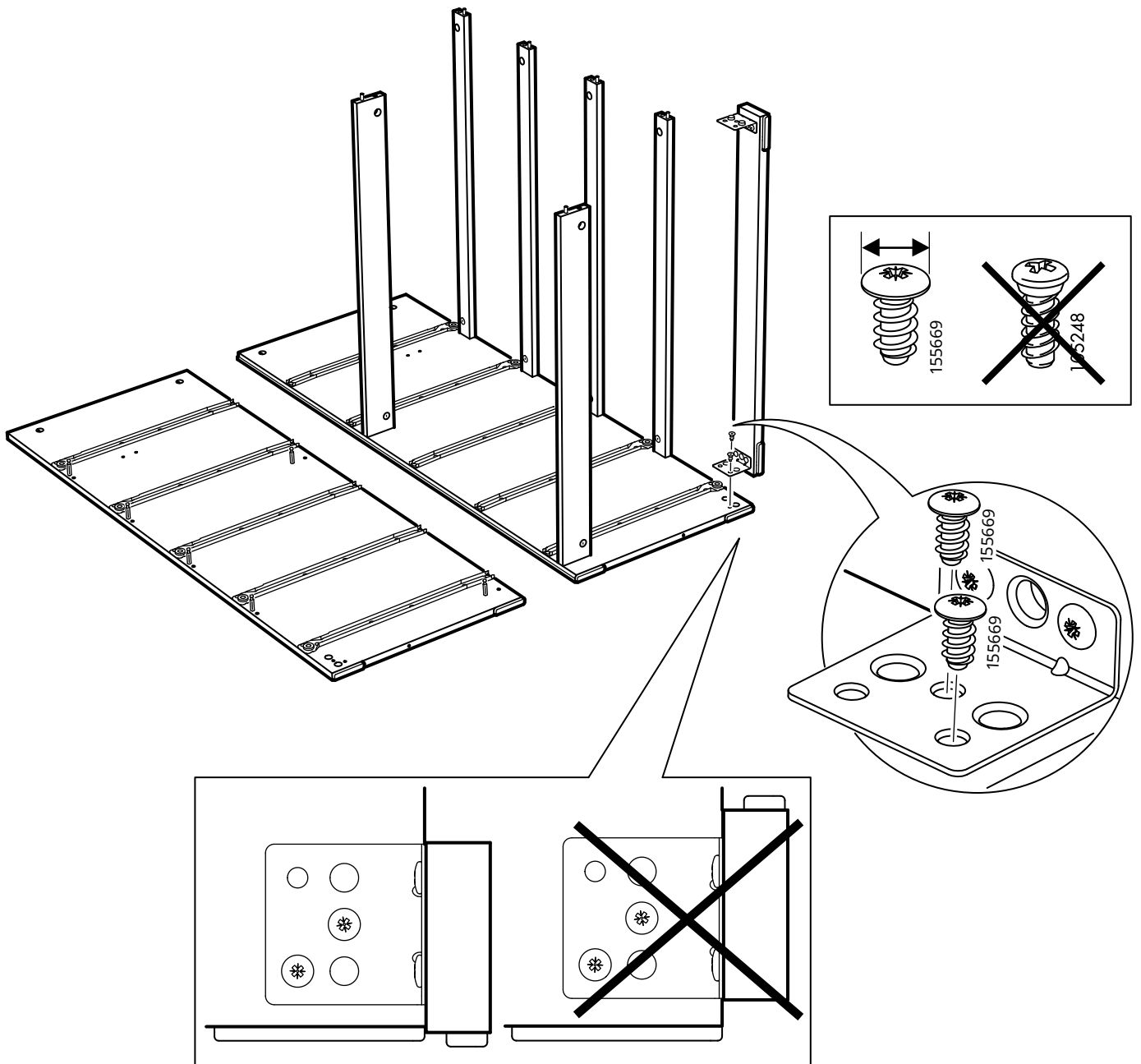

9

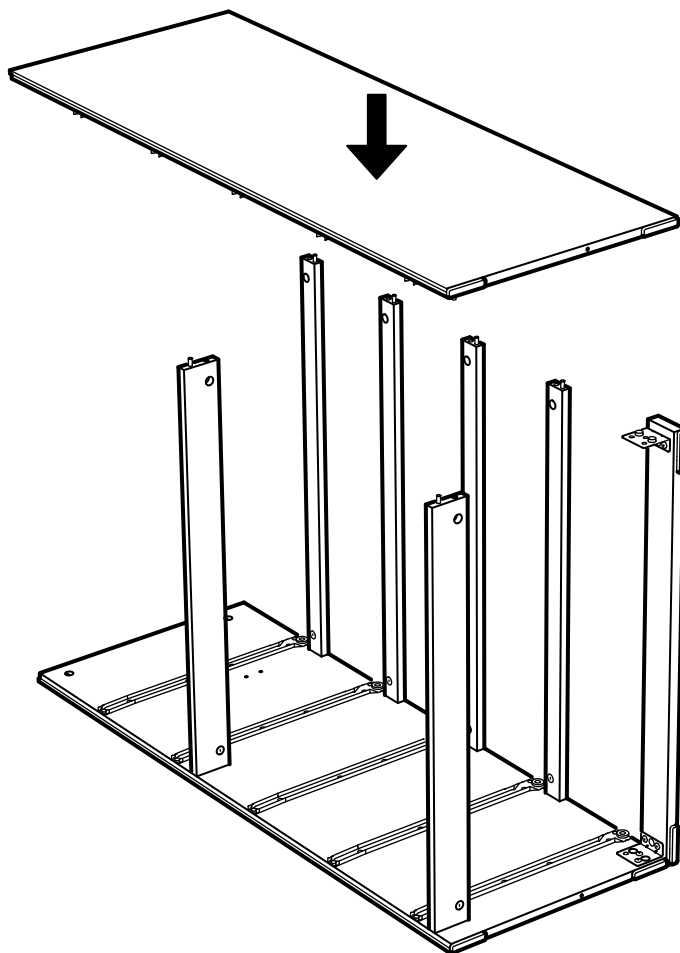

10

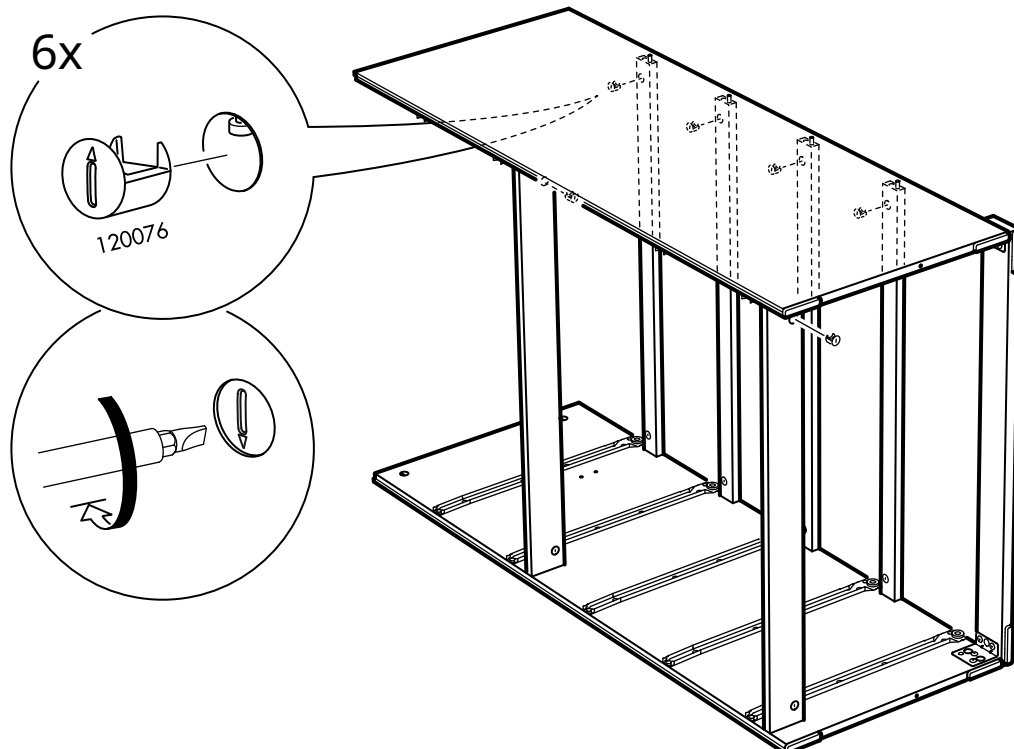
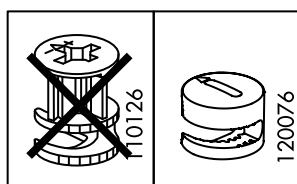

11

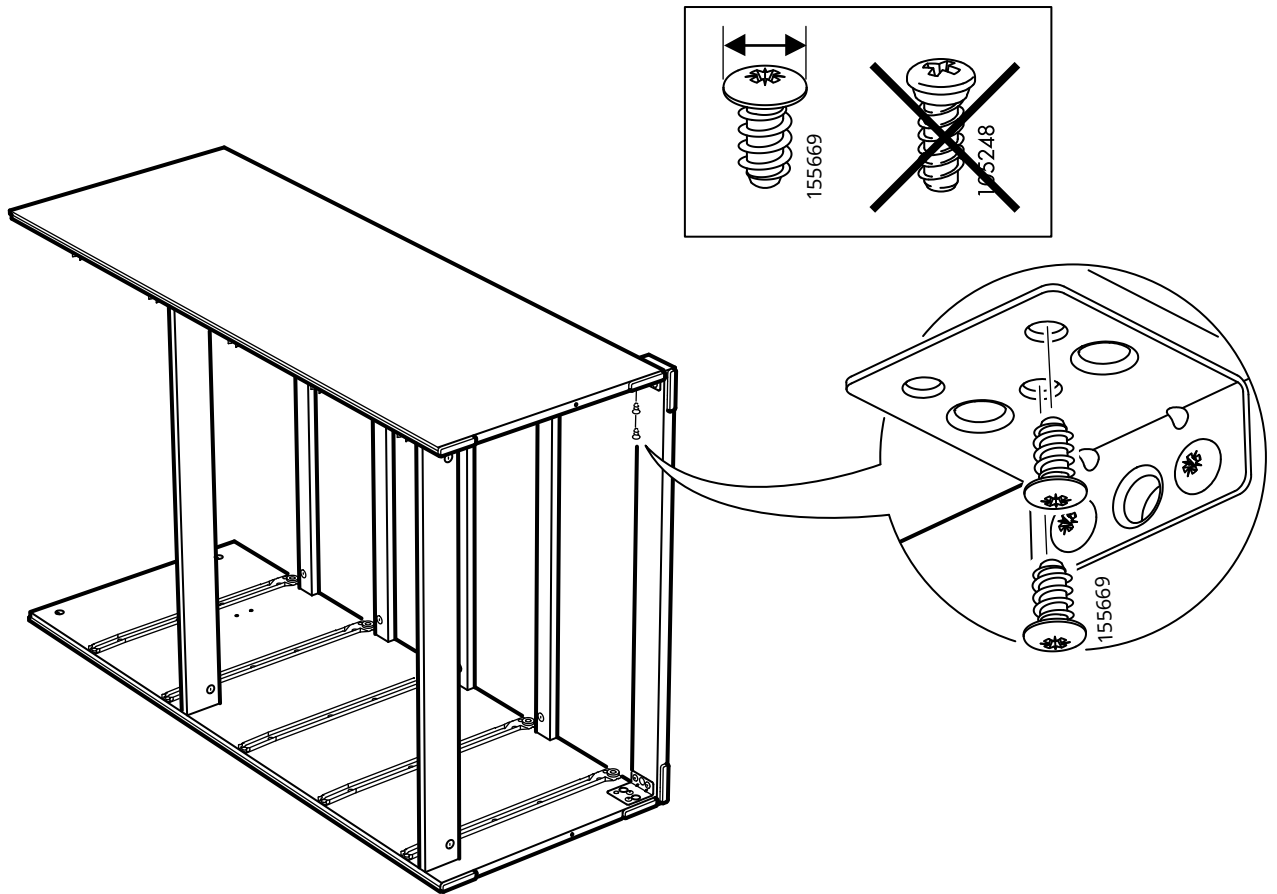

12

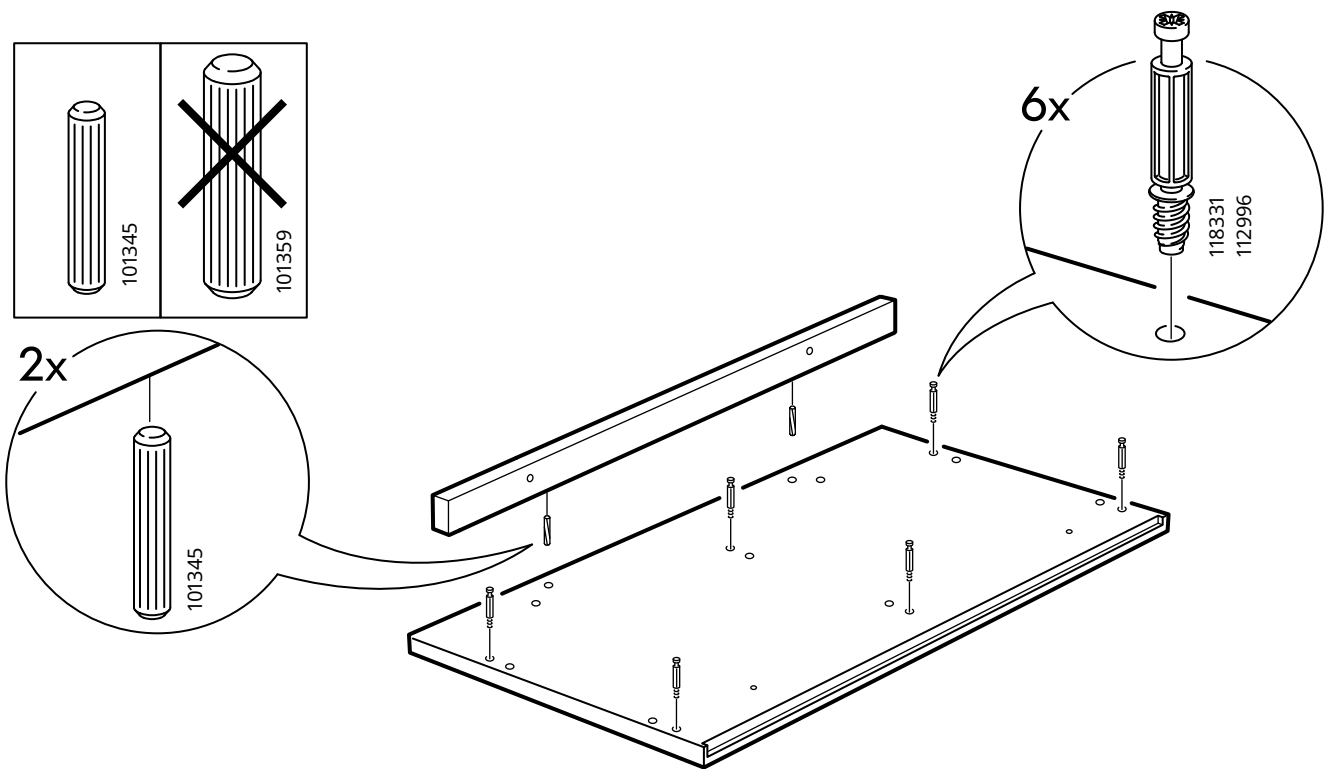

13

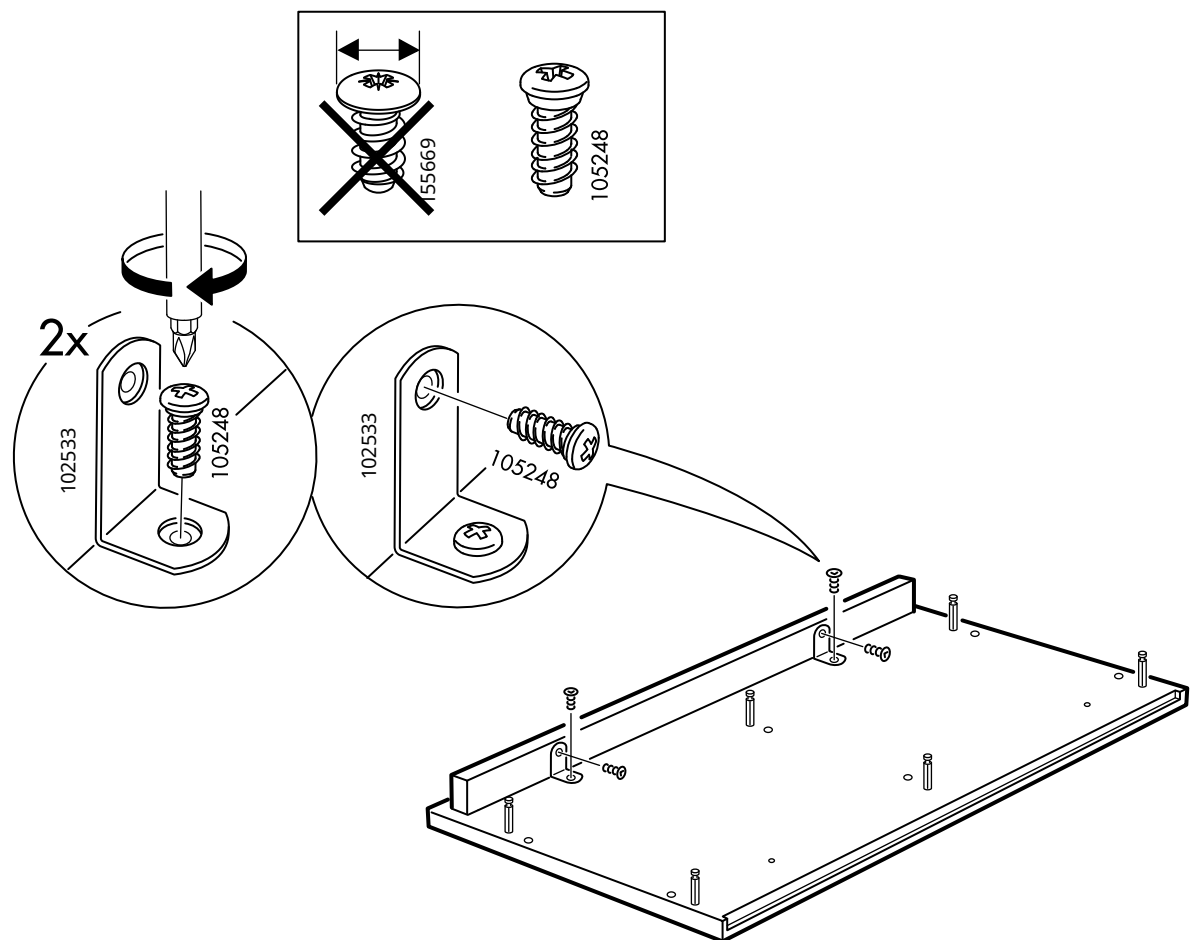

14

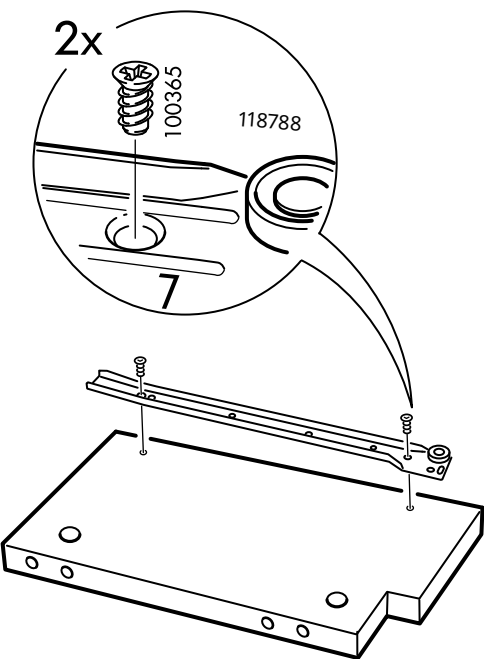

15

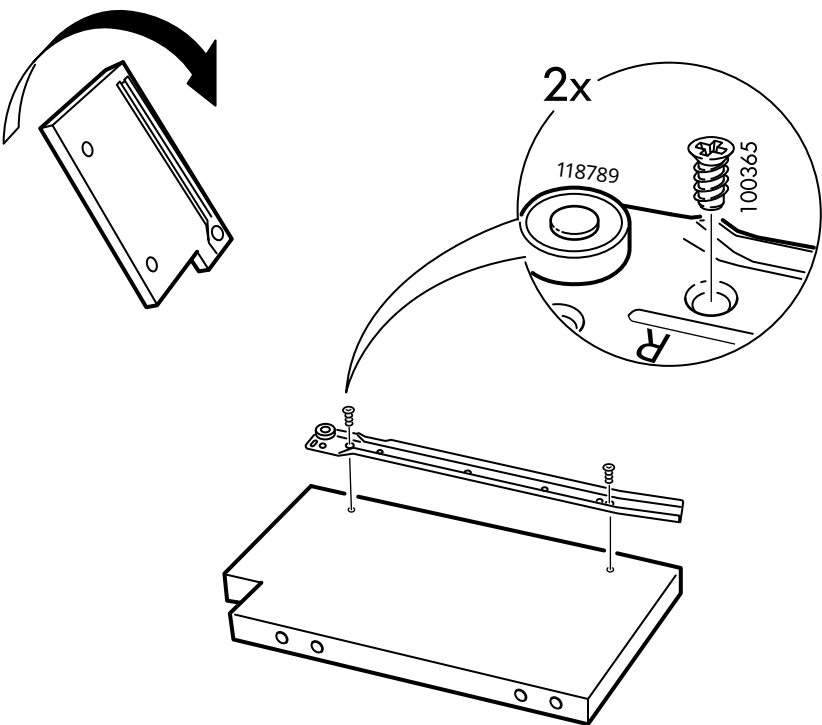

16

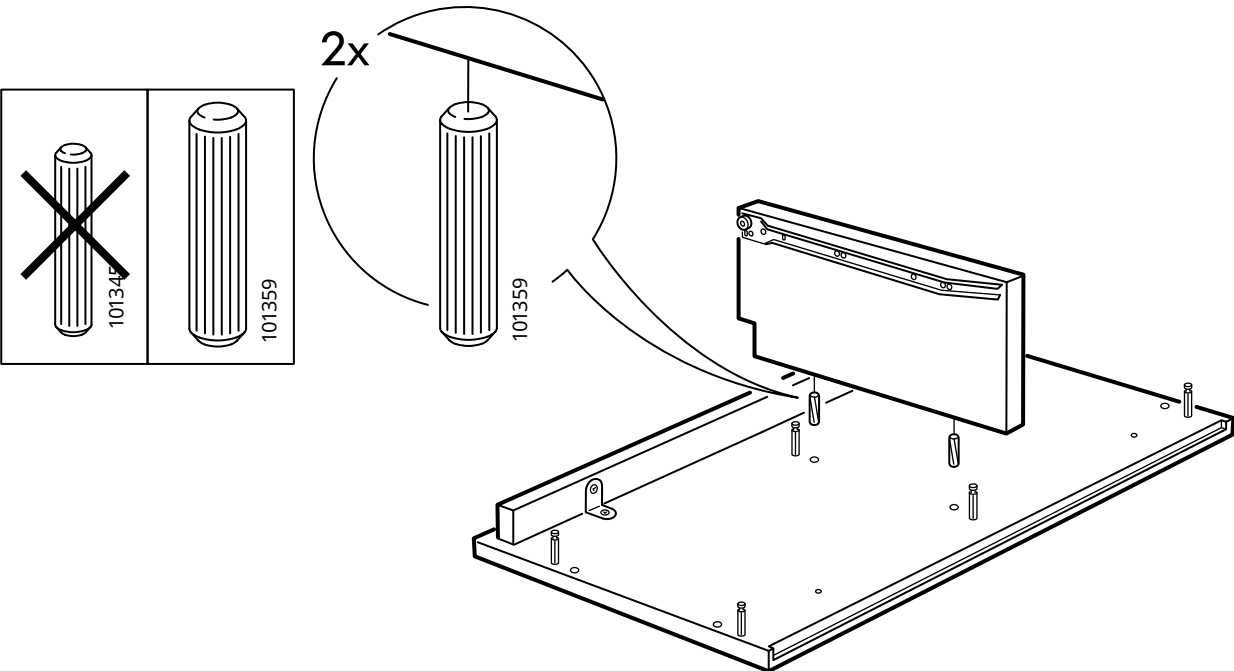

17

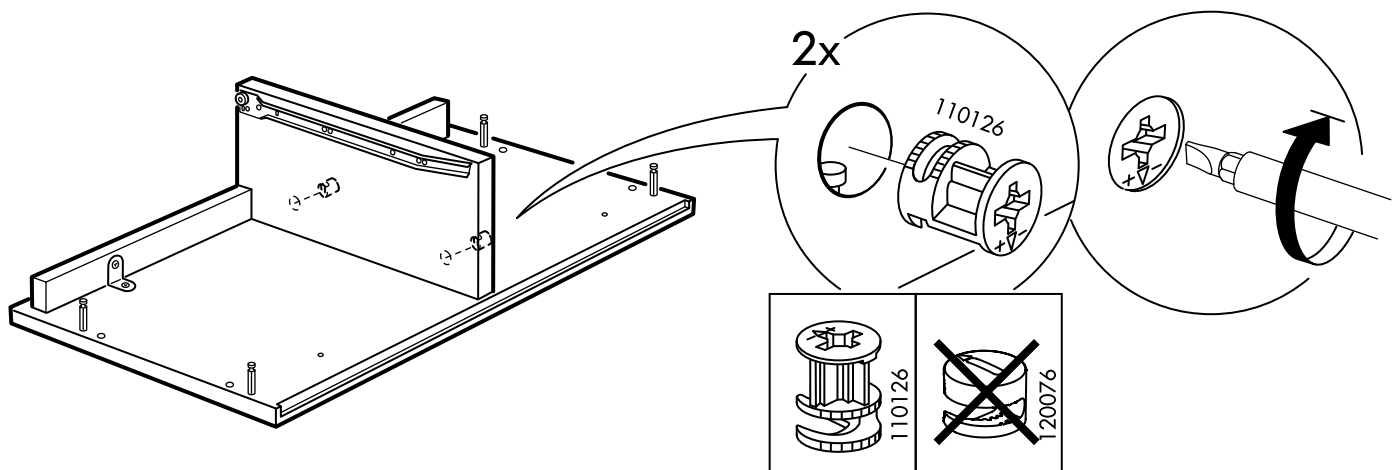

18

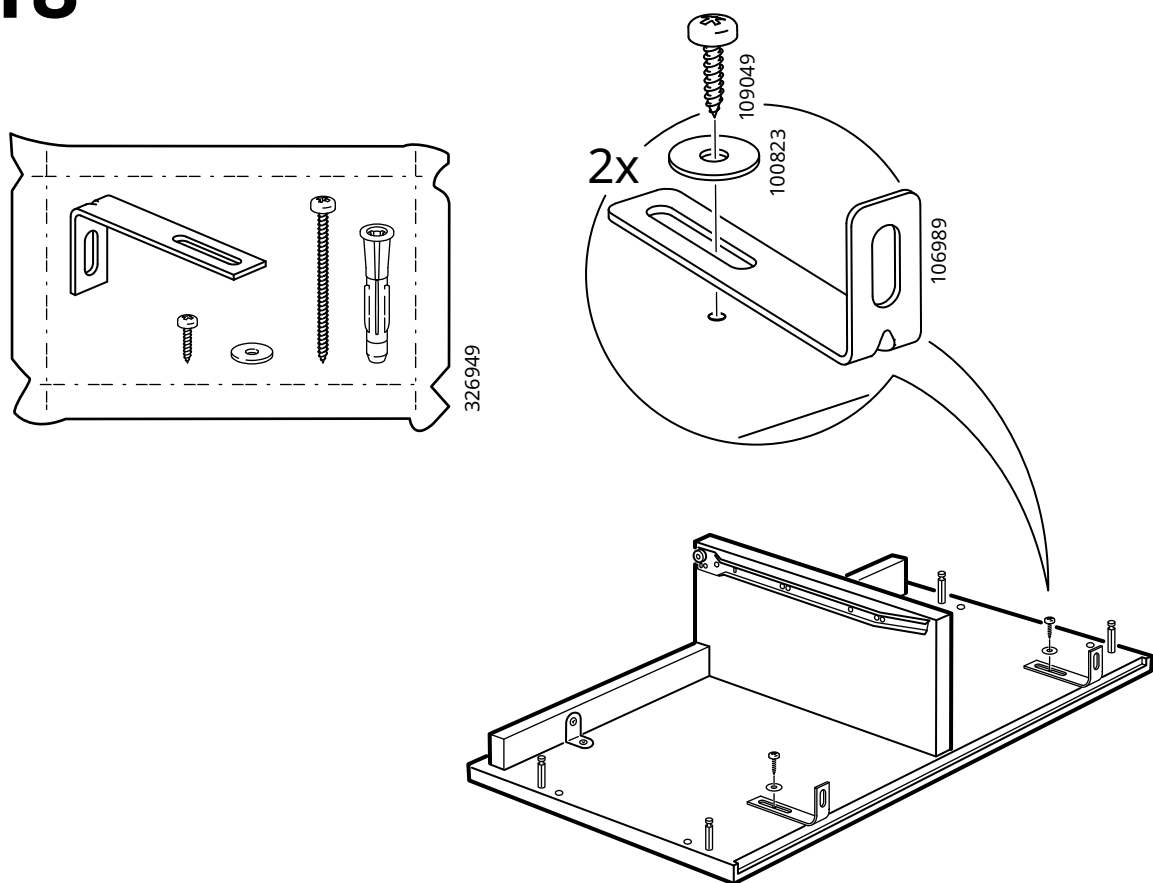

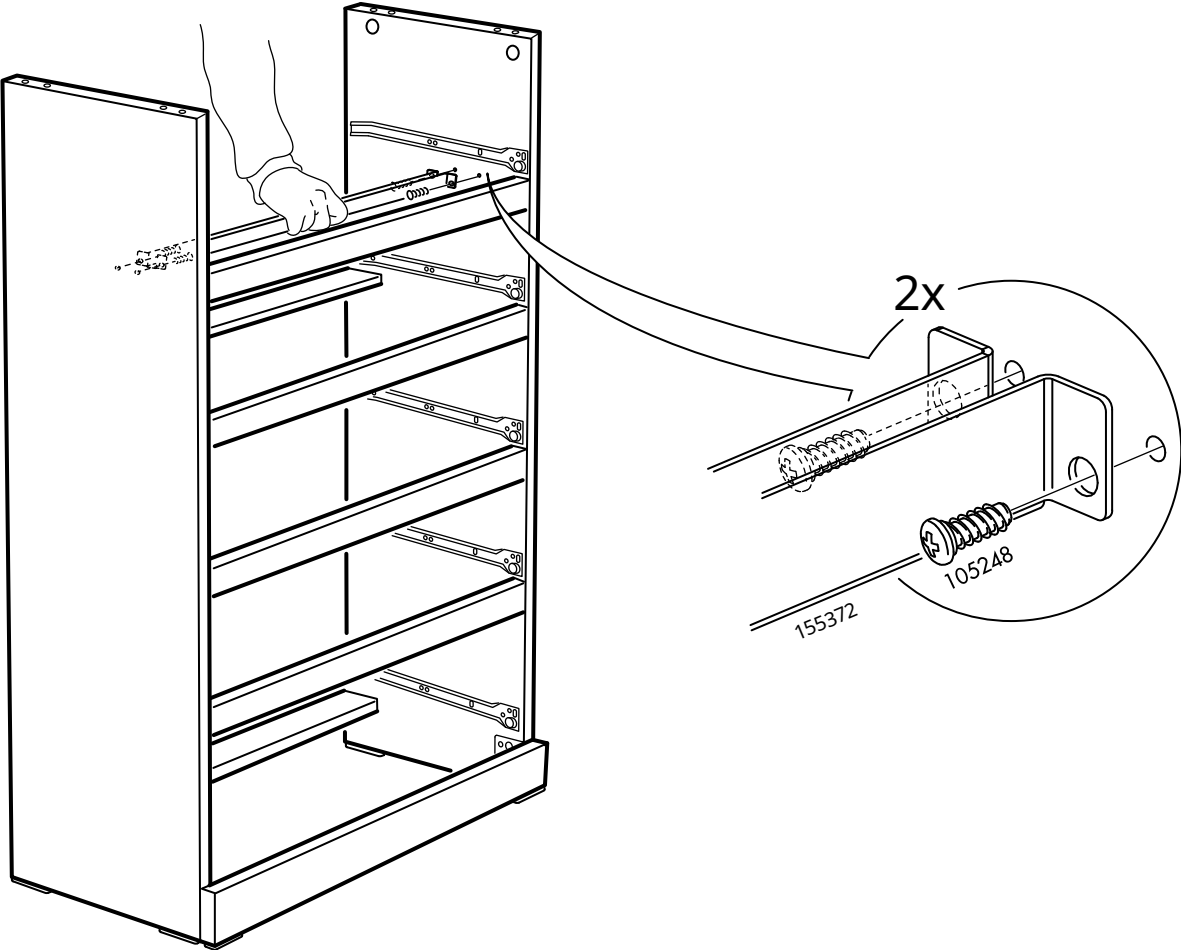

20

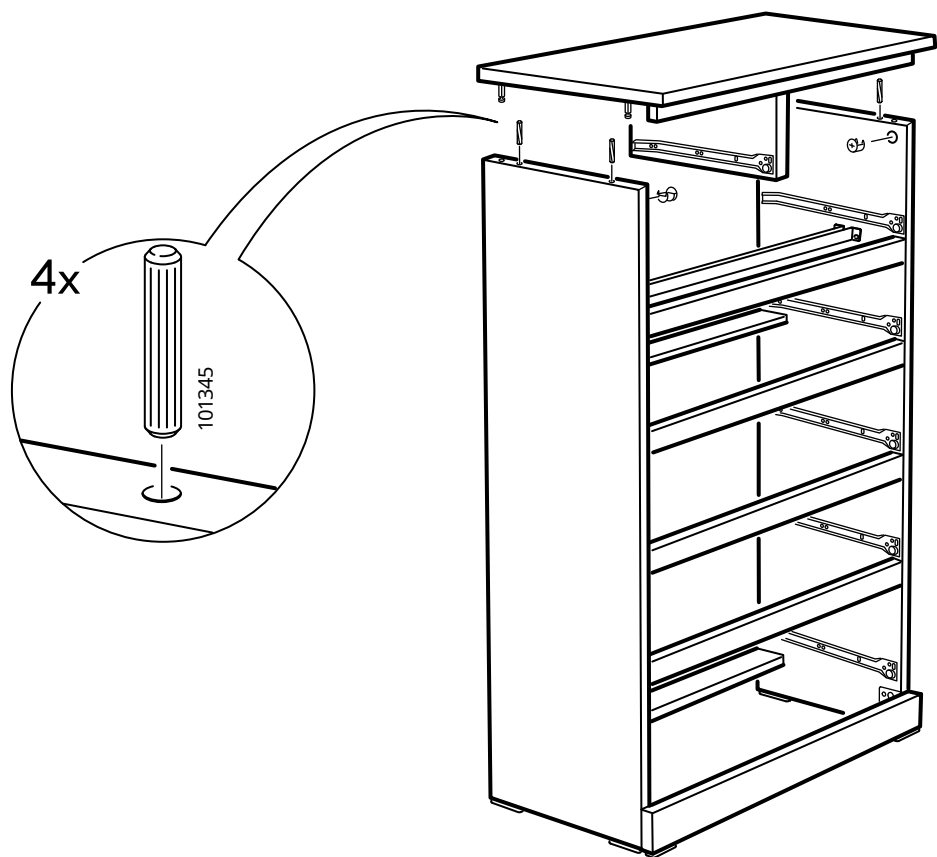

21

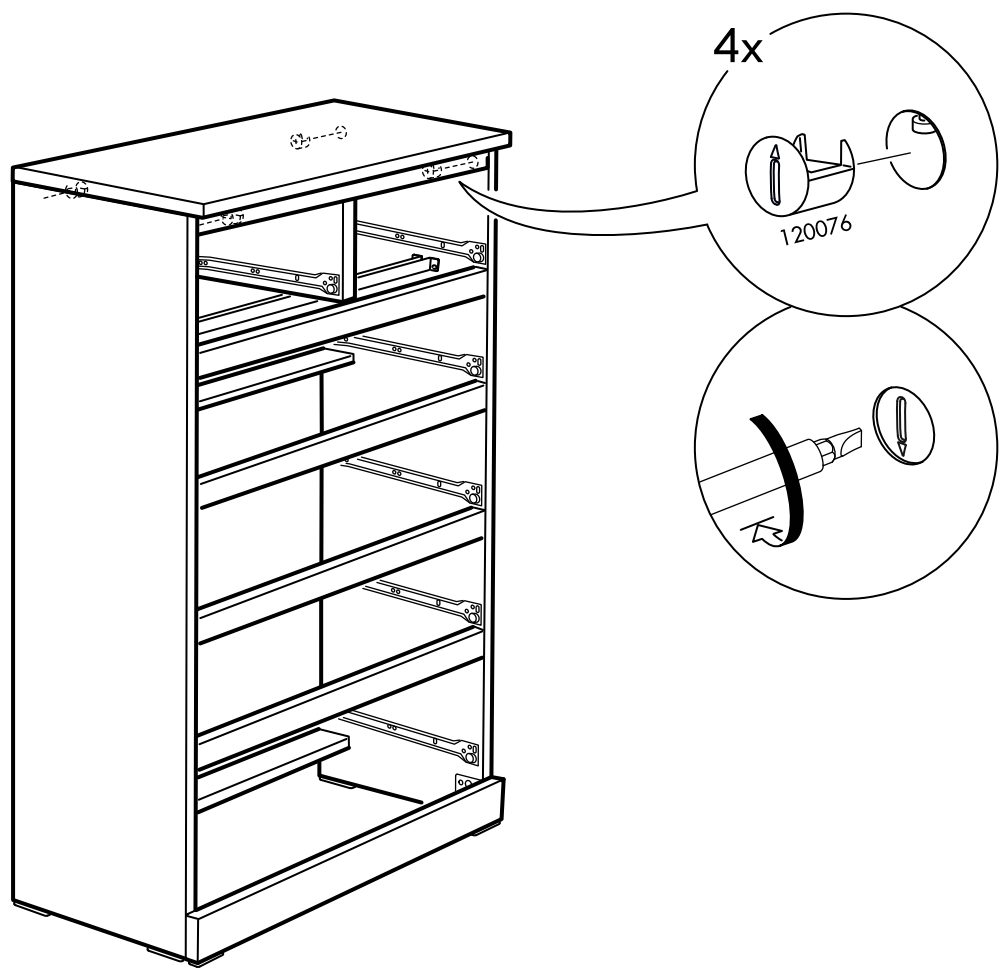

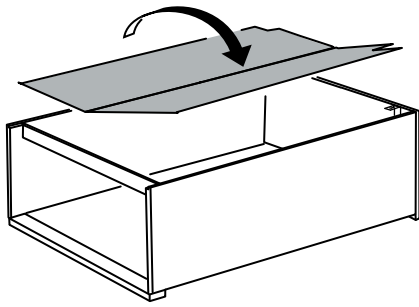

22

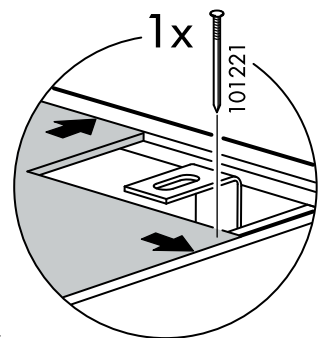
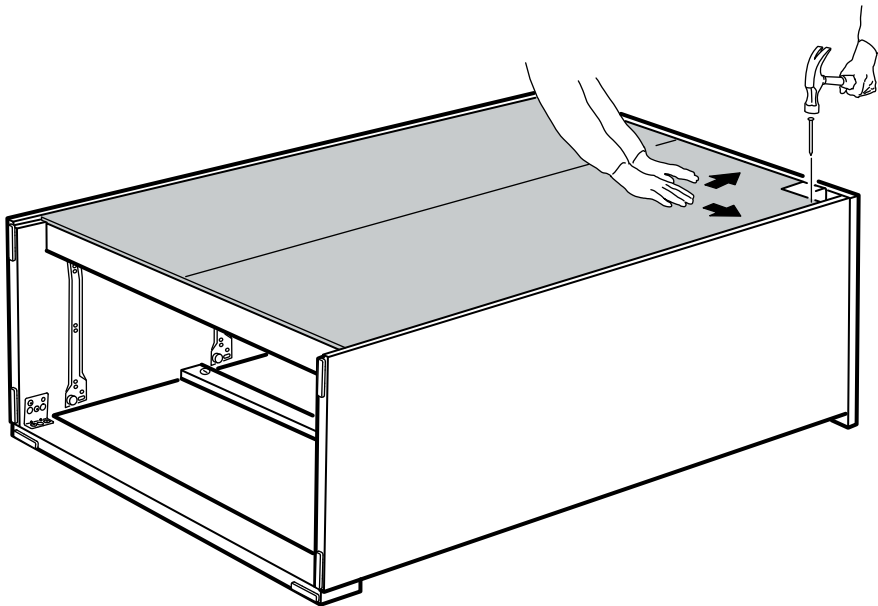

23

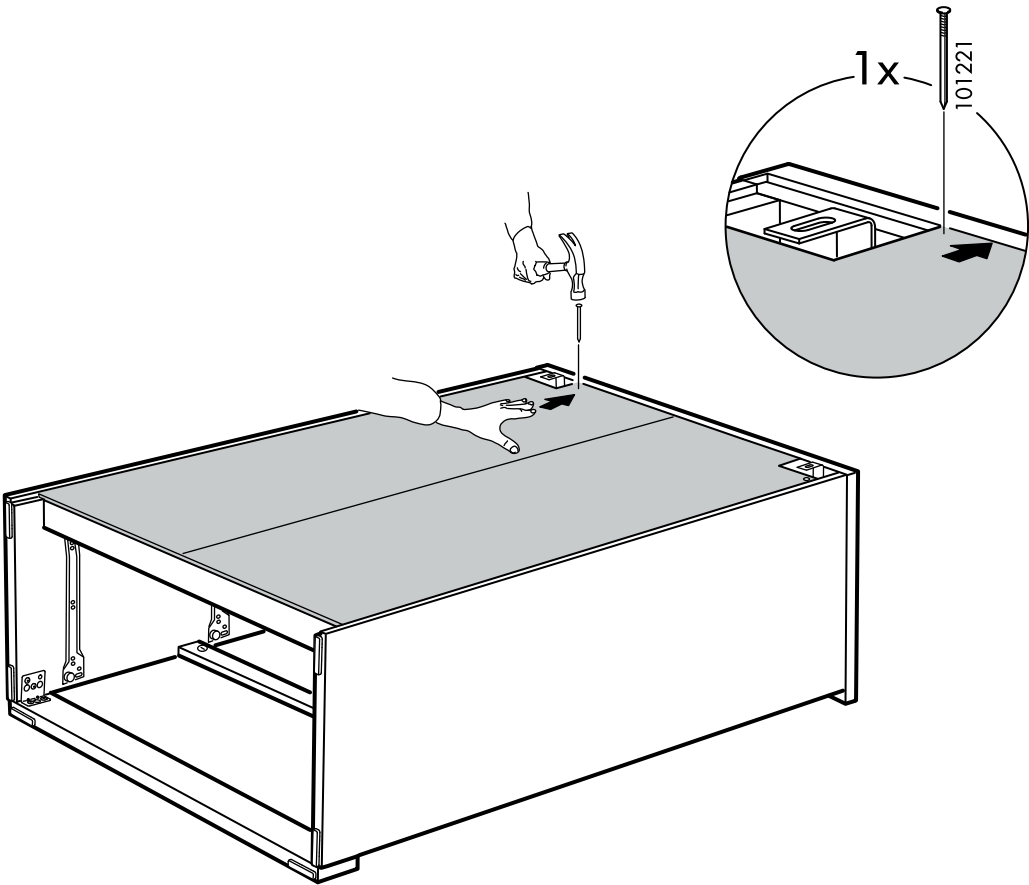

24

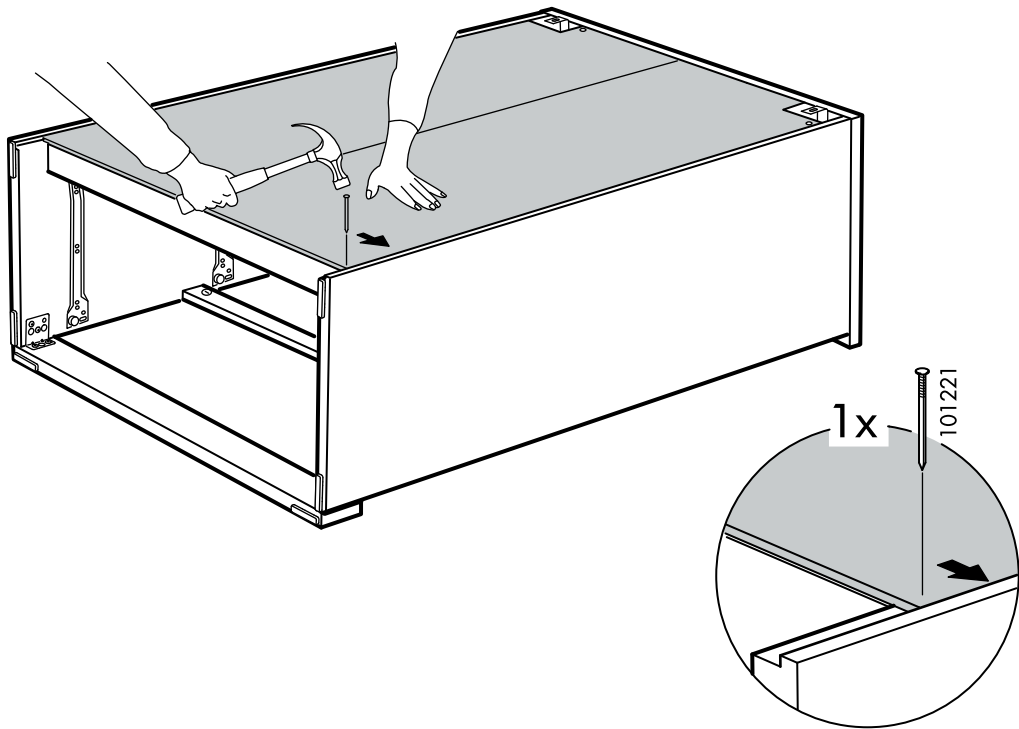

25

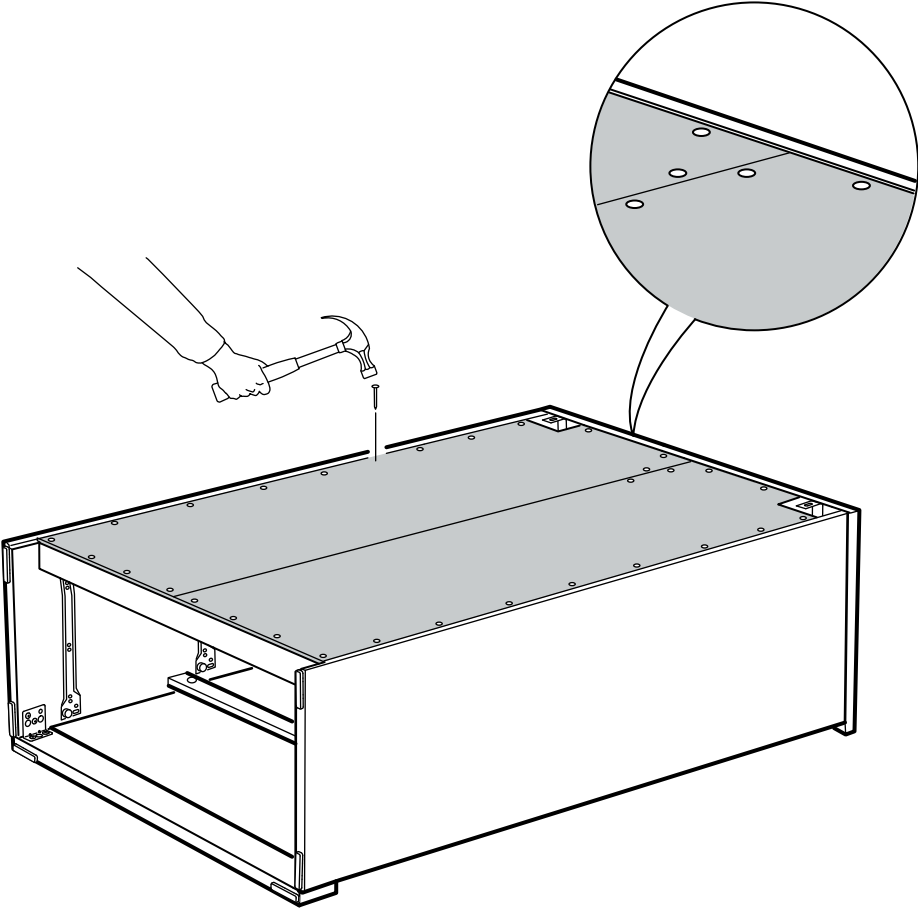
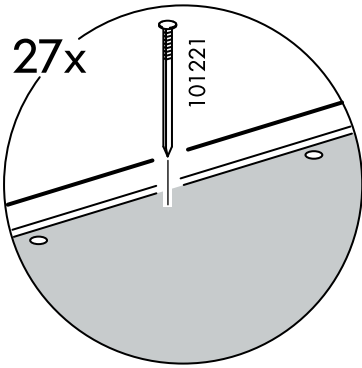

26

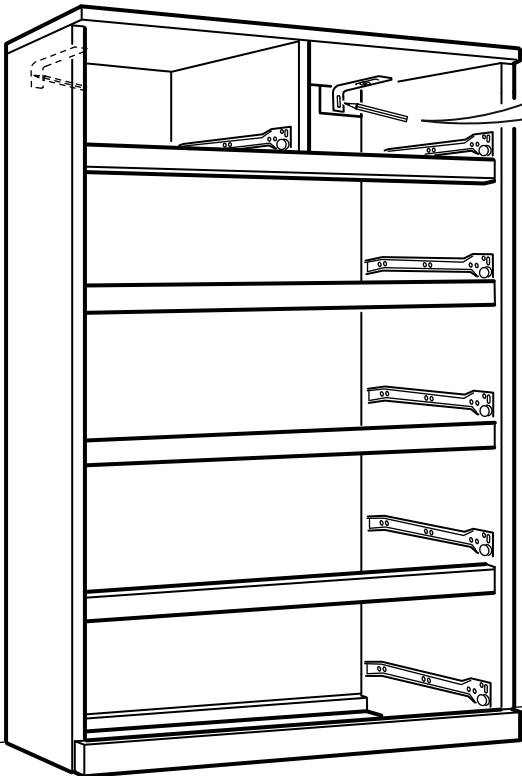
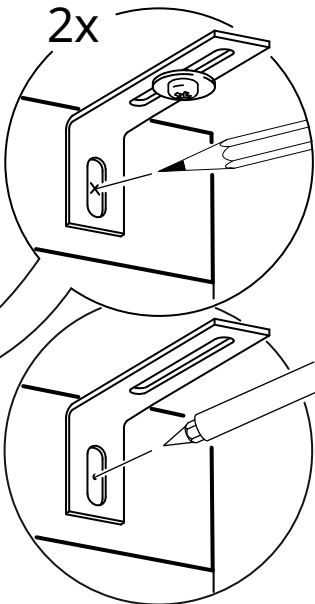
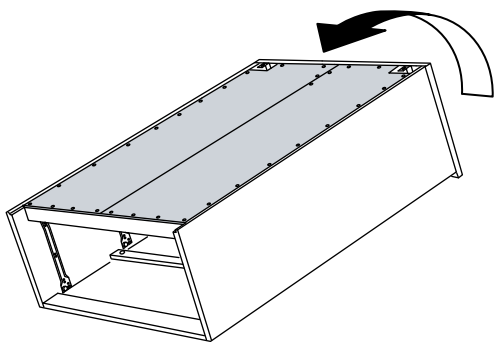

X

X

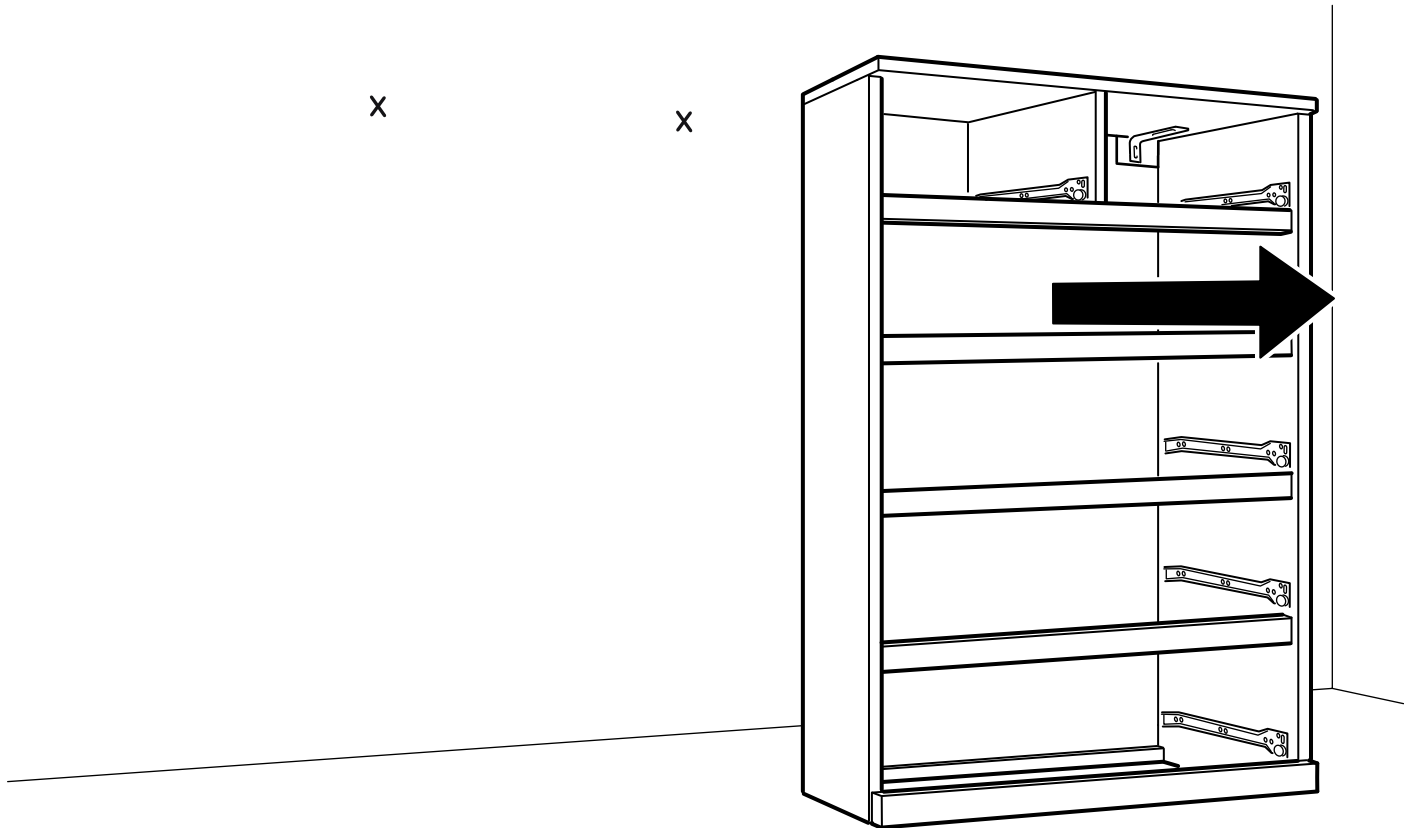

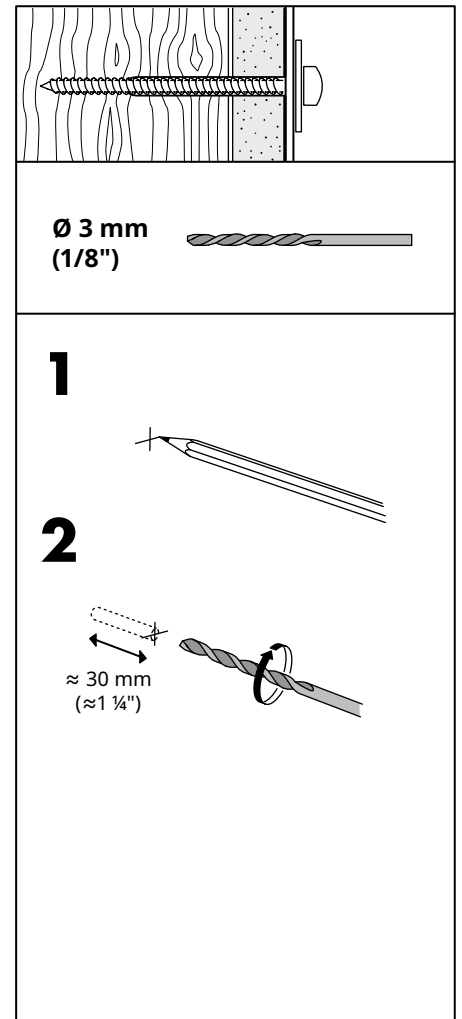
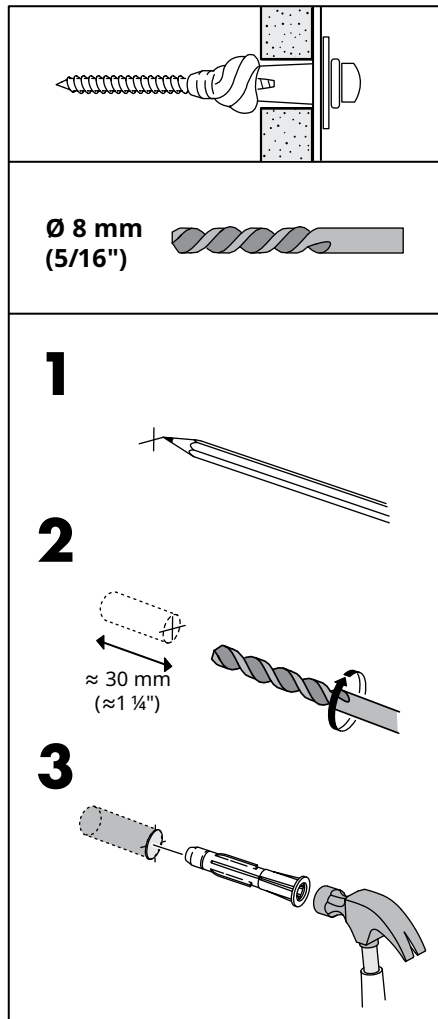
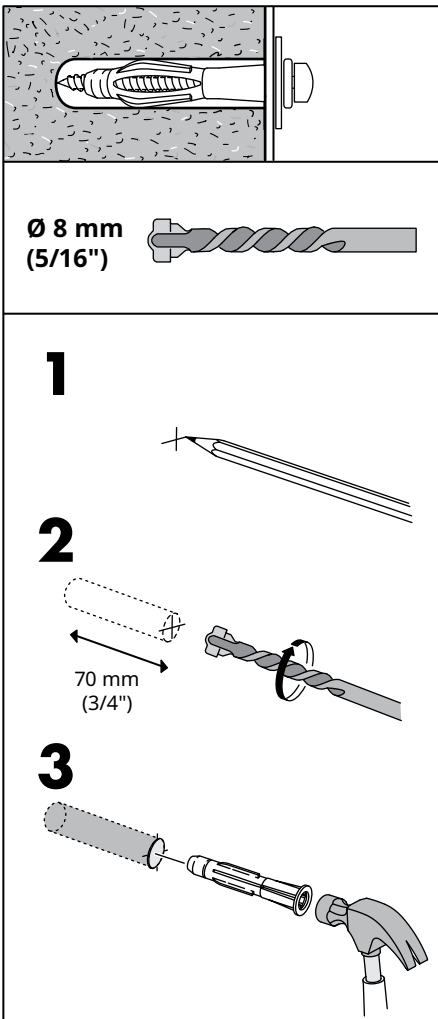
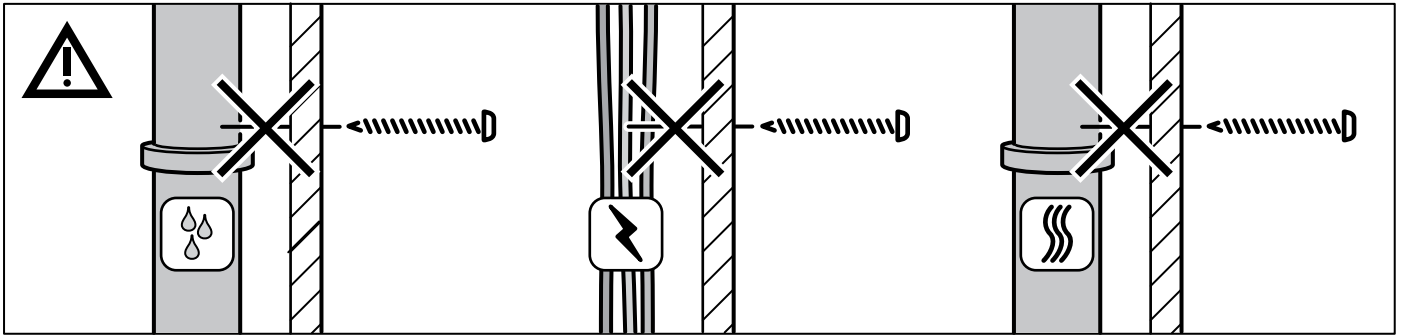
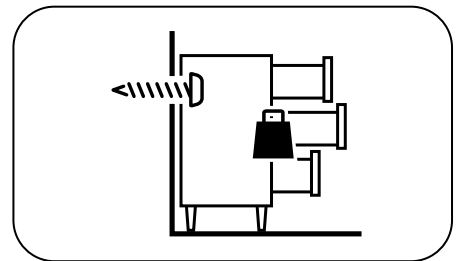

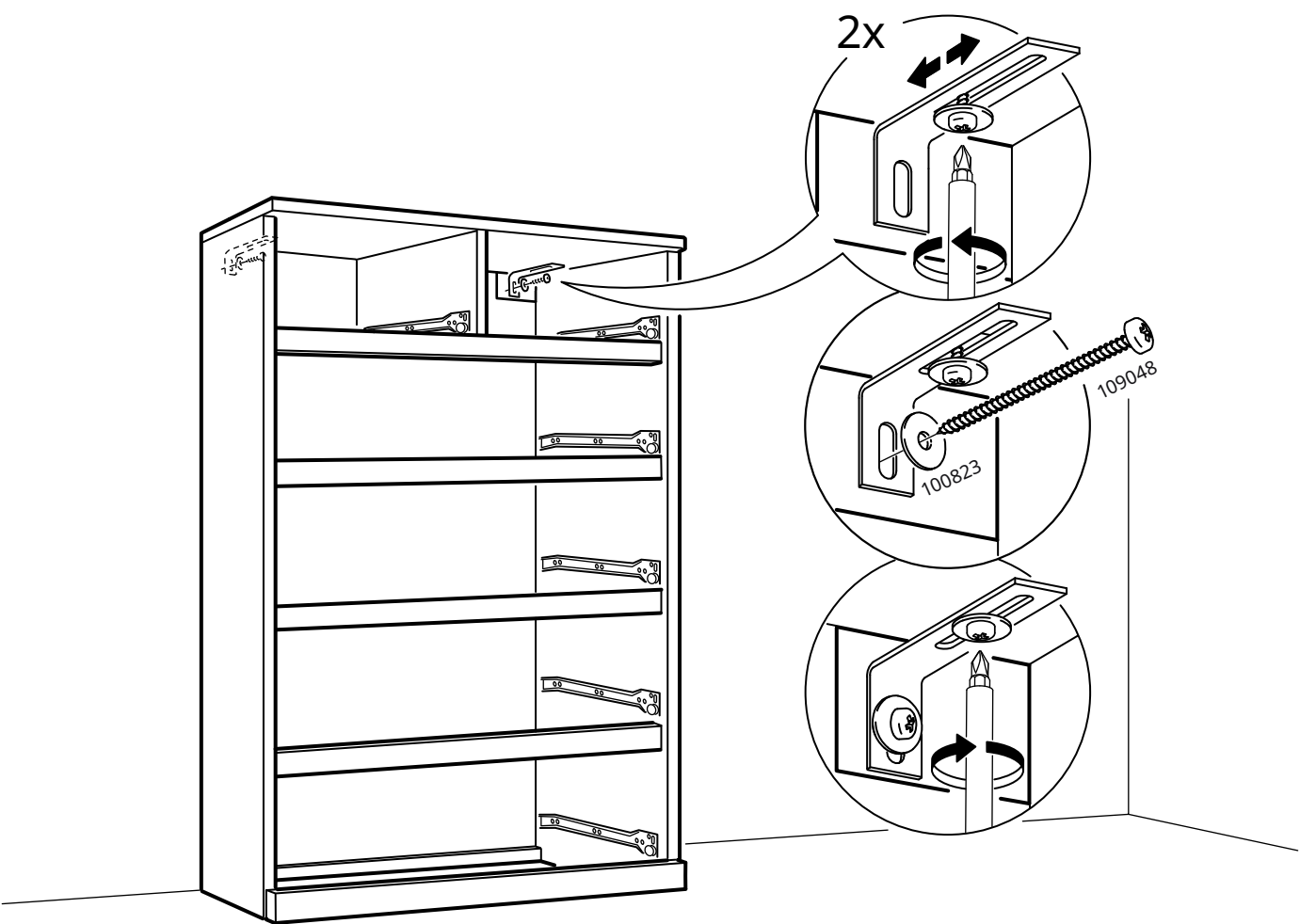

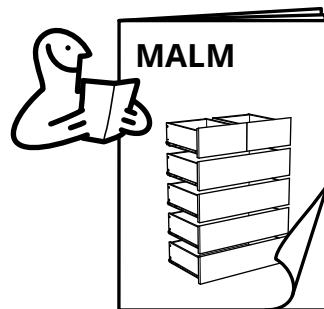
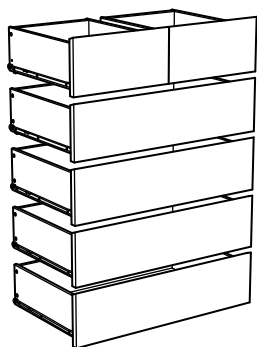

29

