

KILBERGET

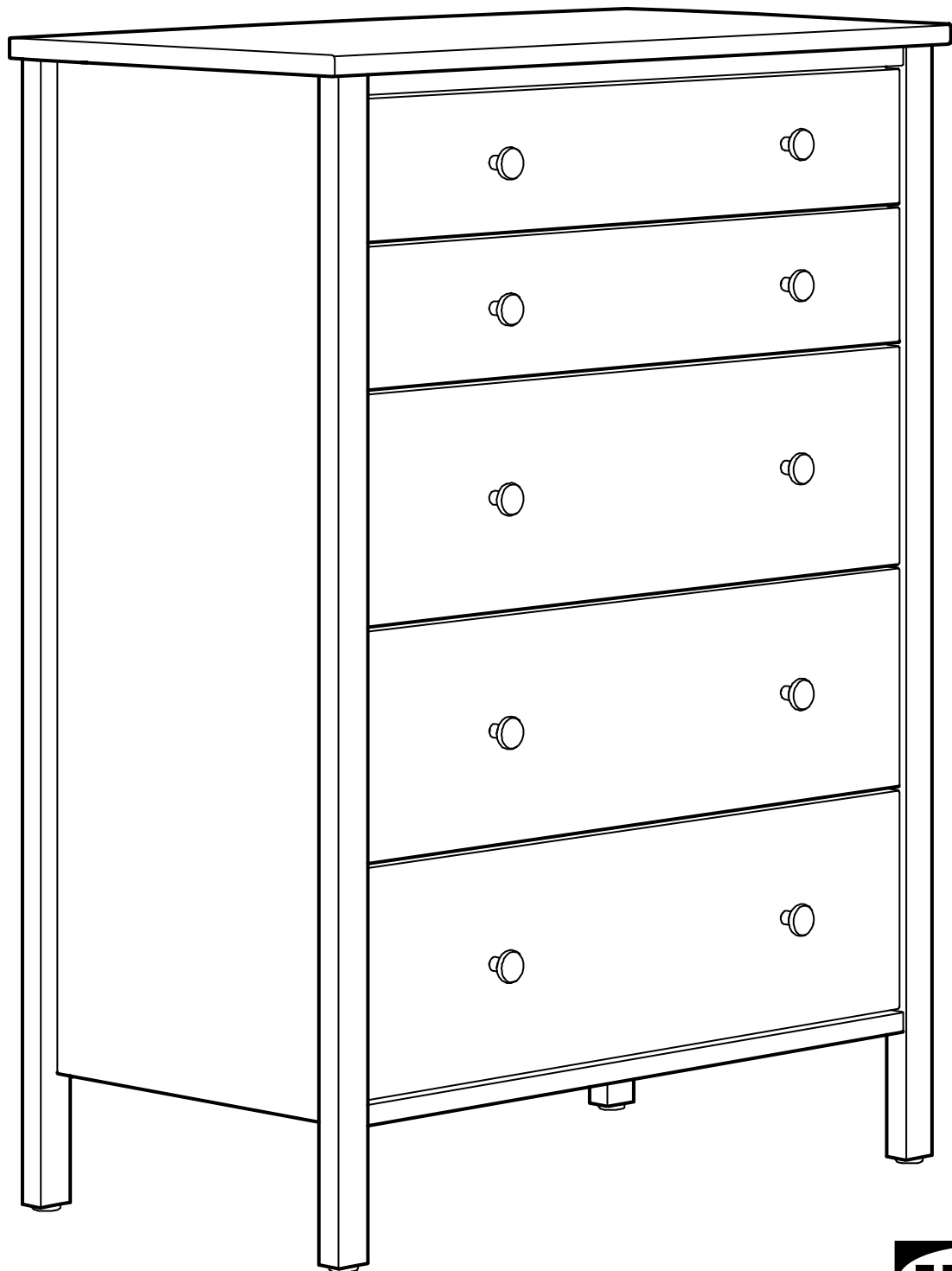

Design and Quality
IKEA of Sweden

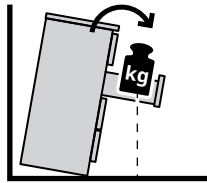
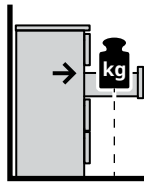
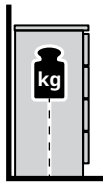

English

WARNING

Children have died from furniture tipover. To reduce the risk of furniture tipover:

ALWAYS install anti-tip device provided.

NEVER put a TV on this product.

NEVER allow children to stand, climb, or hang on any drawers, doors, or shelves.

NEVER open more than one drawer at a time.

DO NOT defeat or remove the drawer interlock system; it is an important stability and safety system.

Place heaviest items in the lowest drawers.

English

Read and follow each step of the instruction carefully.

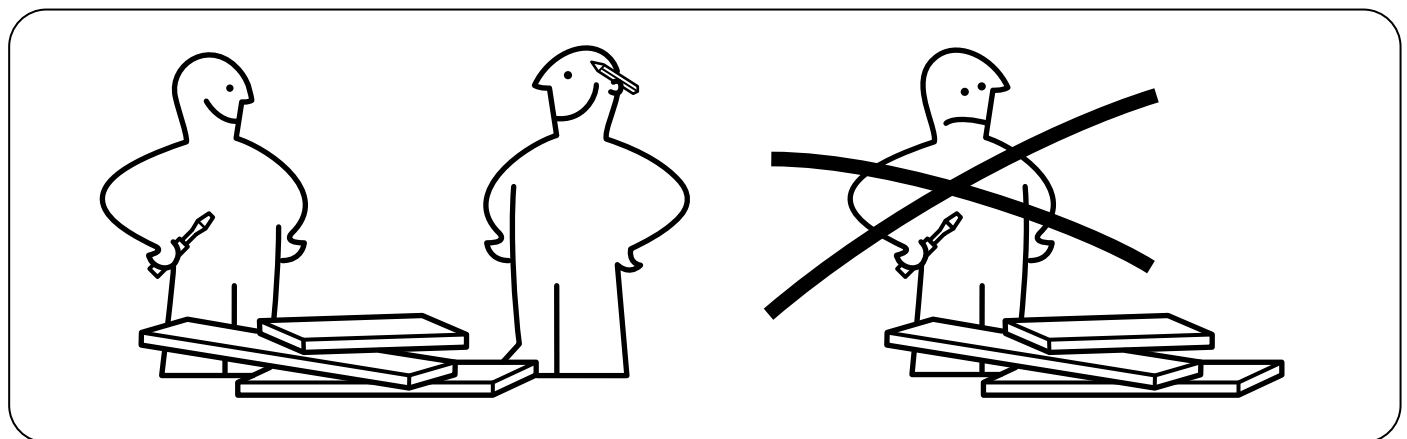
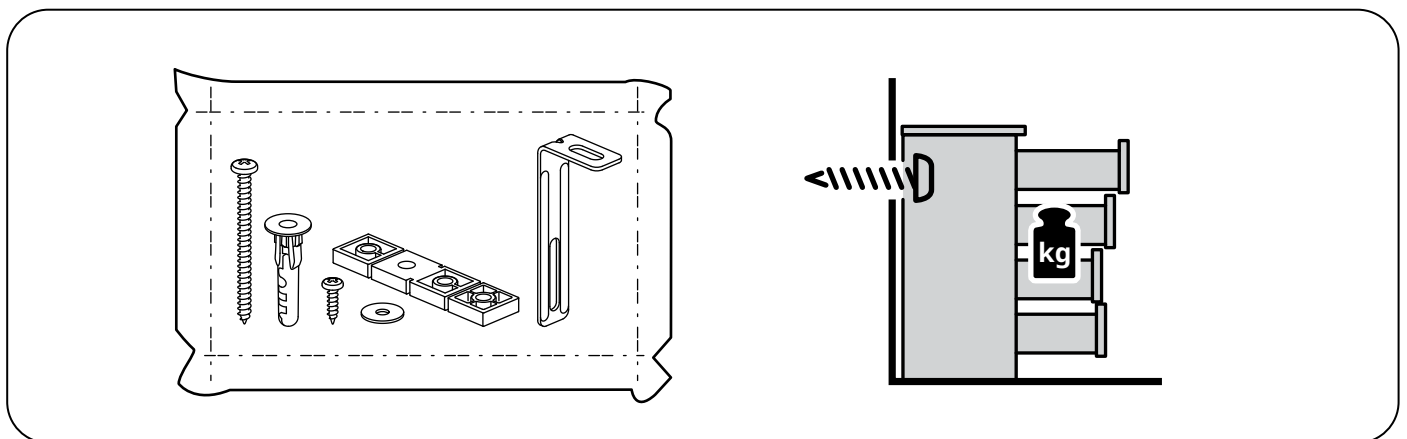
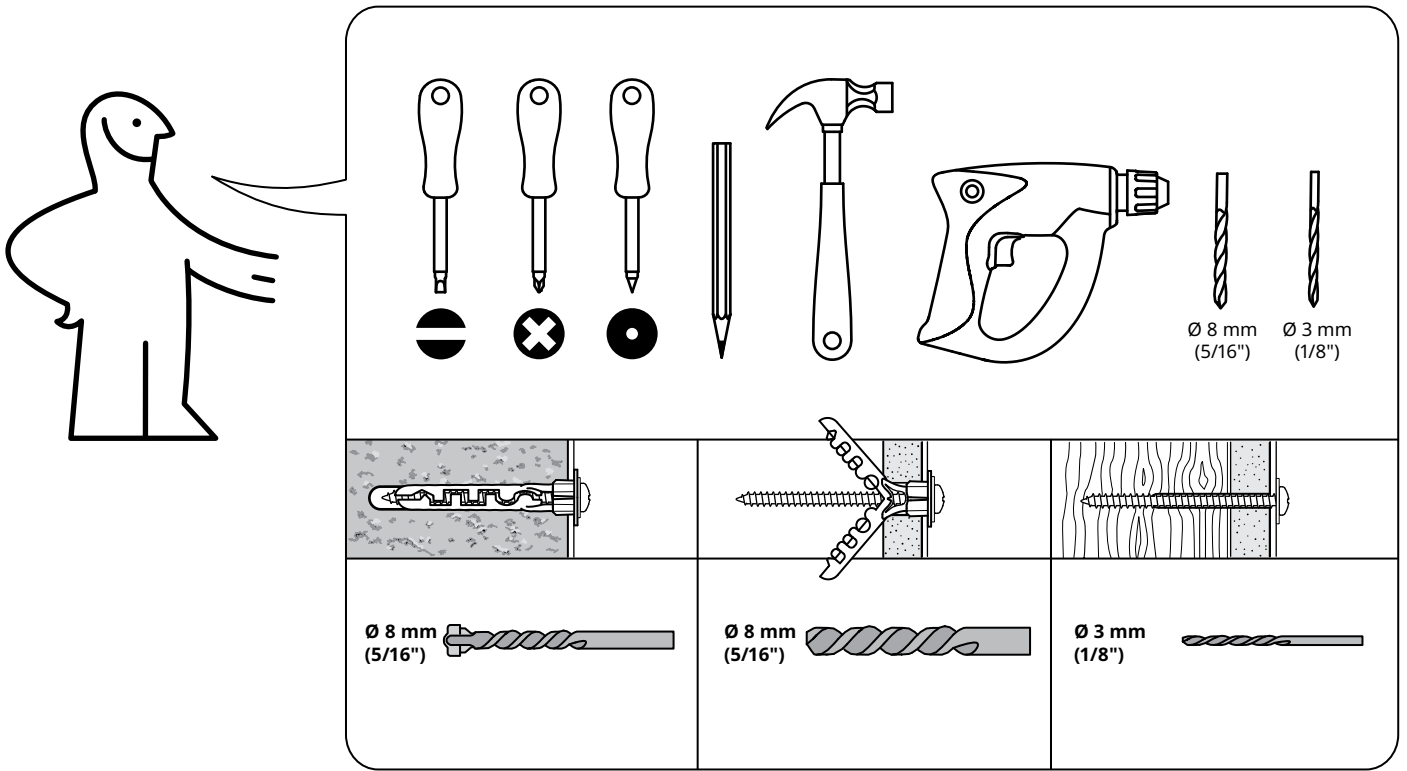

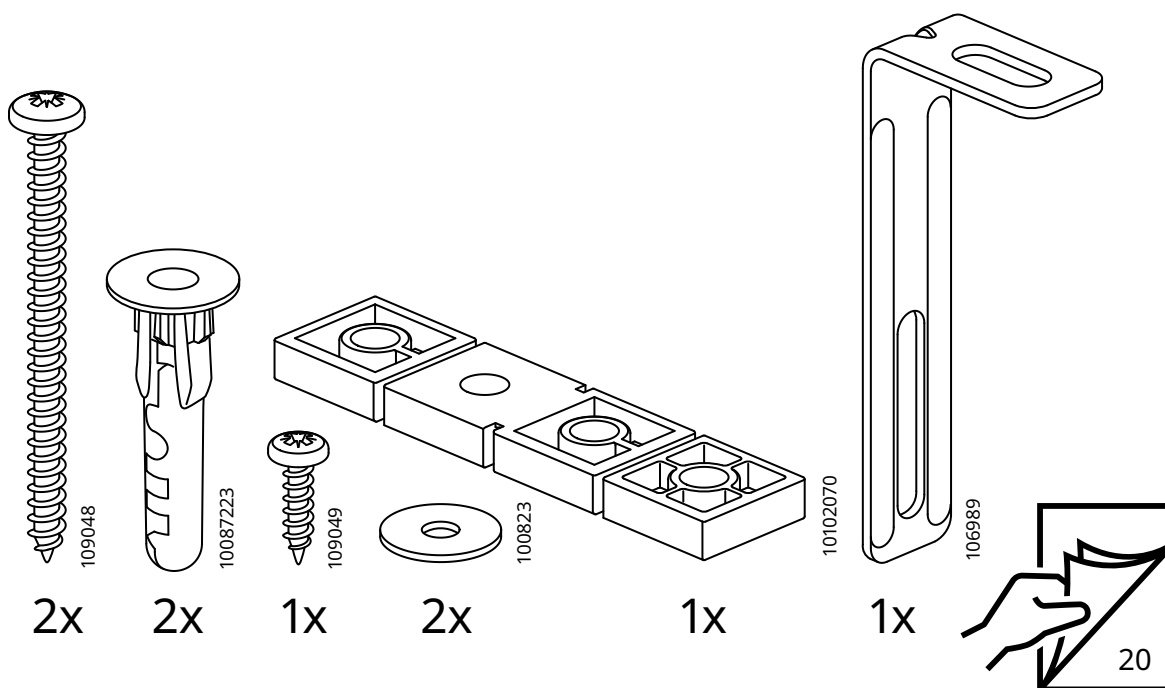
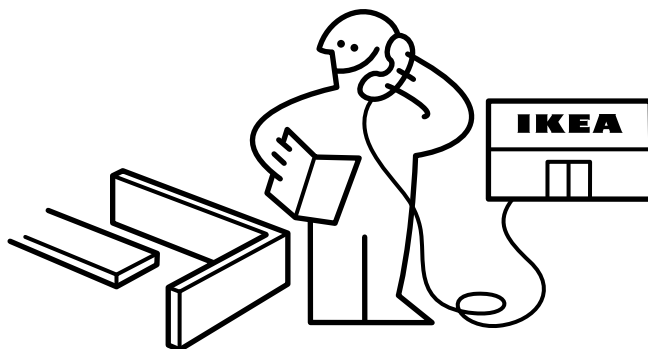
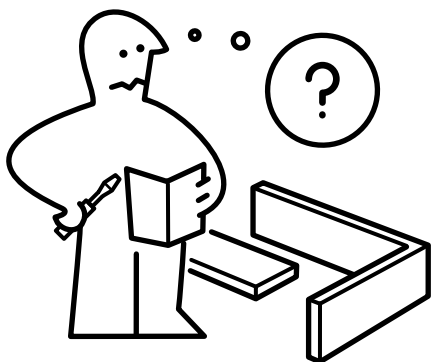
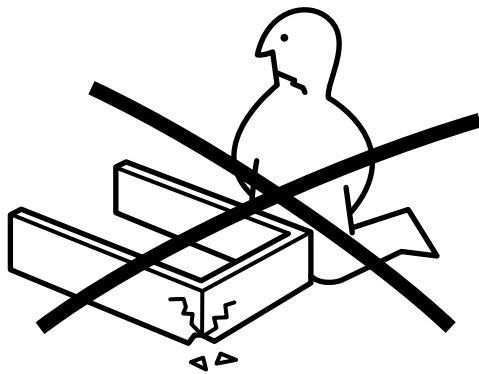
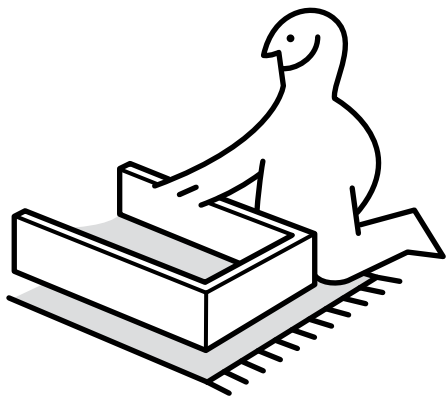

370173

1

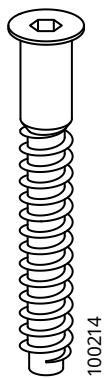

10x

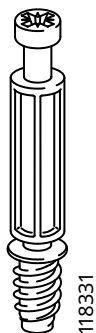

26x

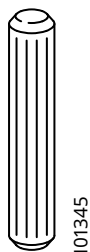

40x



4x



30x

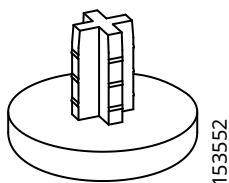

4x

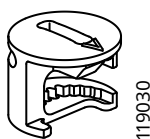

26x

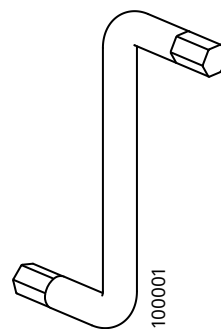

1x

2

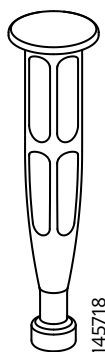

16x

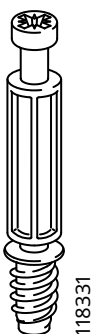

16x



10x

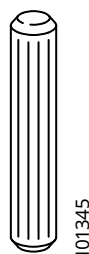

10x

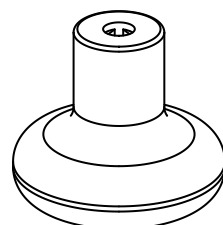

10x

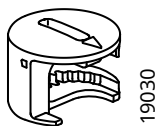

32x



30x

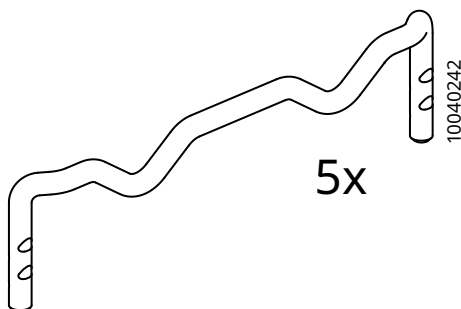

5x

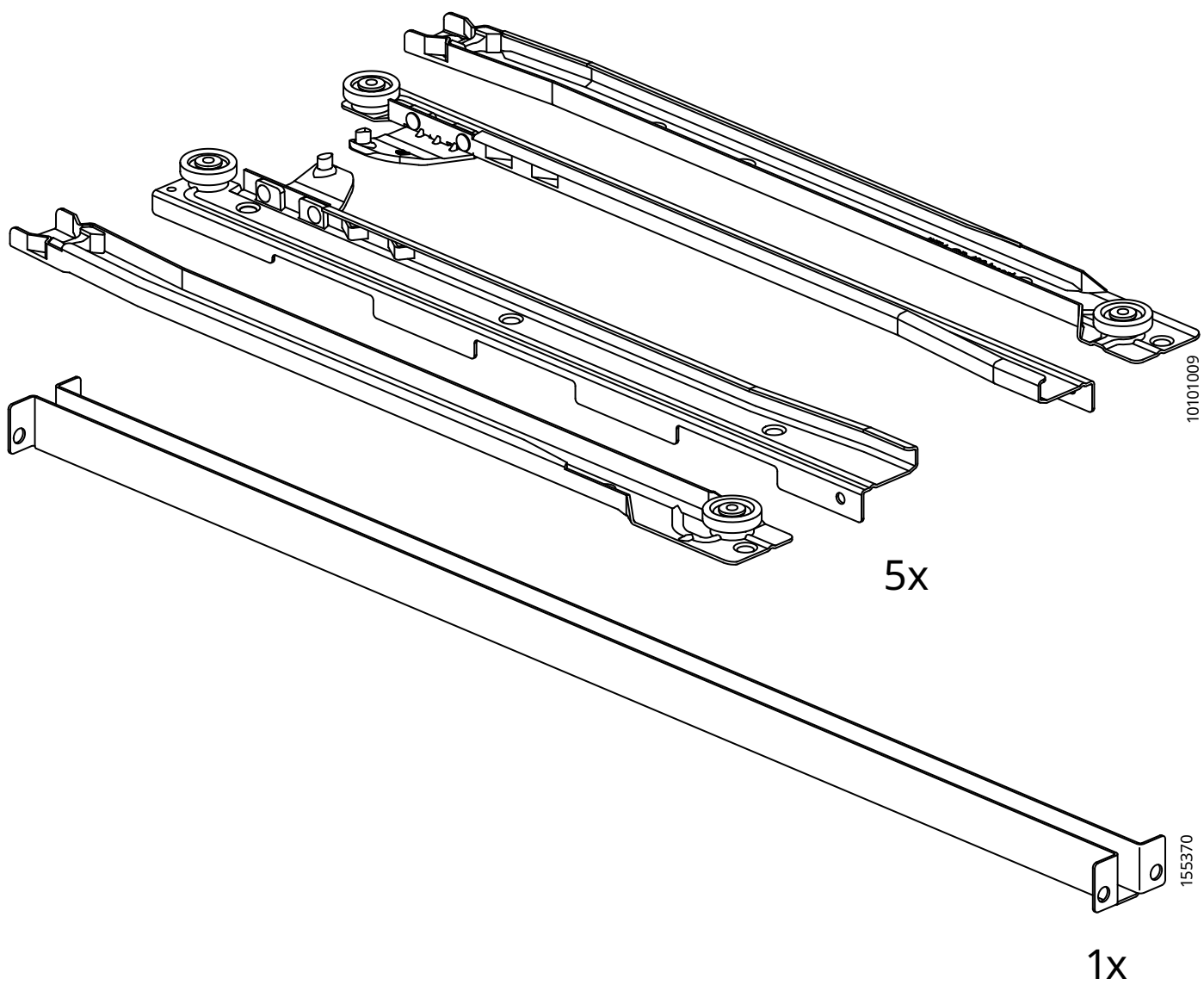

1

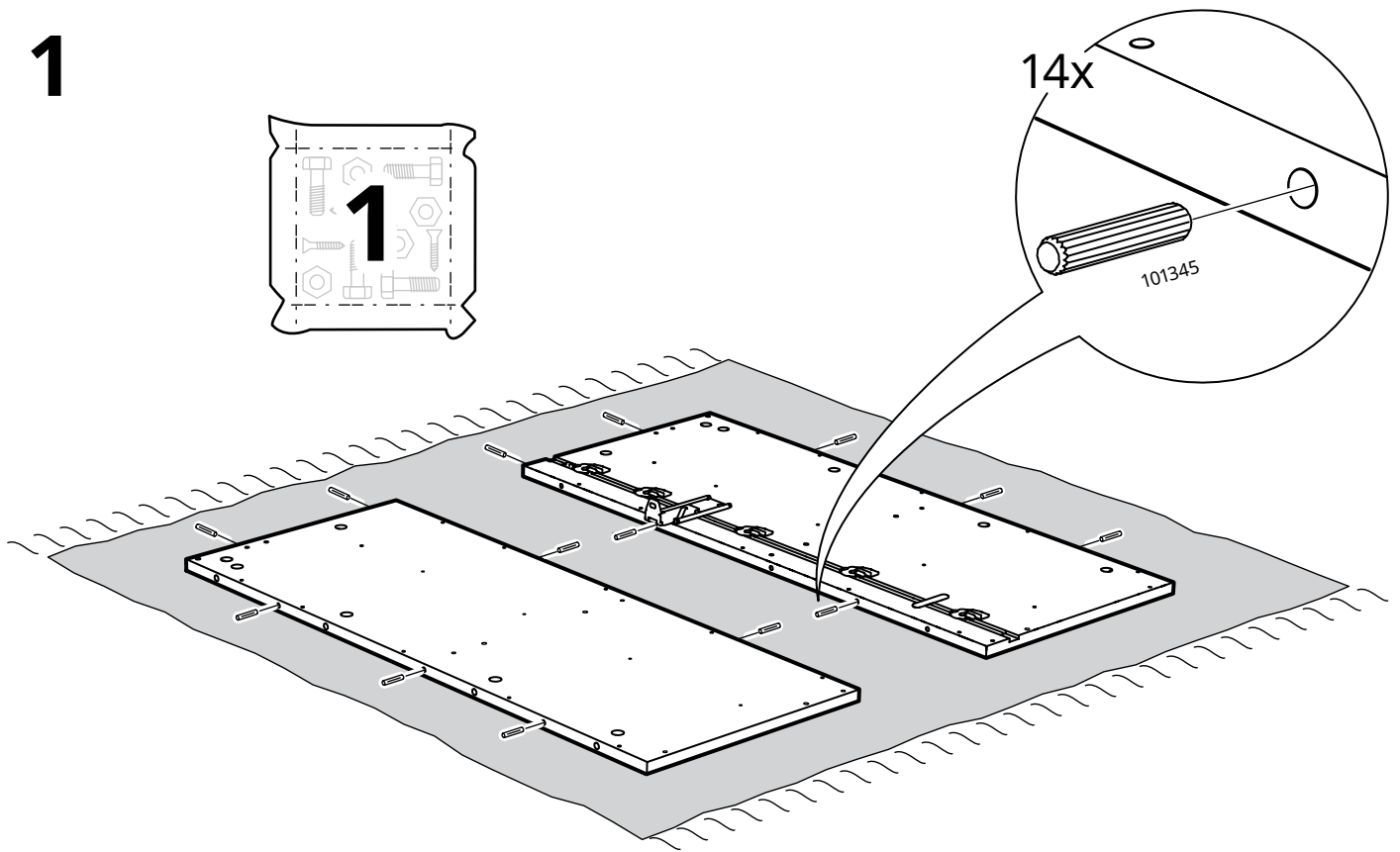

2

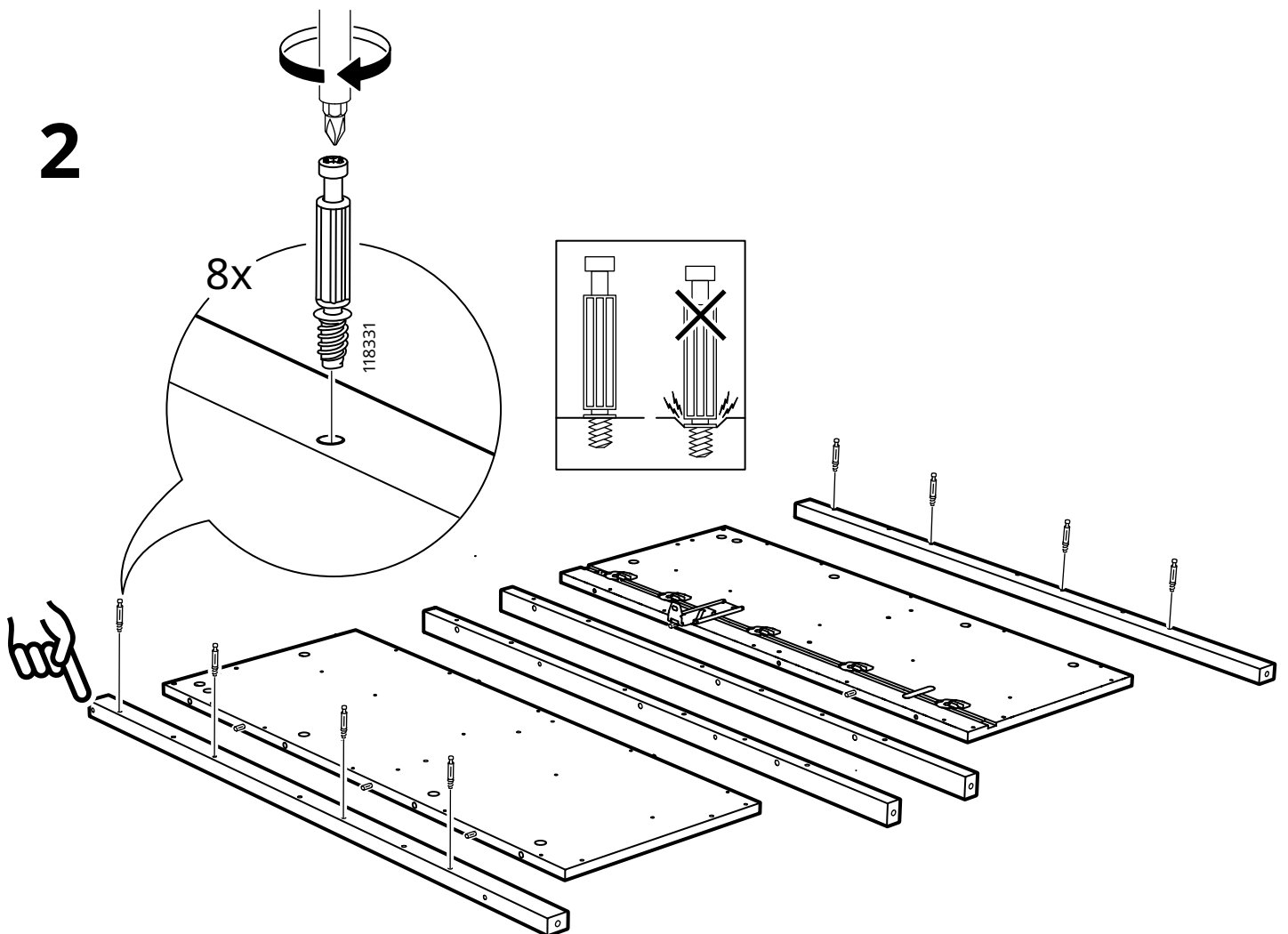

3

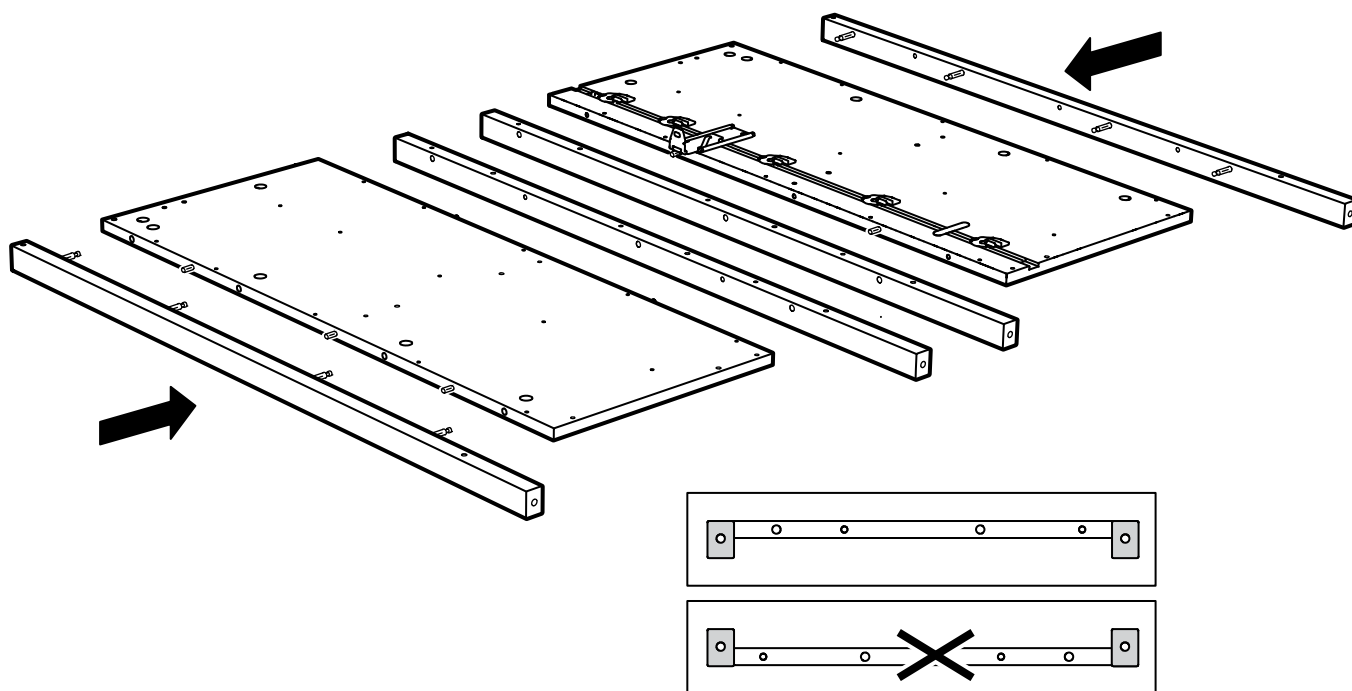

4

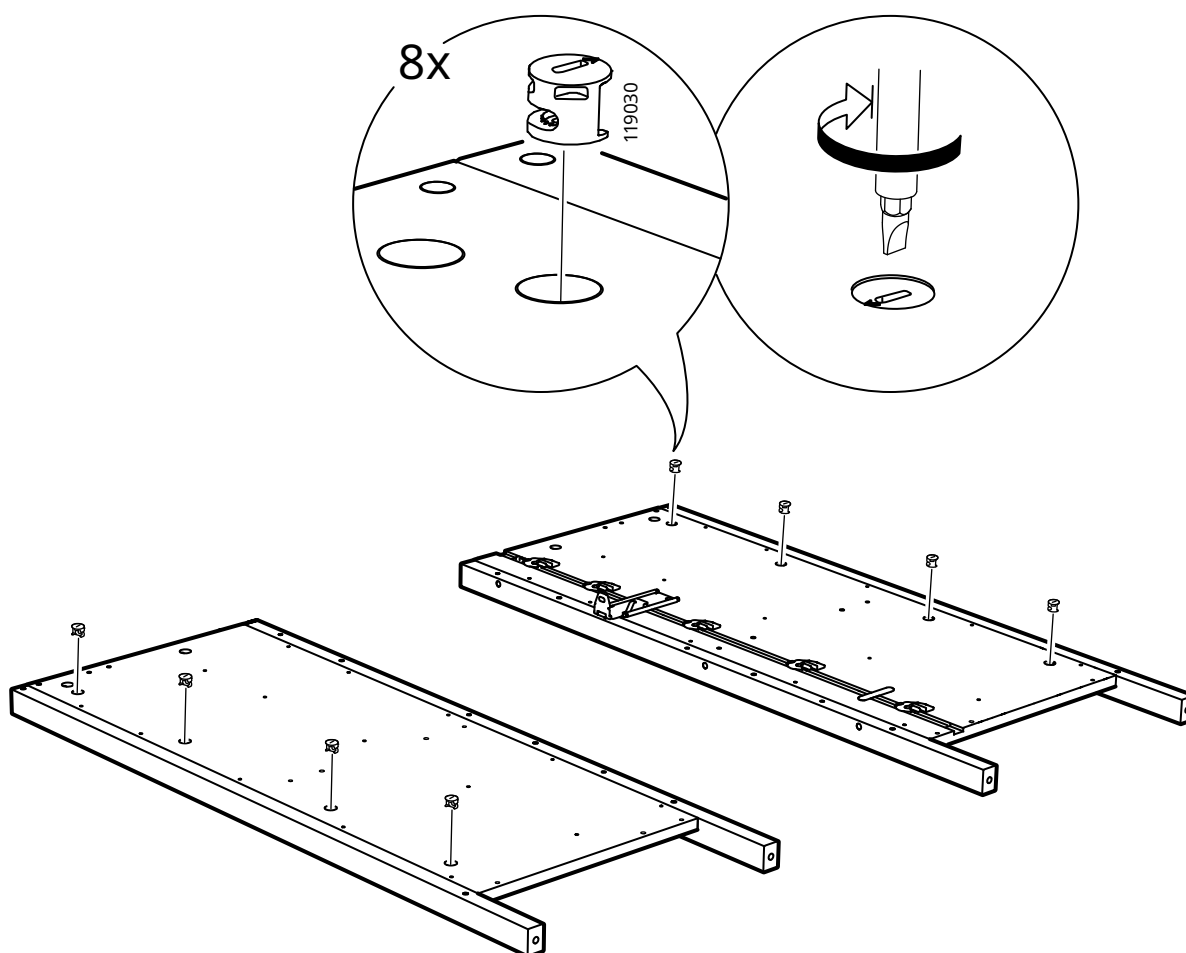

5

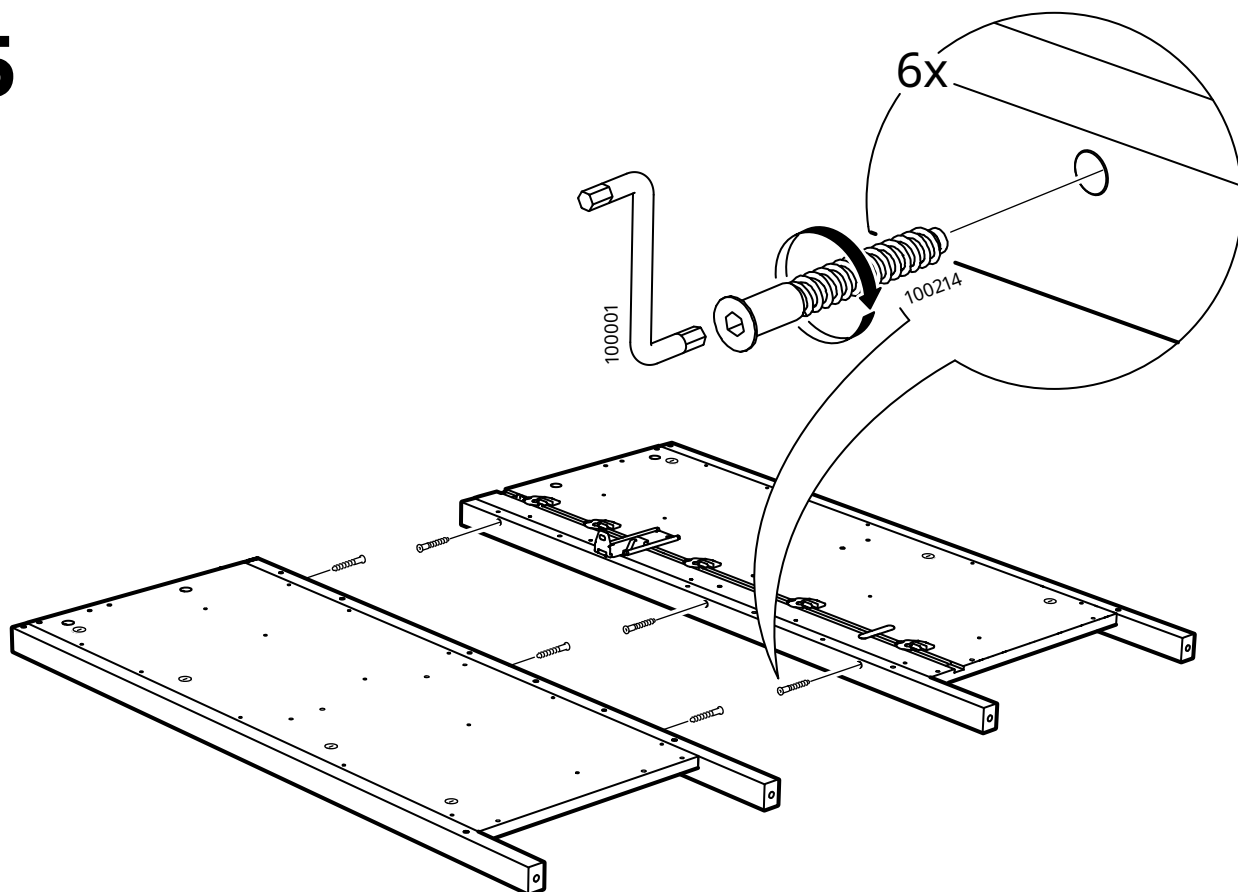

6

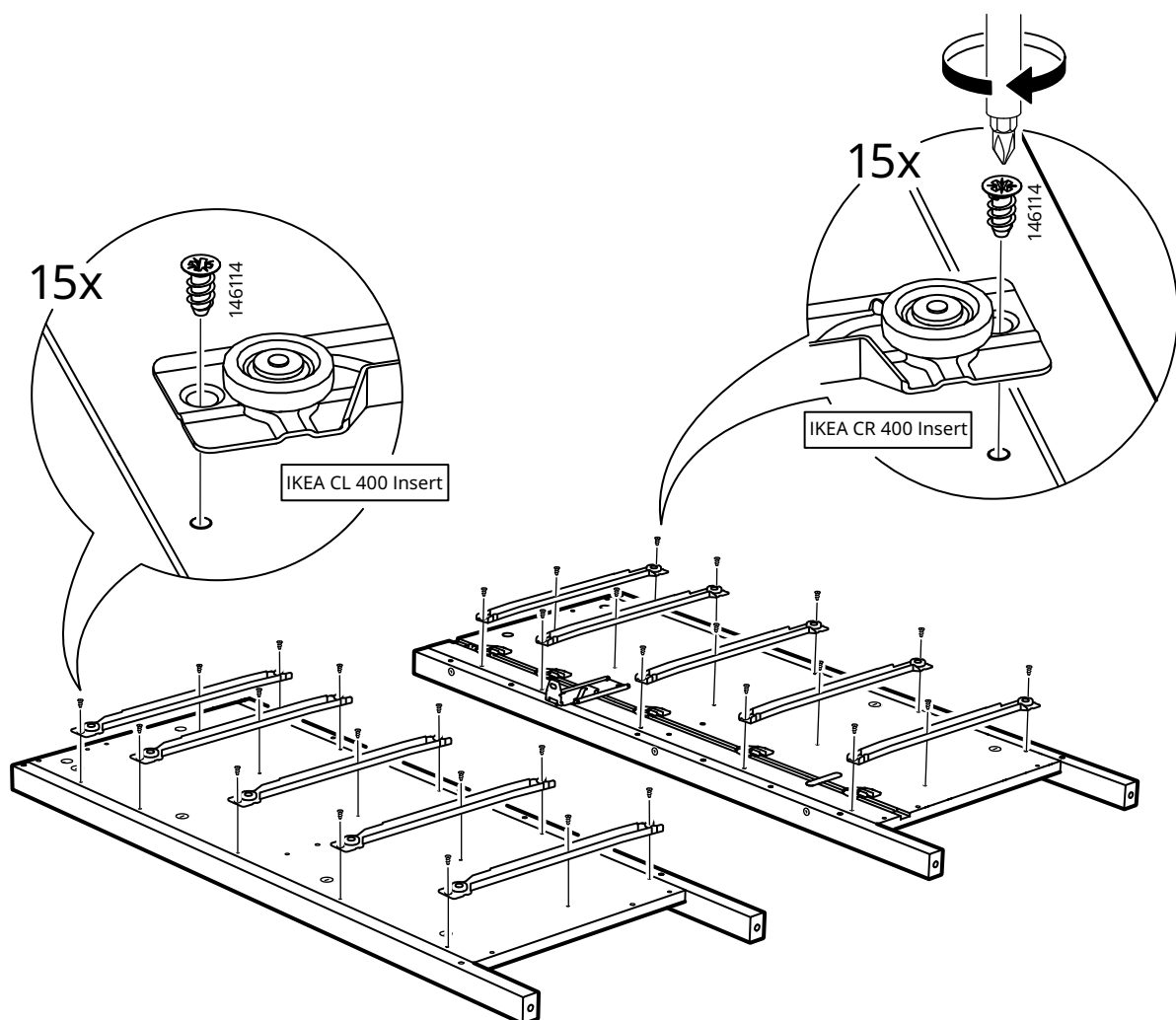

7

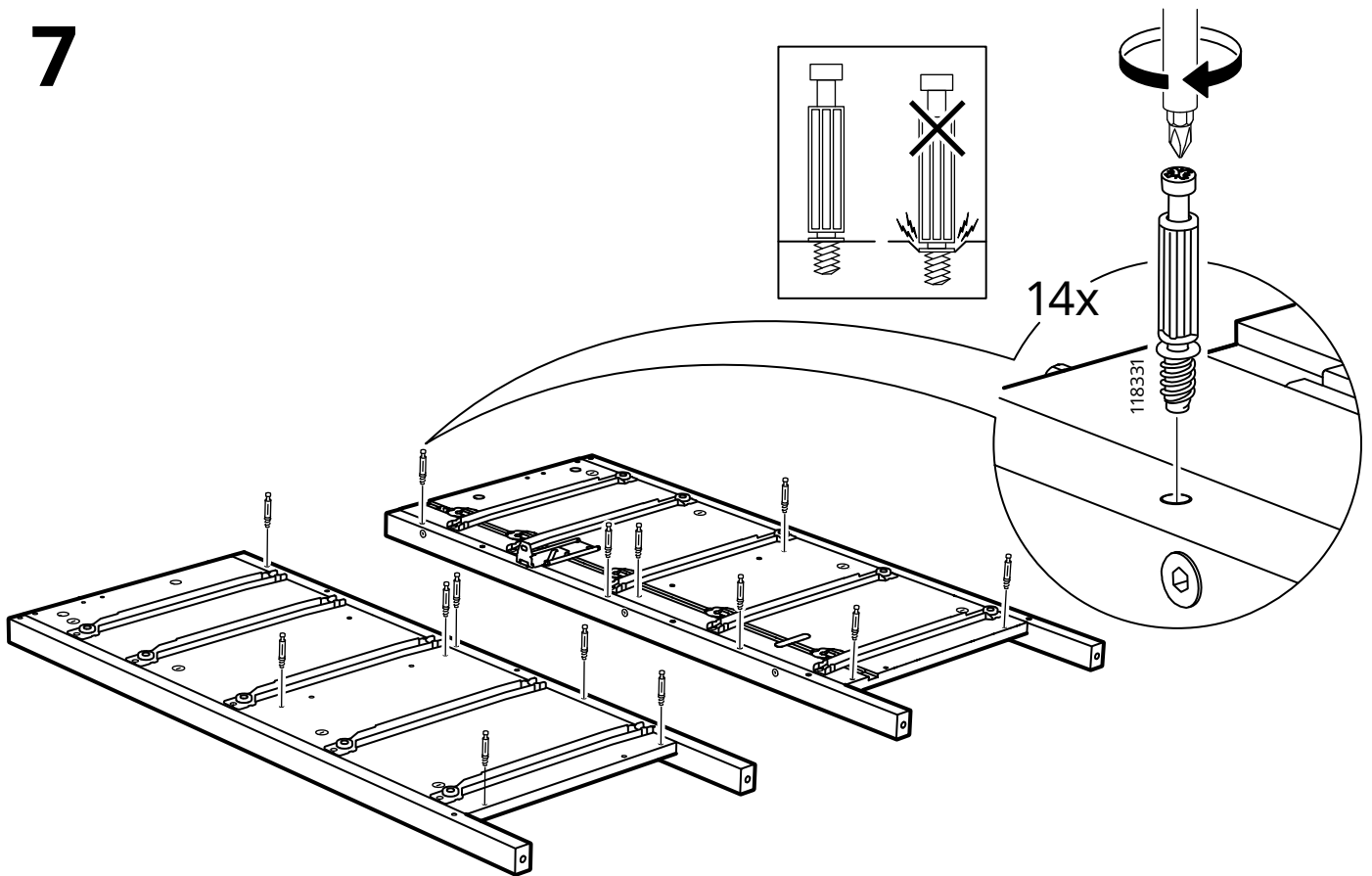

8

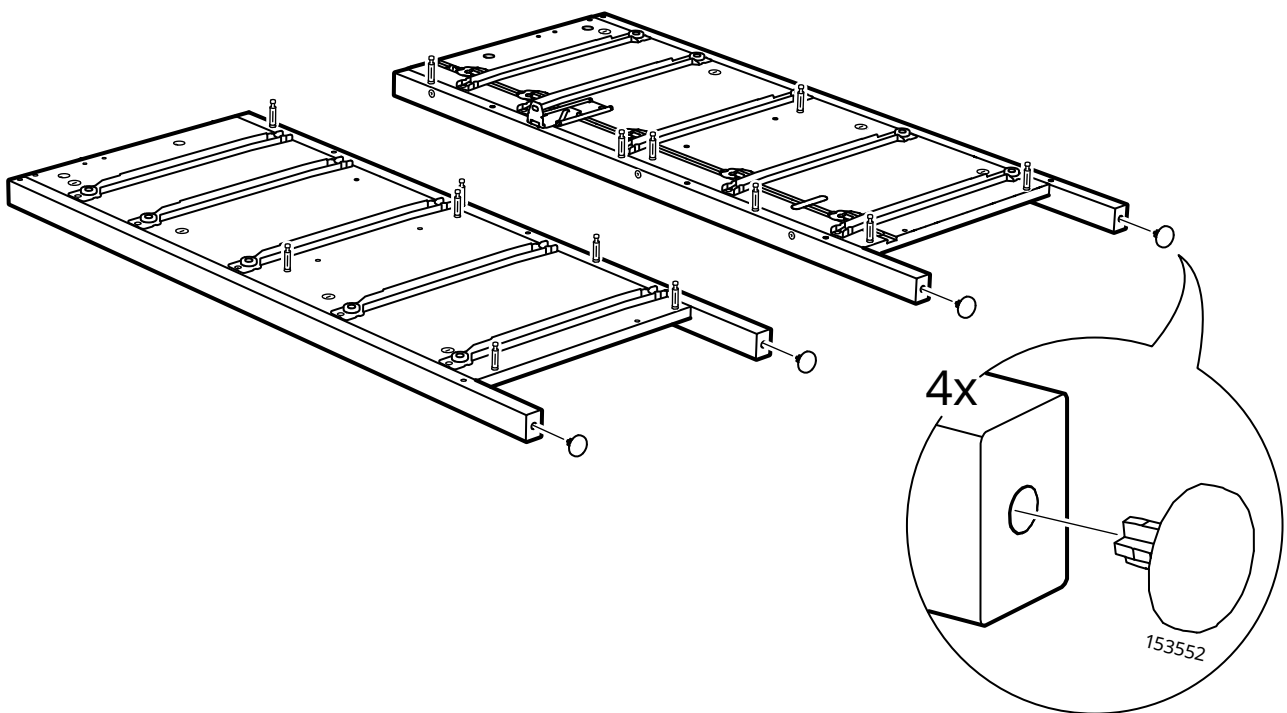

9

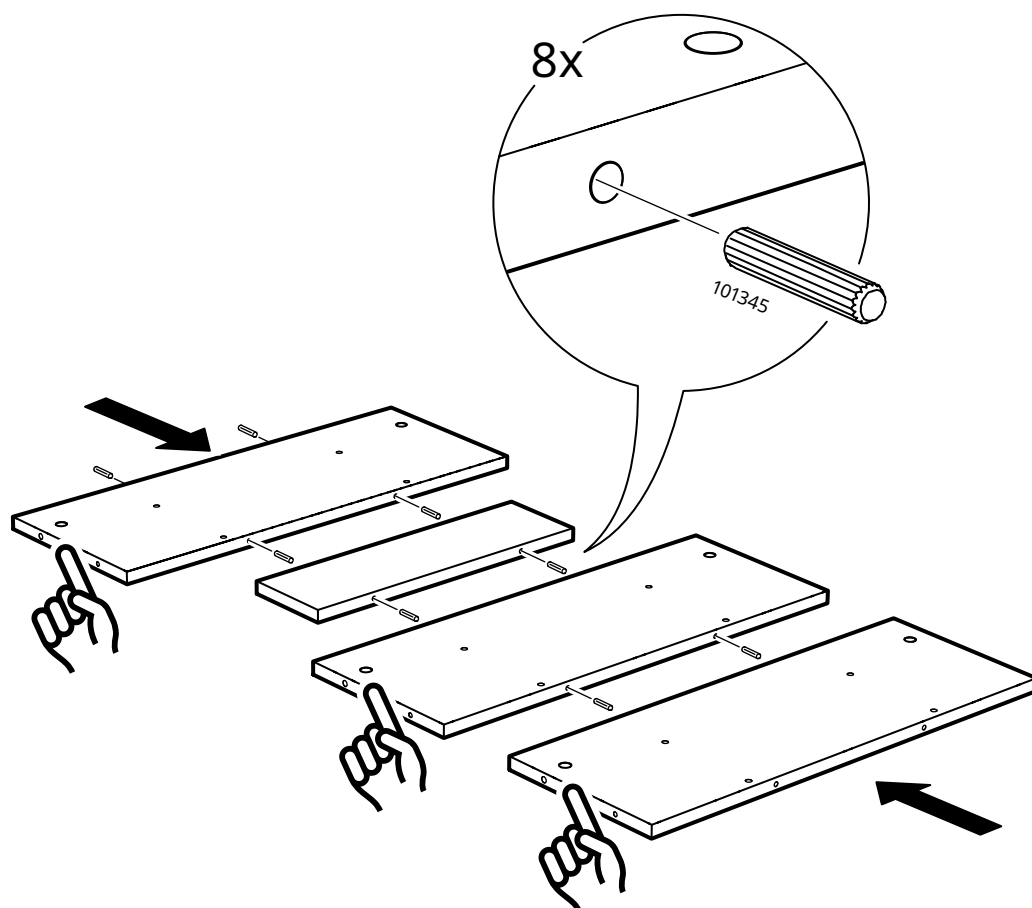

10

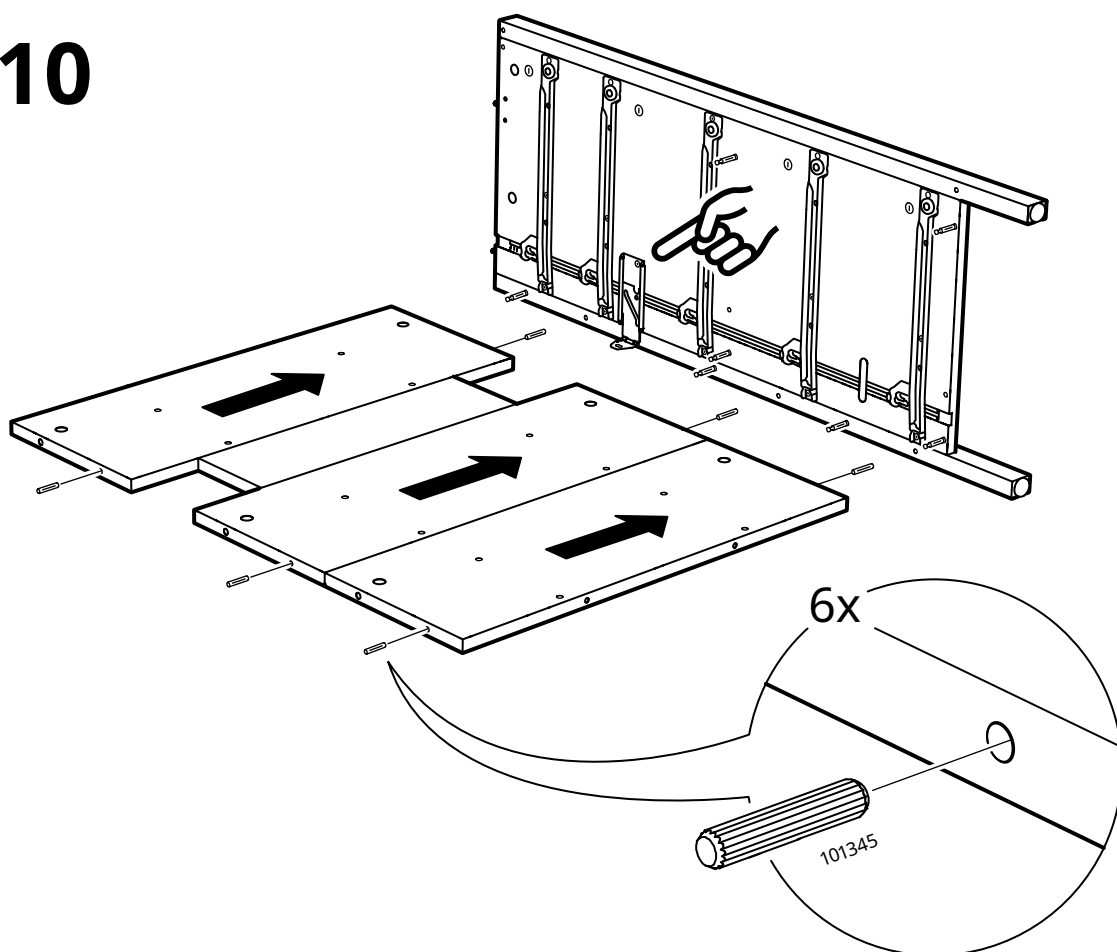

11

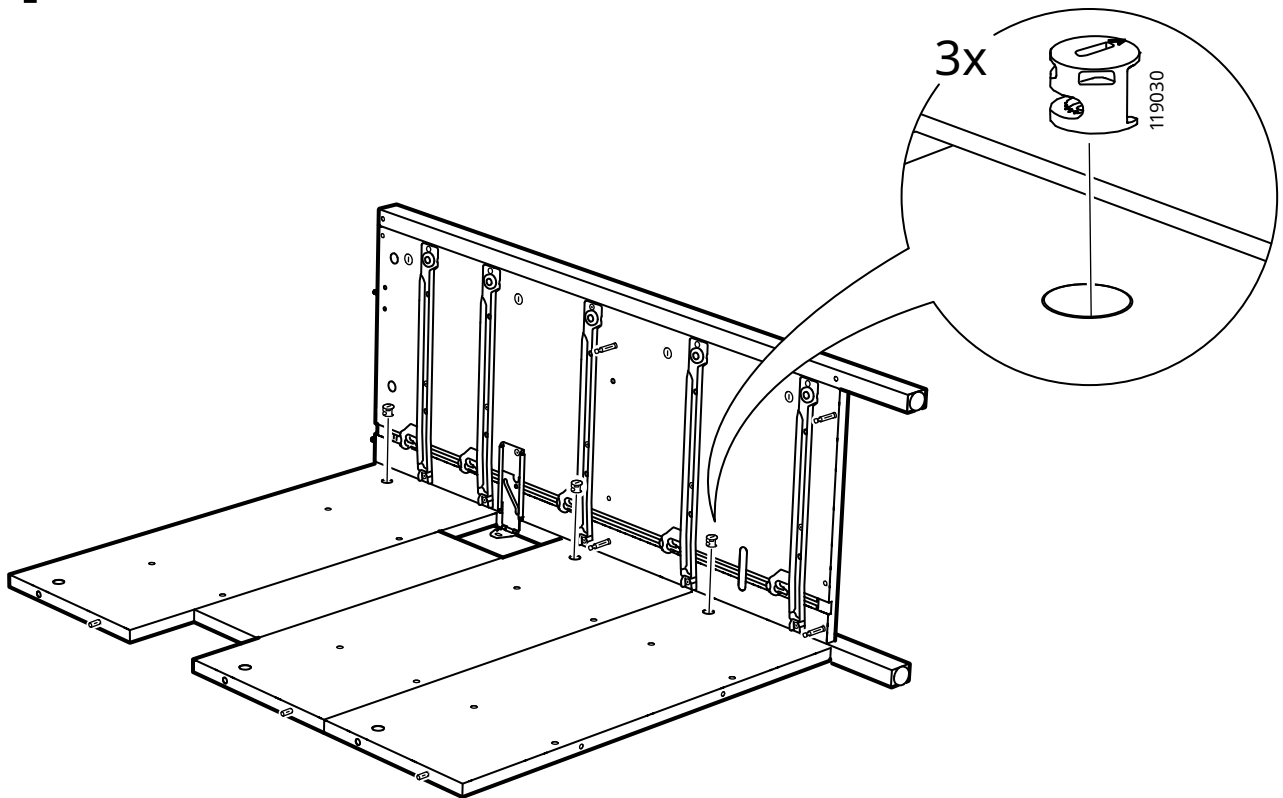

12

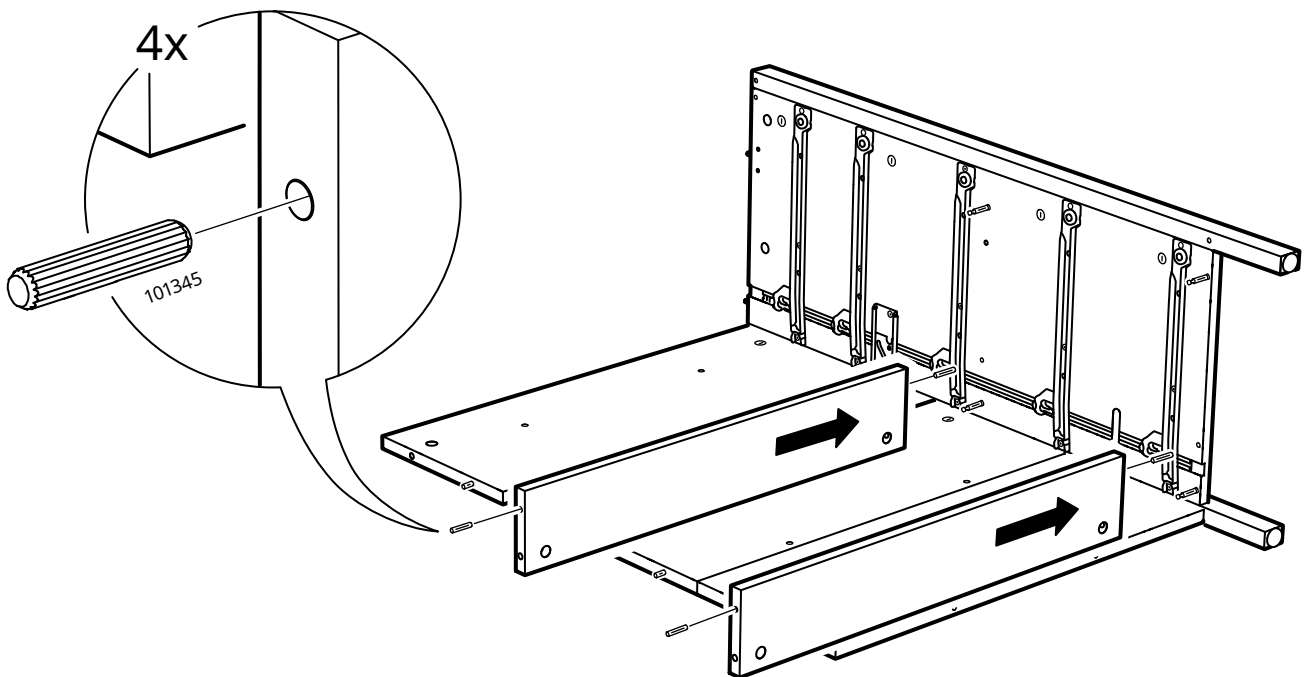

13

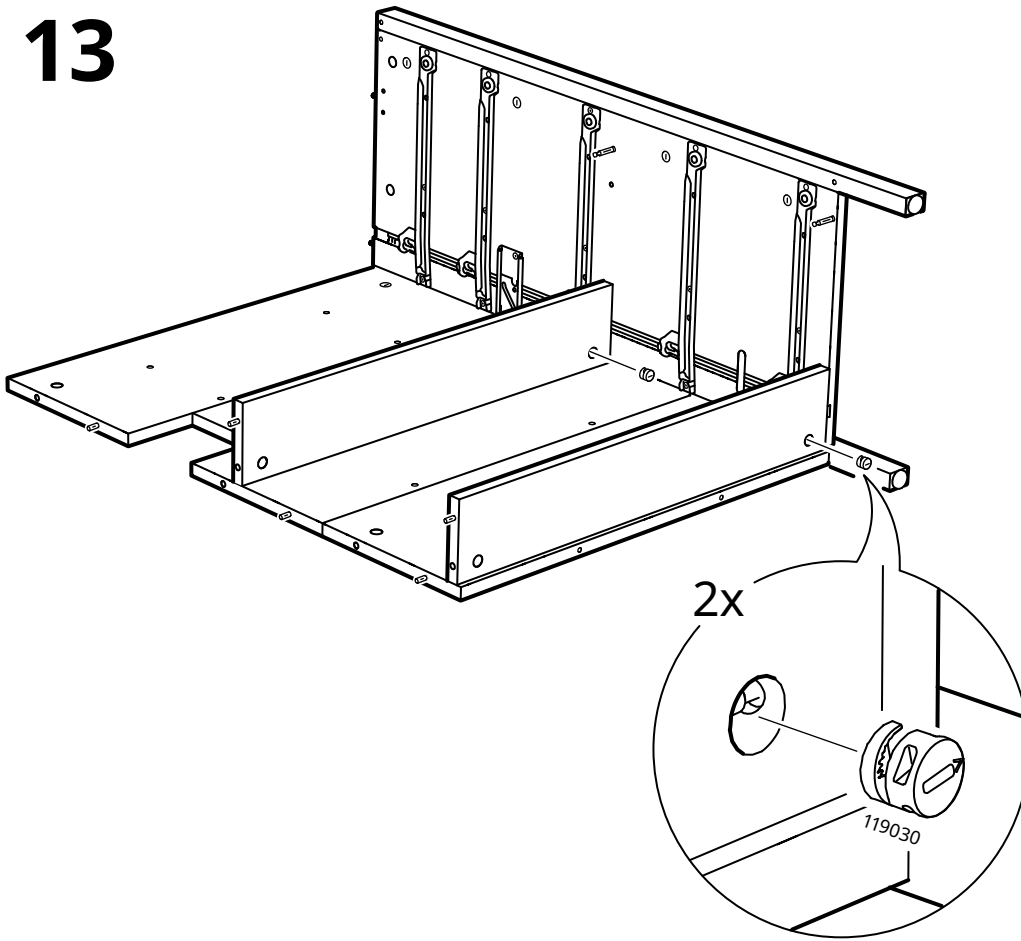

14

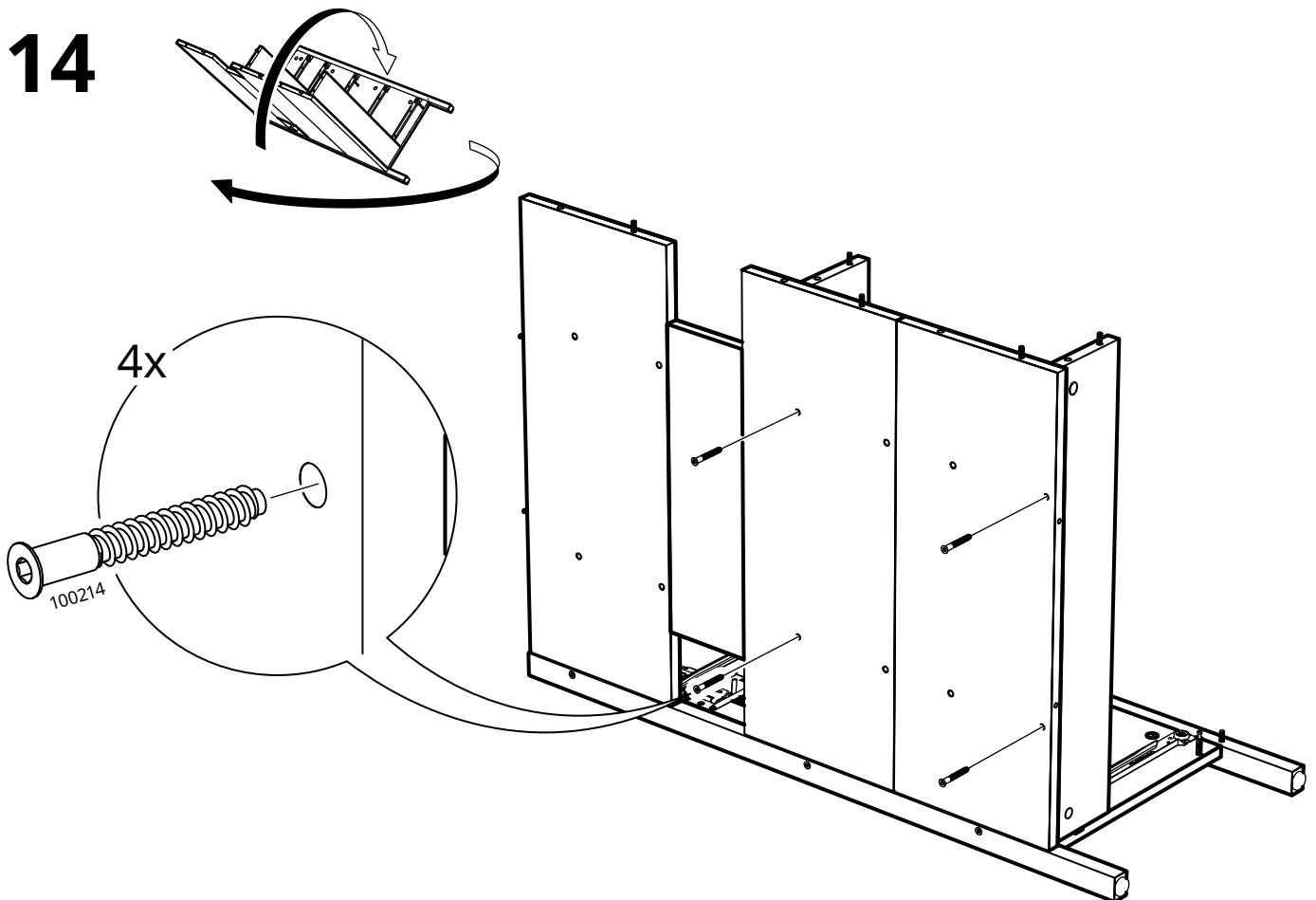

15

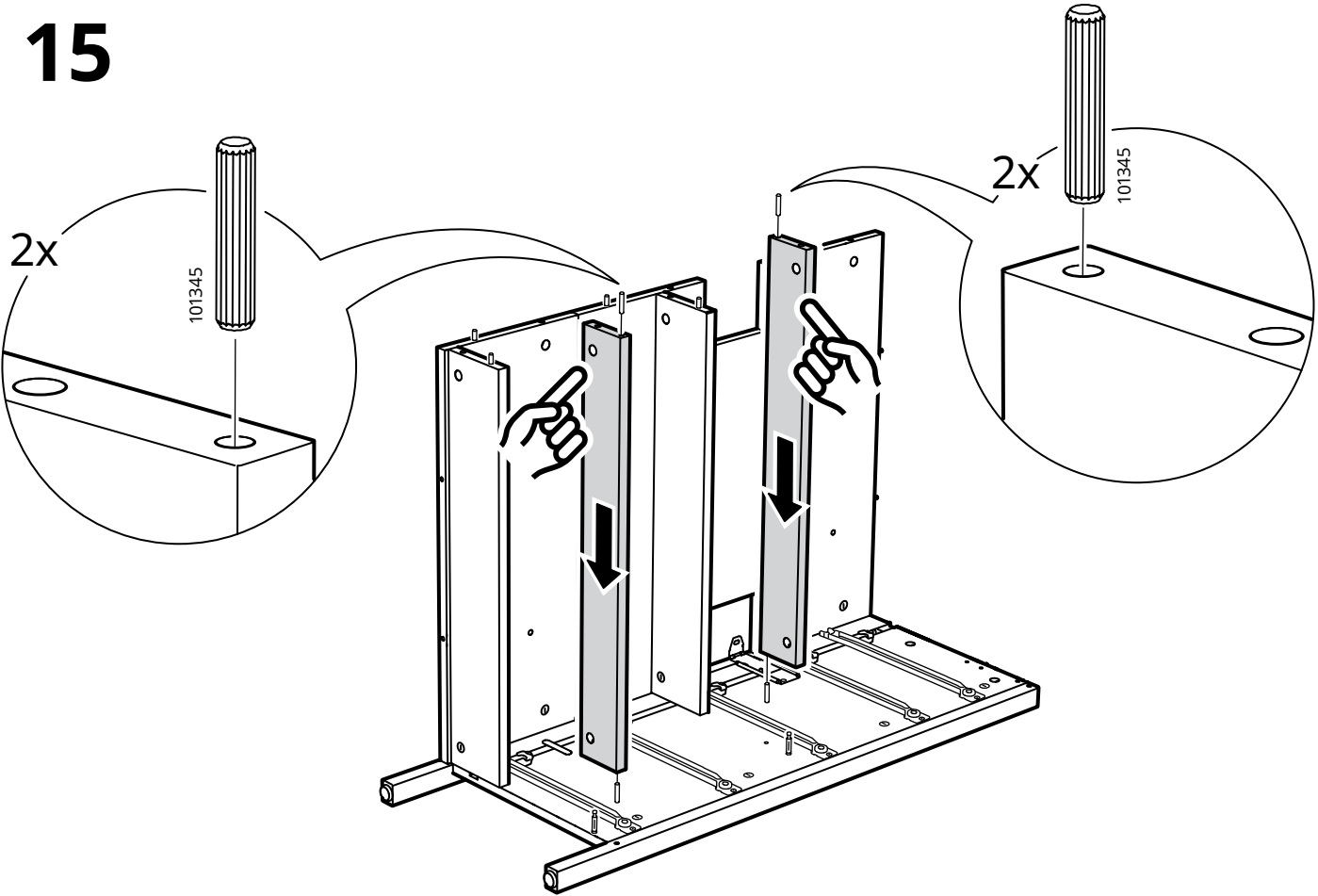

16

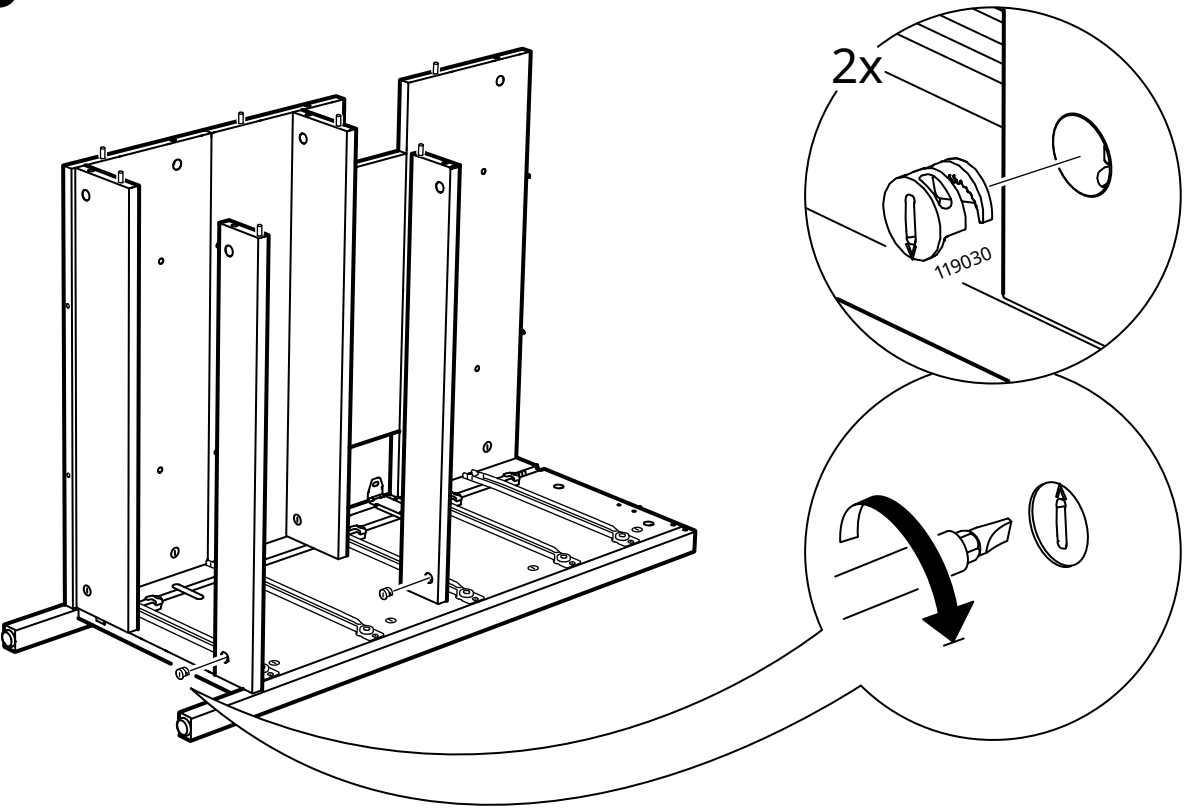

17

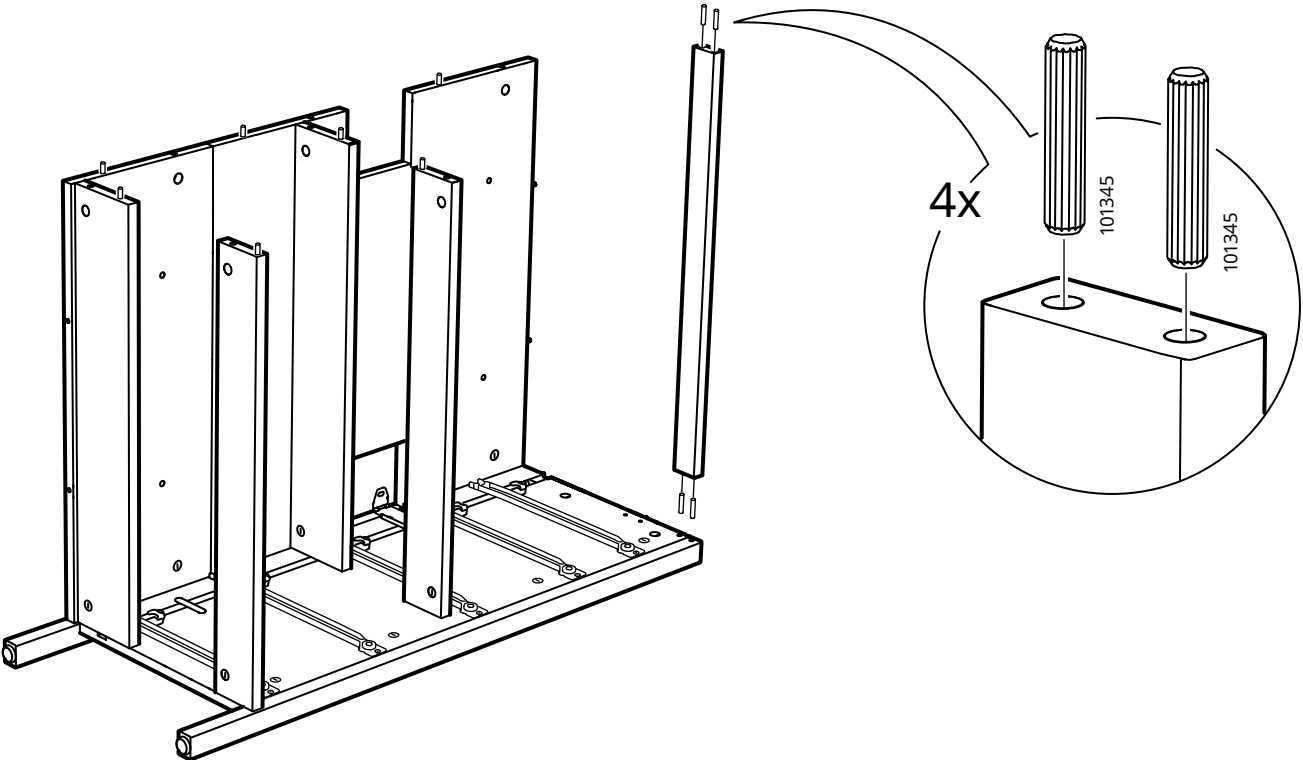

18

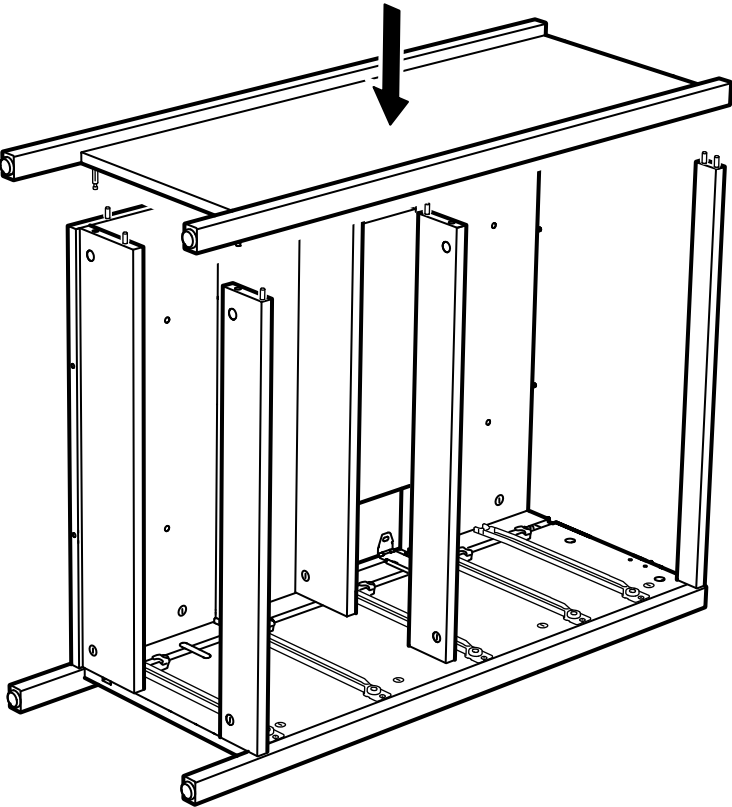

19

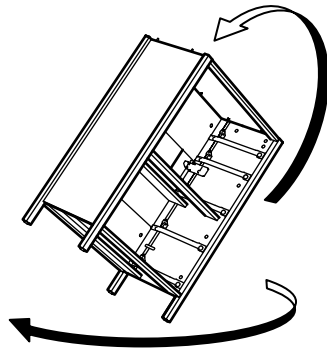
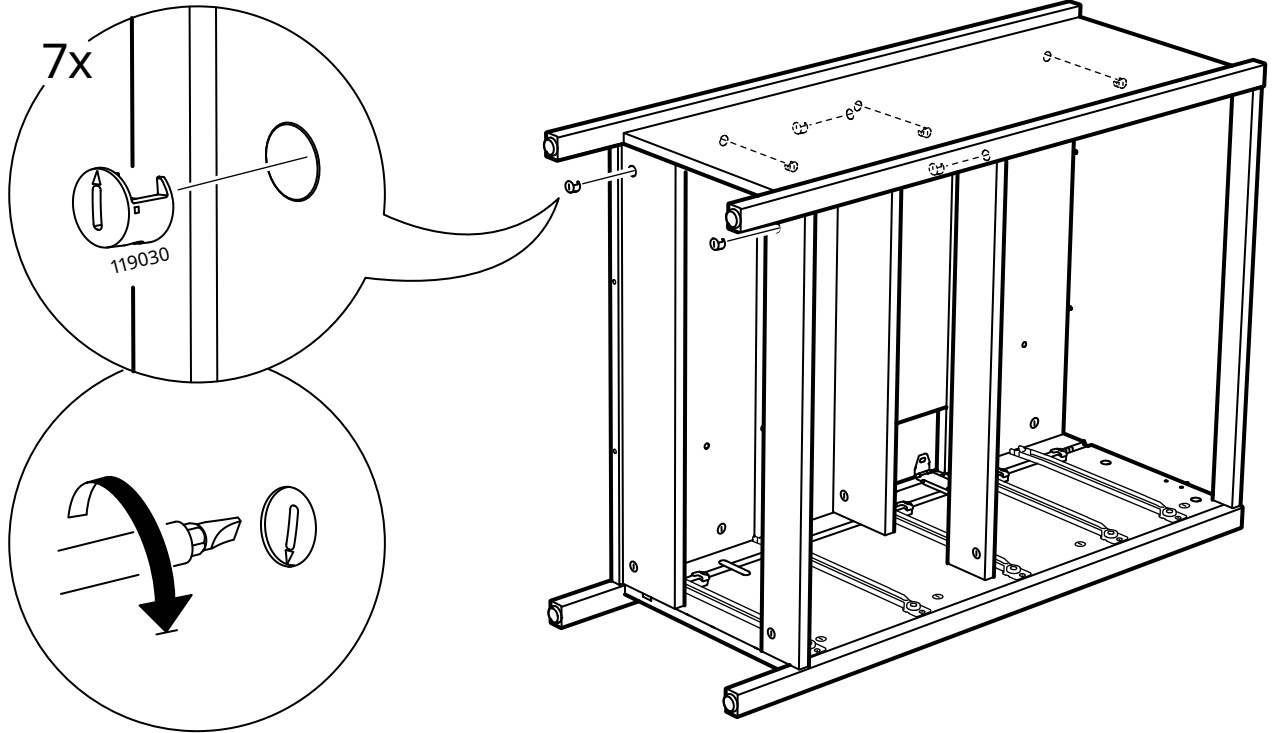

20

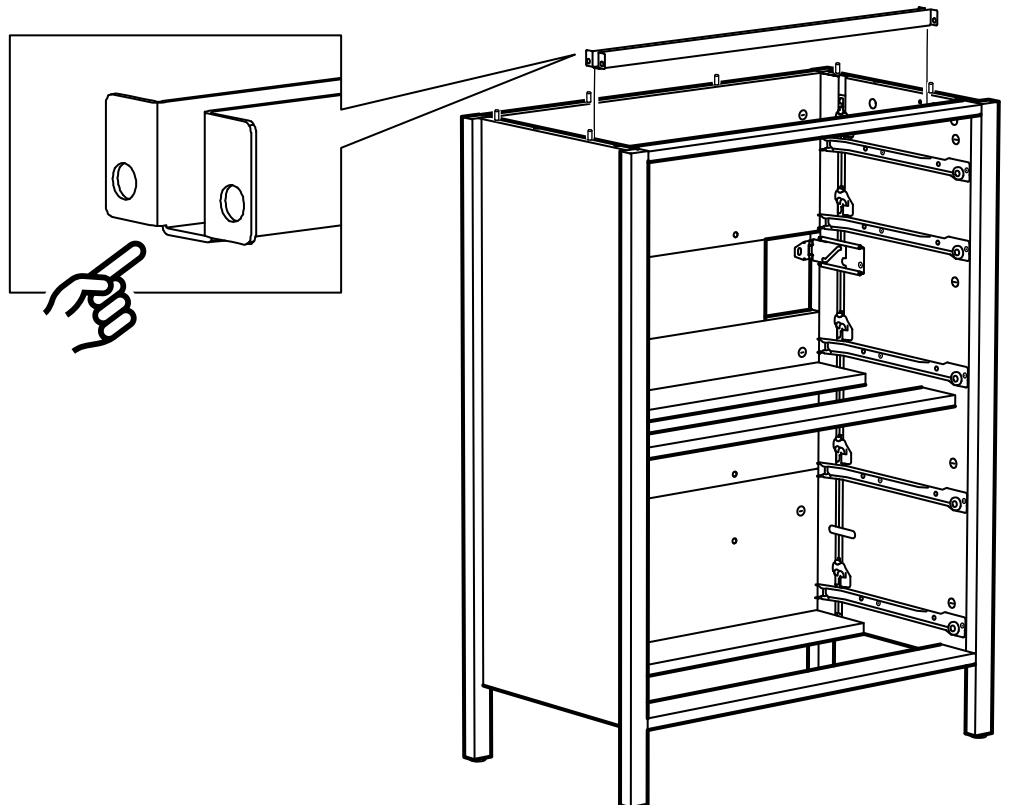

21

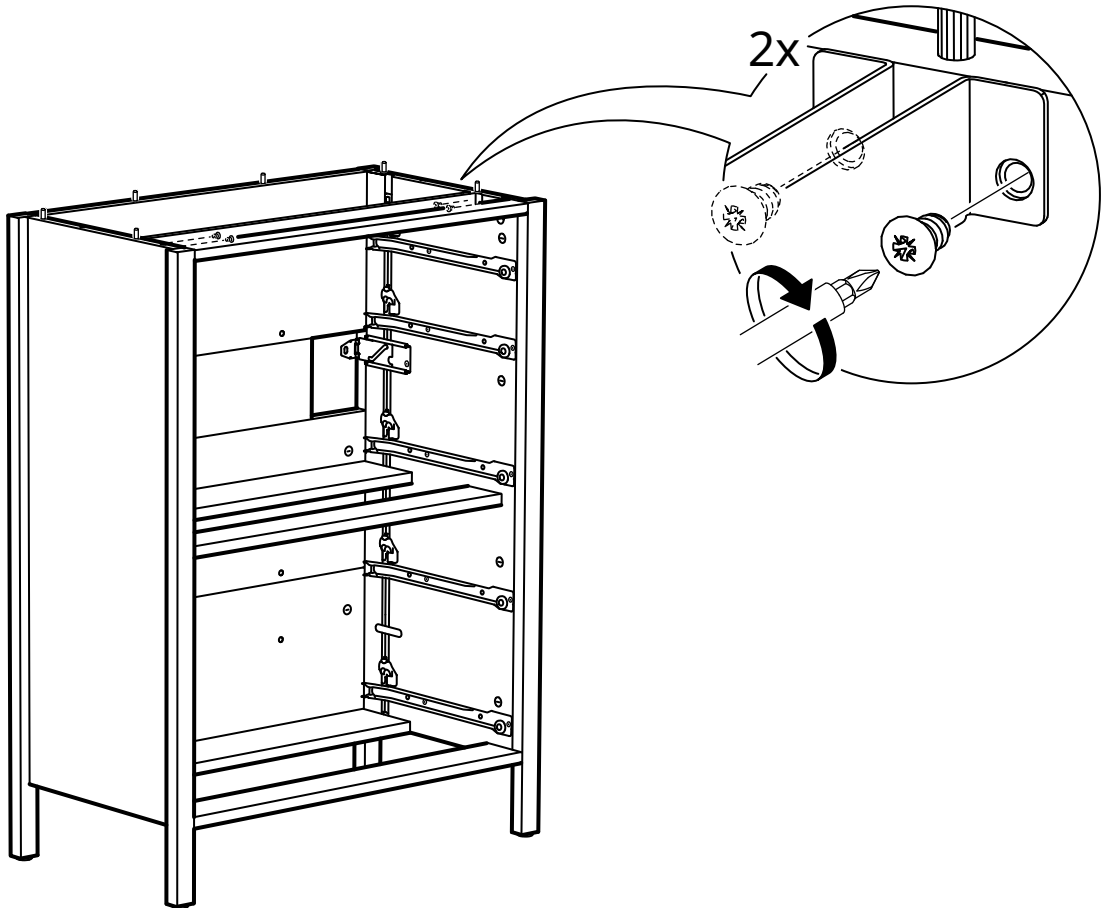

22

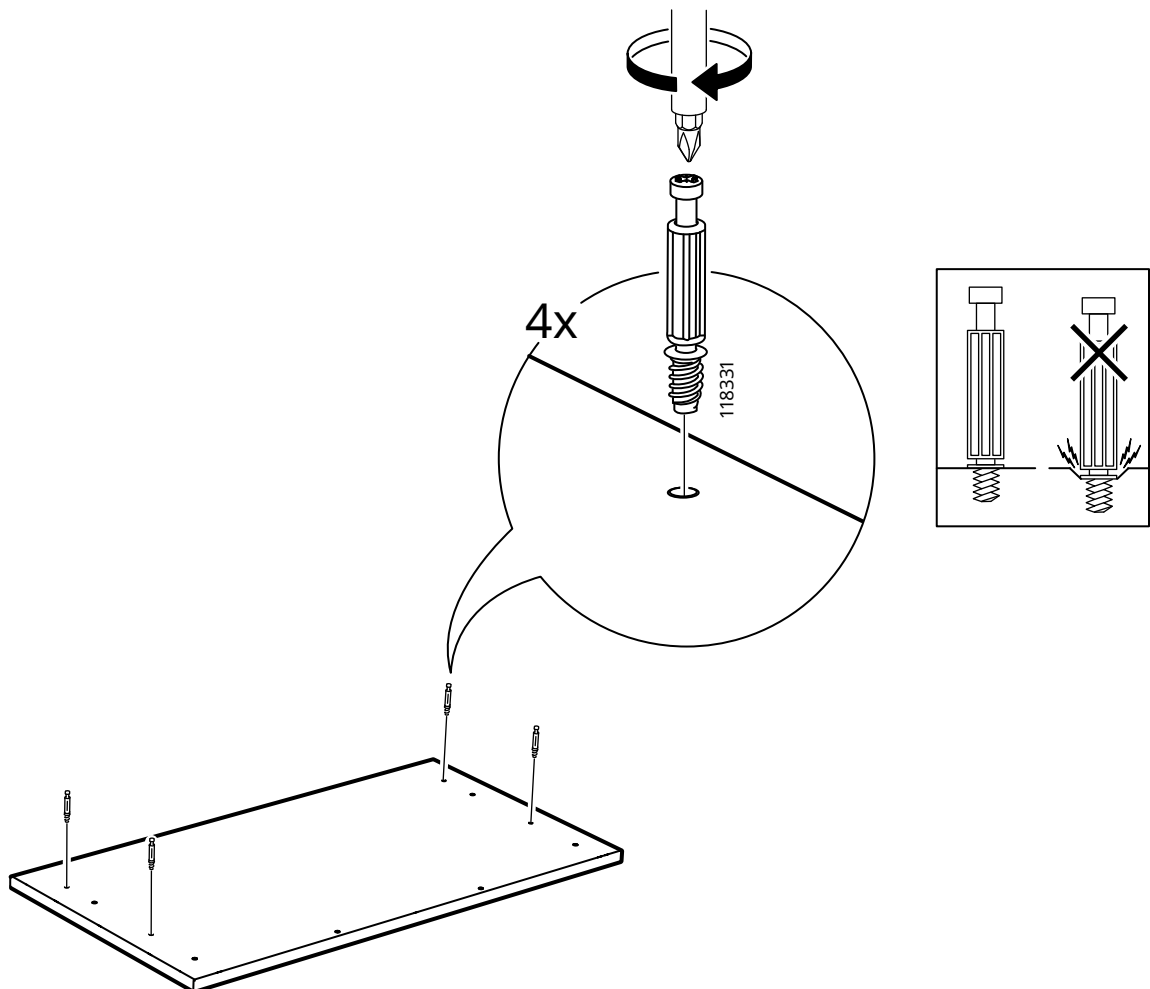

23

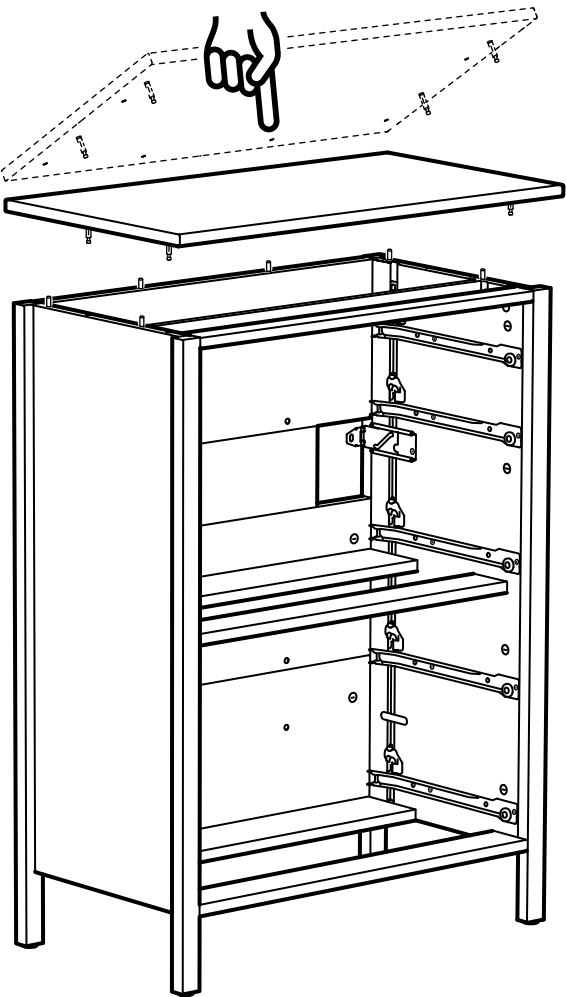

24

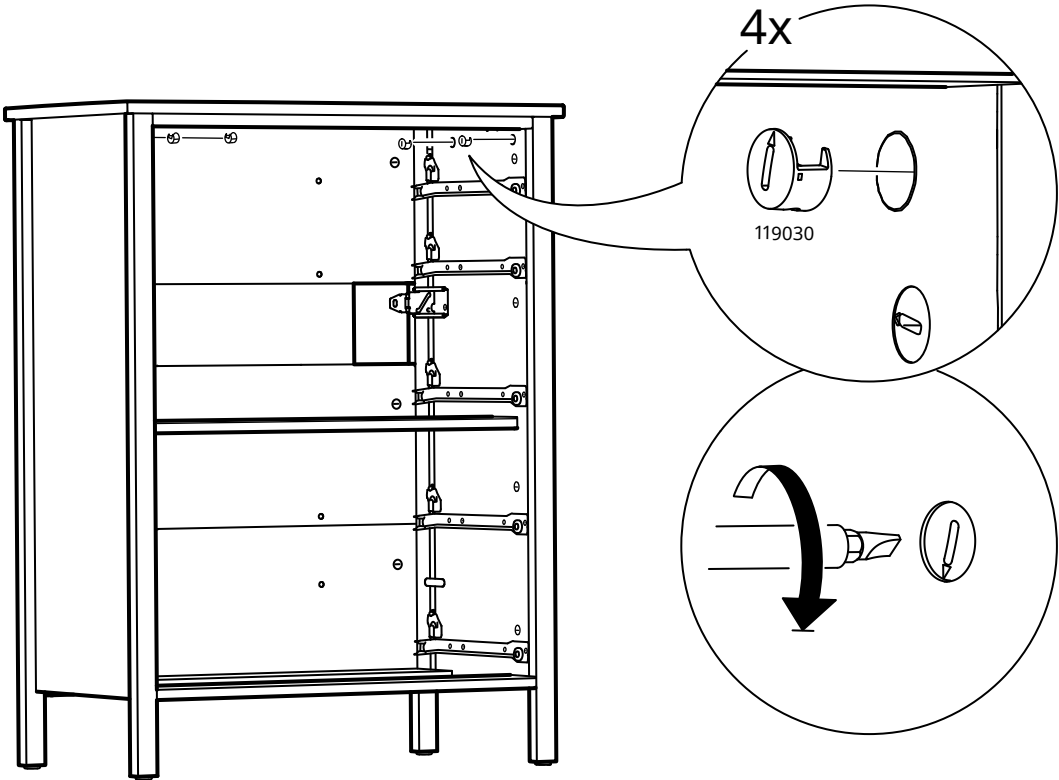

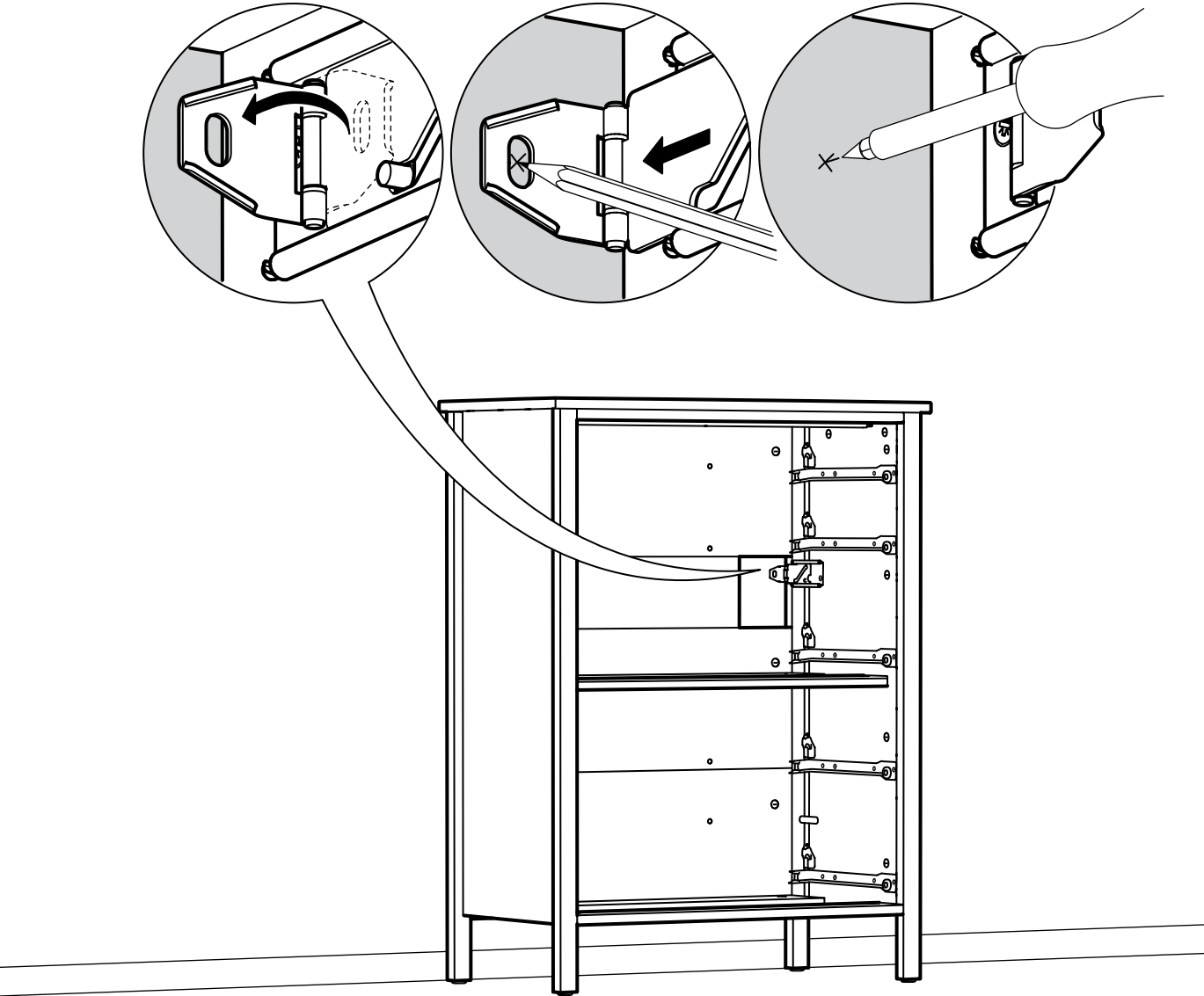

26

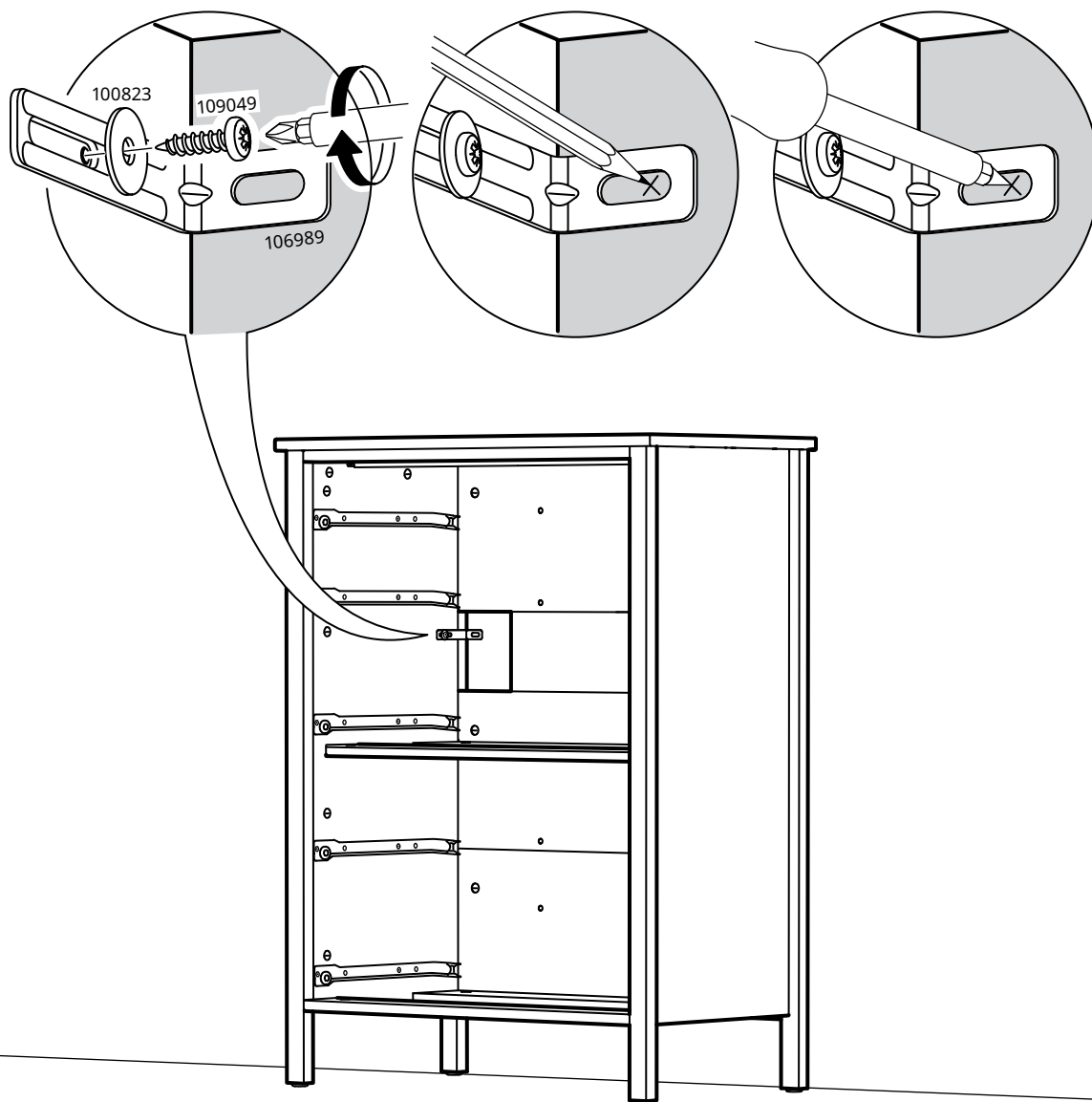

27

×

×

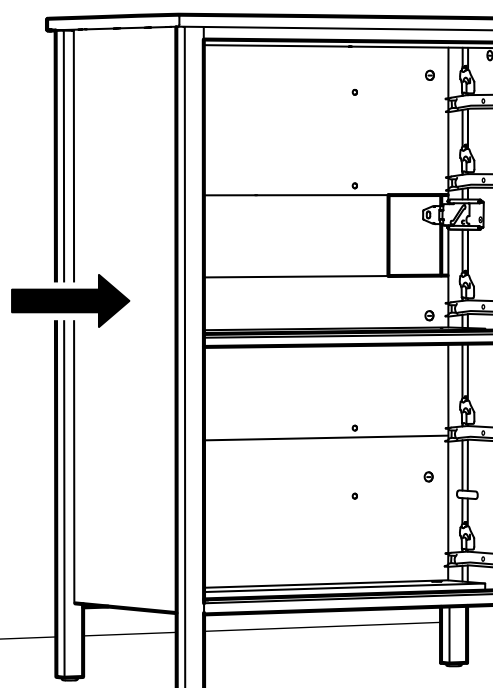

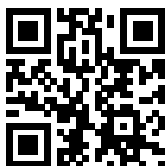

www.IKEA.com/secure-it



www.IKEA.cn/secure-it

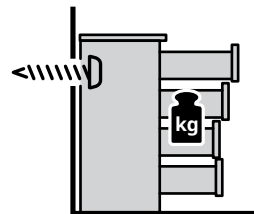

English

The screw(s) and plug(s) supplied can be used with most solid (A) and hollow (B) walls. For solid wood (C) use the screw(s) without plug(s). If you are uncertain, seek professional advice.

A

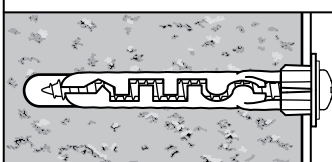

Ø 8 mm
(5/16")

1

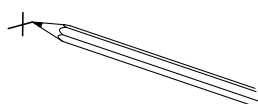

2

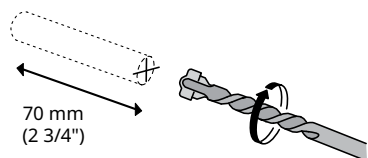

3

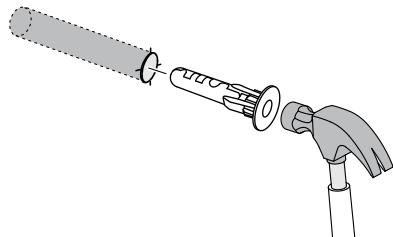

B

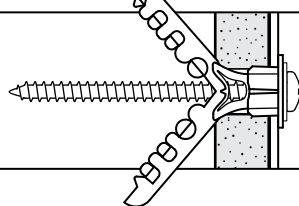

Ø 8 mm
(5/16")

1

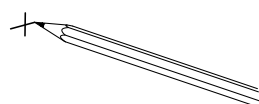

2

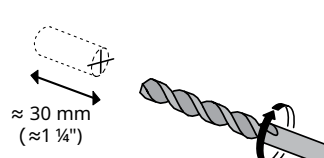

3

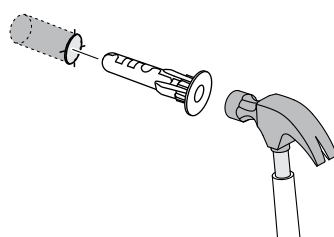

C

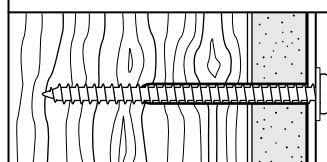

Ø 3 mm
(1/8")

1

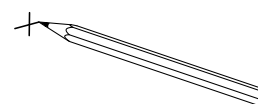

2

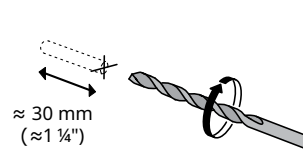

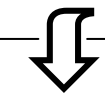
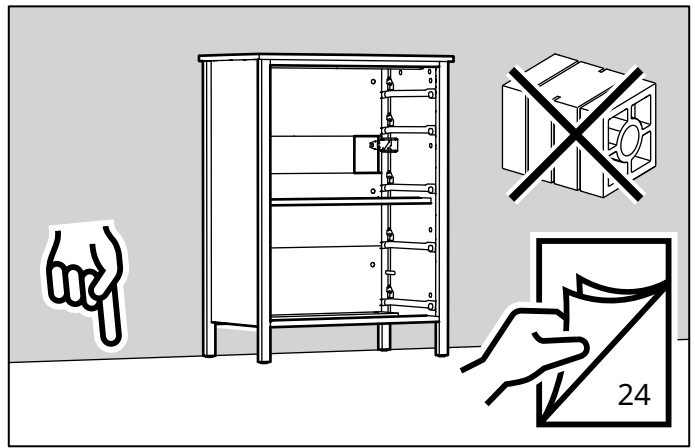
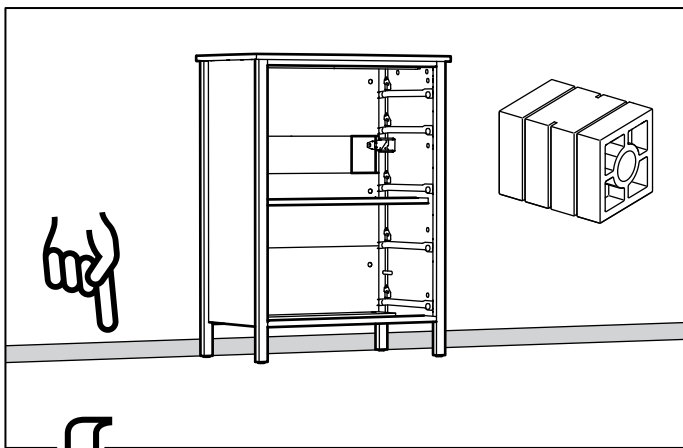

28

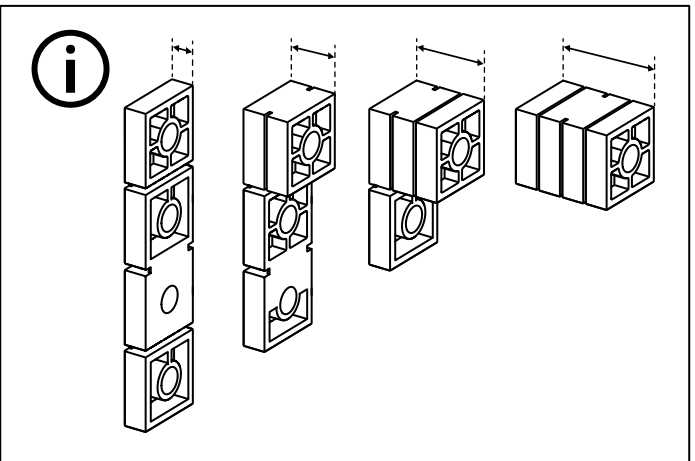
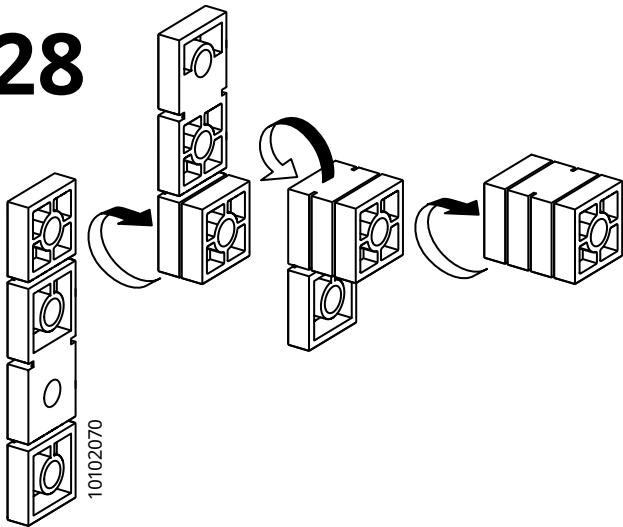

29

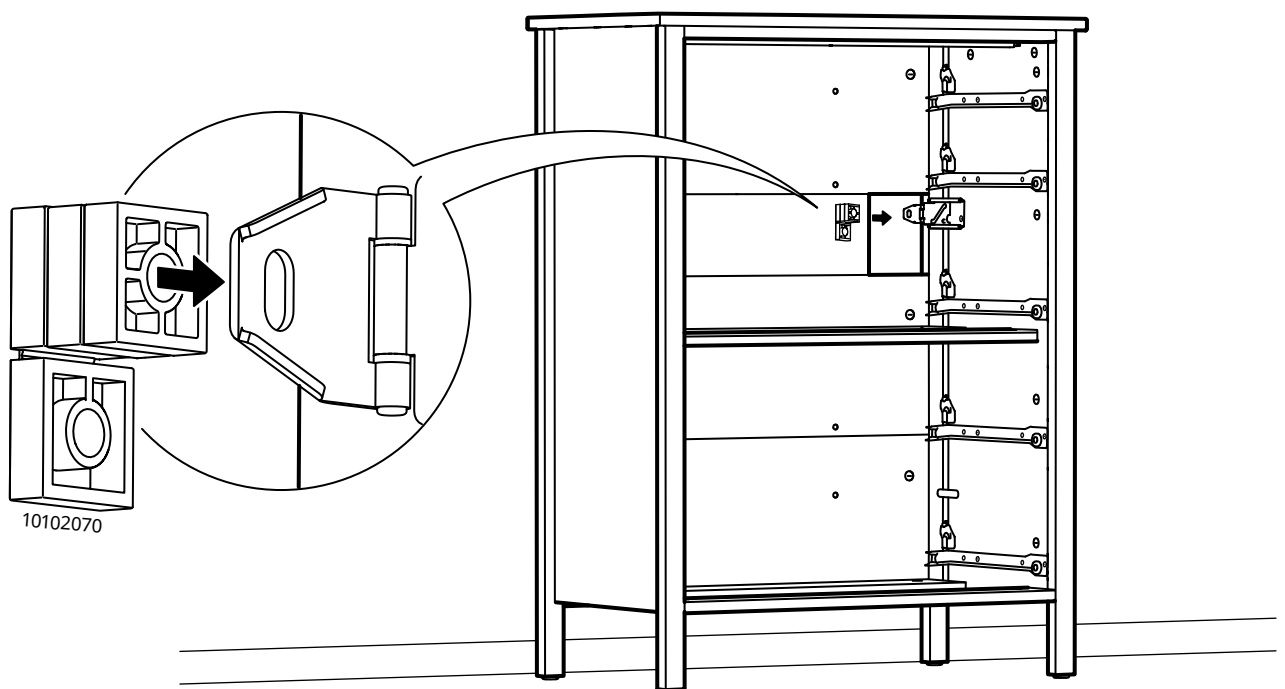

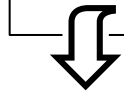
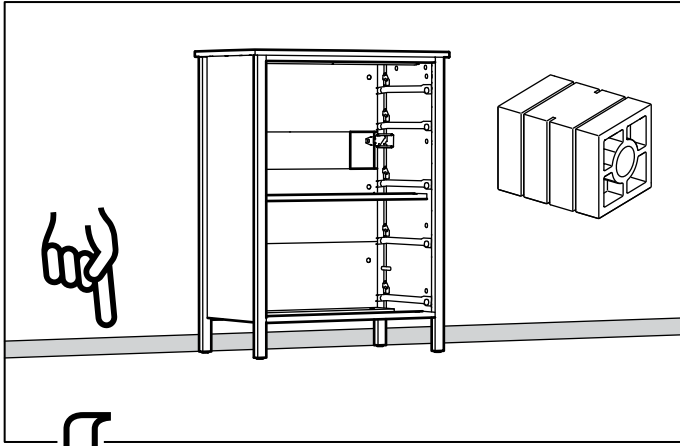

30

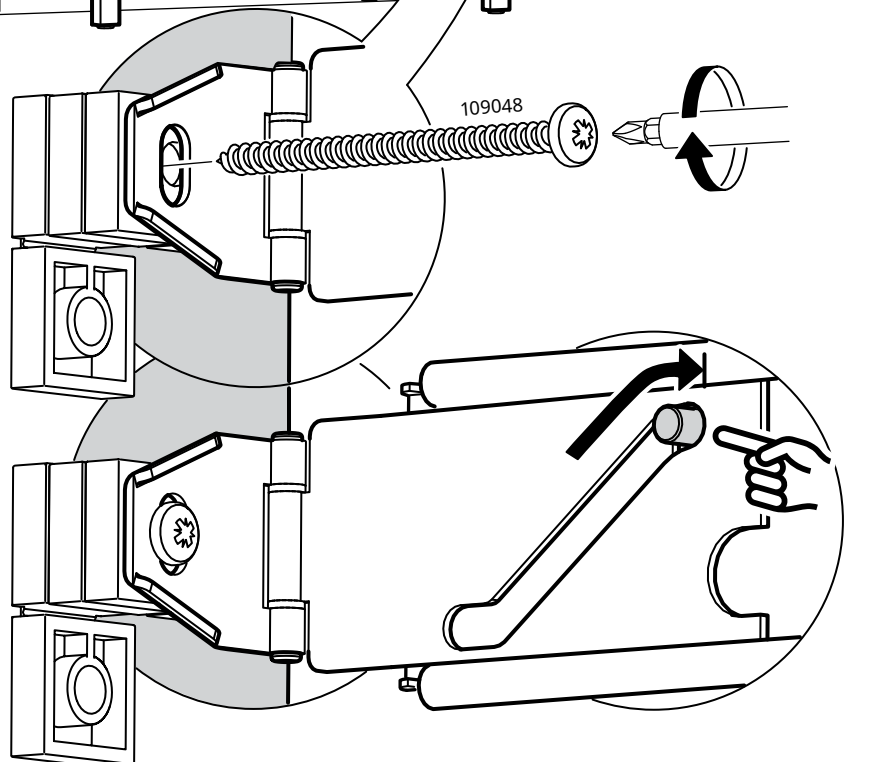
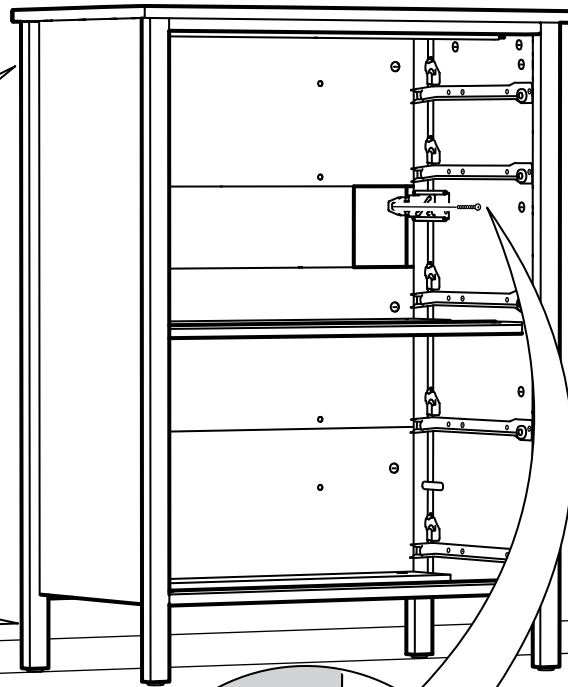
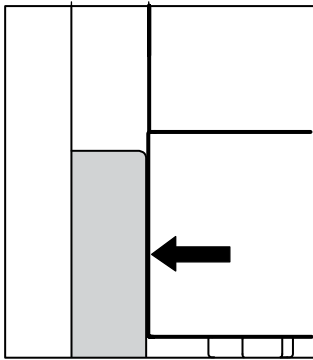
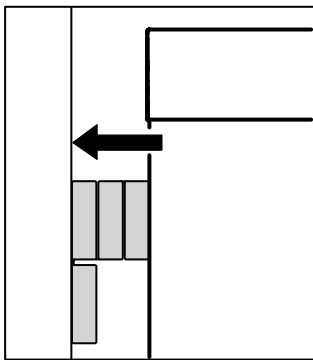

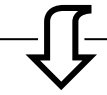
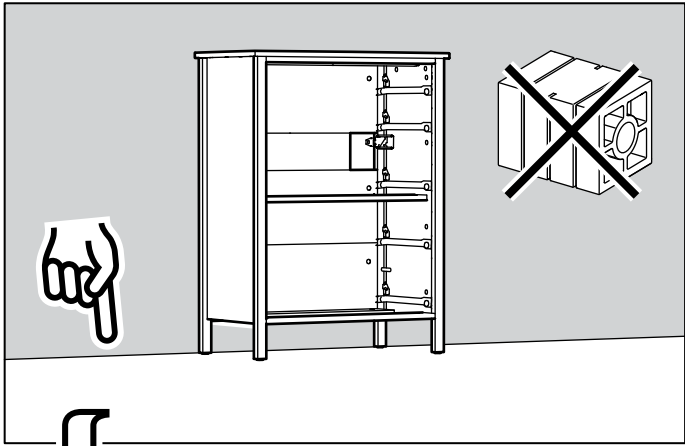

30

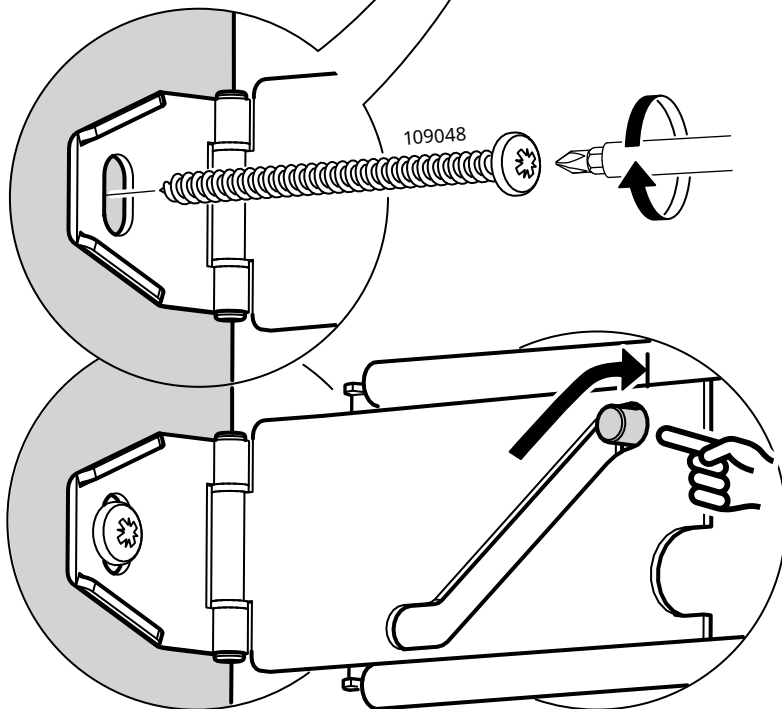
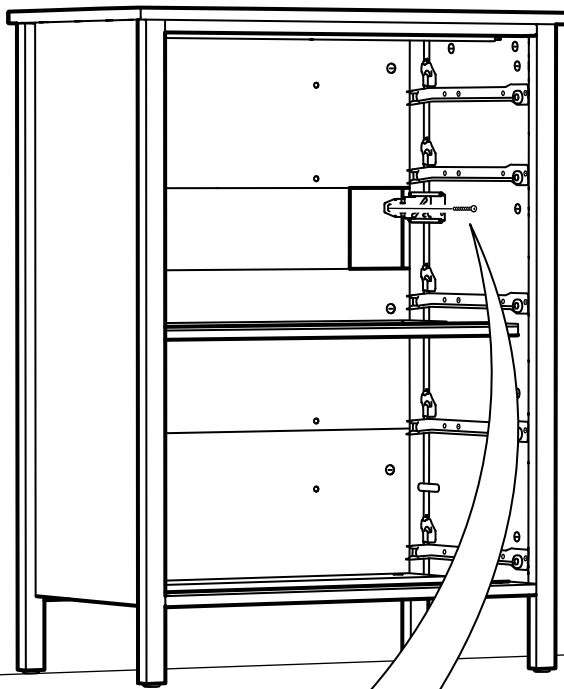

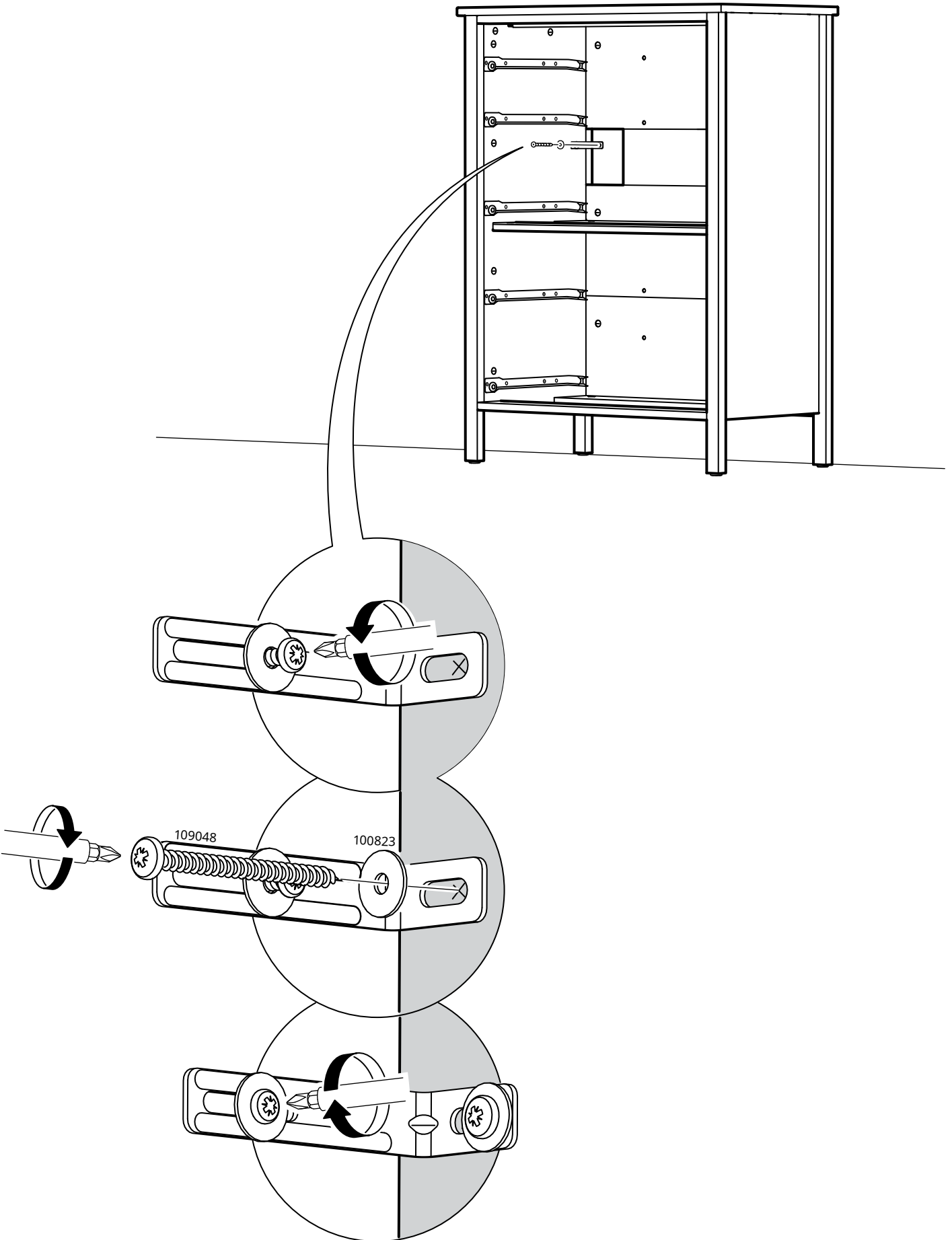

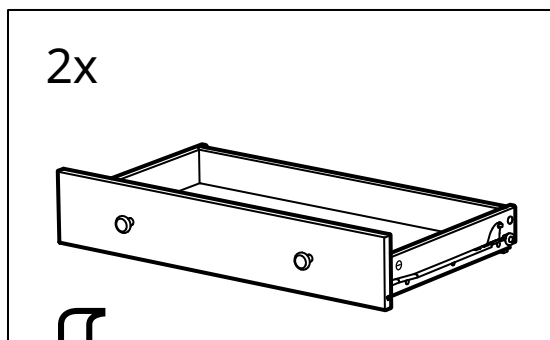

32

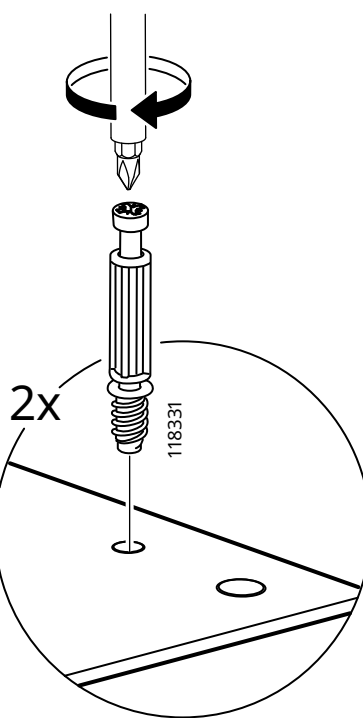
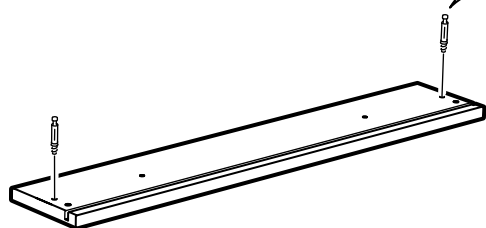

33

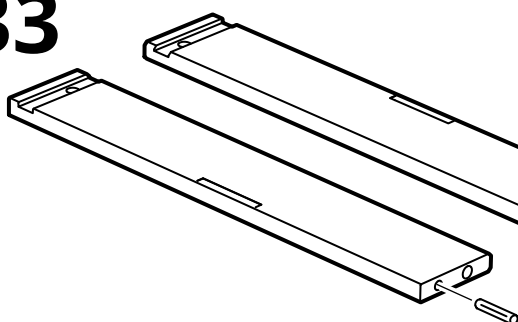

2x

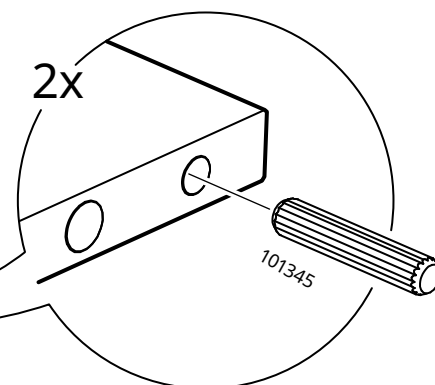

34

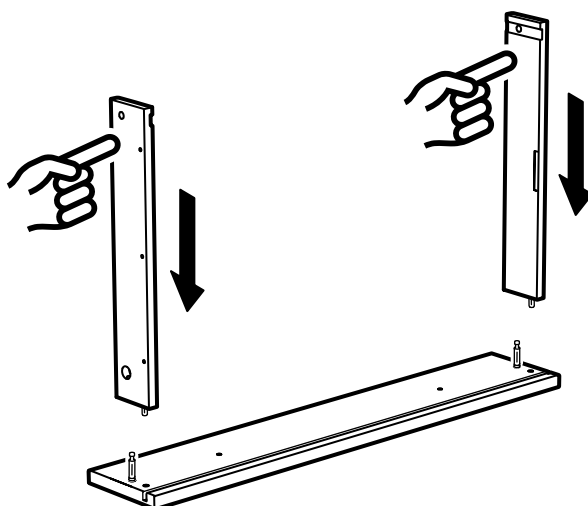

35

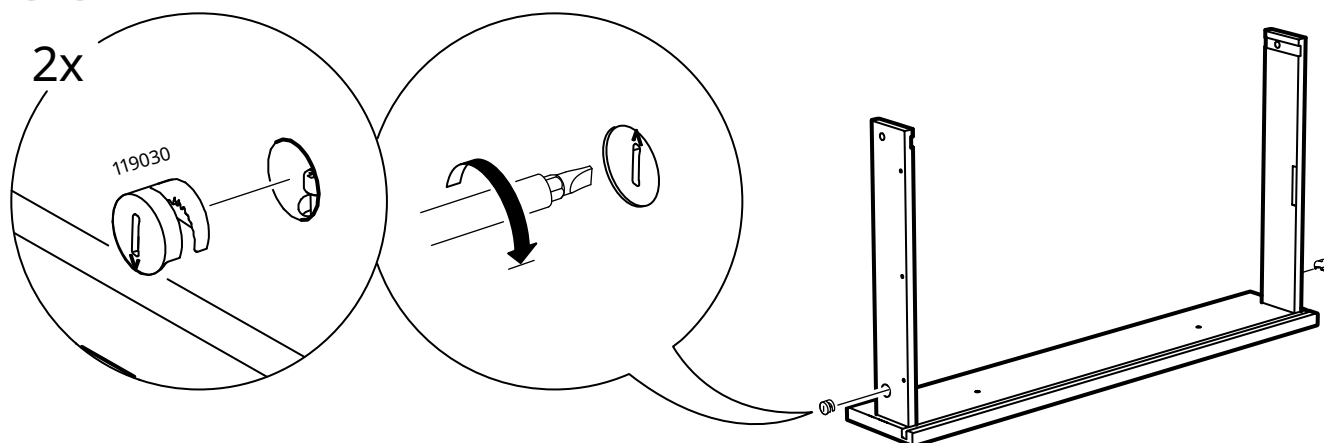

36

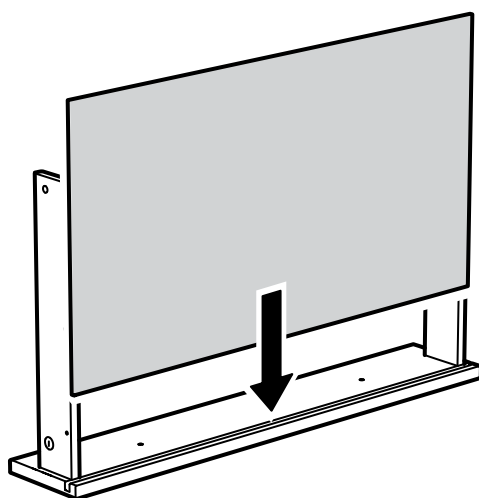

37

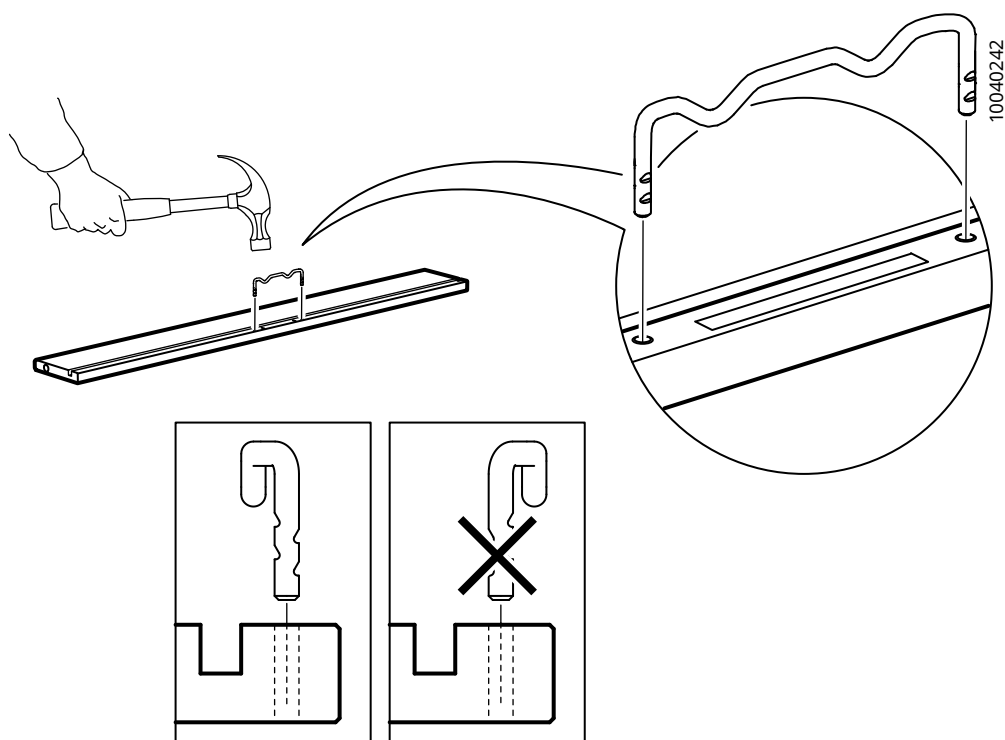

38

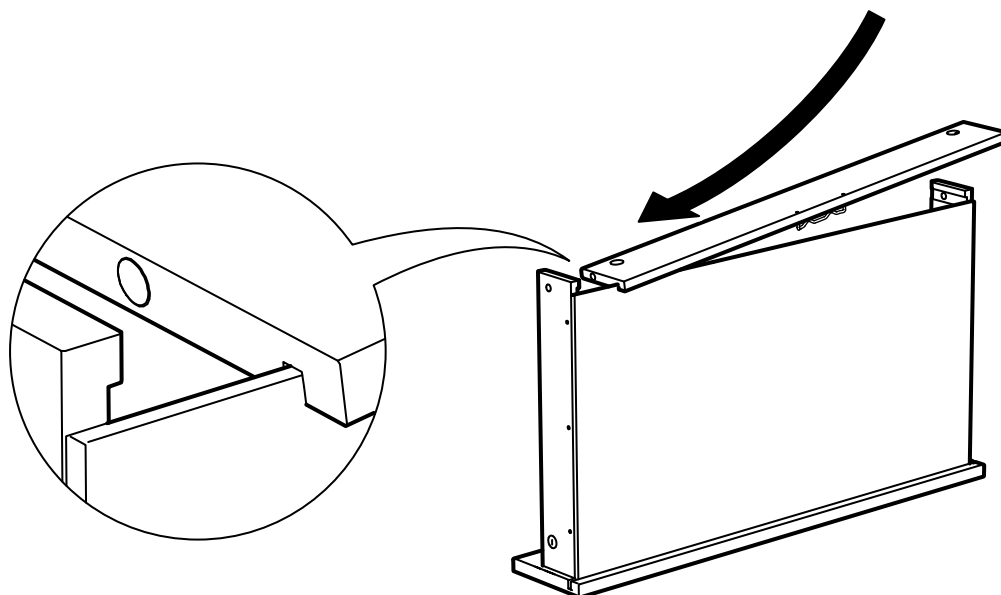

39

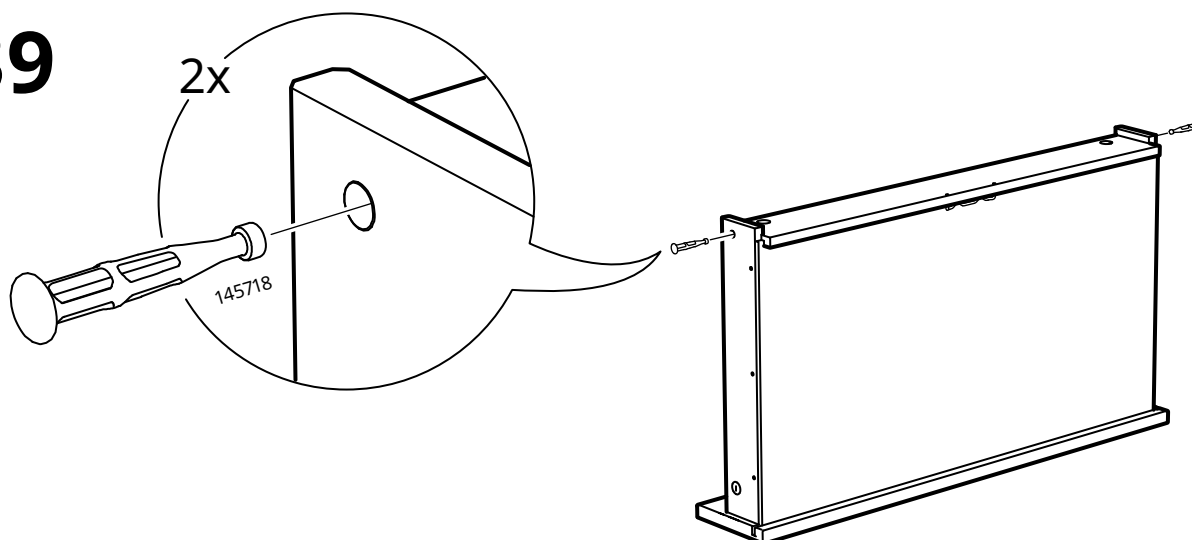

40

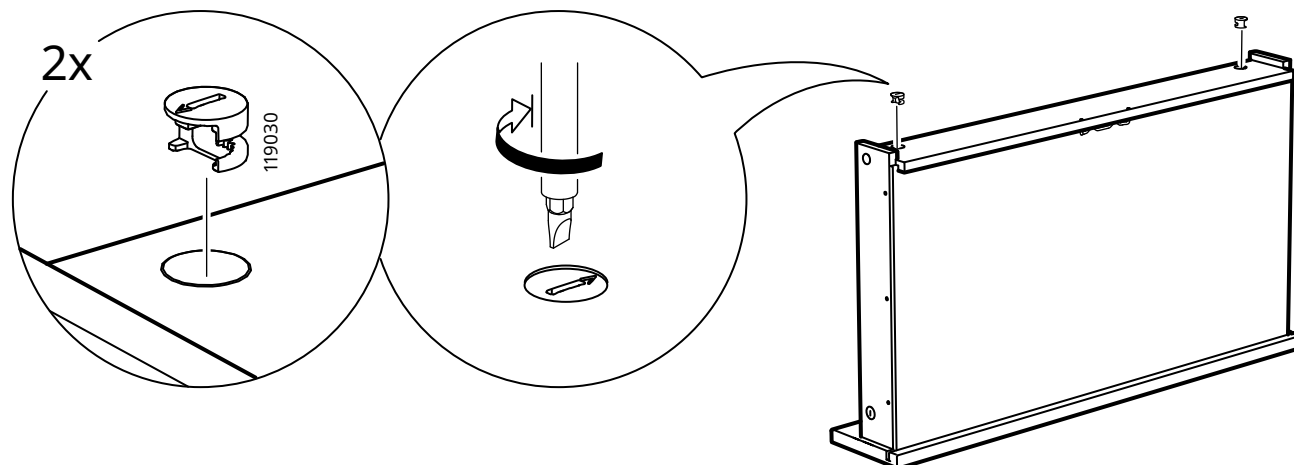

41

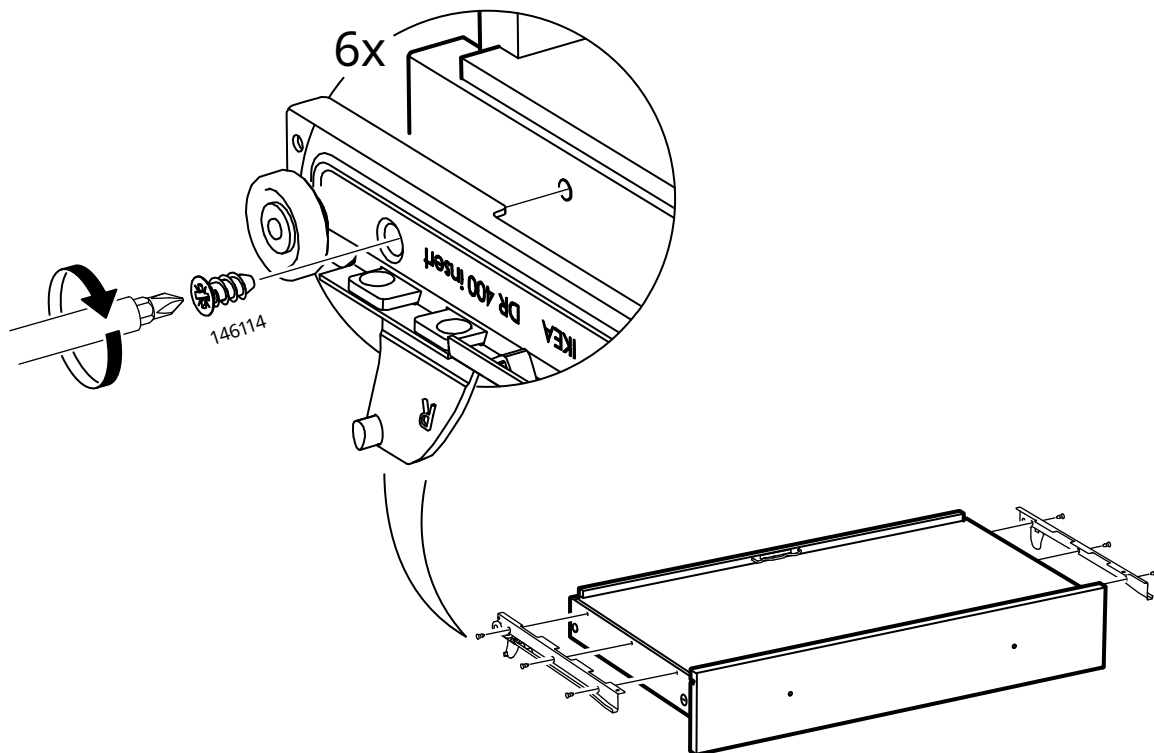

42

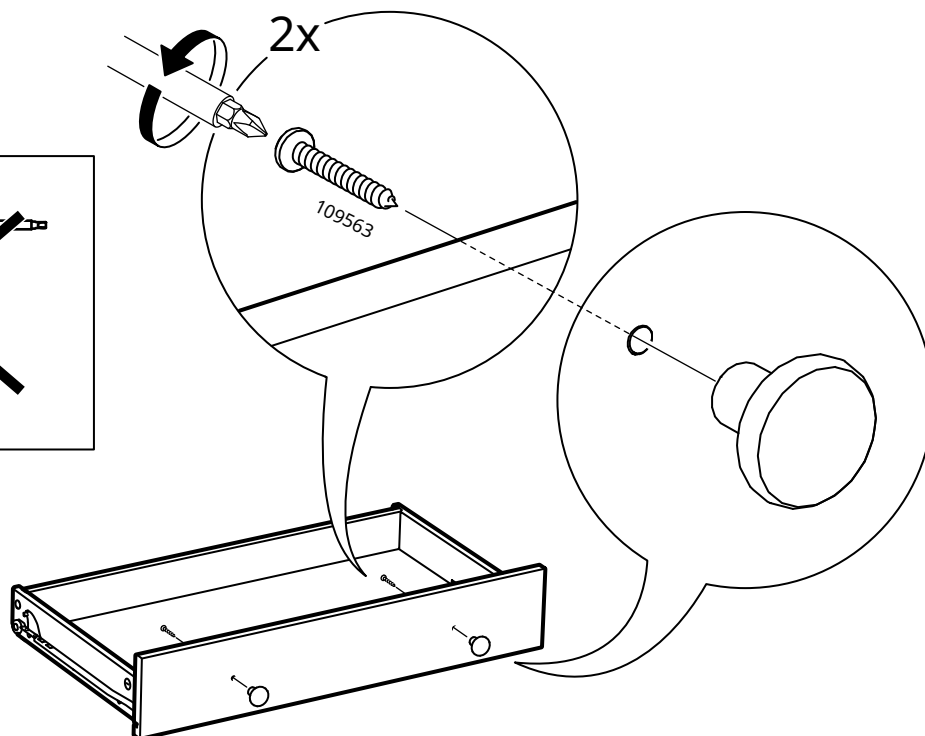
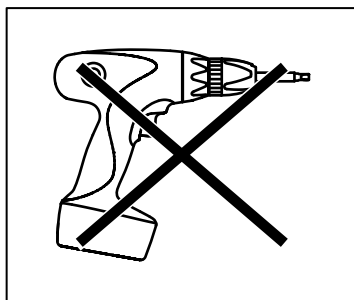

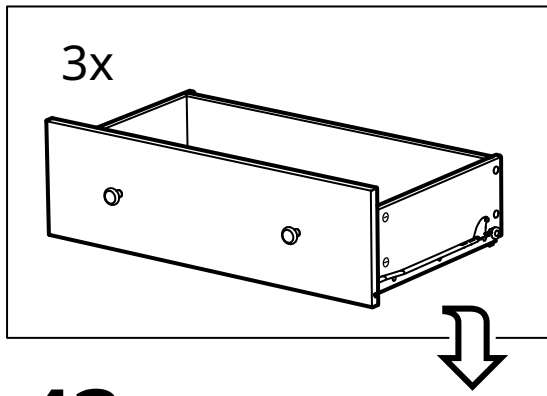

43

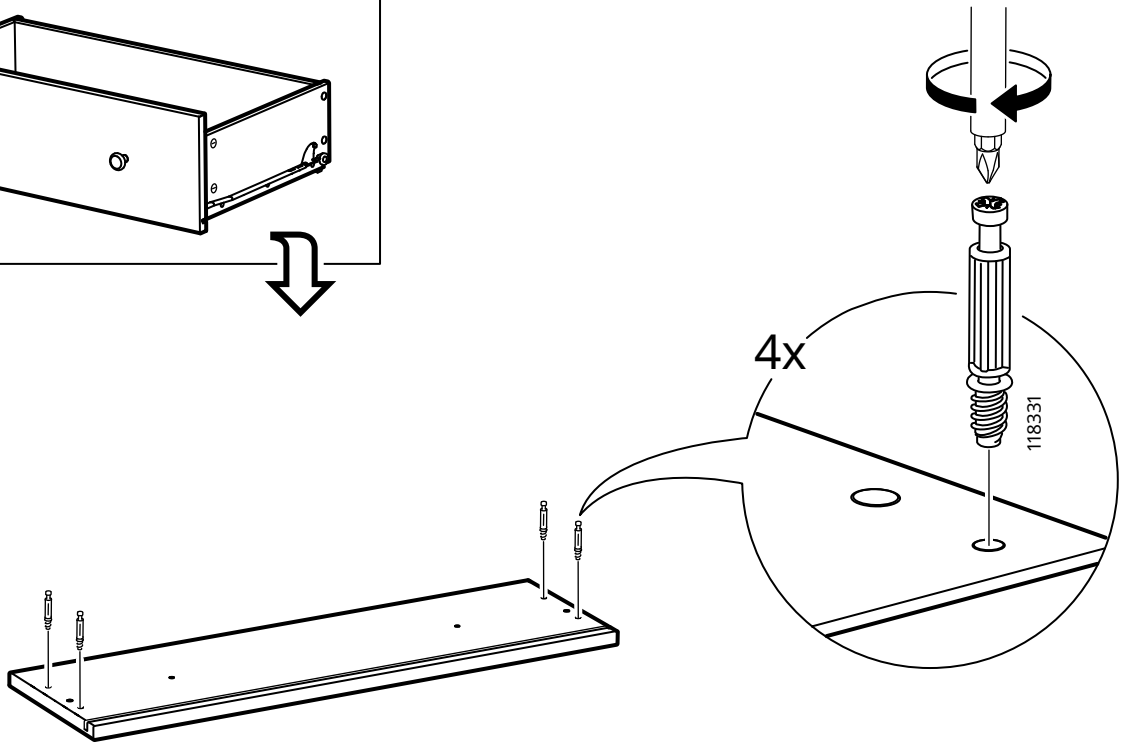

44

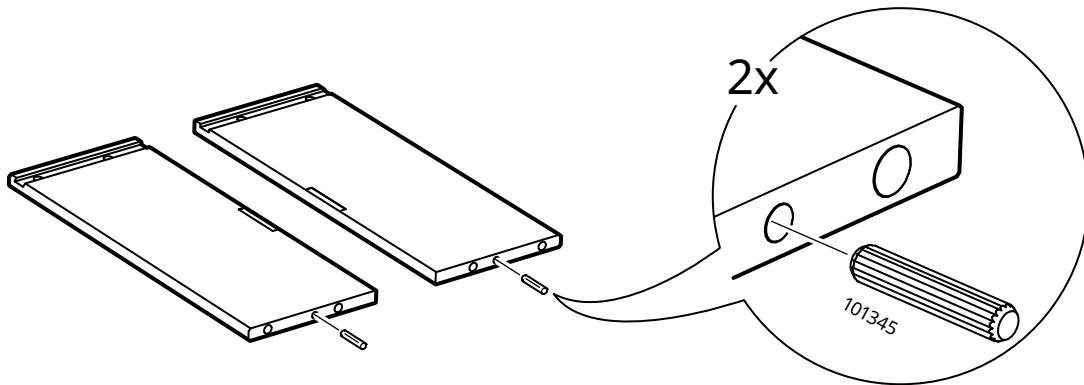

45

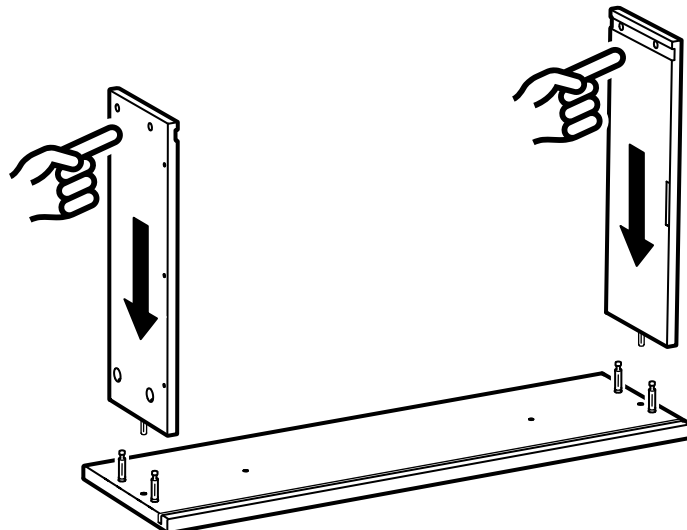

46

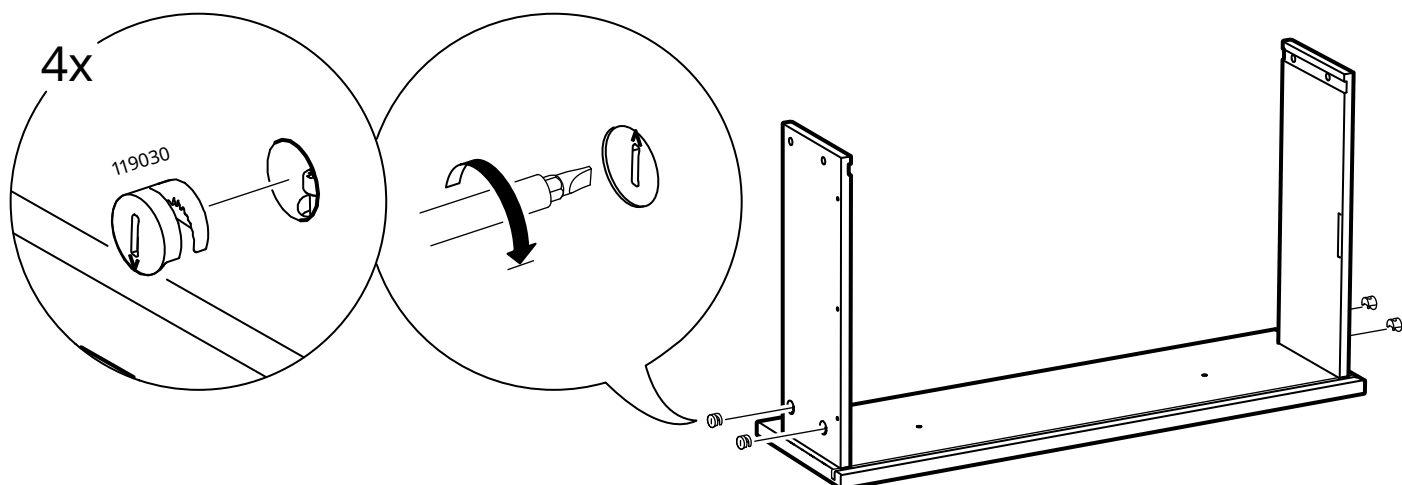

47

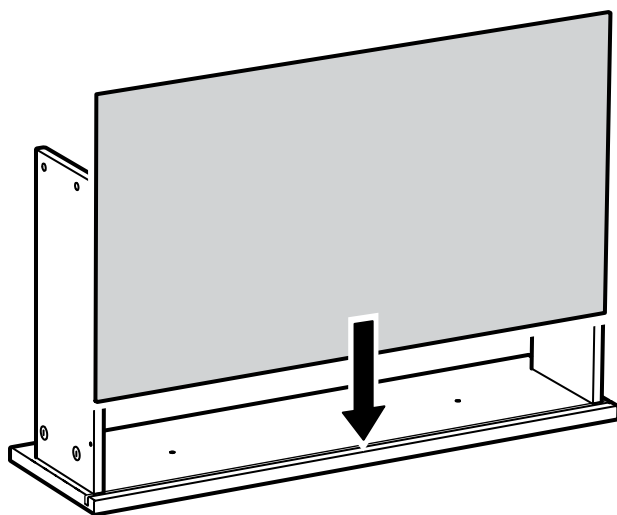

48

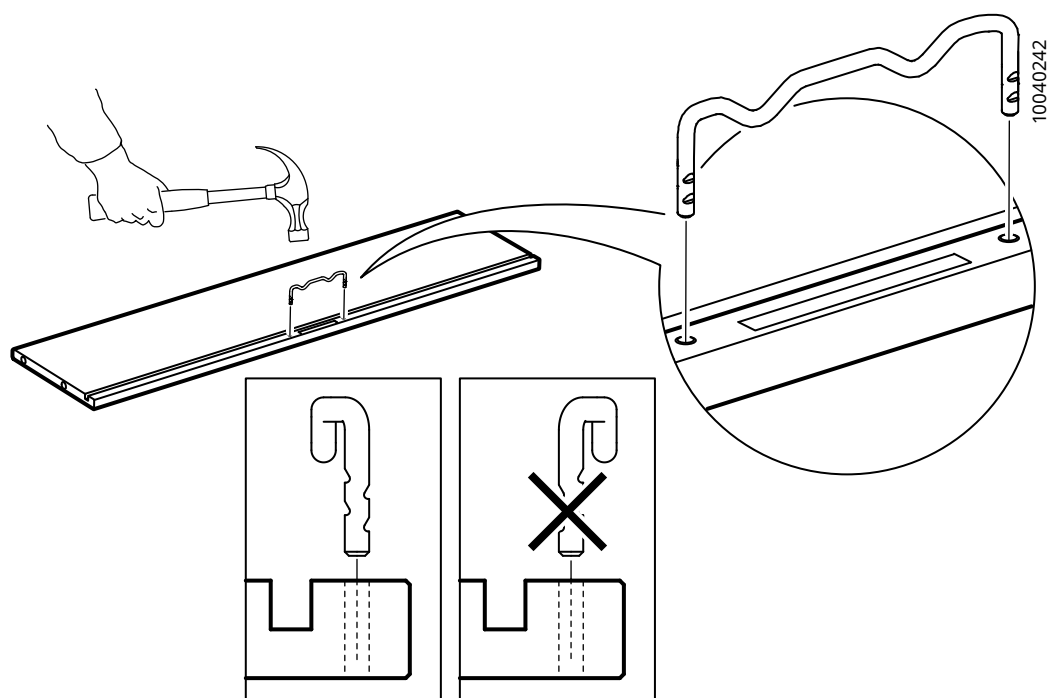

49

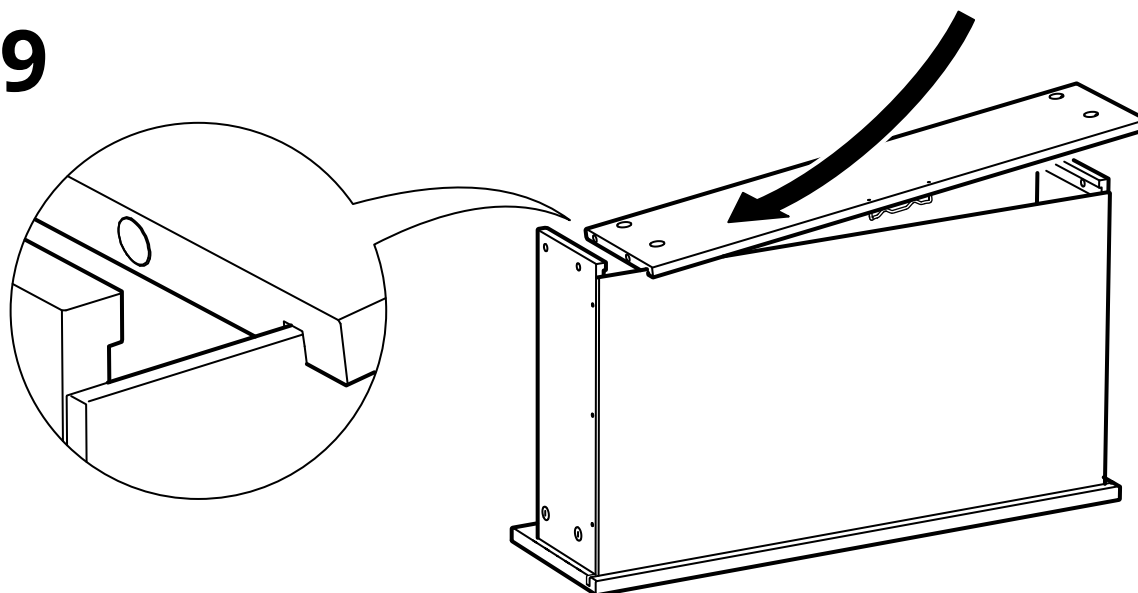

50

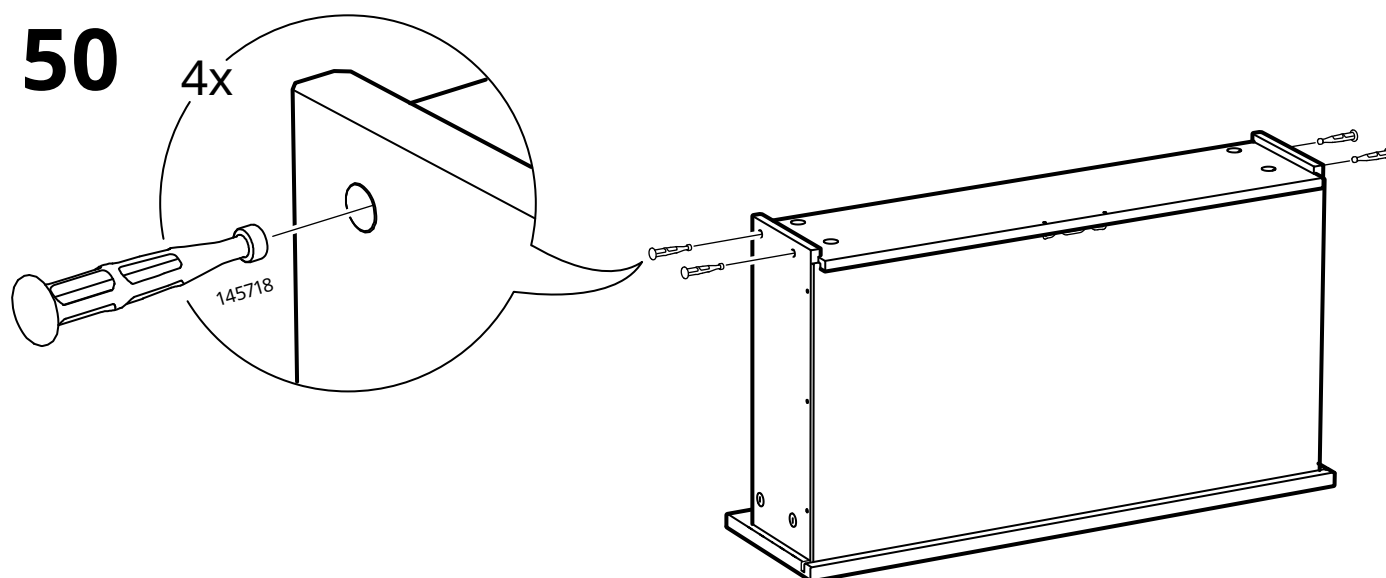

51

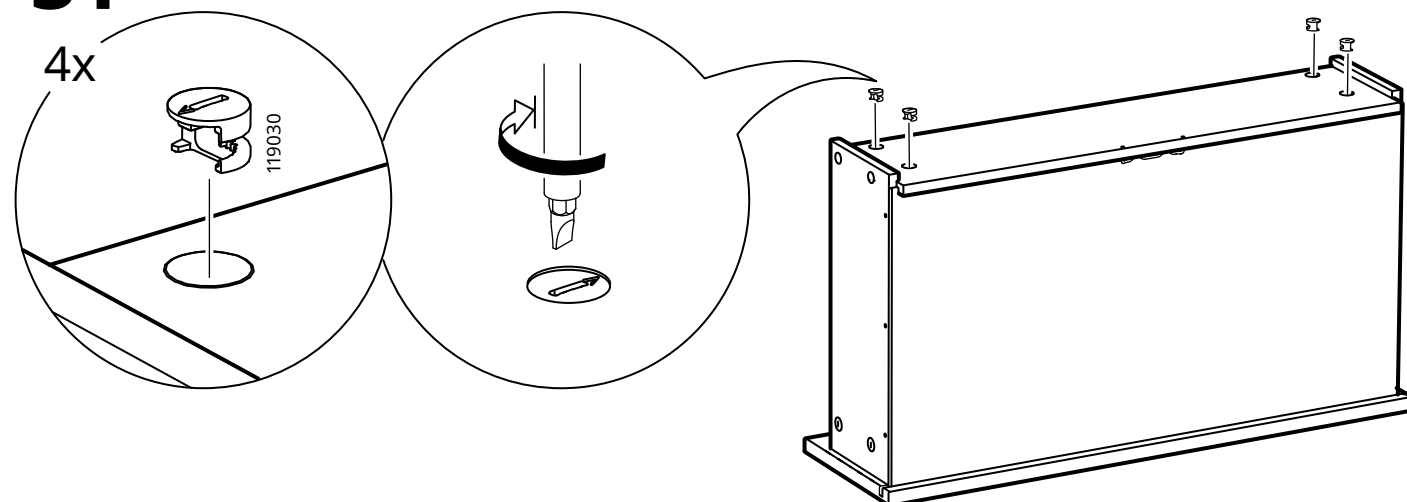

52

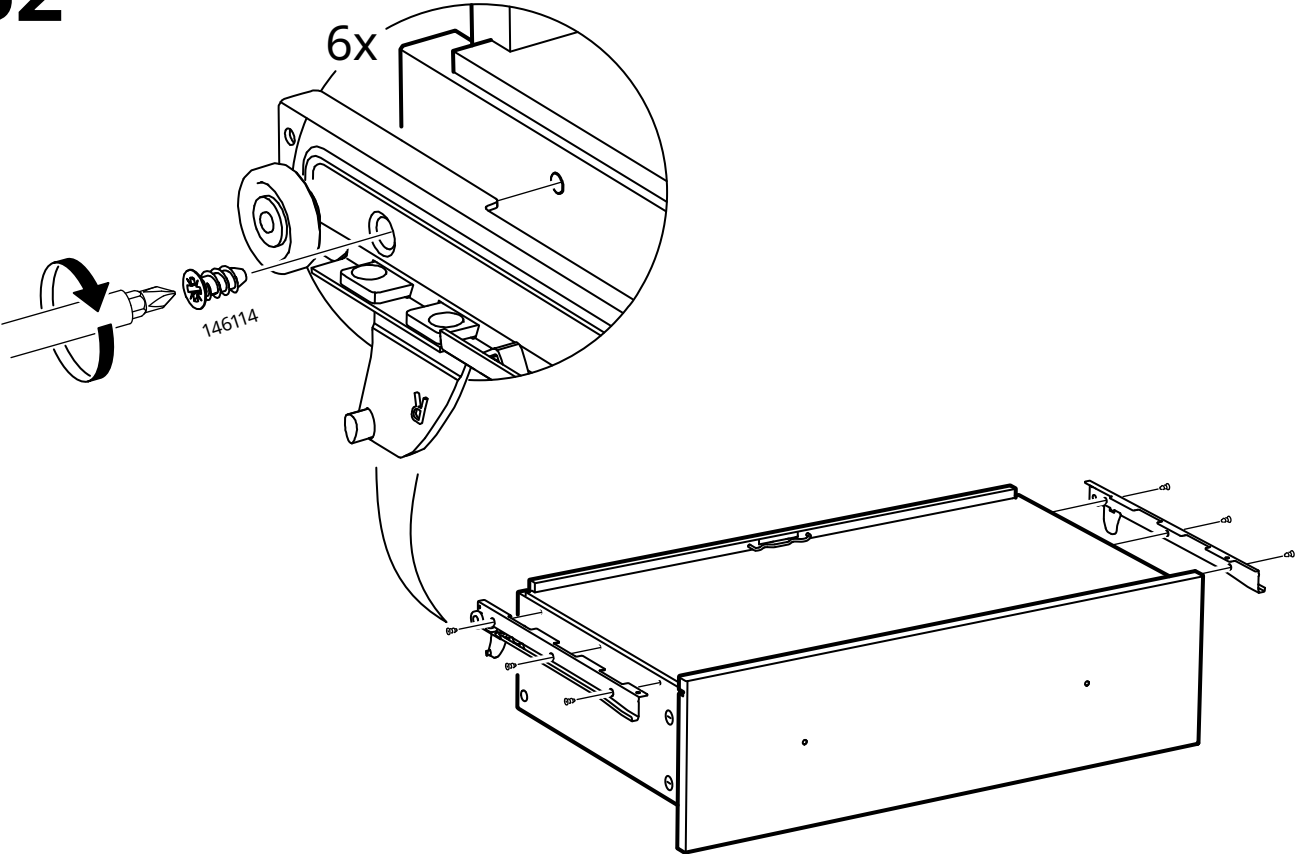

53

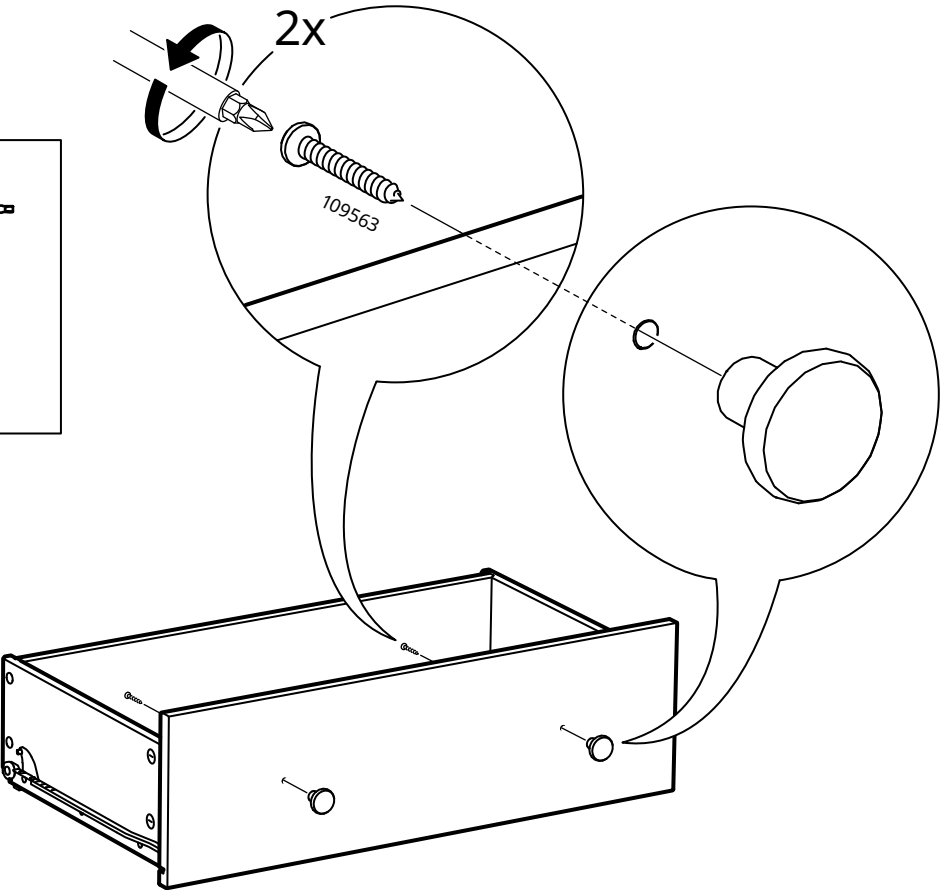
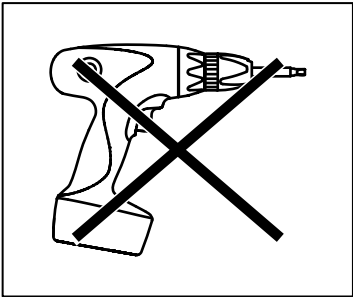

54

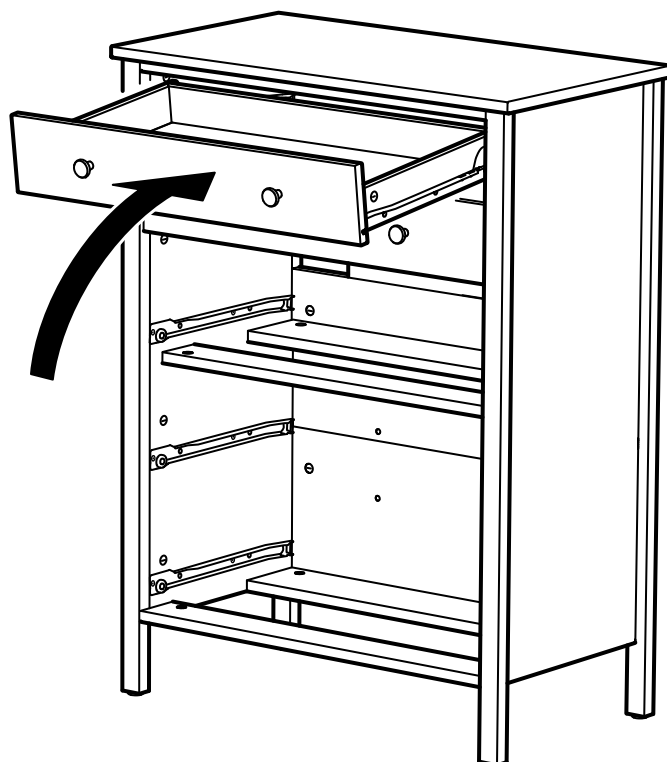

55

