

BRIMNES

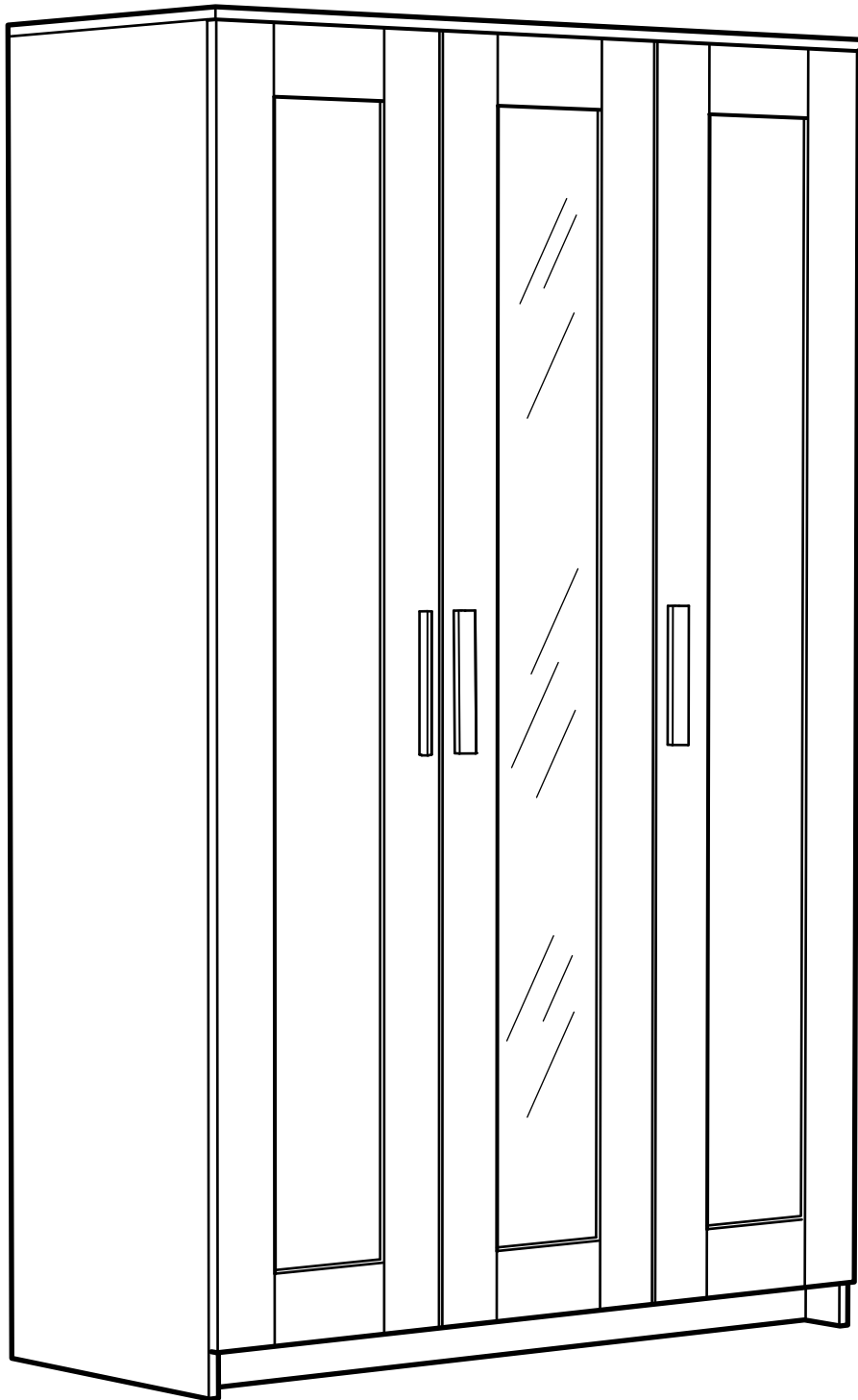

Design and Quality
IKEA of Sweden



English

WARNING

Children have died from furniture tipover. To reduce the risk of furniture tipover:

ALWAYS install anti-tip device provided.

NEVER put a TV on this product.

NEVER allow children to stand, climb, or hang on any drawers, doors, or shelves.

NEVER open more than one drawer at a time.

Place heaviest items in the lowest drawers.

English

Read and follow each step of the instruction carefully.

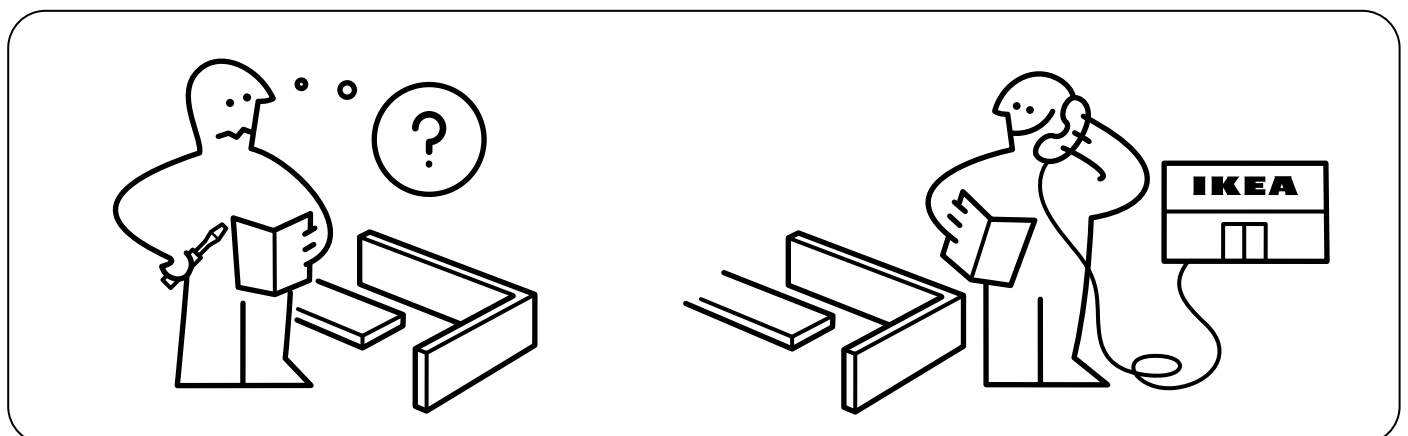
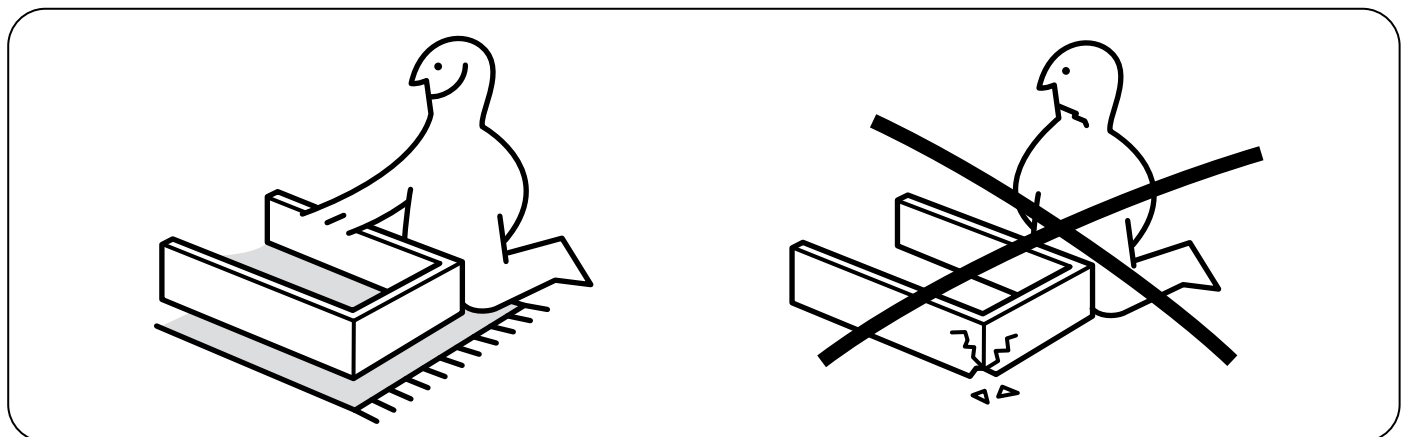
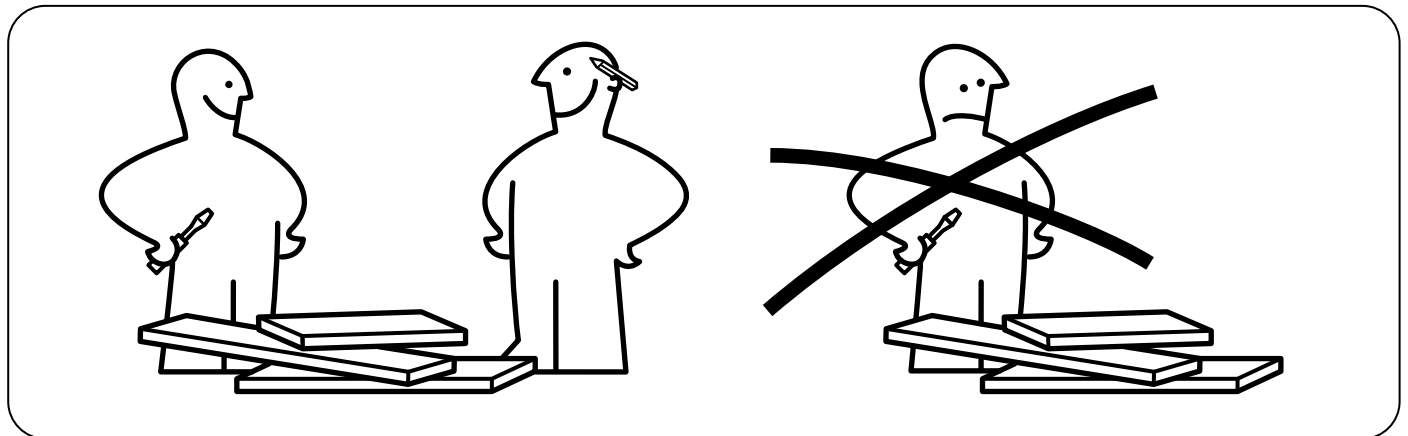
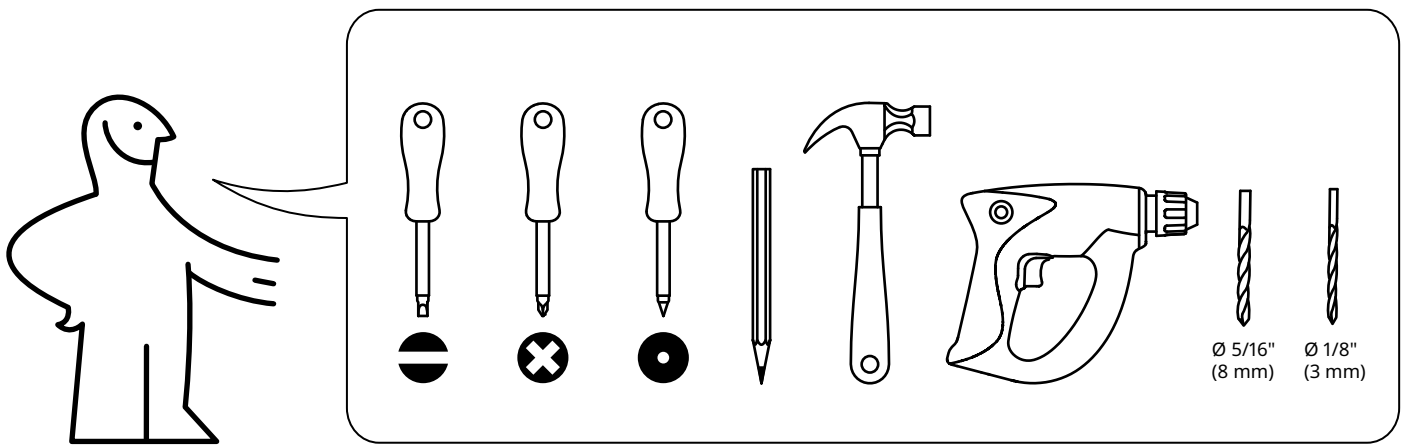

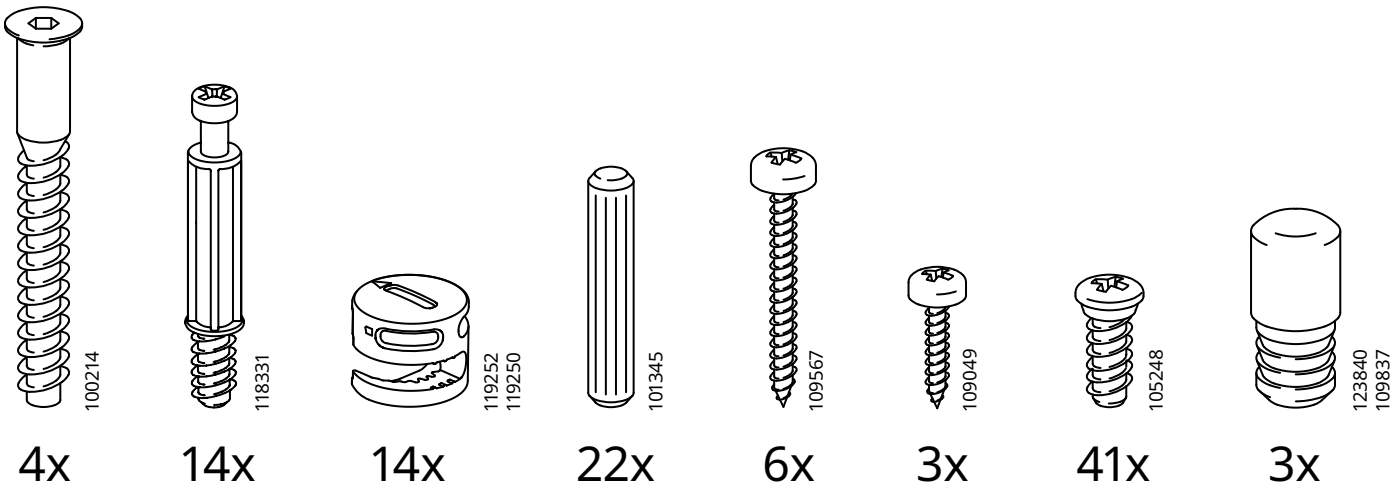
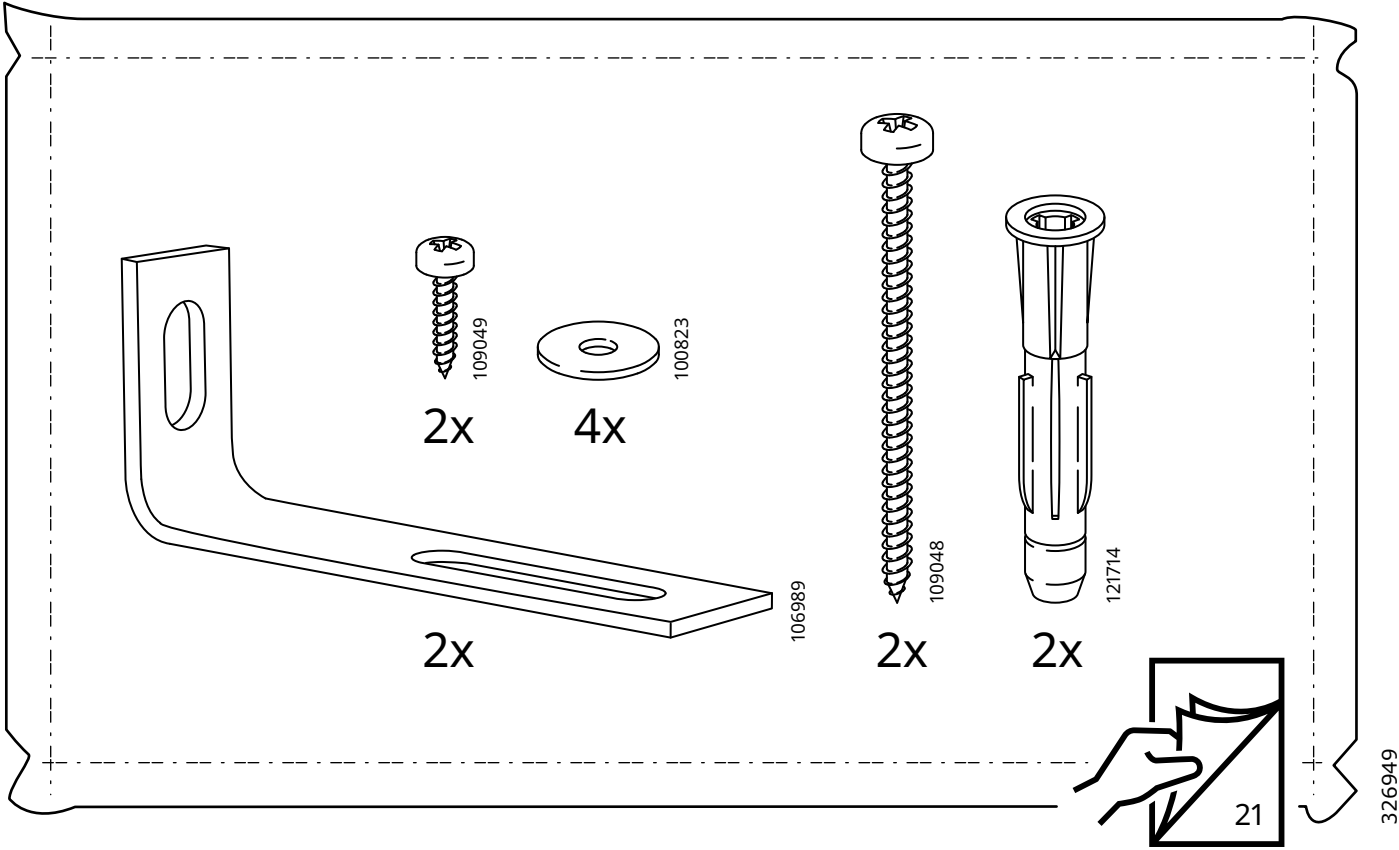
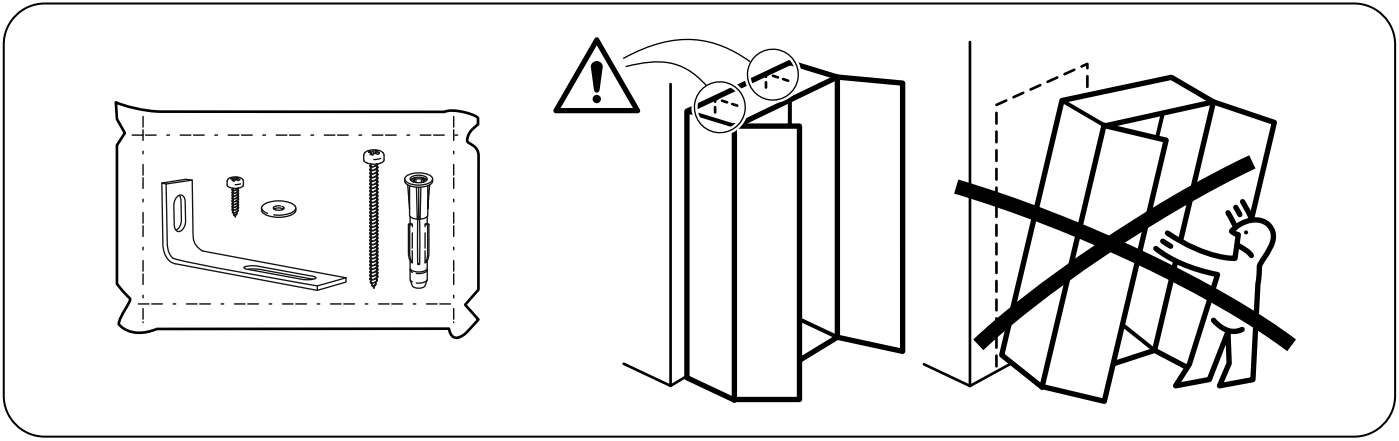

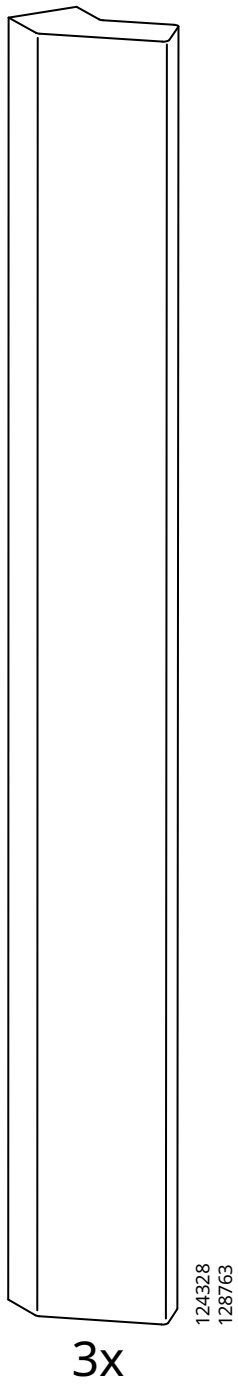

3x

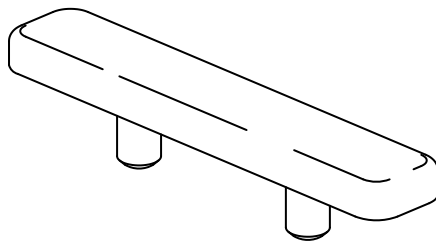

6x

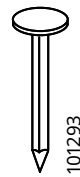

60x

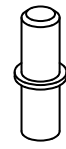

12x

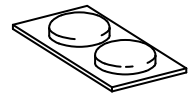

2x

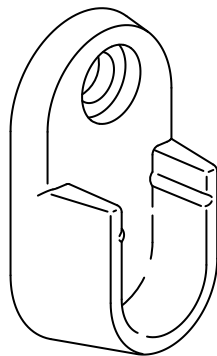

2x

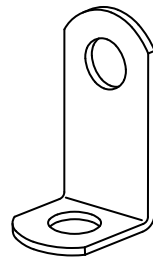

3x

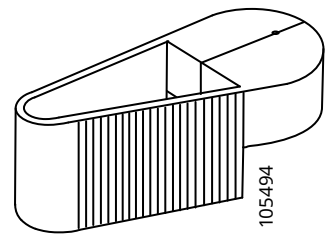

1x

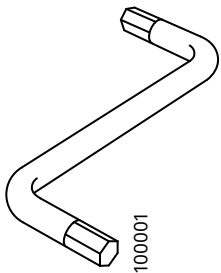

1x

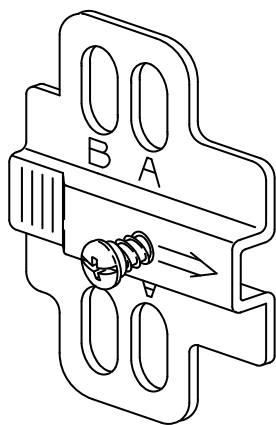

9x

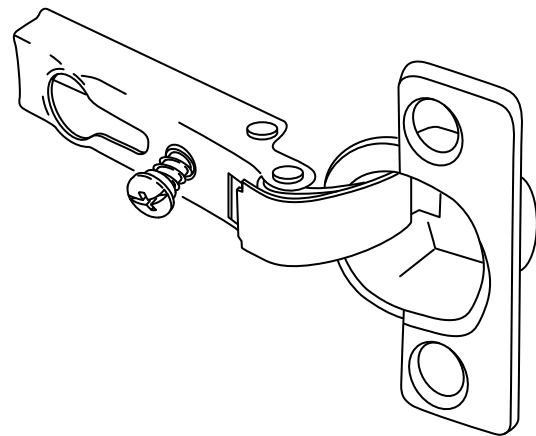

9x

1

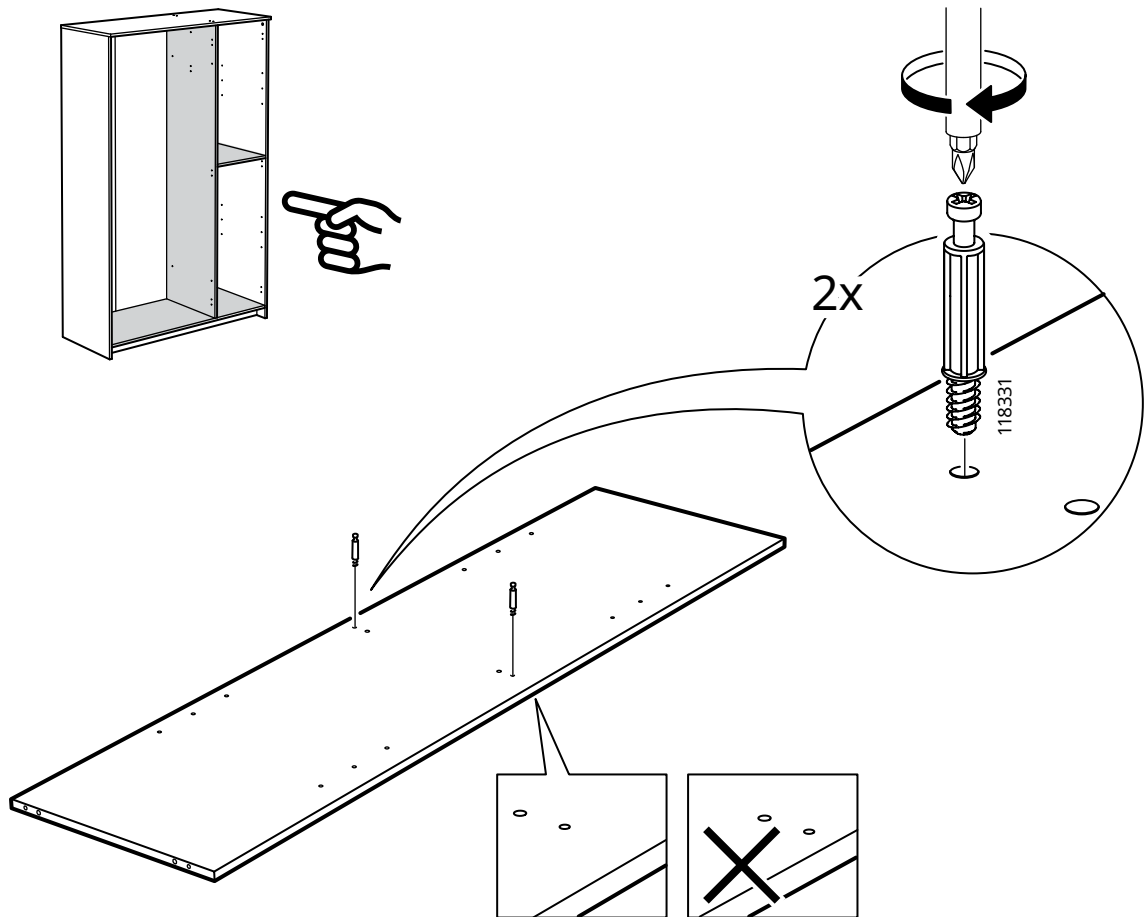

2

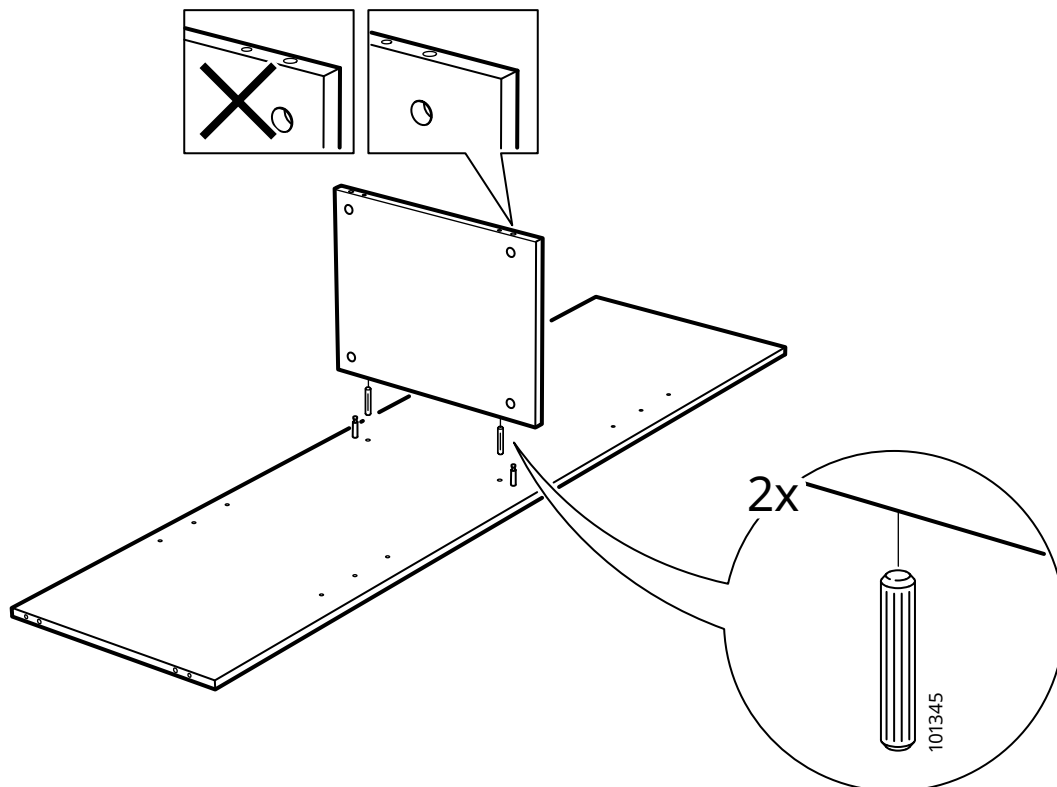

3

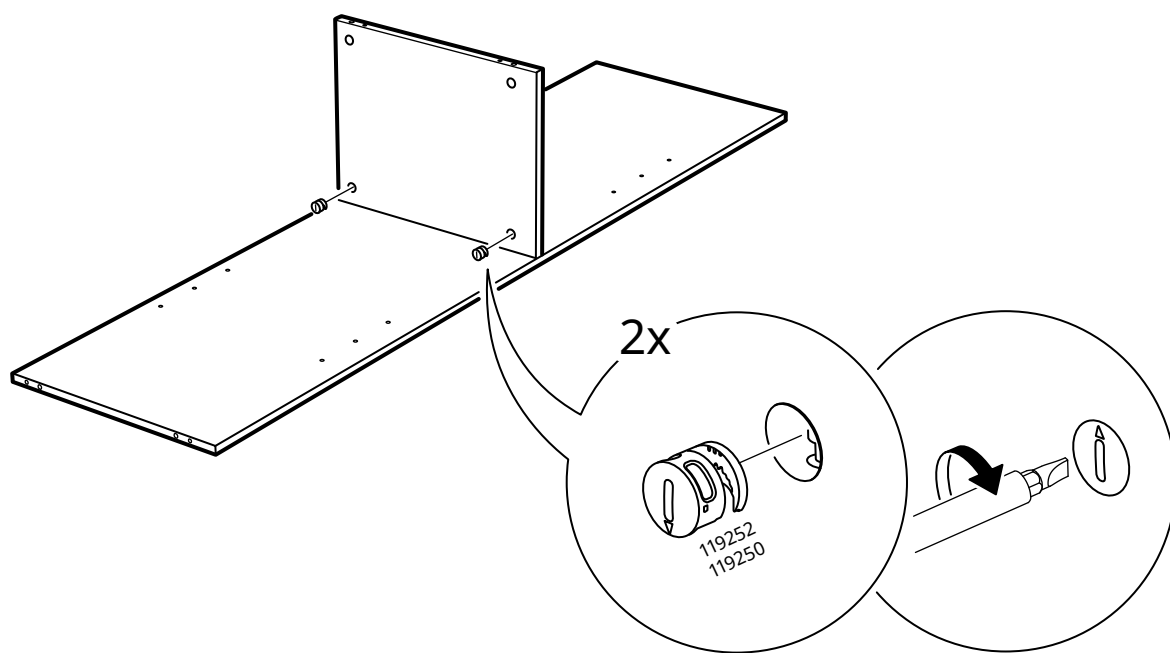

4

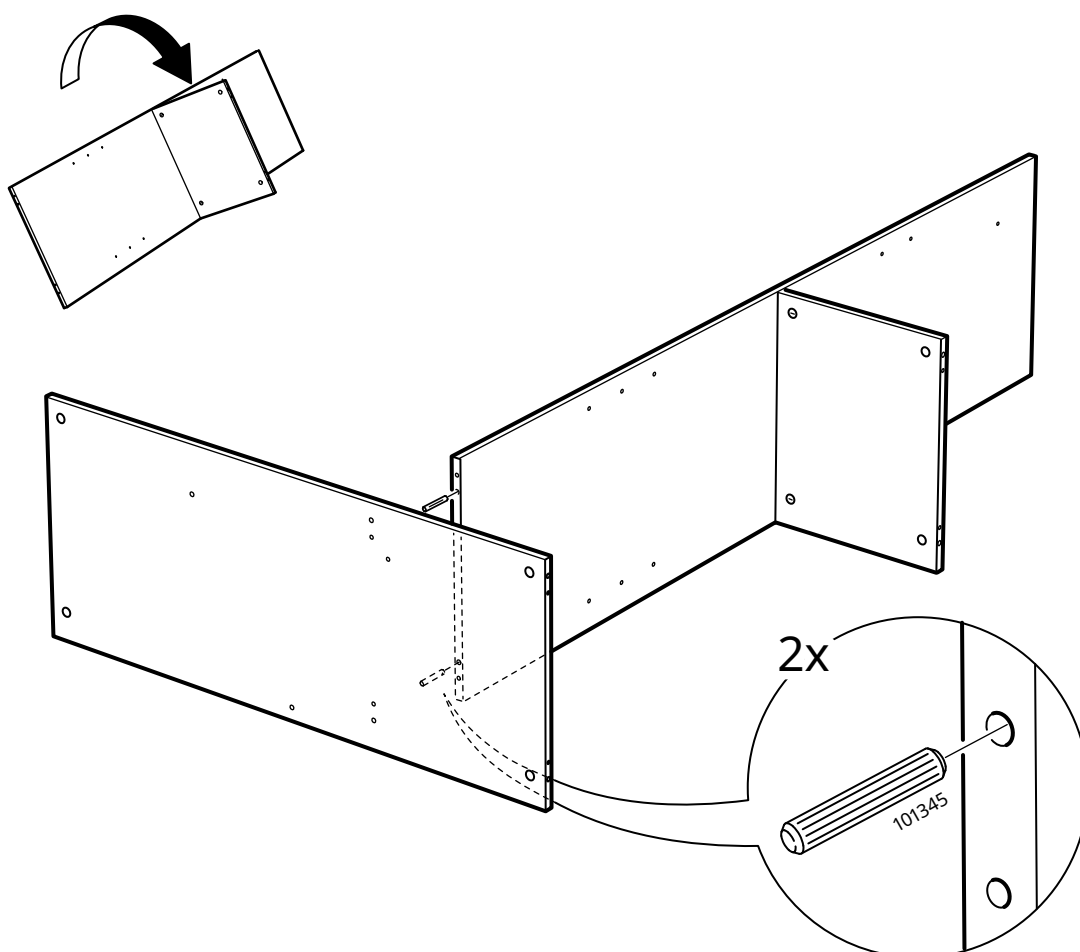

5

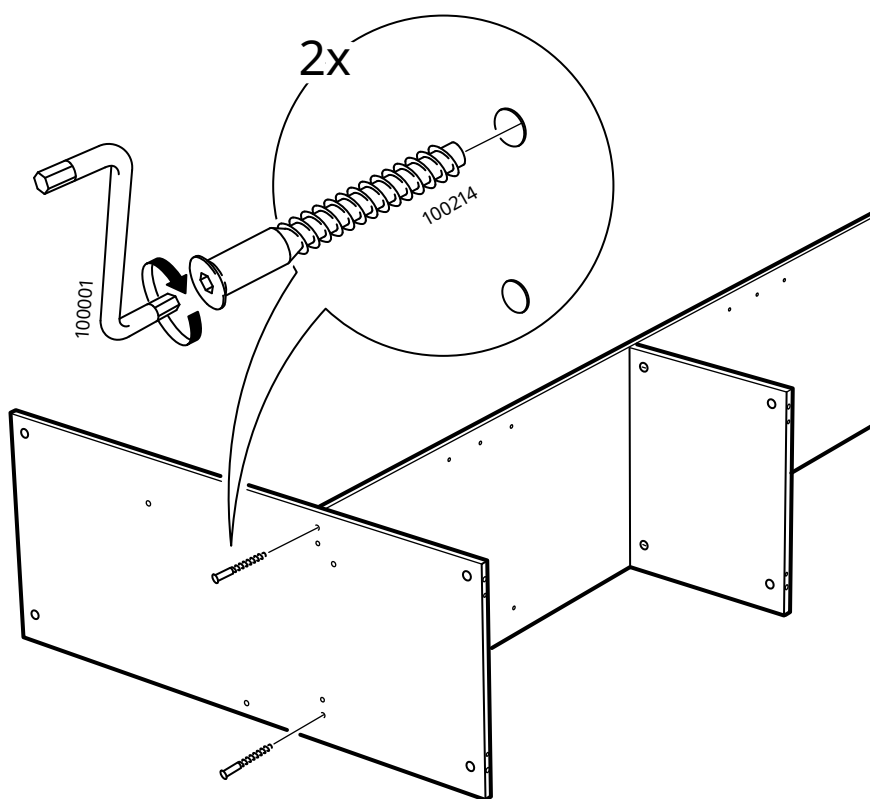

6

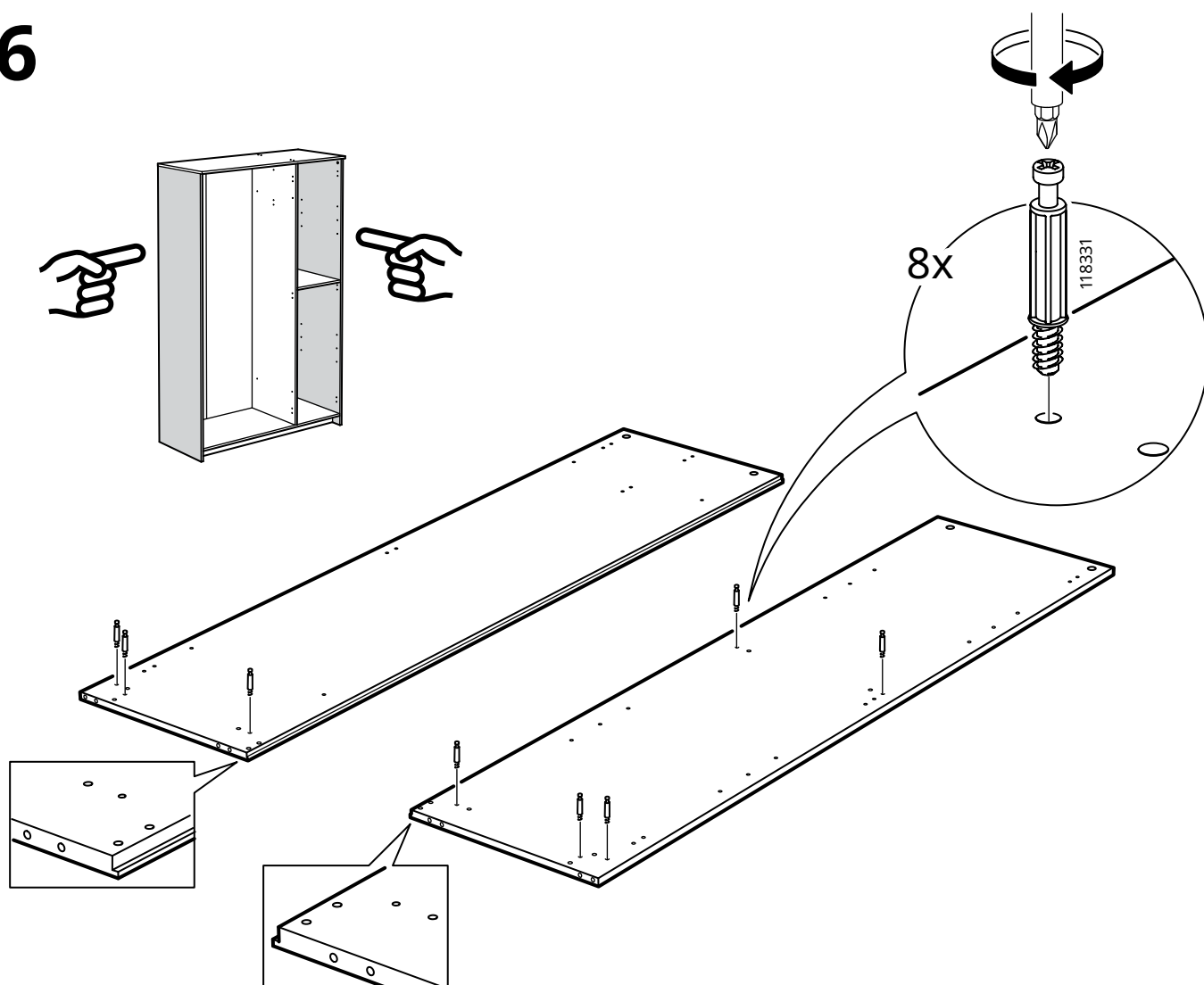

7

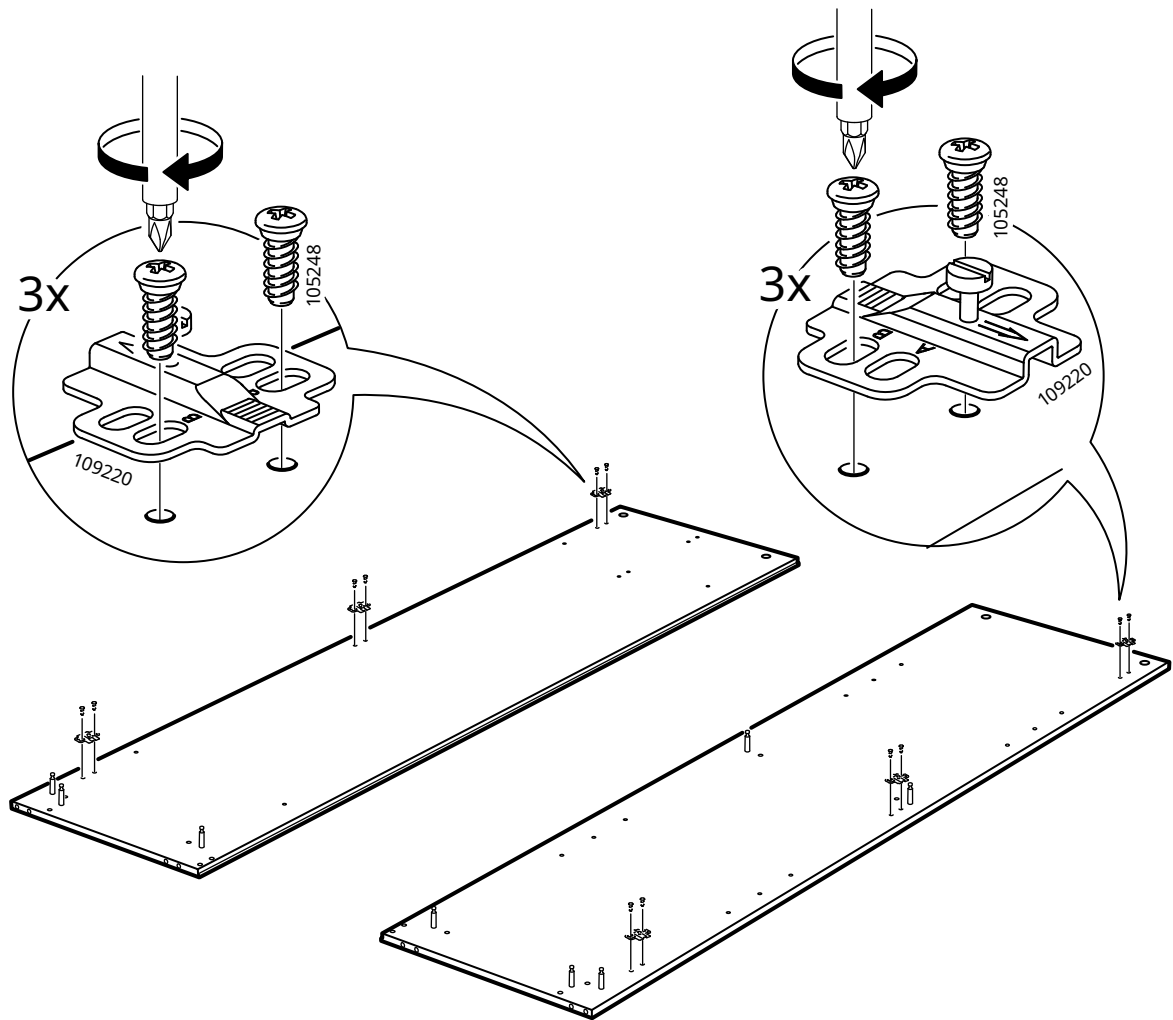

8

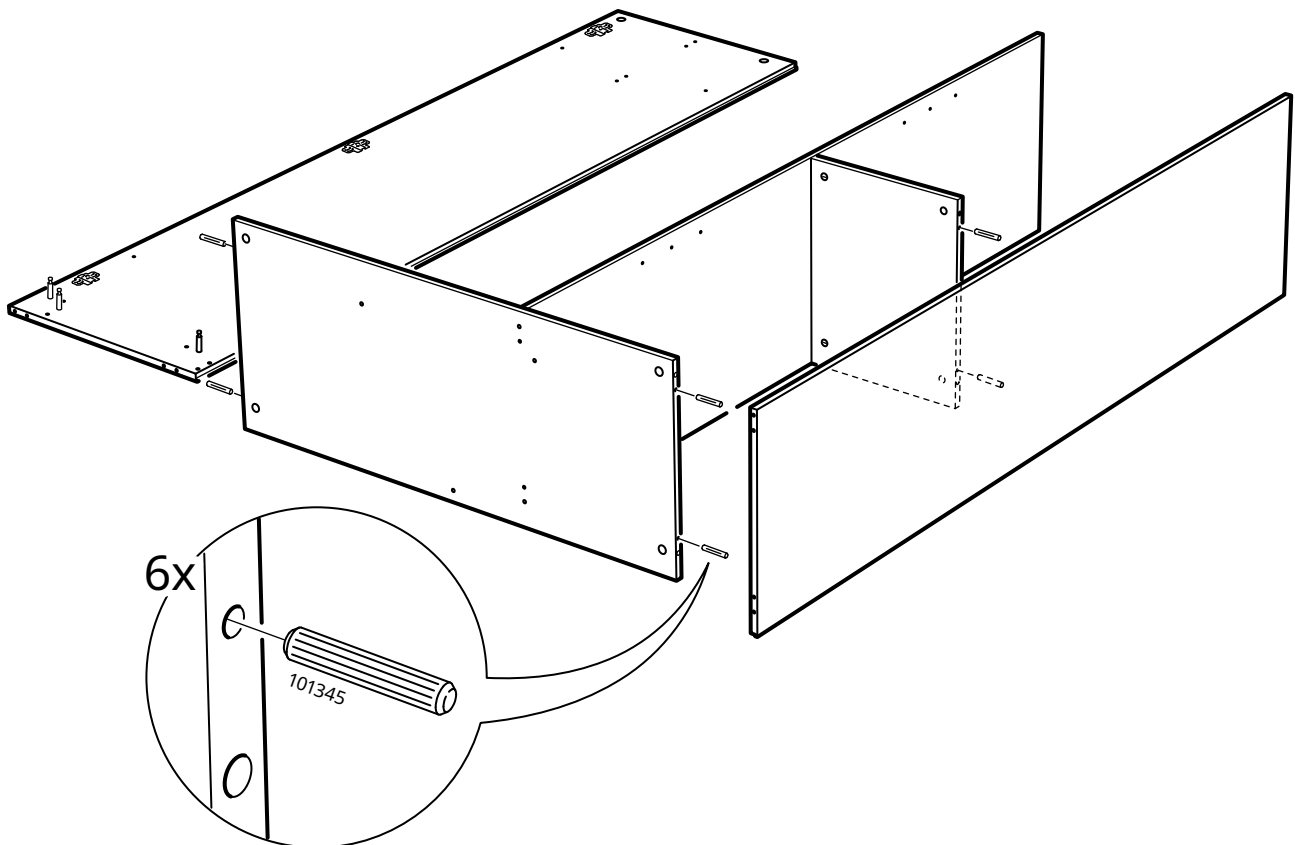

9

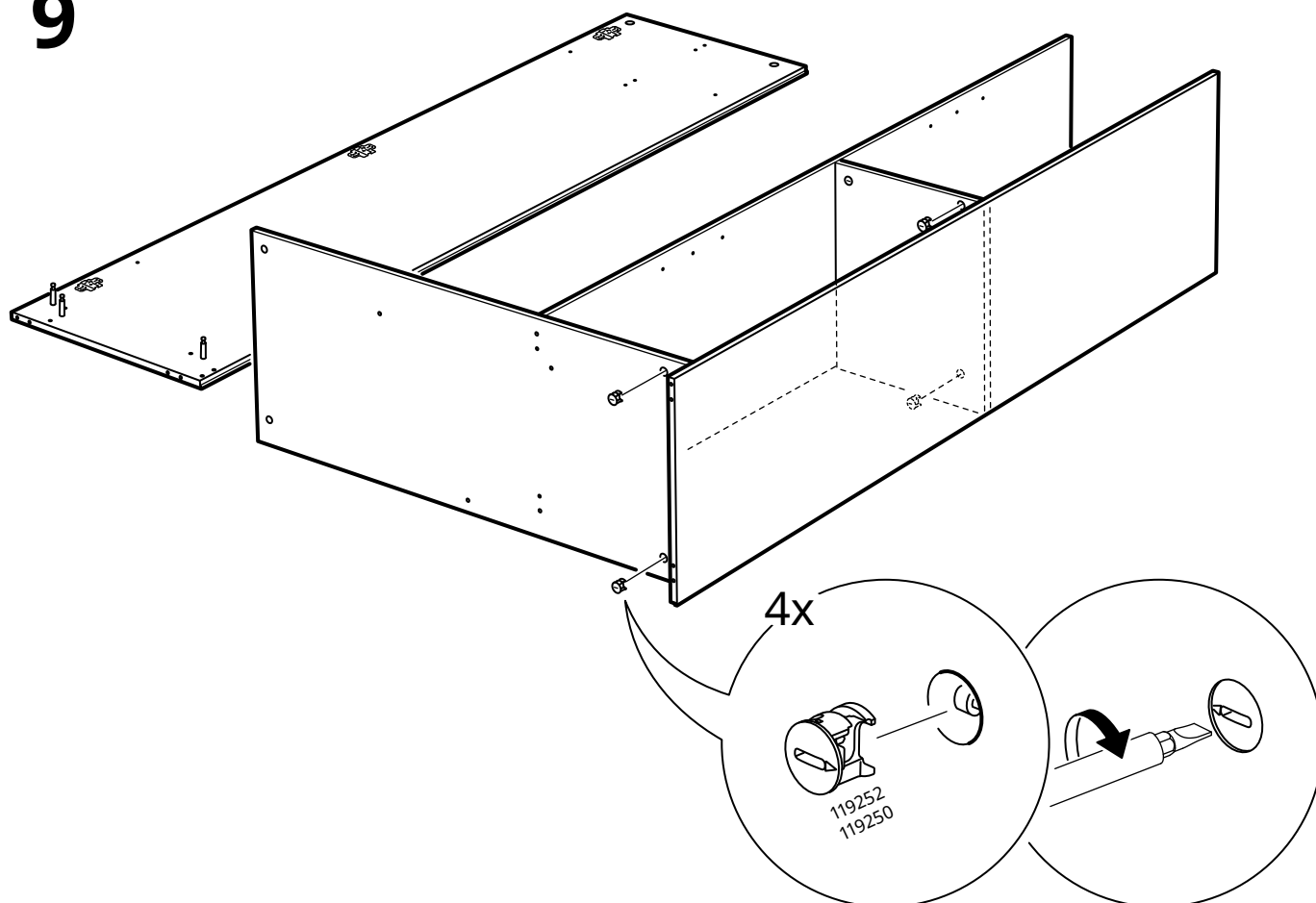

10

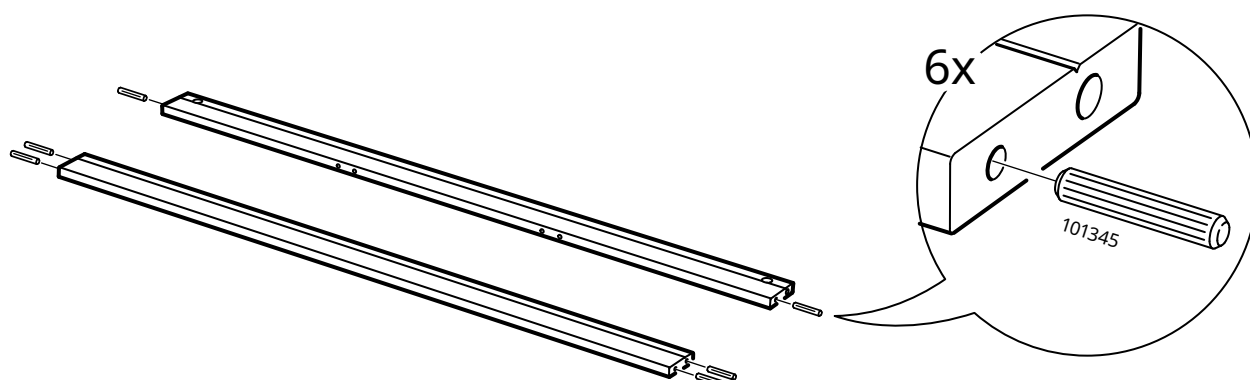

11

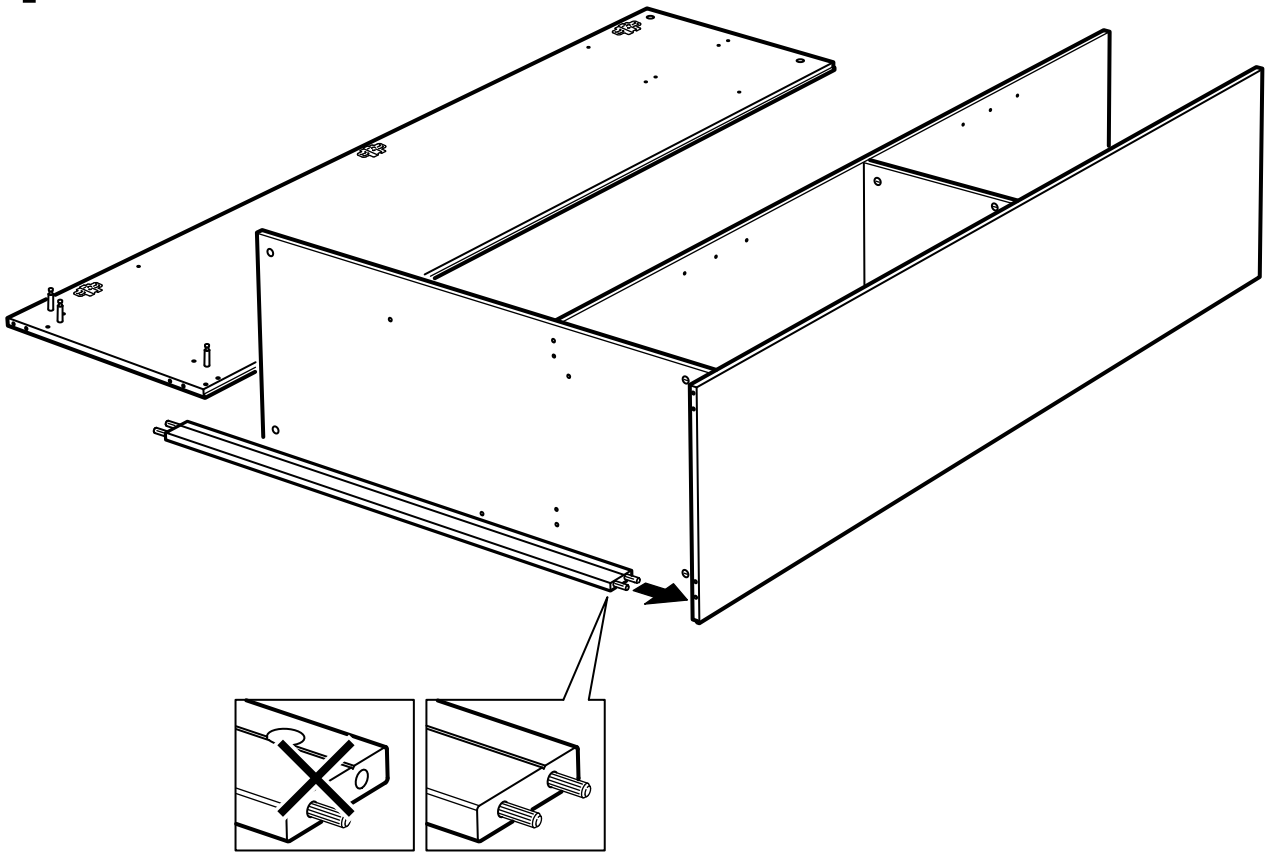

12

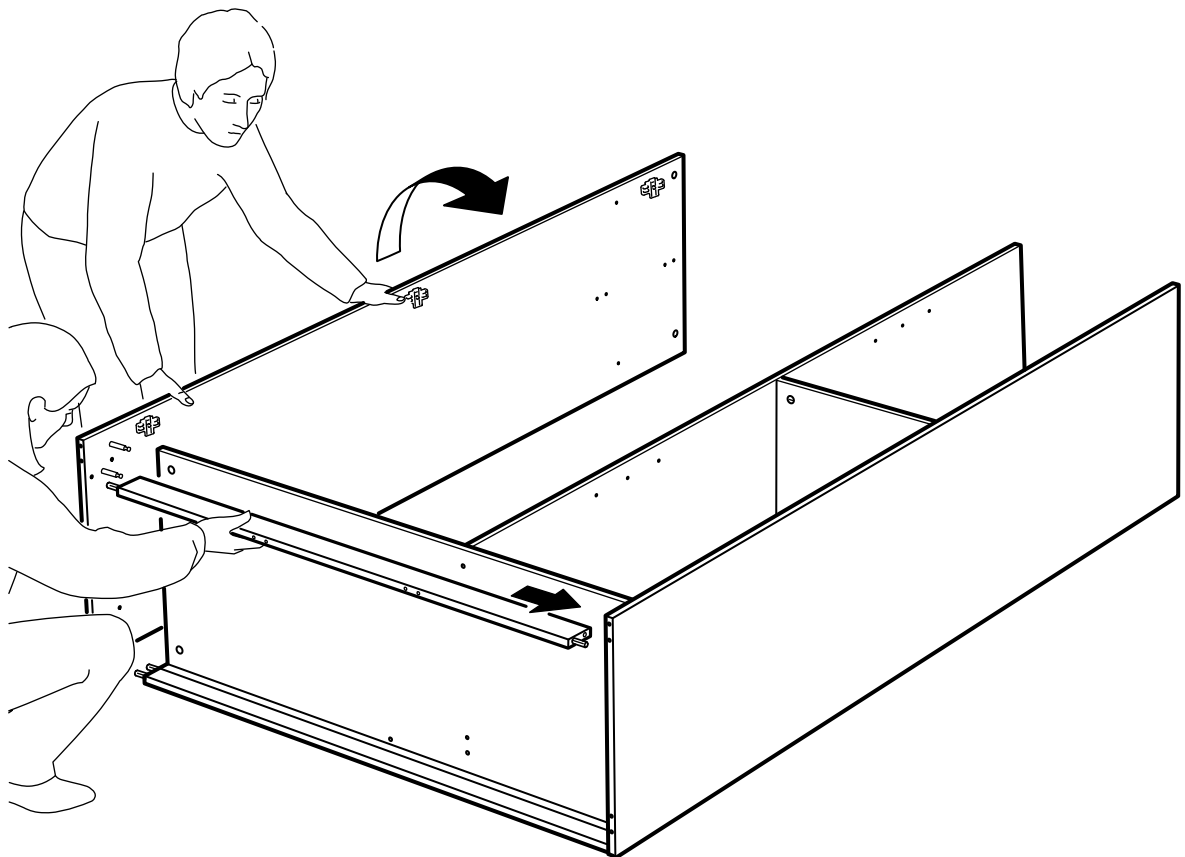

13

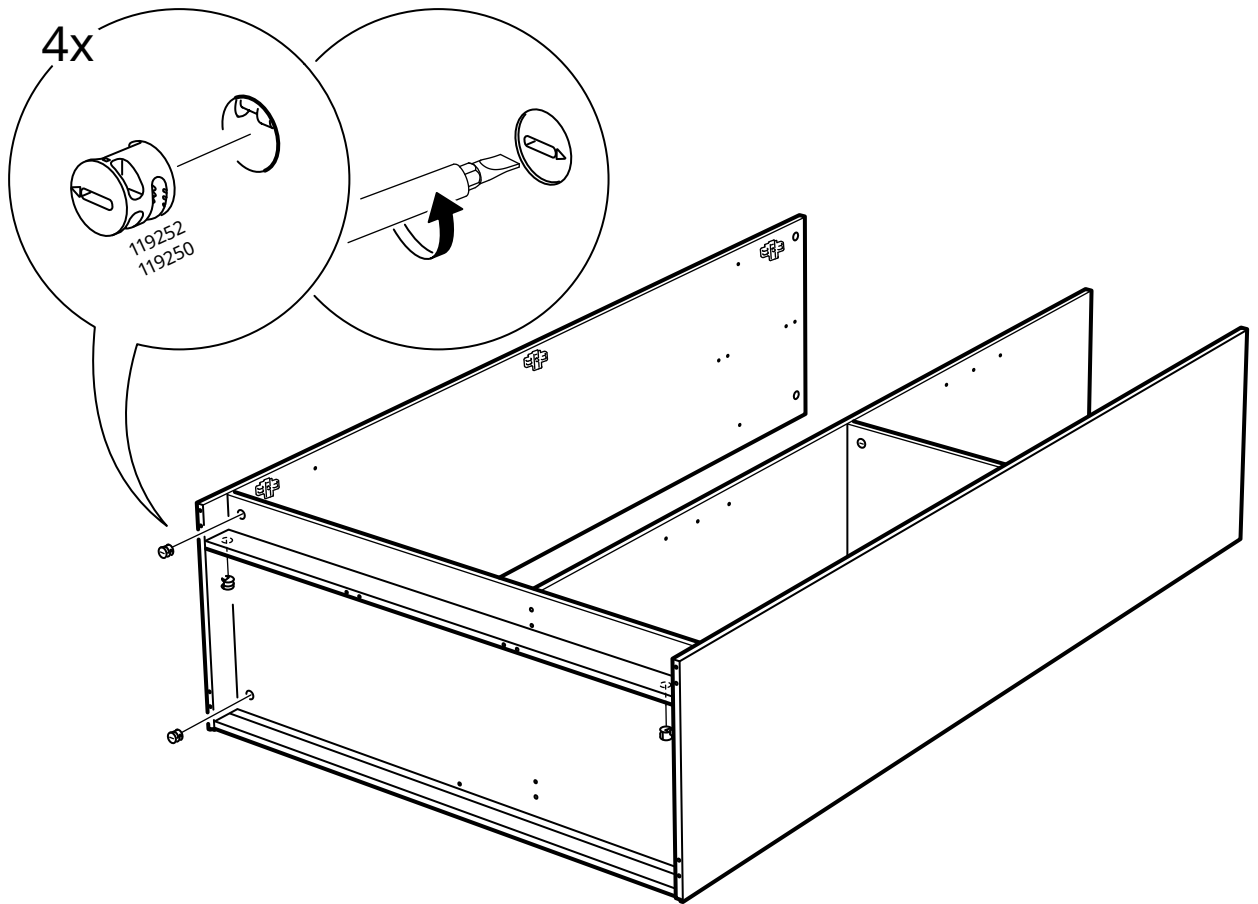

14

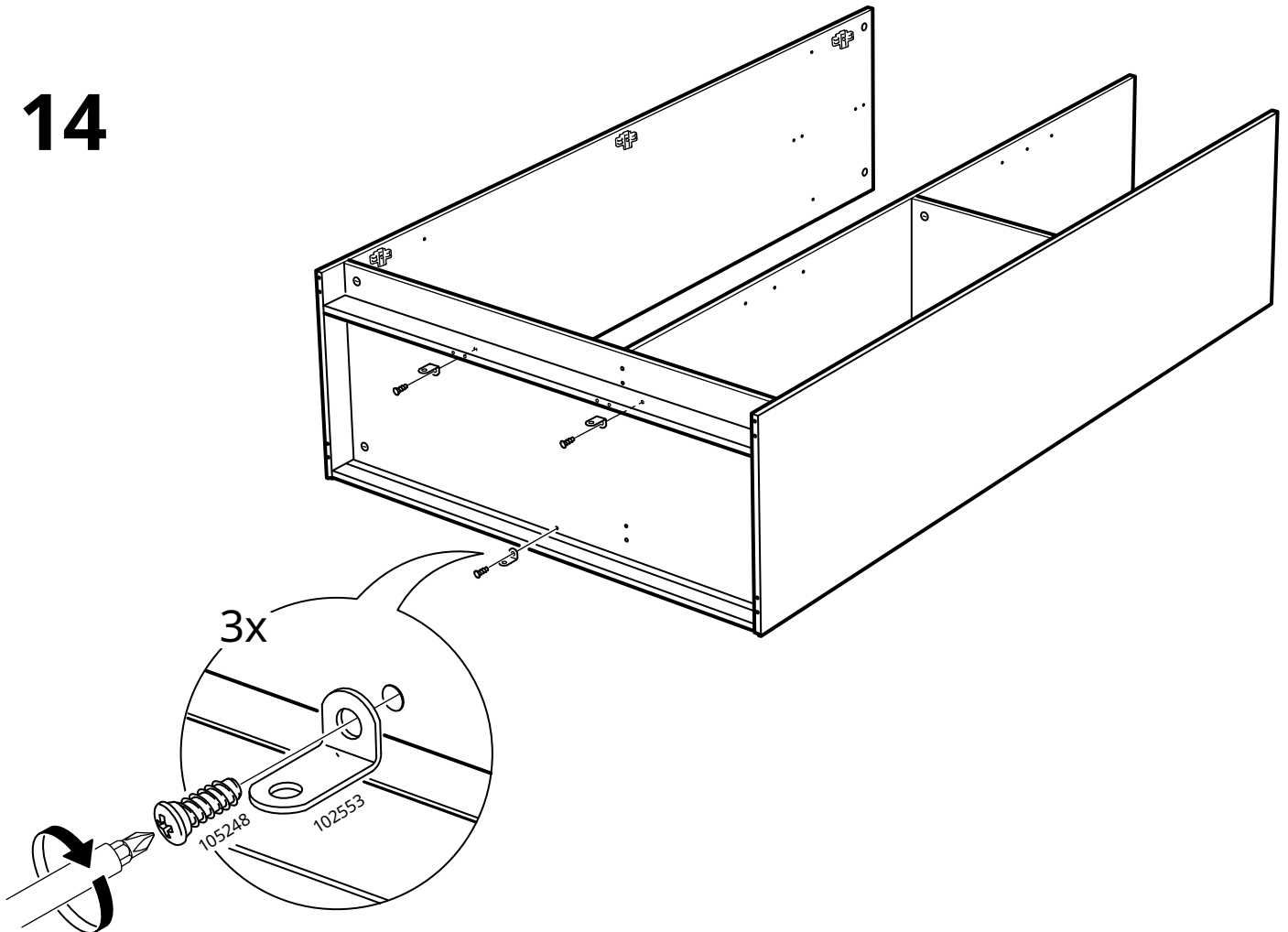

15

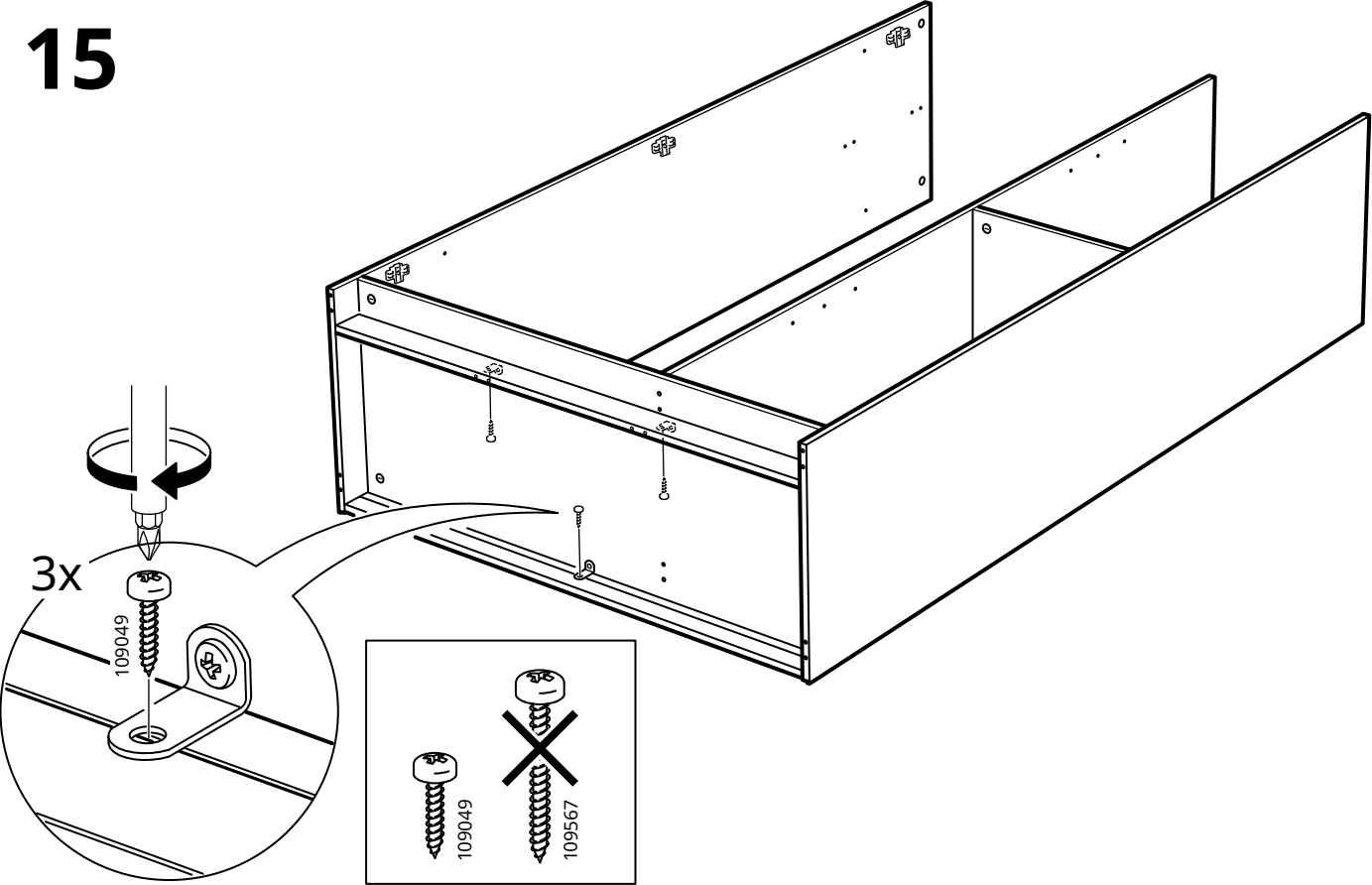

16

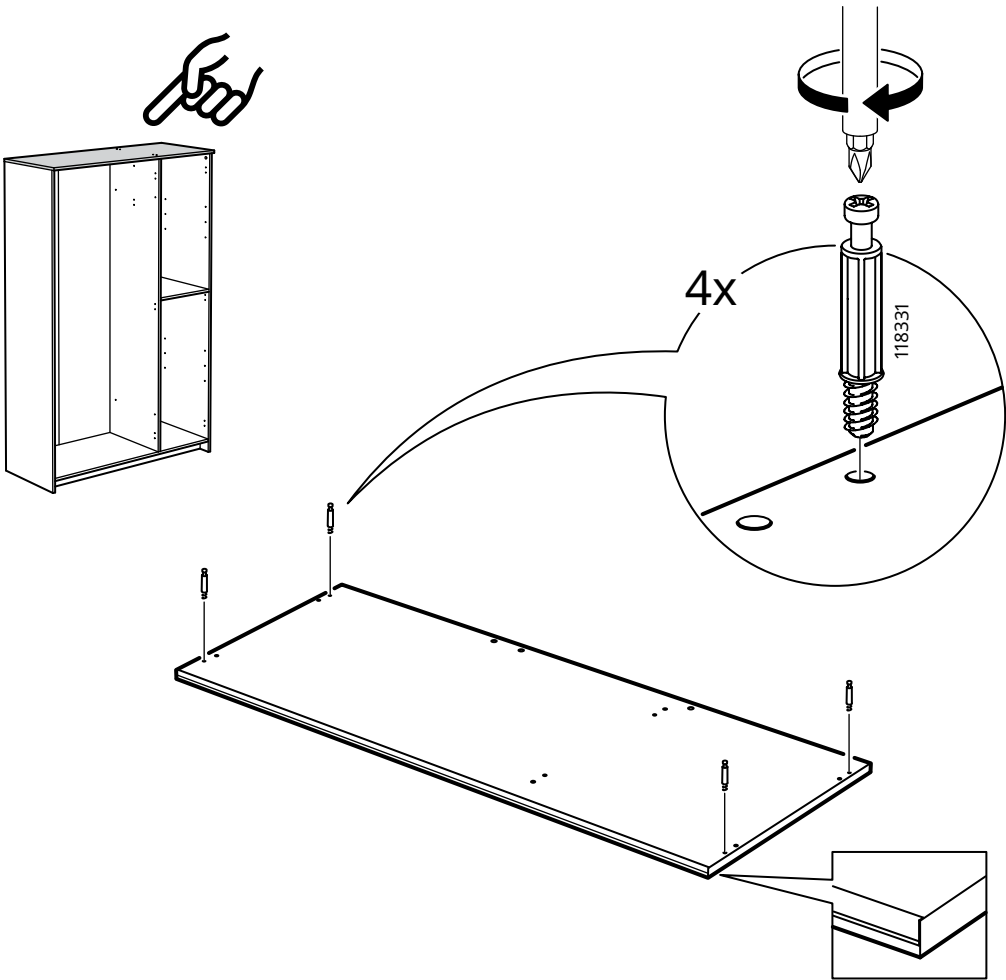

17

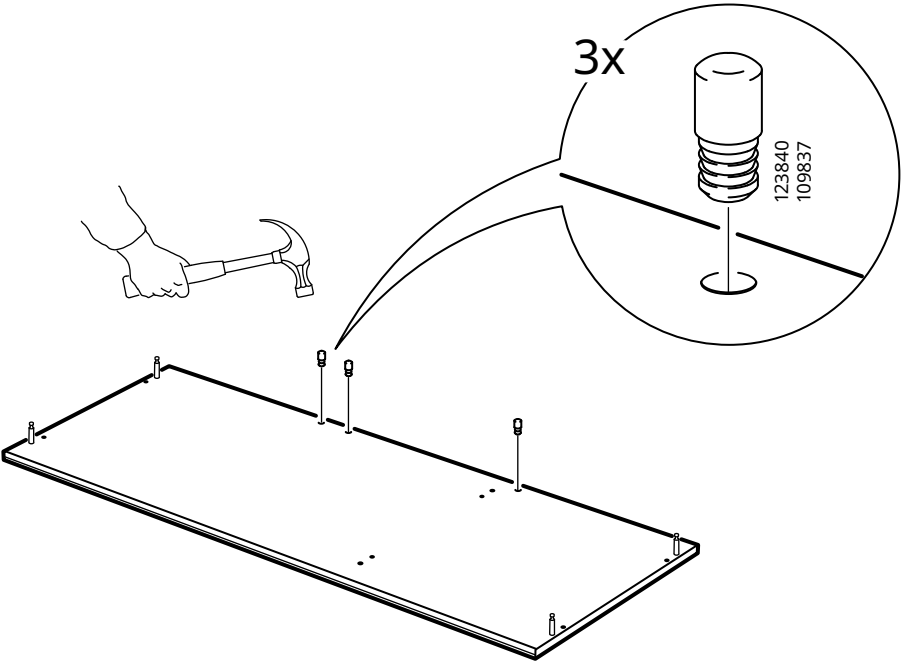

18

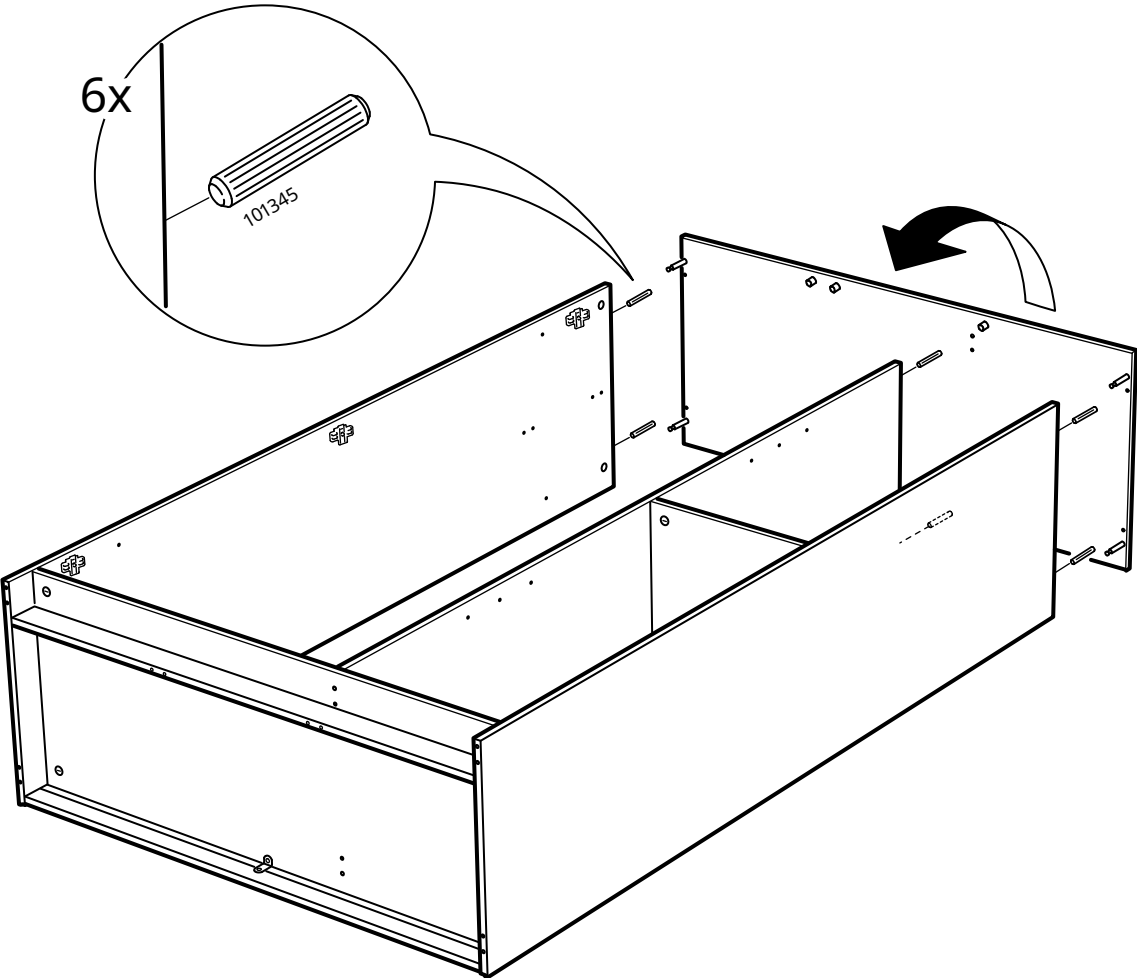

19

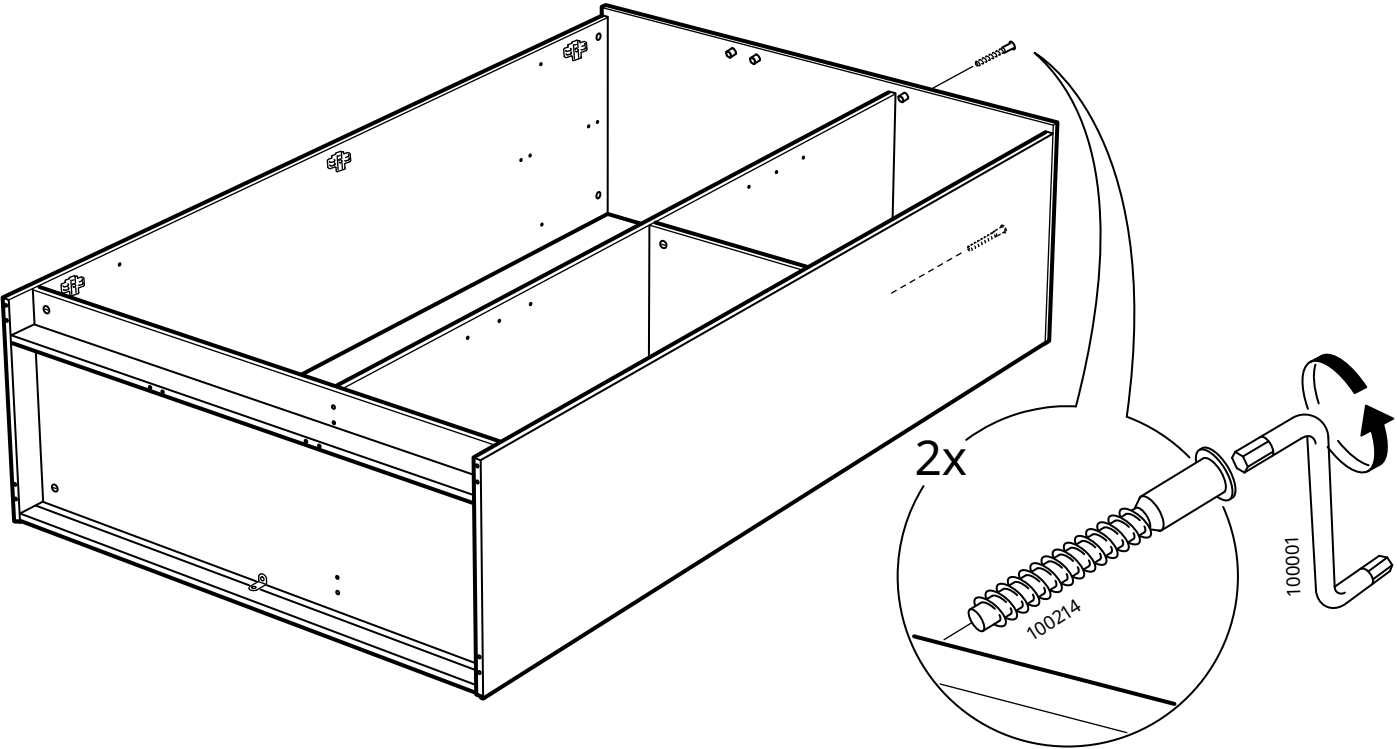

20

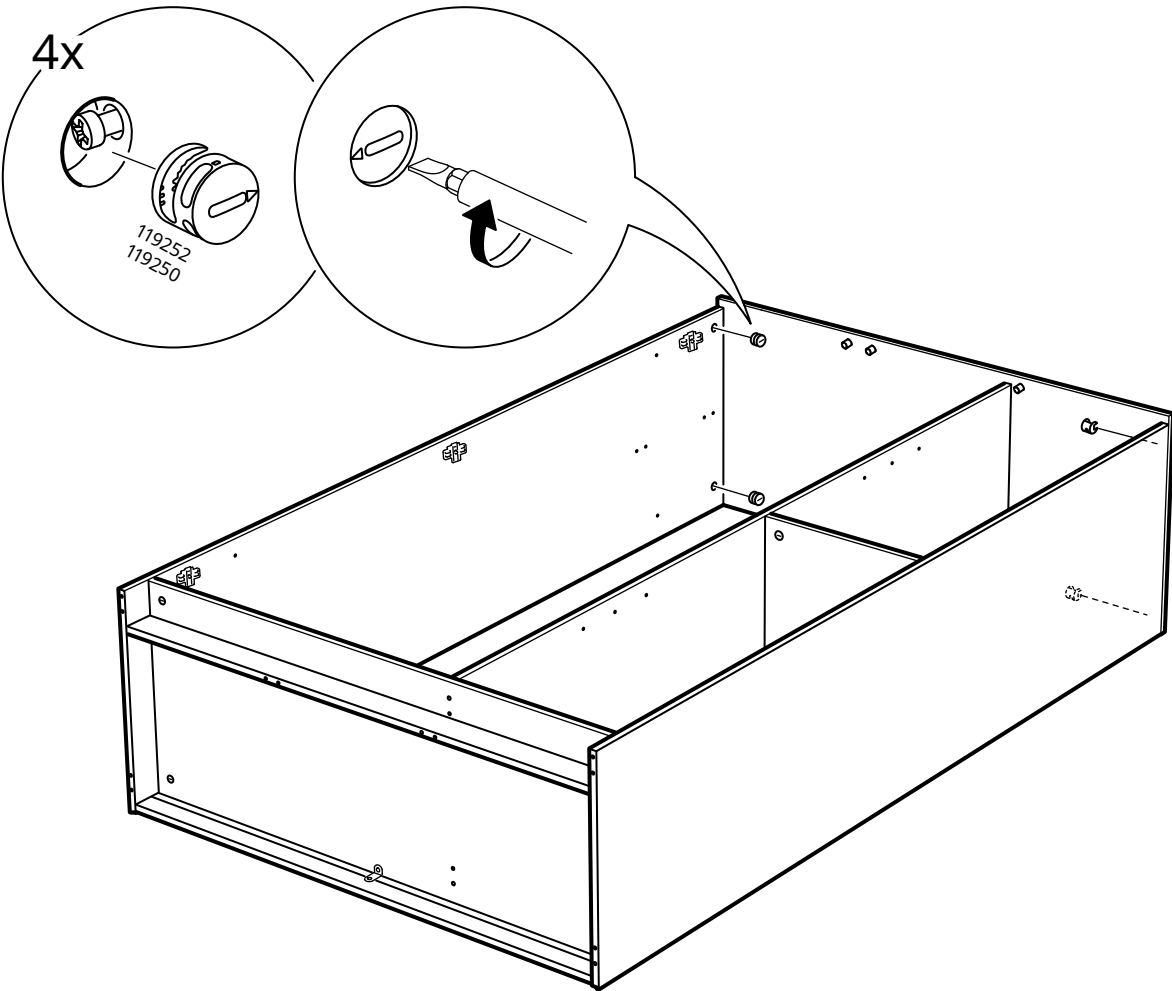

21

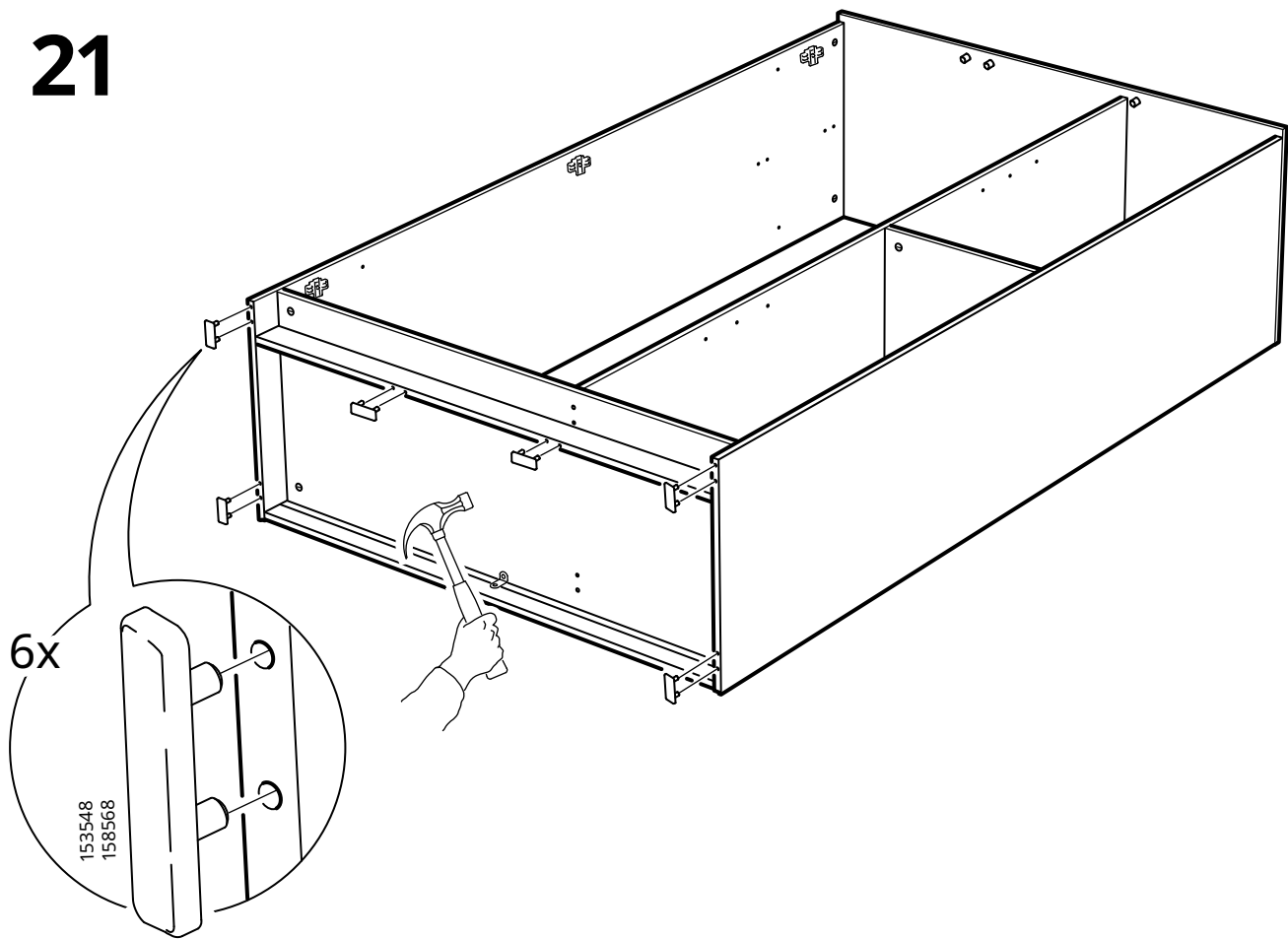

22

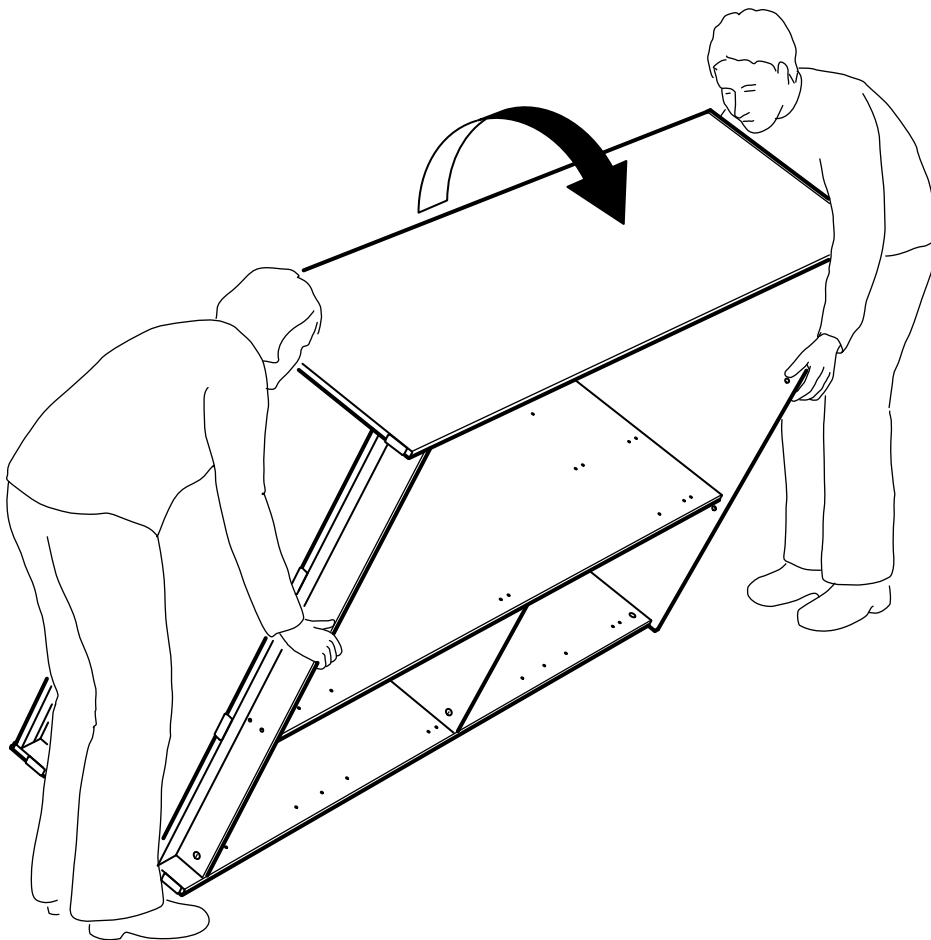

23

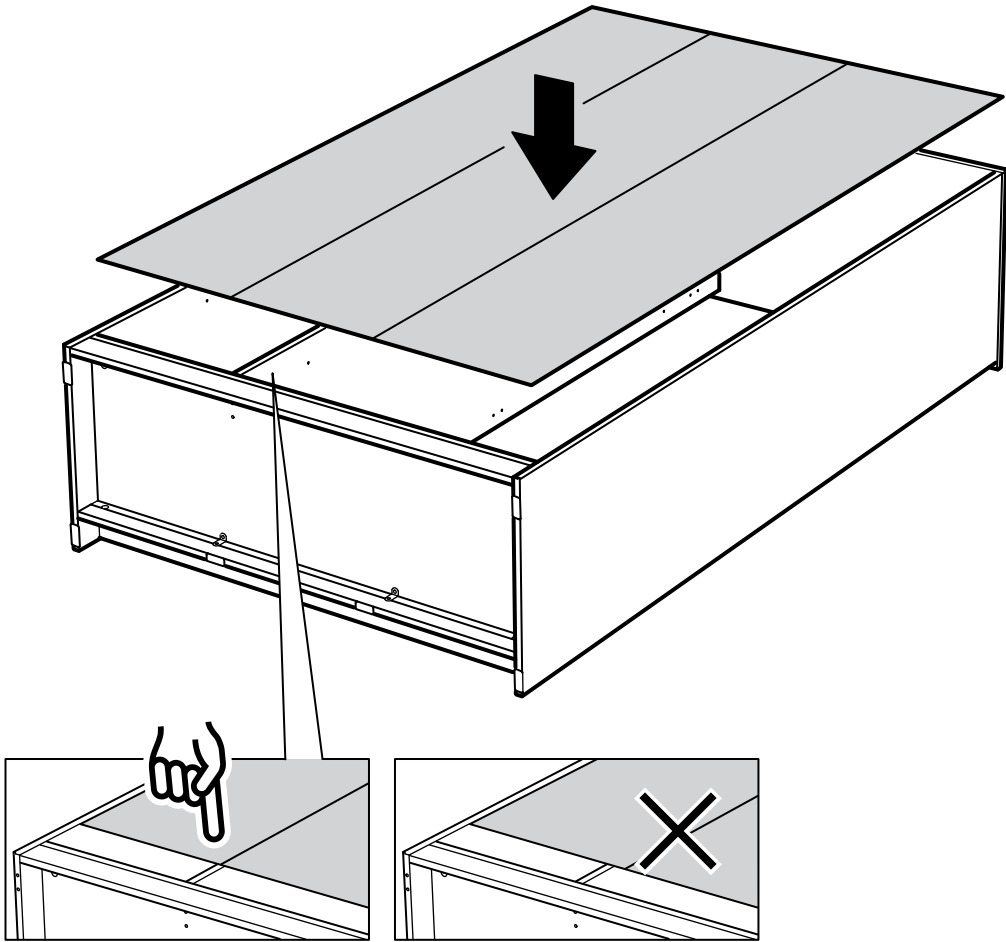

24

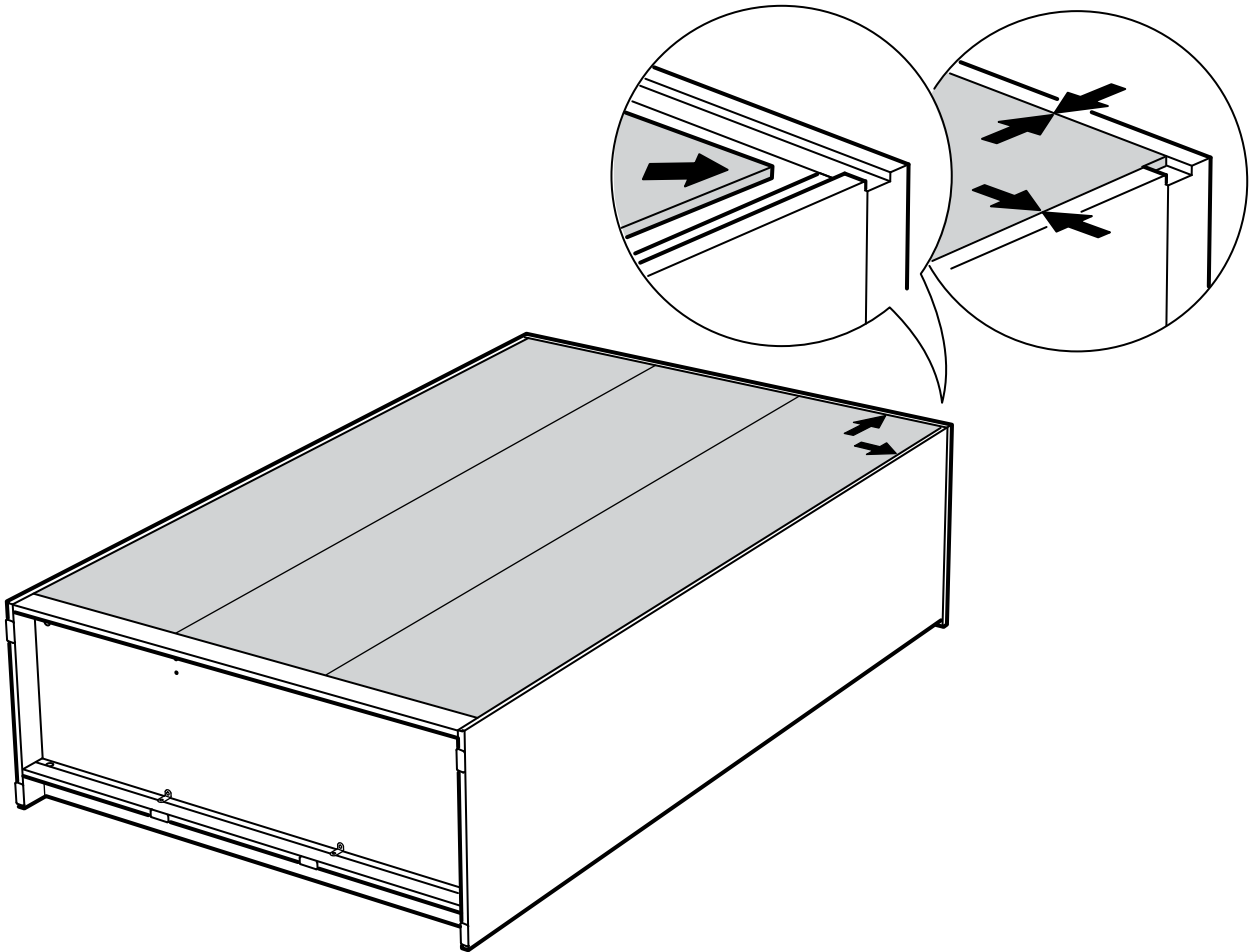

25

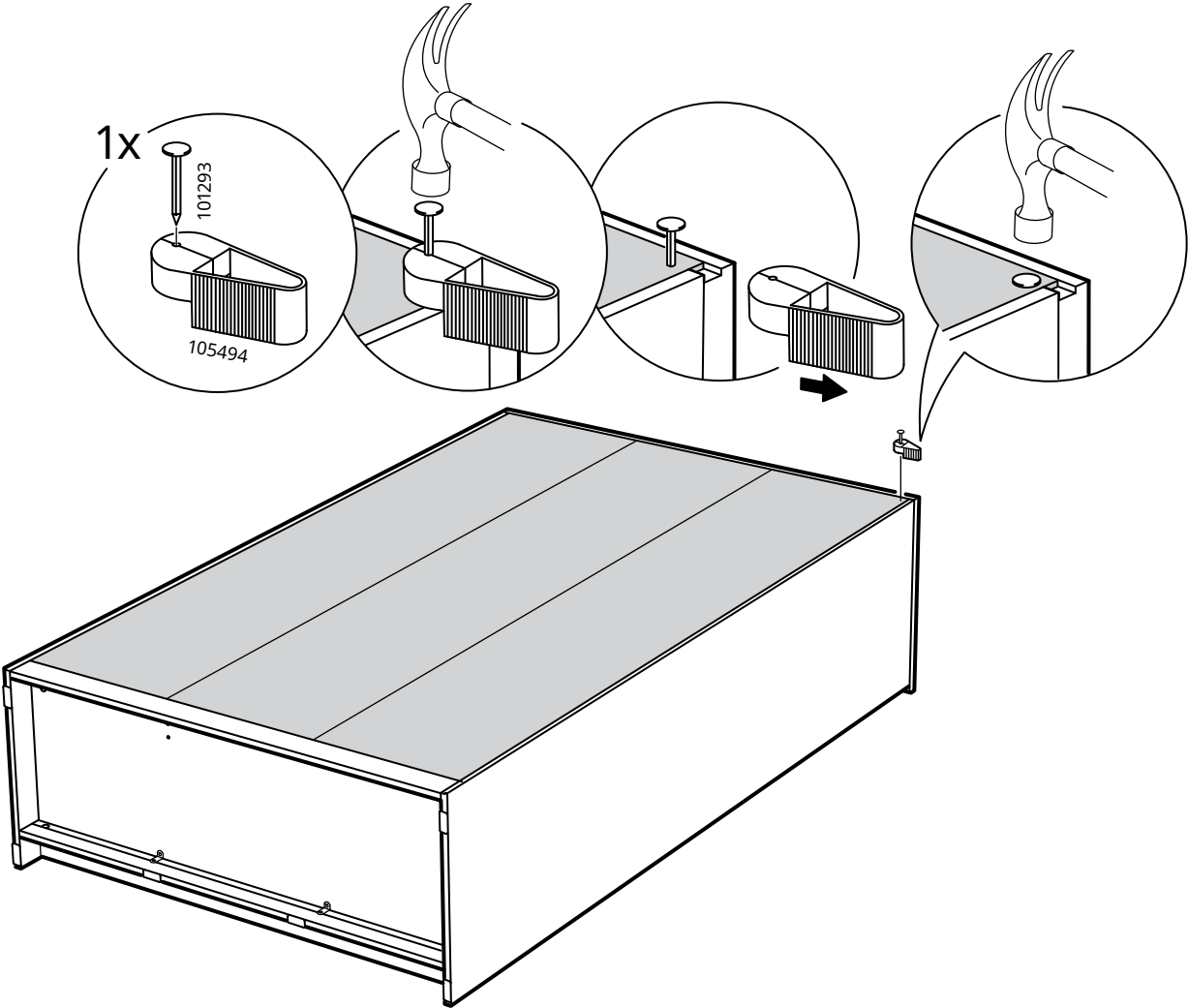

26

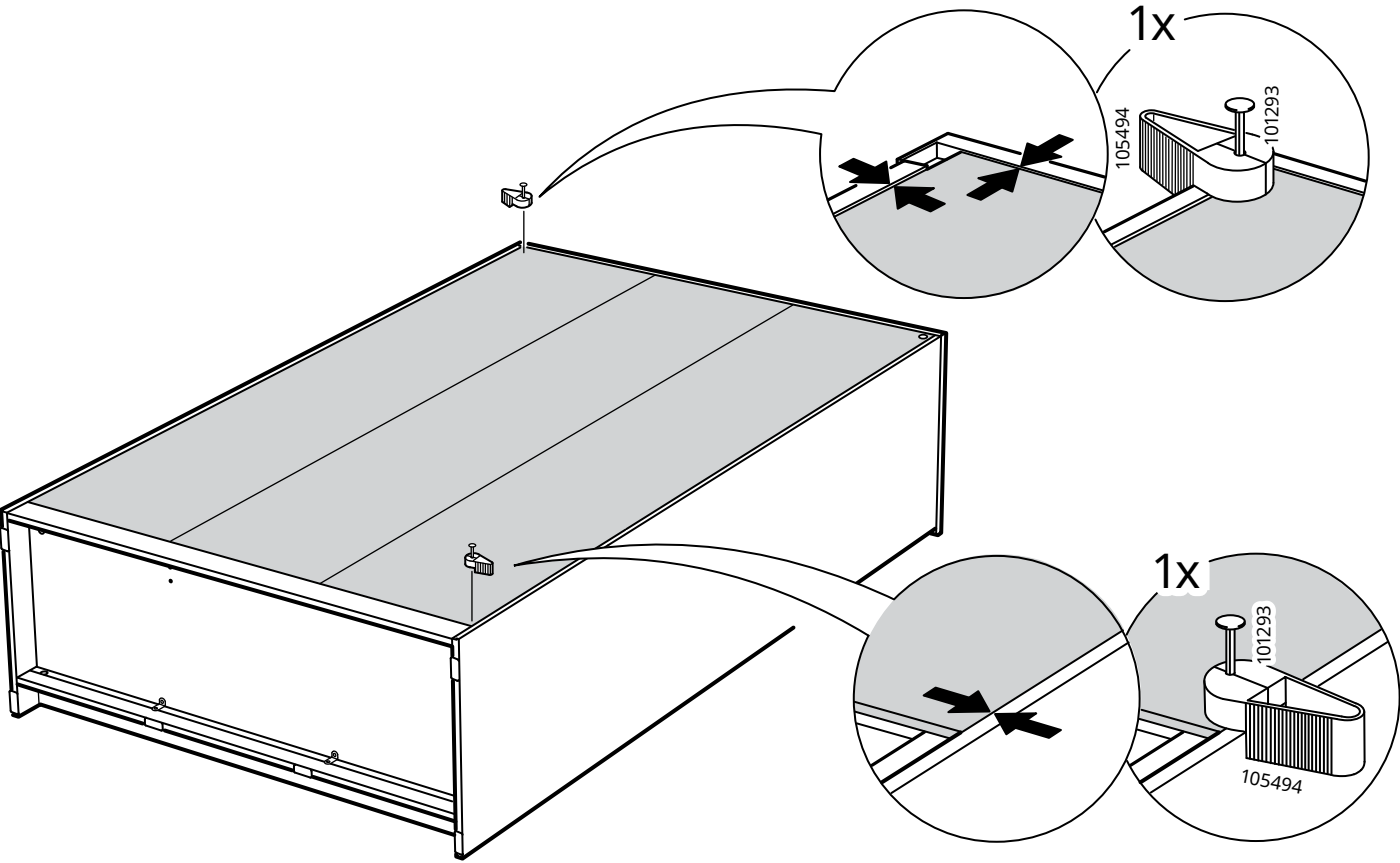

27

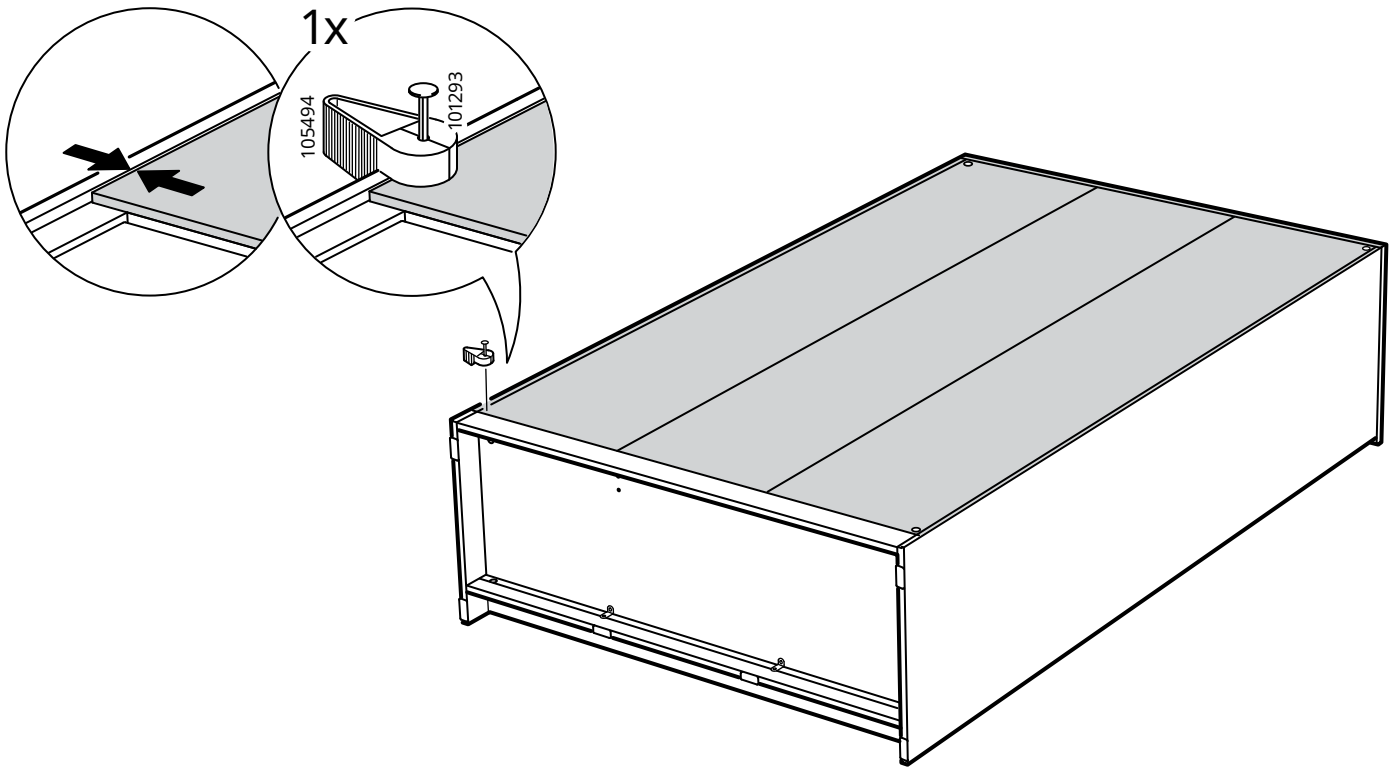

28

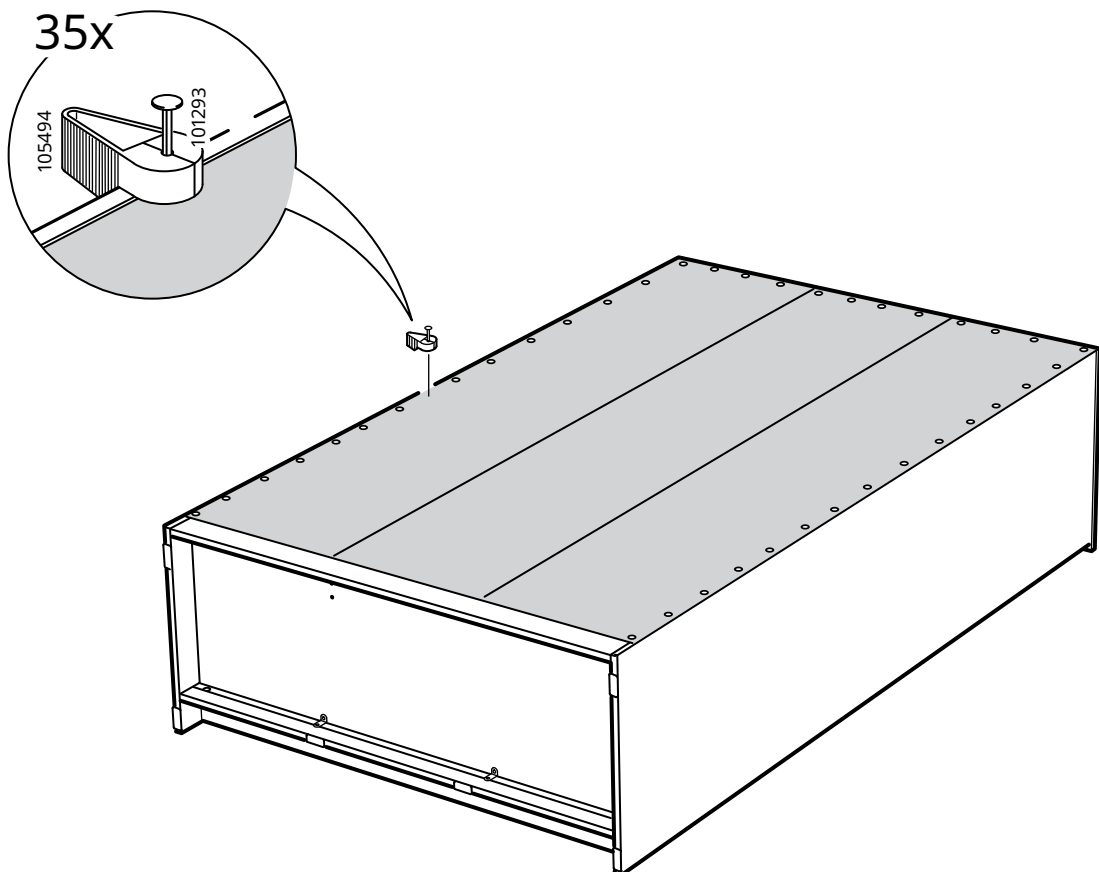

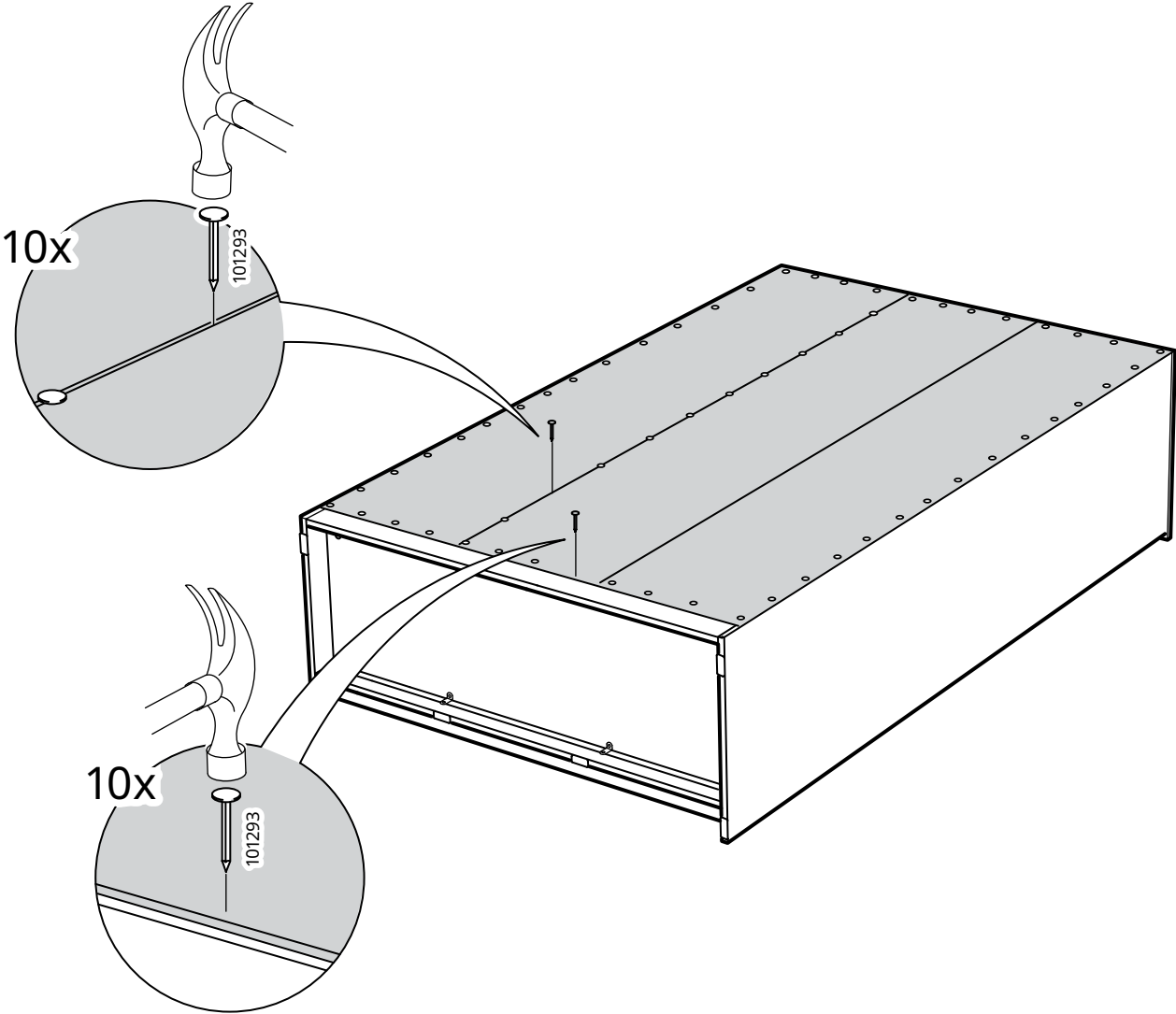

30

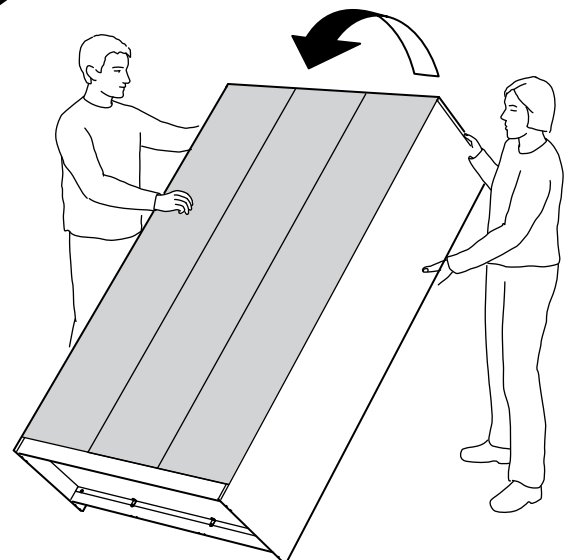
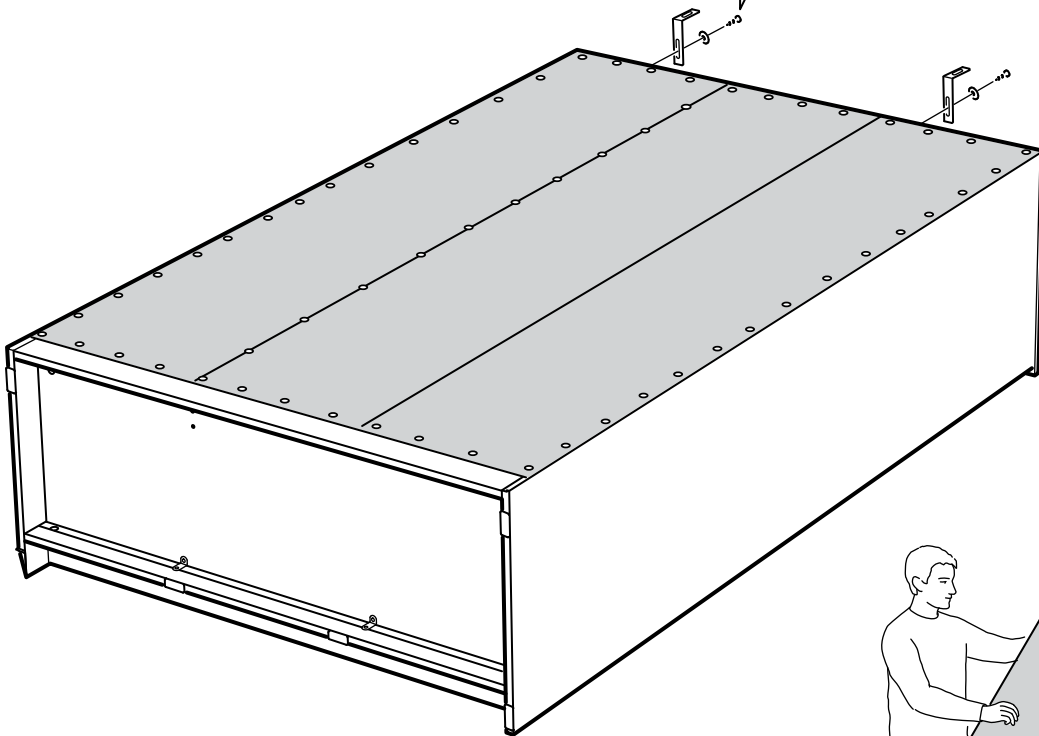
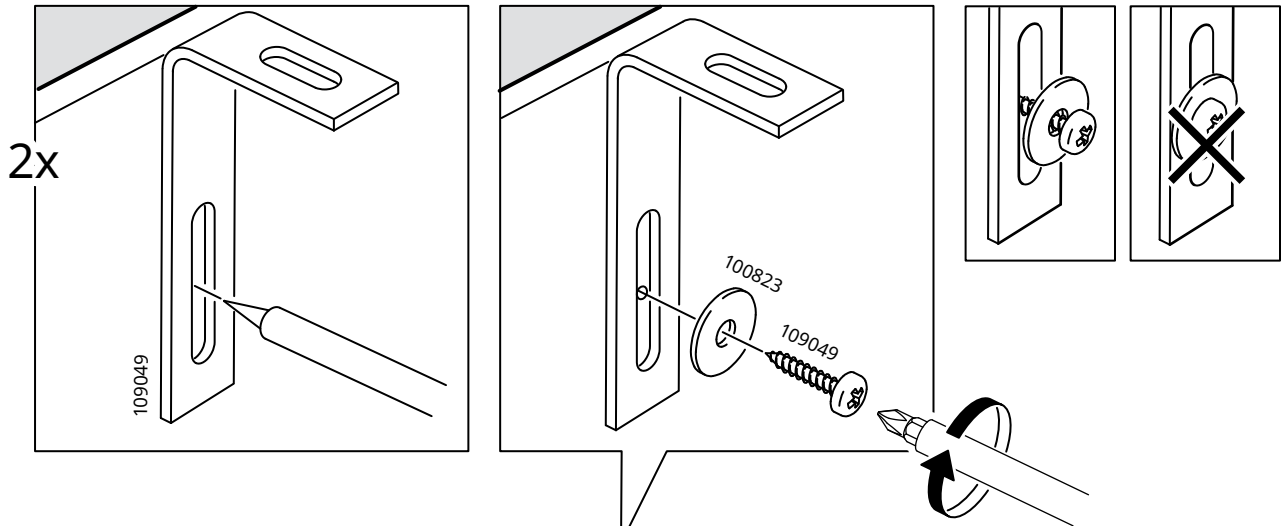
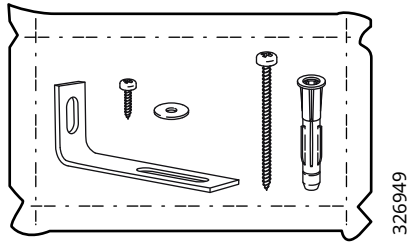

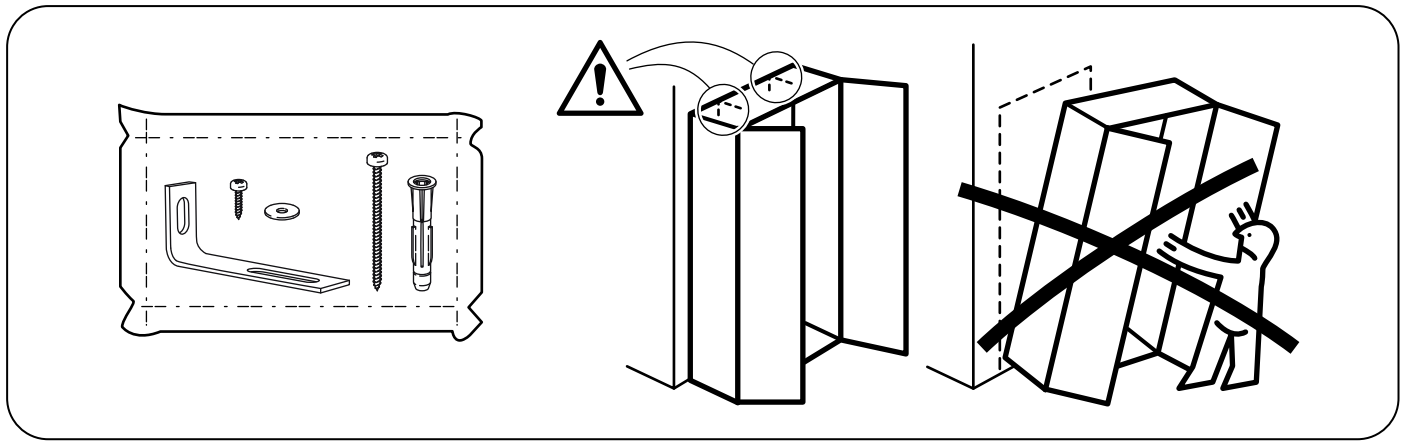

31

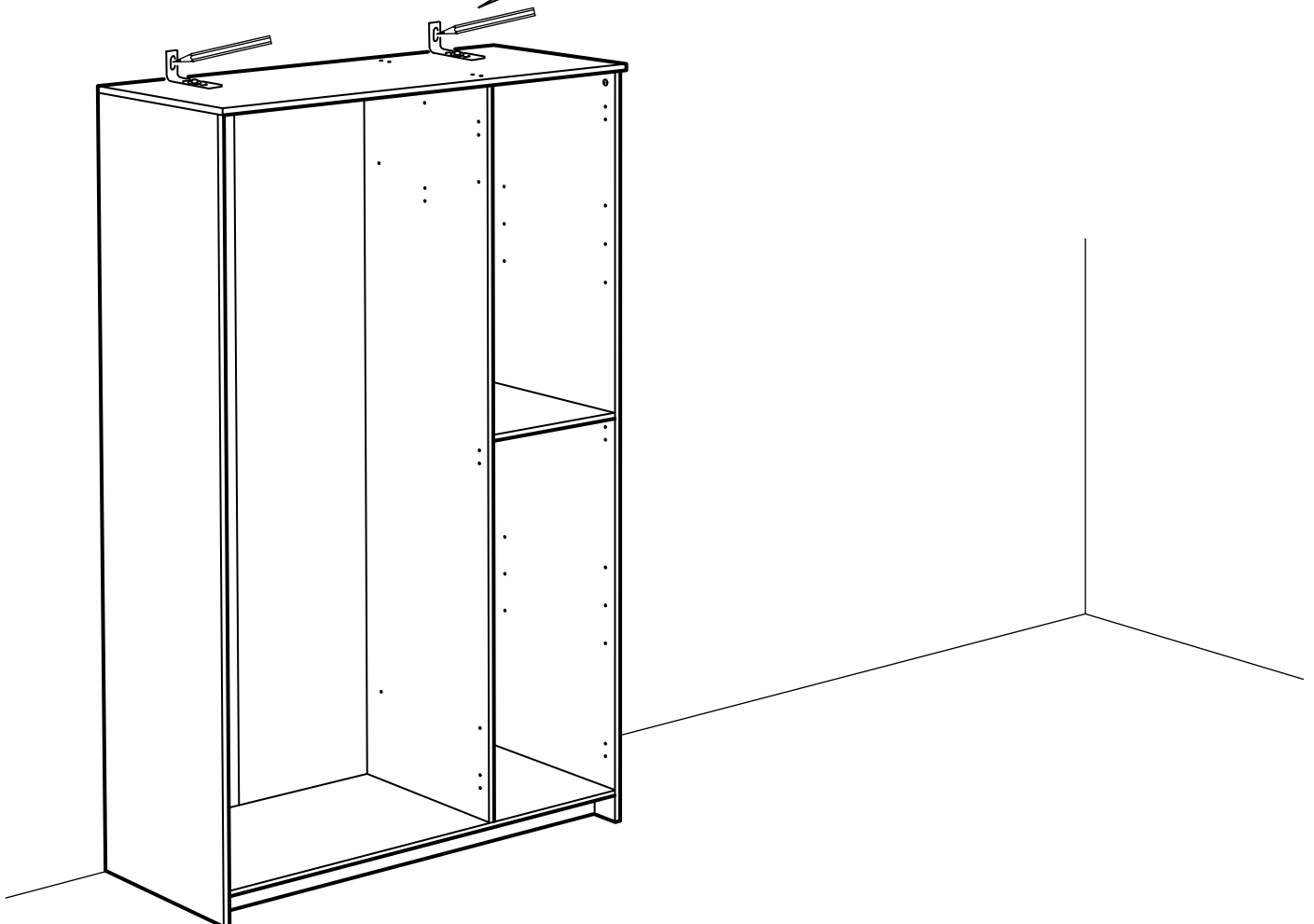
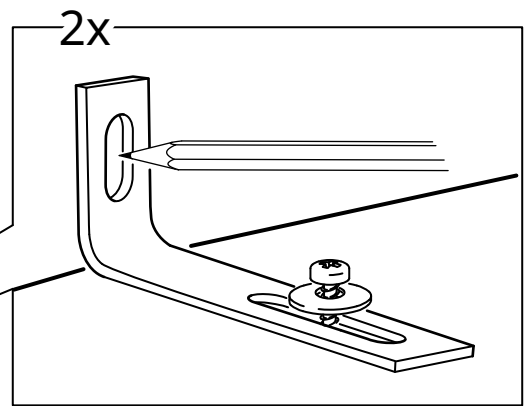
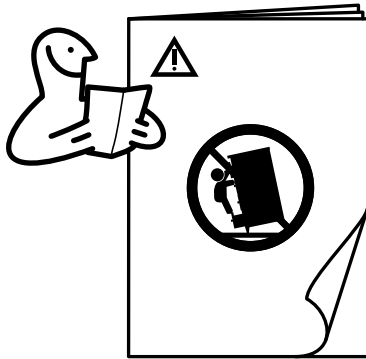

32

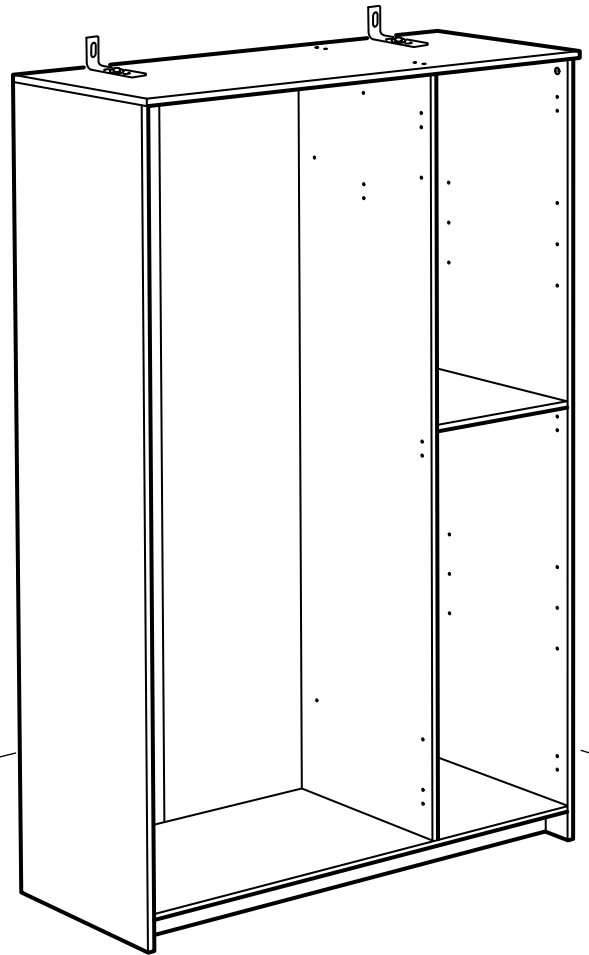
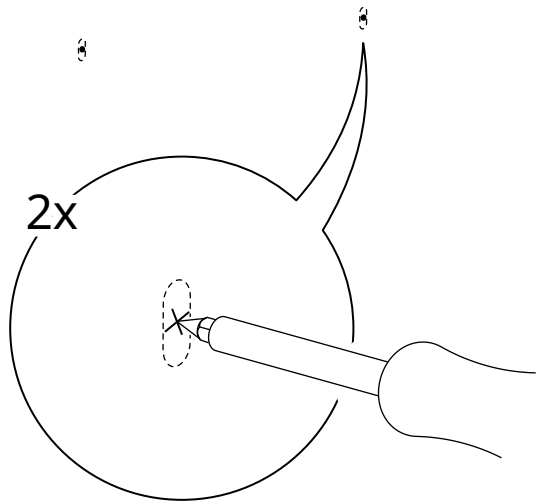

33

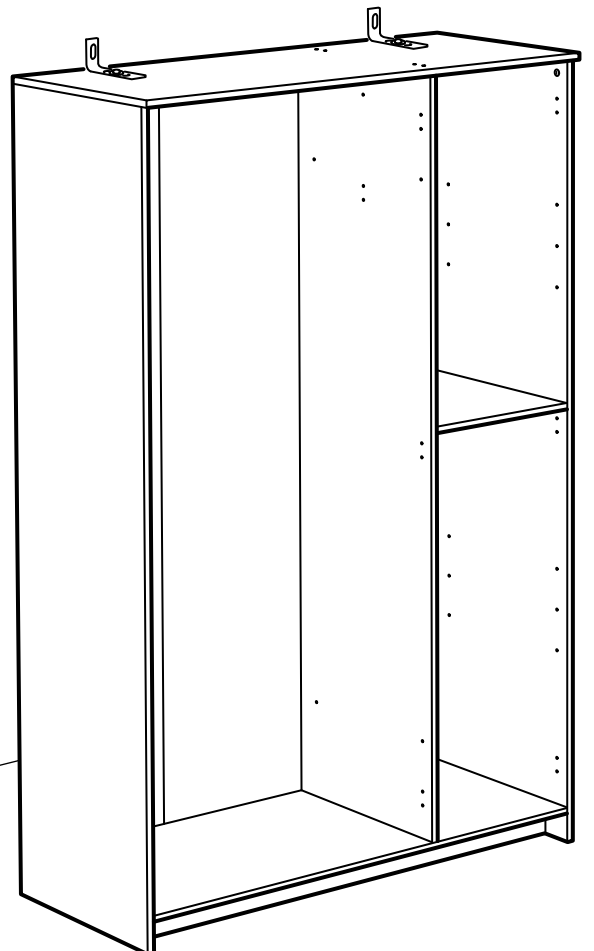
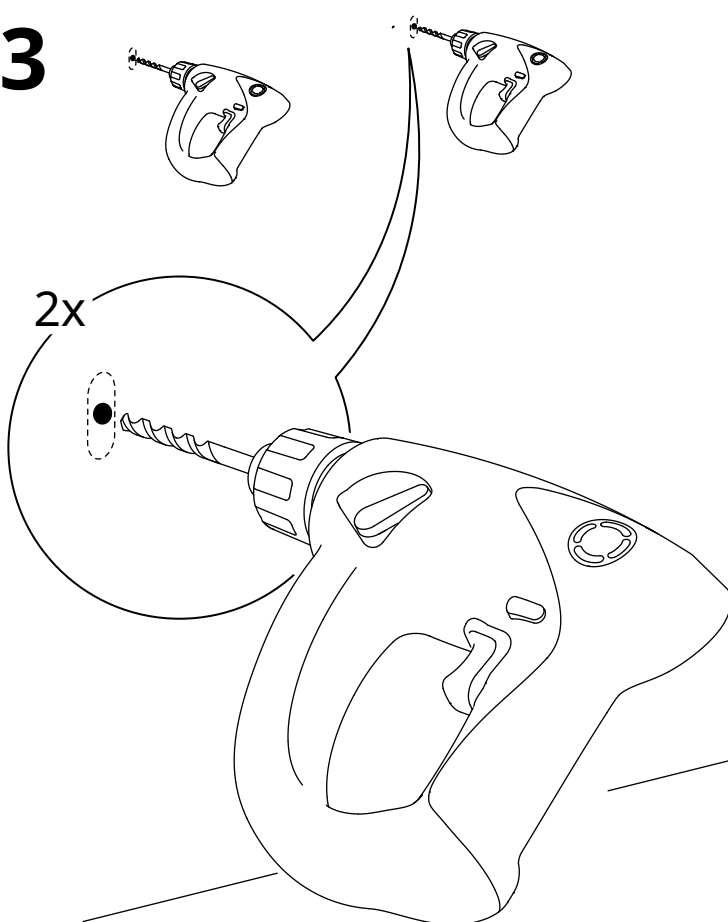

34

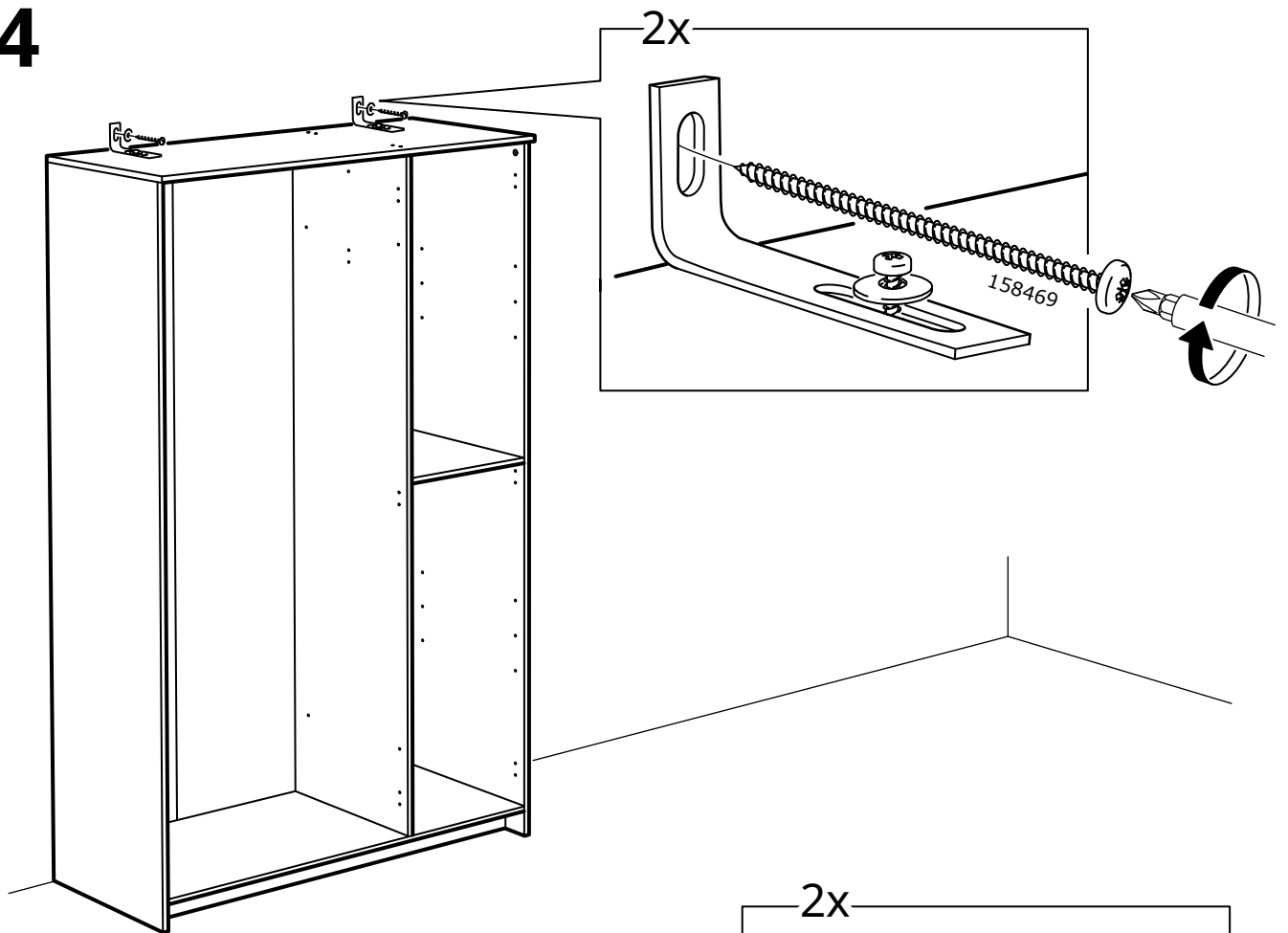

35

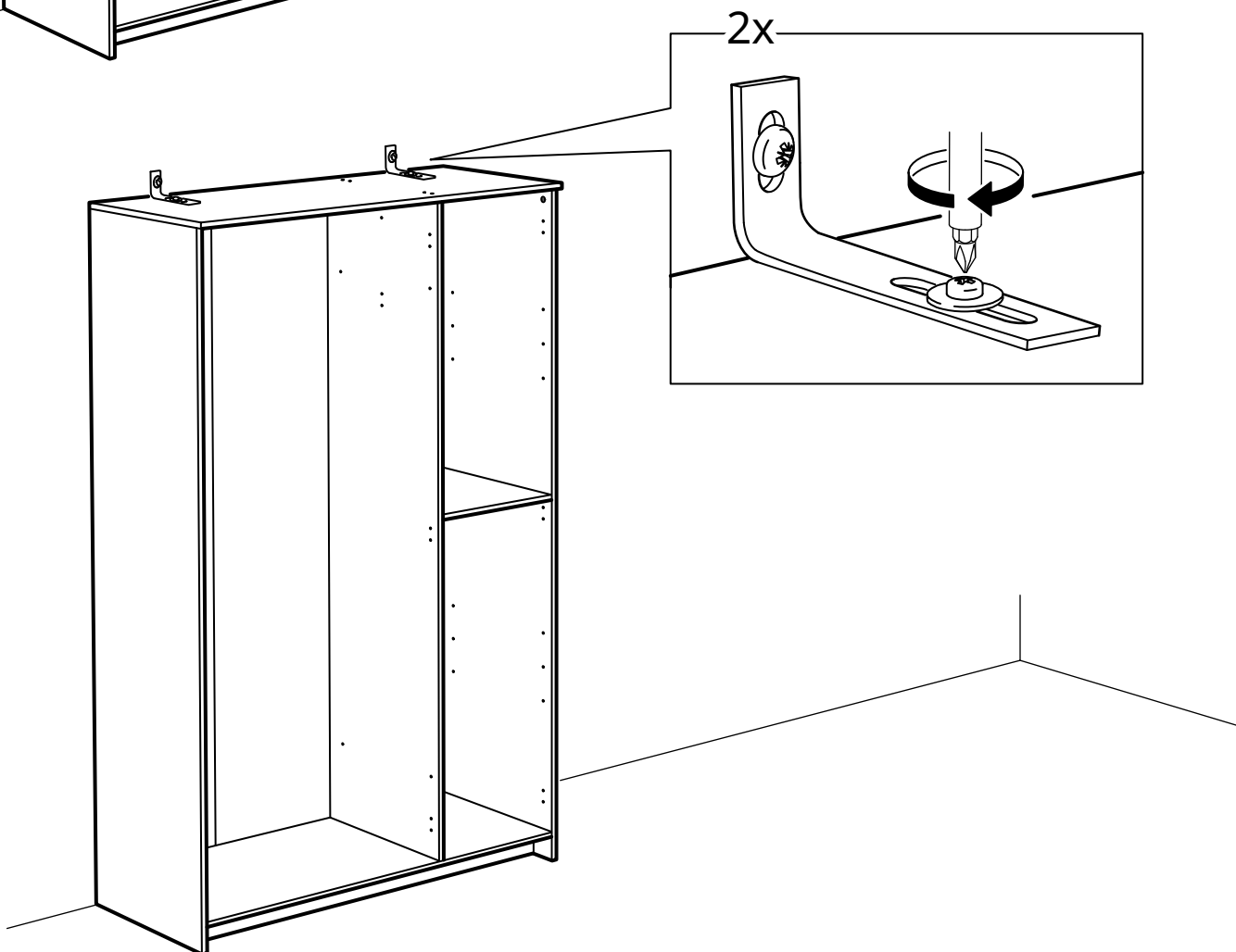

36

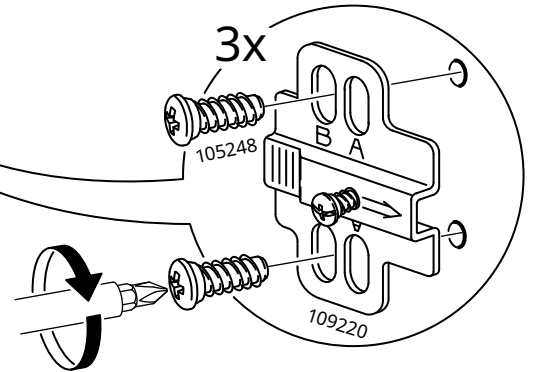
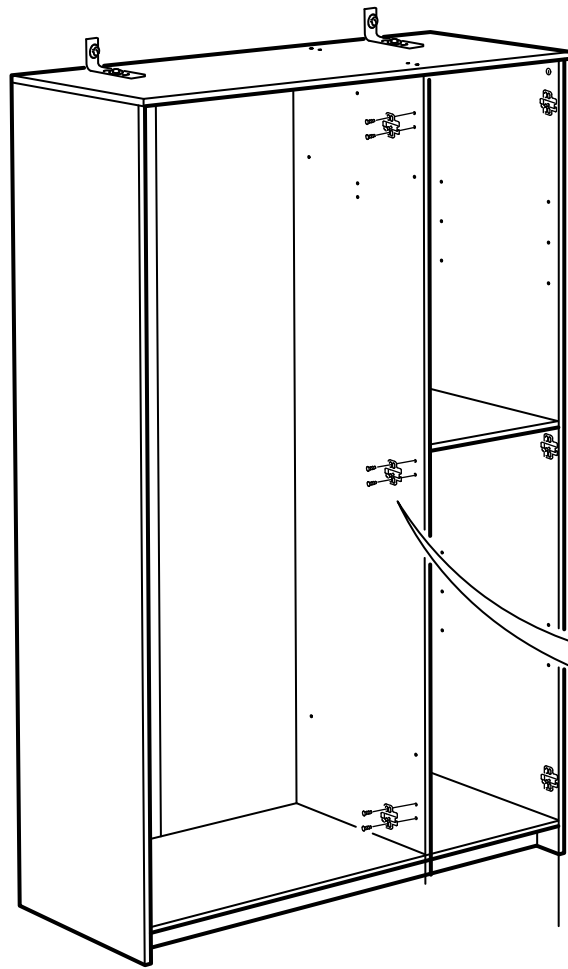

37

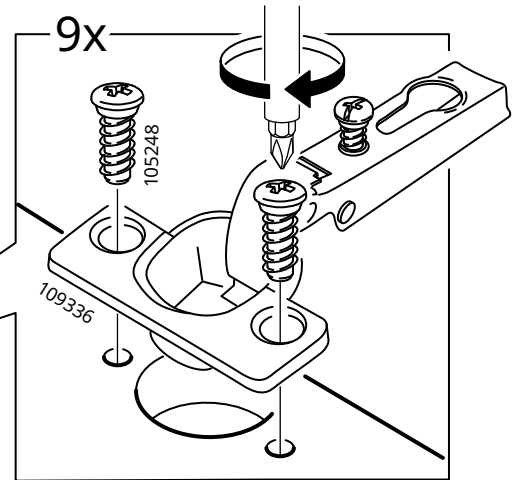
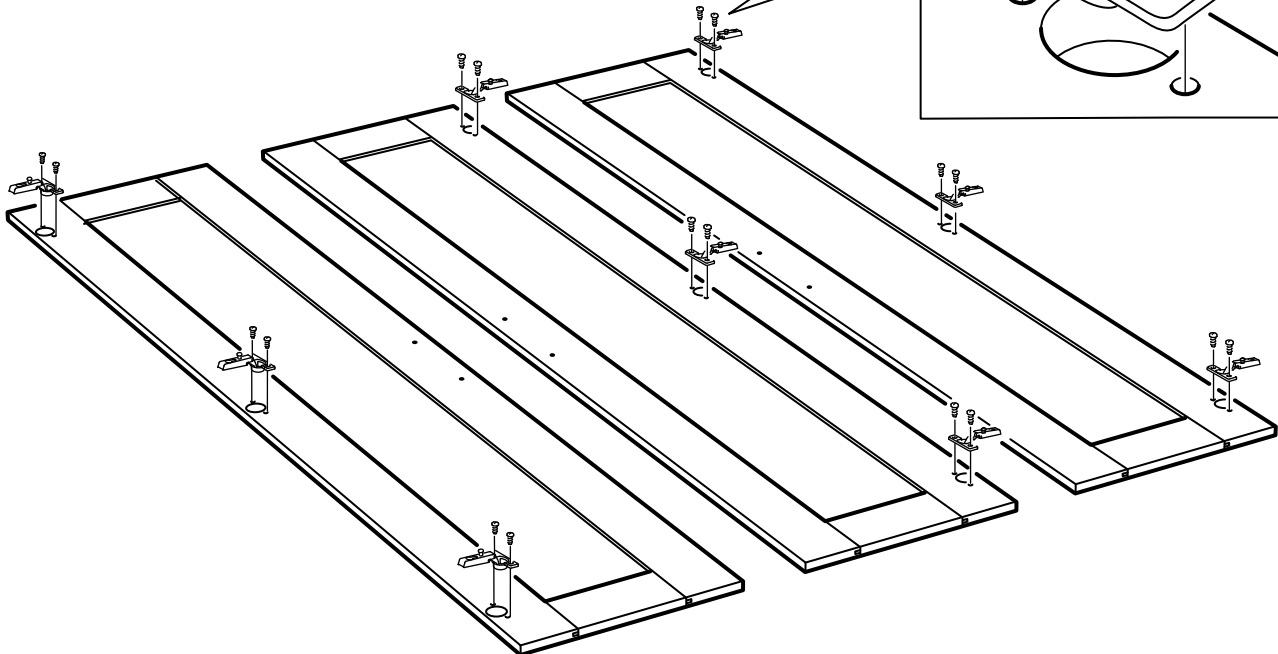

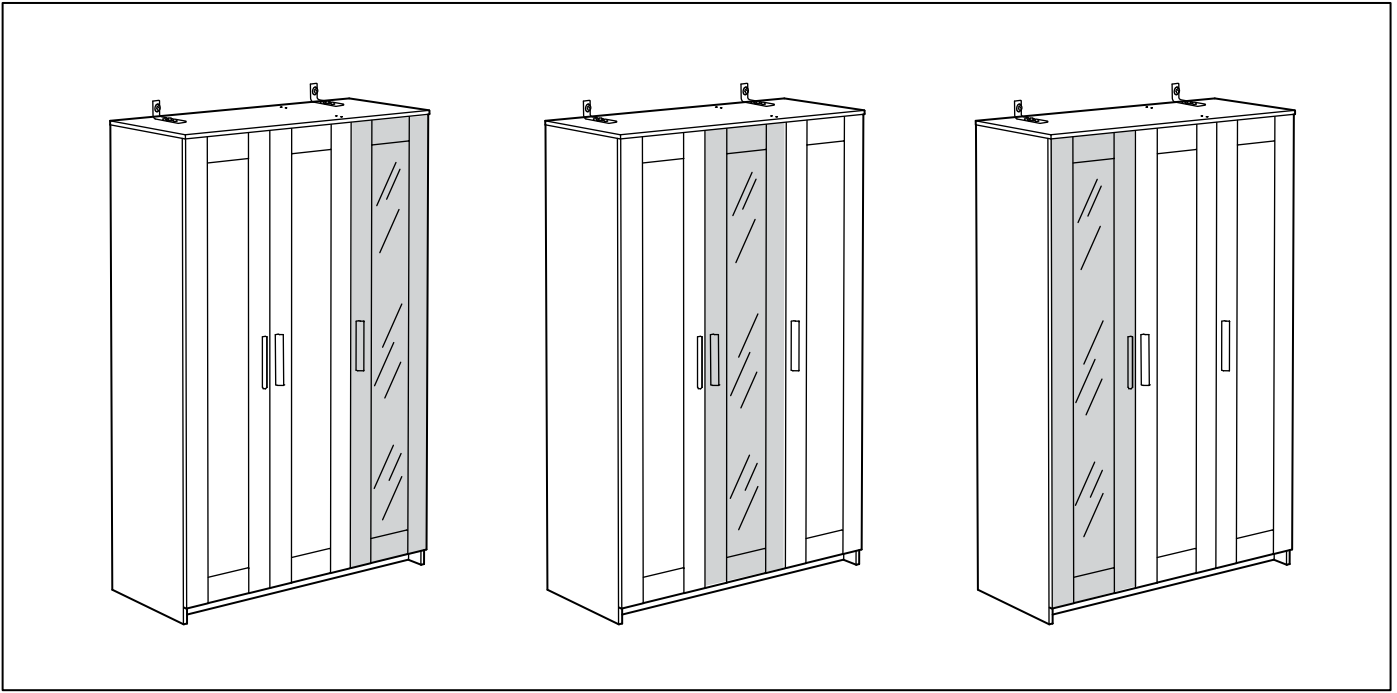

38

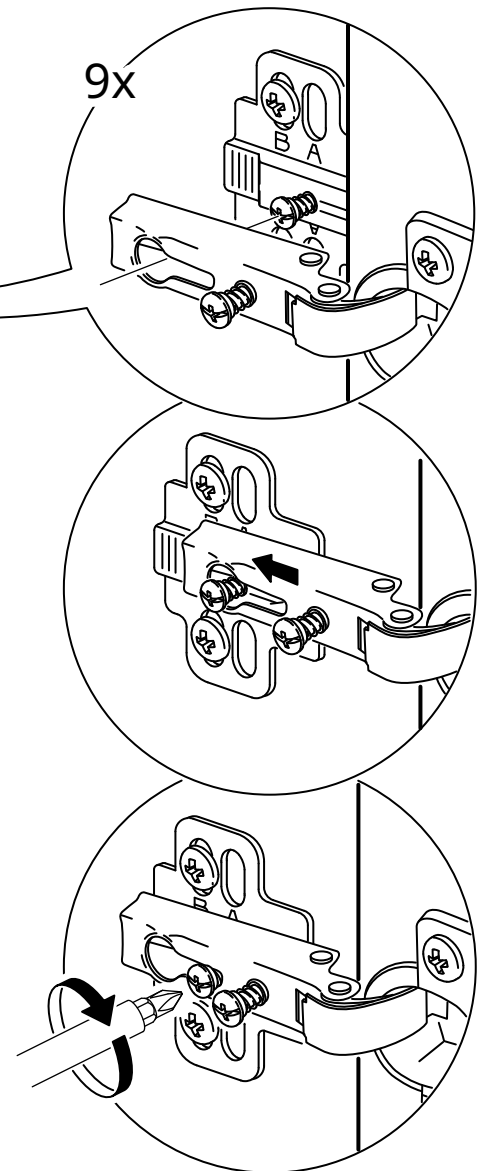

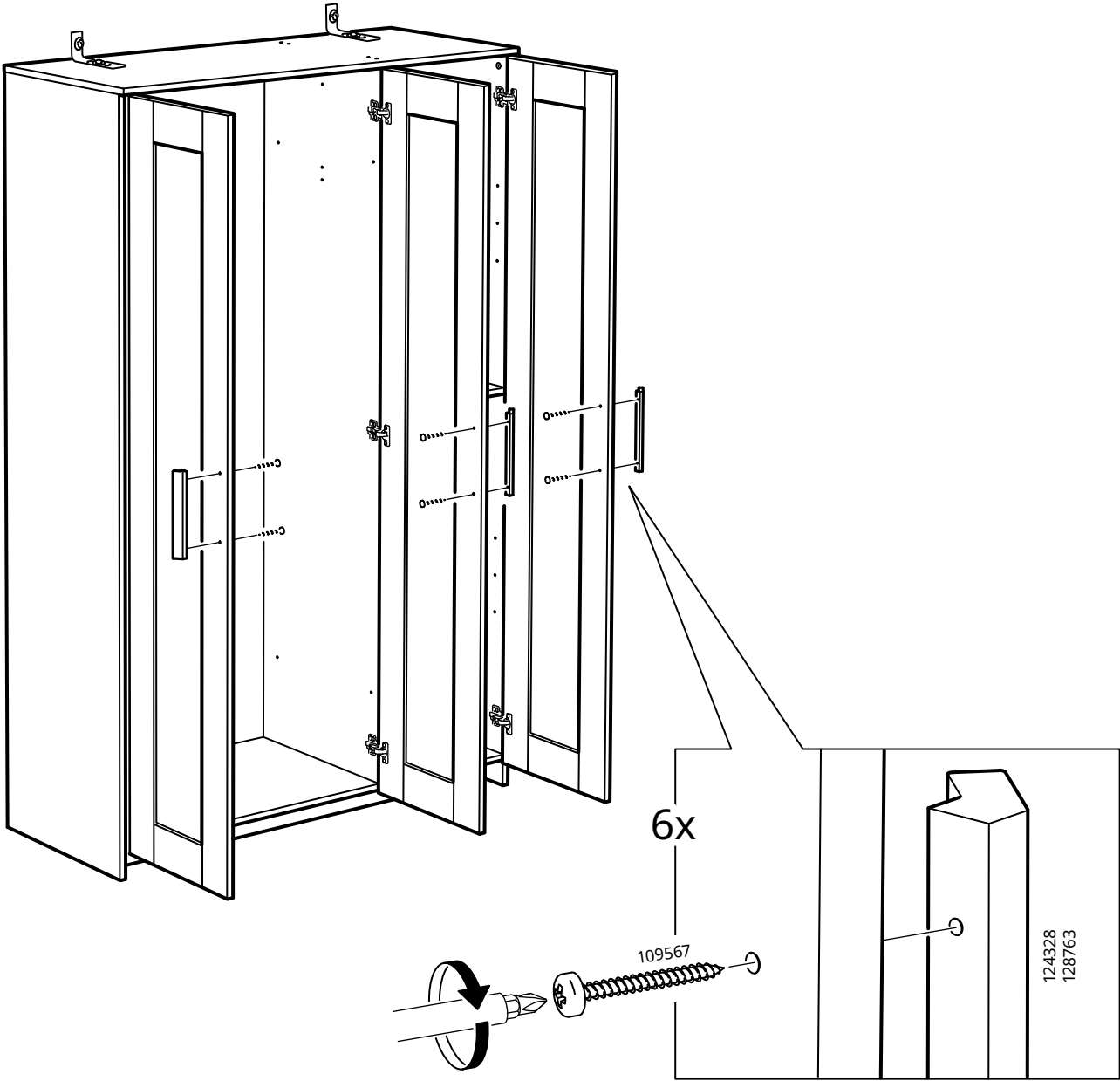

40

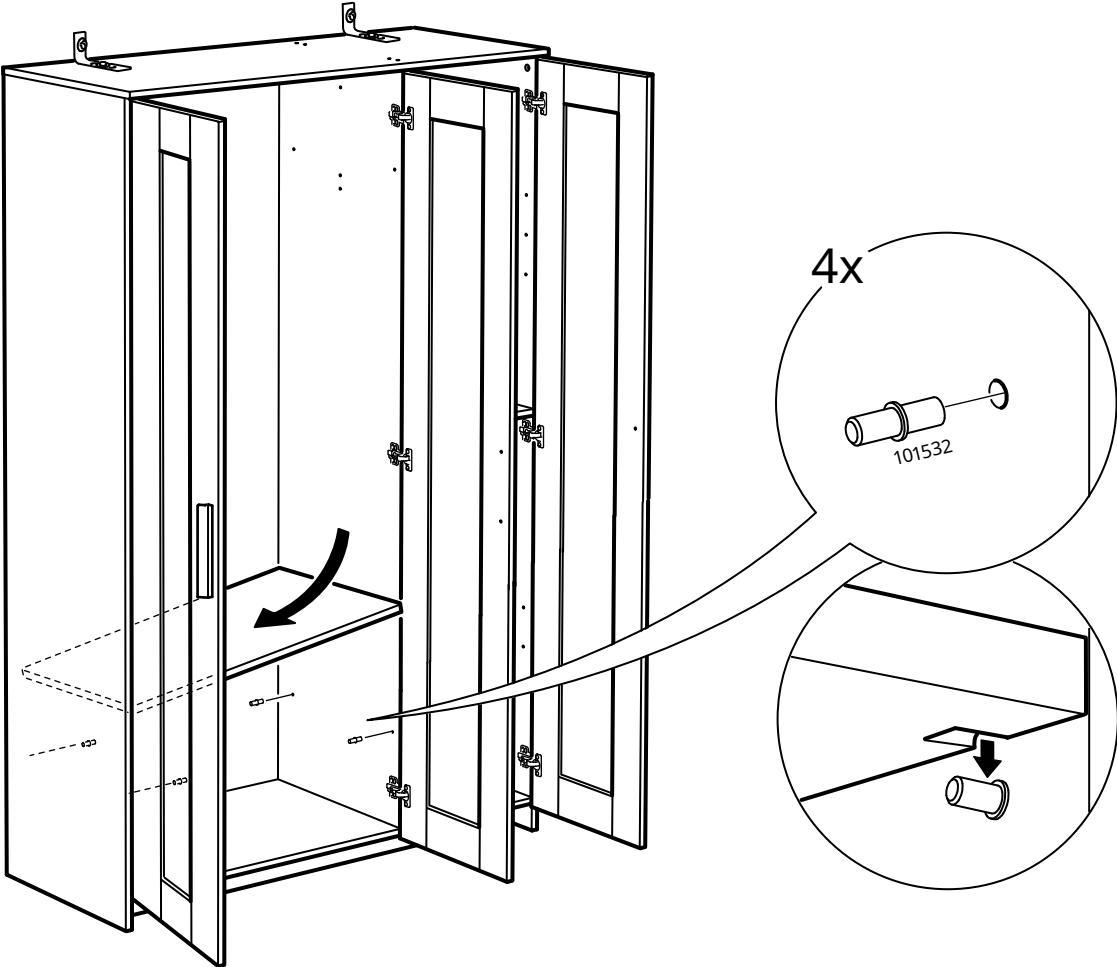

41

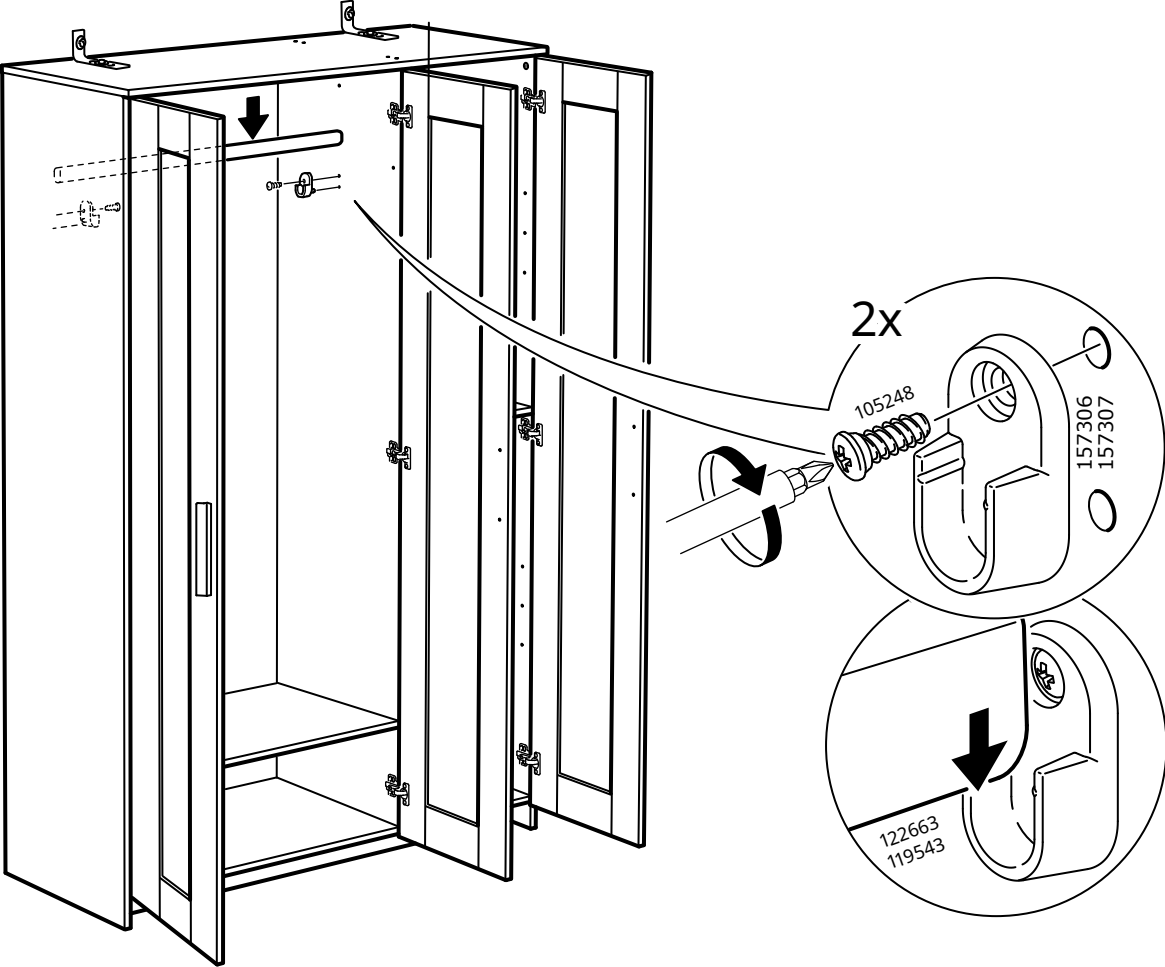

42



8x

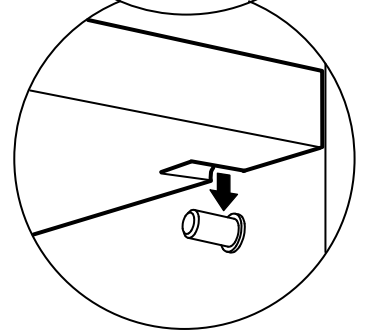
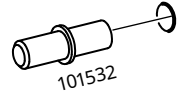

43

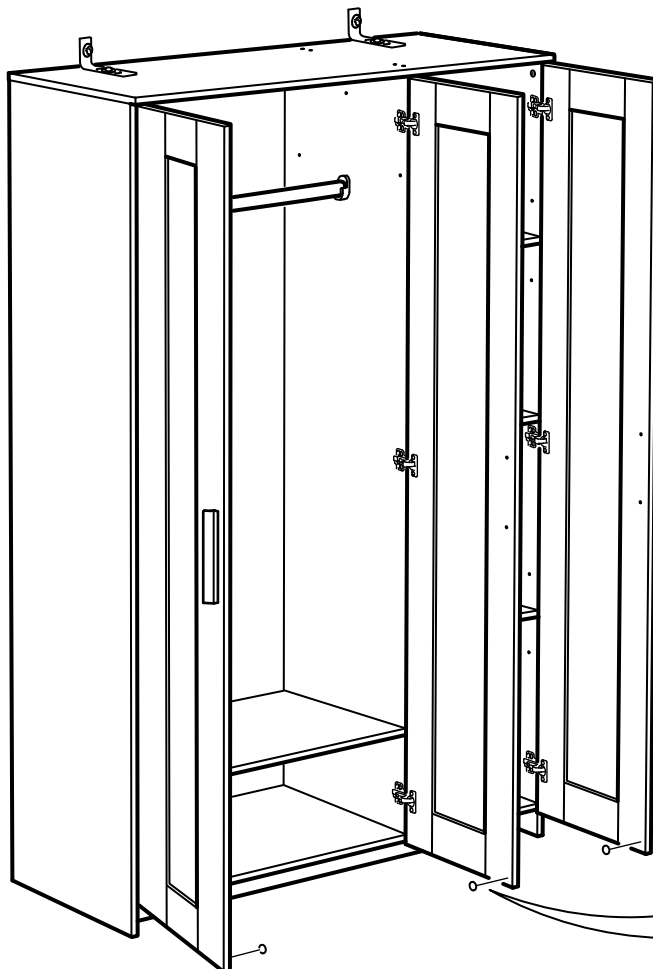

3x

