

BISSA

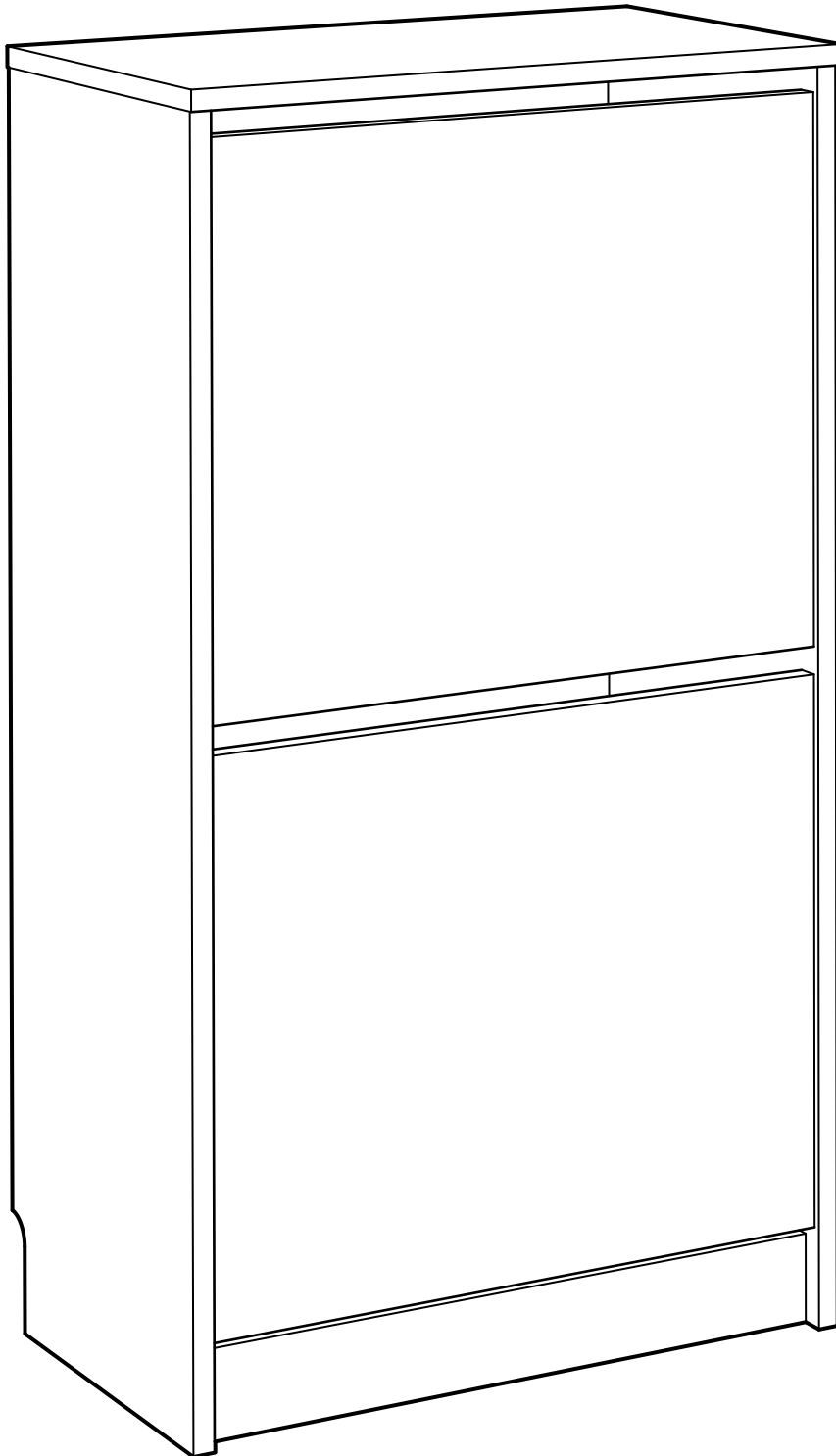

Design and Quality
IKEA of Sweden

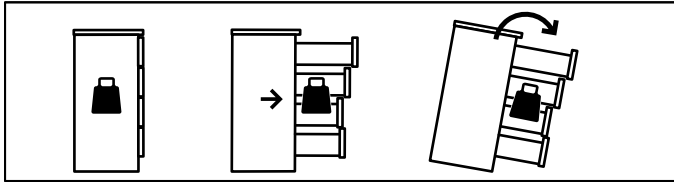

English

WARNING

Children have died from furniture tipover. To reduce the risk of furniture tipover:

ALWAYS install anti-tip device provided.

NEVER put a TV on this product.

NEVER allow children to stand, climb, or hang on any drawers, doors, or shelves.

NEVER open more than one drawer at a time.

Place heaviest items in the lowest drawers.

English

Read and follow each step of the instruction carefully.

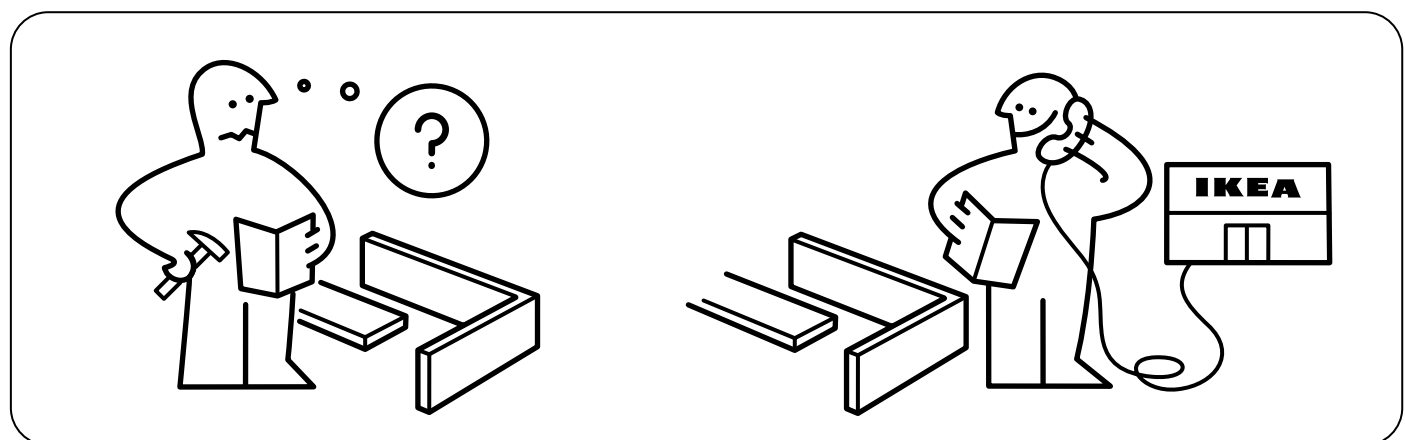
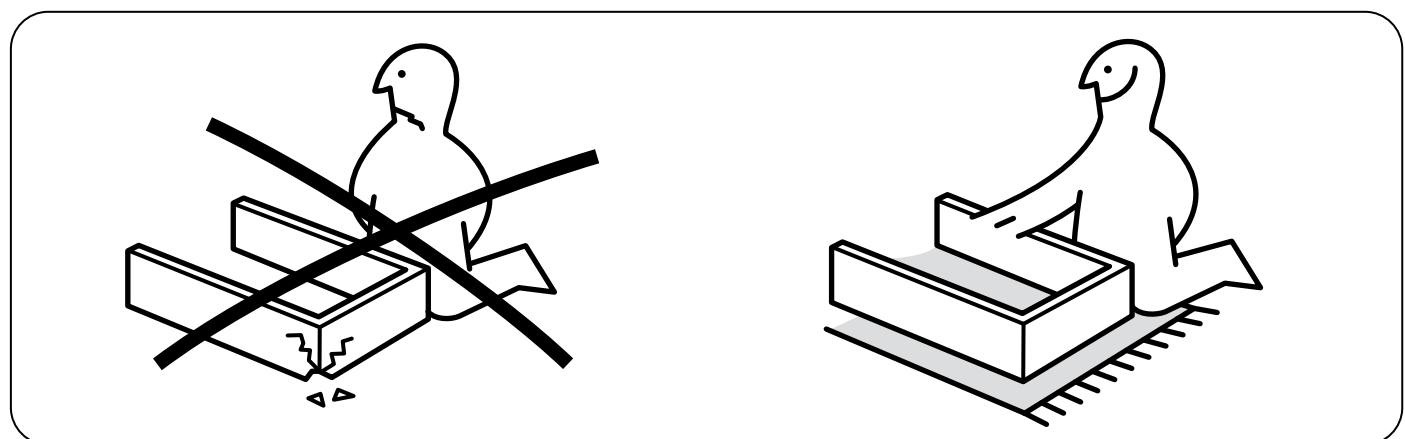
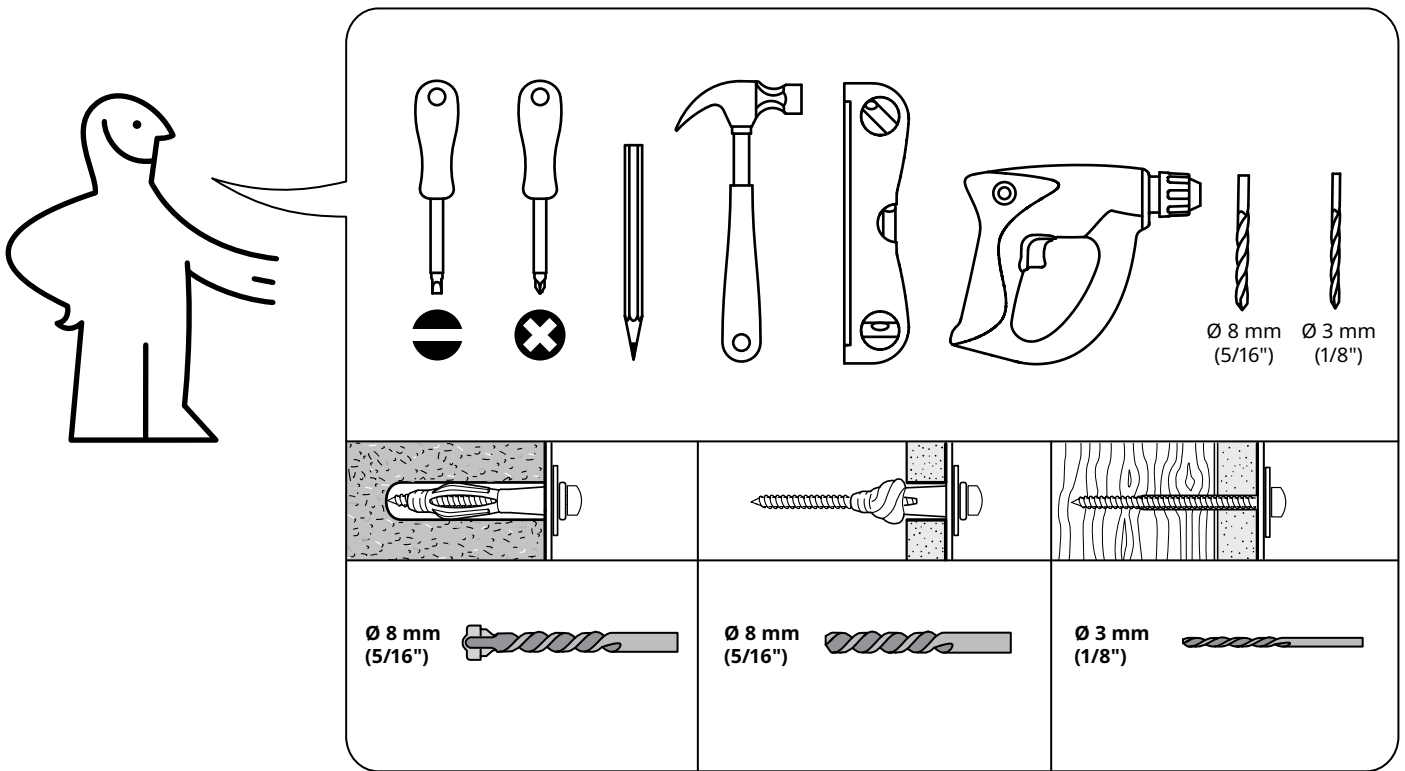

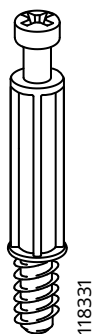
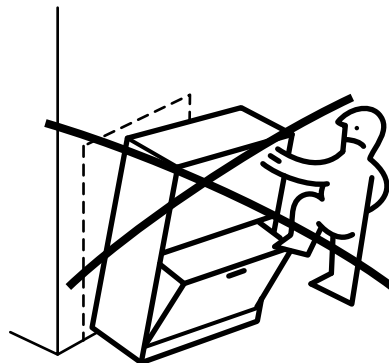
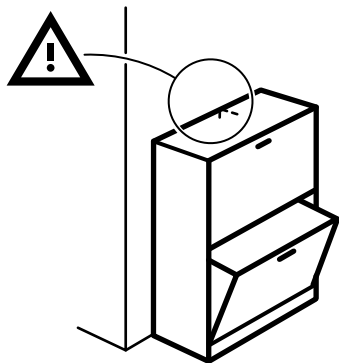

10x



10x

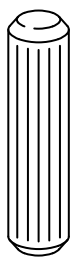

10x

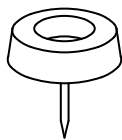

4x



12x

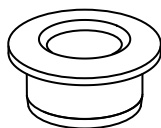

4x



16x

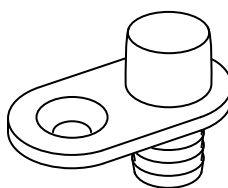

4x



4x

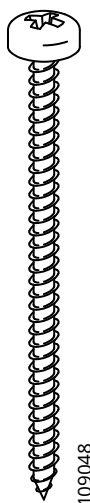

2x

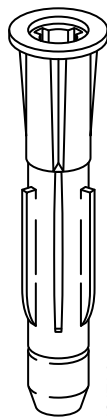

2x



2x

1

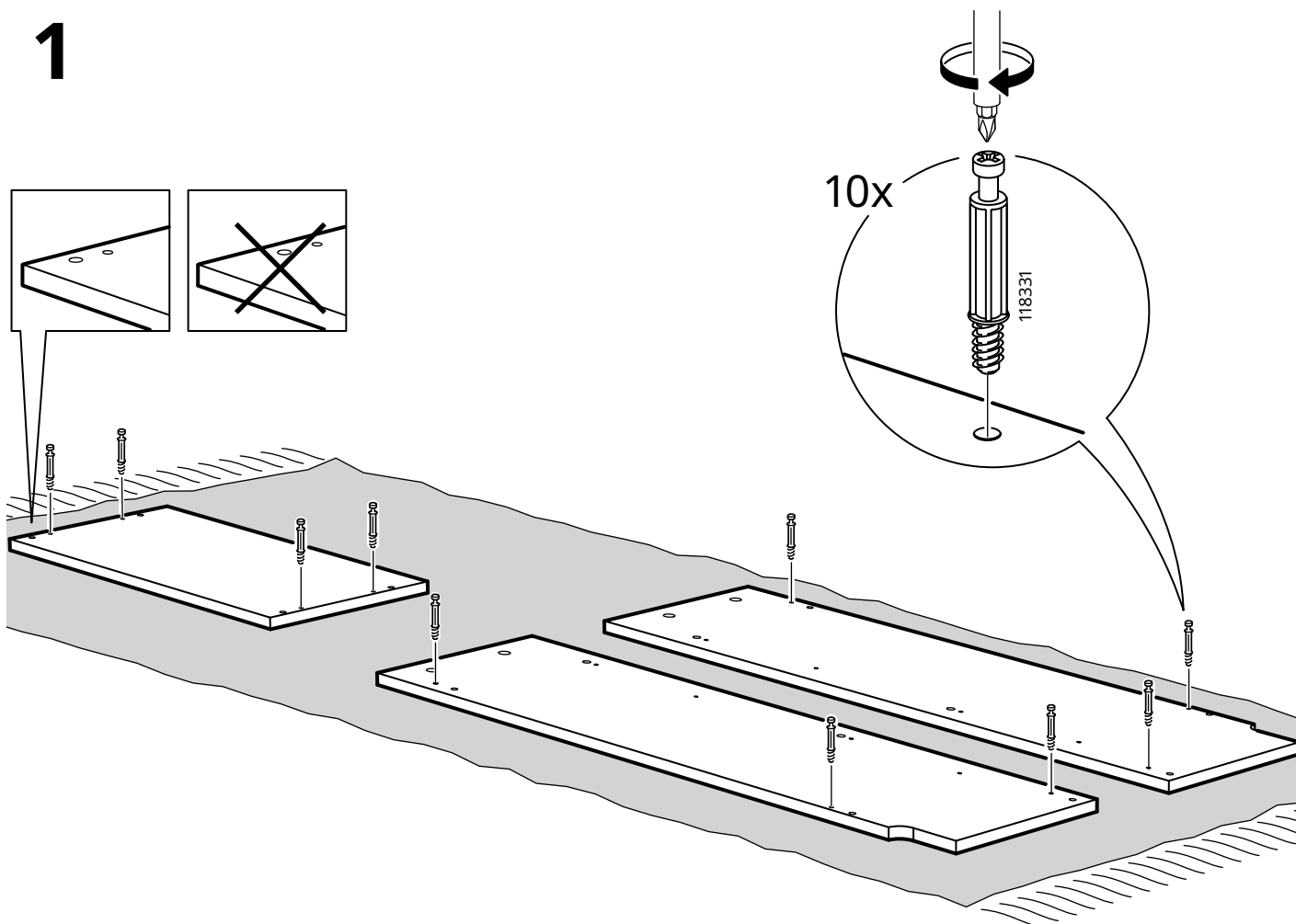

2

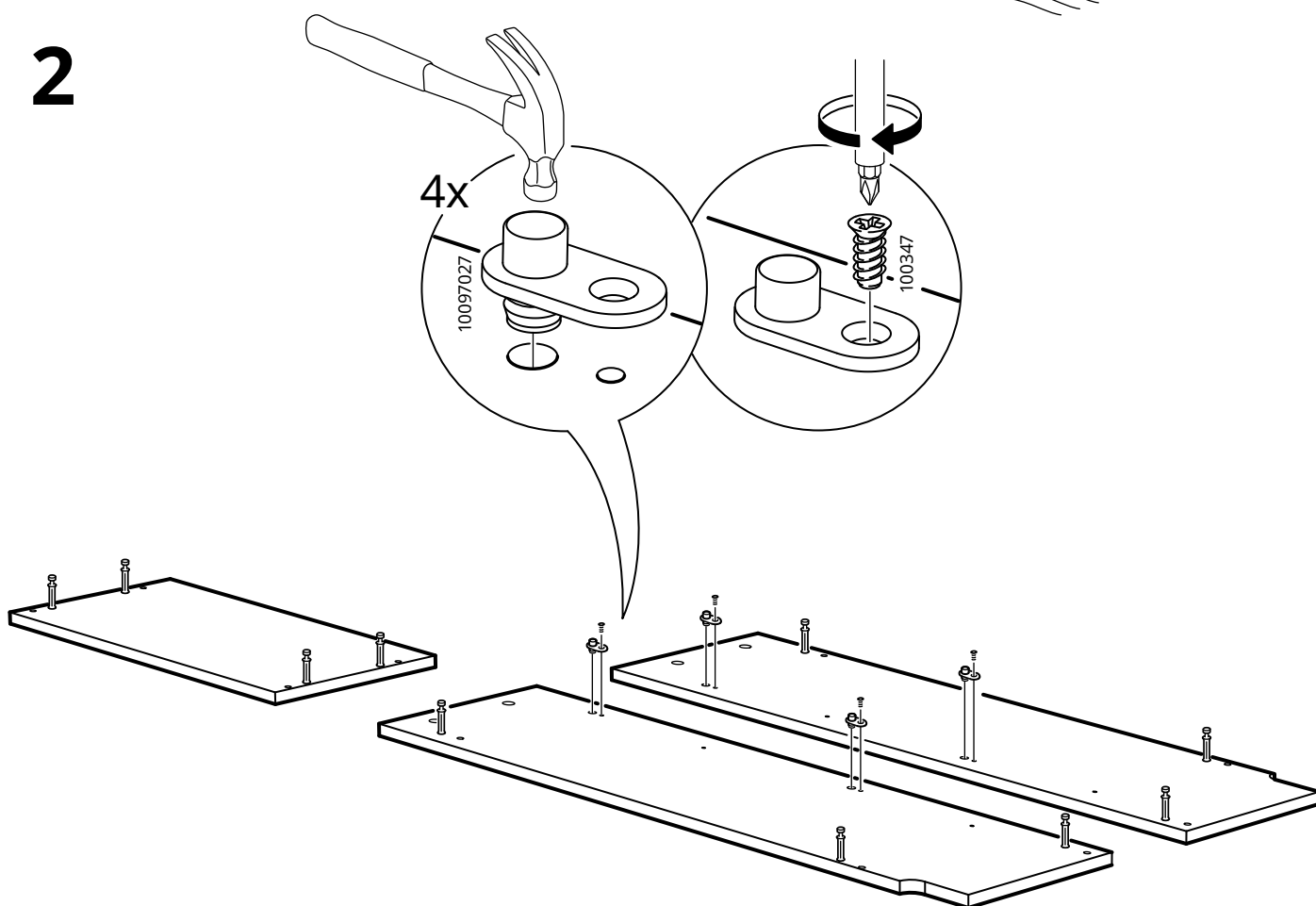

3

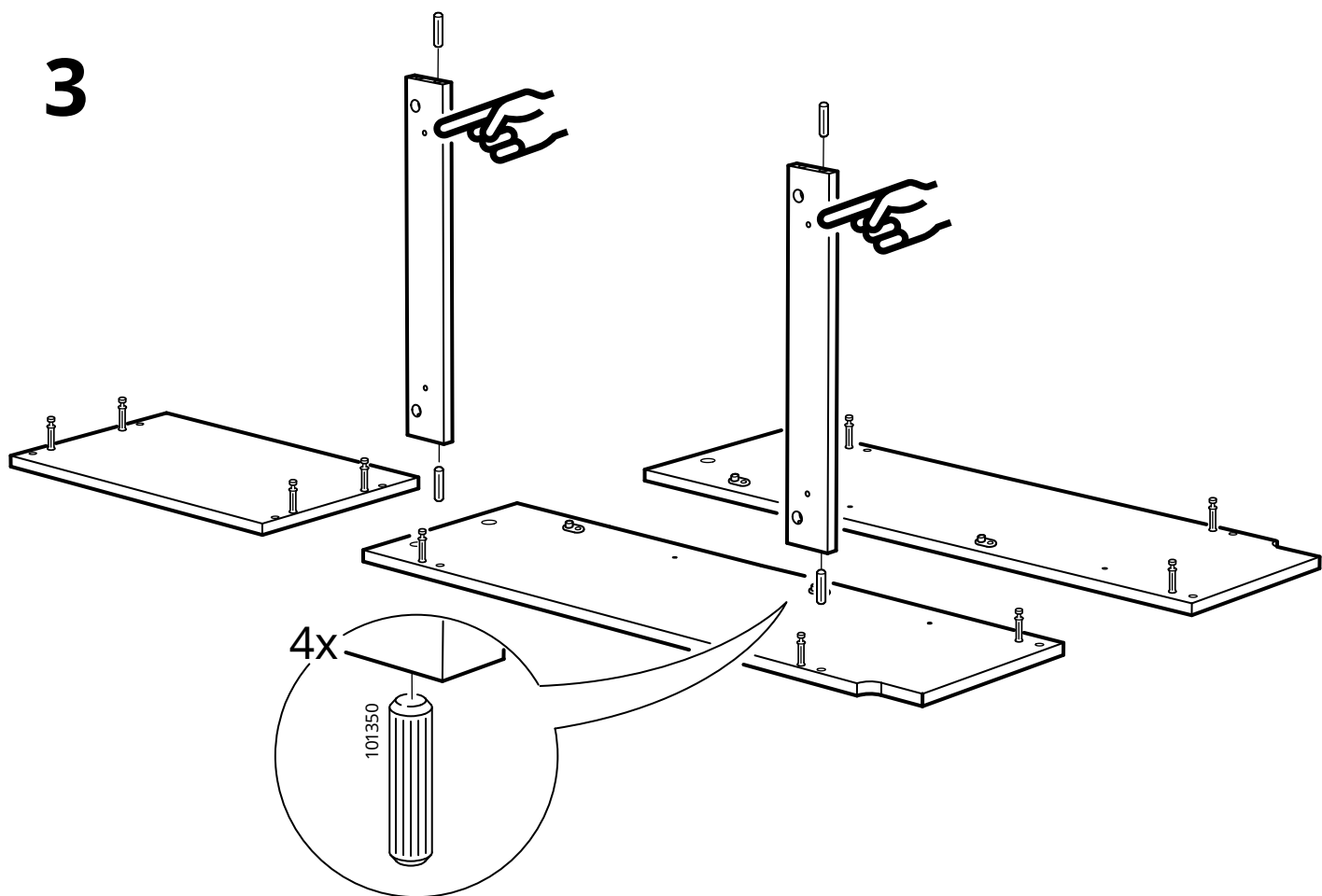

4

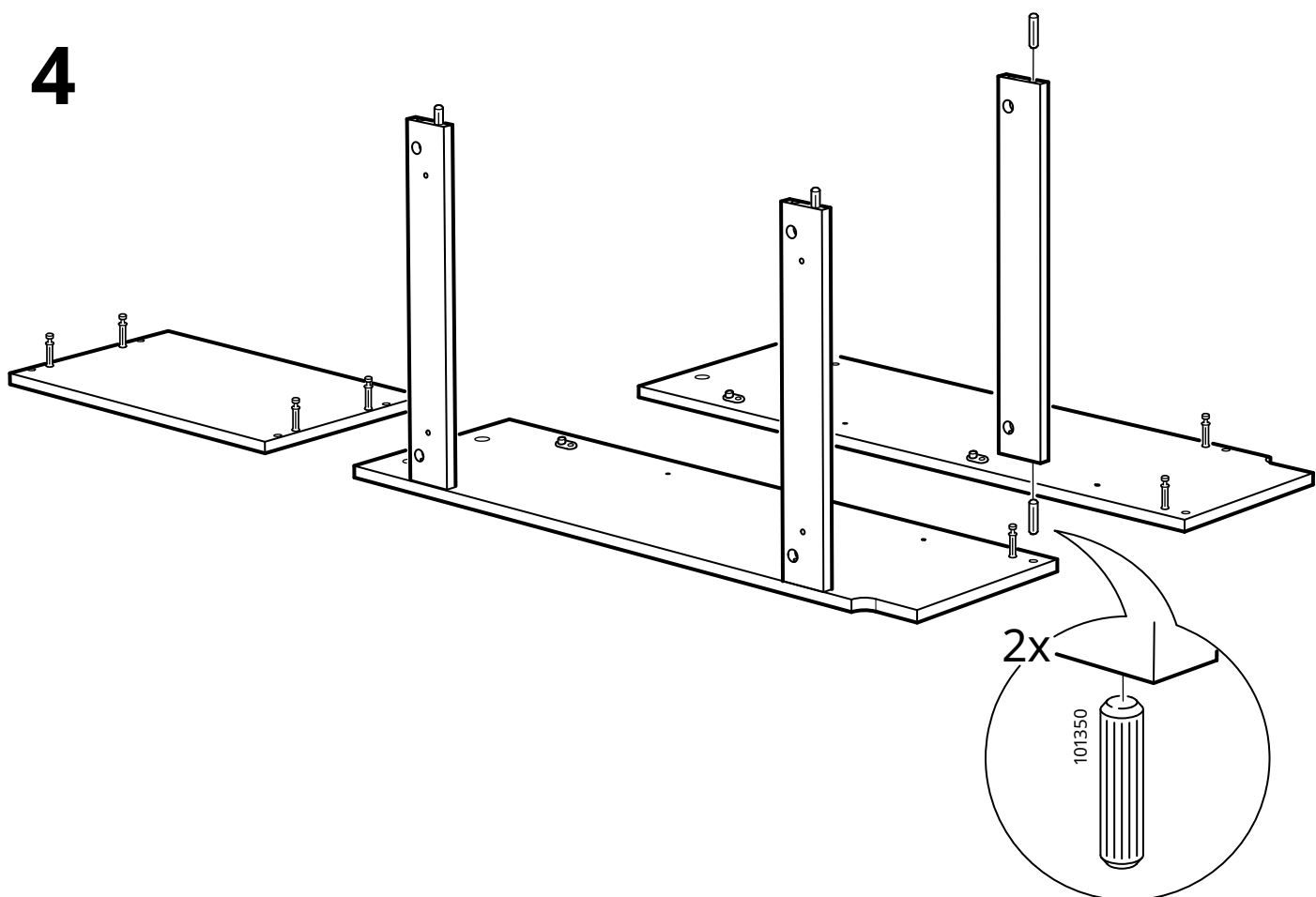

5

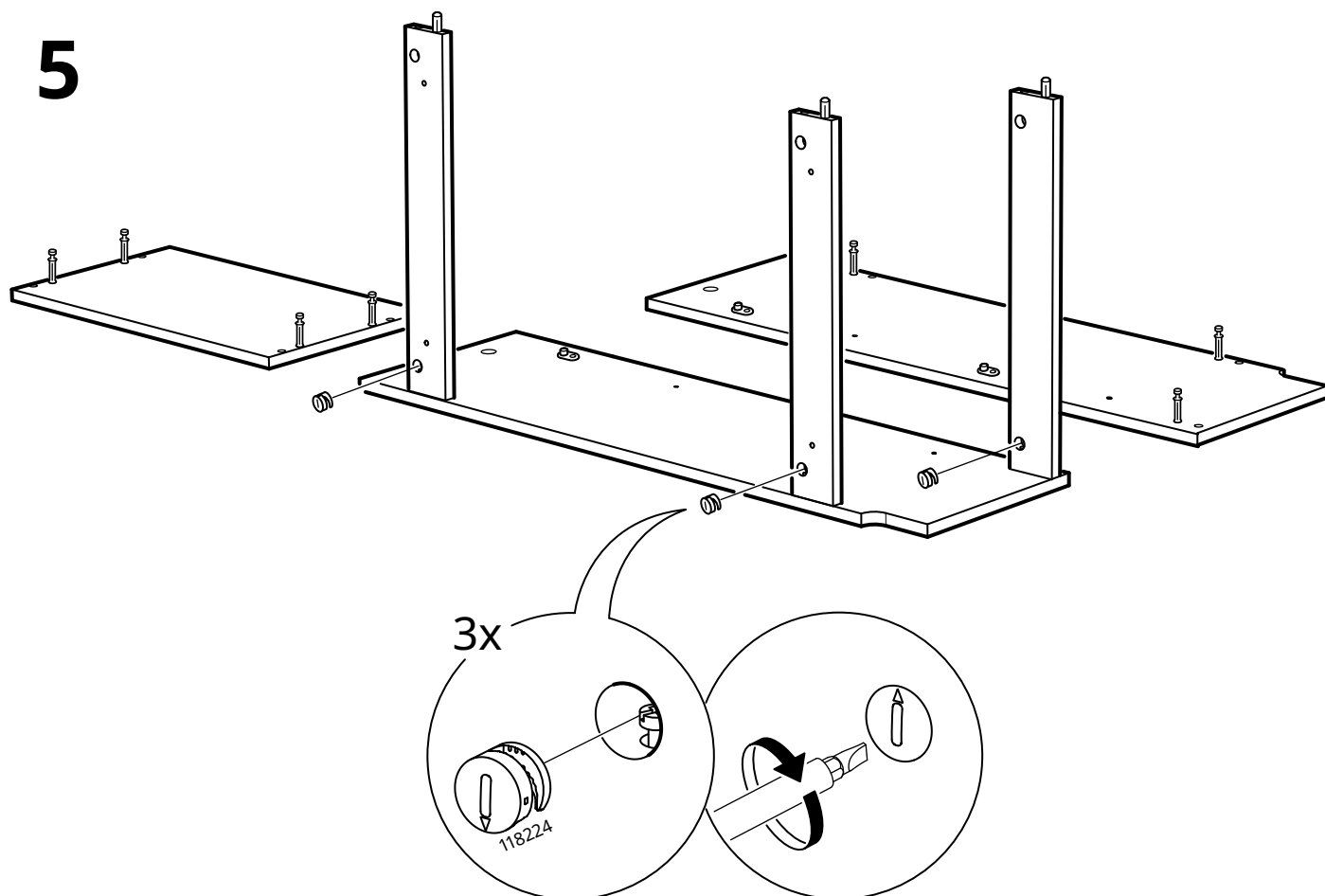

6

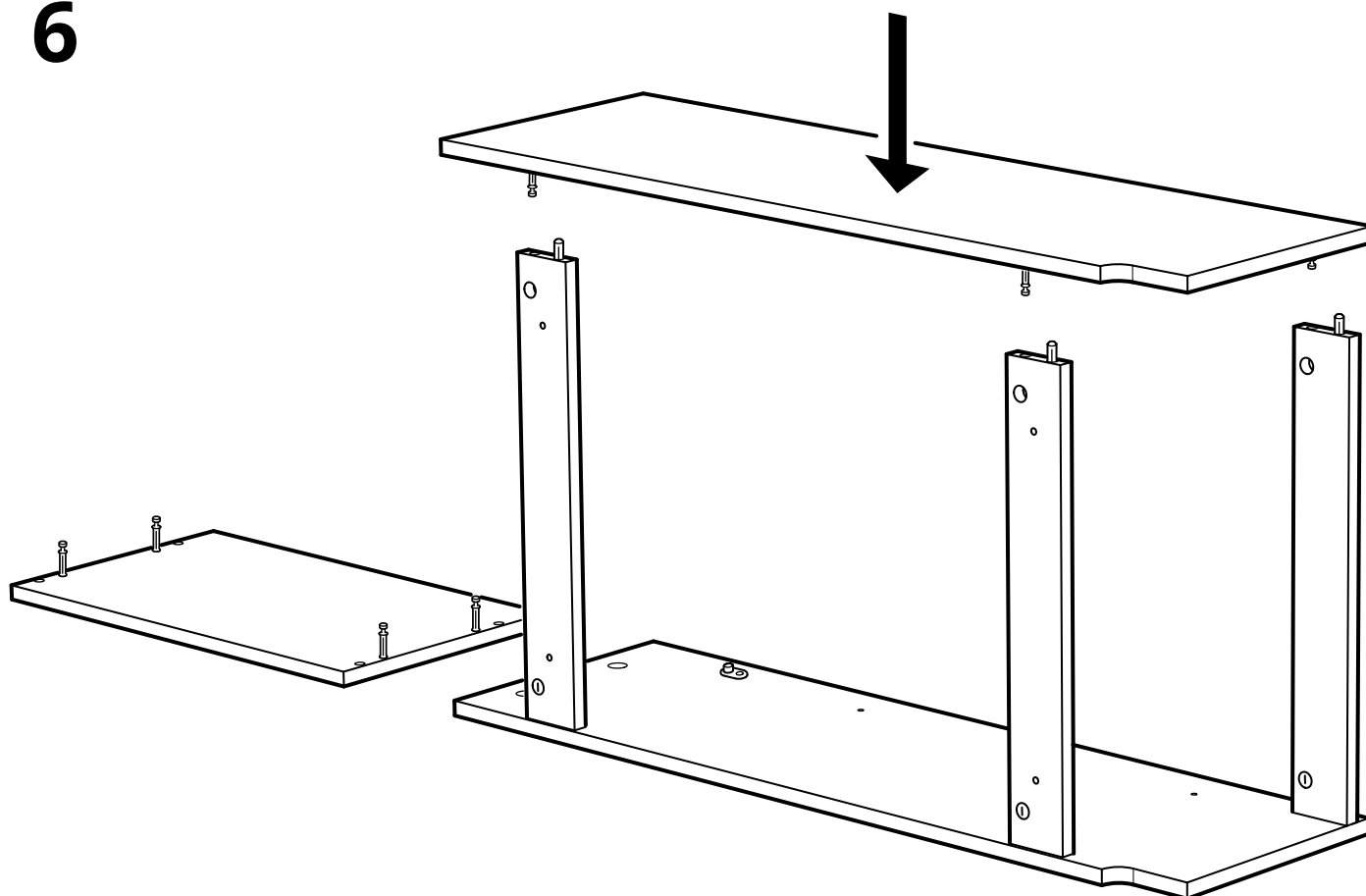

7

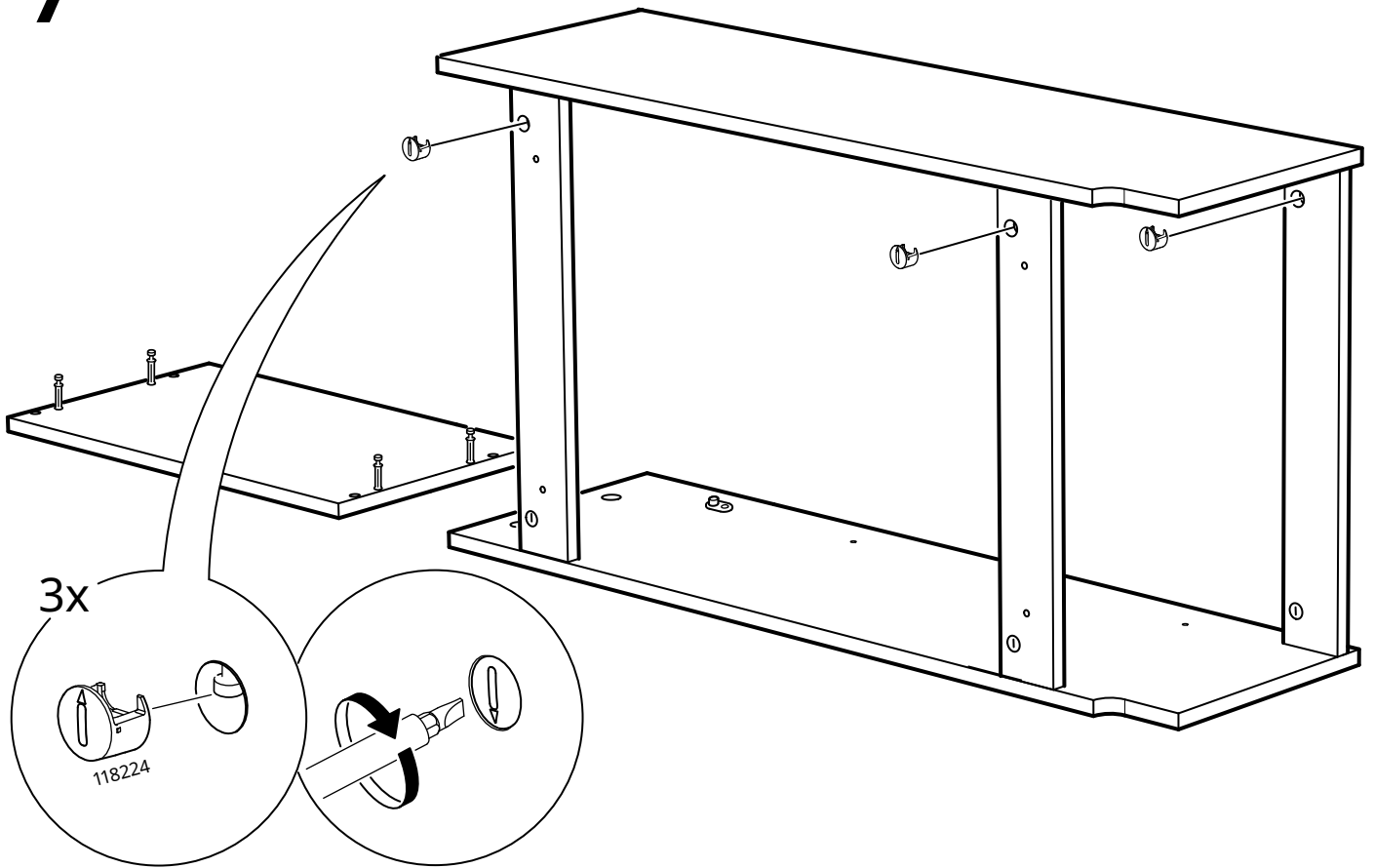

8

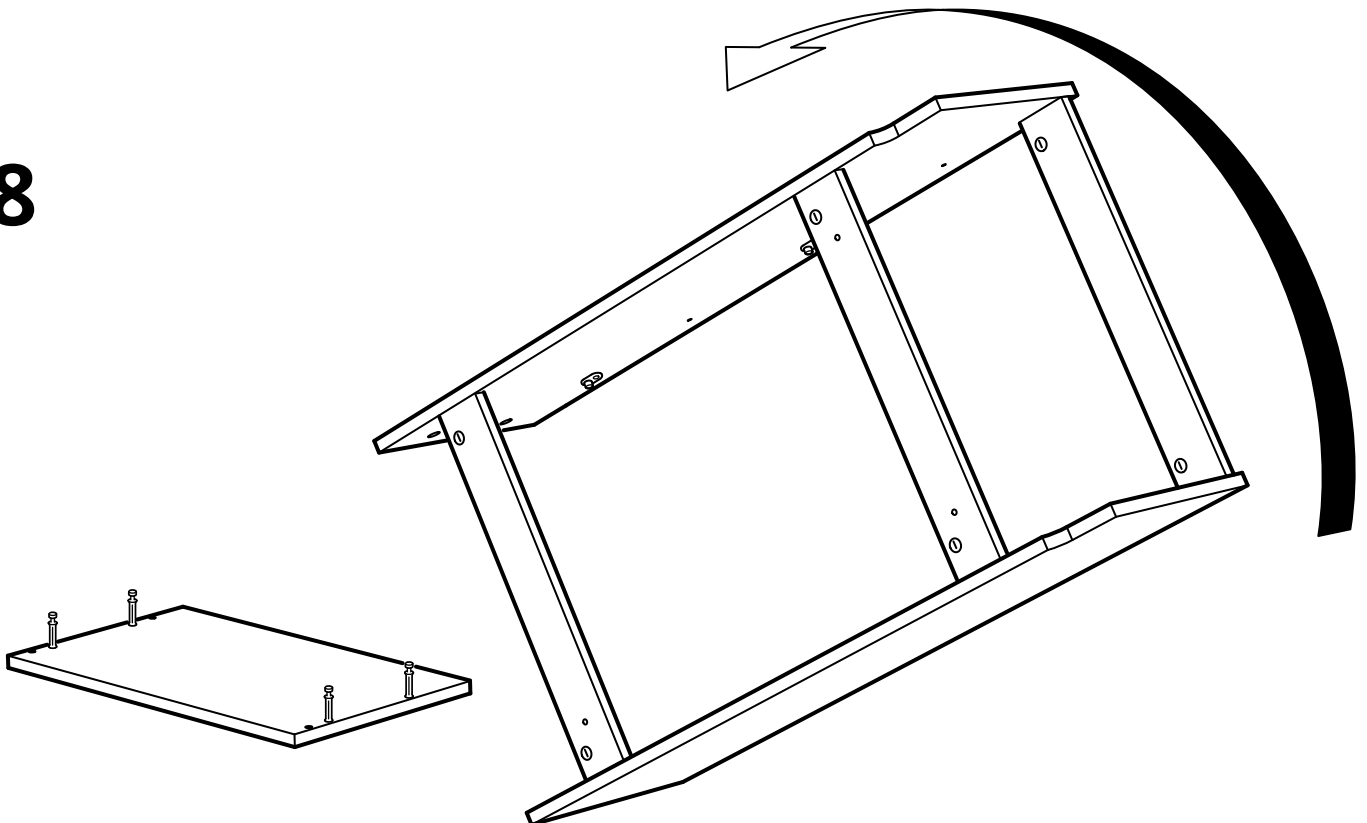

9

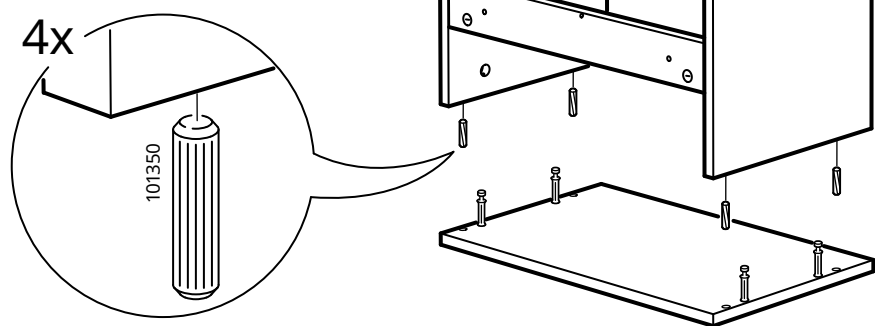

10

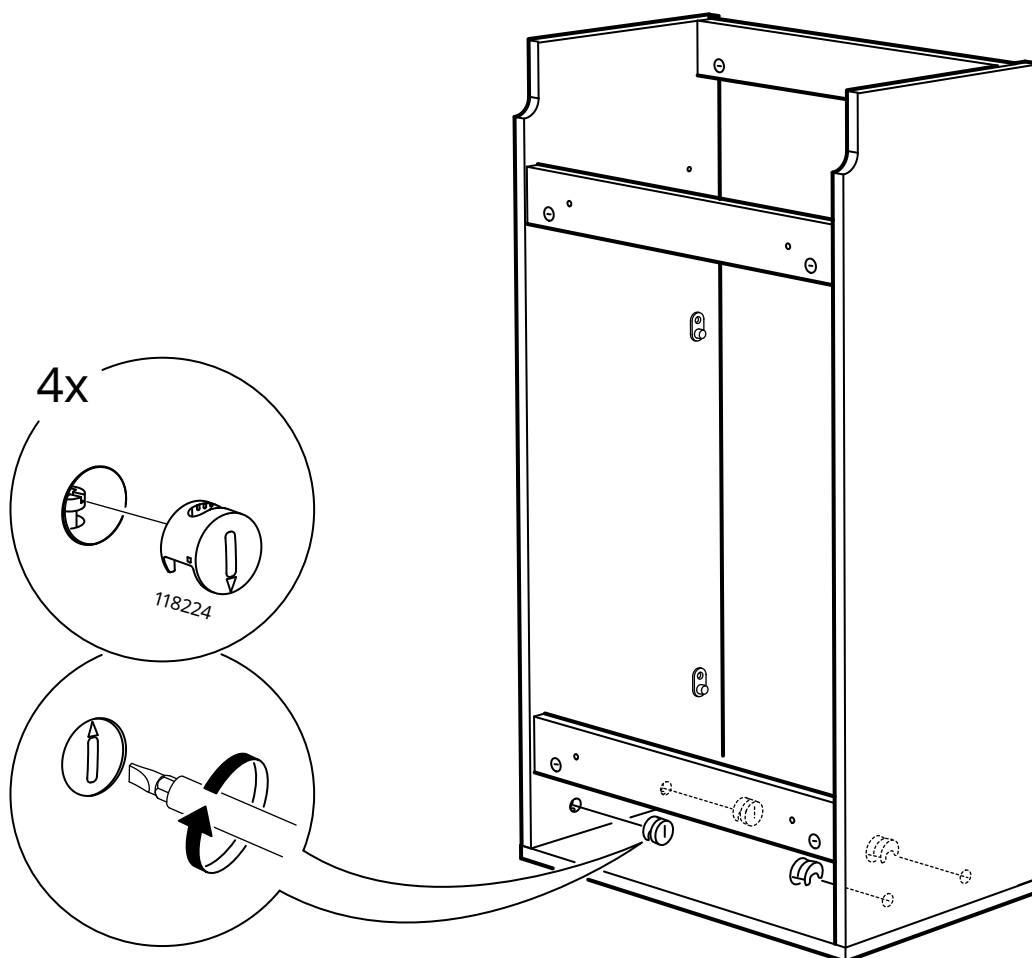

11

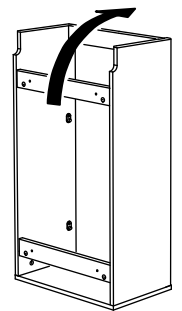
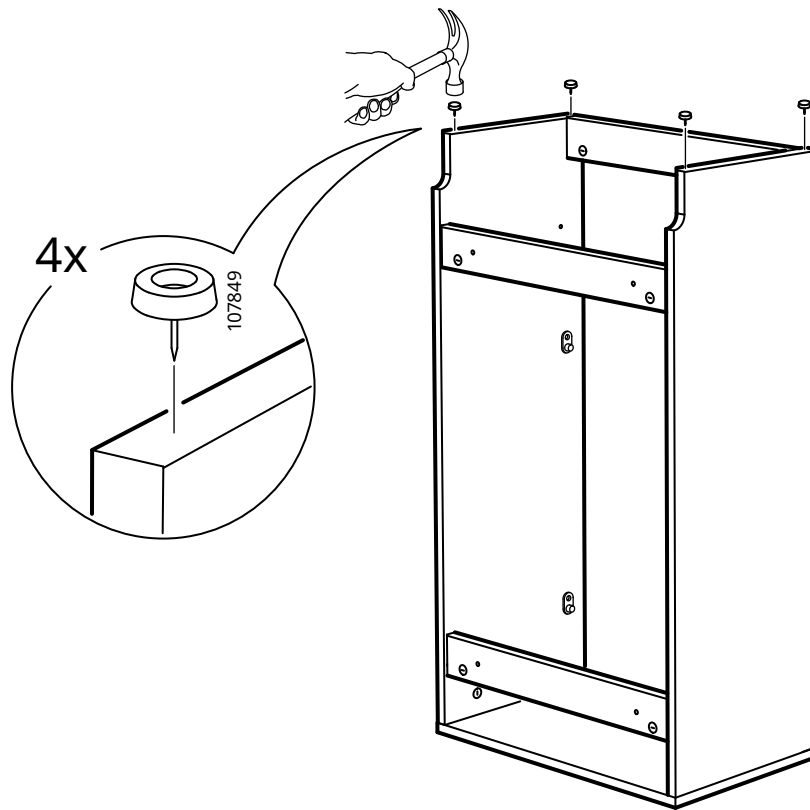

12

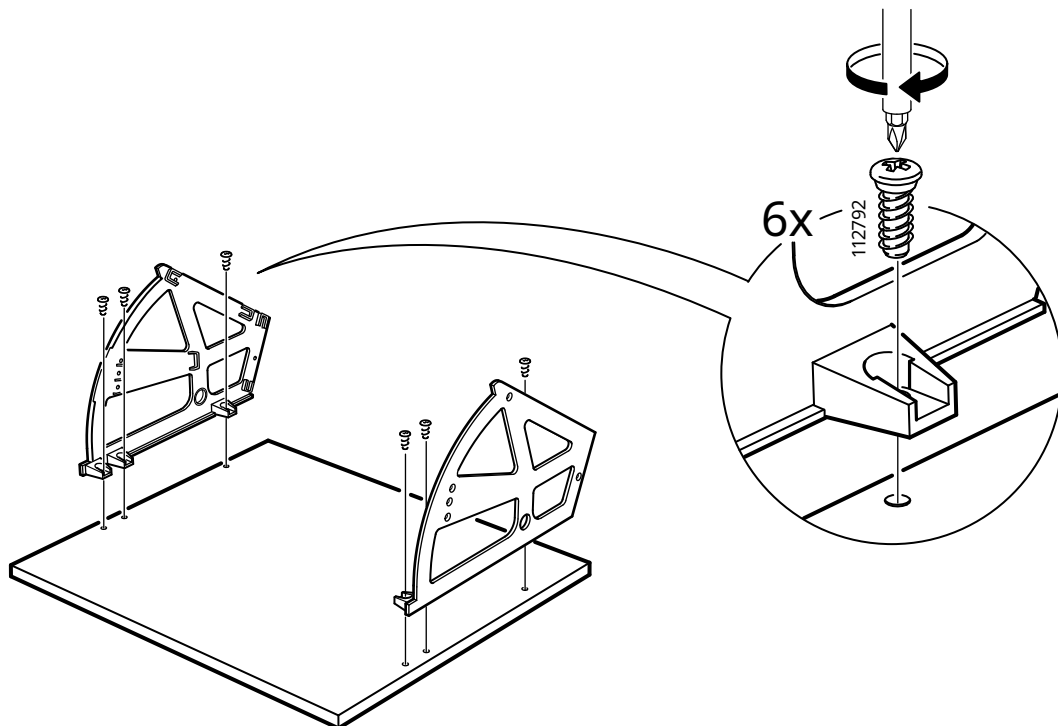

13

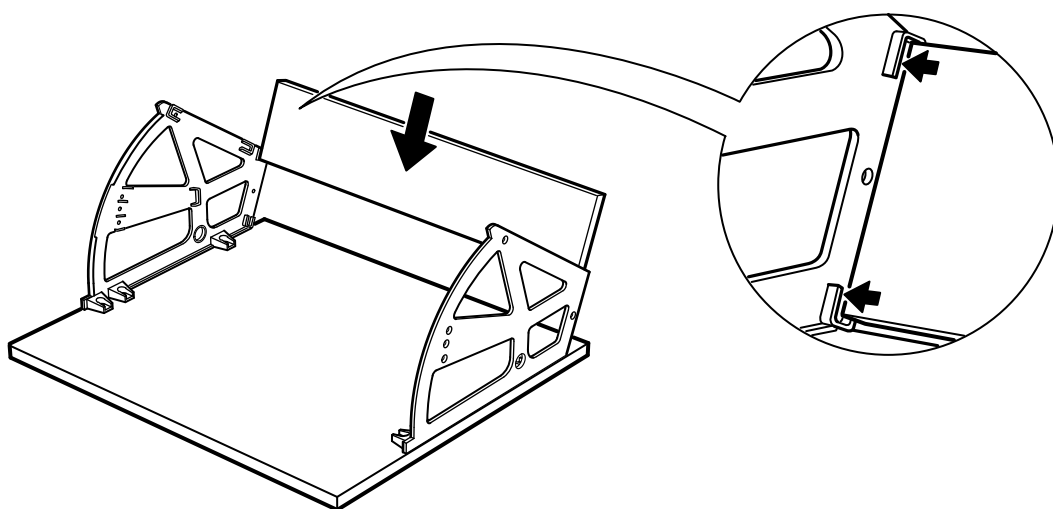
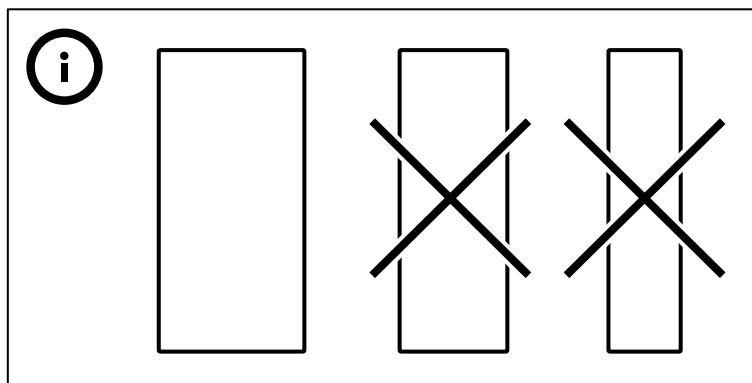

14

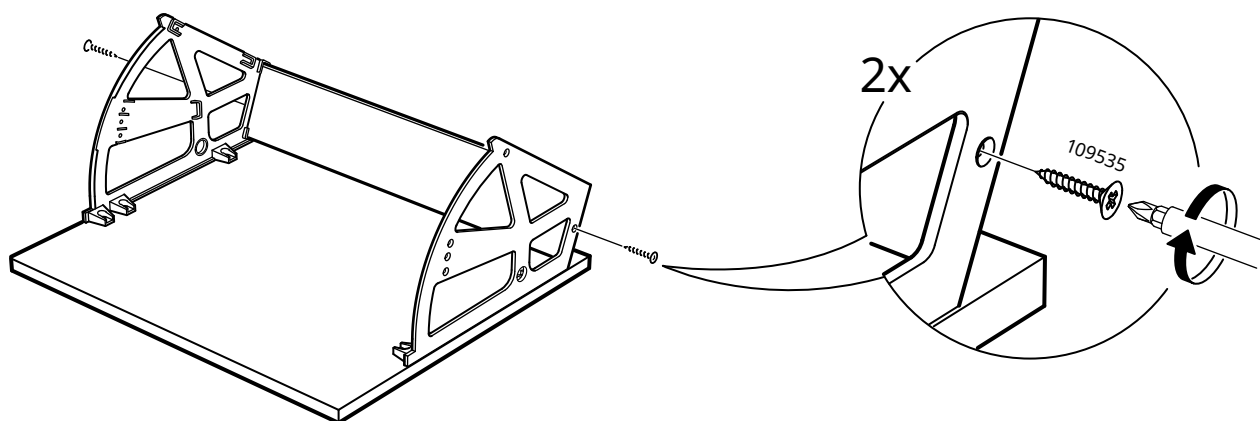

15

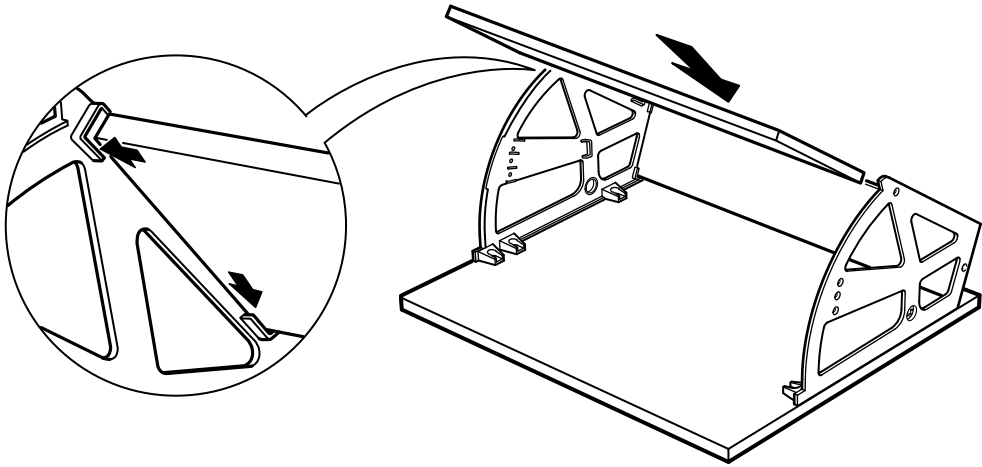
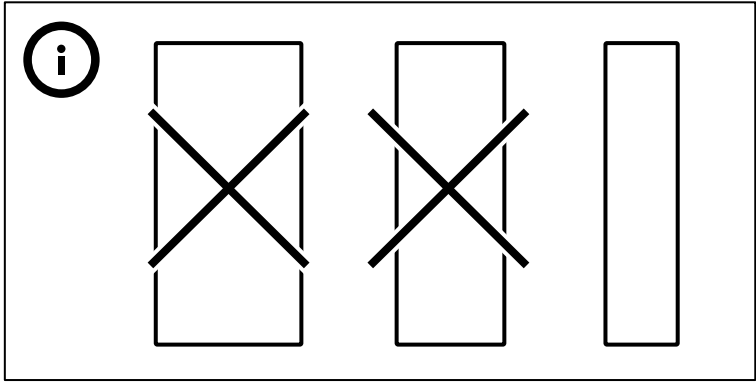

16

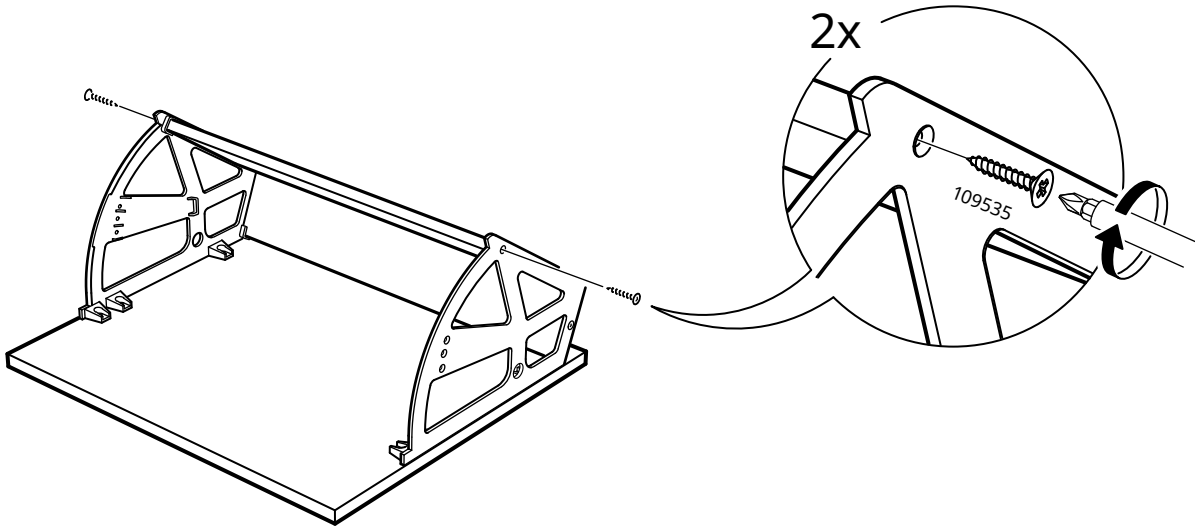

17

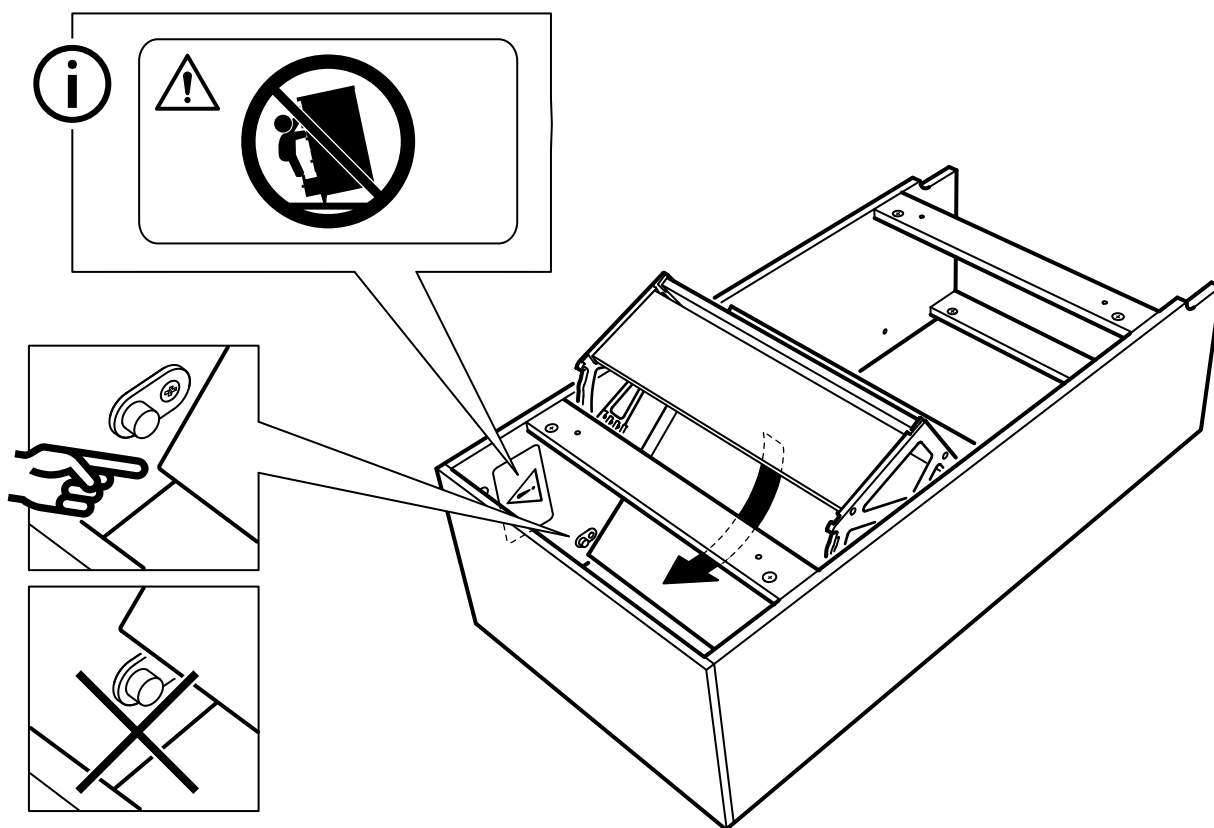

18

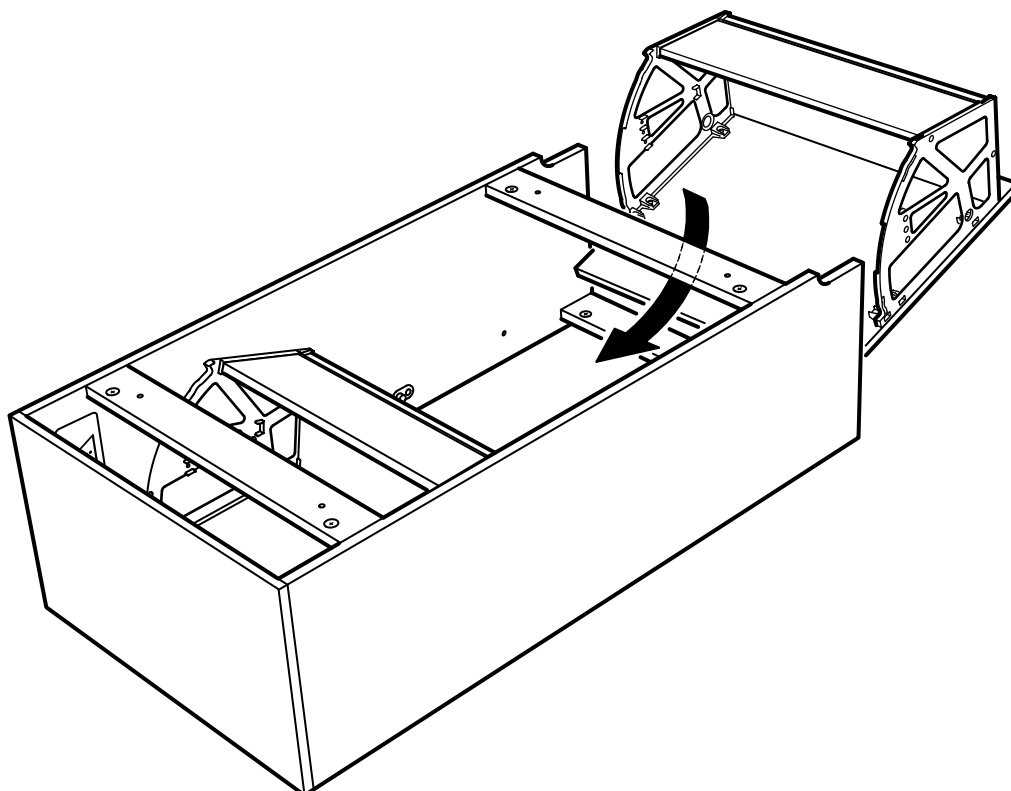

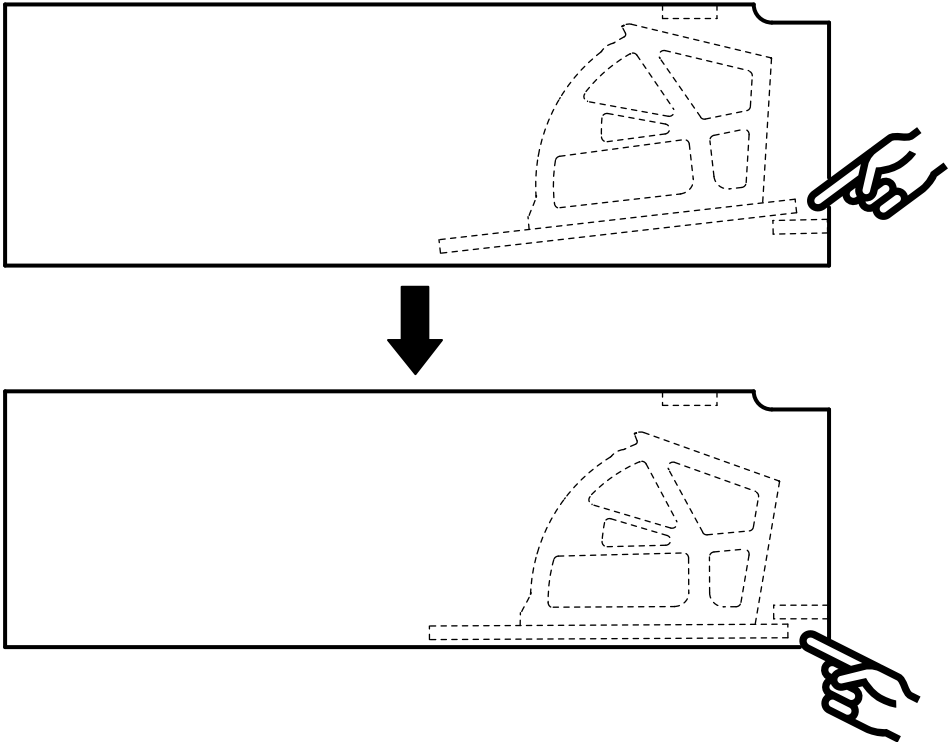
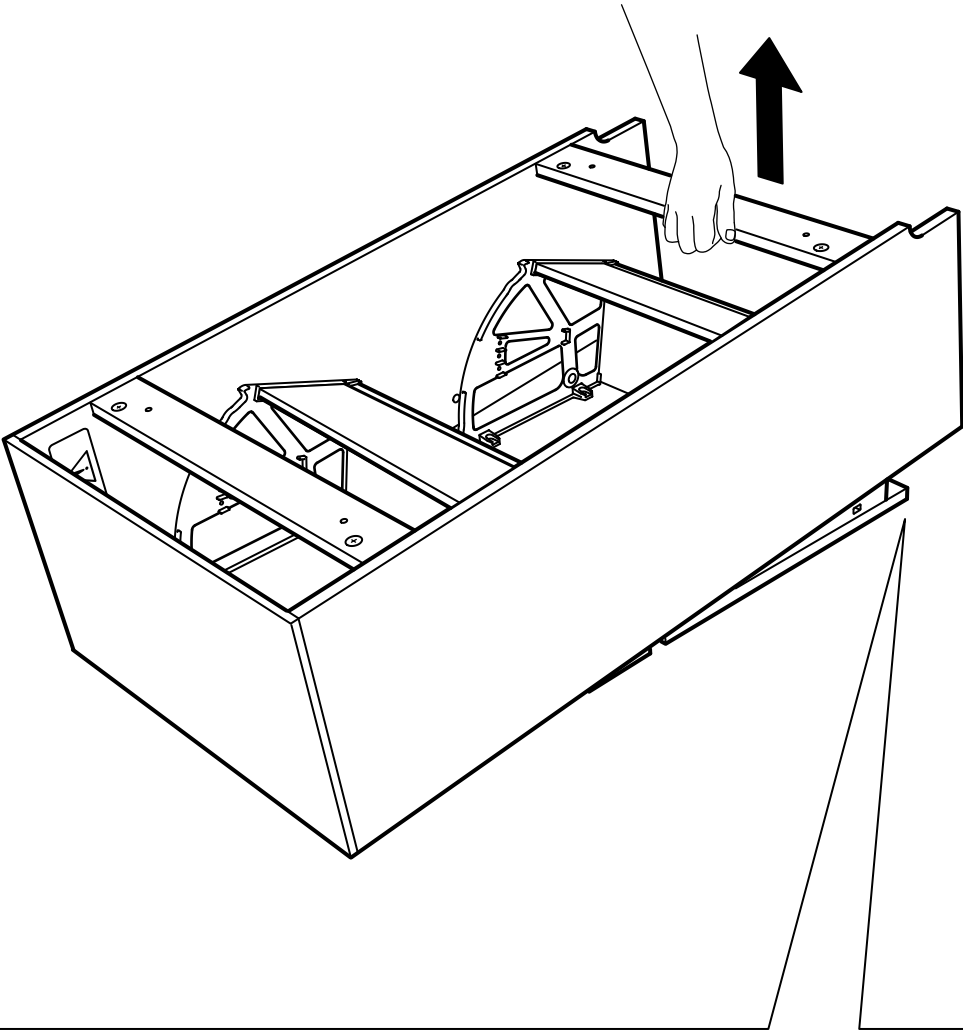

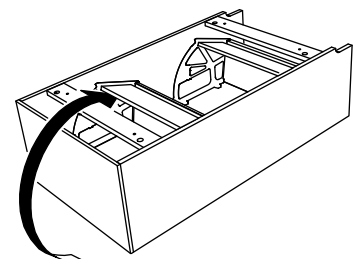
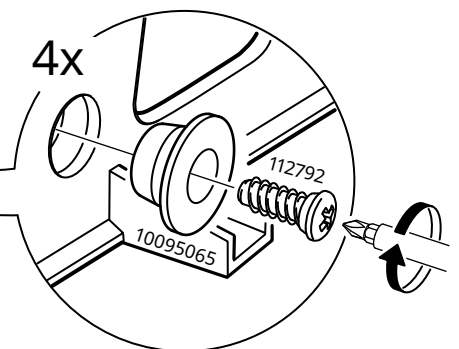
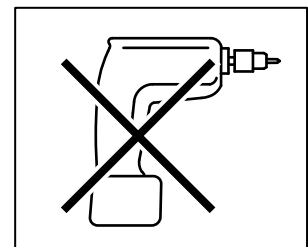
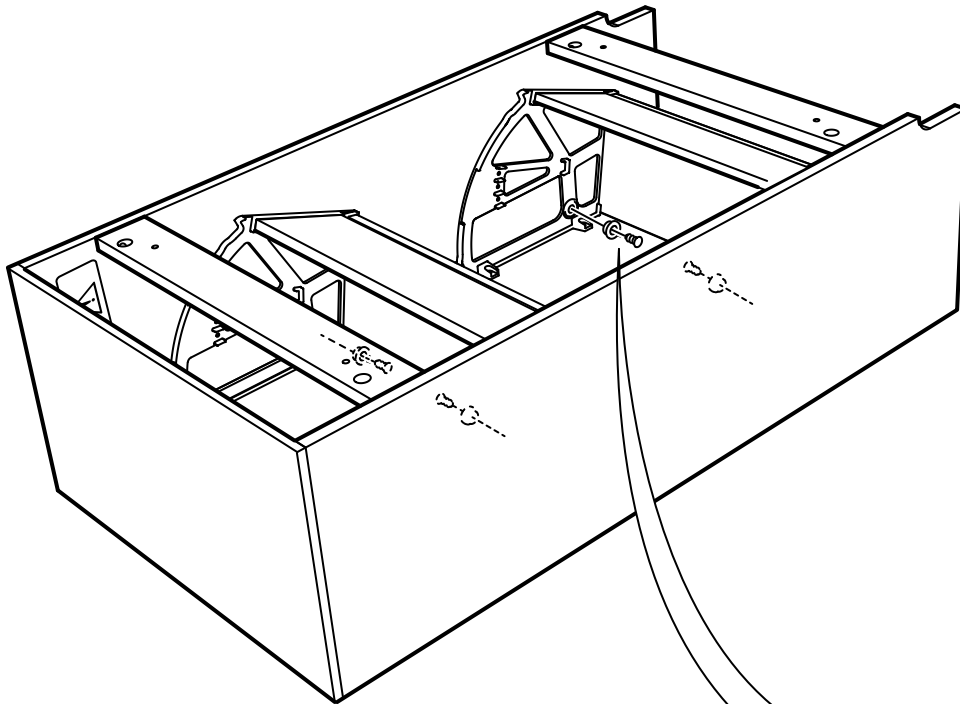



www.IKEA.com/secure-it

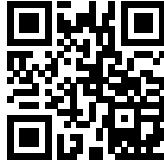

www.IKEA.cn/secure-it

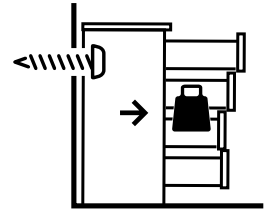

English

The screw(s) and plug(s) supplied can be used with most solid (A) and hollow (B) walls. For solid wood (C) use the screw(s) without plug(s). If you are uncertain, seek professional advice.

A

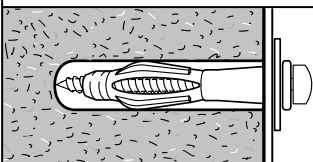

Ø 8 mm
(5/16")



1

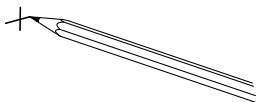

2

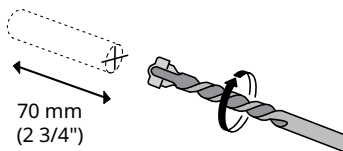

3

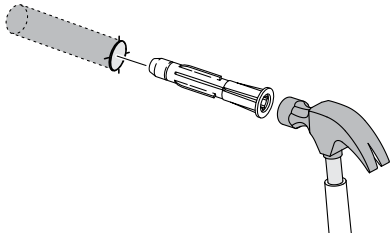

B

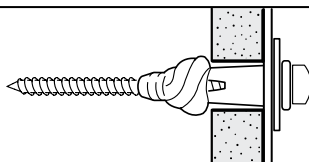

Ø 8 mm
(5/16")



1

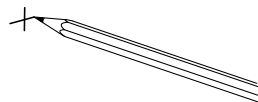

2

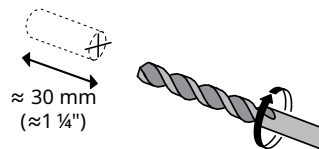

3

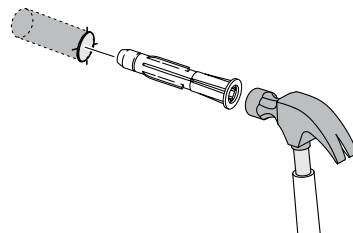

C

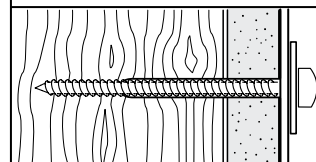

Ø 3 mm
(1/8")



1

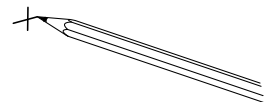

2

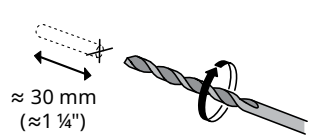

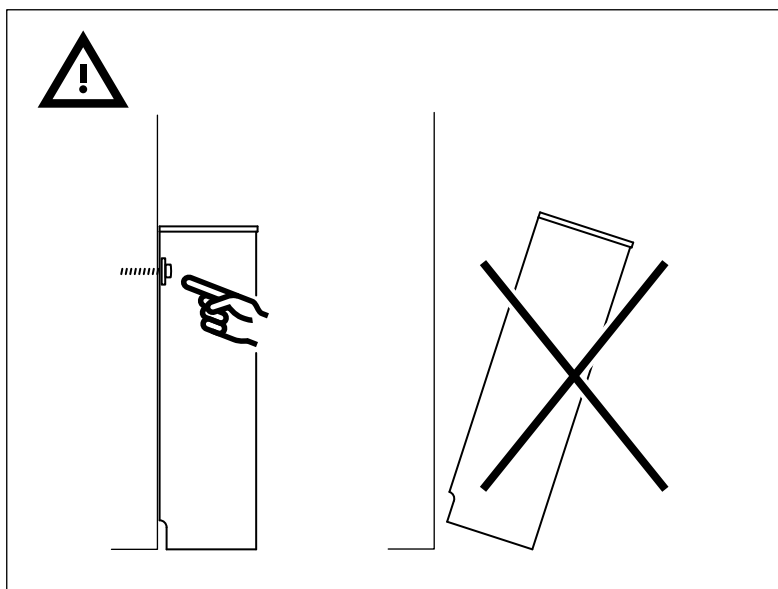

21

