

# VINDÅS

en



Design and Quality  
IKEA of Sweden







Contents

Safety Information	5	Preparation	10
Environmental concerns	6	Daily use	10
Product description	7	Maintenance and cleaning	12
First use	8	What to do if ...	13
Tehnical data	8	IKEA GUARANTEE	17
Installation	9		

Safety Information

Please review the following information. Failure to observe this information may cause injuries or material damage. Otherwise, all warranty and reliability commitments will become invalid.

Original Spare parts will be provided for 10 years, following the product purchasing date.

Intended use

This product is intended to be used:

- indoors and in closed areas such as homes;
- in closed working environments such as stores and offices;
- in closed accommodation areas such as farm houses, hotels, pensions.
- it should not be used outdoors.

General safety

- When you want to dispose/scrap the product, we recommend you to consult the authorized service in order to learn the required information and authorized bodies.
- Consult your authorized service for all your questions and problems related to the refrigerator. Do not intervene or let someone intervene to the refrigerator without notifying the authorised services.
- For products with a freezer compartment; Do not eat cone ice cream and ice cubes immediately after you take them out of the freezer compartment! (This may cause frostbite in your mouth.)
- For products with a freezer compartment: Do not put bottled and canned liquid beverages in the freezer compartment. Otherwise, these may burst.
- Do not touch frozen food by hand; they may stick to your hand.
- Unplug your refrigerator before cleaning or defrosting.

- Vapor and vaporized cleaning materials should never be used in cleaning and defrosting processes of your refrigerator. In such cases, the vapor may get in contact with the electrical parts and cause short circuit or electric shock.
- Never use the parts on your refrigerator such as the door as a means of support or step.
- Do not use electrical devices inside the refrigerator.
- Do not damage the parts, where the refrigerant is circulating, with drilling or cutting tools. The refrigerant that might blow out when the gas channels of the evaporator, pipe extensions or surface coatings are punctured causes skin irritations and eye injuries.
- Do not cover or block the ventilation holes on your refrigerator with any material.
- Electrical devices must be repaired by only authorised persons. Repairs performed by incompetent persons create a risk for the user.
- Never store spray cans containing flammable and explosive substances in the refrigerator.
- In case of any failure or during a maintenance or repair work, disconnect your refrigerator's mains supply by either turning off the relevant fuse or unplugging your appliance.
- Do not pull by the cable when pulling off the plug.
- Place the beverage with higher proofs tightly closed and vertically.
- Do not use mechanical devices or other means to accelerate the defrosting process, other than those recommended by the manufacturer.
- This product is not intended to be used by persons with physical, sensory or mental disorders or unlearned or inexperienced people (including children) unless they are attended by a person who will be responsible for their safety or who will instruct them accordingly for use of the product.
- Do not operate a damaged refrigerator. Consult with the service agent if you have any concerns.

- Electrical safety of your refrigerator shall be guaranteed only if the earth system in your house complies with standards.
- Exposing the product to rain, snow, sun and wind is dangerous with respect to electrical safety.
- Contact authorized service when there is a power cable damage to avoid danger.
- Never plug the refrigerator into the wall outlet during installation. Otherwise, risk of death or serious injury may arise
- This refrigerator is intended for only storing food items. It must not be used for any other purpose.
- Label of technical specifications is located on the left wall inside the refrigerator.
- Never connect your refrigerator to electricity-saving systems; they may damage the refrigerator.
- If there is a blue light on the refrigerator, do not look at the blue light with optical tools.
- For manually controlled refrigerators, wait for at least 5 minutes to start the refrigerator after power failure.
- This operation manual should be handed in to the new owner of the product when it is given to others.
- Avoid causing damage on power cable when transporting the refrigerator. Bending cable may cause fire. Never place heavy objects on power cable.
- Do not touch the plug with wet hands when plugging the product.

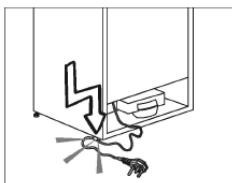

- Avoid causing damage on power cable when transporting the refrigerator. Bending cable may cause fire. Never place heavy objects on power cable.
- Do not touch the plug with wet hands when plugging the product.
- Do not plug the refrigerator if the wall outlet is loose.
- Water should not be sprayed on inner or outer parts of the product for safety purposes.
- Do not spray substances containing inflammable gases such as propane gas near the refrigerator to avoid fire and explosion risk.
- Never place containers filled with water on top of the refrigerator; in the event of spillages, this may cause electric shock or fire.
- Do not overload the refrigerator with food. If overloaded, the food items may fall down and hurt you and damage refrigerator when you open the door.
- Never place objects on top of the refrigerator; otherwise, these objects may fall down when you open or close the refrigerator's door.
- As they require a precise temperature, vaccines, heat-sensitive medicine and scientific materials and etc. should not be kept in the refrigerator.
- If not to be used for a long time, refrigerator should be unplugged. A possible problem in power cable may cause fire.
- The plug's tip should be cleaned regularly with a dry cloth; otherwise, it may cause fire.
- Refrigerator may move if adjustable legs are not properly secured on the floor. Properly securing adjustable legs on the floor can prevent the refrigerator to move.
- When carrying the refrigerator, do not hold it from door handle. Otherwise, it may be snapped.
- When you have to place your product next to another refrigerator or freezer, the distance between devices should be at least 8cm. Otherwise, adjacent side walls may be humidified.

## Environmental concerns

### Compliance with the WEEE Regulation and Disposing of the Waste Product



The symbol  on the product or on packaging indicates that this product may not be treated as household waste. Instead it shall be handed over to the applicable collection point for the recycling of electrical and electronic equipment. By ensuring this product is disposed of correctly, you will help prevent potential negative consequences for the environment and human health, which could otherwise be caused by inappropriate waste handling of this product. For more detailed information about recycling of this product, please

contact your local city office, your household waste disposal service or the shop where you purchased the product.

### Package information



Packaging materials of the product are manufactured from recyclable materials in accordance with our National Environment Regulations. Do not dispose of the packaging materials together with the domestic or other wastes. Take them to the packaging material collection points designated by the local authorities.

## Do not forget...

Any recycled substance is an indispensable matter for nature and our national asset wealth.

If you want to contribute to the reevaluation of the packaging materials, you can consult to your environmentalist organizations or the municipalities where you are located.

## HCA warning

If your product's cooling system contains R600a:

This gas is flammable. Therefore, pay attention to not damaging the cooling system and piping during usage and transportation. In the event of damage, keep your product away from potential fire sources that can cause the product catch a fire and ventilate the room in which the unit is placed.

Type of gas used in the product is stated in the type label which is on the left wall inside the refrigerator.

Never throw the product in fire for disposal.

- Do not put hot food or drinks in your refrigerator.
- Do not overload your refrigerator so that the air circulation inside of it is not prevented.
- Do not install your refrigerator under direct sunlight or near heat emitting appliances such as ovens, dishwashers or radiators. Keep your refrigerator at least 30 cm away from heat emitting sources and at least 5 cm from electrical ovens.
- Pay attention to keep your food in closed containers.
- For products with a freezer compartment; You can store maximum amount of food items in the freezer when you remove the shelf or drawer of the freezer.
- Energy consumption value stated for your refrigerator has been determined by removing freezer shelf or drawer and under maximum load. There is no harm to use a shelf or drawer according to the shapes and size of food to be frozen.
- Thawing frozen food in fridge compartment will both provide energy saving and preserve the food quality.

## Things to be done for energy Saving

- Do not leave the doors of your refrigerator open for a long time.

**⚠** In case the information which are given in the user manual are not taken into account, manufacturer will not assume any liability for this.

## Product description

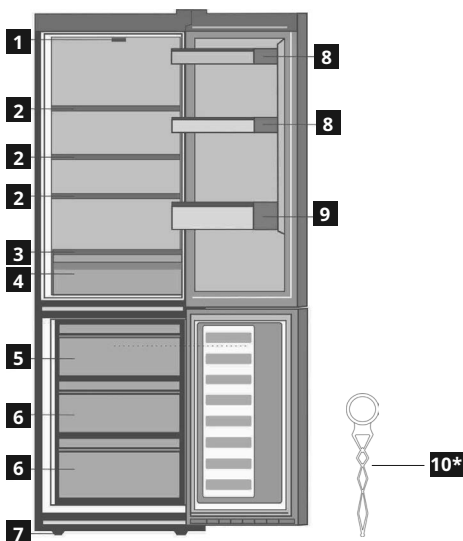

- 1 Setting knob and interior light
- 2 Adjustable Cabinet shelves
- 3 Cover glass
- 4 Salad crispers
- 5 Compartment for quickly freezing
- 6 Compartments for frozen froods
- 7 Adjustable front feet
- 8 Shelf for jars
- 9 Shelf for bottles
- 10 Plunger

\* (annexed to the reversibility kit)

First use

Before using your refrigerator, make sure the necessary preparations are made in line with the instructions in "Safety Information" and "Installation" sections.

- ❗ After horizontal transportation, product must stand upright for 4 hours before switch on to allow compressor oil to settle.
- ❗ Keep the product running without placing any food inside for 12 hours and do not open the door, unless absolutely necessary.
- ❗ A sound will be heard when the compressor is engaged. It is normal for the product to make noise even if the compressor is not running, as fluid and gas may be compressed in the cooling system.
- ❗ It is normal for the front edges of the freezer area to be warm. These areas are designed to warm up in order to prevent condensation.

Tehnnical data

Dimensions (mm)	VINDÁS
Height(min-max)	1857
Width	595
Depth	661
Net Volume(l)	
Fridge	223
Freezer	120
Defrost system	
Fridge	auto
Freezer	manual
Star Rating	4
Rising Time ( h)	12
Freezing capacity(kg/24h)	6
Energy consumption( kwh/Year)	304
Noise level(dba)	38
Energy class	1



## Installation

To make the product ready for use, be careful that the electrical wiring and plumbing are appropriate by referring to the information in the user manual. If not, call a qualified electrician and plumber and have the necessary arrangements made.

**⚠ WARNING:** The manufacturer is not liable for damages caused by operations by unauthorized persons. To avoid shaking, place the product on a flat surface.

**⚠ WARNING:** During the installation, the power plug of the product should not be plugged in. Otherwise, there is a danger of death or serious injury!

**⚠ WARNING:** If the doorway of the room to where the product will be placed is so narrow that the product cannot pass through, pass the product by turning it to side; otherwise, call an authorized service.

- Do not expose the product to direct sunlight and do not store it in humid place.
- Do not install the product where the temperature drops below 10 °C.

### Points to be paid attention to when the relocation of the refrigerator

1. Your refrigerator should be unplugged. Before transportation of your refrigerator, it should be emptied and cleaned.
2. Before it is re-packaged, shelves, accessories, crisper, etc. inside your refrigerator should be fixed with adhesive tape and secured against impacts. Package should be bound with a thick tape or sound ropes and the transportation rules on the package should be strictly observed.
3. Original packaging and foam materials should be kept for future transportations or moving.

### Before you start the refrigerator,

Check the following before you start to use your refrigerator:

1. Clean the interior of the refrigerator as recommended in the "Maintenance and cleaning" section.
2. Open the back condenser.
3. Connect the plug of the refrigerator to the wall socket. When the fridge door is opened, fridge internal lamp will turn on.
4. When the compressor starts to operate, a sound will be heard. The liquid and gases sealed within the refrigeration system may also give rise to noise, even if the compressor is not running and this is quite normal.
5. Front edges of the refrigerator may feel warm. This is normal. These areas are designed to be warm to avoid condensation.

### Electrical connection

Connect your product to a grounded socket which is being protected by a fuse with the appropriate capacity. Important:

The connection must be in compliance with national regulations.

- The power plug must be easily accessible after installation.
- Electrical safety of your refrigerator shall be guaranteed only if the earth system in your house complies with standards.
- The voltage stated on the label located at left inner side of your product should be equal to your network voltage.
- Extension cables and multi plugs must not be used for connection.

**⚠** A damaged power cable must be replaced by a qualified electrician.

**⚠** Product must not be operated before it is repaired! There is the risk of electric shock!

### Disposing of the packaging

The packing materials may be dangerous for children. Keep the packing materials out of the reach of children or dispose of them by classifying them in accordance with the waste instructions stated by your local authorities. Do not throw away with regular house waste, throw away on packaging pick up spots designated by the local authorities.

The packing of your refrigerator is produced from recyclable materials.

### Disposing of your old Refrigerator

Dispose of your old refrigerator without giving any harm to the environment.

- You may consult your authorized dealer or waste collection center of your municipality about the disposal of your refrigerator.

Before disposing of your refrigerator, cut out the electric plug and, if there are any locks on the door, make them inoperable in order to protect children against any danger.

### Changing the illumination Lamp

To change the Bulb/LED used for illumination of your refrigerator, call your Authorized Service.

The lamp(s) used in this appliance is not suitable for household room illumination. The intended

purpose of this lamp is to assist the user to place foodstuffs in the refrigerator/freezer in a safe and comfortable way.

The lamps used in this appliance have to withstand extreme physical conditions such as temperatures below -20°C.

Adjusting the legs

If your refrigerator is unbalanced; You can balance your refrigerator by turning its front legs as illustrated in the figure. The corner where the leg exists is lowered when you turn in the direction of black arrow and raised when you turn in the opposite direction. Taking help from someone to slightly lift the refrigerator will facilitate this process.

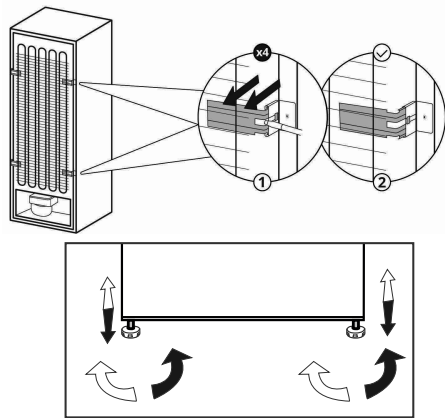

Preparation

- Your refrigerator should be installed at least 30 cm away from heat sources such as hobs, ovens, central heater and stoves and at least 5 cm away from electrical ovens and should not be located under direct sunlight
- Original packaging and foam materials should be kept for future transportations or moving.
- Please make sure that the interior of your refrigerator is cleaned thoroughly.
- If two refrigerators are to be installed side by side, there should be at least 5 cm distance between them.
- The door should not be opened frequently.
- When you operate your refrigerator for the first time, please observe the following instructions during the initial 12 hours.
- It must be operated empty without any food in it.
- Do not unplug your refrigerator. If a power failure occurs out of your control, please see the warnings in the “What to do if ...” section.
- The ambient temperature of the room where you install your refrigerator should at least be 10°C. Operating your refrigerator under cooler conditions is not recommended with regard to its efficiency.

Daily use

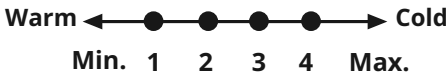
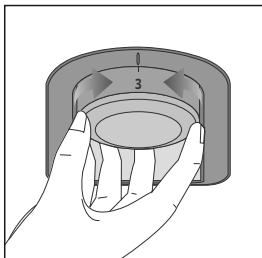

Thermostat setting button

The interior temperature of your refrigerator changes for the following reasons:

- Seasonal temperatures.
- Frequent opening of the door and leaving the door open for long periods.
- Food put into the refrigerator without cooling down to the room temperature.

- The location of the refrigerator in the room (e.g. exposing to sunlight).
- You may adjust the varying interior temperature due to such reasons by using the thermostat. Numbers around the thermostat button indicates the cooling degrees.
- If the ambient temperature is higher than 32°C, turn the thermostat button to maximum position.
- If the ambient temperature is lower than 25°C, turn the thermostat button to minimum position.

## Defrost

### A) Fridge compartment

Fridge compartment performs full-automatic defrosting.

Water drops and a frosting up to 7-8 mm can occur on the inner rear wall of the fridge compartment while your refrigerator cools down. Such formation is normal as a result of the cooling system.

The frost formation is defrosted by performing automatic defrosting with certain intervals thanks to the automatic defrosting system of the rear wall. User is not required to scrape the frost or remove the water drops. Water resulting from the defrosting passes from the water collection groove and flows into the evaporator through the drain pipe and evaporates here by itself.

Check regularly to see if the drain pipe is clogged or not and clear it with the stick in the hole when necessary.

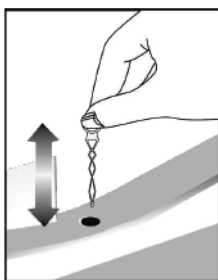

### B) Freezer compartment

Deep freezer compartment does not perform automatic defrosting in order to prevent decaying of the frozen food. Defrosting is very straightforward and without mess, thanks to a special defrost collection basin. Defrost twice a year or when a frost layer of around 7 (1/4") mm has formed. To start the defrosting procedure, switch



off the appliance at the socket outlet and pull out the mains plug. All food should be wrapped in several layers of newspaper and stored in a cool place (e.g. fridge or larder).

Containers of warm water may be placed carefully in the freezer to speed up the defrosting. Do not use pointed or sharpedged objects, such as knives or forks to remove the frost. Never use hair dryers, electrical heaters or other such electrical appliances for defrosting.

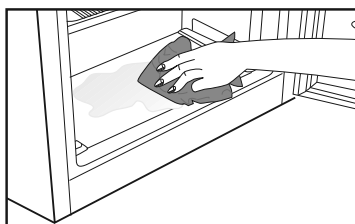
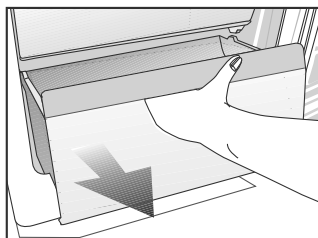
Sponge out the defrost water collected in the bottom of the freezer compartment. After defrosting, dry the interior thoroughly. Insert the plug into the wall socket and switch on the electricity supply.

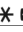

## Recommendations for preservation of frozen food

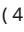
Prepacked commercially frozen food should be stored in accordance with the frozen food manufacturer's instructions for a     (4 star) frozen food storage compartment.

- To ensure that the high quality achieved by the frozen food manufacturer and the food retailer is maintained, the following should be remembered:

1. Put packages in the freezer as quickly as possible after purchase.
2. Ensure that contents are labeled and dated.
3. Do not exceed "Use By", "Best Before" dates on the packaging.

## Recommendations for the fresh food compartment

- Do not allow the food to touch the temperature sensor in fresh food compartment. To allow the fresh food compartment keep its ideal storage temperature, sensor must not be hindered by food.
- Do not place hot foods in the product.

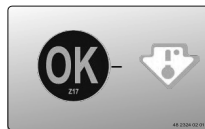
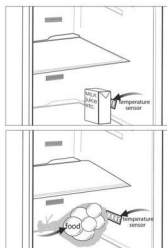

To maintain a correct temperature inside the appliance, check that the indicator always shows OK.

If the indicator turns black, the temperature is too high in this case, increase the thermostat setting and wait for 12 hours before checking the indicator again.

When fresh food has been introduced or the door has been left open for some time, it is normal for the indicator to turn black.

## COLDEST ZONE INSIDE THE REFRIGERATOR

The symbol at the side indicates the coldest zone in the refrigerator. The coldest zone is between the glass shelf of the salad crisper at the bottom of the refrigerator and the bottom cabinet shelf.

To maintain the temperature in the zone, be careful not to change the position of the rack.

For optimum temperature adjustment, the refrigerator is provided with a temperature indicator to allow you to control the average temperature in the coldest zone.

You can carry out regular checks to ensure the temperature in the coldest zone is correct and, if necessary, adjust the thermostat as indicated in the user instructions (chapter "Daily use").



Correct setting



Temperature too high, adjust the thermostat

## Maintenance and cleaning

⚠ Never use gasoline, benzene or similar substances for cleaning purposes.

⚠ We recommend that you unplug the appliance before cleaning.

⚠ Never use any sharp abrasive instrument, soap, household cleaner, detergent and wax polish for cleaning.

1 Use lukewarm water to clean the cabinet of your refrigerator and wipe it dry.

1 Use a damp cloth wrung out in a solution of one teaspoon of bicarbonate of soda to one pint of water to clean the interior and wipe it dry.

⚠ Make sure that no water enters the lamp housing and other electrical items.

1 Check door seals regularly to ensure they are clean and free from food particles.

⚠ If your refrigerator is not going to be used for a long period of time, unplug the power cable, remove all food, clean it and leave the door ajar.

⚠ To remove door racks, remove all the contents and then simply push the door rack upwards from the base.

⚠ Never use cleaning agents or water that contain chlorine to clean the outer surfaces and chromium coated parts of the product. Chlorine causes corrosion on such metal surfaces.

## Protection of plastic surfaces

1 Do not put the liquid oils or oil-cooked meals in your refrigerator in unsealed containers as they damage the plastic surfaces of your refrigerator. In case of spilling or smearing oil on the plastic surfaces, clean and rinse the relevant part of the surface at once with warm water.

What to do if ...

Please review this list before calling the service. It will save your time and money. This list includes frequent complaints that are not arising from defective workmanship or material usage. Some of the features described here may not exist in your product.

Problems		Solutions
The refrigerator does not operate.	<ul style="list-style-type: none"><li>The plug is not inserted into the socket correctly.</li></ul>	<ul style="list-style-type: none"><li>Insert the plug into the socket securely.</li></ul>
	<ul style="list-style-type: none"><li>The fuse of the socket which your refrigerator is connected to or the main fuse have blown out.</li></ul>	<ul style="list-style-type: none"><li>Check the fuse.</li></ul>
Condensation on the side wall of the fridge compartment (MULTIZONE, COOL CONTROL and FLEXIZONE).	<ul style="list-style-type: none"><li>Door has been opened frequently.</li></ul>	<ul style="list-style-type: none"><li>Do not open and close the door of refrigerator frequently.</li></ul>
	<ul style="list-style-type: none"><li>Ambient is very humid.</li></ul>	<ul style="list-style-type: none"><li>Do not install your refrigerator into highly humid places.</li></ul>
	<ul style="list-style-type: none"><li>Food containing liquid is stored in open containers.</li></ul>	<ul style="list-style-type: none"><li>Do not store food with liquid content in open containers.</li></ul>
	<ul style="list-style-type: none"><li>Door of the refrigerator is left open.</li></ul>	<ul style="list-style-type: none"><li>Close the door of the refrigerator.</li></ul>
	<ul style="list-style-type: none"><li>Thermostat is set to a very cold level.</li></ul>	<ul style="list-style-type: none"><li>Set the thermostat to a suitable level.</li></ul>
Compressor is not running	<ul style="list-style-type: none"><li>Protective thermic of the compressor will blow out during sudden power failures.</li></ul>	<ul style="list-style-type: none"><li>The refrigerator will start running approximately after 6 minutes.</li></ul>
	<ul style="list-style-type: none"><li>plug-out plug-ins as the refrigerant pressure in the cooling system of the refrigerator has not been balanced yet.</li></ul>	<ul style="list-style-type: none"><li>Please call the service if the refrigerator does not startup at the end of this period.</li></ul>
	<ul style="list-style-type: none"><li>The fridge is in defrost cycle.</li></ul>	<ul style="list-style-type: none"><li>This is normal for a full-automatically defrosting refrigerator. Defrosting cycle occurs periodically.</li></ul>
	<ul style="list-style-type: none"><li>The refrigerator is not plugged into the socket.</li></ul>	<ul style="list-style-type: none"><li>Make sure that the plug is fit into the socket.</li></ul>
	<ul style="list-style-type: none"><li>Temperature settings are not made correctly.</li></ul>	<ul style="list-style-type: none"><li>Select the suitable temperature value.</li></ul>
	<ul style="list-style-type: none"><li>There is a power outage.</li></ul>	<ul style="list-style-type: none"><li>Refrigerator returns to normal operation when the power restores.</li></ul>

<ul style="list-style-type: none"><li>• The operation noise increases when the refrigerator is running.</li></ul>	<ul style="list-style-type: none"><li>• The operating performance of the refrigerator may change due to the changes in the ambient temperature. It is normal and not a fault.</li></ul>	
The refrigerator is running frequently or for a long time.	<ul style="list-style-type: none"><li>• New product may be wider than the previous one. Larger refrigerators operate for a longer period of time.</li></ul>	
	<ul style="list-style-type: none"><li>• The room temperature may be high.</li></ul>	<ul style="list-style-type: none"><li>• It is normal that the product operates for longer periods in hot ambient.</li></ul>
	<ul style="list-style-type: none"><li>• The refrigerator might be plugged in recently or might be loaded with food.</li></ul>	<ul style="list-style-type: none"><li>• When the refrigerator is plugged in or loaded with food recently, it will take longer for it to attain the set temperature. This is normal.</li></ul>
	<ul style="list-style-type: none"><li>• Large amounts of hot food might be put in the refrigerator recently.</li></ul>	<ul style="list-style-type: none"><li>• Do not put hot food into the refrigerator.</li></ul>
	<ul style="list-style-type: none"><li>• Doors might be opened frequently or left open for a long time.</li></ul>	<ul style="list-style-type: none"><li>• &gt;The warm air that has entered into the refrigerator causes the refrigerator to run for longer periods. Do not open the doors frequently.</li></ul>
	<ul style="list-style-type: none"><li>• Freezer or fridge compartment door might be left open.</li></ul>	<ul style="list-style-type: none"><li>• Check if the doors are closed completely.</li></ul>
	<ul style="list-style-type: none"><li>• The refrigerator is adjusted to a very low temperature.</li></ul>	<ul style="list-style-type: none"><li>• Adjust the refrigerator temperature to a warmer degree and wait until the temperature is achieved.</li></ul>
	<ul style="list-style-type: none"><li>• Door seal of the fridge or freezer may be soiled, worn out, broken or not properly seated.</li></ul>	<ul style="list-style-type: none"><li>• Clean or replace the seal. Damaged/broken seal causes the refrigerator to run for a longer period of time in order to maintain the current temperature.</li></ul>
Fridge temperature is very low while the freezer temperature is sufficient.	<ul style="list-style-type: none"><li>• The fridge temperature is adjusted to a very low value.</li></ul>	<ul style="list-style-type: none"><li>• Adjust the freezer temperature to a warmer degree and check.</li></ul>
Freezer temperature is very low while the fridge temperature is sufficient.	<ul style="list-style-type: none"><li>• The freezer temperature is adjusted to a very low value.</li></ul>	<ul style="list-style-type: none"><li>• Adjust the fridge temperature to a lower value and check.</li></ul>
Food kept in the fridge compartment drawers is frozen.	<ul style="list-style-type: none"><li>• The fridge temperature is adjusted to a very high value.</li></ul>	<ul style="list-style-type: none"><li>• Adjust the fridge temperature to a lower value and check.</li></ul>

Temperature in the fridge or freezer is very low.	<ul style="list-style-type: none"><li>The fridge temperature is adjusted to a very high value.</li></ul>	<ul style="list-style-type: none"><li>Fridge compartment temperature setting has an effect on the temperature of the freezer. Change the temperatures of the fridge or freezer and wait until the relevant compartments attain a sufficient temperature.</li></ul>
	<ul style="list-style-type: none"><li>Doors are opened frequently or left open for a long time.</li></ul>	<ul style="list-style-type: none"><li>Do not open the doors frequently.</li></ul>
	<ul style="list-style-type: none"><li>Door is open.</li></ul>	<ul style="list-style-type: none"><li>Close the door completely.</li></ul>
	<ul style="list-style-type: none"><li>The refrigerator is plugged in or loaded with food recently.</li></ul>	<ul style="list-style-type: none"><li>This is normal. When the refrigerator is plugged in or loaded with food recently, it will take longer for it to attain the set temperature.</li></ul>
	<ul style="list-style-type: none"><li>Large amounts of hot food might be put in the refrigerator recently.</li></ul>	<ul style="list-style-type: none"><li>Do not put hot food into the refrigerator.</li></ul>
Vibrations or noise.	<ul style="list-style-type: none"><li>The floor is not level or stable.</li></ul>	<ul style="list-style-type: none"><li>If the refrigerator rocks when moved slowly, balance it by adjusting its feet. Also make sure that the floor is strong enough to carry the refrigerator, and level.</li></ul>
	<ul style="list-style-type: none"><li>The items put onto the refrigerator may cause noise.</li></ul>	<ul style="list-style-type: none"><li>Remove the items on top of the refrigerator.</li></ul>
There are noises coming from the refrigerator like liquid flowing, spraying, etc.	<ul style="list-style-type: none"><li>Liquid and gas flows occur in accordance with the operating principles of your refrigerator. It is normal and not a fault.</li></ul>	
Whistle comes from the refrigerator.	<ul style="list-style-type: none"><li>Fans are used in order to cool the refrigerator. It is normal and not a fault.</li></ul>	
Condensation on the inner walls of refrigerator.	<ul style="list-style-type: none"><li>Hot and humid weather increases icing and condensation. It is normal and not a fault.</li></ul>	
	<ul style="list-style-type: none"><li>Doors are opened frequently or left open for a long time.</li></ul>	<ul style="list-style-type: none"><li>Do not open the doors frequently. Close them if they are open.</li></ul>
	<ul style="list-style-type: none"><li>Door is open.</li></ul>	<ul style="list-style-type: none"><li>Close the door completely.</li></ul>
Humidity occurs on the outside of the refrigerator or between the doors.	<ul style="list-style-type: none"><li>There might be humidity in the air; this is quite normal in humid weather. When the humidity is less, condensation will disappear.</li></ul>	

Bad odour inside the refrigerator.	<ul style="list-style-type: none"><li>• No regular cleaning is performed.</li></ul>	<ul style="list-style-type: none"><li>• Clean the inside of the refrigerator regularly with a sponge, lukewarm water or carbonate dissolved in water.</li></ul>
	<ul style="list-style-type: none"><li>• Some containers or package materials may cause the smell.</li></ul>	<ul style="list-style-type: none"><li>• Use a different container or different brand packaging material.</li></ul>
	<ul style="list-style-type: none"><li>• Food is put into the refrigerator in uncovered containers.</li></ul>	<ul style="list-style-type: none"><li>• Keep the food in closed containers. Microorganisms spreading out from uncovered containers can cause unpleasant odours.</li></ul>
	<ul style="list-style-type: none"><li>• Remove the foods that have expired best before dates and spoiled from the refrigerator.</li></ul>	
The door is not closing.	<ul style="list-style-type: none"><li>• Food packages are preventing the door from closing.</li></ul>	<ul style="list-style-type: none"><li>• Replace the packages that are obstructing the door.</li></ul>
	<ul style="list-style-type: none"><li>• The refrigerator is not completely even on the floor.</li></ul>	<ul style="list-style-type: none"><li>• Adjust the feet to balance the refrigerator.</li></ul>
	<ul style="list-style-type: none"><li>• The floor is not level or strong.</li></ul>	<ul style="list-style-type: none"><li>• Make sure that the product is leveled and capable to carry the refrigerator.</li></ul>
Crispers are stuck.	<ul style="list-style-type: none"><li>• The food is touching the ceiling of the drawer.</li></ul>	<ul style="list-style-type: none"><li>• Rearrange food in the drawer.</li></ul>
If The Surface Of The Product Is Hot.	<ul style="list-style-type: none"><li>• High temperatures may be observed between the two doors, on the side panels and at the rear grill while the product is operating. This is normal and does not require service maintenance!</li></ul>	



## IKEA GUARANTEE

### How long is the IKEA guarantee valid?

This guarantee is valid for five years from the original date of purchase of your appliance at IKEA. The original sales receipt, is required as proof of purchase. If service work is carried out under guarantee, this will not extend the guarantee period for the appliance.

### Who will execute the service?

IKEA service provider will provide the service through its own service operations or authorized service partner network.

### What does this guarantee cover?

The guarantee covers faults of the appliance, which have been caused by faulty construction or material faults from the date of purchase from IKEA. This guarantee applies to domestic use only. The exceptions are specified under the headline "What is not covered under this guarantee?" Within the guarantee period, the costs to remedy the fault e.g. repairs, parts, labour and travel will be covered, provided that the appliance is accessible for repair without special expenditure. On these conditions the EU guidelines (Nr. 99/44/EG) and the respective local regulations are applicable. Replaced parts become the property of IKEA.

### What will IKEA do to correct the problem?

IKEA appointed Service Provider will examine the product and decide, at its sole discretion, if it is covered under this guarantee. If considered covered, IKEA Service Provider or its authorized service partner through its own service operations, will then, at its sole discretion, either repair the defective product or replace it with the same or a comparable product.

### What is not covered under this guarantee?

- Normal wear and tear.
- Deliberate or negligent damage, damage caused by failure to observe operating instructions, incorrect installation or by connection to the wrong voltage, damage caused by chemical or electrochemical reaction, rust, corrosion or water damage including but not limited to damage caused by excessive lime in the water supply, damage caused by abnormal environmental conditions.
- Consumable parts including batteries and lamps.
- Non-functional and decorative parts which do not affect normal use of the appliance, including any scratches and possible color differences.
- Accidental damage caused by foreign objects or substances and cleaning or unblocking of filters, drainage systems or soap drawers.
- Damage to the following parts: ceramic glass, accessories, crockery and cutlery baskets, feed and drainage pipes, seals, lamps and lamp covers, screens, knobs, casings and parts of casings. Unless such damages can be proved to have been caused by production faults.
- Cases where no fault could be found during a technician's visit.
- Repairs not carried out by our appointed service providers and/or an authorized service contractual partner or where non-original parts have been used.
- Repairs caused by installation which is faulty or not according to specification.
- The use of the appliance in a non-domestic environment i.e. professional use.
- Transportation damages. If a customer transports the product to his home or another address, IKEA is not liable for any damage that may occur during transport. However, if IKEA delivers the product to the customer's delivery address, then damage to the product that occurs during this delivery will be covered by IKEA.
- Cost for carrying out the initial installation of the IKEA appliance.
- However, if an IKEA appointed Service Provider or its authorized service partner repairs or replaces the appliance under the terms of this guarantee, the appointed Service Provider or its authorized service partner will reinstall the repaired appliance or install the replacement, if necessary.

- This does not apply within Ireland, customer should contact the local IKEA dedicated after sales line or the appointed Service Provider for further information.  
**(just for GB)**

These restrictions do not apply to fault-free work carried out by a qualified specialist using our original parts in order to adapt the appliance to the technical safety specifications of another EU country.

### How country law applies

The IKEA guarantee gives you specific legal rights, which cover or exceed all the local legal demands. However these conditions do not limit in any way consumer rights described in the local legislation.

### Area of validity

For appliances which are purchased in one EU country and taken to another EU country, the services will be provided in the framework of the guarantee conditions normal in the new country.

An obligation to carry out services in the framework of the guarantee exists only if the appliance complies and is installed in accordance with:

- the technical specifications of the country in which the guarantee claim is made;
- the Assembly Instructions and User Manual Safety Information.

### The dedicated AFTER SALES for IKEA appliances

Please don't hesitate to contact IKEA appointed Authorized Service Centre to:

- make a service request under this guarantee;
- ask for clarifications on installation of the IKEA appliance in the dedicated IKEA kitchen furniture;
- ask for clarification on functions of IKEA appliances.

To ensure that we provide you with the best assistance, please read carefully the Assembly Instructions and/or the User Manual before contacting us.

### How to reach us if you need our service



Please refer to the last page of this manual for the full list of IKEA appointed Authorized Service Centre and relative national phone numbers.

- i** In order to provide you a quicker service, we recommend to use the specific phone numbers listed on this manual. Always refer to the numbers listed in the booklet of the specific appliance you need an assistance for. Please also always refer to the IKEA article number (8 digit code) and 10 digit service number placed on the rating plate of your appliance.

- i** **SAVE THE SALES RECEIPT!**

It is your proof of purchase and required for the guarantee to apply. The sales receipt also reports the IKEA name and article number (8 digit code) for each of the appliances you have purchased.

### Do you need extra help?

For any additional questions not related to After Sales of your appliances please contact your nearest IKEA store call centre. We recommend you read the appliance documentation carefully before contacting us.



## UNITED ARAB EMIRATES & OMAN

Toll free:	8 004 532	: رقم مجاني
Web:	www.IKEA.com	: موقع الإنترنت

## QATAR

Toll free:	8 004 532	: رقم مجاني
Web:	www.IKEA.qa	: موقع الإنترنت
e-mail:	Ikea_qatar@alfuttaim.com	: البريد الإلكتروني

## EGYPT

Hotline:	16576	: الخط الساخن
Web:	www.IKEA.eg	: موقع الإنترنت
e-mail:	IkeaCairo.customerservice@alfuttaim.com	: البريد الإلكتروني

## STATE OF KUWAIT

Contact centre:	+965 18 40 40 8	: مركز الاتصال
Web:	www.IKEA.com.kw	: موقع الإنترنت
e-mail:	info@IKEA.com.kw	: البريد الإلكتروني

## JORDAN

Contact centre:	+962 6 400 1000	: مركز الاتصال
Web:	www.IKEA.jo	: موقع الإنترنت

## KINGDOM OF SAUDI ARABIA

Contact centre:	92000-4532	: مركز الاتصال
Our phone lines are open:		: خطوط الهاتف لدينا مفتوحة
Saturday - Thursday	09:00 AM - 10:00 PM	السبت - الخميس
Friday	2:00 PM - 10:00 PM	يوم الجمعة

## BAHRAIN

Contact centre:	80001120	: مركز الاتصال
Our telephone lines are open all day	09:00 AM - 10:00 PM	: خطوط الهاتف لدينا مفتوحة طوال اليوم

## MOROCCO

Web:	www.IKEA.com	: موقع الإنترنت
------	--------------	-----------------



