

A WALKING GUIDE OF IKEA STOUGHTON

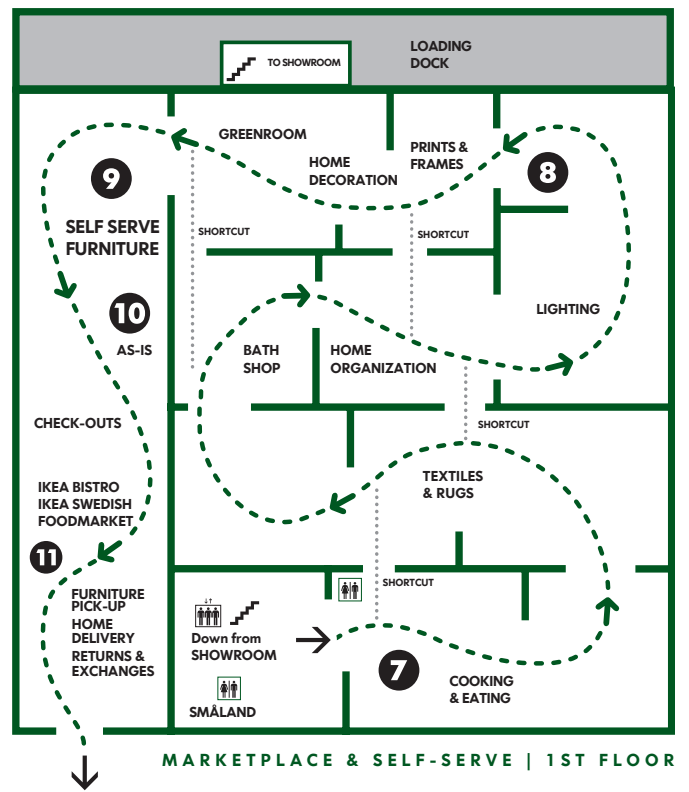
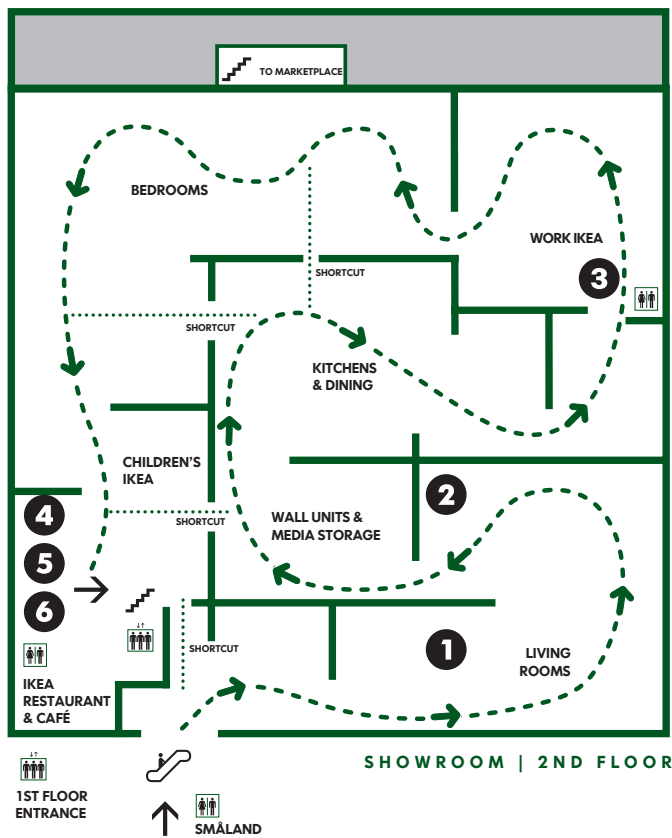

- 1** The building's HVAC (heating/ventilation/air conditioning) units do not use ozone-depleting CFC refrigerants. IKEA chose to make this switch before a nation-wide ban takes effect in 2010.
- 2** The store is equipped with energy-efficient T5 bulbs. Lighting schedules help conserve total kilowatt hours and reduces carbon dioxide emissions.
- 3** Low-flow sinks reduce water consumption by 30% from a typical building. The nine public, waterless urinals save an estimated 500,000 gallons of water a year.
- 4** The Marmoleum used for flooring in the IKEA Restaurant & Café, Showroom and administrative area is a 95% recycled, ultra-durable material with a 30-year life cycle.
- 5** You do a little, we do a little! Leave your plastic, glass or aluminum containers on your tray in our restaurant and our food service staff will be sure to recycle them.

- 6** Take a glimpse at a portion of our green roof: atop our main roof there are 37,000 sq. ft of low-maintenance groundcover plants. The plants keep the roof cooler and absorb rainwater, which is diverted into a storm-water retention system and reused to irrigate landscaping around the store. Five inches of insulation as opposed to an industry standard of three inches under the roof also optimizes energy use, while the white membrane rooftop surface helps reflect sunlight.
- 7** Bare concrete floors throughout the store means that no raw materials are used.
- 8** Our wide selection of Compact Fluorescent Lamps (CFLs) shows you how easy and affordable it is to be energy efficient.
- 9** Oversize fans destratisfy air for more efficient cooling and heating in the warehouse.

- 10** The As-Is Department extends the life of merchandise by reusing parts and items that have been returned or slightly damaged.
- 11** For all store functions, we recycle cardboard, plastic, metal, paper, glass, CFL bulbs, batteries and reuse wood.

OFF THE MAP

- The two-level parking garage was made of 90% recycled steel and concrete. Also, land conservation was achieved by placing the garage under the actual store. In addition, IKEA reused about 75% of on-site construction waste.
- Bicycle racks and showers are provided for co-workers to encourage commuting by bicycle.