

# PFEFFERKUCHEN- HAUS

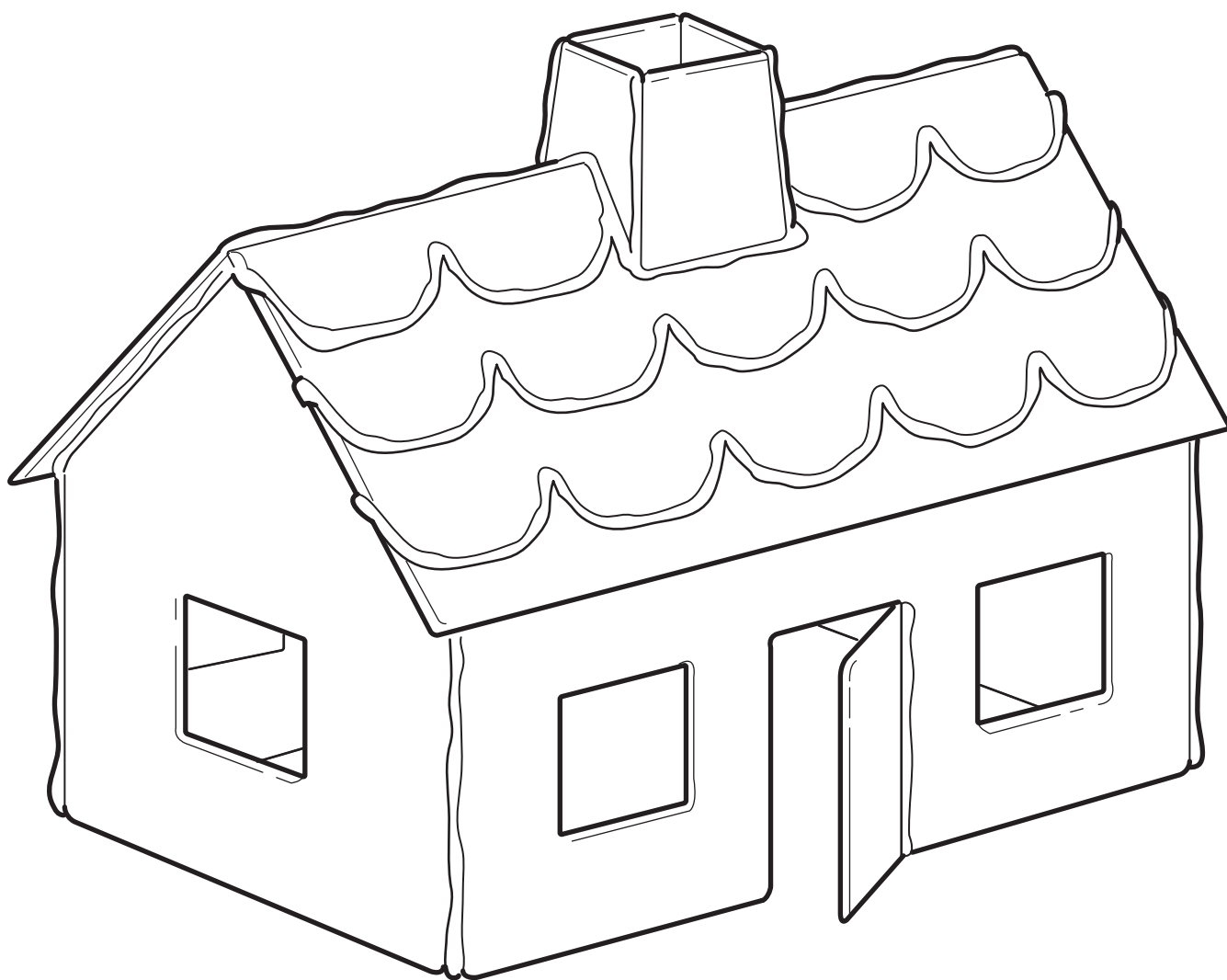

Design and Quality  
IKEA of Sweden

# PFEFFERKUCHENTEIG

Du kannst Fertigteig aus deinem IKEA Einrichtungshaus verwenden oder ihn selbst machen:

200 ml Wasser

100 ml Zuckerrübensirup (Melasse)

2 Esslöffel gemahlene Zimt

1 Esslöffel gemahlene Nelken

1 Esslöffel gemahlener Ingwer

1 Teelöffel gemahlener Kardamom

1 Teelöffel schwarzer Pfeffer

1 Teelöffel Backpulver

300 g Butter

510 g Zucker

1075 g Mehl

Butter, Zucker und Zuckerrübensirup mischen. Gewürze und Backpulver hinzufügen, dann Wasser und einen Teil des Mehls.

Restliches Mehl unterrühren.

Teig über Nacht in Folie eingewickelt im Kühlschrank ruhen lassen.

# GLASUR

400 ml Puderzucker

1 Eiweiß

1 Teelöffel Weißweinessig

Alles miteinander verquirlen, dann eine Papier- oder Spritztüte damit füllen.

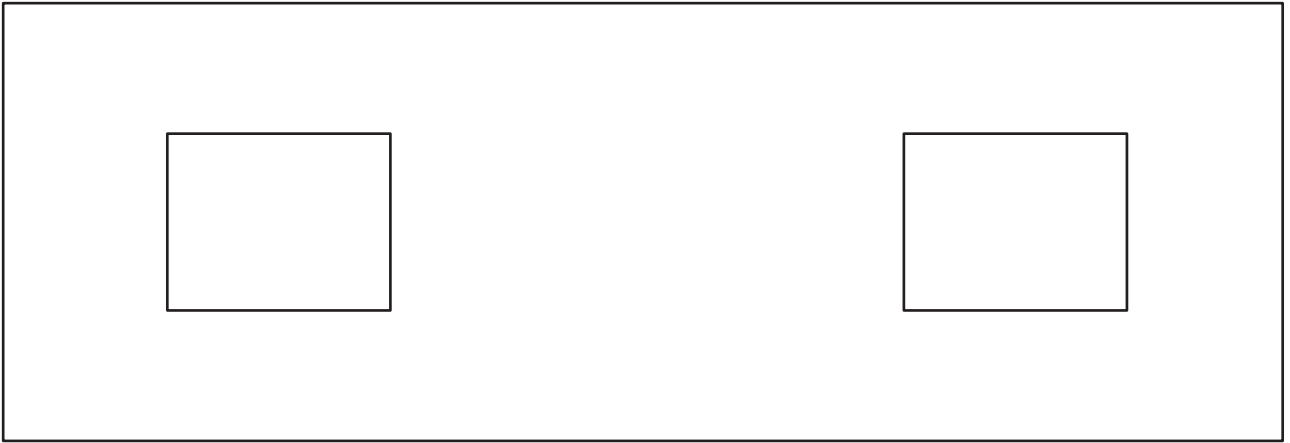
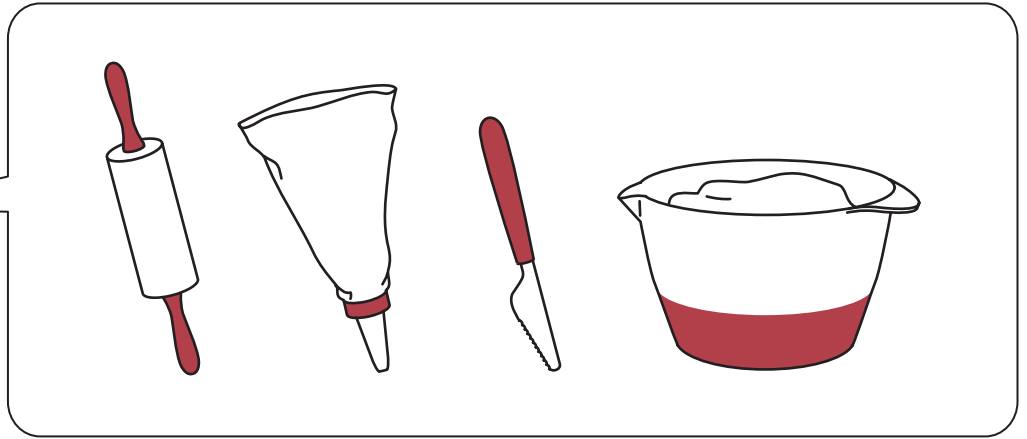

1x

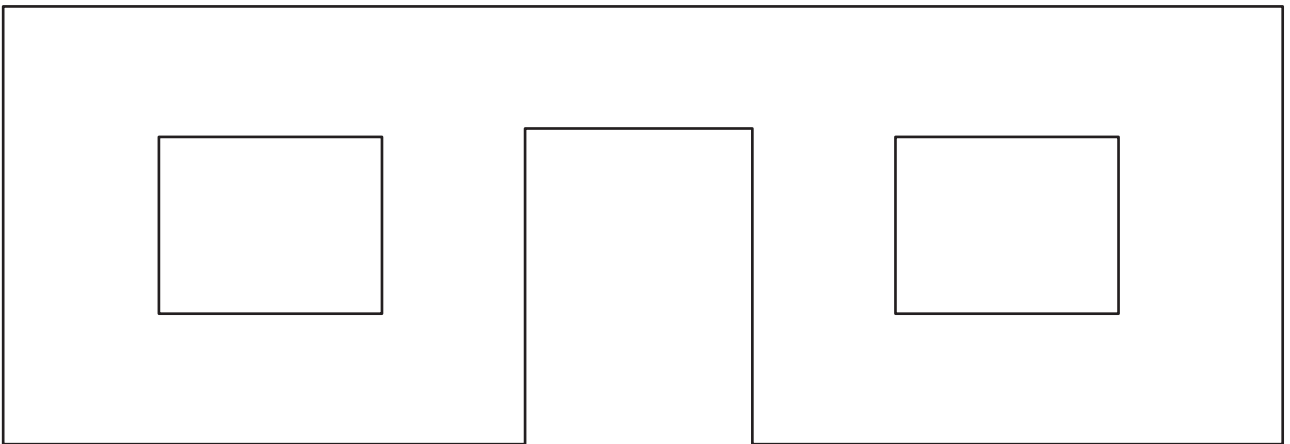

1x

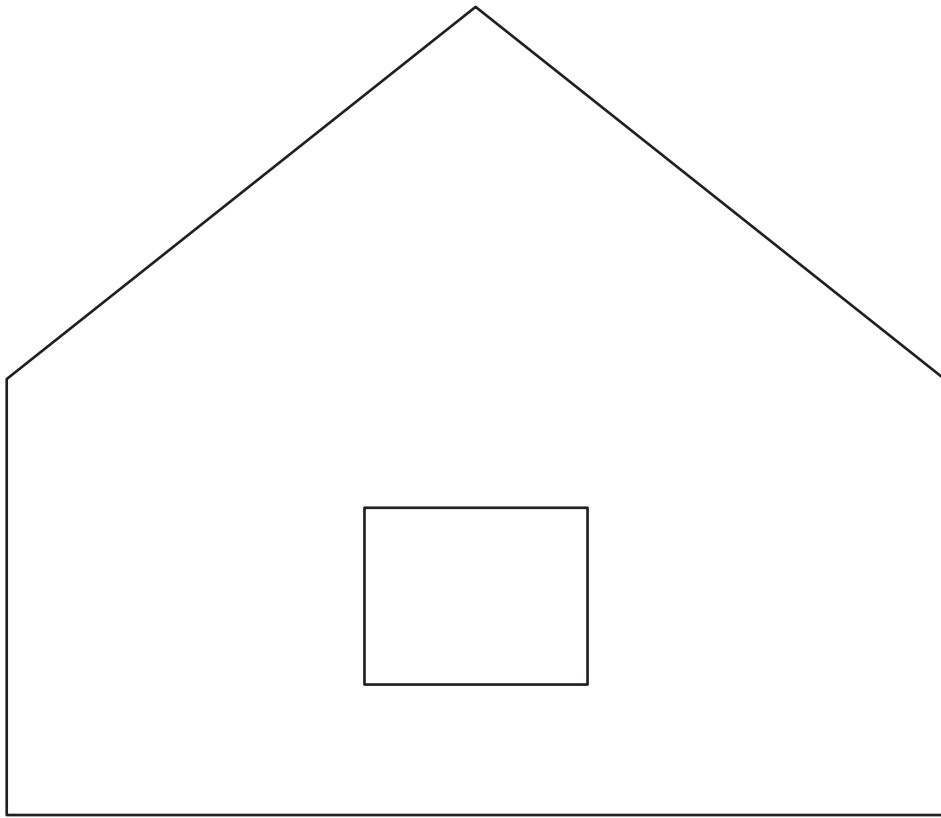

2x

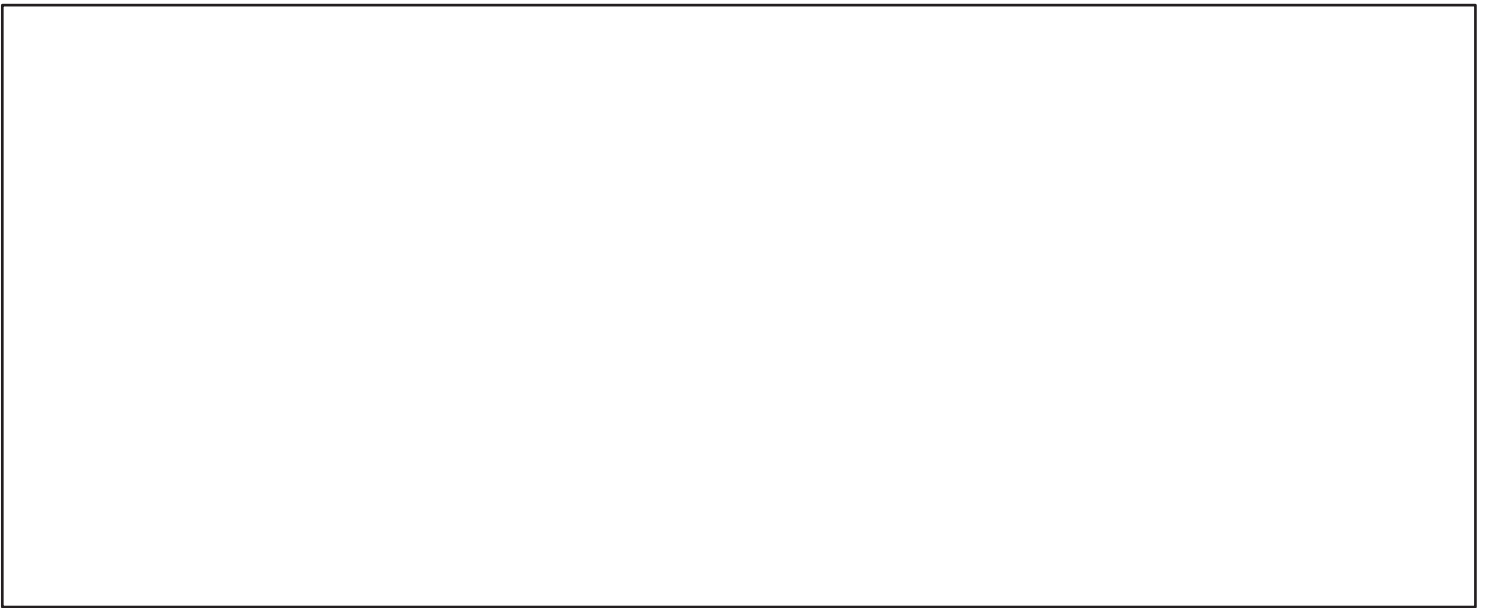

2x

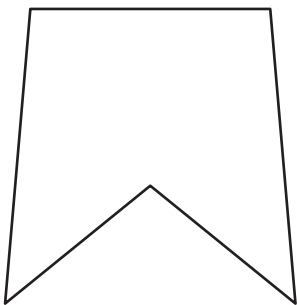

2x

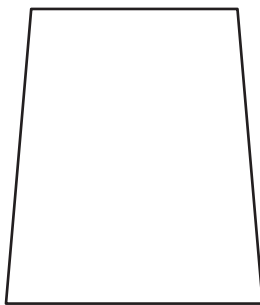

2x

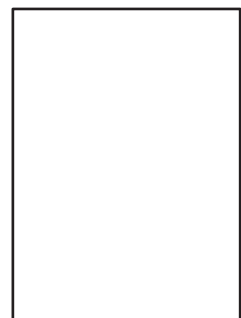

1x

**1**

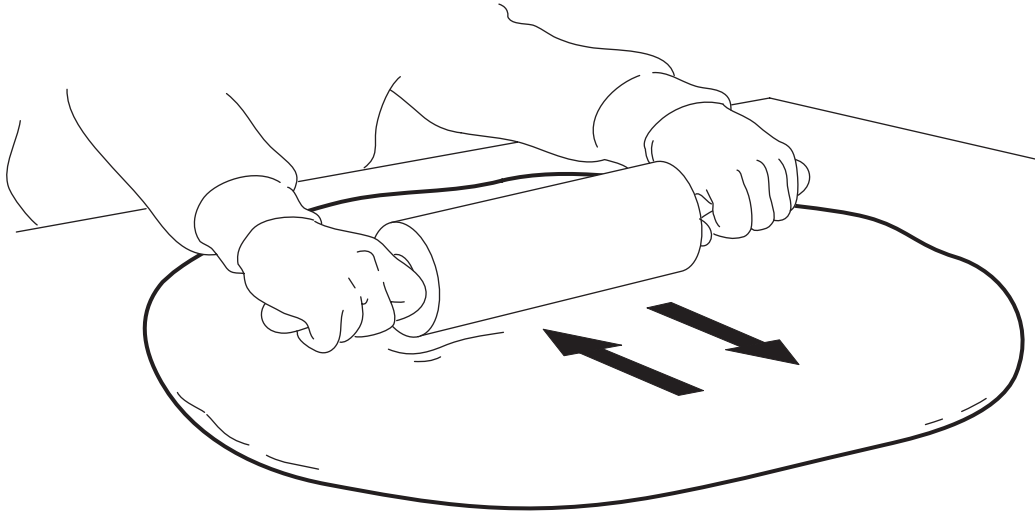

**2**

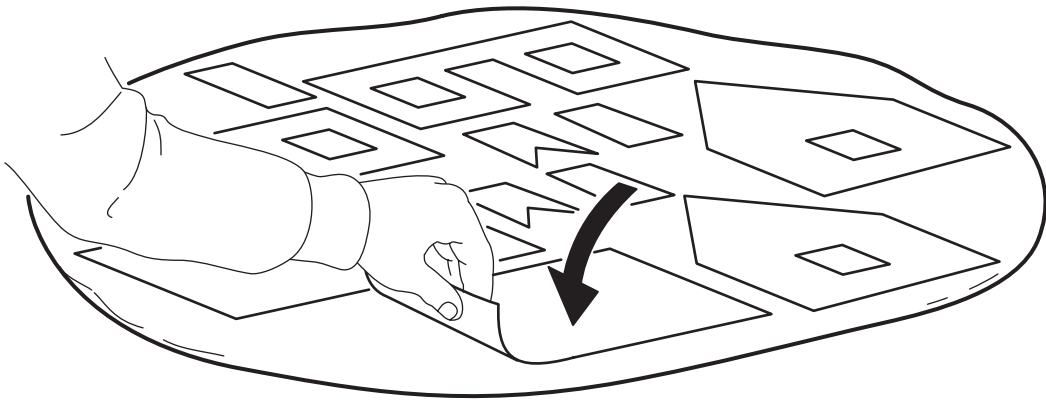

**3**

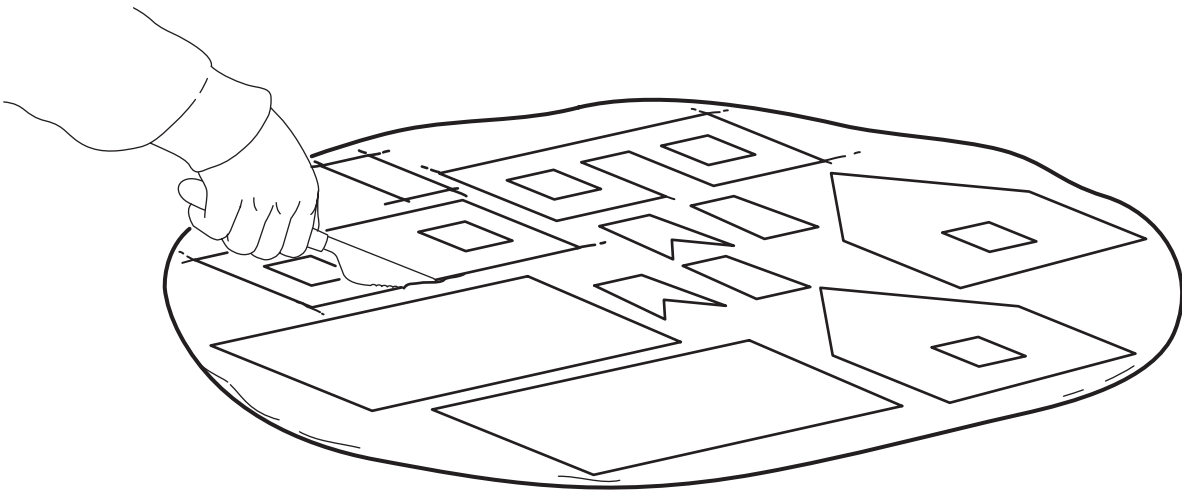

**4**

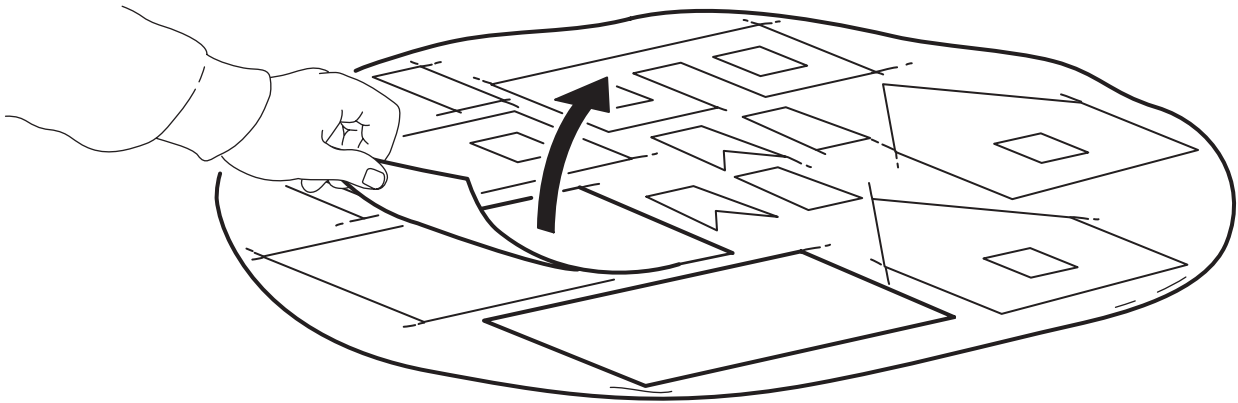

**5**

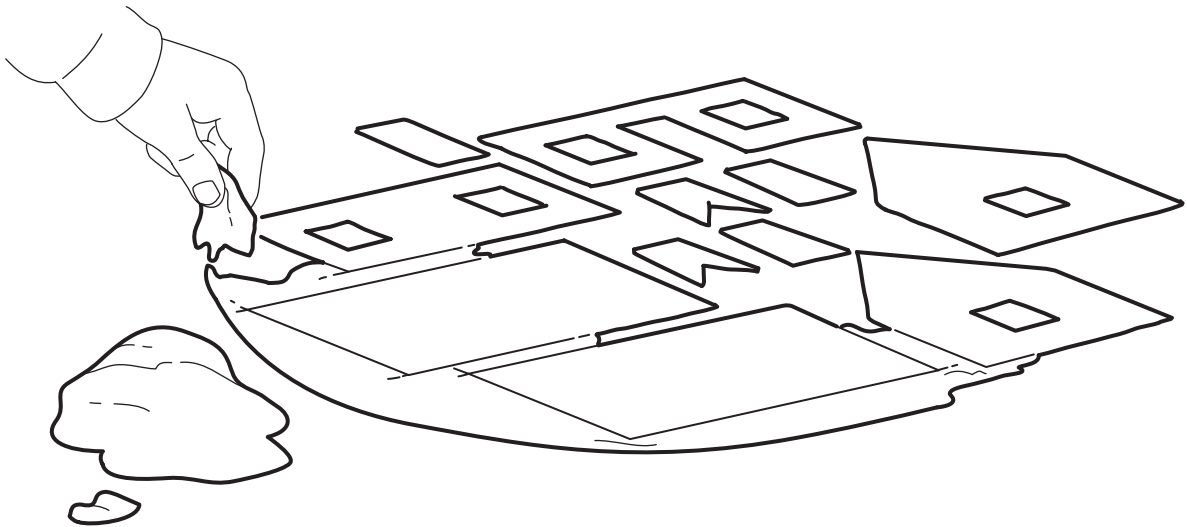

**6**

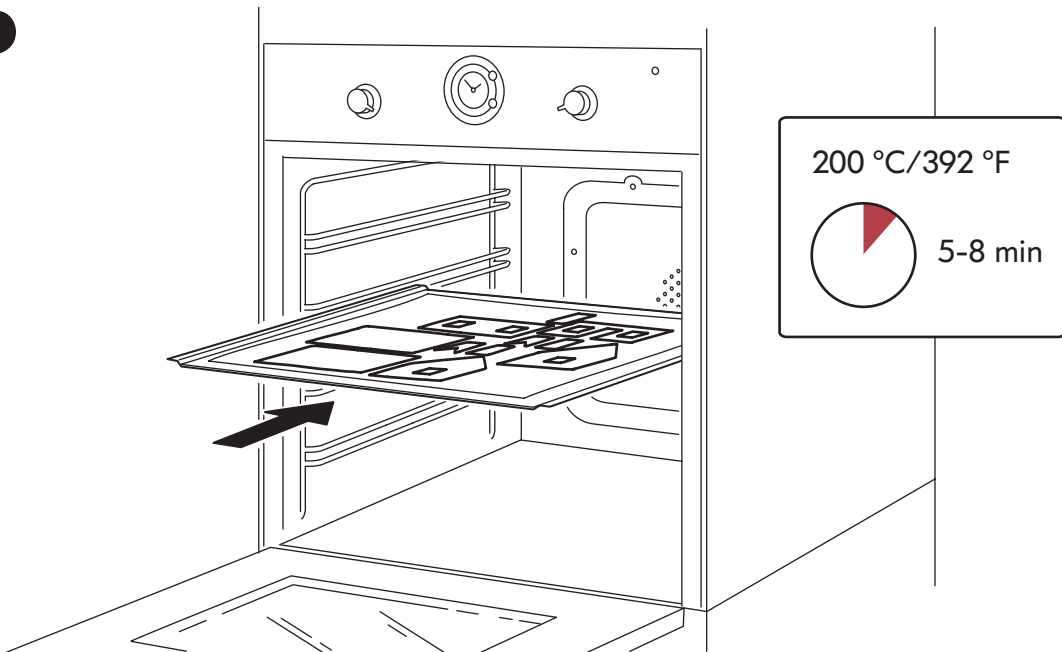

7

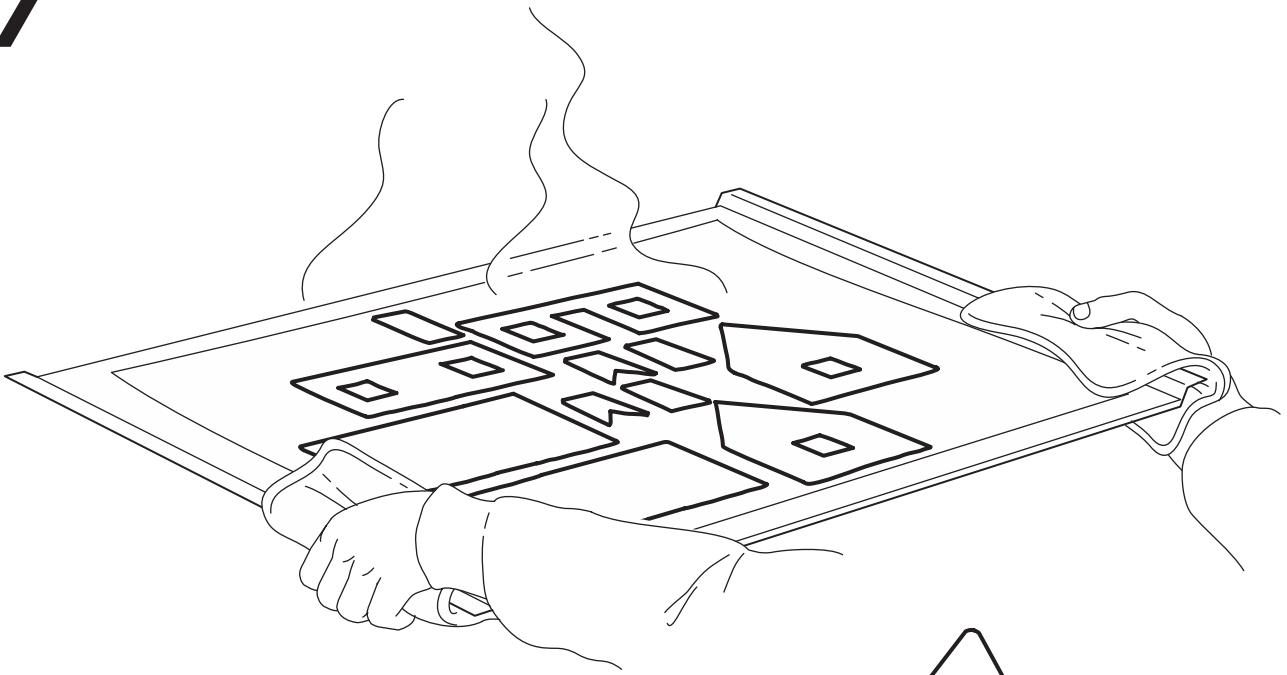

8

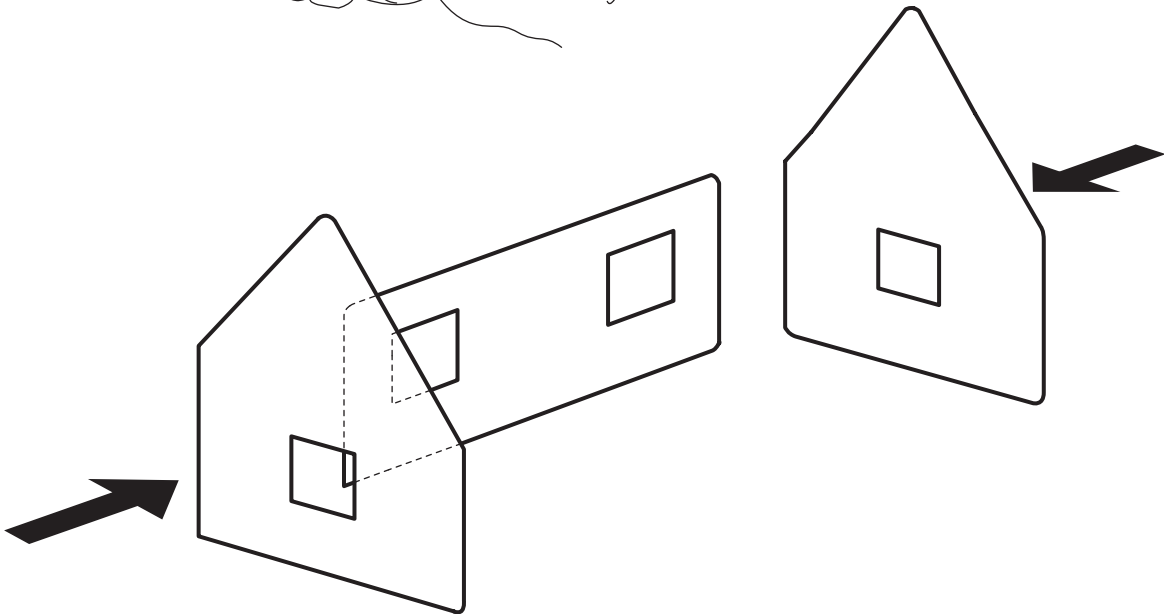

9

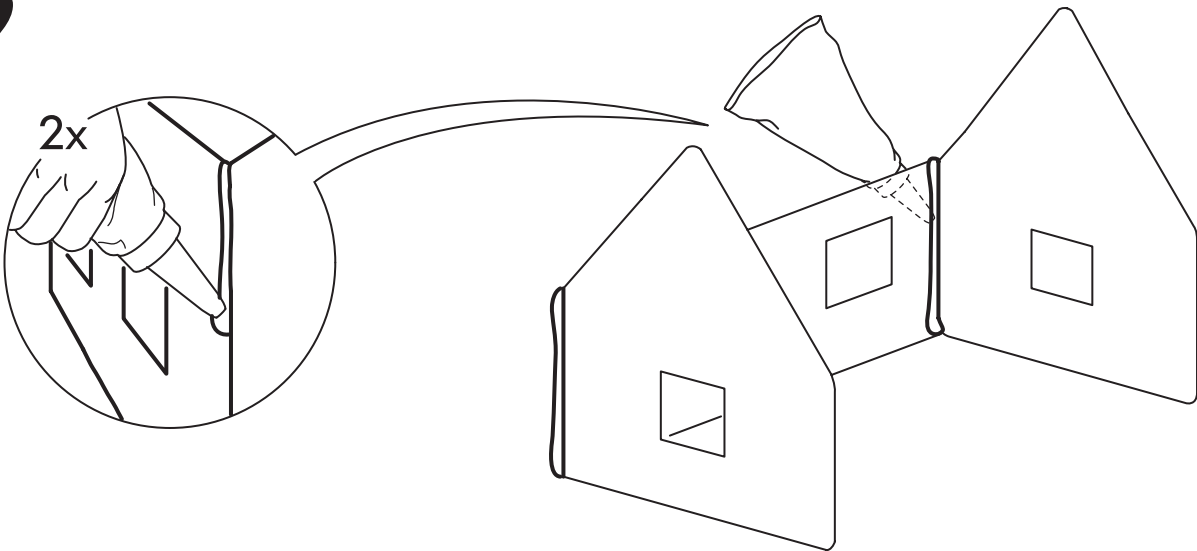

10

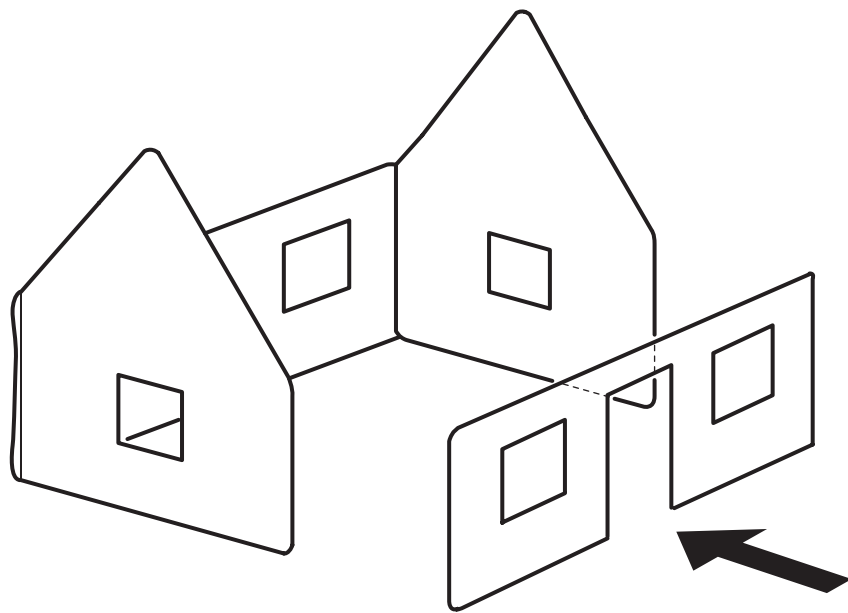

11

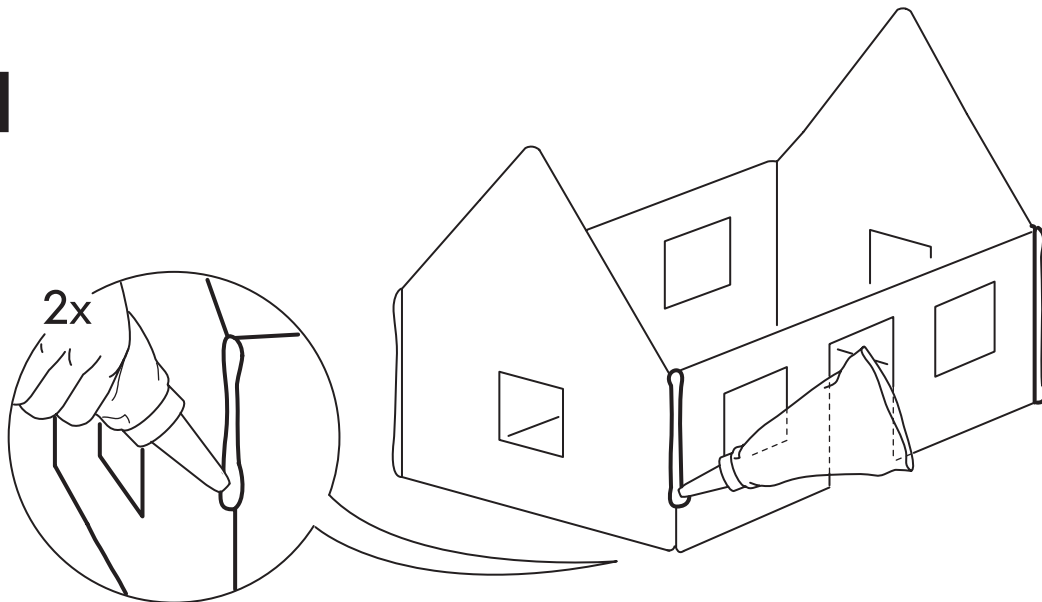

12

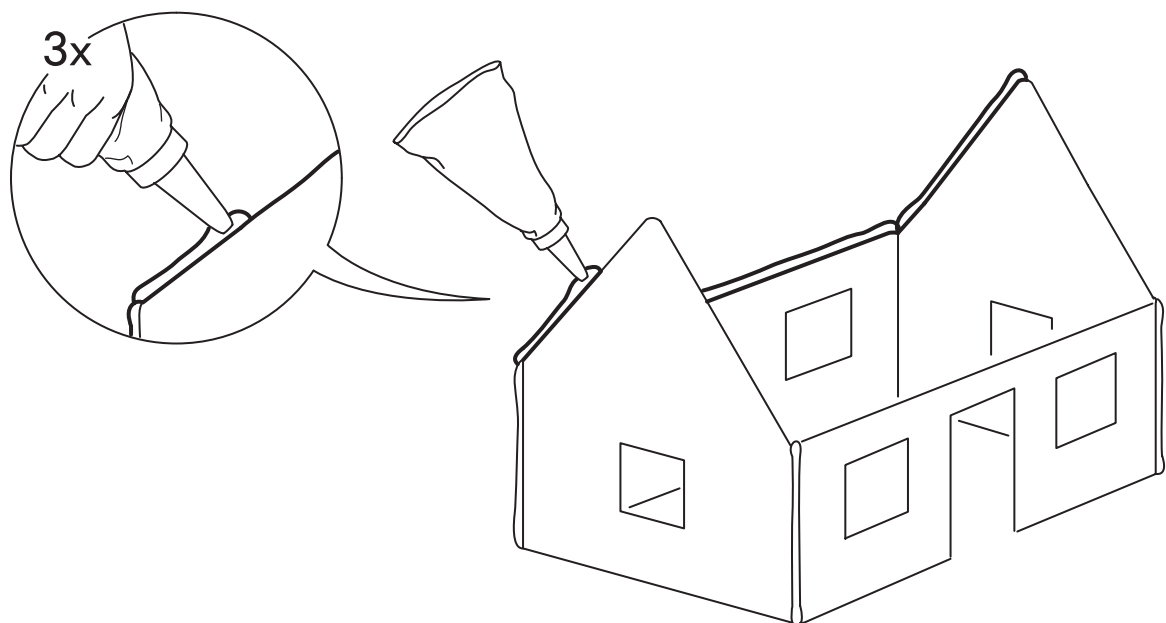

**13**

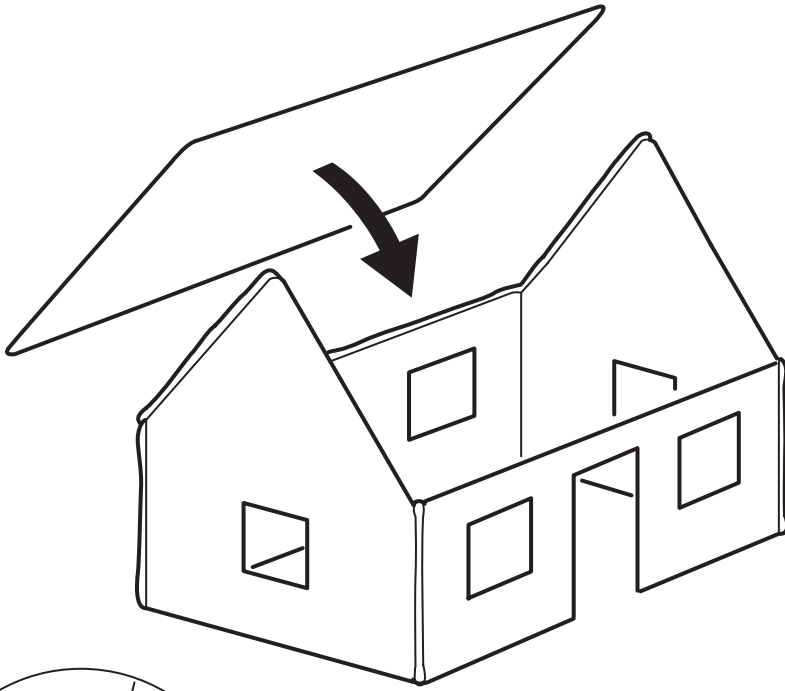

**14**



**15**

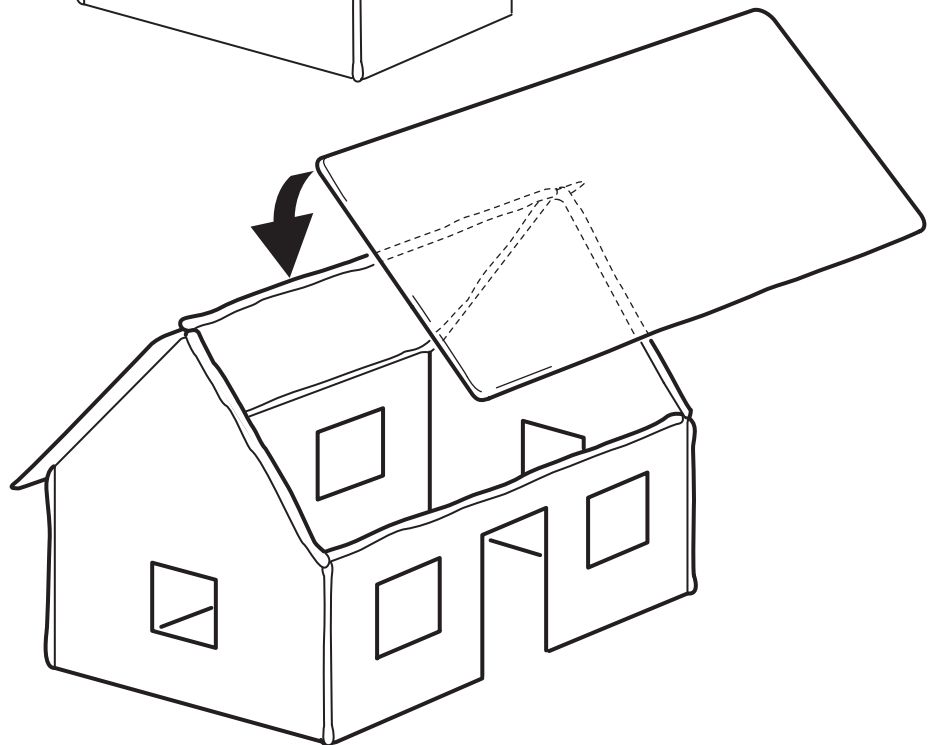

16

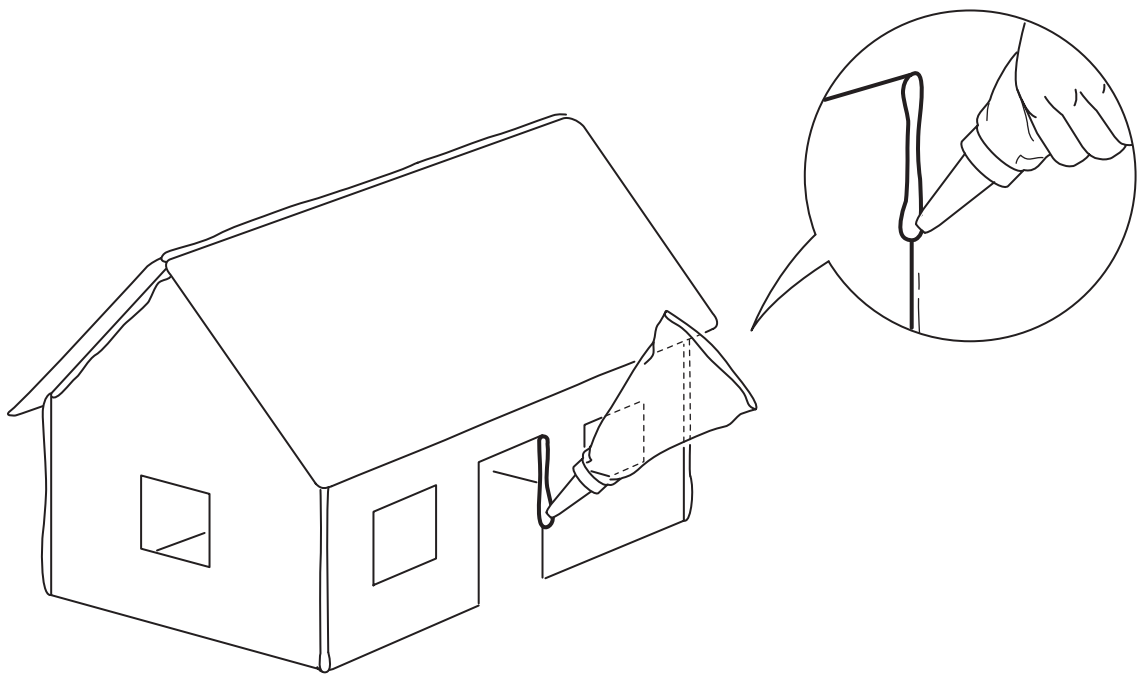

17

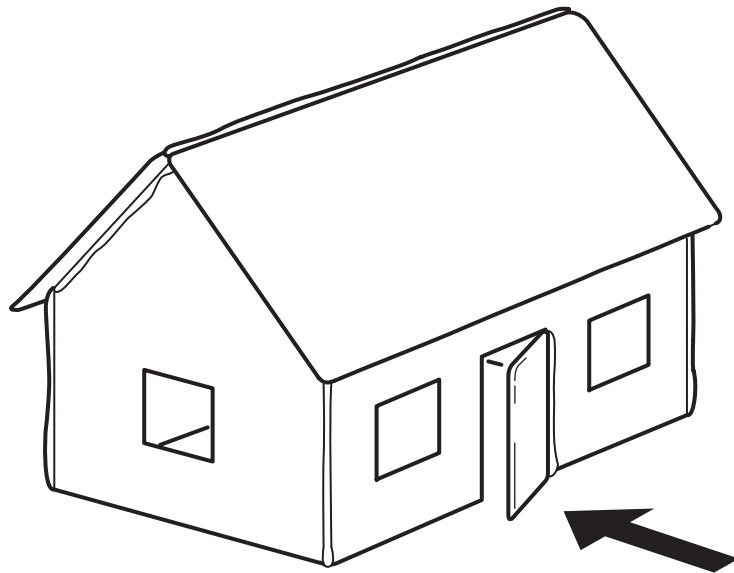

18

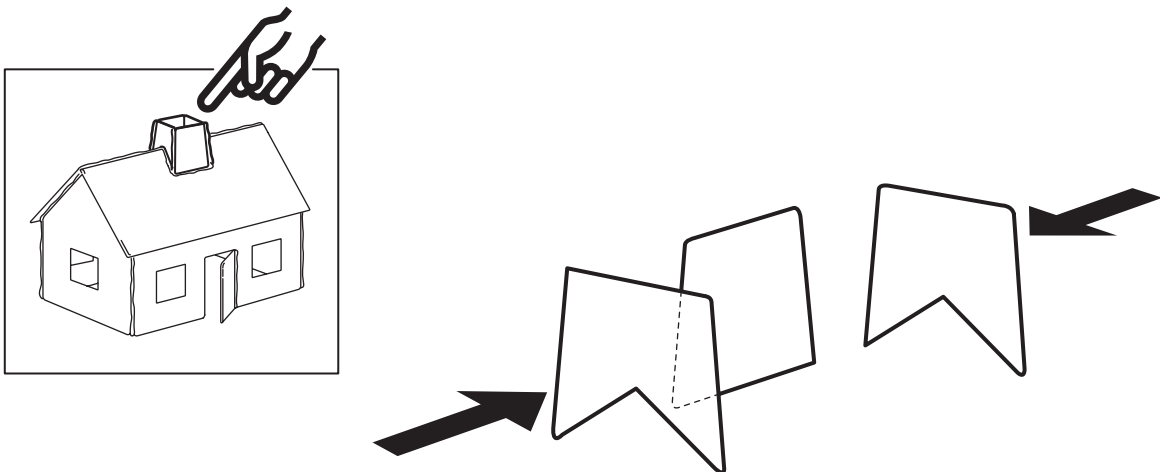

**19**

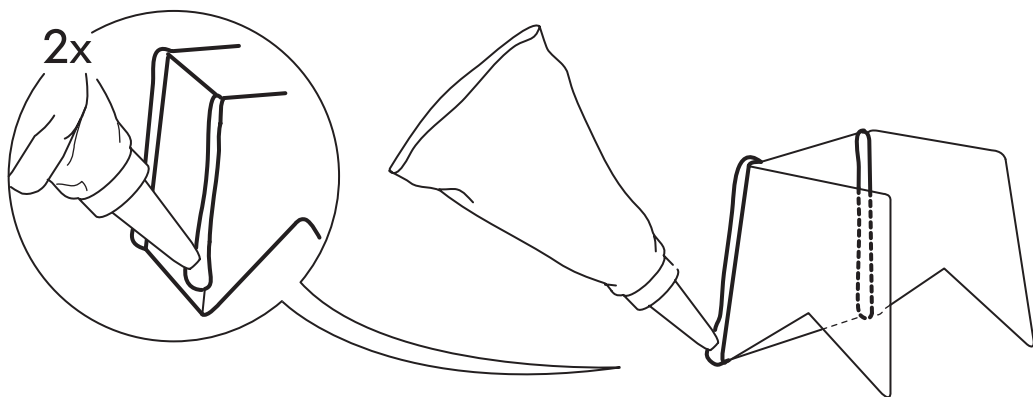

**20**

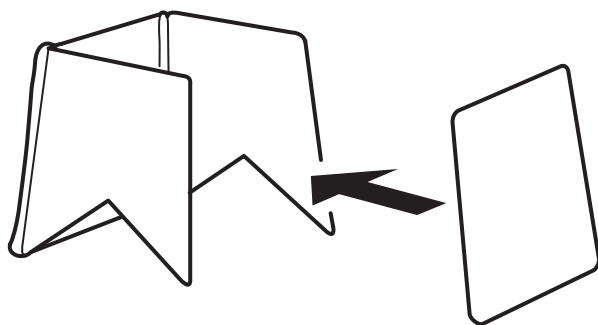

**21**

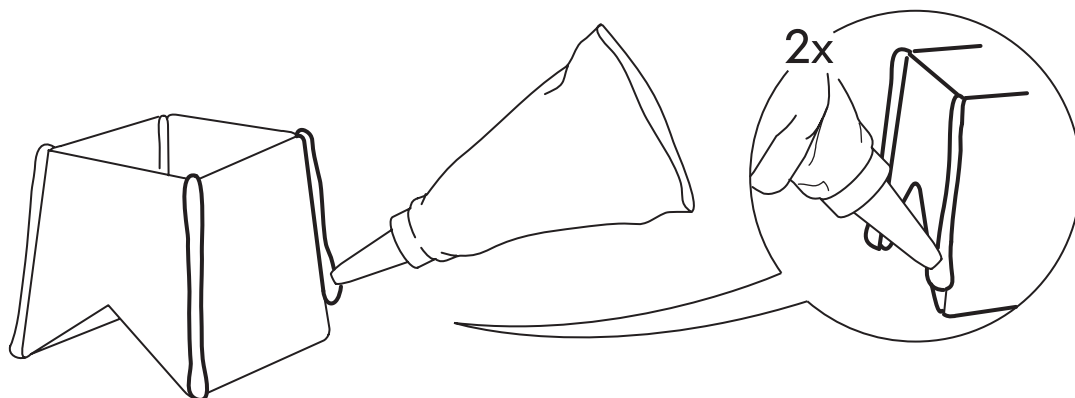

**22**

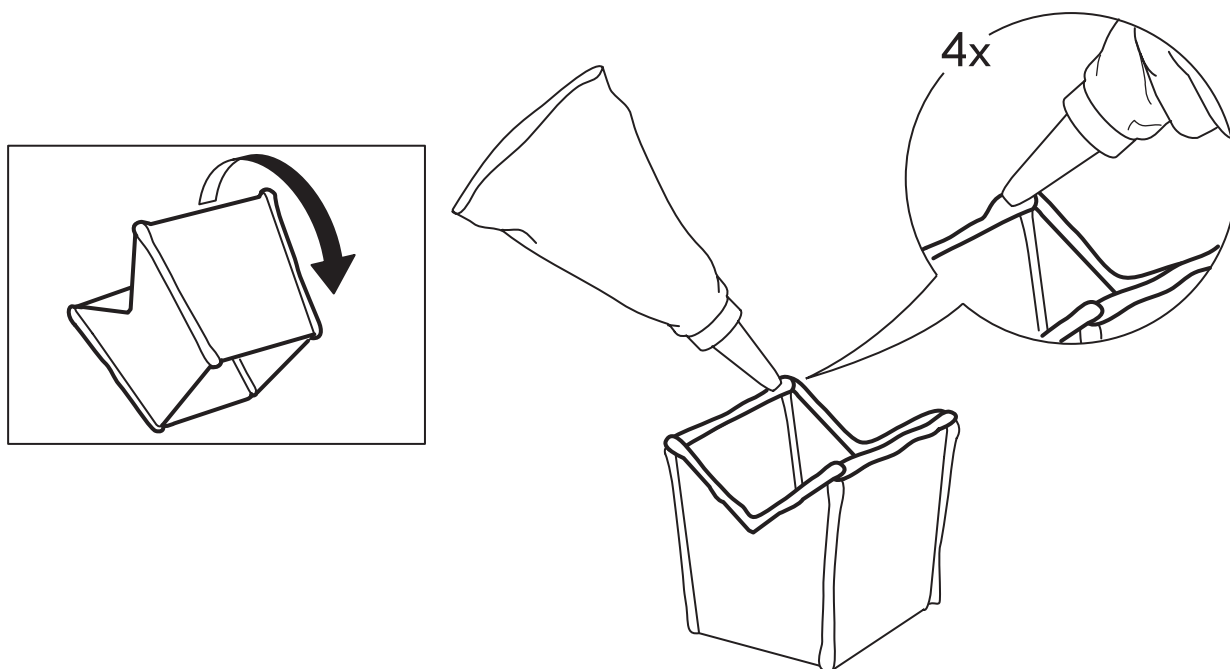

**23**

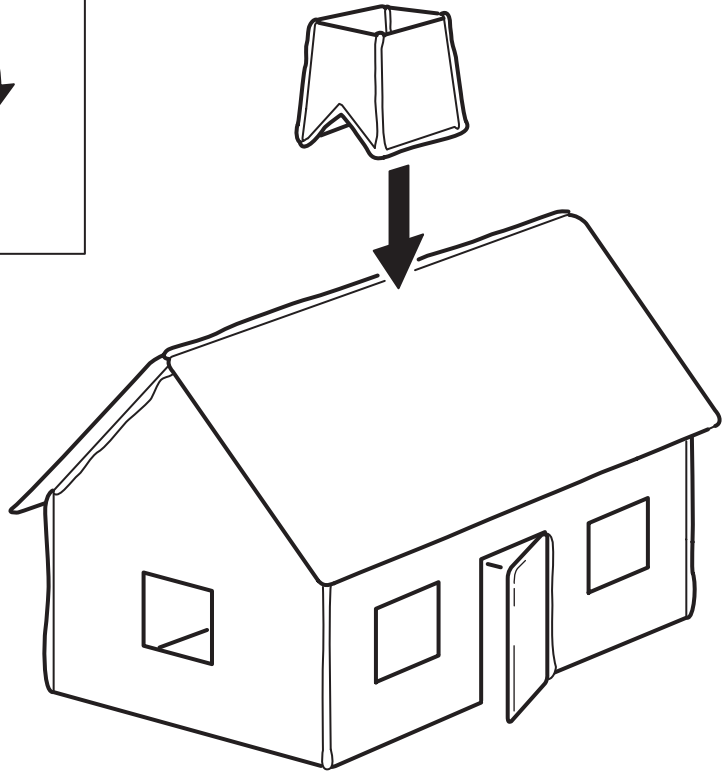
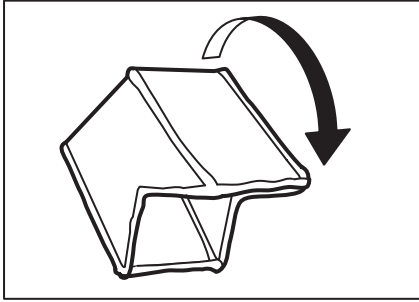

**24**

