

GB

FR

ES

# MINNEN

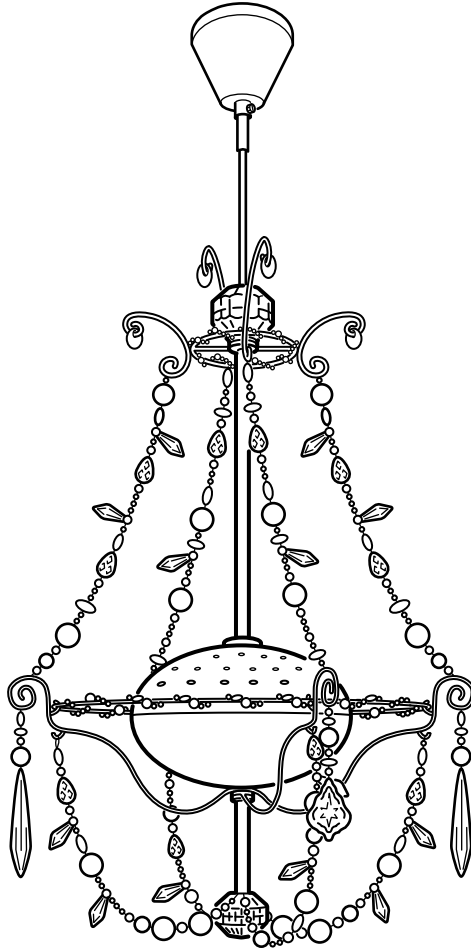

Design and Quality  
IKEA of Sweden



**ENGLISH**

**INSTALLATION INSTRUCTIONS**

**CAUTION:** Before starting, turn off power at main circuit panel.

**FRANÇAIS**

**INSTRUCTIONS D'INSTALLATION**

**ATTENTION :** coupez l'alimentation avant de procéder à l'installation.

**ESPAÑOL**

**INSTRUCCIONES DE MONTAJE**

**ADVERTENCIA:** Antes de comenzar el montaje, cortar la luz en el cuadro general.

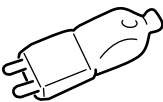
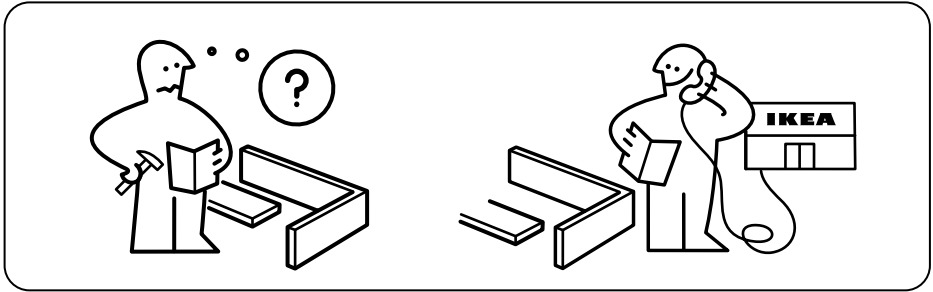

1x

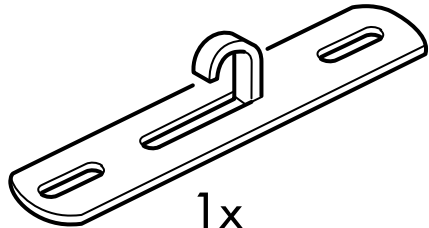

1x

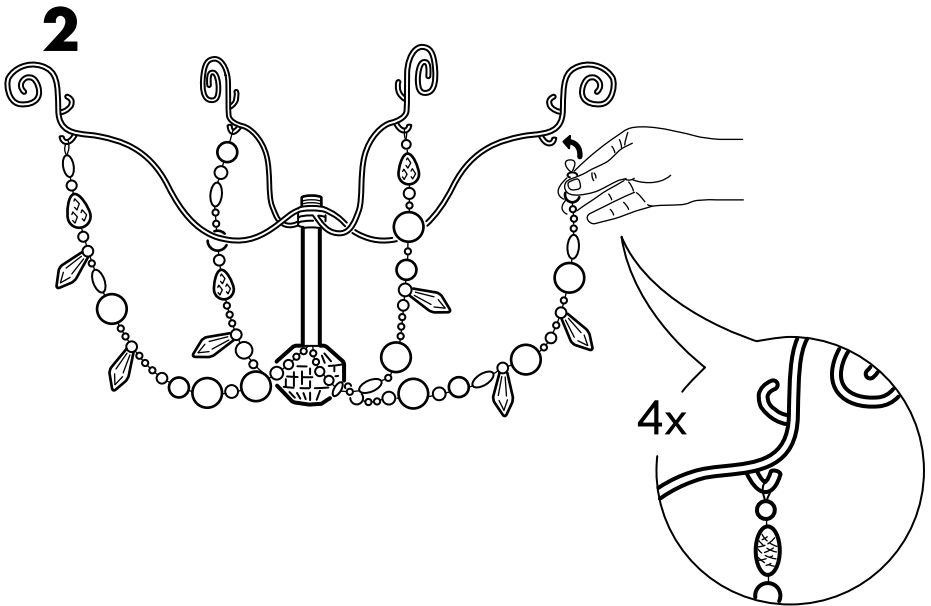
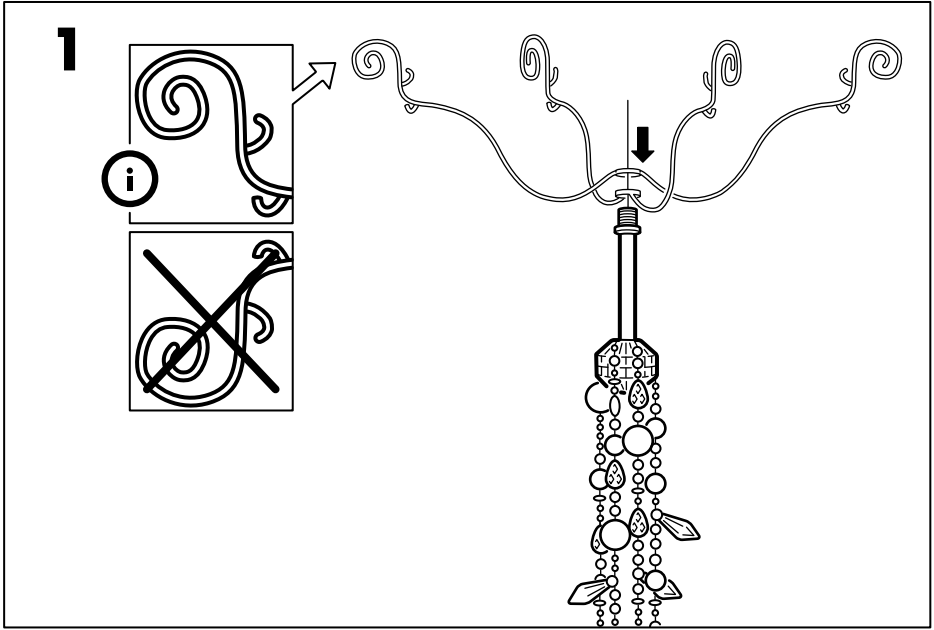

3

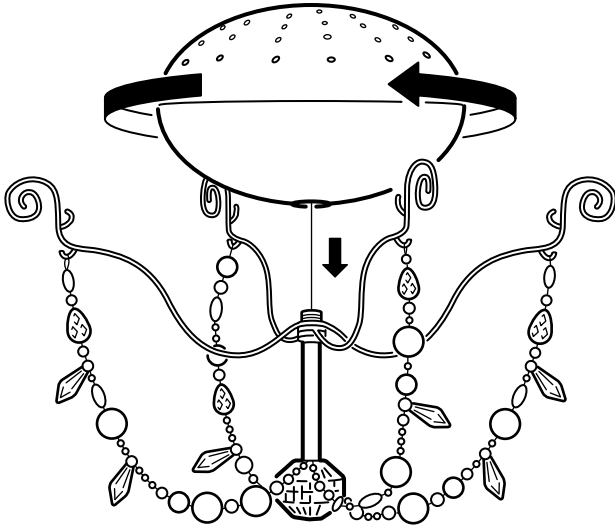

4

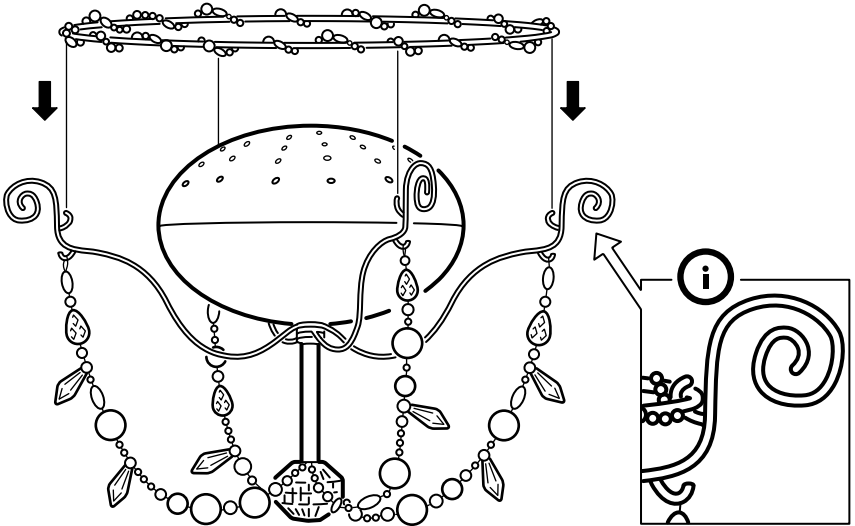

**5**

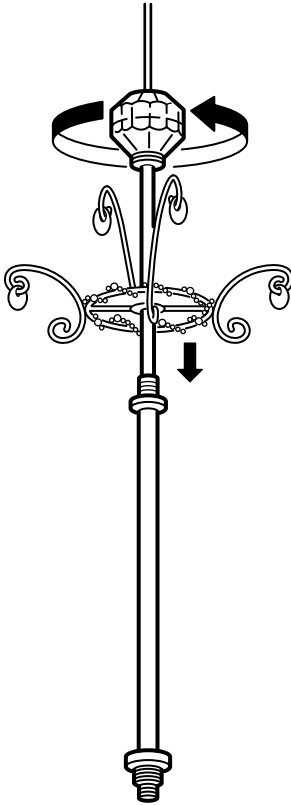

**6**

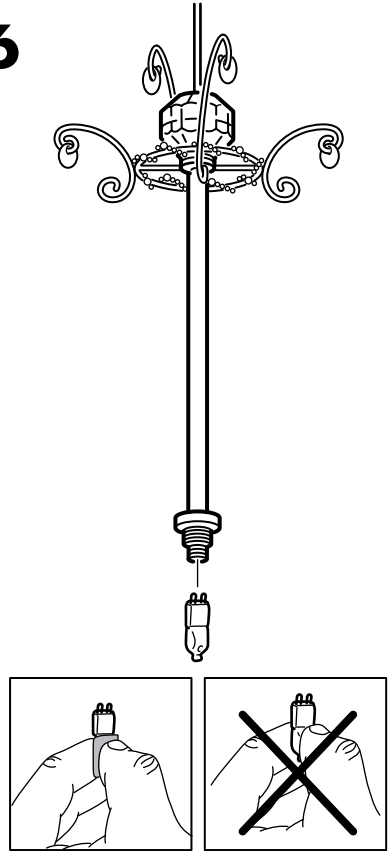

**ENGLISH**

WHEN REPLACING BULB - use a G9 class bulb with built-in protective glass guard.

**FRANÇAIS**

REPLACEMENT DE L'AMPOULE :  
Utiliser une ampoule G9 avec verre de protection intégré.

**ESPAÑOL**

PARA SUSTITUIR LA BOMBILLA use un bombilla de clase G9 con protección incorporada del vidrio.

7

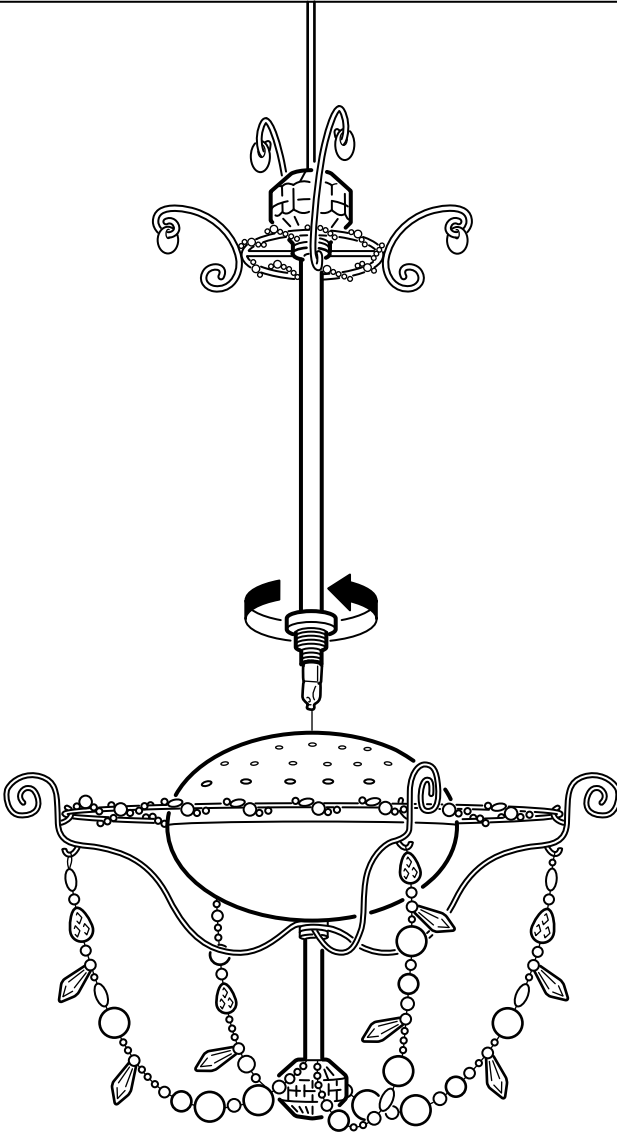

8

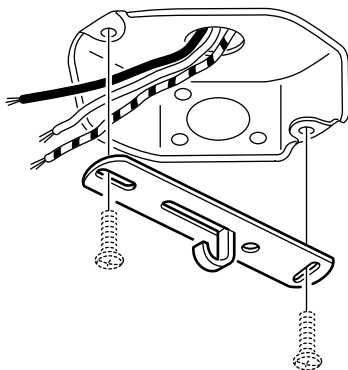

**ENGLISH**

Hang out of reach from a standing child.

**FRANÇAIS**

A accrocher hors de portée d'un enfant en position debout.

**ESPAÑOL**

Colgar fuera del alcance de los niños.

9

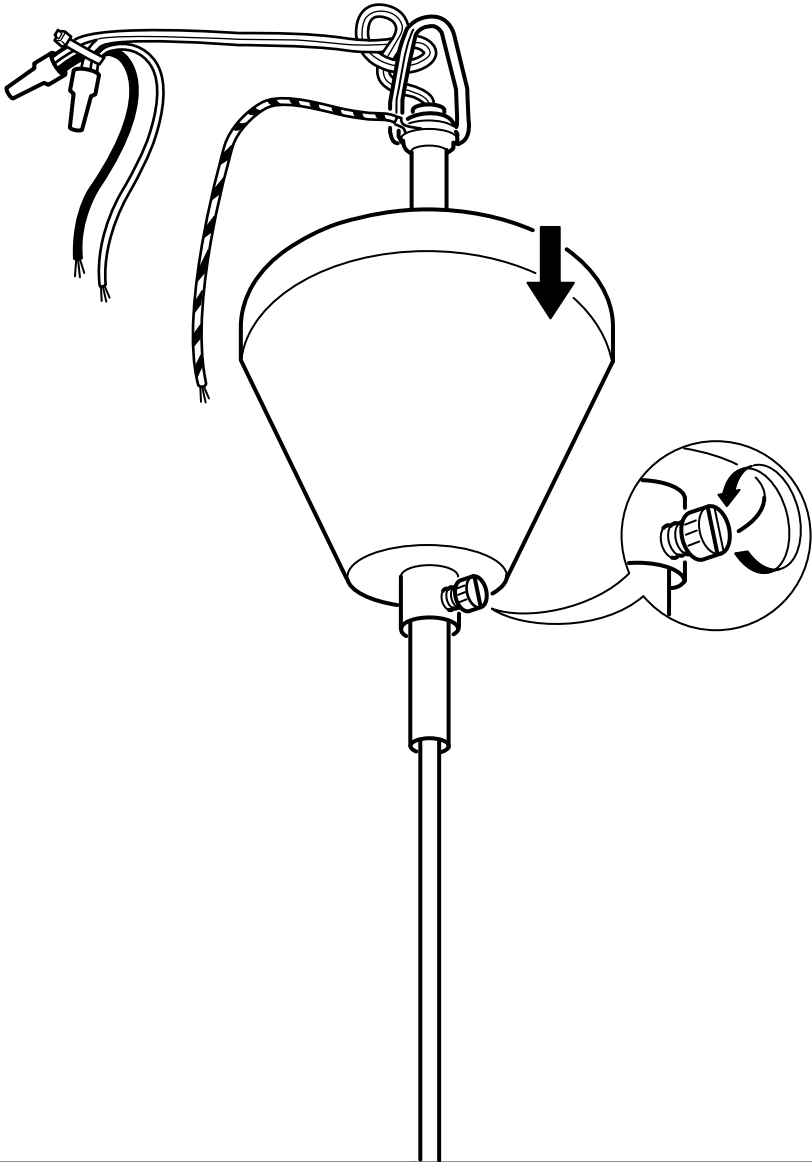

**10**

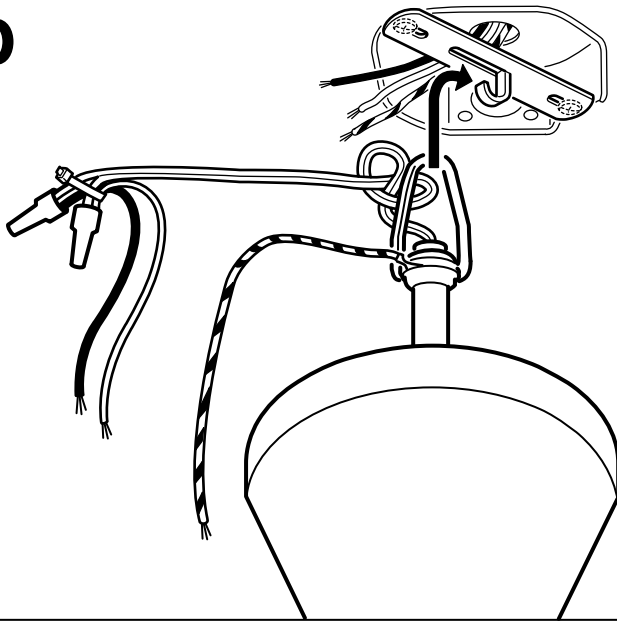

**11**

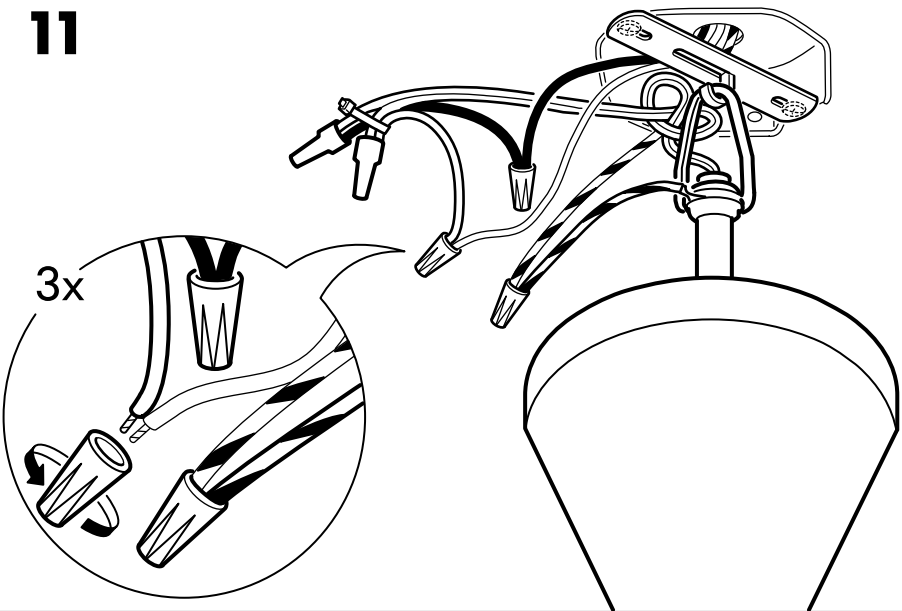

**12**

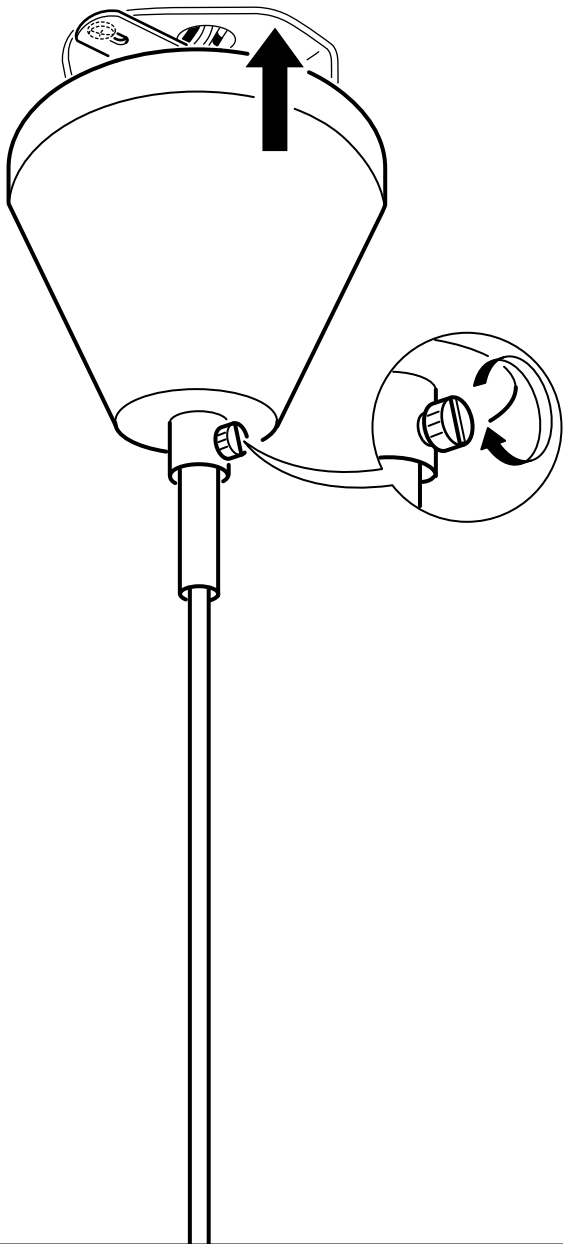

13

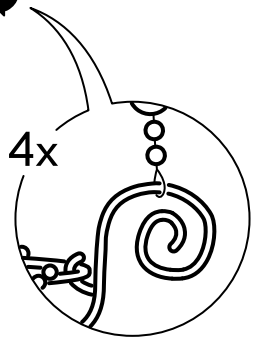
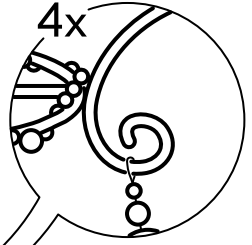
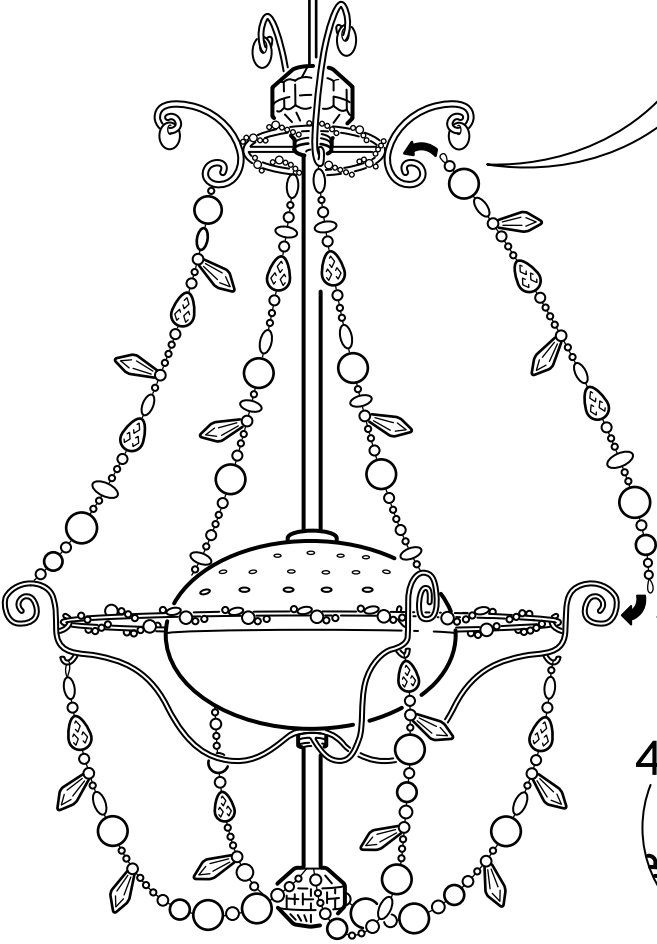

14

